

DATE	
BY	
ORIGINAL SURVEY	
FLUORESCENT PLOTTED	
REPLACEMENT	
NO. OF SHEETS	
AREAS CHECKED	

DATE	
BY	
ORIGINAL SURVEY	
FLUORESCENT PLOTTED	
REPLACEMENT	
NO. OF SHEETS	
AREAS CHECKED	

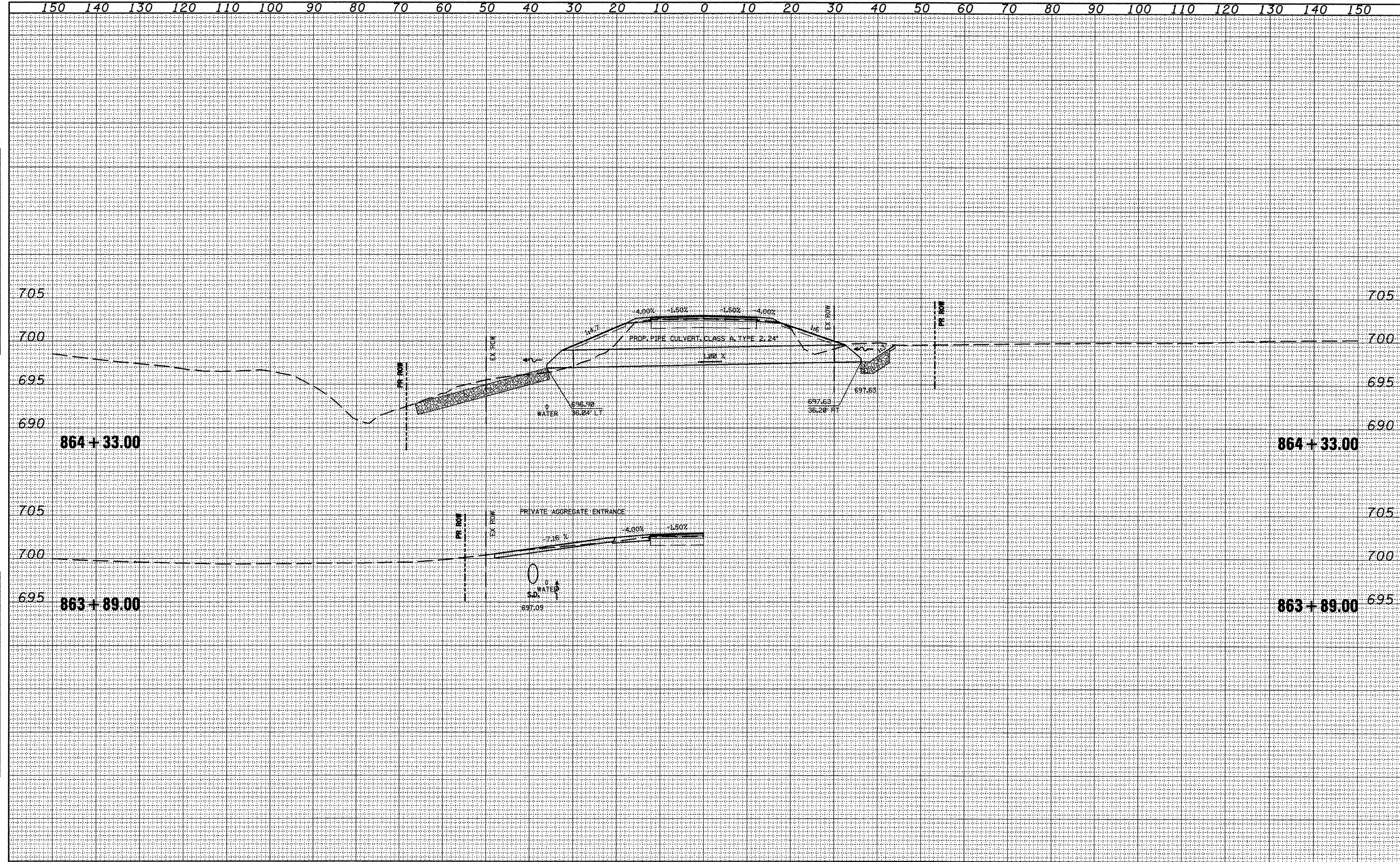

FILE NAME = xsec.sheet.dgn	USER NAME = jochums.jg	DESIGNED -	REVISED -	STATE OF ILLINOIS DEPARTMENT OF TRANSPORTATION	CROSS SECTIONS				
		DRAWN -	REVISED -		F. #/A.P. RTE. 317	SECTION 16W-2,RS-4+17W-1,RS-3	COUNTY FULTON	TOTAL SHEETS 240	SHEET NO. 233
		CHECKED -	REVISED -		SCALE:	SHEET NO. OF SHEETS	STA. 863+65.94 TO STA. 864+33.00	CONTRACT NO. 88703	
		DATE -	REVISED -		ILLINOIS FED. AID PROJECT				