

TRAFFIC SIGNAL LEGEND

	PROPOSED	EXISTING
DETECTOR LOOP	□	□
SIGNAL HEAD		△
G.S. CONDUIT IN TRENCH OR PUSHED	---	---
SIGNAL HEAD WITH BACKPLATE		△
RACEWAY FOR MAGNETIC DETECTOR, TYPE I OR II		"E"
VEHICLE DETECTOR, NON-COMPENSATED MAGNETIC TYPE		□

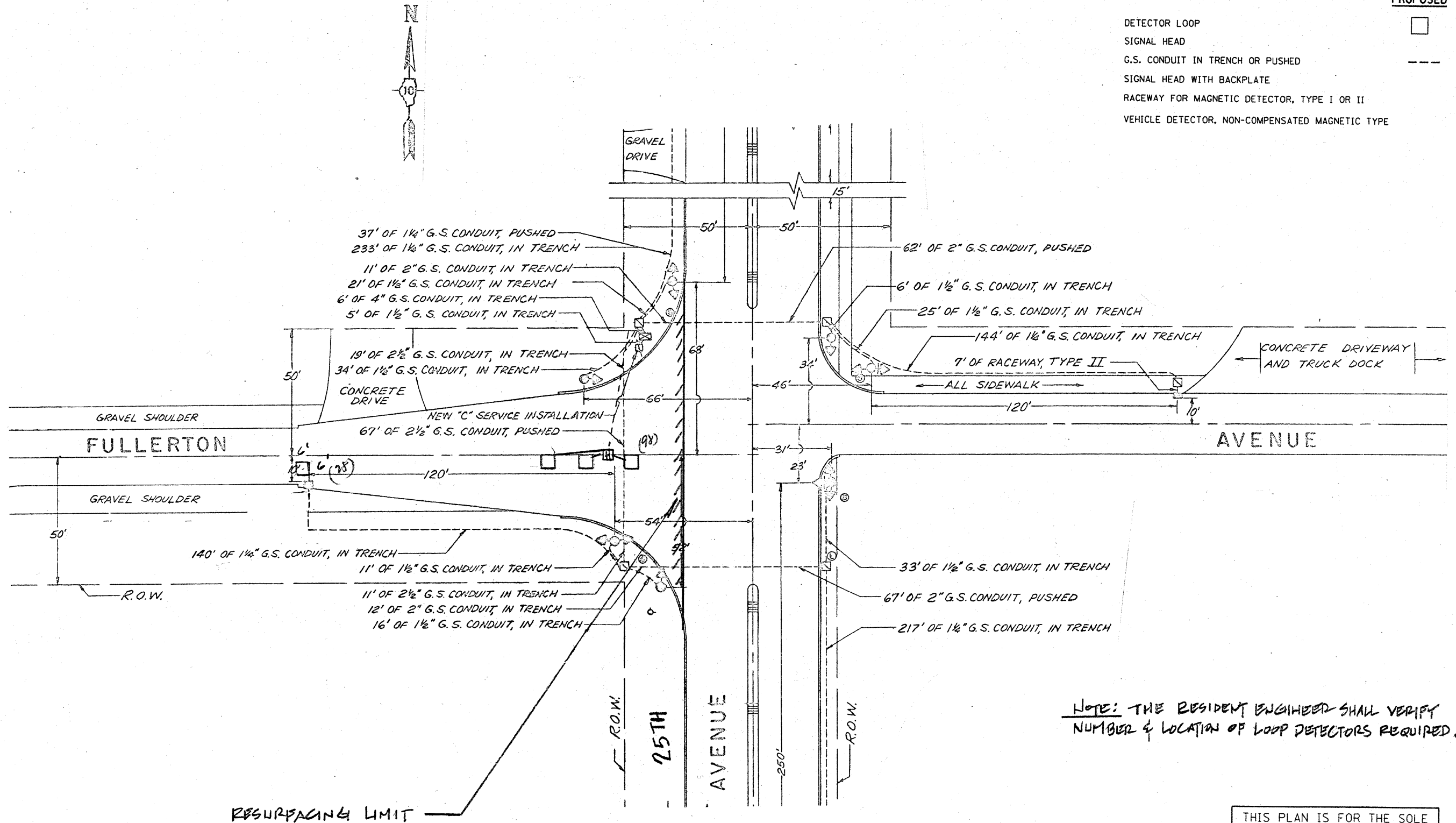

NOTE: THE RESIDENT ENGINEER SHALL VERIFY NUMBER & LOCATION OF LOOP DETECTORS REQUIRED.

THIS PLAN IS FOR THE SOLE PURPOSE OF DETECTOR LOOP REPLACEMENTS ONLY

REPLACE ALL DETECTOR LOOPS AS SHOWN (WITHIN THE RESURFACING LIMITS)

CODE	QUANTITY	UNIT	ITEM
88600600	126	FOOT	DETECTOR LOOP, REPLACEMENT

FILE NAME =	USER NAME = kanthaphixaybc	DESIGNED - BCK	REVISED -
ci:\pw\work\K\PWIDOT\KANTHAPHIXAYBC\081126	4\traffic.legend.v7.dgn	DRAWN - BCK	REVISED -
	PLOT SCALE = 3/4" = 1' IN.	CHECKED - DAD	REVISED -
	PLOT DATE = 4/3/2009	DATE -	REVISED -

**STATE OF ILLINOIS
DEPARTMENT OF TRANSPORTATION**

**DISTRICT ONE - DETECTOR LOOP REPLACEMENT
FULLERTON AV. @ 25TH AVENUE**

F.A.U. RTE.	SECTION	COUNTY	TOTAL SHEETS	SHEET NO.
1381	2000-048RS	COOK	17	8
FED. ROAD DIST. NO.			ILLINOIS FED. AID PROJECT	
			60957	

SCALE: NONE SHEET NO. OF SHEETS STA. TO STA.