

PROP. 6" WHITE THERMOPLASTIC CROSSWALK (2 LINES @ 6" C-C) (TYP.)
 PROP. 4" YELLOW THERMOPLASTIC 2 LINES @ 11" C-C (TYP.)
 PROP. 6" WHITE THERMOPLASTIC SKIP-DASH (10' DASH, 30' SKIP) (TYP.)
 PARKING LANES (TYP.)
 PROP. WHITE THERMOPLASTIC LETTERS & SYMBOLS (TYP.)
 PROP. HMA SURFACE REMOVAL, 2 1/4"
 PROP. POLYMERIZED HMA SURFACE COURSE, MIX "D", N70, 1 3/4"
 PROP. POLYMERIZED LEVELING BINDER (MM), N50, 3/4"

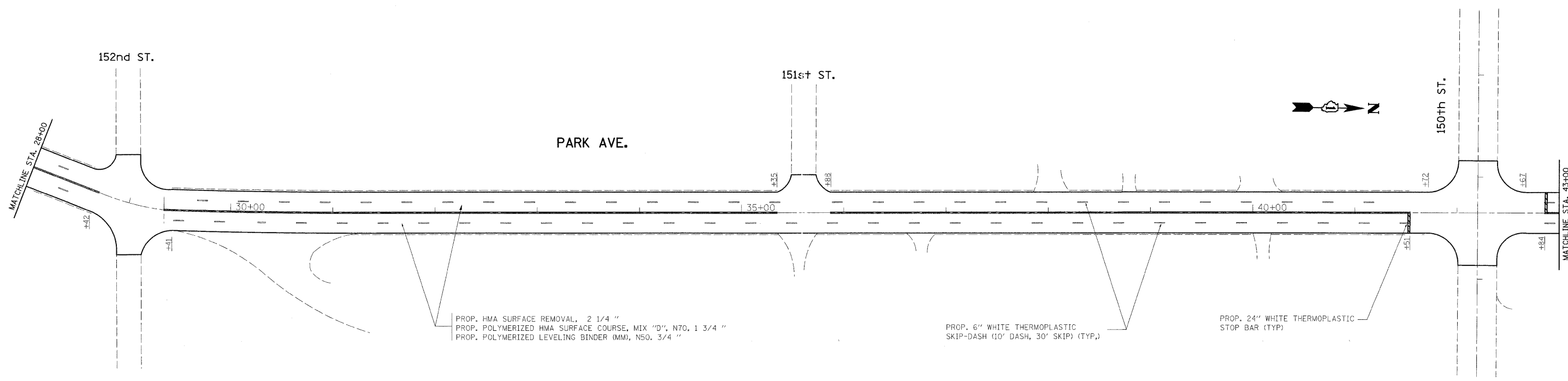

PROP. HMA SURFACE REMOVAL, 2 1/4"
 PROP. POLYMERIZED HMA SURFACE COURSE, MIX "D", N70, 1 3/4"
 PROP. POLYMERIZED LEVELING BINDER (MM), N50, 3/4"
 PROP. 6" WHITE THERMOPLASTIC SKIP-DASH (10' DASH, 30' SKIP) (TYP.)
 PROP. 24" WHITE THERMOPLASTIC STOP BAR (TYP.)

FILE NAME =	USER NAME = mitchellrf	DESIGNED -	REVISED -	STATE OF ILLINOIS DEPARTMENT OF TRANSPORTATION	ROADWAY AND PAVEMENT MARKING PLAN PARK AVE. (154th ST. - IL. RTE. 1)				F.A.U. RTE.	SECTION	COUNTY	TOTAL SHEETS	SHEET NO.
ci:\pw_work\pwidot\mitchellrf\d8137633\DI16526-shr-plan.dgn		DRAWN -	REVISED -		3597	163 RS	COOK	20	6				
PLOT SCALE = 58.5122' / IN.		CHECKED -	REVISED -		SCALE: 1"=50'				SHEET NO. OF SHEETS STA. TO STA.				
PLOT DATE = 4/17/2009		DATE -	REVISED -		CONTRACT NO. 60A52 ILLINOIS FED. AID PROJECT								