

TRAFFIC SIGNAL LEGEND

	PROPOSED	EXISTING
DETECTOR LOOP		
SIGNAL HEAD		
G.S. CONDUIT IN TRENCH OR PUSHED		
SIGNAL HEAD WITH BACKPLATE		
RACEWAY FOR MAGNETIC DETECTOR, TYPE I OR II		
VEHICLE DETECTOR, NON-COMPENSATED MAGNETIC TYPE		

THERE IS NO IMPACT TO THE INTERCONNECT TO ILL. RTE. 64 @ RAILROAD AVE. SEE INTERCONNECT PLANS IN CONTRACT 62092.

RESURFACING LIMITS

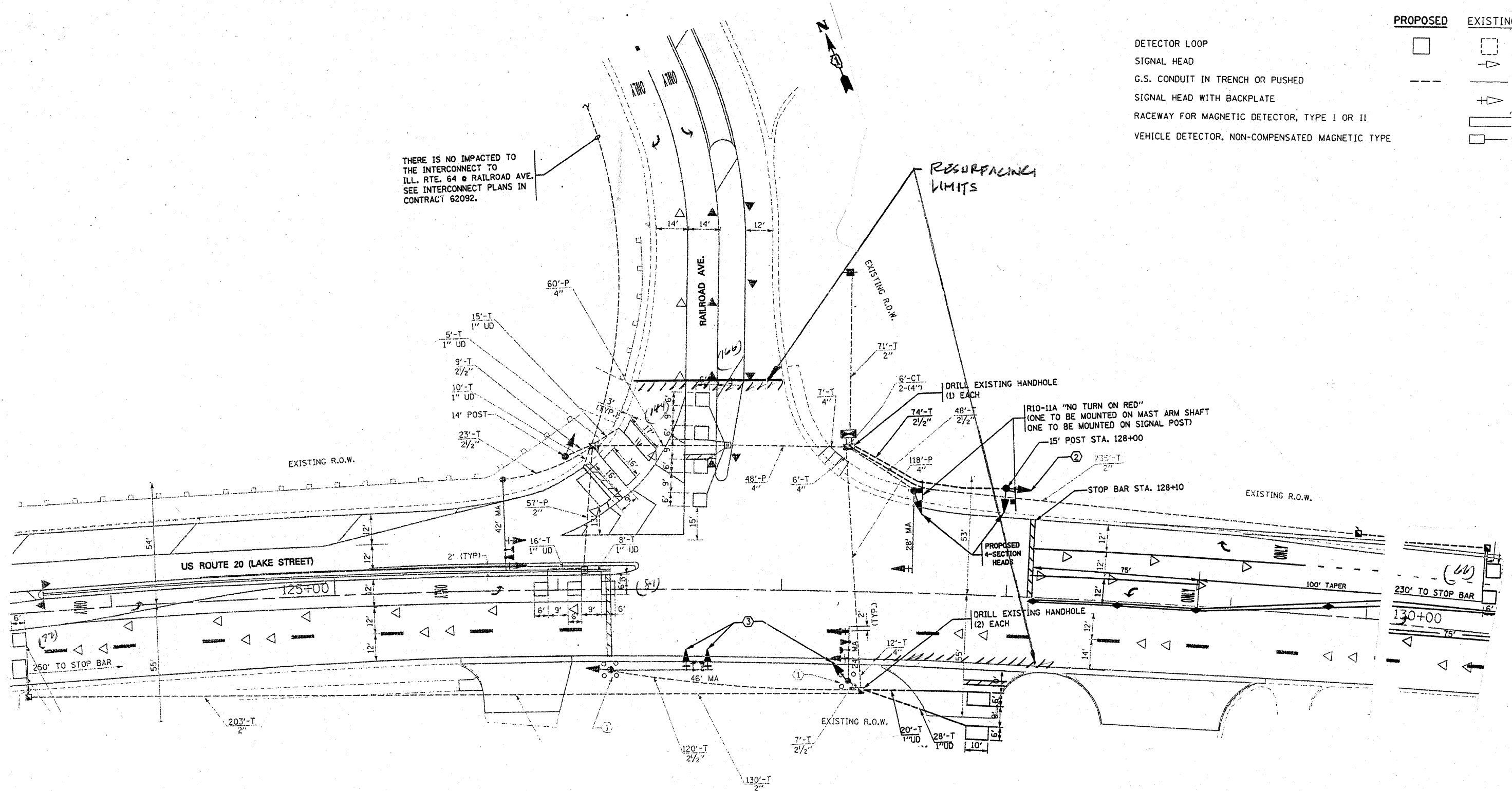

THIS PLAN IS FOR THE SOLE PURPOSE OF DETECTOR LOOP REPLACEMENTS ONLY

REPLACE ALL DETECTOR LOOPS AS SHOWN (WITHIN THE RESURFACING LIMITS)

CODE	QUANTITY	UNIT	ITEM
86600600	529	FOOT	DETECTOR LOOP, REPLACEMENT

FILE NAME =
c:\pwworksp\KVPW1001\KANTHAPHIXAYBC\081126

USER NAME = kanthaphixaybc
4\traffic.legend.v7.dgn
PLOT SCALE = 39.9360' / IN.
PLOT DATE = 4/3/2009

DESIGNED - BCK
DRAWN - BCK
CHECKED - DAD
DATE

REVISED -
REVISED -
REVISED -
REVISED -

STATE OF ILLINOIS
DEPARTMENT OF TRANSPORTATION

DISTRICT ONE - DETECTOR LOOP REPLACEMENT
U.S. RTE. 20 @ RAILROAD AVENUE

SCALE: NONE SHEET NO. OF SHEETS STA. TO STA.

F.A. RTE.	SECTION	COUNTY	TOTAL SHEETS	SHEET NO.
		COOK	21	8D
CONTRACT NO.				

FED. ROAD DIST. NO. ILLINOIS FED. AID PROJECT