

TRAFFIC SIGNAL LEGEND

	PROPOSED	EXISTING
DETECTOR LOOP		
SIGNAL HEAD		
G.S. CONDUIT IN TRENCH OR PUSHED		
SIGNAL HEAD WITH BACKPLATE		
RACEWAY FOR MAGNETIC DETECTOR, TYPE I OR II		
VEHICLE DETECTOR, NON-COMPENSATED MAGNETIC TYPE		

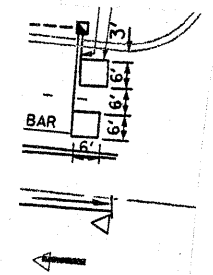
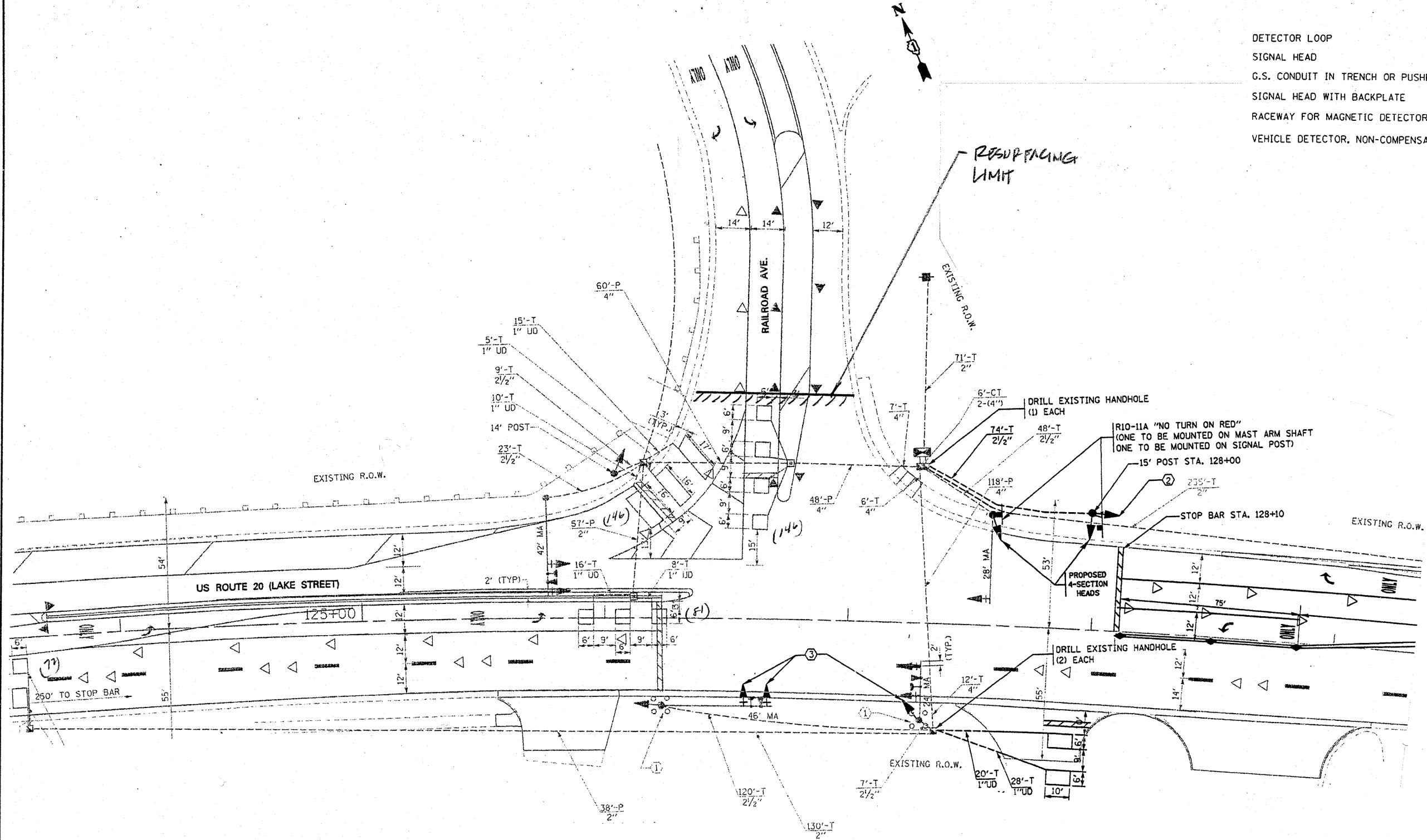

THIS PLAN IS FOR THE SOLE PURPOSE OF DETECTOR LOOP REPLACEMENTS ONLY

REPLACE ALL DETECTOR LOOPS AS SHOWN (WITHIN THE RESURFACING LIMITS)

CODE	QUANTITY	UNIT	ITEM
86600600	511	FOOT	DETECTOR LOOP, REPLACEMENT

FILE NAME =	USER NAME = kanthaphixaybc
es:\p\work\p\WIDOT\KANTHAPHIXAYBC\d01126	4\tr\of\ic.legend_v7.dgn
	PLOT SCALE = 39.9368 / IN.
	PLOT DATE = 4/3/2009

DESIGNED - BCK	REVISED -
DRAWN - BCK	REVISED -
CHECKED - DAD	REVISED -
DATE	REVISED -

**STATE OF ILLINOIS
DEPARTMENT OF TRANSPORTATION**

**DISTRICT ONE - DETECTOR LOOP REPLACEMENT
U.S. ROUTE 20 @ RAILROAD AVENUE**

F.A. RTE.	SECTION	COUNTY	TOTAL SHEETS	SHEET NO.
			LOOK 21	BE
CONTRACT NO.				

SCALE: NONE SHEET NO. OF SHEETS STA. TO STA.

FED. ROAD DIST. NO. ILLINOIS FED. AID PROJECT