

F.A.J. RTE.	SECTION	COUNTY	TOTAL SHEETS	SHEET NO.
3537	3264 RS-5	COOK	21	1
FED. ROAD DIST. NO.	ILLINOIS	CONTRACT NO. 60A89		

*21+6=27

D-91-121-06



LOCATION OF SECTION INDICATED THUS: -

STATE OF ILLINOIS
DEPARTMENT OF TRANSPORTATION
DIVISION OF HIGHWAYS

**PROPOSED
HIGHWAY PLANS**

FAU-3537 (U.S. 20-LAKE ST.)
COUNTY LINE RD. TO U.S. 12 /45 (MANNHEIM RD.)
SECTION 3264 RS-5
RESURFACING IMPROVEMENT
COOK COUNTY
C-91-121-06

FOR INDEX OF SHEETS, SEE SHEET NO. 2

IMPROVEMENT LOCATED IN THE VILLAGE OF:
MELROSE PARK, NORTHLAKE, STONE PARK

CONSULTANT PROJECT ENGINEER: ISSAM RAYYAN (847) 705-4556

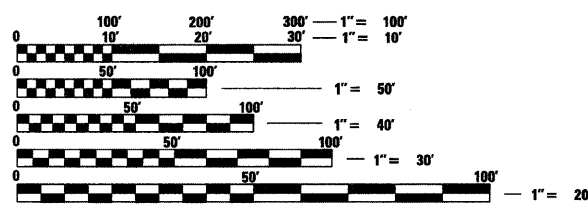

FULL SIZE PLANS HAVE BEEN PREPARED USING STANDARD ENGINEERING SCALES. REDUCED SIZED PLANS WILL NOT CONFORM TO STANDARD SCALES. IN MAKING MEASUREMENTS ON REDUCED PLANS, THE ABOVE SCALES MAY BE USED.

J.U.L.I.E.
JOINT UTILITY LOCATION INFORMATION FOR EXCAVATION
1-800-892-0123
OR 811

benesch
alfred benesch & company
Engineers • Surveyors • Planners
205 North Michigan Avenue, Suite 2400
Chicago, Illinois 60601
312-565-0450

CONTRACT NO. 60A89

PROJECT BEGINS
STA. 82+90

PROJECT ENDS
STA. 185+50

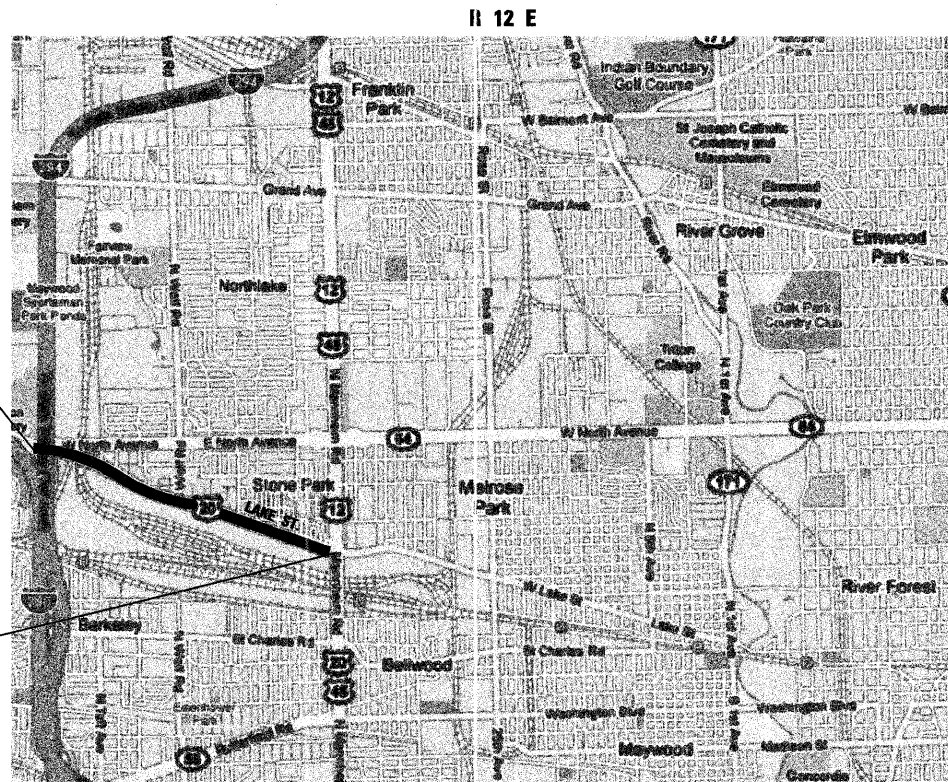

TOWNSHIP OF PROVISO

GROSS AND NET LENGTH OF IMPROVEMENT = 10,260 LIN. FEET OR 1.943 MILES



T 39 N

TRAFFIC DATA
ADT (2006) = 22,500
SPEED LIMIT
U.S. 20 (NORTH AVE. TO MANNHEIM RD.) = 35 MPH

ANDREW J. PIHALY
ALFRED BENESCH & CO.

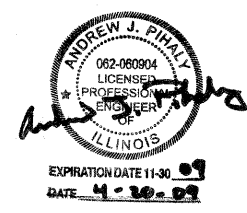

STATE OF ILLINOIS
DEPARTMENT OF TRANSPORTATION
DIVISION OF HIGHWAYS

SUBMITTED APRIL 21 20 09

Devin M. O'Keefe DEPUTY DIRECTOR OF HIGHWAYS, REGION ENGINEER
May 1, 20 09

Charles J. Ingersoll ENGINEER OF DESIGN AND ENVIRONMENT
May 1, 20 09

Christine M. Reed DIRECTOR OF HIGHWAYS, CHIEF ENGINEER

PRINTED BY THE AUTHORITY
OF THE STATE OF ILLINOIS

INDEX OF SHEETS

GENERAL NOTES

SHEET NO.	DESCRIPTION
1	COVER SHEET
2	INDEX OF SHEETS, STATE STANDARDS & GENERAL NOTES
3	SUMMARY OF QUANTITIES
4	EXISTING AND PROPOSED TYPICAL SECTIONS
5 - 8	ROADWAY AND PAVEMENT MARKING PLANS
8A-8F	DETECTOR LOOP REPLACEMENT
9	DETAILS FOR FRAMES AND LIDS ADJUSTMENT WITH MILLING (BD-8)
10	PAVEMENT PATCHING FOR HMA SURFACED PAVEMENT (BD-22)
11	CURB OR CURB AND GUTTER REMOVAL AND REPLACEMENT (BD-24)
12	BUTT JOINT AND HMA TAPER DETAILS (BD-32)
13	HMA TAPER AT EDGE OF PCC PAVEMENT (BD-33)
14	TRAFFIC CONTROL AND PROTECTION FOR SIDE ROADS, INTERSECTIONS, AND DRIVEWAYS, (TC-10)
15	TYPICAL APPLICATIONS: RAISED REFLECTIVE PAVEMENT MARKERS (SNOW PLOW RESISTANT) (TC-11)
16	DISTRICT ONE TYPICAL PAVEMENT MARKINGS (TC-13)
17	TRAFFIC CONTROL AND PROTECTION AT TURN BAYS (TO REMAIN OPEN TO TRAFFIC) (TC-14)
18	PAVEMENT MARKING LETTERS AND SYMBOLS FOR TRAFFIC STAGING (TC-16)
19	ARTERIAL ROAD INFORMATION SIGN (TC-22)
20	DRIVEWAY ENTRANCE SIGNING (TC-26)
21	DISTRICT 1 DETECTOR LOOP INSTALLATION DETAILS FOR ROADWAY RESURFACING (TS-07)

- BEFORE STARTING ANY EXCAVATION, THE CONTRACTOR SHALL CALL "JULIE" AT 1-800-892-0123 FOR FIELD LOCATIONS OF BURIED ELECTRIC, TELEPHONE AND GAS FACILITIES, (48 HOUR NOTIFICATION IS REQUIRED).
- 10 FEET TRANSITIONS SHALL BE USED TO MATCH PROPOSED CURB AND GUTTER AND MEDIAN ITEMS OF WORK TO EXISTING CURBS & CUTTERS AND MEDIANS IN THE FIELD, UNLESS OTHERWISE SHOWN. THE TRANSITIONS SHALL BE PAID FOR AT THE CONTRACT UNIT PRICE FOR THE PROPOSED ITEMS OF WORK SPECIFIED.
- THE CONTRACTOR SHALL COORDINATE CONSTRUCTION ACTIVITIES WITH UTILITY COMPANIES AND THE VILLAGES OF NORTHLAKE, MELROSE PARK, AND STONE PARK.
- THE CONTRACTOR WILL NOT BE ALLOWED TO SET UP A YARD OR FIELD OFFICE ON STATE PROPERTY WITHOUT WRITTEN PERMISSION FROM THE DEPARTMENT.
- WHEN MILLED PAVEMENT IS OPEN TO TRAFFIC THE MAXIMUM GRADE DIFFERENTIAL BETWEEN PASSES OF THE MILLING MACHINE SHALL NOT EXCEED 1 1/2 INCHES WHERE THE SPEED LIMIT IS 45 MPH OR LESS AND 1 INCH WHERE THE SPEED LIMIT IS GREATER THAN 45 MPH. WITH WRITTEN APPROVAL FROM THE ENGINEER, A MAXIMUM GRADE DIFFERENTIAL OF 3 INCHES MAY BE ALLOWED IF THE EDGE OF THE MILLING IS SLOPED A MINIMUM 1:3 (V:H).
- BUTT JOINTS WILL BE INSTALLED AT THE ENDS OF ALL RESURFACING (WHERE RESURFACING MEETS EXISTING PAVEMENT). IN ACCORDANCE WITH THE "BUTT JOINT AND HMA TAPER DETAILS" SHEET INCLUDED IN THE PLANS, UNLESS OTHERWISE SPECIFIED.
- THE RESIDENT ENGINEER SHALL CONTACT CORY JUCIUS, TRAFFIC CONTROL SUPERVISOR AT (847) 705-4470 A MINIMUM OF 72 HOURS PRIOR TO THE PLACEMENT OF ANY TEMPORARY TRAFFIC CONTROL DEVICES.
- THE RESIDENT ENGINEER SHALL CONTACT WALTER CZARNY, AREA TRAFFIC FIELD ENGINEER AT (773) 685-4342 AT LEAST (2) WEEKS PRIOR TO PLACEMENT OF PERMANENT PAVEMENT MARKINGS.
- ALL PAVEMENT MARKING SHALL BE PLACED THROUGHOUT THE PROJECT ACCORDING TO DISTRICT 1 TYPICAL PAVEMENT MARKING.
- ALL HMA PAVEMENT PATCHING SHALL BE CLASS D.
- ANY PAVEMENT MARKINGS AND RAISED REFLECTIVE PAVEMENT MARKERS OBLITERATED BY MILLING AND RESURFACING OPERATIONS ON SIDE STREETS AND ENTRANCES SHALL BE REPLACED AND PAID FOR IN KIND.
- BEFORE BEGINNING ANY WORK, THE CONTRACTOR SHALL RETAIN AND RECORD (FOR FUTURE REFERENCES), ALL EXISTING PAVEMENT MARKING LINES IN ORDER THAT THESE LOCATIONS CAN BE RE-ESTABLISHED FOR STRIPING. EXACT LOCATIONS OF ALL STRIPING SHALL BE AS DIRECTED BY THE ENGINEER.
- ALL PAVEMENT PATCHING LOCATIONS WILL BE DETERMINED IN THE FIELD BY THE ENGINEER.
- DRAINAGE ADJUSTMENT, CLEANING OR RECONSTRUCTION LOCATIONS WILL BE DETERMINED IN THE FIELD BY THE ENGINEER.
- THE CONTRACTOR SHALL BE REQUIRED TO PROVIDE ACCESS TO ABUTTING PROPERTY AT ALL TIMES DURING THE CONSTRUCTION OF THIS PROJECT.
- EXISTING BROKEN FRAMES AND LIDS SHALL BE REMOVED AND DISPOSED OF BY THE CONTRACTOR AND SHALL BE REPLACED AS DIRECTED BY THE ENGINEER. REPLACEMENT FRAMES AND LIDS WILL BE PAID FOR IN ACCORDANCE WITH ARTICLE 109.04 OF THE STANDARD SPECIFICATIONS UNLESS A SEPARATE PAY ITEM HAS BEEN PROVIDED.
- DO NOT SCALE PLANS FOR CONSTRUCTION DIMENSIONS. STATIONS ARE SHOWN FOR REFERENCE ONLY AND ARE APPROXIMATE.

- WHEN ARTIFICIAL LIGHTING IS USED IN NIGHT OPERATIONS THE CONTRACTOR SHALL EXERCISE THE UTMOST PRECAUTIONS IN PREVENTING ADVERSE VISIBILITY TO THE MOTORING PUBLIC AND ADJOINING RESIDENTIAL AREAS.
- IT SHALL BE THE CONTRACTOR'S RESPONSIBILITY TO VERIFY ALL DIMENSIONS AND CONDITIONS EXISTING IN THE FIELD PRIOR TO CONSTRUCTION AND ORDERING OF MATERIALS.
- SAW CUTTING PRIOR TO ANY REMOVAL ITEMS NOTED ON THE PLANS OR DIRECTED BY THE ENGINEER SHALL BE CONSIDERED INCLUDED IN THE COST OF THE ITEMS BEING REMOVED.
- THE CONTRACTOR SHALL USE CARE IN REMOVING OR EXCAVATING NEAR ALL EXISTING ITEMS WHICH WILL REMAIN. ANY DAMAGE DONE TO EXISTING ITEMS BY THE CONTRACTOR SHALL BE REPAIRED AT THE CONTRACTOR'S EXPENSE.
- UNLESS OTHER CONDITIONS WARRANT, EXTENDED LANE CLOSURES SHALL BE AS DETERMINED AND APPROVED IN WRITING BY THE ENGINEER OR AS PROVIDED FOR IN THE CONTRACT SPECIFICATIONS. OVERNIGHT CLOSURES SHALL NOT BE ALLOWED FOR REHABILITATION PROJECTS INVOLVING DAYTIME MILLING AND RESURFACING OPERATIONS AND CLASS D PATCHING.
- PAVEMENT MARKING TAPE, TYPE III SHALL BE USED FOR SHORT TERM PAVEMENT MARKINGS AND TEMPORARY PAVEMENT MARKINGS ON ALL FINAL SURFACES. THE COST OF THE PAVEMENT MARKING TAPE, TYPE III SHALL BE INCLUDED IN THE COST OF SHORT TERM PAVEMENT MARKINGS AND TEMPORARY PAVEMENT MARKINGS.
- TEMPORARY RAMPS AT BUTT JOINTS SHALL BE INCLUDED IN THE COST OF THE BUTT JOINT AS SHOWN ON THE "BUTT JOINT AND HMA TAPER DETAILS" SHEET.
- MATCH EXISTING PAVEMENT MARKINGS AT THE PROJECT AND OMISSION LIMITS.
- PAY ITEM 55039700 - STORM SEWERS TO BE CLEANED - SHALL ONLY BE UTILIZED TO CLEAN STORM SEWER LATERAL PIPES BETWEEN INLETS OR CATCH BASINS AND MAIN SEWERS.

STATE STANDARDS

STANDARD NO.	DESCRIPTION
000001-05	STANDARD SYMBOLS, ABBREVIATION AND PATTERNS
424001-05	CURB RAMPS FOR SIDEWALKS
442201-03	CLASS C AND D PATCHES
604001-03	FRAME AND LIDS TYPE 1
604086-02	FRAME AND GRATE TYPE 23
604091-02	FRAME AND GRATE TYPE 24
606001-04	CONCRETE CURB TYPE B AND COMBINATION CONCRETE CURB AND GUTTER
701601-00	URBAN LANE CLOSURE, MULTILANE, 1W OR 2W WITH NONTRAVERSABLE MEDIAN
701606-00	URBAN LANE CLOSURE, MULTILANE, 2W WITH MOUNTABLE MEDIAN
701701-00	URBAN LANE CLOSURE, MULTILANE INTERSECTION
701901-01	TRAFFIC CONTROL DEVICES
780001-02	TYPICAL PAVEMENT MARKINGS
781001-03	TYPICAL APPLICATIONS RAISED REFLECTIVE PAVEMENT MARKERS

100% STATE I000

SUMMARY OF QUANTITIES			TOTAL	CONSTRUCTION TYPE CODE	
CODE NO.	ITEM DESCRIPTION	UNIT	QUANTITIES	URBAN	
40600100	BITUMINOUS MATERIALS (PRIME COAT)	GALLON	13504	13504	
40600300	AGGREGATE (PRIME COAT)	TON	271	271	
40600400	MIXTURE FOR CRACKS, JOINTS, AND FLANGEWAYS	TON	9	9	
40600895	CONSTRUCTING TEST STRIP	EACH	2	2	
40600982	HOT-MIX ASPHALT SURFACE REMOVAL - BUTT JOINT	SQ YD	587	587	
40601005	HOT-MIX ASPHALT REPLACEMENT OVER PATCHES	TON	228	228	
40603340	HOT-MIX ASPHALT SURFACE COURSE, MIX "D", N70	TON	5,672	5,672	
42400100	PORTLAND CEMENT CONCRETE SIDEWALK 4 INCH	SQ FT	167	167	
44000159	HOT-MIX ASPHALT SURFACE REMOVAL, 2 1/2"	SQ YD	66,931	66,931	
44000200	DRIVEWAY PAVEMENT REMOVAL	SQ YD	28	28	
44000600	SIDEWALK REMOVAL	SQ FT	167	167	
44001700	COMBINATION ^{CONCRETE} CURB AND GUTTER REMOVAL AND REPLACEMENT	FOOT	555	555	
44002212	HOT-MIX ASPHALT REMOVAL OVER PATCHES, 3"	SQ YD	1,353	1,353	
44201749	CLASS D PATCHES, TYPE I, 9 INCH	SQ YD	68	68	
44201753	CLASS D PATCHES, TYPE II, 9 INCH	SQ YD	203	203	
44201757	CLASS D PATCHES, TYPE III, 9 INCH	SQ YD	406	406	
44201759	CLASS D PATCHES, TYPE IV, 9 INCH	SQ YD	676	676	
55039700	STORM SEWERS TO BE CLEANED	FOOT	105	105	
60252800	CATCH BASINS TO BE RECONSTRUCTED	EACH	1	1	
60257900	MANHOLES TO BE RECONSTRUCTED	EACH	1	1	
60300205	FRAMES AND GRATES TO BE ADJUSTED (SPECIAL)	EACH	7	7	
60300310	FRAMES AND LIDS TO BE ADJUSTED (SPECIAL)	EACH	33	33	
67000400	ENGINEER'S FIELD OFFICE, TYPE A	CAL MO	8	8	
67100100	MOBILIZATION	L SUM	1	1	
70102625	TRAFFIC CONTROL AND PROTECTION, STANDARD 701606	L SUM	1	1	
70102630	TRAFFIC CONTROL AND PROTECTION, STANDARD 701601	L SUM	1	1	
70102635	TRAFFIC CONTROL AND PROTECTION, STANDARD 701701	L SUM	1	1	
70300100	SHORT-TERM PAVEMENT MARKING	FOOT	12,284	12,284	
70300210	TEMPORARY PAVEMENT MARKING - LETTERS AND SYMBOLS	SQ FT	546	546	

100% STATE I000

SUMMARY OF QUANTITIES			TOTAL	CONSTRUCTION TYPE CODE	
CODE NO.	ITEM DESCRIPTION	UNIT	QUANTITIES	URBAN	
70300220	TEMPORARY PAVEMENT MARKING - LINE 4"	FOOT	24,567	24,567	
70300240	TEMPORARY PAVEMENT MARKING - LINE 6"	FOOT	2,985	2,985	
70300250	TEMPORARY PAVEMENT MARKING - LINE 8"	FOOT	1,000	1,000	
70300260	TEMPORARY PAVEMENT MARKING - LINE 12"	FOOT	465	465	
70300280	TEMPORARY PAVEMENT MARKING - LINE 24"	FOOT	356	356	
78000100	THERMOPLASTIC PAVEMENT MARKING - LETTERS AND SYMBOLS	SQ FT	546	546	
78000200	THERMOPLASTIC PAVEMENT MARKING - LINE 4"	FOOT	24,567	24,567	
78000400	THERMOPLASTIC PAVEMENT MARKING - LINE 6"	FOOT	2,985	2,985	
78000500	THERMOPLASTIC PAVEMENT MARKING - LINE 8"	FOOT	1,000	1,000	
78000600	THERMOPLASTIC PAVEMENT MARKING - LINE 12"	FOOT	465	465	
78000650	THERMOPLASTIC PAVEMENT MARKING - LINE 24"	FOOT	356	356	
78100100	RAISED REFLECTIVE PAVEMENT MARKER	EACH	1,023	1,023	
78300200	RAISED REFLECTIVE PAVEMENT MARKER REMOVAL	EACH	767	767	
81900200	TRENCH AND BACKFILL FOR ELECTRICAL WORK	FOOT	115	115	
88600600	DETECTOR LOOP REPLACEMENT	FOOT	2,287	2,287	
X0322256	TEMPORARY INFORMATION SIGNING	SQ FT	154	154	
X4067107	POLYMERIZED LEVELING BINDER (MACHINE METHOD), IL-4.75, N50	TON	3,545	3,545	
Z0018500	DRAINAGE STRUCTURES TO BE CLEANED	EACH	3	3	
Z0048665	RAILROAD PROTECTIVE LIABILITY INSURANCE	L SUM	1	1	

* SPECIALTY ITEM

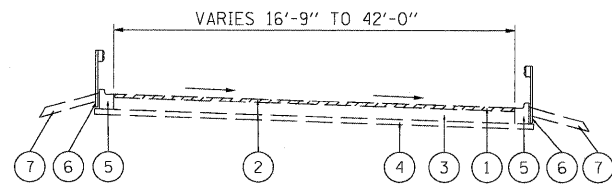

**US 20 - LAKE STREET
EXISTING TYPICAL SECTION**
RAMP OVER NORTH AVE.

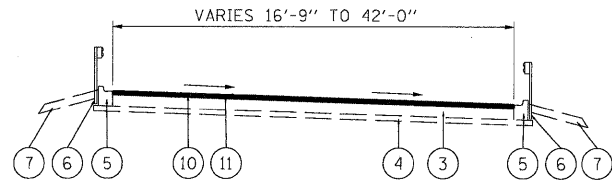

**US 20 - LAKE STREET
PROPOSED TYPICAL SECTION**
RAMP OVER NORTH AVE.

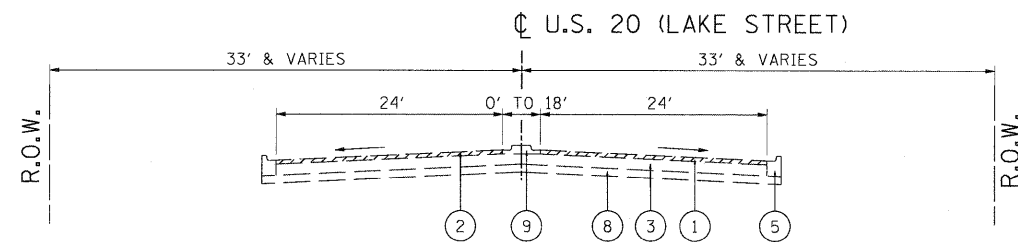

**US 20 - LAKE STREET
EXISTING TYPICAL SECTION**

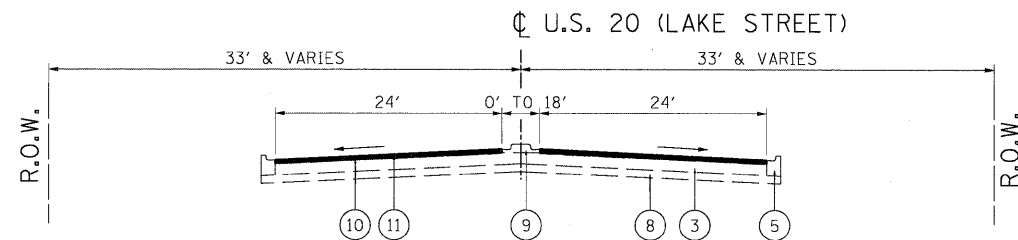

**US 20 - LAKE STREET
PROPOSED TYPICAL SECTION**

LEGEND

- ① EXISTING BITUMINOUS PAVEMENT, 3"
- ② PROPOSED HOT-MIX ASPHALT SURFACE REMOVAL, 2 1/2"
- ③ EXISTING P.C.C. BASE COURSE, 9"
- ④ EXISTING STABILIZED SUB-BASE
- ⑤ EXISTING COMB. CONC. CURB & GUTTER (VARIOUS TYPES)
- ⑥ EXISTING GUARD RAIL
- ⑦ EXISTING BITUMINOUS SHOULDERS
- ⑧ EXISTING SUB-BASE GRANULAR MATERIAL, TYPE A, 6"
- ⑨ EXISTING CONCRETE MEDIAN
- ⑩ PROPOSED POLYMERIZED LEVELING BINDER (MACHINE METHOD), IL-4.75, N50, 3/4" - 1"
- ⑪ PROPOSED HOT-MIX ASPHALT SURFACE COURSE, MIX "D", N70, 1 1/2"

NOTES:

- 1. THE UNIT WEIGHT USED TO CALCULATE ALL HOT MIX ASPHALT SURFACE MIXTURES IS 112 LBS/SQ YD/IN.
- 2. WHEN RAP EXCEEDS 20%, THE NEW ASPHALT BINDER IN THE MIX SHALL BE PG 58-22.
- 3. CROSS-SECTION SLOPE SHOULD BE PAVED TO 2.00% OR TO MATCH EXISTING AS DIRECTED BY THE ENGINEER.
- 4. CONCRETE CURB & GUTTER TO BE REMOVED AND REPLACED AS DIRECTED BY THE ENGINEER.

HOT-MIX ASPHALT MIXTURE REQUIREMENTS		
MIX TYPE	AC TYPE	AIR VOIDS
HOT-MIX ASPHALT SURFACE COURSE, MIX "D", N70 (IL 9.5 mm)	PG 64-22	4% @ 70 GYR
POLYMERIZED LEVELING BINDER (MACHINE METHOD), IL-4.75, N50	SBS/SBR PG 76-28/-22	4% @ 50 GYR
HMA REPLACEMENT OVER PATCHES (HMA BINDER IL-19 mm)	PG 64-22•	4% @ 70 GYR
CLASS D PATCH (HMA BINDER IL-19 mm)	PG 64-22•	4% @ 70 GYR

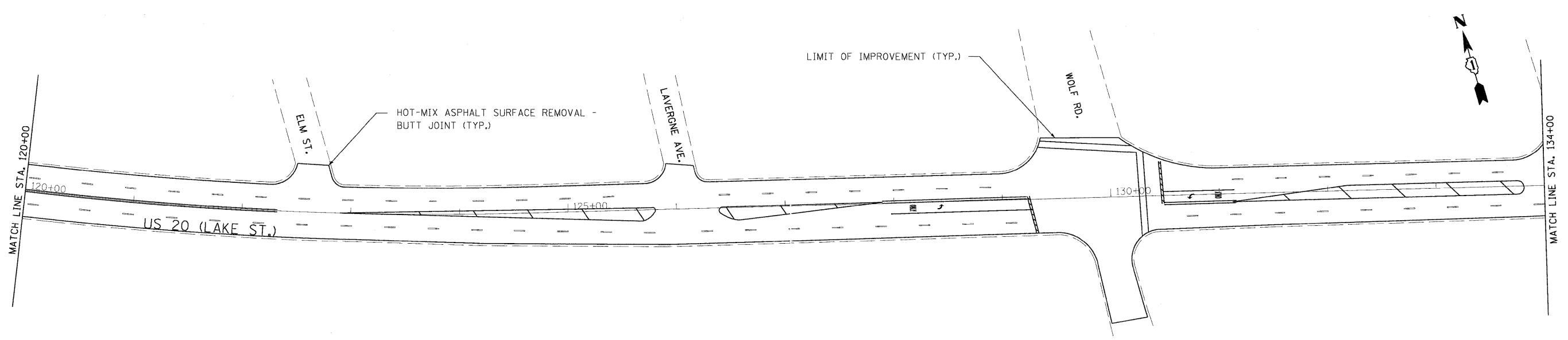
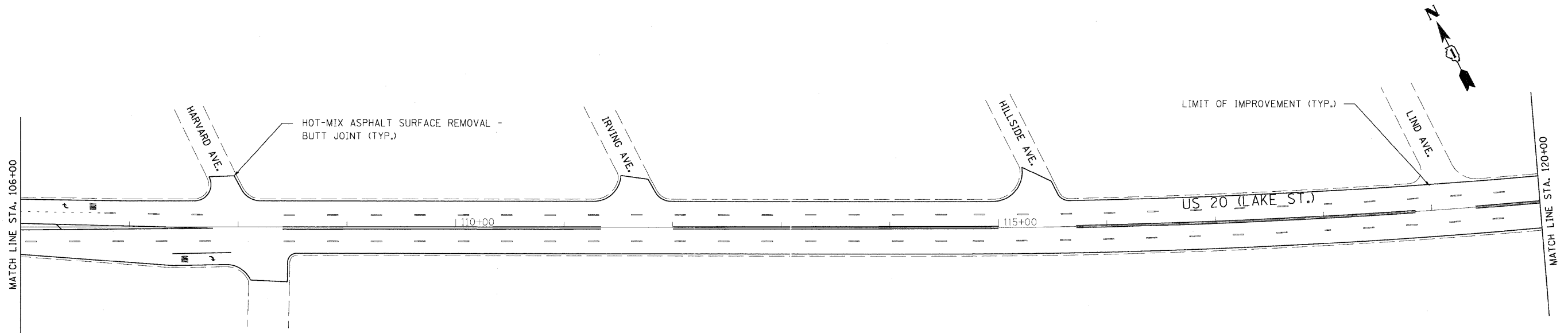

FILE NAME =
 ...N\plans\p1n12105pp&mrk02.dgn

USER NAME = aphaly
 PLOT SCALE = 1" = 50'
 PLOT DATE = 4/21/2009

DESIGNED - AJP
 DRAWN - IS
 CHECKED - JR
 DATE - 4/21/2009

REVISED -
 REVISED -
 REVISED -
 REVISED -

**STATE OF ILLINOIS
 DEPARTMENT OF TRANSPORTATION**

**ROADWAY AND PAVEMENT MARKING PLAN
 US 20 (LAKE ST) - COUNTY LINE RD TO US 12 /45 (MANNHEIM RD)**

SCALE: 1" = 50' SHEET NO. OF SHEETS STA. 106+00 TO STA. 134+00

F.A.J. RTE.	SECTION	COUNTY	TOTAL SHEETS	SHEET NO.
3537	3264 RS-5	COOK	21	6
CONTRACT NO. 60A89				
FED. ROAD DIST. NO. ILLINOIS FED. AID PROJECT				

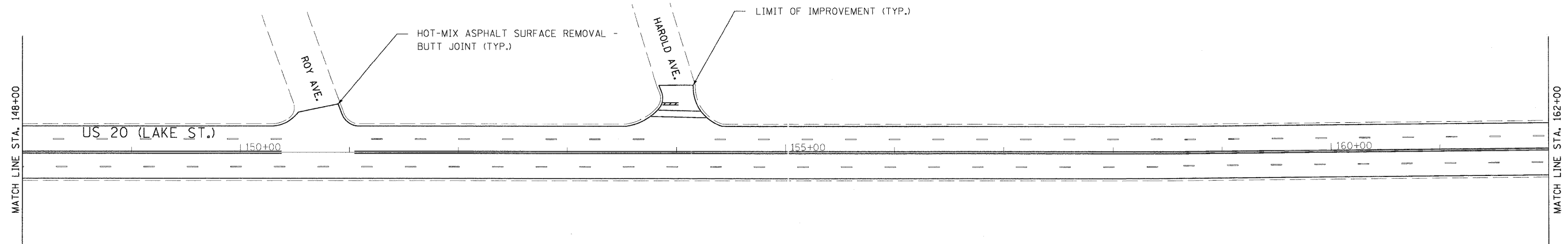
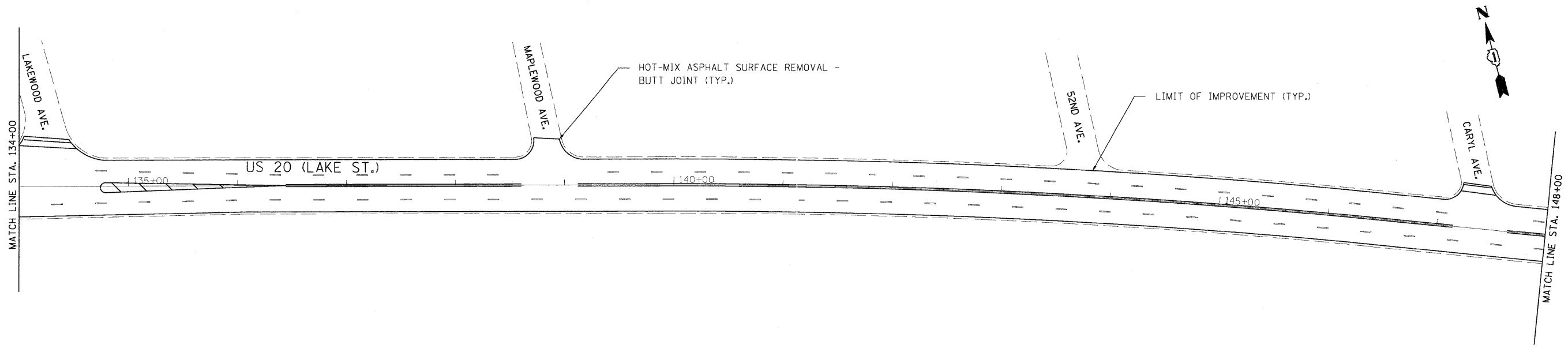

FILE NAME =
 ...Plans\p1n12186pp&mrk03.dgn

USER NAME = eptholy
 PLOT SCALE = 1" = 50'
 PLOT DATE = 4/21/2009

DESIGNED - AJP
 DRAWN - IS
 CHECKED - JR
 DATE - 4/21/2009

REVISED -
 REVISED -
 REVISED -
 REVISED -

**STATE OF ILLINOIS
 DEPARTMENT OF TRANSPORTATION**

**ROADWAY AND PAVEMENT MARKING PLAN
 US 20 (LAKE ST) - COUNTY LINE RD TO US 12 /45 (MANNHEIM RD)**

SCALE: 1" = 50' SHEET NO. OF SHEETS STA. 134+00 TO STA. 162+00

F.A.U. RTE. 3537	SECTION 3264 RS-5	COUNTY COOK	TOTAL SHEETS 21	SHEET NO. 7
FED. ROAD DIST. NO. ILLINOIS FED. AID PROJECT			CONTRACT NO. 60A89	

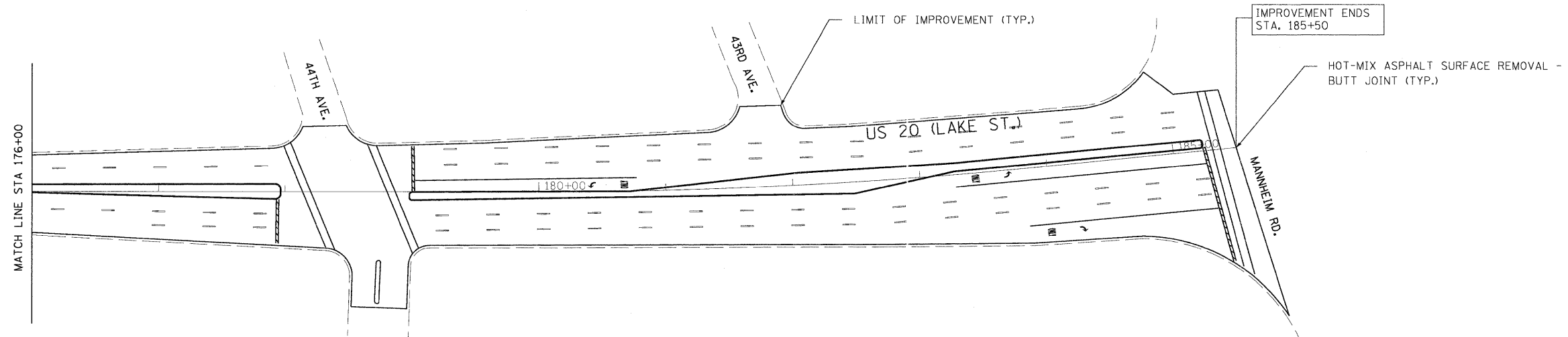
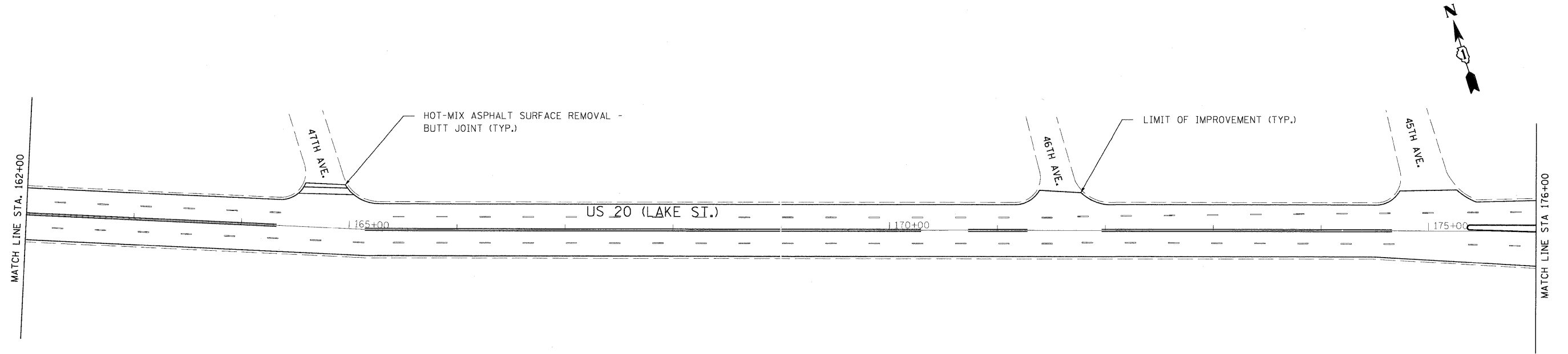

FILE NAME =
 ...Plans\p1n12186pp&mrk04.dgn

USER NAME = apahaly
 DESIGNED - AJP
 DRAWN - IS
 CHECKED - JR
 DATE - 4/21/2009

REVISED -
 REVISED -
 REVISED -
 REVISED -

**STATE OF ILLINOIS
 DEPARTMENT OF TRANSPORTATION**

**ROADWAY AND PAVEMENT MARKING PLAN
 US 20 (LAKE ST) - COUNTY LINE RD TO US 12 /45 (MANNHEIM RD)**

F.A.U. RTE.	SECTION	COUNTY	TOTAL SHEETS	SHEET NO.
3537	3264 RS-5	COOK	21	8
FED. ROAD DIST. NO.			ILLINOIS FED. AID PROJECT	
			CONTRACT NO. 60A89	

SCALE: 1" = 50' SHEET NO. OF SHEETS STA. 162+00 TO STA. 185+50

TRAFFIC SIGNAL LEGEND

	PROPOSED	EXISTING
DETECTOR LOOP		
SIGNAL HEAD		
G.S. CONDUIT IN TRENCH OR PUSHED		
SIGNAL HEAD WITH BACKPLATE		
RACEWAY FOR MAGNETIC DETECTOR, TYPE I OR II		
VEHICLE DETECTOR, NON-COMPENSATED MAGNETIC TYPE		

COUNTY LAKE RD.
(No Signals)

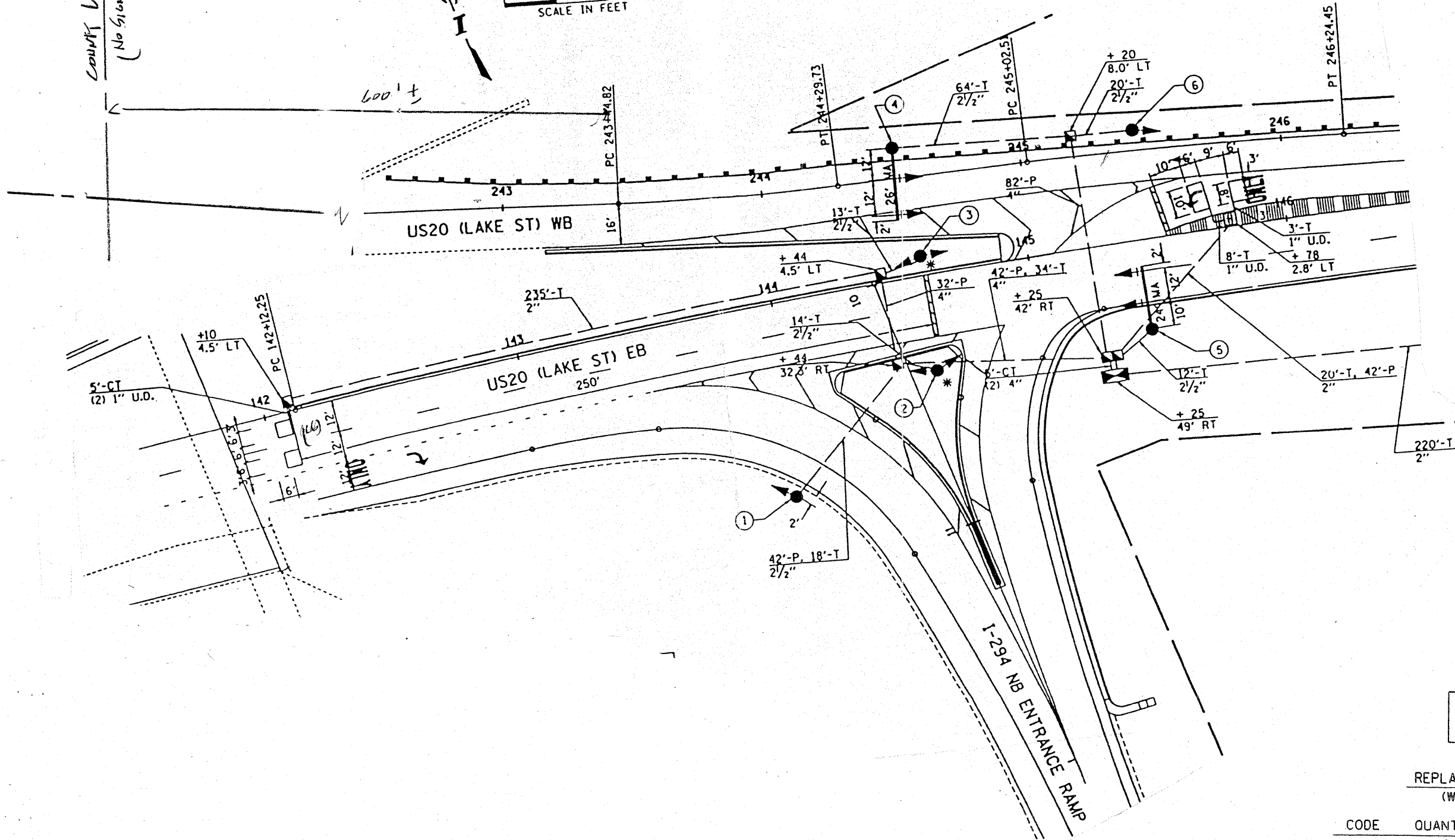
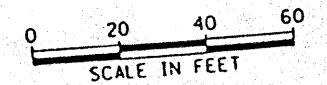

THIS PLAN IS FOR THE SOLE PURPOSE OF DETECTOR LOOP REPLACEMENTS ONLY

REPLACE ALL DETECTOR LOOPS AS SHOWN (WITHIN THE RESURFACING LIMITS)

CODE	QUANTITY	UNIT	ITEM
86600600	146	FOOT	DETECTOR LOOP, REPLACEMENT

FILE NAME =	USER NAME = kanthaphixaybc	DESIGNED - BCK	REVISED -
c:\pwork\pwidot\KANTHAPHIXAYBC\d81126	4\traffic.legend_v7.dgn	DRAWN - BCK	REVISED -
	PLOT SCALE = 39.9360' / IN.	CHECKED - DAD	REVISED -
	PLOT DATE = 4/3/2009	DATE	REVISED -

STATE OF ILLINOIS
DEPARTMENT OF TRANSPORTATION

DISTRICT ONE - DETECTOR LOOP REPLACEMENT
U.S. ROUTE 20 @ I-294 RAMP

SCALE: NONE SHEET NO. 8A OF SHEETS STA. TO STA.

F.A. RTE.	SECTION	COUNTY	TOTAL SHEETS	SHEET NO.
		Cook	21	8A
CONTRACT NO.				

FED. ROAD DIST. NO. ILLINOIS FED. AID PROJECT

SCHEDULE OF QUANTITIES FOR MAGNETIC DETECTOR REPLACEMENTS

(* When Quantities Below Are Shown)

CODE	QUANTITY	UNIT	ITEM
81900200	-0-	FOOT	Trench and Backfill for Electrical Work
85000200	1	EACH	Maintenance of Existing Traffic Signal Installation
87301305	1370	FOOT	Electric Cable in Conduit, Lead-In No. 14 1-Pair
87900200	5	EACH	Drill Existing Handhole
88500100	4	EACH	Inductive Loop Detector
88600100	132	FOOT	Detector Loop, Type I
89502300	1200	FOOT	Remove Electric Cable from Conduit

All Magnetic Detectors will be replaced at a signalized intersection; even if only one magnetic detector is within the resurfacing limits. The "Pay Items" shown above will be paid as per the loop replacement specifications direct for "Magnetic Detectors" during roadway resurfacing projects.

TRAFFIC SIGNAL LEGEND

	PROPOSED	EXISTING
DETECTOR LOOP	[Symbol]	[Symbol]
SIGNAL HEAD	[Symbol]	[Symbol]
C.S. CONDUIT IN TRENCH OR PUSHED	[Symbol]	[Symbol]
SIGNAL HEAD WITH BACKPLATE	[Symbol]	[Symbol]
RACEWAY FOR MAGNETIC DETECTOR, TYPE I OR II	[Symbol]	[Symbol]
VEHICLE DETECTOR, NON-COMPENSATED MAGNETIC TYPE	[Symbol]	[Symbol]

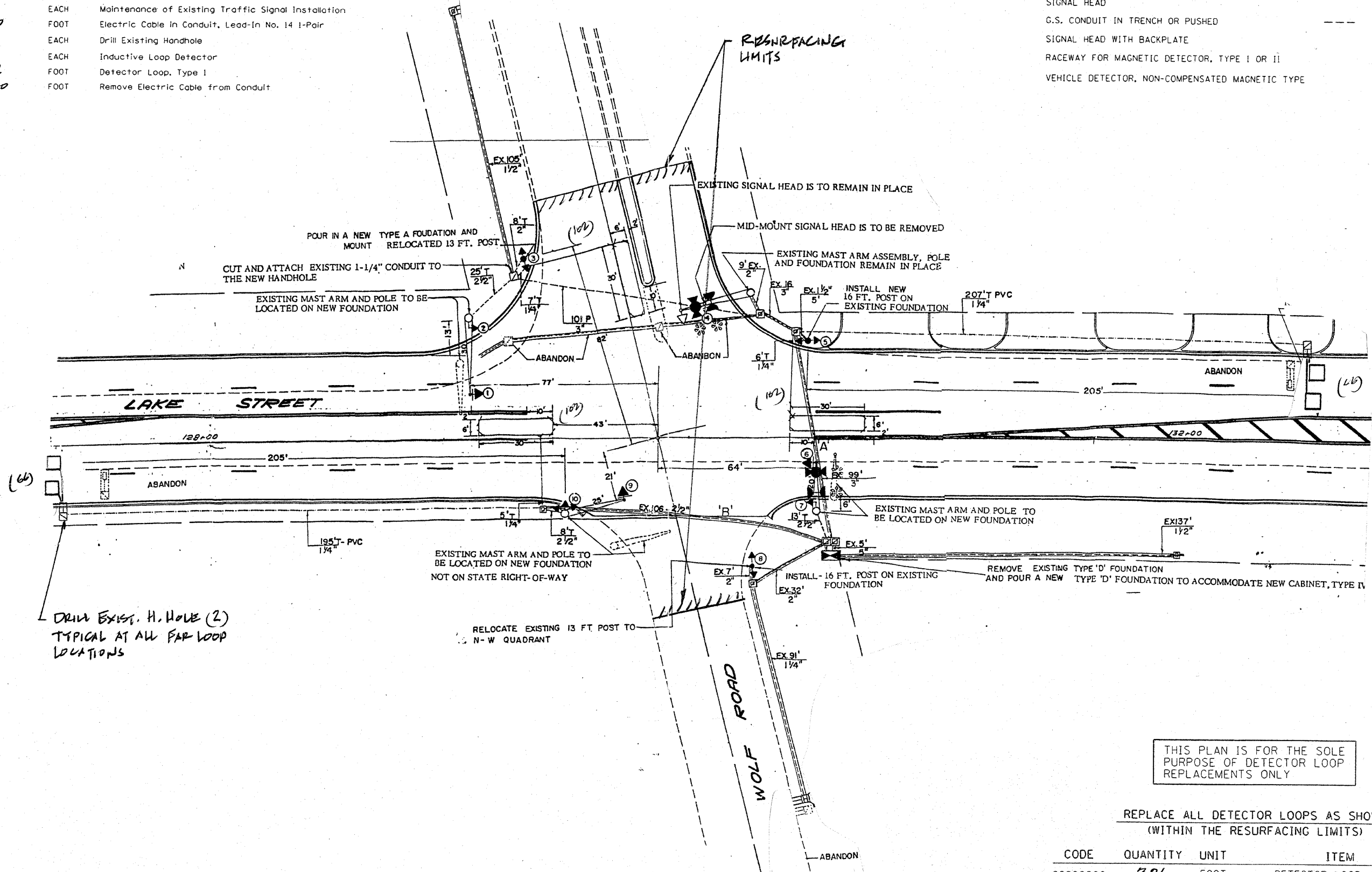

DRILL EXIST. H. HOLE (2)
TYPICAL AT ALL FAR LOOP
LOCATIONS

THIS PLAN IS FOR THE SOLE
PURPOSE OF DETECTOR LOOP
REPLACEMENTS ONLY

REPLACE ALL DETECTOR LOOPS AS SHOWN
(WITHIN THE RESURFACING LIMITS)

CODE	QUANTITY	UNIT	ITEM
86600600	306	FOOT	DETECTOR LOOP, REPLACEMENT

FILE NAME =	USER NAME = kanthaphixaybc	DESIGNED - BCK	REVISED -
c:\pvc\work\p\WIDOT\KANTHAPHIXAYBC\d01126	\traffic\legend.v7.dgn	DRAWN - BCK	REVISED -
PLOT SCALE = 3/8" = 1'	CHECKED - DAD	REVISIONS	
PLOT DATE = 4/3/2009	DATE		

STATE OF ILLINOIS
DEPARTMENT OF TRANSPORTATION

DISTRICT ONE - DETECTOR LOOP REPLACEMENT
U.S. RTE. 20 @ WOLF ROAD

F.A. RTE.	SECTION	COUNTY	TOTAL SHEETS	SHEET NO.
		COOK	21	88
CONTRACT NO.				

SCALE: NONE SHEET NO. OF SHEETS STA. TO STA.

FED. ROAD DIST. NO. ILLINOIS FED. AID PROJECT

TRAFFIC SIGNAL LEGEND

	PROPOSED	EXISTING
DETECTOR LOOP		
SIGNAL HEAD		
G.S. CONDUIT IN TRENCH OR PUSHED		
SIGNAL HEAD WITH BACKPLATE		
RACEWAY FOR MAGNETIC DETECTOR, TYPE I OR II		
VEHICLE DETECTOR, NON-COMPENSATED MAGNETIC TYPE		

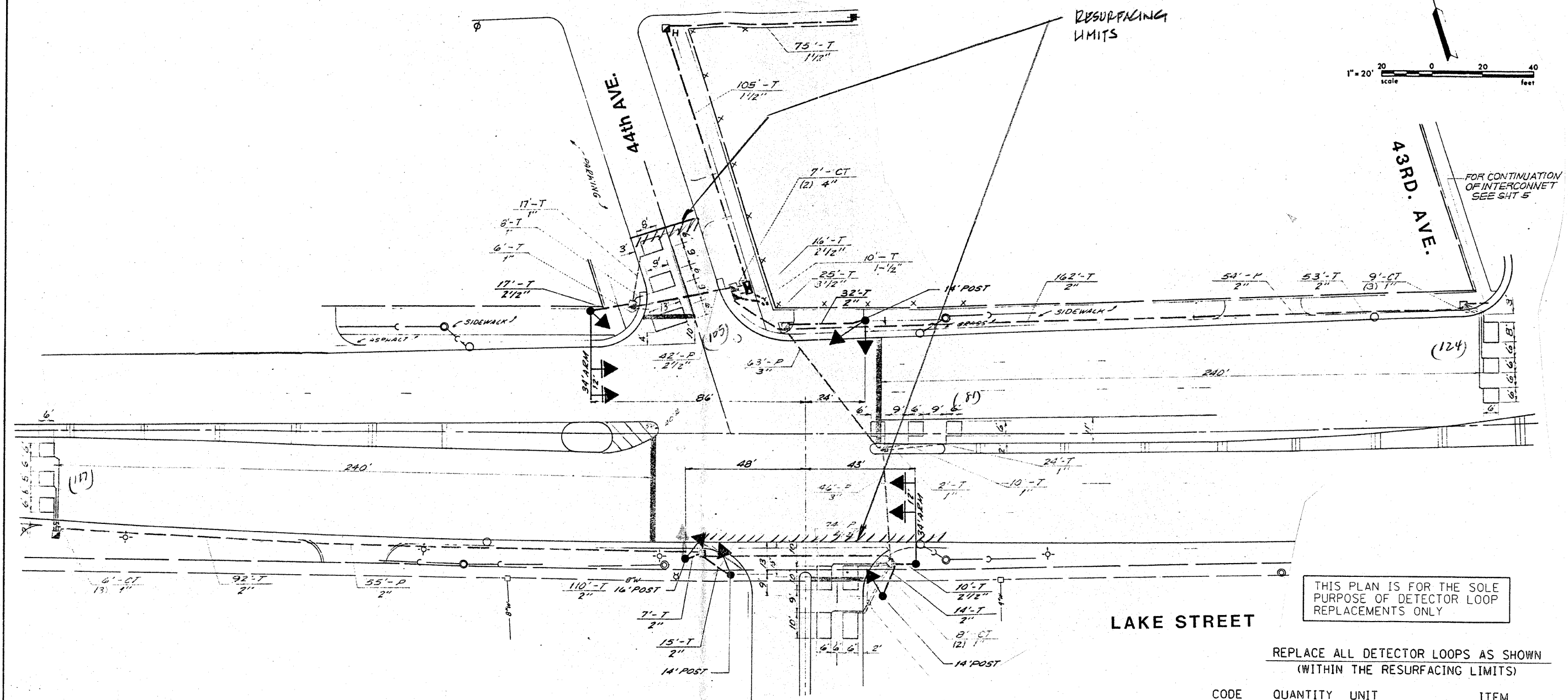
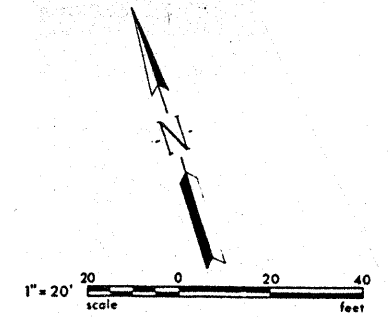

THIS PLAN IS FOR THE SOLE PURPOSE OF DETECTOR LOOP REPLACEMENTS ONLY

REPLACE ALL DETECTOR LOOPS AS SHOWN (WITHIN THE RESURFACING LIMITS)

CODE	QUANTITY	UNIT	ITEM
86600600	427	FOOT	DETECTOR LOOP, REPLACEMENT

FILE NAME *	USER NAME = konthaphixaybc	DESIGNED - BCK	REVISED -
ct:\pwork\PW100T\KANTHAPHIXAYBC\d01126	4\traffsig.legend.v7.dgn	DRAWN - BCK	REVISED -
	PLOT SCALE = 3/8" = 1" IN.	CHECKED - DAD	REVISED -
	PLOT DATE = 4/3/2009	DATE	REVISED -

STATE OF ILLINOIS
DEPARTMENT OF TRANSPORTATION

DISTRICT ONE - DETECTOR LOOP REPLACEMENT
U.S. ROUTE 20 @ 44TH AVENUE

F.A. RTE.	SECTION	COUNTY	TOTAL SHEETS	SHEET NO.
		COOK	21	BC
CONTRACT NO.				

SCALE: NONE SHEET NO. OF SHEETS STA. TO STA.

FED. ROAD DIST. NO. ILLINOIS FED. AID PROJECT

TRAFFIC SIGNAL LEGEND

	PROPOSED	EXISTING
DETECTOR LOOP		
SIGNAL HEAD		
G.S. CONDUIT IN TRENCH OR PUSHED		
SIGNAL HEAD WITH BACKPLATE		
RACEWAY FOR MAGNETIC DETECTOR, TYPE I OR II		
VEHICLE DETECTOR, NON-COMPENSATED MAGNETIC TYPE		

THERE IS NO IMPACT TO THE INTERCONNECT TO ILL. RTE. 64 @ RAILROAD AVE. SEE INTERCONNECT PLANS IN CONTRACT 62092.

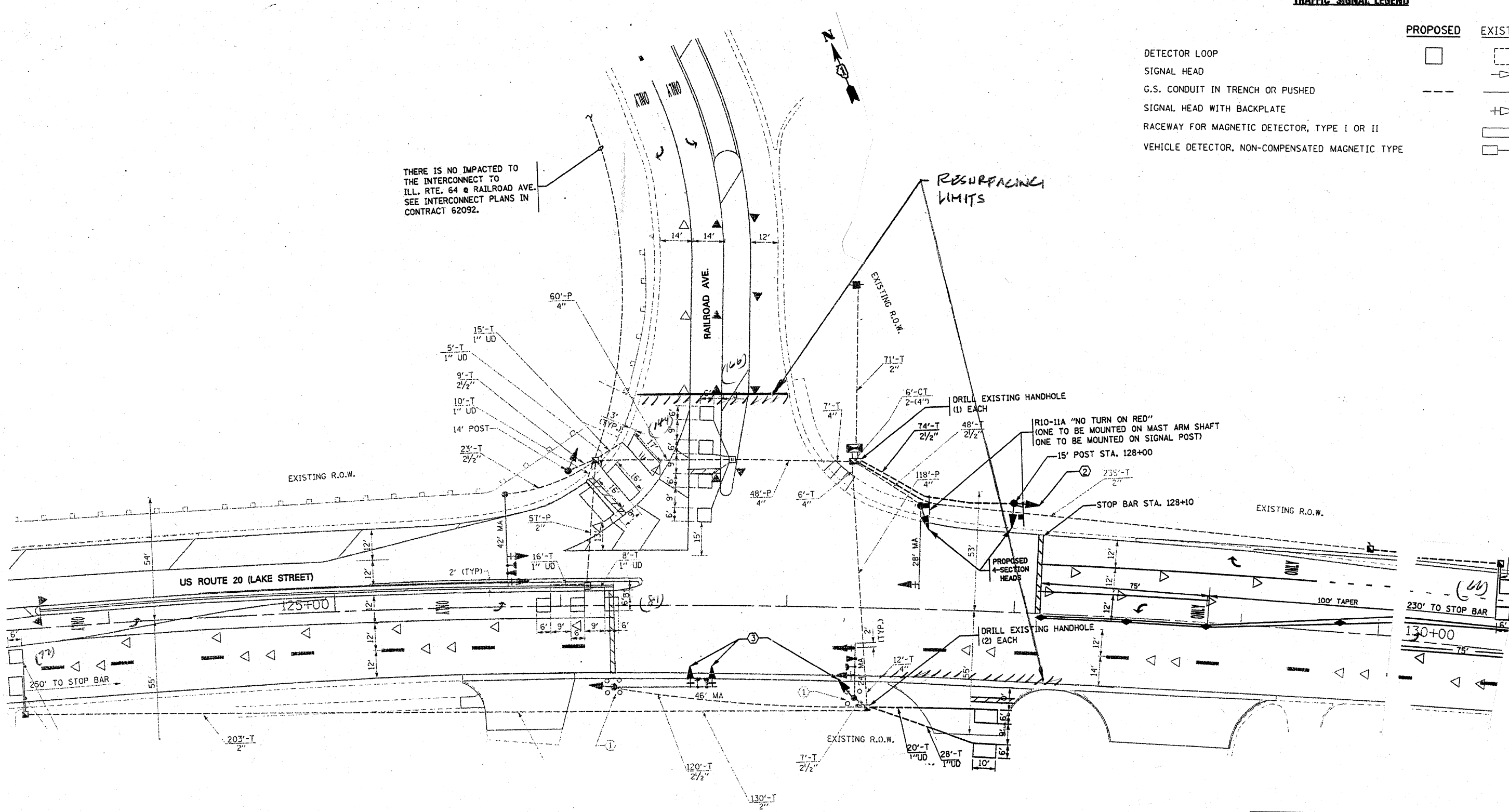

THIS PLAN IS FOR THE SOLE PURPOSE OF DETECTOR LOOP REPLACEMENTS ONLY

REPLACE ALL DETECTOR LOOPS AS SHOWN (WITHIN THE RESURFACING LIMITS)

CODE	QUANTITY	UNIT	ITEM
86600600	529	FOOT	DETECTOR LOOP, REPLACEMENT

FILE NAME =
c:\pwworksp\KANTHAPHIXAYBC\081126

USER NAME = kanthaphixaybc
4\traffic.legend.v7.dgn
PLOT SCALE = 39.9360' / IN.
PLOT DATE = 4/3/2009

DESIGNED - BCK
DRAWN - BCK
CHECKED - DAD
DATE

REVISED -
REVISED -
REVISED -
REVISED -

STATE OF ILLINOIS
DEPARTMENT OF TRANSPORTATION

DISTRICT ONE - DETECTOR LOOP REPLACEMENT
U.S. RTE. 20 @ RAILROAD AVENUE

SCALE: NONE SHEET NO. OF SHEETS STA. TO STA.

F.A. RTE.	SECTION	COUNTY	TOTAL SHEETS	SHEET NO.
		COOK	21	8D
CONTRACT NO.				

FED. ROAD DIST. NO. ILLINOIS FED. AID PROJECT

TRAFFIC SIGNAL LEGEND

	PROPOSED	EXISTING
DETECTOR LOOP		
SIGNAL HEAD		
G.S. CONDUIT IN TRENCH OR PUSHED		
SIGNAL HEAD WITH BACKPLATE		
RACEWAY FOR MAGNETIC DETECTOR, TYPE I OR II		
VEHICLE DETECTOR, NON-COMPENSATED MAGNETIC TYPE		

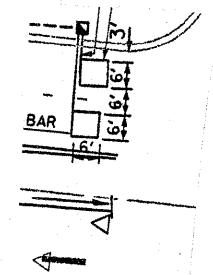
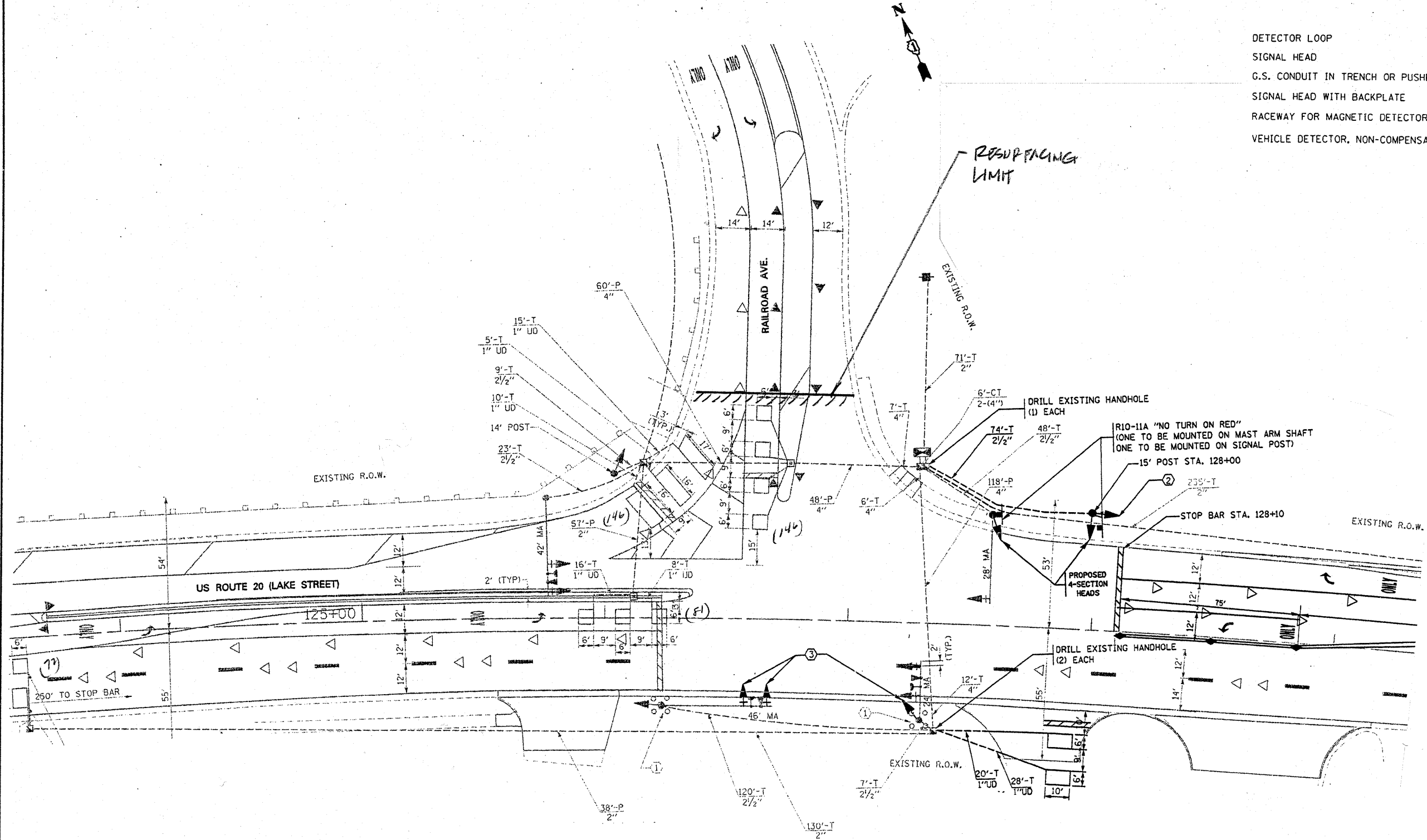

THIS PLAN IS FOR THE SOLE PURPOSE OF DETECTOR LOOP REPLACEMENTS ONLY

REPLACE ALL DETECTOR LOOPS AS SHOWN (WITHIN THE RESURFACING LIMITS)

CODE	QUANTITY	UNIT	ITEM
86600600	511	FOOT	DETECTOR LOOP, REPLACEMENT

FILE NAME =	USER NAME = kanthapixaybc
es:\p\work\p\WIDOT\KANTHAPHIXAYBC\d01126	4\tr\of\ic.legend_v7.dgn
	PLOT SCALE = 39.9368 / IN.
	PLOT DATE = 4/3/2009

DESIGNED - BCK	REVISED -
DRAWN - BCK	REVISED -
CHECKED - DAD	REVISED -
DATE	REVISED -

STATE OF ILLINOIS
DEPARTMENT OF TRANSPORTATION

DISTRICT ONE - DETECTOR LOOP REPLACEMENT
U.S. ROUTE 20 @ RAILROAD AVENUE

F.A. RTE.	SECTION	COUNTY	TOTAL SHEETS	SHEET NO.
			LOOK 21	BE
CONTRACT NO.				

SCALE: NONE SHEET NO. OF SHEETS STA. TO STA.

FED. ROAD DIST. NO. ILLINOIS FED. AID PROJECT

RESURFACING LIMIT

TRAFFIC SIGNAL LEGEND

	PROPOSED	EXISTING
DETECTOR LOOP		
SIGNAL HEAD		
G.S. CONDUIT IN TRENCH OR PUSHED		
SIGNAL HEAD WITH BACKPLATE		
RACEWAY FOR MAGNETIC DETECTOR, TYPE I OR II		
VEHICLE DETECTOR, NON-COMPENSATED MAGNETIC TYPE		

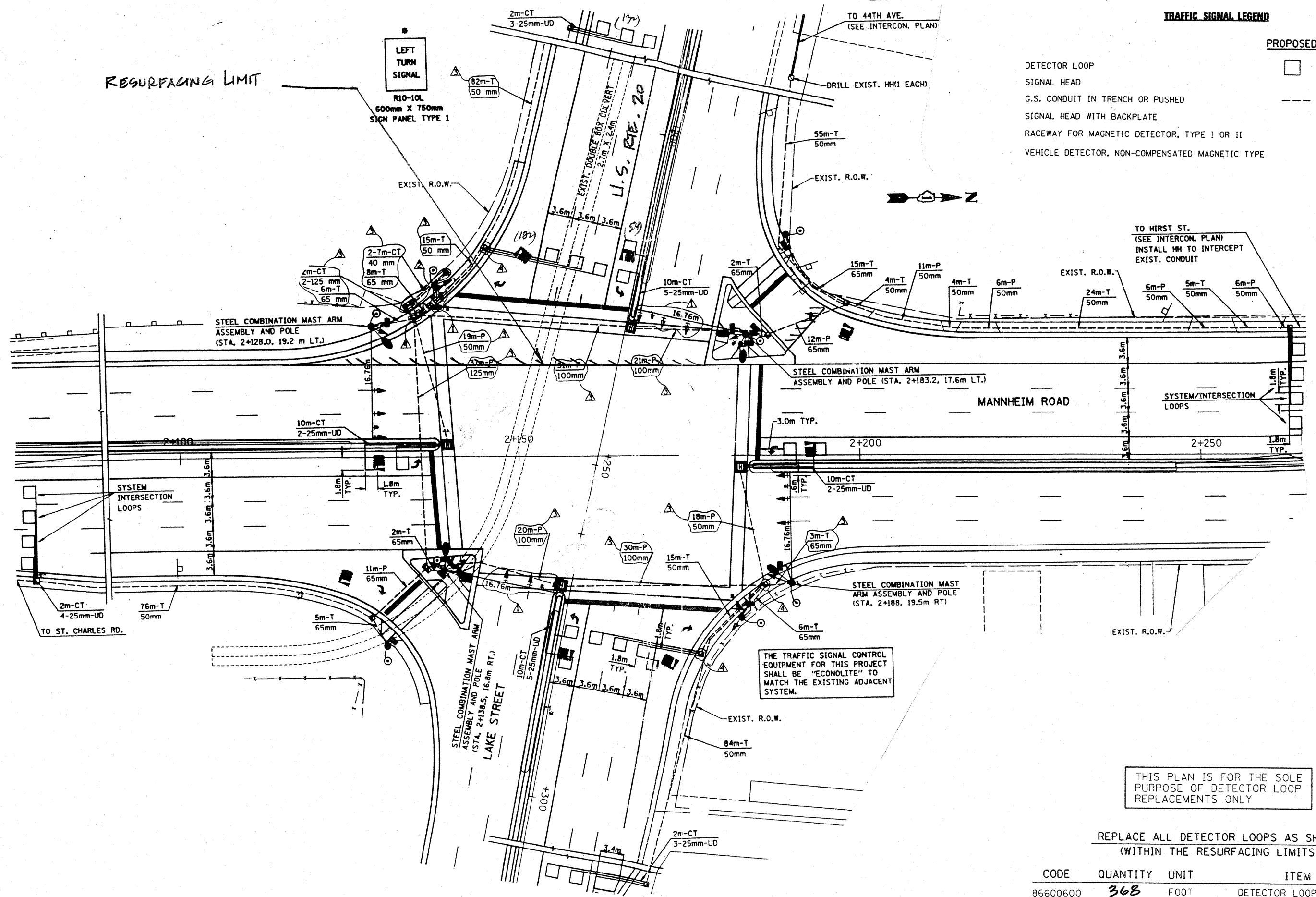

THE TRAFFIC SIGNAL CONTROL EQUIPMENT FOR THIS PROJECT SHALL BE "ECONOLITE" TO MATCH THE EXISTING ADJACENT SYSTEM.

THIS PLAN IS FOR THE SOLE PURPOSE OF DETECTOR LOOP REPLACEMENTS ONLY

REPLACE ALL DETECTOR LOOPS AS SHOWN (WITHIN THE RESURFACING LIMITS)

CODE	QUANTITY	UNIT	ITEM
86600600	368	FOOT	DETECTOR LOOP, REPLACEMENT

STATE OF ILLINOIS
DEPARTMENT OF TRANSPORTATION

DISTRICT ONE - DETECTOR LOOP REPLACEMENT
U.S. RTE. 20 @ U.S. RTE. 12/20/05

F.A. RTE.	SECTION	COUNTY	TOTAL SHEETS	SHEET NO.
		Cook	21	8F

FILE NAME	USER NAME	DESIGNED	REVISED
c:\pwwork\p\1001\KANTHAPHIXAYBC\d1126	kanthaphixaybc	BCK	-
		BCK	-
		DAD	-
		DATE	-

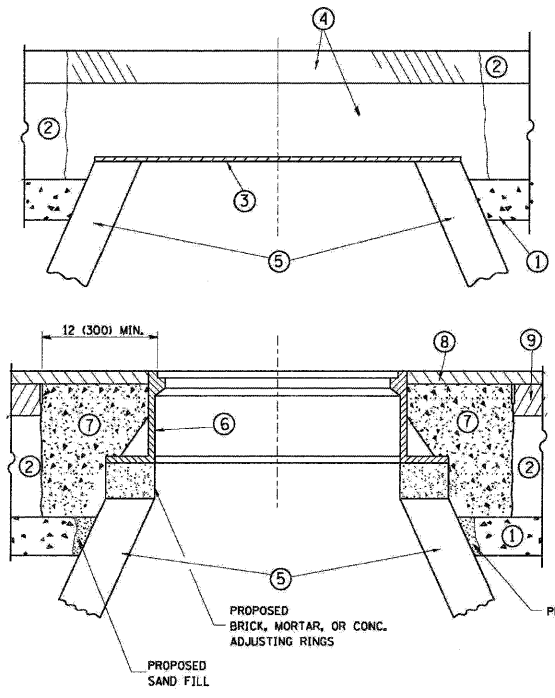

CONSTRUCTION PROCEDURES

- STAGE 1 (BEFORE PAVEMENT MILLING)**
- A) REMOVE A MINIMUM OF 12 (300) OF THE PAVEMENT FROM AROUND THE STRUCTURE.
 - B) REMOVE THE EXISTING FRAME AND LID FROM THE STRUCTURE.
 - C) COVER THE STRUCTURE OPENING WITH A 36 (900) DIAMETER METAL PLATE.
 - D) BACKFILL WITH CRUSHED STONE AND A MINIMUM 1 1/2 (40) THICK HMA SURFACE MIX APPROVED BY THE ENGINEER.
- STAGE 2 (AFTER PAVEMENT MILLING)**
- A) REMOVE THE HMA SURFACE MIX AND CRUSHED STONE.
 - B) INSTALL THE FRAME AND LID; ADJUST THE FRAME TO ITS FINAL SURFACE ELEVATION.
 - C) THE SURROUNDING SPACE SHALL BE FILLED WITH CLASS S1 CONCRETE, OR HMA SURFACE COURSE OR HMA BINDER COURSE TO THE ELEVATION OF THE SURFACE OF THE EXISTING BASE COURSE OR THE BINDER COURSE.

THE PROCEDURE EXPLAINED ABOVE SHALL CONFORM TO THE APPLICABLE PORTIONS OF SECTIONS 353, 406, 602, AND 603 OF THE STANDARD SPECIFICATIONS.

LEGEND

- ① SUB-BASE GRANULAR MATERIAL
- ② EXISTING PAVEMENT
- ③ 36 (900) DIAMETER METAL PLATE
- ④ PROPOSED CRUSHED STONE AND HMA SURFACE MIX
- ⑤ EXISTING STRUCTURE
- ⑥ FRAME AND LID (SEE NOTES)
- ⑦ CLASS S1 CONCRETE, HMA SURFACE COURSE OR HMA BINDER COURSE
- ⑧ PROPOSED HMA SURFACE COURSE
- ⑨ PROPOSED HMA BINDER COURSE

NOTES:

EXISTING BROKEN FRAMES AND LIDS SHALL BE REMOVED AND DISPOSED OF BY THE CONTRACTOR AND SHALL BE REPLACED AS DIRECTED BY THE ENGINEER. REPLACEMENT FRAMES AND LIDS WILL BE PAID FOR IN ACCORDANCE WITH ARTICLE 109.04 OF THE STANDARD SPECIFICATIONS UNLESS A SEPARATE PAY ITEM HAS BEEN PROVIDED.

IF THE EXISTING LIDS ARE OPEN, THE FRAME WILL BE ADJUSTED TO THE ELEVATION OF THE MILLED PAVEMENT SURFACE PRIOR TO THE MILLING OPERATION. THE FRAME WILL NOT BE REMOVED AND COVERED BY THE METAL PLATE.

CITY OF CHICAGO CASTINGS ARE THE PROPERTY OF THE CITY AND THE CONTRACTOR SHALL NOTIFY THE CITY FOR REMOVAL AND DISPOSITION OF THE CASTINGS.

THE METAL PLATE USED TO COVER THE STRUCTURE SHALL REMAIN THE PROPERTY OF THE CONTRACTOR.

WHEN STRUCTURES ARE TO BE ADJUSTED OR RECONSTRUCTED, THE LOWERING AND RAISING OF THE FRAMES AND LIDS WILL NOT BE PAID FOR SEPARATELY BUT WILL BE INCLUDED IN THE COST OF THE CORRESPONDING PAY ITEM.

LOCATION OF STRUCTURES:

THE CONTRACTOR WILL BE REQUIRED TO KEEP A RECORD OF THE LOCATIONS OF THE BURIED STRUCTURES ACCORDING TO THE STATION AND DISTANCE LEFT OR RIGHT OF THE CENTERLINE OF PAVEMENT. UPON COMPLETION OF THE WORK, THE CONTRACTOR WILL DELIVER THE RECORD TO THE ENGINEER.

BASIS OF PAYMENT: THIS WORK WILL BE PAID FOR AT THE CONTRACT UNIT PRICE PER EACH FOR "FRAMES AND LIDS TO BE ADJUSTED, SPECIAL" NEW FRAMES AND LIDS, WHEN SPECIFIED, WILL BE PAID FOR SEPARATELY.

DETAILS FOR FRAMES AND LIDS ADJUSTMENT WITH MILLING

ALL DIMENSIONS ARE IN INCHES (MILLIMETERS) UNLESS OTHERWISE SHOWN

FILE NAME = W:\disto\22x34\bid\8B.dgn	USER NAME = geglennobc	DESIGNED - R. SHAH	REVISED - R. SHAH 03-10-95	STATE OF ILLINOIS DEPARTMENT OF TRANSPORTATION	DETAILS FOR FRAMES AND LIDS ADJUSTMENT WITH MILLING	F.A.U. RTE.	SECTION	COUNTY	TOTAL SHEETS	SHEET NO.	
		DRAWN -	REVISED - A. ABBAS 03-21-97			SCALE: NONE		SHEET NO. 1 OF 1 SHEETS STA.		TO STA.	
		CHECKED - JR	REVISED - R. WIEDEMAN 05-14-04			BD600-03 (BD-8)		CONTRACT NO.			
		DATE - 10-25-94	REVISED - R. BORO 01-01-07			FED. ROAD DIST. NO. ILLINOIS FED. AID PROJECT					

FILE NAME = ...n\Inl2106_Dist1_Det01.dgn	USER NAME = epholy	DESIGNED - AJP	REVISED -	STATE OF ILLINOIS DEPARTMENT OF TRANSPORTATION	DETAILS FOR FRAMES AND LIDS ADJUSTMENT WITH MILLING	F.A.U. RTE.	SECTION	COUNTY	TOTAL SHEETS	SHEET NO.	
		DRAWN - IS	REVISED -			SCALE:		SHEET NO. OF SHEETS STA.		TO STA.	
		CHECKED - JR	REVISED -			3537		3264 RS-5		COOK 21 9	
		DATE - 4/21/2009	REVISED -			FED. ROAD DIST. NO. ILLINOIS FED. AID PROJECT					

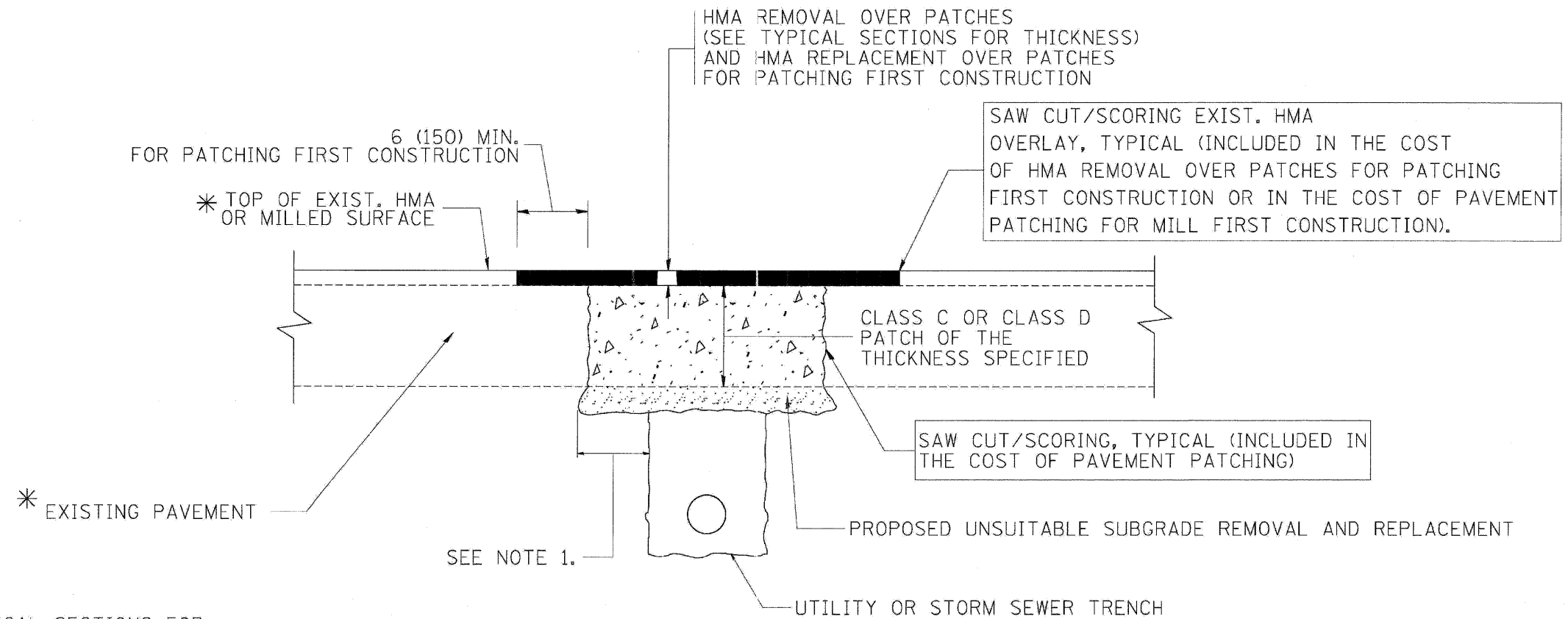

* SEE TYPICAL SECTIONS FOR THICKNESS AND MATERIALS

NOTES:

1. THE WIDTH OF THE FULL DEPTH PATCH OVER A TRENCH SHALL BE 12 (300) WIDER ON EACH SIDE OF THE TRENCH.
2. FOR METHOD OF MEASUREMENT AND BASIS OF PAYMENT, SEE RECURRING SPECIAL PROVISION "PATCHING WITH HOT-MIX ASPHALT OVERLAY REMOVAL".

SEQUENCE OF CONSTRUCTION (PATCHING FIRST)

1. REMOVE THE EXISTING HMA MATERIAL OVER THE AREA TO BE PATCHED.
2. REMOVE AND REPLACE WITH CLASS C OR D PATCH.
3. REPLACE HMA MATERIAL OVER THE AREA TO BE PATCHED.

SEQUENCE OF CONSTRUCTION (MILLING FIRST)

1. MILL HMA FIRST IF THERE IS AT LEAST 4 1/2 INCHES OR MORE OF HMA MATERIAL ON TOP OF THE EXISTING PAVEMENT OR IF THE PAVEMENT IS FULL DEPTH HMA. A MINIMUM OF 2 INCHES OF HMA MATERIAL SHALL BE IN PLACE AFTER MILLING.
2. REMOVE AND REPLACE WITH FULL DEPTH CLASS D PATCHES TO TOP OF MILLED SURFACE.

ALL DIMENSIONS ARE IN INCHES (MILLIMETERS) UNLESS OTHERWISE SHOWN.

FILE NAME = c:\proj\pav\dist\22x34\bd22.dgn	USER NAME = bauerdl	DESIGNED - R. SHAH	REVISED - A. ABBAS 04-27-98	STATE OF ILLINOIS DEPARTMENT OF TRANSPORTATION	PAVEMENT PATCHING FOR HMA SURFACED PAVEMENT		F.A.U. RTE.	SECTION	COUNTY	TOTAL SHEETS	SHEET NO.	
	PLOT SCALE = 58.000' / 1"	CHECKED -	REVISED - R. BORO 01-01-07		SCALE: NONE	SHEET NO. 1 OF 1 SHEETS	STA.	TO STA.	BD400-04 (BD-22)	CONTRACT NO.		
	PLOT DATE = 10/27/2008	DATE - 10-25-94	REVISED - R. BORO 09-04-07									
			REVISED - K. ENG 10-27-08									

FILE NAME = ...p\in\2106_Dist1_0et02.dgn	USER NAME = apthaly	DESIGNED - AJP	REVISED -	STATE OF ILLINOIS DEPARTMENT OF TRANSPORTATION	PAVEMENT PATCHING FOR HMA SURFACED PAVEMENT		F.A.U. RTE.	SECTION	COUNTY	TOTAL SHEETS	SHEET NO.	
	PLOT SCALE = N.T.S.	CHECKED - JR	REVISED -		SCALE:	SHEET NO. OF SHEETS	STA.	TO STA.	3537	3264 RS-5	COOK	21 10
	PLOT DATE = 4/21/2009	DATE - 4/21/2009	REVISED -									CONTRACT NO. 60A89
												FED. ROAD DIST. NO. ILLINOIS FED. AID PROJECT

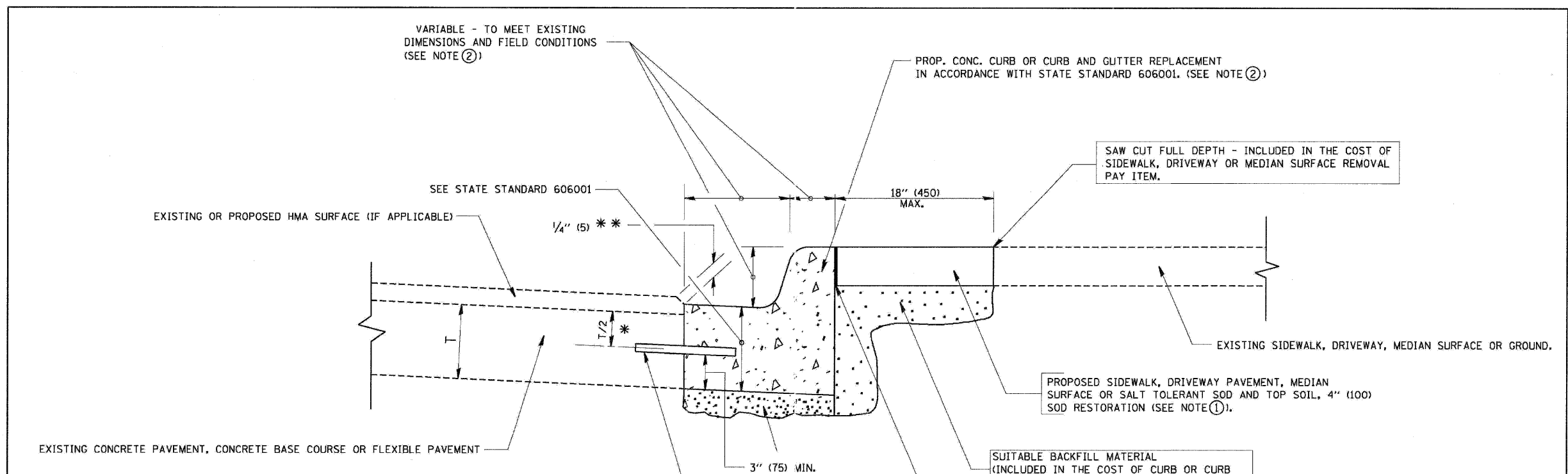

- * 3" (75) MINIMUM FROM TOP AND BOTTOM OF THE CONCRETE PAVEMENT OR BASE COURSE.
- * * IF THE FINAL SURFACE OF THE PAVEMENT IS CONCRETE, THE GUTTER IS TO BE FLUSH WITH THE PAVEMENT.

NOTE: ① SIDEWALK, DRIVEWAY PAVEMENT OR MEDIAN SURFACE SHALL BE SIMILAR TO THE MATERIAL BEING REMOVED AND WILL BE PAID FOR SEPARATELY.

SALT TOLERANT SOD AND TOP SOIL, 4" (100) RESTORATION WILL NOT BE PAID FOR SEPARATELY, BUT SHALL BE INCLUDED IN THE COST OF CURB OR CURB AND GUTTER REMOVAL AND REPLACEMENT.

- ② CURB OR CURB AND GUTTER REPLACEMENT SHALL MATCH THE SHAPE OF THE EXISTING CURB OR CURB AND GUTTER UNLESS OTHERWISE SPECIFIED.
- ③ FOR CURB OR CURB AND GUTTER REMOVAL AND REPLACEMENT ADJACENT TO FLEXIBLE PAVEMENT DELETE EPOXY COATED TIE BARS.
- ④ LONGITUDINAL BARS, IF ENCOUNTERED IN THE EXISTING CURB OR CURB AND GUTTER, ARE NOT TO BE REPLACED. CUTTING AND REMOVING LONGITUDINAL BARS SHALL BE INCLUDED IN THE COST OF CURB OR CURB AND GUTTER REMOVAL AND REPLACEMENT.
- ⑤ THE COST OF HMA SURFACE REMOVAL IN THE EXISTING GUTTER FLAG SHALL BE INCLUDED IN THE COST OF THE CURB AND GUTTER REMOVAL AND REPLACEMENT.
- ⑥ THE REMOVAL AND REPLACEMENT OF THE EXISTING CURB OR CURB AND GUTTER SHALL BE DONE IN ACCORDANCE WITH THE APPLICABLE PORTIONS OF SECTION 440 AND 606 OF THE STANDARD SPECIFICATIONS.
- ⑦ THE LOCATIONS OF REMOVAL AND REPLACEMENT OF EXISTING CURB OR CURB AND GUTTER SHALL BE DETERMINED BY THE RESIDENT ENGINEER AT THE TIME OF CONSTRUCTION.

UNSUITABLE SUB-BASE MATERIAL TO BE REMOVED, IF DIRECTED BY THE ENGINEER, SHALL BE REPLACED WITH EITHER SUB-BASE GRANULAR MATERIAL, TYPE B OR ADDITIONAL THICKNESS OF CONCRETE.

REMOVAL AND REPLACEMENT 4" (100) OR LESS IS INCLUDED IN THE COST OF CURB OR CURB AND GUTTER REMOVAL AND REPLACEMENT.

REMOVAL AND REPLACEMENT IN EXCESS OF 4" (100) WILL BE PAID FOR IN ACCORDANCE WITH ARTICLE 109.04 OF THE STANDARD SPECIFICATIONS.

PROPOSED #6 (20) EPOXY COATED TIE BARS 24" (600) LONG AT 24" (600) CENTERS WILL NOT BE PAID FOR SEPARATELY. DELETE EPOXY COATED TIE BARS IF EXISTING TIE BARS ARE USUABLE AS DETERMINED BY THE ENGINEER. (SEE NOTE ③).

BASIS OF PAYMENT:
THIS WORK WILL BE PAID FOR AT THE CONTRACT UNIT PRICE PER FOOT (METER) FOR "CURB REMOVAL AND REPLACEMENT" OR "COMBINATION CONCRETE CURB AND GUTTER REMOVAL AND REPLACEMENT".

CURB OR CURB AND GUTTER REMOVAL AND REPLACEMENT

ALL DIMENSIONS ARE IN INCHES (MILLIMETERS) UNLESS OTHERWISE SHOWN.

FILE NAME = W:\dist\22x34\bd24.dgn	USER NAME = gaglianob	DESIGNED - A. HOUSEH	REVISED - R. SHAH 10-03-96	STATE OF ILLINOIS DEPARTMENT OF TRANSPORTATION	CURB OR CURB AND GUTTER REMOVAL AND REPLACEMENT	F.A.U. RTE.	SECTION	COUNTY	TOTAL SHEETS	SHEET NO.
PLOT SCALE = 58,000 "/>										
PLOT DATE = 1/4/2009	CHECKED - JR	REVISOR - M. GOMEZ 01-22-01	REVISOR - R. BORO 01-01-07	SCALE: NONE SHEET NO. 1 OF 1 SHEETS STA. TO STA.		BD600-06 (BD-24) CONTRACT NO. FED. ROAD DIST. NO. ILLINOIS FED. AID PROJECT				

FILE NAME = ...p\ini\2106_Dist1_Det03.dgn	USER NAME = aphaly	DESIGNED - AJP	REVISED -	STATE OF ILLINOIS DEPARTMENT OF TRANSPORTATION	CURB OR CURB AND GUTTER REMOVAL AND REPLACEMENT	F.A.U. RTE.	SECTION	COUNTY	TOTAL SHEETS	SHEET NO.	
PLOT SCALE = N.T.S.	CHECKED - JR	REVISOR -	REVISOR -	SCALE: SHEET NO. OF SHEETS STA. TO STA.		3537 3264 RS-5 COOK 21 11 CONTRACT NO. 60A89 FED. ROAD DIST. NO. ILLINOIS FED. AID PROJECT					
PLOT DATE = 4/21/2009	DATE - 4/21/2009	REVISOR -	REVISOR -								CONTRACT NO. 60A89

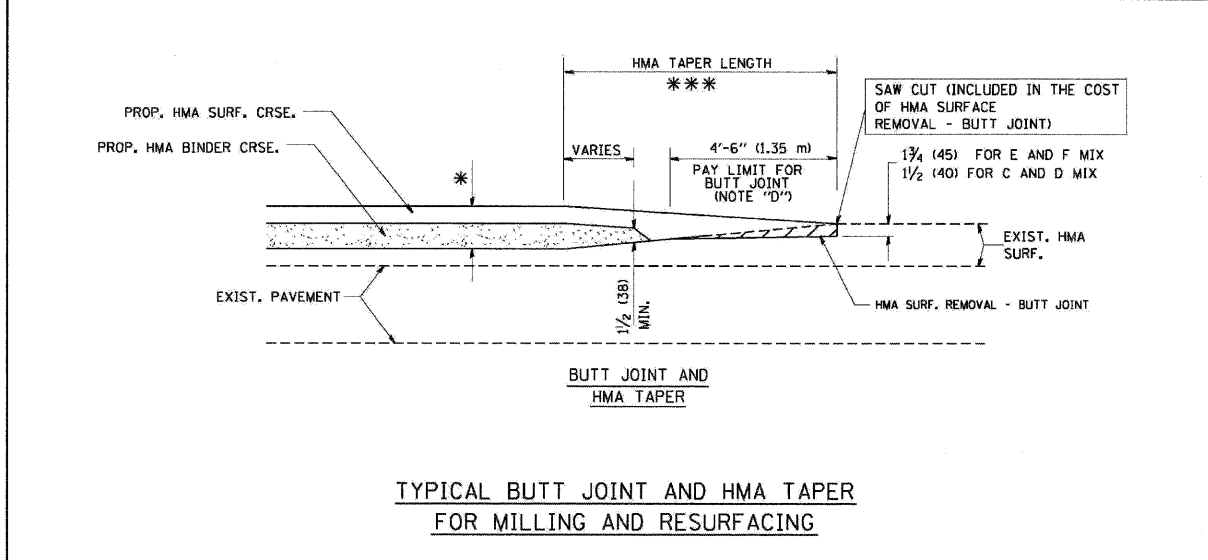
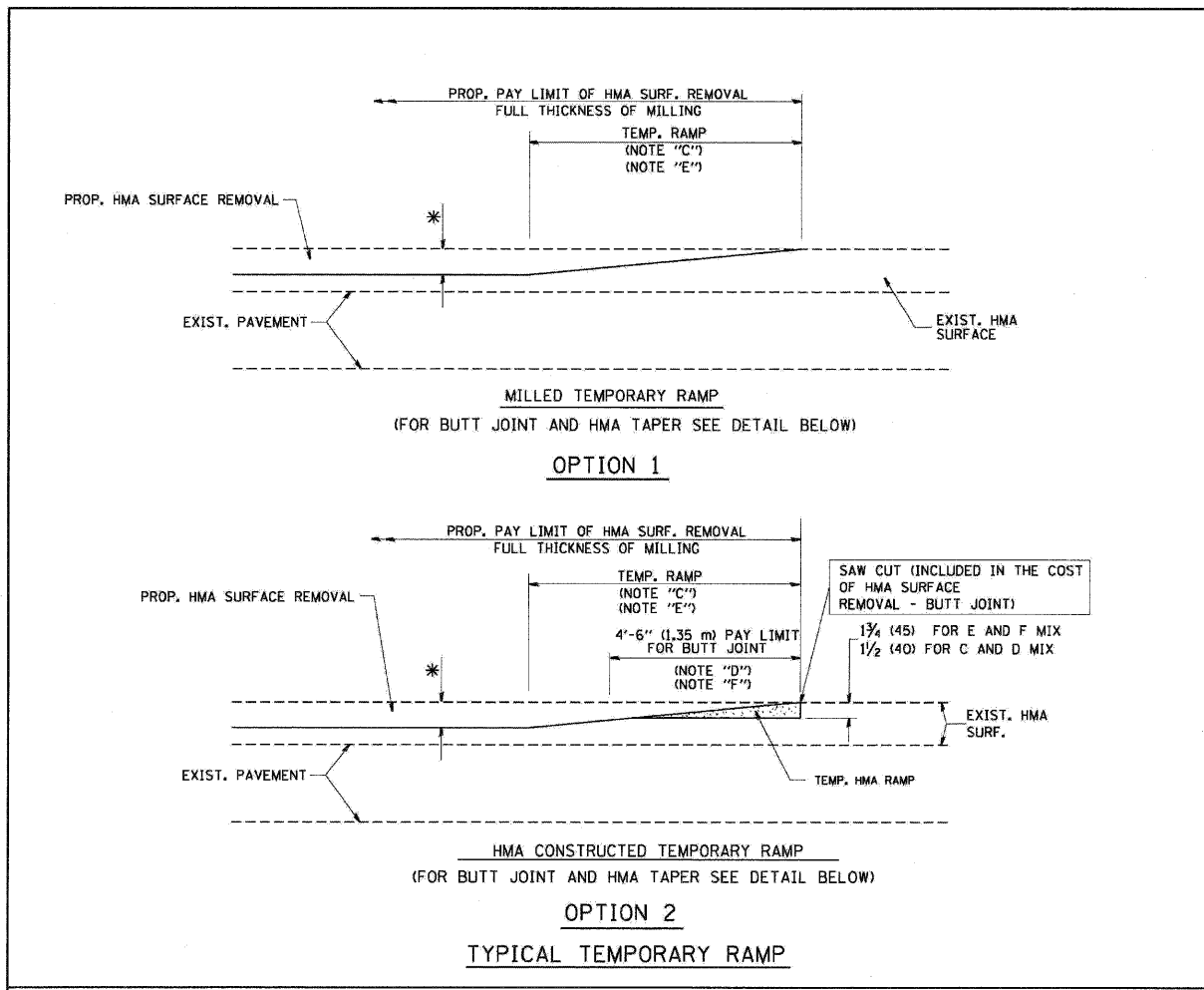

FILE NAME = W:\distand\22x34\bd32.dgn	USER NAME = qeqlanobis	DESIGNED - M. DE YONG	REVISED - R. SHAH 10-25-94
		DRAWN -	REVISED - A. ABBAS 03-21-97
PLOT SCALE = 5/8"=1'-0" IN.	CHECKED - JR	REVISION - M. GOMEZ 04-06-01	
PLOT DATE = 1/4/2008	DATE - 06-13-90	REVISION - R. BORO 01-01-07	

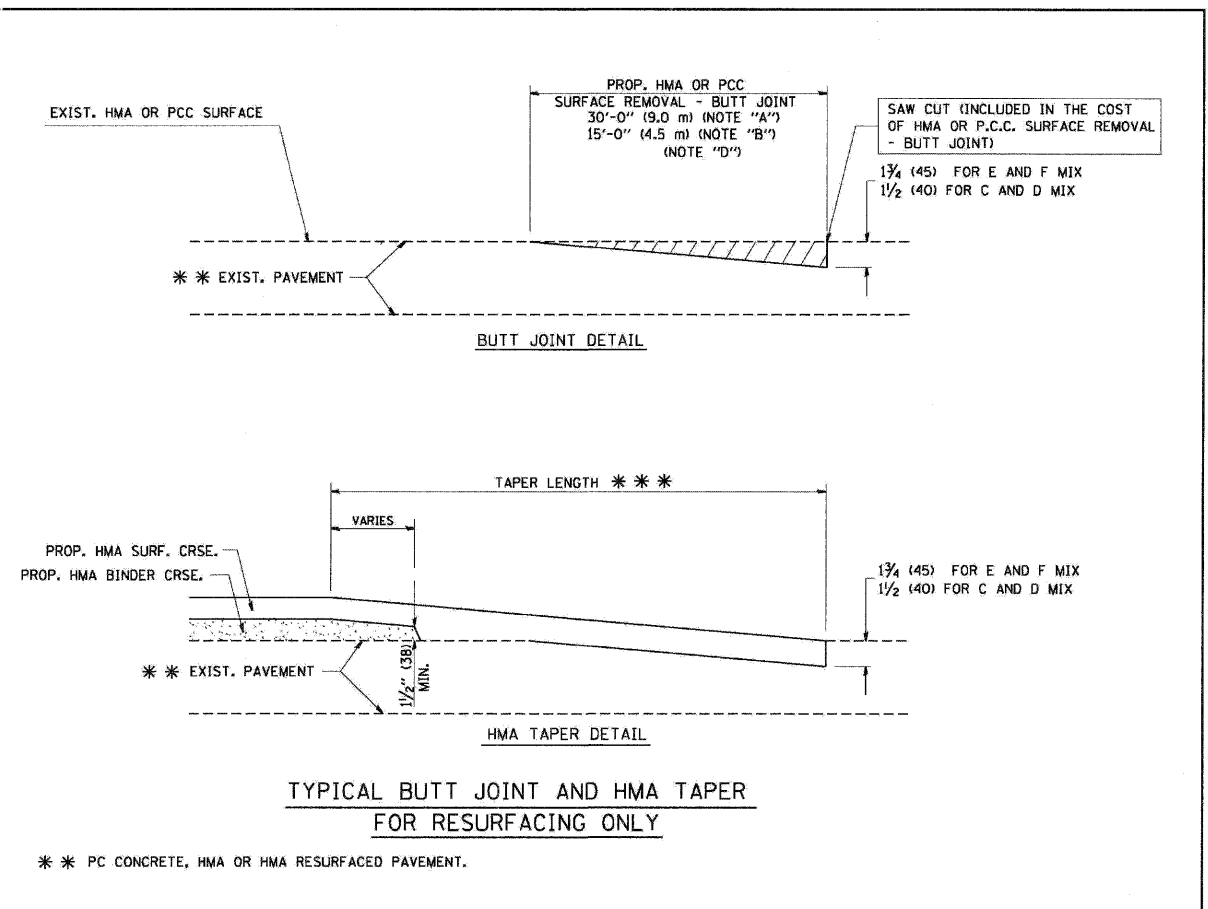

NOTES

A: MAINLINE ROADWAYS AND MAJOR SIDE ROADS.
 B: MINOR SIDE ROADS.
 C: THE TEMP. RAMP SHALL BE CONSTRUCTED IMMEDIATELY UPON REMOVAL OF THE EXISTING HMA SURFACE.
 D: THE BUTT JOINT SHALL BE CONSTRUCTED IMMEDIATELY PRIOR TO PLACING THE PROPOSED HMA COURSES.
 E: TAPER THE TEMP. RAMP AT A RATE OF 3'-0" (900 mm) PER 1 INCH (25 mm) OF MILLING THICKNESS.
 F: INSTALLATION AND REMOVAL OF THE 4'-6" (1.35 m) TEMP. RAMP IS INCLUDED IN COST OF HMA SURFACE REMOVAL - BUTT JOINT.
 G: SEE ARTICLE 406.08 AND 406.14 OF THE STANDARD SPECIFICATIONS FOR "HMA AND/OR PCC SURFACE REMOVAL, BUTT JOINT".
 * SEE TYPICAL SECTIONS FOR MILLING THICKNESS.
 *** 20'-0" (6.1 m) PER 1 (25) RESURFACING (NOTE "A")
 10'-0" (3.0 m) PER 1 (25) RESURFACING (NOTE "B")

BASIS OF PAYMENT:
 THE BUTT JOINT WILL BE PAID FOR AT THE CONTRACT UNIT PRICE PER SQUARE YARD (SQUARE METER) FOR "HOT-MIX ASPHALT SURFACE REMOVAL - BUTT JOINT" OR FOR "PORTLAND CEMENT CONCRETE SURFACE REMOVAL - BUTT JOINT".

ALL DIMENSIONS ARE IN INCHES (MILLIMETERS) UNLESS OTHERWISE SHOWN.

STATE OF ILLINOIS DEPARTMENT OF TRANSPORTATION		BUTT JOINT AND HMA TAPER DETAILS		F.A.U. RTE.	SECTION	COUNTY	TOTAL SHEETS	SHEET NO.
		SCALE: NONE		BD400-05 BD32		CONTRACT NO.		
		SHEET NO. 1 OF 1 SHEETS STA. TO STA.		FED. ROAD DIST. NO. 1 ILLINOIS FED. AID PROJECT				

FILE NAME = ...\p1n12106.Dist1.Det24.dgn	USER NAME = apihaly	DESIGNED - AJP	REVISED -
		DRAWN - IS	REVISED -
PLOT SCALE = N.T.S.	CHECKED - JR	REVISION -	
PLOT DATE = 4/21/2009	DATE - 4/21/2009	REVISION -	

STATE OF ILLINOIS DEPARTMENT OF TRANSPORTATION		BUTT JOINT AND HMA TAPER DETAILS		F.A.U. RTE.	SECTION	COUNTY	TOTAL SHEETS	SHEET NO.
		SCALE: SHEET NO. OF SHEETS STA. TO STA.		CONTRACT NO. 60A89				
				FED. ROAD DIST. NO. ILLINOIS FED. AID PROJECT				

F.A.U. RTE.	SECTION	COUNTY	TOTAL SHEETS	SHEET NO.
3537	3264 RS-5	COOK	21	12
FED. ROAD DIST. NO. ILLINOIS FED. AID PROJECT				

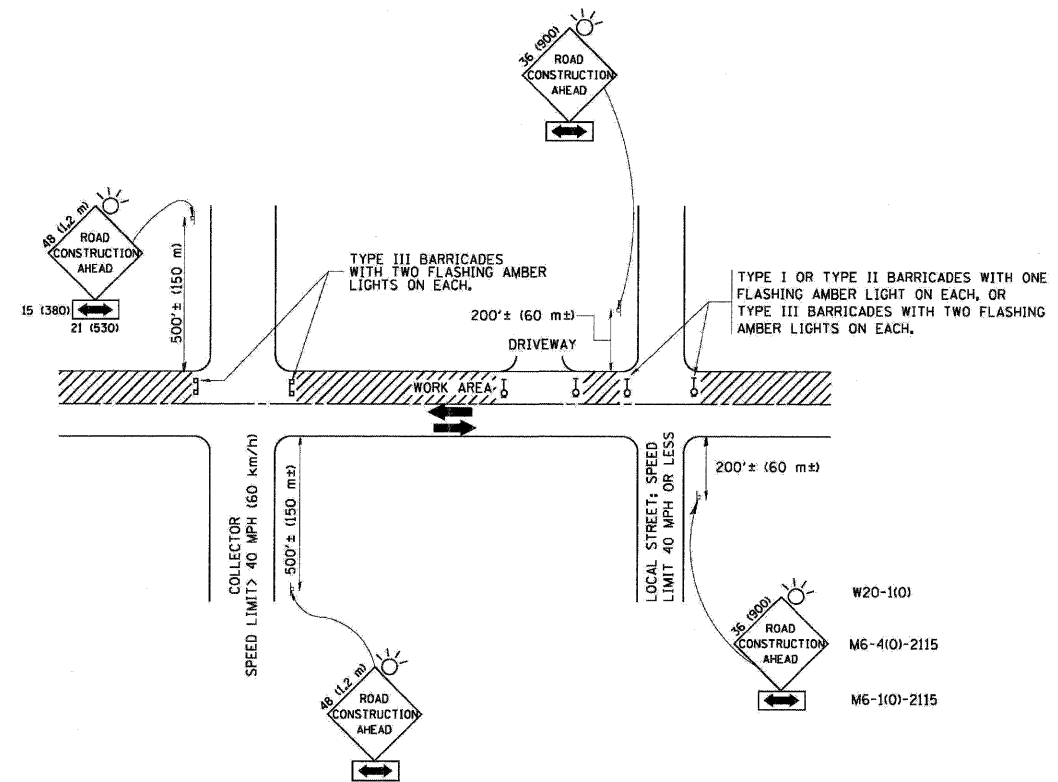

TRAFFIC CONTROL AND PROTECTION FOR SIDE ROADS, INTERSECTIONS, AND DRIVEWAYS

NOTES:

- A. FOR NO LANE RESTRICTION ON THE SIDE ROAD OR DRIVEWAYS:
 1. SIDE ROAD WITH A SPEED LIMIT OF 40 MPH (60 km/h) OR LESS AS SHOWN ON THE DRAWING AND AS DIRECTED BY THE ENGINEER:
 - a) ONE ROAD CONSTRUCTION AHEAD SIGN 36 x 36 (900x900) WITH A FLASHER AND FLAG MOUNTED ON IT APPROXIMATELY 200' (60 m) IN ADVANCE OF THE MAIN ROUTE.
 - b) THE CLOSED PORTION OF THE MAIN ROUTE SHALL BE PROTECTED BY BLOCKING WITH TYPE I, TYPE II OR TYPE III BARRICADES, 1/3 OF THE CROSS SECTION OF THE CLOSED PORTION.
 2. SIDE ROAD WITH A SPEED LIMIT GREATER THAN 40 MPH (60 km/h) AS SHOWN ON THE DRAWING AND AS DIRECTED BY THE ENGINEER:
 - a) ONE ROAD CONSTRUCTION AHEAD SIGN 48 x 48 (1.2 m x 1.2 m) WITH A FLASHER MOUNTED ON IT APPROXIMATELY 500' (150 m) IN ADVANCE OF THE MAIN ROUTE.
 - b) THE CLOSED PORTION OF THE MAIN ROUTE SHALL BE PROTECTED BY BLOCKING WITH TYPE III BARRICADES, 1/2 OF THE CROSS SECTION OF THE CLOSED PORTION.
 3. WHEN THE SIDE ROAD LIES BETWEEN THE BEGINNING OF THE MAINLINE SIGNING AND THE WORK ZONE, A SINGLE HEADED ARROW (M6-1) SHALL BE USED IN LIEU OF THE DOUBLE HEADED ARROW (M6-4).
- B. FOR A LANE CLOSURE ON A SIDE ROAD OR DRIVEWAY:

USE APPLICABLE PORTIONS OF THE TYPICAL APPLICATION OF TRAFFIC CONTROL DEVICES (STD. 701501, STD. 701606 OR THE APPROPRIATE STANDARD). THE SPACING OF SIGNS AND BARRICADES SHALL BE ADJUSTED FOR FIELD CONDITIONS AS DIRECTED BY THE ENGINEER. THE DIRECTIONAL ARROW SHALL BE COVERED OR REMOVED WHEN NO LONGER CONSISTENT WITH THE SIDE ROAD LANE CLOSURE.

 - C. ADVANCE WARNING SIGNS ARE TO BE OMITTED ON DRIVEWAY UNLESS OTHERWISE NOTED.
 - D. THE TRAFFIC CONTROL AND PROTECTION FOR SIDE ROADS, INTERSECTIONS, AND DRIVEWAYS SHALL BE INCIDENTAL TO THE COST OF SPECIFIED TRAFFIC CONTROL STANDARDS OR ITEMS.

All dimensions are in millimeters (inches) unless otherwise shown.

FILE NAME = W:\dist\td\22x34\td1.dgn	USER NAME = gaglianob	DESIGNED - LHA	REVISED - J. OBERLE 10-18-95
	PLOT SCALE = 58.888' / IN.	DRAWN -	REVISED - A. HOUSEH 03-06-96
	PLOT DATE = 1/4/2008	CHECKED - JR	REVISED - A. HOUSEH 10-15-96
		DATE - 06-89	REVISED - T. RAMMACHER 01-06-00

**STATE OF ILLINOIS
DEPARTMENT OF TRANSPORTATION**

**TRAFFIC CONTROL AND PROTECTION FOR
SIDE ROADS, INTERSECTIONS, AND DRIVEWAYS**

F.A. RTE.	SECTION	COUNTY	TOTAL SHEETS	SHEET NO.
TC-10			CONTRACT NO.	
FED. ROAD DIST. NO. 1 ILLINOIS FED. AID PROJECT				

SCALE: NONE SHEET NO. 1 OF 1 SHEETS STA. TO STA.

FILE NAME =
...pini2106.Dist1.Det06.dgn

USER NAME = epihely	DESIGNED - AJP	REVISED -
PLOT SCALE = N.T.S.	DRAWN - IS	REVISED -
PLOT DATE = 4/21/2009	CHECKED - JR	REVISED -
	DATE - 4/21/2009	REVISED -

**STATE OF ILLINOIS
DEPARTMENT OF TRANSPORTATION**

**TRAFFIC CONTROL AND PROTECTION FOR
SIDE ROADS, INTERSECTIONS, AND DRIVEWAYS**

F.A. RTE.	SECTION	COUNTY	TOTAL SHEETS	SHEET NO.
3537	3264 RS-5	COOK	21	14
CONTRACT NO. 60A89				
FED. ROAD DIST. NO. ILLINOIS FED. AID PROJECT				

SCALE: SHEET NO. OF SHEETS STA. TO STA.

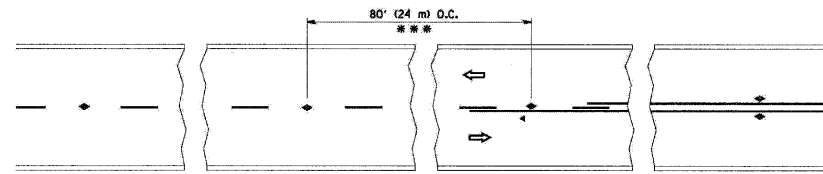

*** REDUCE TO 40' (12 m) O.C. ON CURVES WITH POSTED OR ADVISORY SPEED 45 M.P.H. (70 km/h) OR LESS.

TWO-LANE/TWO-WAY

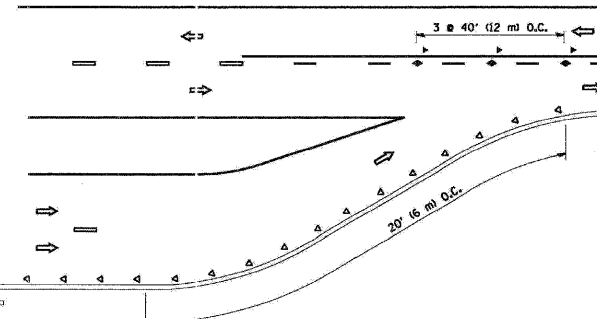

#4-2

LANE REDUCTION TRANSITION

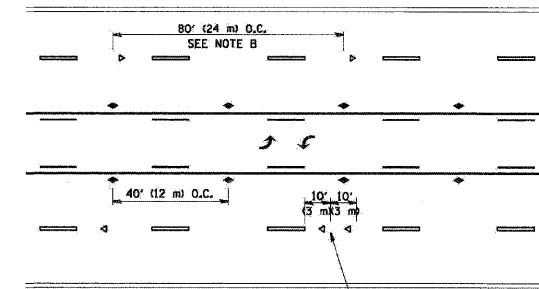

SEE NOTE A

TWO-WAY LEFT TURN

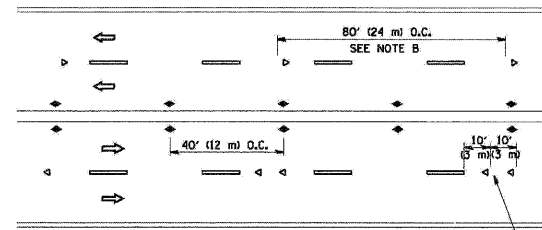

SEE NOTE A

MULTI-LANE/UNDIVIDED

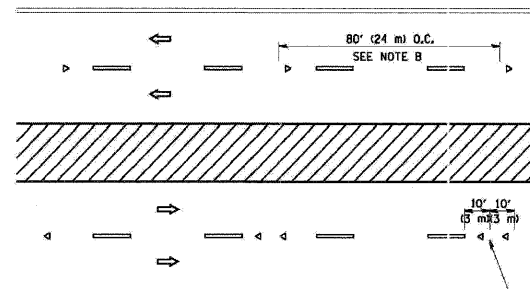

SEE NOTE A

MULTI-LANE/DIVIDED

GENERAL NOTES

1. MARKERS USED WITH DASHED LINES SHALL BE CENTERED IN THE GAP BETWEEN SEGMENTS.
2. MARKERS USED ADJACENT TO SOLID LINES SHALL BE OFFSET 2 TO 3 (50 TO 75) TOWARD TRAFFIC AS SHOWN.
3. MARKERS THROUGH TANGENTS LESS THAN 500' (150 m) IN LENGTH BETWEEN CURVES SHALL BE INSTALLED AT THE LESSER OF THE TWO CURVE SPACINGS.

SYMBOLS

- YELLOW STRIPE
- WHITE STRIPE
- ◄ ONE-WAY AMBER MARKER
- ◄ ONE-WAY CRYSTAL MARKER (W/O)
- ◆ TWO-WAY AMBER MARKER

LANE MARKER NOTES

- A. USE DOUBLE LANE LINE MARKERS SPACED AS SHOWN.
- B. REDUCE TO 40' (12 m) O.C. ON CURVES WHERE ADVISORY SPEEDS ARE 10 M.P.H. (20 km/h) LOWER THAN POSTED SPEEDS.

DESIGN NOTES

1. DOUBLE LANE LINE MARKERS SHALL BE USED UNLESS SPECIFIED OTHERWISE.
2. EXCEPT AS SHOWN ON THE LANE REDUCTION TRANSITION AND FREEWAY EXIT RAMP DETAIL, MARKERS ARE NOT TO BE SPECIFIED ON RIGHT EDGE LINES.
3. THE EXACT MARKER LIMITS, SPACING, AND COLOR SHOULD BE INCLUDED IN THE PLANS.
4. MARKERS SHOULD NOT BE USED ALONGSIDE CURBS EXCEPT FOR EXTREMELY SHORT SECTIONS OF CURBS WHERE NOT MORE THAN TWO MARKERS WOULD BE INVOLVED.

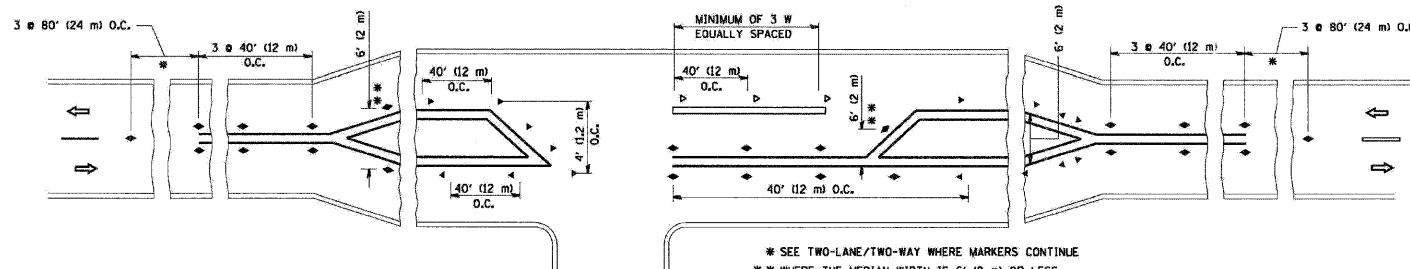

SEE TWO-LANE/TWO-WAY WHERE MARKERS CONTINUE
 ** WHERE THE MEDIAN WIDTH IS 6' (2 m) OR LESS USE TWO-WAY MARKERS.

LEFT TURN

All dimensions are in inches (millimeters) unless otherwise shown.

FILE NAME = W:\state\226\34\to1\dgn	USER NAME = geglianob	DESIGNED - -	REVISED - - T. RAMMACHER 09-19-94
	PLOT SCALE = 50:000 1/4 IN.	DRAWN - -	REVISED - - T. RAMMACHER 03-12-99
	PLOT DATE = 1/4/2008	CHECKED - JR	REVISED - - T. RAMMACHER 01-06-00
		DATE - -	REVISED - -

STATE OF ILLINOIS
DEPARTMENT OF TRANSPORTATION

TYPICAL APPLICATIONS		F.A.U. RTE.	SECTION	COUNTY	TOTAL SHEETS	SHEET NO.
RAISED REFLECTIVE PAVEMENT MARKERS (SNOW-PLOW RESISTANT)						
SCALE: NONE	SHEET NO. 1 OF 1 SHEETS	STA.	TO STA.	CONTRACT NO.		
		FED. ROAD DIST. NO. 1 ILLINOIS FED. AID PROJECT				

FILE NAME = ...xp\12106.Dist1.Det07.dgn	USER NAME = opholj	DESIGNED - AJP	REVISED - -
	PLOT SCALE = N.T.S.	DRAWN - IS	REVISED - -
	PLOT DATE = 4/21/2009	CHECKED - JR	REVISED - -
		DATE - 4/21/2009	REVISED - -

STATE OF ILLINOIS
DEPARTMENT OF TRANSPORTATION

TYPICAL APPLICATIONS		F.A.U. RTE.	SECTION	COUNTY	TOTAL SHEETS	SHEET NO.
RAISED REFLECTIVE PAVEMENT MARKERS (SNOW-PLOW RESISTANT)						
SCALE:	SHEET NO. OF SHEETS	STA.	TO STA.	CONTRACT NO. 60A89		
		FED. ROAD DIST. NO. ILLINOIS FED. AID PROJECT				

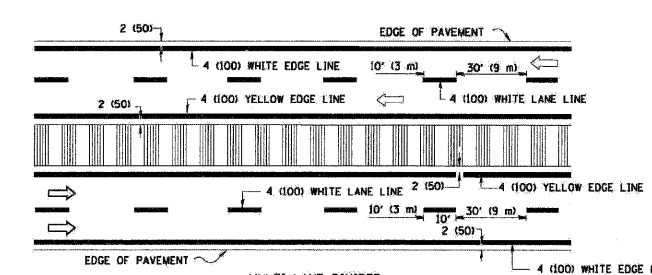
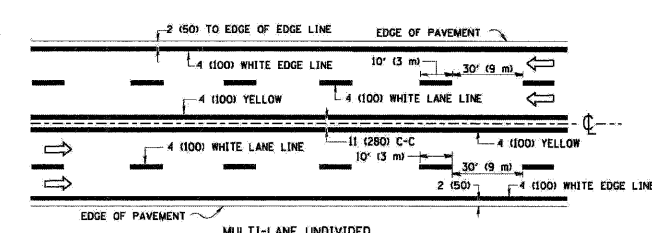
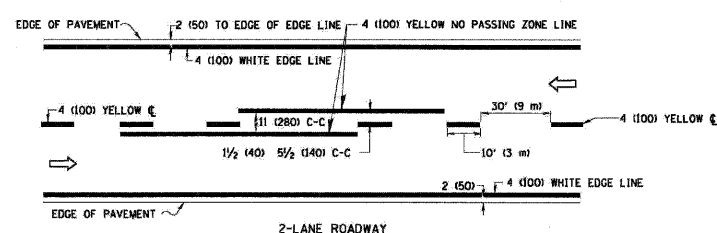

NOTE: MEDIANS WITH BARRIER CURB DO NOT REQUIRE AN EDGE LINE

TYPICAL LANE AND EDGE LINE MARKING

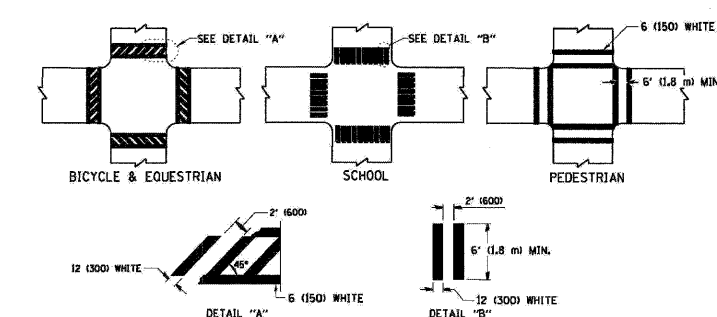

TYPICAL CROSSWALK MARKING

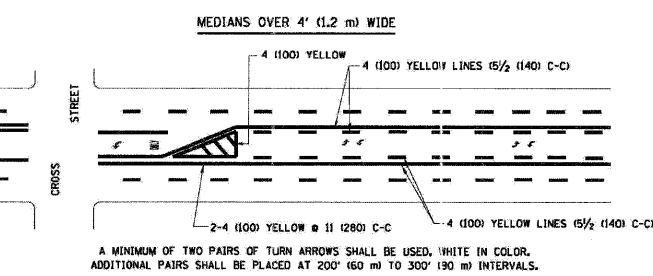
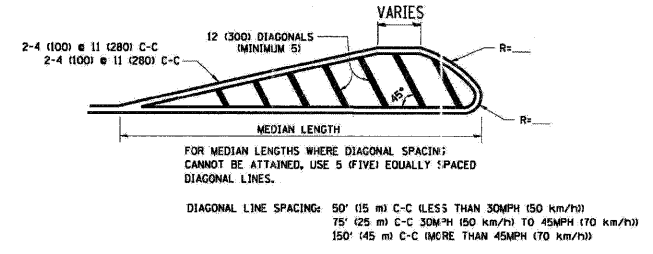
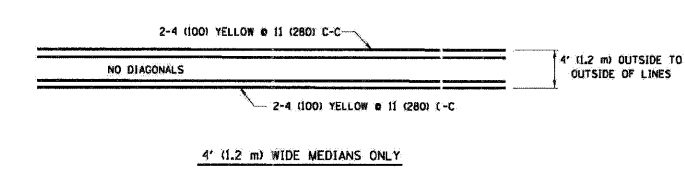

TYPICAL PAINTED MEDIAN MARKING

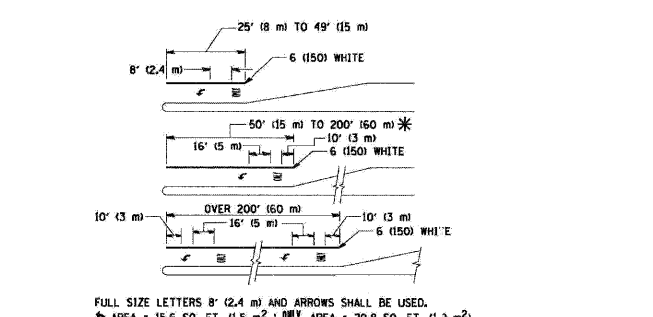

TYPICAL LEFT (OR RIGHT) TURN LANE MARKING

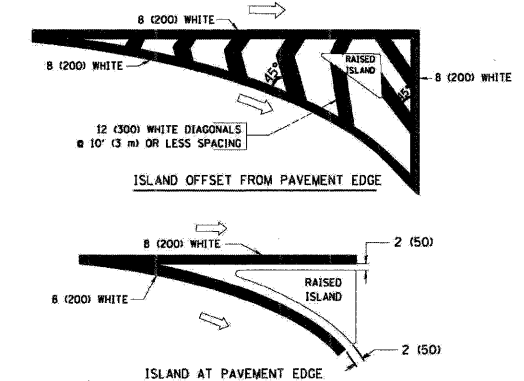

TYPICAL ISLAND MARKING

TYPE OF MARKING	WIDTH OF LINE	PATTERN	COLOR	SPACING / REMARKS
CENTERLINE ON 2 LANE PAVEMENT	4 (100)	SKIP-DASH	YELLOW	10' (3 m) LINE WITH 30' (9 m) SPACE
CENTERLINE ON MULTI-LANE UNDIVIDED PAVEMENT	2 @ 4 (100)	SOLID	YELLOW	11 (280) C-C
NO PASSING ZONE LINES FOR ONE DIRECTION FOR BOTH DIRECTIONS	4 (100) 2 @ 4 (100)	SOLID SOLID	YELLOW YELLOW	5/2 (140) C-C FROM SKIP-DASH CENTERLINE 11 (280) C-C OMIT SKIP-DASH CENTERLINE BETWEEN
LANE LINES	4 (100) 5 (125) ON FREEWAYS	SKIP-DASH SKIP-DASH	WHITE WHITE	10' (3 m) LINE WITH 30' (9 m) SPACE
DOTTED LINES (EXTENSIONS OF CENTER, LANE OR TURN LANE MARKINGS)	SAME AS LINE BEING EXTENDED	SKIP-DASH	SAME AS LINE BEING EXTENDED	2' (600) LINE WITH 6' (1.8 m) SPACE
EDGE LINES	4 (100)	SOLID	YELLOW-LEFT WHITE-RIGHT	OUTLINE MOUNTABLE MEDIANS IN YELLOW. EDGE LINES ARE NOT USED NEXT TO BARRIER CURB
TURN LANE MARKINGS	6 (150) LINE, FULL SIZE LETTERS & SYMBOLS 8' (2.4m)	SOLID	WHITE	SEE TYPICAL TURN LANE MARKING DETAIL
TWO WAY LEFT TURN MARKING	2 @ 4 (100) EACH DIRECTION 8' (2.4m) LEFT ARROW	SKIP-DASH AND SOLID IN PAIRS	YELLOW WHITE	10' (3 m) LINE WITH 30' (9 m) SPACE FOR SKIP-DASH, 5/2 (140) C-C BETWEEN SOLID LINE AND SKIP-DASH LINE SEE TYPICAL TWO-WAY LEFT TURN MARKING DETAIL
CROSSWALK LINES (PEDESTRIAN, BICYCLE, EQUESTRIAN) A. DIAGONALS (BIKE & EQUESTRIAN) B. LONGITUDINAL BARS (SCHOOL)	2 @ 6 (150) 12 (300) @ 45° 12 (300) @ 90°	SOLID SOLID SOLID	WHITE WHITE WHITE	NOT LESS THAN 6' (1.8 m) APART 2' (600) APART 2' (600) APART SEE TYPICAL CROSSWALK MARKING DETAILS.
STOP LINES	24 (600)	SOLID	WHITE	PLACE 4' (1.2 m) IN ADVANCE OF AND PARALLEL TO CROSSWALK, IF PRESENT. OTHERWISE, PLACE AT DESIRED STOPPING POINT, PARALLEL TO CROSSROAD CENTERLINE, WHERE POSSIBLE
PAINTED MEDIANS	2 @ 4 (100) WITH 12 (300) DIAGONALS @ 45° NO DIAGONALS USED FOR 4' (1.2 m) WIDE MEDIANS	SOLID	YELLOW TWO WAY TRAFFIC WHITE ONE WAY TRAFFIC	11 (280) C-C FOR THE DOUBLE LINE SEE TYPICAL PAINTED MEDIAN MARKING.
GORE MARKING AND CHANNELIZING LINES	8 (200) WITH 12 (300) DIAGONALS @ 45°	SOLID	WHITE	DIAGONALS: 15' (4.5 m) C-C (LESS THAN 30MPH (50 km/h)) 20' (6 m) C-C (30MPH (50 km/h) TO 45MPH (70 km/h)) 30' (9 m) C-C (OVER 45MPH (70 km/h))
RAILROAD CROSSING	24 (600) TRANSVERSE LINES: "RR" IS 6' (1.8 m) LETTERS: 16 (400) LINE FOR "X"	SOLID	WHITE	SEE STATE STANDARD 780001 AREA OF: "R"=3.0 SQ. FT. (0.33 m²) EACH "X"=54.0 SQ. FT. (5.0 m²)
SHOULDER DIAGONALS	12 (300) @ 45°	SOLID	WHITE - RIGHT YELLOW - LEFT	50' (15 m) C-C (LESS THAN 30MPH (50 km/h)) 75' (22.5 m) C-C (30 MPH (50 km/h) TO 45MPH (70 km/h)) 150' (45 m) C-C (OVER 45MPH (70 km/h))

FOR FURTHER DETAILS ON PAVEMENT MARKING REFER TO STANDARD SPECIFICATIONS FOR ROAD AND BRIDGE CONSTRUCTION AND STATE STANDARD 780001.

All dimensions are in inches (millimeters) unless otherwise shown.

FILE NAME = W:\dists\222\34\1\13.dgn	USER NAME = goglianobt	DESIGNED - EVERS	REVISED - T. RAMMACHER 10-27-94
		DRAWN -	REVISED - A. HOUSEH 10-09-96
	PLOT SCALE = 50.000 1/ IN.	CHECKED -	REVISED - A. HOUSEH 10-17-96
	PLOT DATE = 1/4/2008	DATE - 03-19-90	REVISED - T. RAMMACHER 01-06-00

STATE OF ILLINOIS
DEPARTMENT OF TRANSPORTATION

DISTRICT ONE
TYPICAL PAVEMENT MARKINGS

F.A.U. RTE.	SECTION	COUNTY	TOTAL SHEETS	SHEET NO.
TC-13			CONTRACT NO.	
FED. ROAD DIST. NO. 1 ILLINOIS FED. AID PROJECT				

FILE NAME = ...\p1\12106.Dist1.Dat28.dgn	USER NAME = apshaly	DESIGNED - AJP	REVISED -
		DRAWN - IS	REVISED -
	PLOT SCALE = N.T.S.	CHECKED - JR	REVISED -
	PLOT DATE = 4/21/2009	DATE - 4/21/2009	REVISED -

STATE OF ILLINOIS
DEPARTMENT OF TRANSPORTATION

DISTRICT ONE
TYPICAL PAVEMENT MARKINGS

F.A.U. RTE.	SECTION	COUNTY	TOTAL SHEETS	SHEET NO.
3537	3264 RS-5	COOK	21	16
TC-13			CONTRACT NO. 60A89	
FED. ROAD DIST. NO. ILLINOIS FED. AID PROJECT				

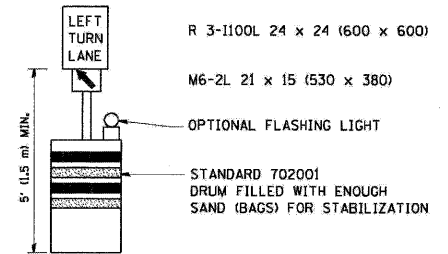
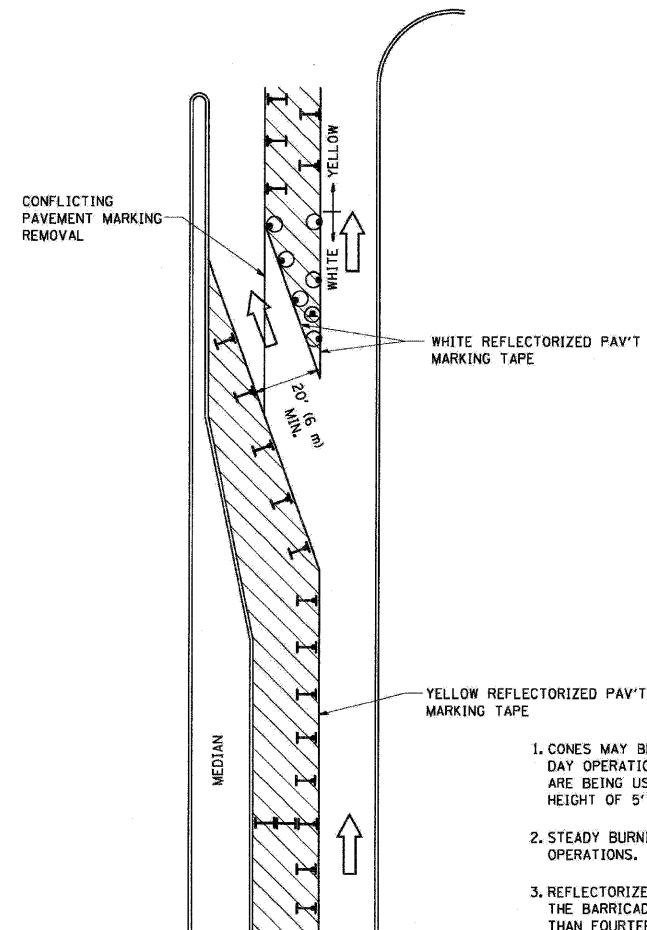

GENERAL NOTES

1. CONES MAY BE SUBSTITUTED FOR BARRICADES OR DRUMS AT HALF THE SPACING DURING DAY OPERATIONS. CONES SHALL BE A MINIMUM OF 28 (710) IN HEIGHT. WHEN CONES ARE BEING USED, THE "LEFT TURN LANE" SIGN MAY BE SKID MOUNTED AT A MINIMUM HEIGHT OF 5' (1.5 m).
2. STEADY BURNING LIGHTS WILL NOT BE REQUIRED ON BARRICADES OR DRUMS FOR DAY OPERATIONS. ALL LIGHTS SHALL BE MONODIRECTIONAL.
3. REFLECTORIZED TEMPORARY PAVEMENT MARKING TAPE SHALL BE PLACED THROUGHOUT THE BARRICADED AREA OF EACH TURN BAY WHERE THE CLOSURE TIME IS GREATER THAN FOURTEEN DAYS.
4. THIS APPLICATION ALSO APPLIES WHEN WORK IS BEING PERFORMED IN THE RIGHT LANE(S) AND THE RIGHT TURN BAY IS TO REMAIN OPEN. UNDER THIS CONDITION, "RIGHT TURN LANE" R3-100 24 x 24 (600 x 600) AND M6-2R 21 x 15 (530 x 380) SHALL BE USED.
5. THESE CONTROLS SHALL SUPPLEMENT MAINLINE TRAFFIC CONTROL FOR LANE CLOSURES.
6. LONGITUDINAL DIMENSIONS MAY BE ADJUSTED TO FIT FIELD CONDITIONS.
7. FORM BT 725 IS REQUIRED.
8. TRAFFIC CONTROL AND PROTECTION AT TURN BAYS (TO REMAIN OPEN TO TRAFFIC) SHALL BE INCLUDED IN THE COST SPECIFIED TRAFFIC CONTROL STANDARDS OR ITEMS.

All dimensions are in inches (millimeters) unless otherwise shown.

LEGEND

- WORK AREA
- LANE OPEN TO TRAFFIC
- TYPE I OR II BARRICADE WITH STEADY BURN LIGHT
- DRUM WITH STEADY BURN LIGHT
- DRUM WITH SIGN (WITH OPTIONAL FLASHING LIGHT) SEE DETAIL
- TYPE I OR II CHECK BARRICADE WITH FLASHING LIGHT

FILE NAME =	USER NAME =	DESIGNED -	REVISED -
W:\data\22x34\14.dgn	gegliarob	-	T. RAMMACHER 09-08-94
		DRAWN -	REVISED -
		-	A. HOUSEH 11-07-95
		CHECKED -	REVISED -
		-	A. HOUSEH 10-12-96
		DATE -	REVISED -
		-	T. RAMMACHER 01-06-00

**STATE OF ILLINOIS
DEPARTMENT OF TRANSPORTATION**

**TRAFFIC CONTROL AND PROTECTION AT TURN BAYS
(TO REMAIN OPEN TO TRAFFIC)**

F.A.U. RTE.	SECTION	COUNTY	TOTAL SHEETS	SHEET NO.
TC-14		CONTRACT NO.		
FED. ROAD DIST. NO. 1 ILLINOIS FED. AID PROJECT				

SCALE: NONE SHEET NO. 1 OF 1 SHEETS STA. TO STA.

FILE NAME =	USER NAME =	DESIGNED -	REVISED -
...p\12105_01st1_01.dgn	apshaly	-	AJP
		DRAWN -	REVISED -
		-	IS
		CHECKED -	REVISED -
		-	JR
		DATE -	REVISED -
		-	4/21/2009

**STATE OF ILLINOIS
DEPARTMENT OF TRANSPORTATION**

**TRAFFIC CONTROL AND PROTECTION AT TURN BAYS
(TO REMAIN OPEN TO TRAFFIC)**

F.A.U. RTE.	SECTION	COUNTY	TOTAL SHEETS	SHEET NO.
3537	3264 RS-5	COOK	21	17
		CONTRACT NO. 60A89		
FED. ROAD DIST. NO. ILLINOIS FED. AID PROJECT				

SCALE: SHEET NO. OF SHEETS STA. TO STA.

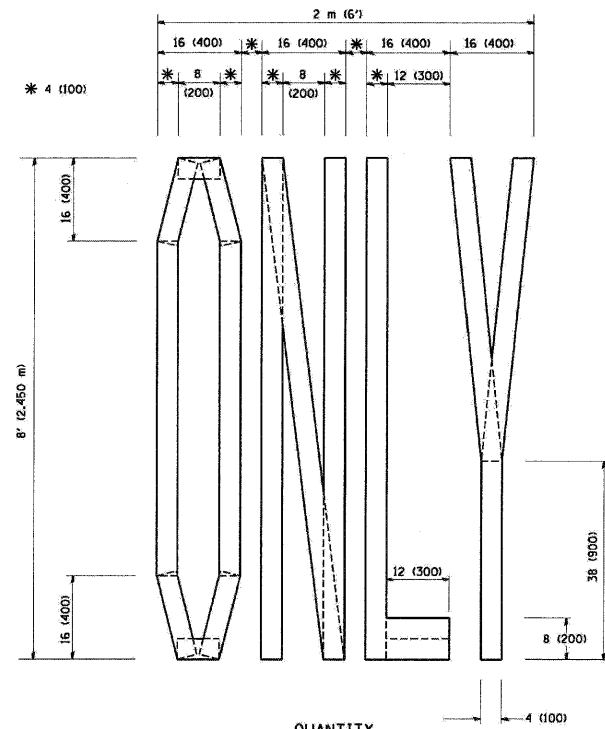

QUANTITY
 4 (100) LINE = 64.1 ft. (19.7 m)
 21.1 sq. ft. (1.97 sq. m)

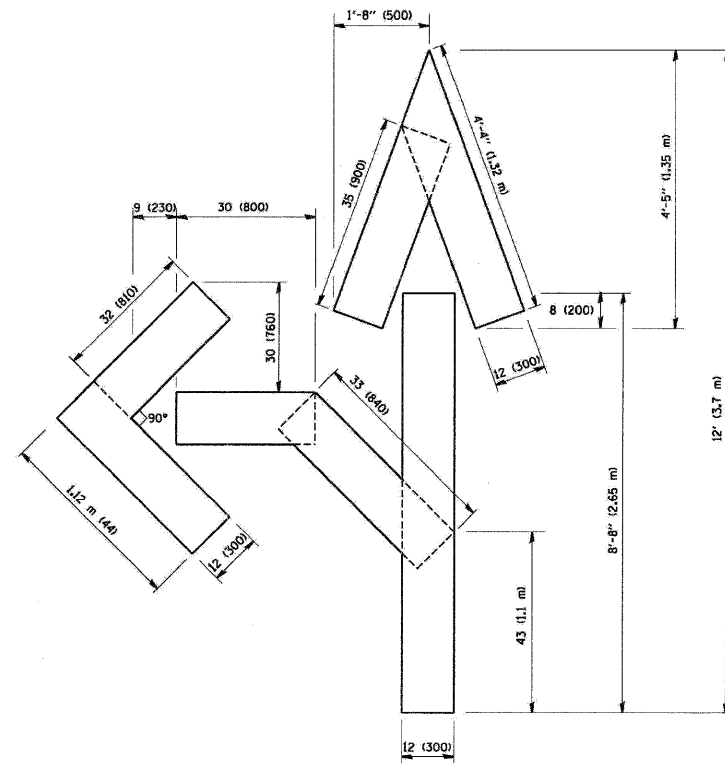

QUANTITY
 4 (100) LINE = 82.5 ft. (25.3 m)
 27.5 sq. ft. (2.53 sq. m)

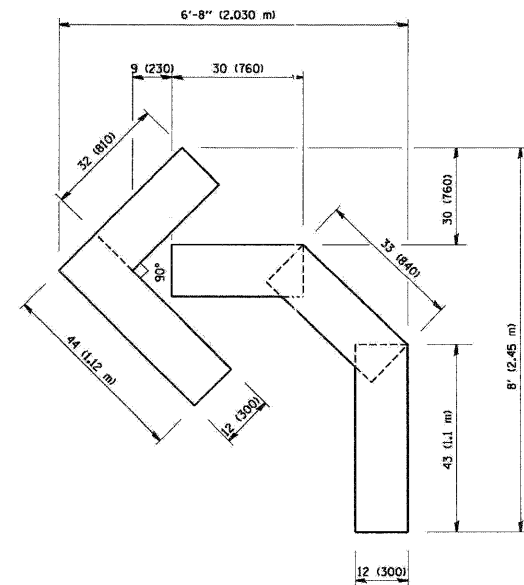

QUANTITY
 4 (100) LINE = 45.5 ft. (13.9 m)
 15.2 sq. ft. (1.39 sq. m)

All dimensions are in inches (millimeters) unless otherwise shown.

FILE NAME = W:\disto\22x34\16.dgn	USER NAME = gaglianob	DESIGNED - -	REVISED - -T. RAMMACHER 06-05-96
		DRAWN - -	REVISED - -T. RAMMACHER 11-04-97
PLOT SCALE = 50,0000' / IN.	CHECKED - -	DATE - 09-18-94	REVISED - -T. RAMMACHER 03-02-98
PLOT DATE = 1/4/2008			REVISED - -E. GOMEZ 08-28-00

**STATE OF ILLINOIS
 DEPARTMENT OF TRANSPORTATION**

**PAVEMENT MARKING LETTERS AND SYMBOLS
 FOR TRAFFIC STAGING**

SCALE: NONE	SHEET NO. 1	OF 1	SHEETS	STA.	TO STA.	F.A.U. RTE.	SECTION	COUNTY	TOTAL SHEETS	SHEET NO.
						TC-16				
						CONTRACT NO.				
						FED. ROAD DIST. NO. 1 ILLINOIS FED. AID PROJECT				

FILE NAME = ...p\12105_Dist1.Det10.dgn	USER NAME = apihely	DESIGNED - AJP	REVISED - -
		DRAWN - IS	REVISED - -
PLOT SCALE = N.T.S.	CHECKED - JR	DATE - 4/21/2009	REVISED - -
PLOT DATE = 4/21/2009			

**STATE OF ILLINOIS
 DEPARTMENT OF TRANSPORTATION**

**PAVEMENT MARKING LETTERS AND SYMBOLS
 FOR TRAFFIC STAGING**

SCALE:	SHEET NO.	OF	SHEETS	STA.	TO STA.	F.A.U. RTE.	SECTION	COUNTY	TOTAL SHEETS	SHEET NO.
						3537	3264 RS-5	COOK	21	18
						CONTRACT NO. 60A89				
						FED. ROAD DIST. NO. ILLINOIS FED. AID PROJECT				

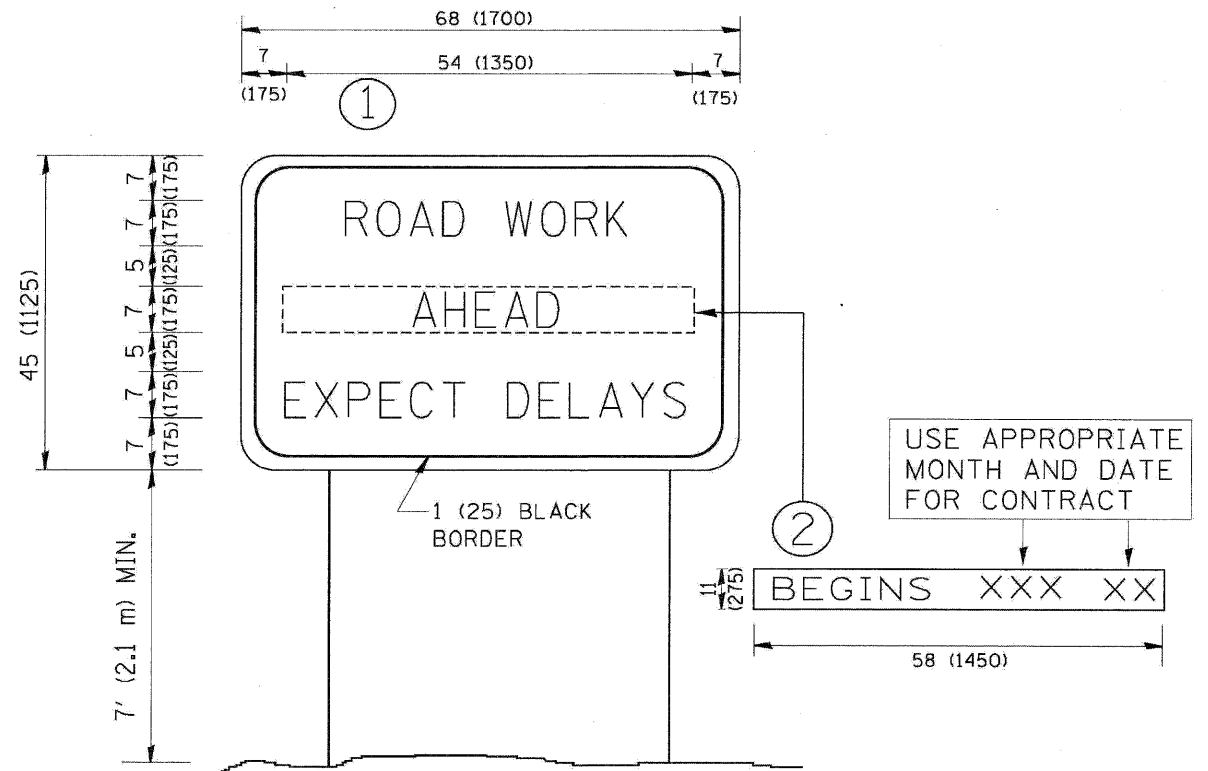

NOTES:

1. USE BLACK LETTERING ON ORANGE BACKGROUND.
2. ERECT SIGNS IN ADVANCE OF THE LOCATION FOR THE "ROAD CONSTRUCTION AHEAD" SIGN AT LOCATIONS AS DIRECTED BY THE ENGINEER.
3. ERECT SIGN ① WITH INSTALLED PANEL ② ONE WEEK PRIOR TO THE START OF CONSTRUCTION.
4. REMOVE PANEL ② SOON AFTER THE START OF CONSTRUCTION.
5. SEE SPECIAL PROVISION FOR "TEMPORARY INFORMATION SIGNING" FOR ADDITIONAL INFORMATION.
6. ONE SIGN ASSEMBLY EQUALS 25.70 SQ. FT. (2.3 SQ. M.)
7. SHALL BE PAID FOR AS TEMPORARY INFORMATION SIGNING.

ALL DIMENSIONS ARE IN INCHES (MILLIMETERS) UNLESS OTHERWISE SHOWN.

FILE NAME = W:\dist\td\22v34\to22.dgn	USER NAME = gng\emobt	DESIGNED -	REVISED - R. MIRS 09-15-97
		DRAWN -	REVISED - R. MIRS 12-11-97
	PLOT SCALE = 50.000" / IN.	CHECKED -	REVISED - T. RAMMACHER 02-02-99
	PLOT DATE = 1/4/2008	DATE -	REVISED - C. JUCIUS 01-31-07

STATE OF ILLINOIS
DEPARTMENT OF TRANSPORTATION

ARTERIAL ROAD
INFORMATION SIGN

F.A. RTE.	SECTION	COUNTY	TOTAL SHEETS	SHEET NO.
TC-22		CONTRACT NO.		
FED. ROAD DIST. NO. ILLINOIS FED. AID PROJECT				

SCALE: NONE SHEET NO. 1 OF 1 SHEETS STA. TO STA.

FILE NAME = ...N\p12106_0vst1.Det11.dgn	USER NAME = ap1holj	DESIGNED - AJP	REVISED -
		DRAWN - IS	REVISED -
	PLOT SCALE = N.T.S.	CHECKED - JR	REVISED -
	PLOT DATE = 4/21/2009	DATE - 4/21/2009	REVISED -

STATE OF ILLINOIS
DEPARTMENT OF TRANSPORTATION

ARTERIAL ROAD
INFORMATION SIGN

F.A. RTE.	SECTION	COUNTY	TOTAL SHEETS	SHEET NO.
3537	3264 RS-5	COOK	21	19
CONTRACT NO. 60A89				
FED. ROAD DIST. NO. ILLINOIS FED. AID PROJECT				

SCALE: SHEET NO. OF SHEETS STA. TO STA.

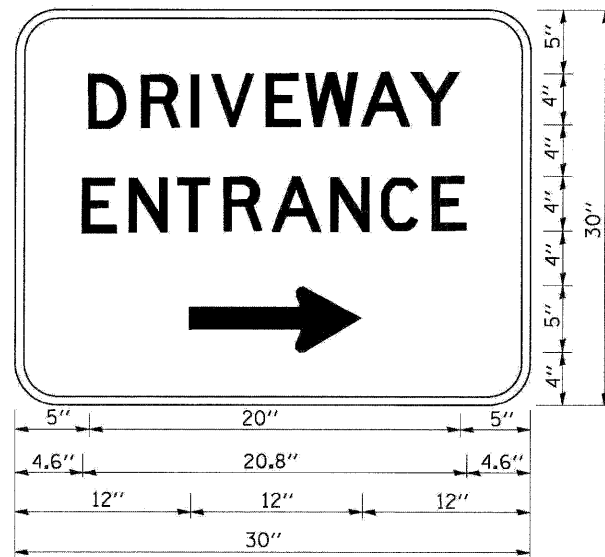

3.0" RADIUS, 0.5" BORDER, WHITE ON GREEN; REFLECTORIZED
 "DRIVEWAY" D; "ENTRANCE" D; STANDARD ARROW CUSTOM 12.0" x 5.0"

NOTES:

1. HALF OF THE SIGNS WILL REQUIRE A LEFT HAND FACING ARROW.
2. TWO SIGNS SHALL BE USED AT EACH COMMERCIAL ENTRANCE PLACED BACK-TO-BACK; ONE WITH A RIGHT HAND ARROW (SHOWN) SHALL BE PLACED ON THE NEAR RIGHT SIDE THE DRIVEWAY AND ONE WITH A LEFT HAND ARROW SHALL BE PLACED ON THE FAR LEFT SIDE OF THE DRIVEWAY.
3. SIGNS TO BE PAID FOR AS ITEM "TEMPORARY INFORMATION SIGNING".

FILE NAME = W:\distatd\22x34\to26.dgn	USER NAME = geglanoob	DESIGNED - DRAWN -	REVISOR - C. JUCIUS 02-15-07
	PLOT SCALE = 50.000 ' / IN.	CHECKED -	REVISOR -
	PLOT DATE = 1/4/2008	DATE -	REVISOR -

**STATE OF ILLINOIS
 DEPARTMENT OF TRANSPORTATION**

DRIVEWAY ENTRANCE SIGNING

F.A. RTE.	SECTION	COUNTY	TOTAL SHEETS	SHEET NO.
	TC-26			
FED. ROAD DIST. NO. 1 ILLINOIS			FED. AID PROJECT	

SCALE: NONE SHEET NO. 1 OF 1 SHEETS STA. TO STA.

FILE NAME = ...p1n12106.Dist1_Det12.dgn	USER NAME = eptha'y	DESIGNED - AJP	REVISOR -
	PLOT SCALE = N.T.S.	DRAWN - IS	REVISOR -
	PLOT DATE = 4/21/2009	CHECKED - JR	REVISOR -
		DATE - 4/21/2009	REVISOR -

**STATE OF ILLINOIS
 DEPARTMENT OF TRANSPORTATION**

**DRIVEWAY ENTRANCE
 SIGNING**

F.A. RTE.	SECTION	COUNTY	TOTAL SHEETS	SHEET NO.
3537	3264 RS-5	COOK	21	20
FED. ROAD DIST. NO. ILLINOIS			FED. AID PROJECT	

SCALE: SHEET NO. OF SHEETS STA. TO STA.

CONTRACT NO. 60A89

