

* STA. 150+78.59 TO STA. 154+63 NO PATCHING IS ALLOWED ON DRY-LAND BRIDGE. ALSO NO ADDITIONAL LOAD SHOULD BE PLACED ON THE DRY-LAND BRIDGE WITHOUT CONSULTING A STRUCTURAL ENGINEER FIRST.

IL RTE 132 (GRAND AVE.)

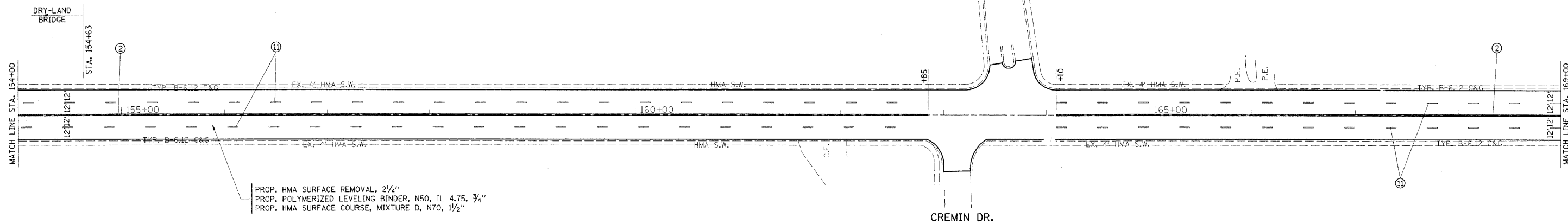

SHOSHONI TRAIL



PROP. HMA SURFACE REMOVAL, 2/4"
 PROP. POLYMERIZED LEVELING BINDER, N50, IL 4.75, 3/4"
 PROP. HMA SURFACE COURSE, MIXTURE D, N70, 1 1/2"

LEGEND	
①	THERMOPLASTIC PAVEMENT MARKING LINE, 4" - WHITE SOLID EDGE LINE
②	THERMOPLASTIC PAVEMENT MARKING LINE, 4" - DOUBLE YELLOW SOLID CENTERLINE, 11" C-C
③	THERMOPLASTIC PAVEMENT MARKING LINE, 4" - YELLOW SKIP DASH CENTERLINE, 10'-40'
④	THERMOPLASTIC PAVEMENT MARKING LINE, 4" - YELLOW SOLID CENTERLINE, NO PASS ZONE
⑤	THERMOPLASTIC PAVEMENT MARKING LINE, 6" - WHITE SOLID TURN LANE
⑥	THERMOPLASTIC PAVEMENT MARKING LINE, 12" - YELLOW SOLID DIAGONAL, 45°, 20' C-C
⑦	THERMOPLASTIC PAVEMENT MARKING LINE, 24" - WHITE SOLID STOP BAR
⑧	THERMOPLASTIC PAVEMENT MARKING LINE, 8" - WHITE SOLID DIAGONAL, 45°, 10' C-C
⑨	THERMOPLASTIC PAVEMENT MARKING LINE, LETTERS AND SYMBOLS
⑩	THERMOPLASTIC PAVEMENT MARKING LINE, 6" - WHITE SOLID CROSSWALK
⑪	THERMOPLASTIC PAVEMENT MARKING LINE, 4" - WHITE SKIP DASH LANE LINE
⑫	THERMOPLASTIC PAVEMENT MARKING LINE, 6" - WHITE DOTTED TURN LANE LINE, 2'-6"
⑬	THERMOPLASTIC PAVEMENT MARKING LINE, 24" - WHITE SOLID SCHOOL CROSSWALK, 4' C-C

IL RTE 132 (GRAND AVE.)

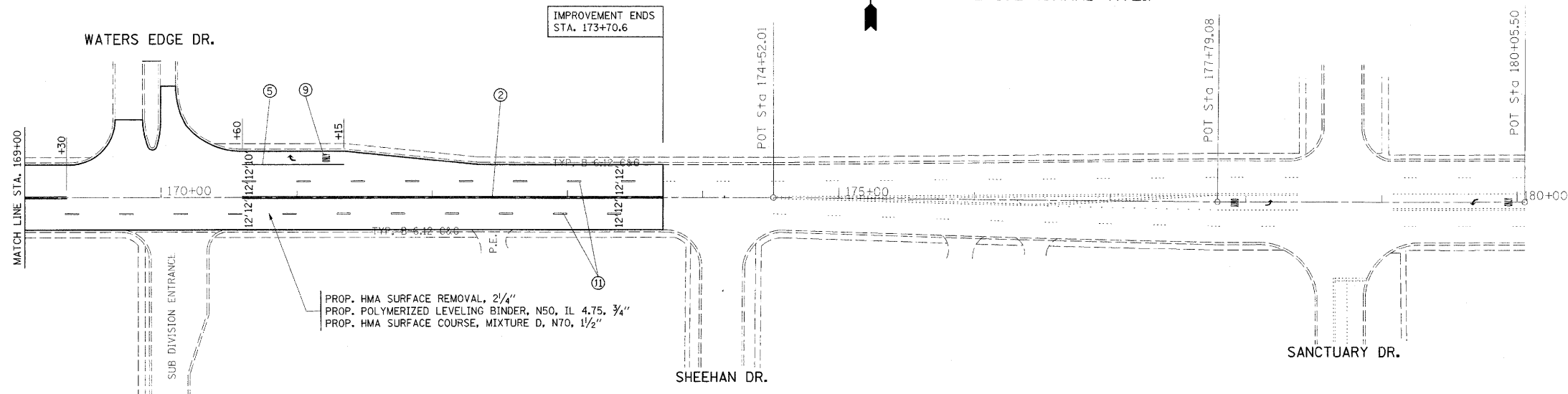

PROP. HMA SURFACE REMOVAL, 2/4"
 PROP. POLYMERIZED LEVELING BINDER, N50, IL 4.75, 3/4"
 PROP. HMA SURFACE COURSE, MIXTURE D, N70, 1 1/2"

FILE NAME =	USER NAME = ul-richkd	DESIGNED -	REVISED -	STATE OF ILLINOIS DEPARTMENT OF TRANSPORTATION	IL RTE. 132 IL RTE. 59 TO SHEEHAN DR.		F.A.P. RTE. 541	SECTION W-RS-3	COUNTY LAKE	TOTAL SHEETS 23	SHEET NO. 10	
ca:\pwwork\p\w\DOT\ULRICHK\dm92563\0138006-SHT-PLAN.dgn	PLOT SCALE = 50.0000' / 1" IN.	DRAWN -	REVISED -		SCALE: 1"=50'	SHEET NO. OF	SHEETS	STA. 154+00	TO STA. 173+70.6	ILLINOIS FED. AID PROJECT		
	PLOT DATE = 3/31/2009	CHECKED -	REVISED -							CONTRACT NO. 60B55		
		DATE -	REVISED -									