

SECTION	COUNTY	TOTAL SHEETS	SHEET NO.
W-RS-3	LAKE	23	12
STA.		TO STA.	
FED. ROAD DIST NO 7 ILLINOIS		FED AID PROJECT	

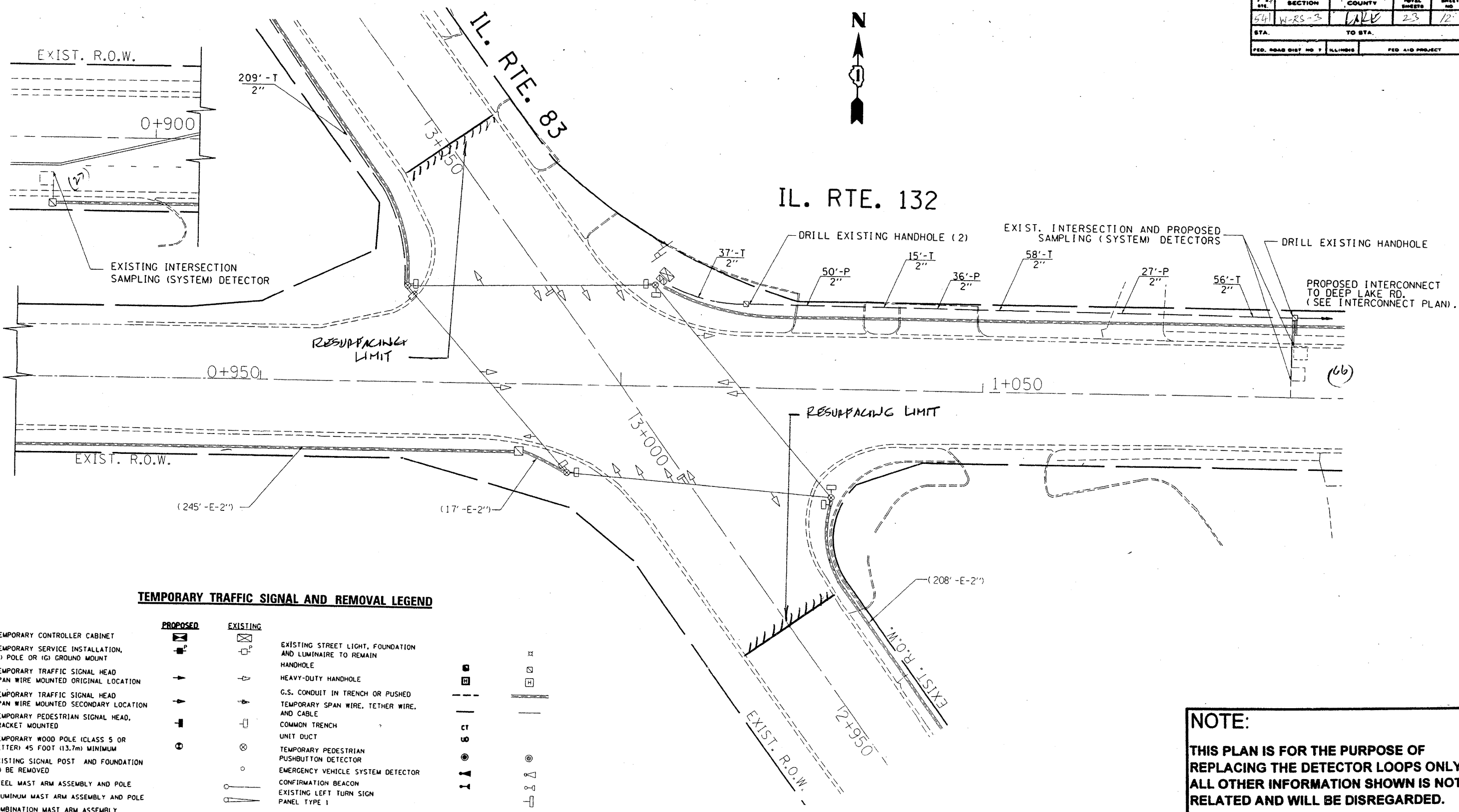

PROPOSED	EXISTING	
TEMPORARY CONTROLLER CABINET	EXISTING STREET LIGHT, FOUNDATION AND LUMINAIRE TO REMAIN	
TEMPORARY SERVICE INSTALLATION, (P) POLE OR (G) GROUND MOUNT	HANDHOLE	
TEMPORARY TRAFFIC SIGNAL HEAD	HEAVY-DUTY HANDHOLE	
SPAN WIRE MOUNTED ORIGINAL LOCATION	G.S. CONDUIT IN TRENCH OR PUSHED	
TEMPORARY TRAFFIC SIGNAL HEAD	TEMPORARY SPAN WIRE, TETHER WIRE, AND CABLE	
SPAN WIRE MOUNTED SECONDARY LOCATION	COMMON TRENCH	
TEMPORARY PEDESTRIAN SIGNAL HEAD, BRACKET MOUNTED	UNIT DUCT	
TEMPORARY WOOD POLE (CLASS 5 OR BETTER) 45 FOOT (13.7m) MINIMUM	TEMPORARY PEDESTRIAN PUSHBUTTON DETECTOR	
EXISTING SIGNAL POST AND FOUNDATION TO BE REMOVED	EMERGENCY VEHICLE SYSTEM DETECTOR	
STEEL MAST ARM ASSEMBLY AND POLE	CONFIRMATION BEACON	
ALUMINUM MAST ARM ASSEMBLY AND POLE	EXISTING LEFT TURN SIGN PANEL TYPE 1	
COMBINATION MAST ARM ASSEMBLY AND POLE, STEEL WITH LUMINAIRE		

**NOTE:**  
 THIS PLAN IS FOR THE PURPOSE OF REPLACING THE DETECTOR LOOPS ONLY. ALL OTHER INFORMATION SHOWN IS NOT RELATED AND WILL BE DISREGARDED.

**REPLACE ALL DETECTOR LOOPS AS SHOWN**  
 (WITHIN THE RESURFACING LIMITS)

CODE NO.	QUANTITY	UNIT	ITEM
86600600	93	Foot	Detector Loop Replacement

REVISIONS	
NAME	DATE

ILLINOIS DEPARTMENT OF TRANSPORTATION  
**DETECTOR LOOP REPLACEMENT**  
 IL. RTE. 83 @ IL. RTE. 132  
 SCALE: NONE  
 DATE: FEB. 2009  
 DRAWN BY: JHE  
 DESIGNED BY: JHE  
 CHECKED BY: DAD