

F.A.P. RTE.	SECTION	COUNTY	TOTAL SHEETS	SHEET NO.
349	15 RS-11	WILL	25	1
		ILLINOIS	CONTRACT NO. 60E68	

STATE OF ILLINOIS
DEPARTMENT OF TRANSPORTATION
DIVISION OF HIGHWAYS

**PROPOSED
HIGHWAY PLANS**

FAP ROUTE 349 / US 30 (LINCOLN HIGHWAY)
NORMANTOWN ROAD TO 143RD STREET
SECTION : 15 RS-11

RESURFACING (3P)
WILL COUNTY
C-91-502-08

FOR INDEX OF SHEETS, SEE SHEET NO. 2

THE PROJECT IS LOCATED IN THE VILLAGE OF PLAINFIELD

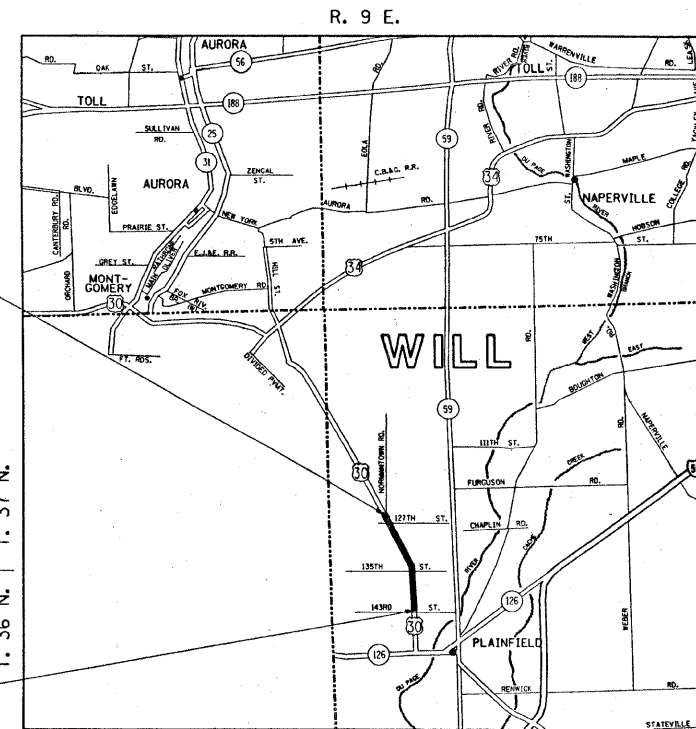

PROJECT ENDS
STA. 128 + 48

PROJECT BEGINS
STA. 5 + 42.7

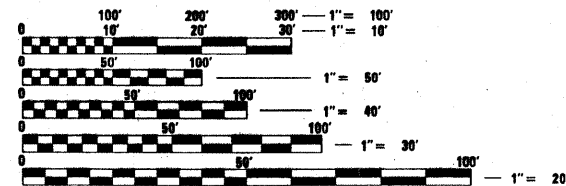

FULL SIZE PLANS HAVE BEEN PREPARED USING STANDARD ENGINEERING SCALES. REDUCED SIZED PLANS WILL NOT CONFORM TO STANDARD SCALES. IN MAKING MEASUREMENTS ON REDUCED PLANS, THE ABOVE SCALES MAY BE USED.

J.U.L.I.E.
JOINT UTILITY LOCATION INFORMATION FOR EXCAVATION
1-800-892-0123
OR 811



TRAFFIC DATA
2007 ADT = 13,700
SPEED LIMIT = 45 MPH

STATE OF ILLINOIS
DEPARTMENT OF TRANSPORTATION
DIVISION OF HIGHWAYS

SUBMITTED MARCH 24, 20 09

Dan M. O'Keefe
DEPUTY DIRECTOR OF HIGHWAYS, REGION ENGINEER

May 1, 20 09
Charles J. Innes
ENGINEER OF DESIGN AND ENVIRONMENT

May 1, 20 09
Christine M. Reed
DIRECTOR OF HIGHWAYS, CHIEF ENGINEER

PROJECT ENGINEER: DAN WILGREEN (847) 705-4240
PROJECT MANAGER: KEN ENG

GROSS & NET LENGTH = 12,305.3 FT. = 2.33 MILE

CONTRACT NO. 60E68

PRINTED BY THE AUTHORITY
OF THE STATE OF ILLINOIS