

P.A. DIST.	SECTION	COUNTY	TOTAL SHEETS	SHEET NO.
331	20RS-2	LAKE	20	11
STA.		TO STA.		
FED. ROAD DIST. NO. 1		ILLINOIS	FED. AID PROJECT	

Cont. # 60F31

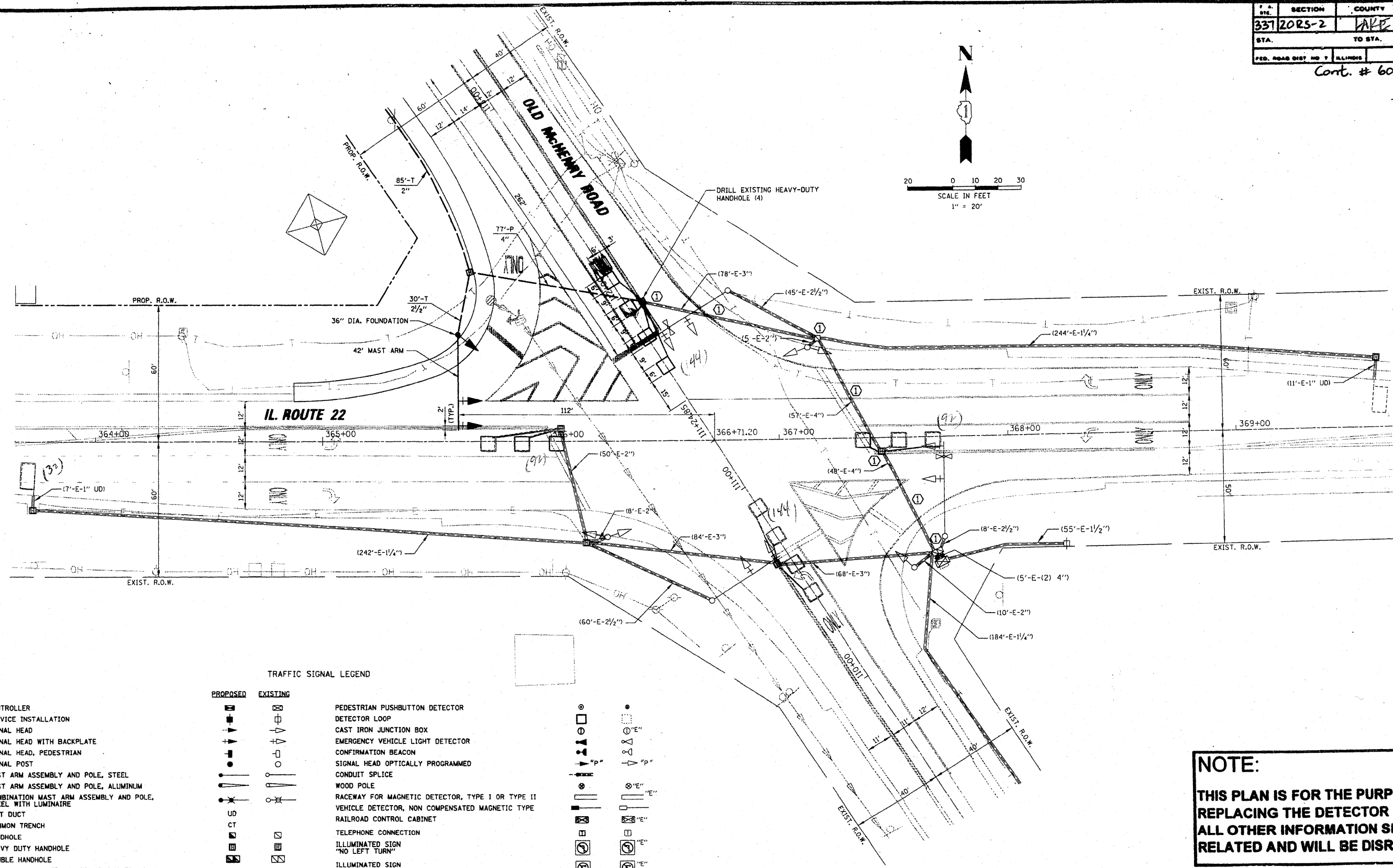
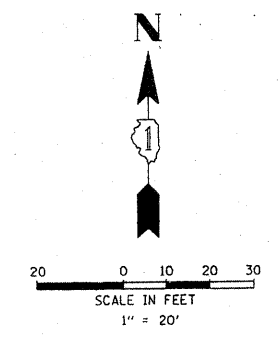

TRAFFIC SIGNAL LEGEND

<p>CONTROLLER</p> <p>SERVICE INSTALLATION</p> <p>SIGNAL HEAD</p> <p>SIGNAL HEAD WITH BACKPLATE</p> <p>SIGNAL HEAD, PEDESTRIAN</p> <p>SIGNAL POST</p> <p>MAST ARM ASSEMBLY AND POLE, STEEL</p> <p>MAST ARM ASSEMBLY AND POLE, ALUMINUM</p> <p>COMBINATION MAST ARM ASSEMBLY AND POLE, STEEL WITH LUMINAIRE</p> <p>UNIT DUCT</p> <p>COMMON TRENCH</p> <p>HANDHOLE</p> <p>HEAVY DUTY HANDHOLE</p> <p>DOUBLE HANDHOLE</p> <p>G.S. CONDUIT IN TRENCH (T) OR PUSHED (P)</p>	<p>PROPOSED</p> <p>EXISTING</p>	<p>PEDESTRIAN PUSHBUTTON DETECTOR</p> <p>DETECTOR LOOP</p> <p>CAST IRON JUNCTION BOX</p> <p>EMERGENCY VEHICLE LIGHT DETECTOR</p> <p>CONFIRMATION BEACON</p> <p>SIGNAL HEAD OPTICALLY PROGRAMMED</p> <p>CONDUIT SPLICE</p> <p>WOOD POLE</p> <p>RACEWAY FOR MAGNETIC DETECTOR, TYPE I OR TYPE II</p> <p>VEHICLE DETECTOR, NON COMPENSATED MAGNETIC TYPE</p> <p>RAILROAD CONTROL CABINET</p> <p>TELEPHONE CONNECTION</p> <p>ILLUMINATED SIGN "NO LEFT TURN"</p> <p>ILLUMINATED SIGN "NO RIGHT TURN"</p>	<p>①</p> <p>②</p> <p>③</p> <p>④</p> <p>⑤</p> <p>⑥</p> <p>⑦</p> <p>⑧</p> <p>⑨</p> <p>⑩</p> <p>⑪</p> <p>⑫</p> <p>⑬</p> <p>⑭</p> <p>⑮</p> <p>⑯</p> <p>⑰</p> <p>⑱</p> <p>⑲</p> <p>⑳</p> <p>㉑</p> <p>㉒</p> <p>㉓</p> <p>㉔</p> <p>㉕</p> <p>㉖</p> <p>㉗</p> <p>㉘</p> <p>㉙</p> <p>㉚</p> <p>㉛</p> <p>㉜</p> <p>㉝</p> <p>㉞</p> <p>㉟</p> <p>㊱</p> <p>㊲</p> <p>㊳</p> <p>㊴</p> <p>㊵</p> <p>㊶</p> <p>㊷</p> <p>㊸</p> <p>㊹</p> <p>㊺</p> <p>㊻</p> <p>㊼</p> <p>㊽</p> <p>㊾</p> <p>㊿</p>
---	---------------------------------	--	---

REPLACE ALL DETECTOR LOOPS AS SHOWN

(WITHIN THE RESURFACING LIMITS)

CODE NO.	QUANTITY	UNIT	ITEM
80600600	570	Foot	Detector Loop Replacement

REVISIONS	
NAME	DATE

NOTE:
THIS PLAN IS FOR THE PURPOSE OF REPLACING THE DETECTOR LOOPS ONLY. ALL OTHER INFORMATION SHOWN IS NOT RELATED AND WILL BE DISREGARDED.

ILLINOIS DEPARTMENT OF TRANSPORTATION
DETECTOR LOOP REPLACEMENT
ILL. ROUTE 22 @ OLD MCHENRY RD.

SCALE: NONE
DATE: FEB. 2009

DRAWN BY: JHE
DESIGNED BY: JHE
CHECKED BY: DAD