

STATE OF ILLINOIS  
DEPARTMENT OF TRANSPORTATION  
DIVISION OF HIGHWAYS

**PROPOSED  
HIGHWAY PLANS**

F.A.U. 3510 (NB I-55 EAST FRONTAGE ROAD)  
SECTION 29 R-2AC-RS-1  
IL 53 TO JOLIET ROAD  
RESURFACING

WILL COUNTY  
C-91-135-09

F.A.U. RTE.	SECTION	COUNTY	TOTAL SHEETS	SHEET NO.
3510	29 R-2AC-RS-1	WILL	16	1
FED. ROAD DIST. NO. 1	ILLINOIS	CONTRACT NO.	60F58	

FOR INDEX OF SHEETS, SEE SHEET NO. 2

THESE IMPROVEMENTS ARE LOCATED  
WITHIN THE VILLAGE OF BOLINGBROOK

**TRAFFIC DATA**

2005 ADT - 8,900  
POSTED SPEED LIMIT - 45 MPH

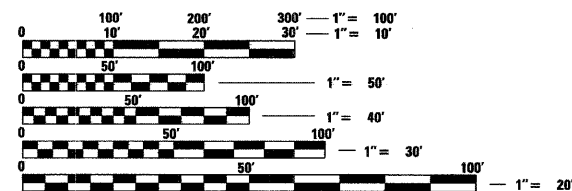

FULL SIZE PLANS HAVE BEEN PREPARED USING STANDARD ENGINEERING SCALES. REDUCED SIZED PLANS WILL NOT CONFORM TO STANDARD SCALES. IN MAKING MEASUREMENTS ON REDUCED PLANS, THE ABOVE SCALES MAY BE USED.

J.U.L.I.E.  
JOINT UTILITY LOCATION INFORMATION FOR EXCAVATION  
1-800-892-0123  
OR 811

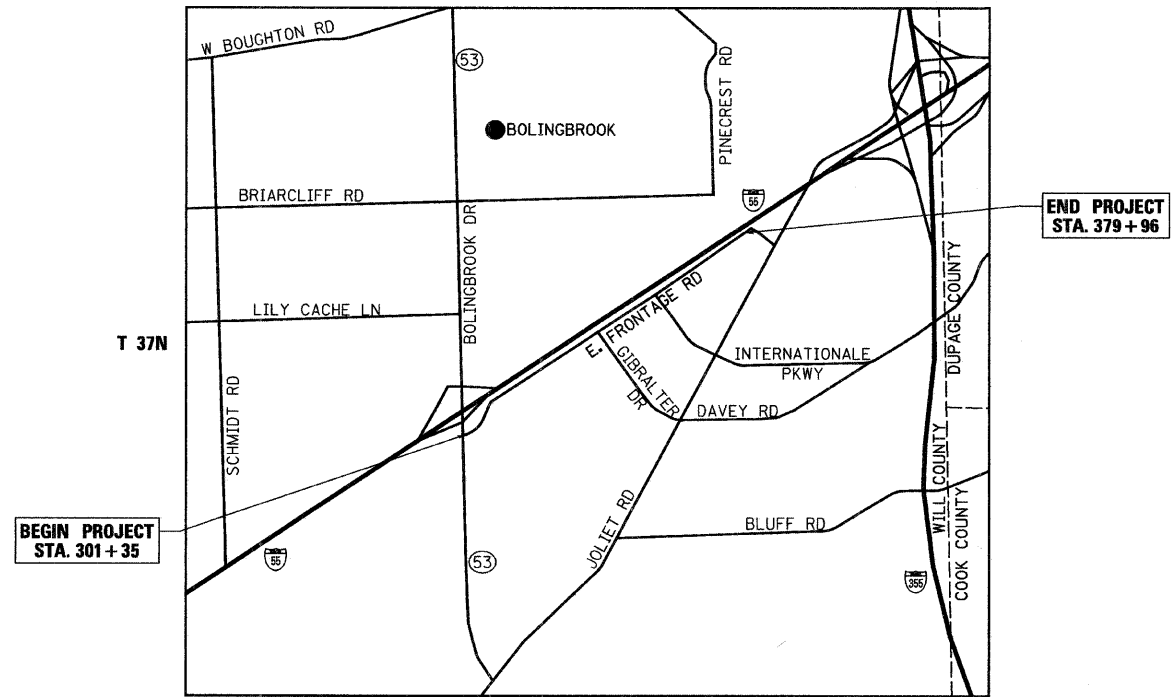

BEGIN PROJECT  
STA. 301+35

END PROJECT  
STA. 379+96

DUPAGE TOWNSHIP  
LOCATION MAP  
1" = 2,000'

GROSS AND NET LENGTH OF PROJECT = 7,861 FT = 1.48 MI.

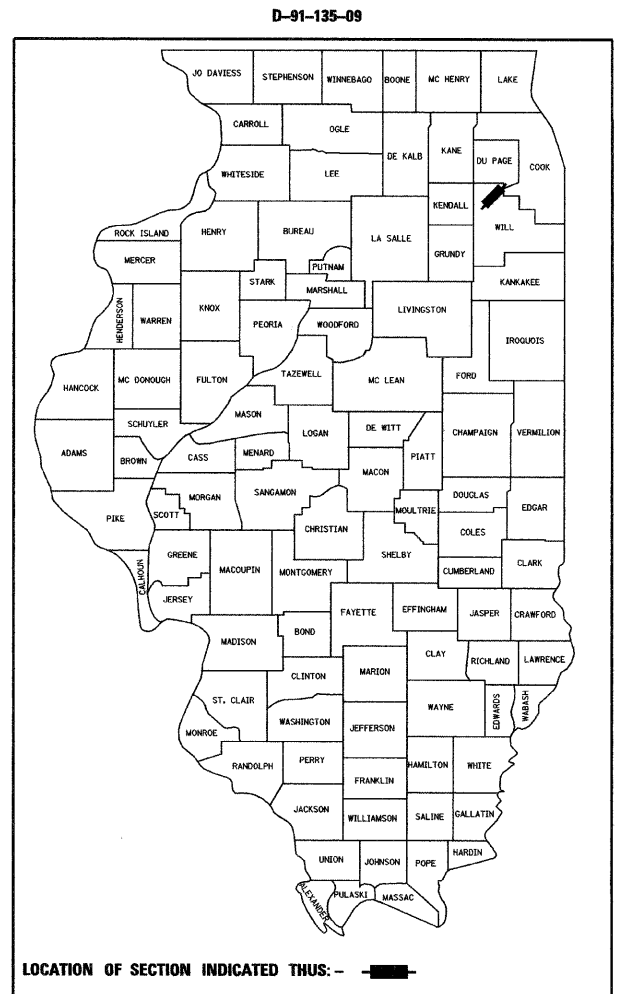

LOCATION OF SECTION INDICATED THUS: - [black rectangle] -

STATE OF ILLINOIS  
DEPARTMENT OF TRANSPORTATION  
DIVISION OF HIGHWAYS

SUBMITTED MARCH 24, 2009

Diane M. O'Keefe DEPUTY DIRECTOR OF HIGHWAYS, REGION ENGINEER

May 1, 2009

Charles J. Ingersoll ENGINEER OF DESIGN AND ENVIRONMENT

May 1, 2009

Christine M. Reed DIRECTOR OF HIGHWAYS, CHIEF ENGINEER

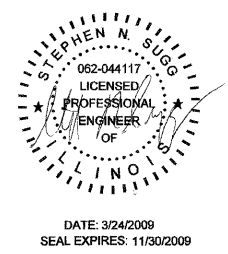

**PRINTED BY THE AUTHORITY  
OF THE STATE OF ILLINOIS**

DISTRICT 1 DESIGN PLAN PREPARATION ENGINEER: K. ENG (847)705-4247

CONTRACT NO. 60F58

**Giorba Group, Inc.**

DESIGN FIRM  
REGISTRATION NUMBER  
184-001016

CONSULTING ENGINEERS  
SUITE 402, 5507 NORTH CUMBERLAND AVE  
CHICAGO, ILLINOIS 60656 :: (773) 775-4009