

TYPICAL ENTRANCE/EXIT RAMP COMBINATION PAVEMENT MARKINGS

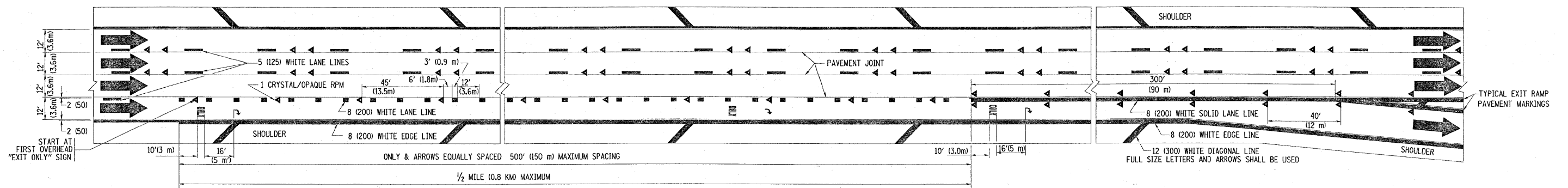

TYPICAL EXIT ONLY LANE PAVEMENT MARKINGS

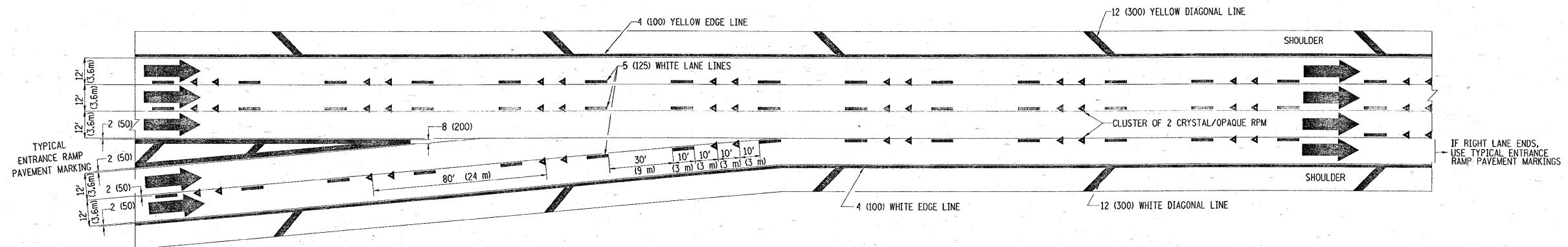

TYPICAL TWO LANE ENTRANCE RAMP PAVEMENT MARKINGS

FILE NAME =	USER NAME = smithk1	DESIGNED - D.W.S.	REVISED - A.H. 03-96	STATE OF ILLINOIS DEPARTMENT OF TRANSPORTATION	MULTI-LANE FREEWAY PAVEMENT MARKING DETAILS		F.A.P. RTE. 345	SECTION 22-3 (I&2) RS	COUNTY DUPAGE	TOTAL SHEETS 25	SHEET NO. 22	
CONTRACT NO. 60656	PLLOT SCALE = 50,00000' / IN.	CHECKED -	REVISED - J.A.F. 02-06		SCALE: NONE	SHEET NO. 2 OF 2 SHEETS	STA. TO STA.	TC-12				
	PLLOT DATE = 4/9/2009	DATE - 01-90	REVISED - S.P.B. 01-07		FED. ROAD DIST. NO. 1 ILLINOIS FED. AID PROJECT							