

CONTRACT NO.		TOTAL SHEETS	SHEET NO.
F.A. RTE.	SECTION	COUNTY	
STA.		TO STA.	
FED. ROAD DIST. NO.	ILLINOIS FED. AID PROJECT		

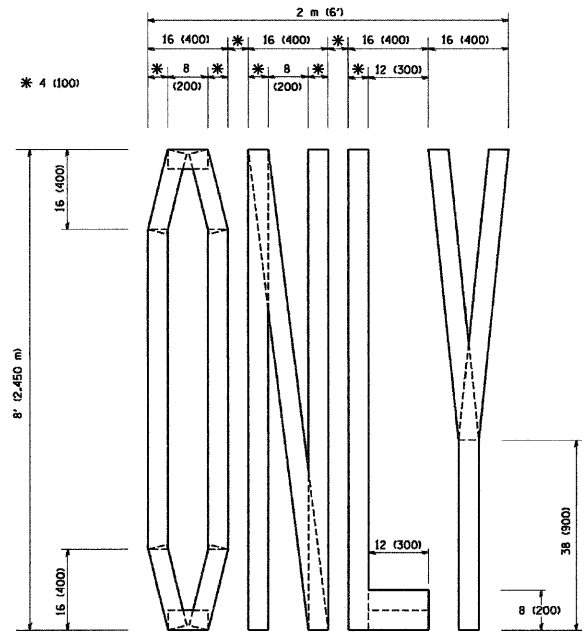

QUANTITY
4 (100) LINE = 64.1 ft. (19.7 m)
21.1 sq. ft. (1.97 sq. m)

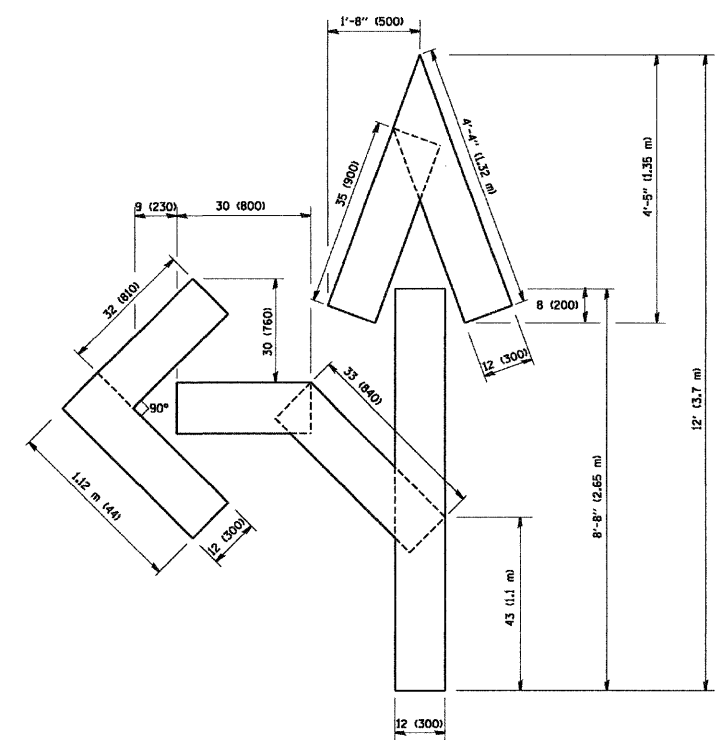

QUANTITY
4 (100) LINE = 82.5 ft. (25.3 m)
27.5 sq. ft. (2.53 sq. m)

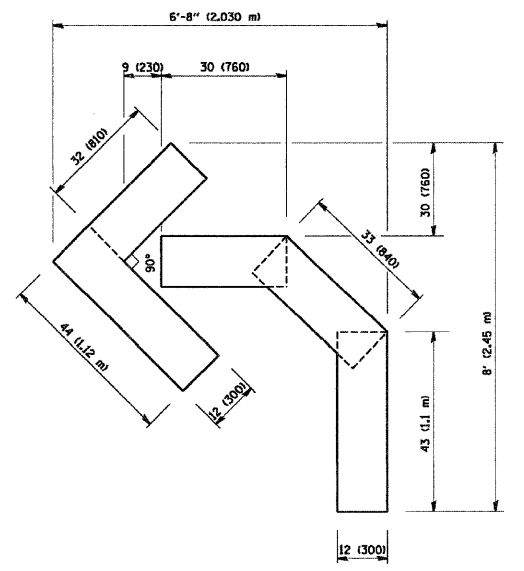

QUANTITY
4 (100) LINE = 45.5 ft. (13.9 m)
15.2 sq. ft. (1.39 sq. m)

All dimensions are in inches (millimeters) unless otherwise shown.

REVISIONS	
NAME	DATE
T. RAMMACHER	09/18/94
J. OBERLE	06/01/96
T. RAMMACHER	06/03/96
T. RAMMACHER	11/03/97
T. RAMMACHER	03/02/98
E. GOMEZ	08/28/00

ILLINOIS DEPARTMENT OF TRANSPORTATION
PAVEMENT MARKING LETTERS AND SYMBOLS FOR TRAFFIC STAGING
SCALE: NONE
DRAWN BY CADD
CHECKED BY TC-16

PLOT DATE = 3/7/2007
FILE NAME = K:\GIS\1009.Dwg
PLOT SCALE = 3/8" = 1' IN.
USER NAME = gthesse

FILE NAME = ...p\151809.Dwg	USER NAME = gthesse	DESIGNED - TJJ	REVISED -	STATE OF ILLINOIS DEPARTMENT OF TRANSPORTATION	PAVEMENT MARKING LETTERS AND SYMBOLS FOR TRAFFIC STAGING	F.A. RTE. 345	SECTION 10 RS-9	COUNTY KANE	TOTAL SHEETS 28	SHEET NO. 25	
PLOT SCALE = N.T.S.	CHECKED - JJT	REVISED -	SCALE: N.T.S.			SHEET NO. 25 OF 28 SHEETS	STA. TO STA.	CONTRACT NO. 60662			
PLOT DATE = 4/17/2009	DATE - 04/16/09	REVISED -	FED. ROAD DIST. NO. ILLINOIS FED. AID PROJECT								