

QUANTITY
 4 (100) LINE = 64.1 ft. (19.7 m)
 21.1 sq. ft. (1.97 sq. m)

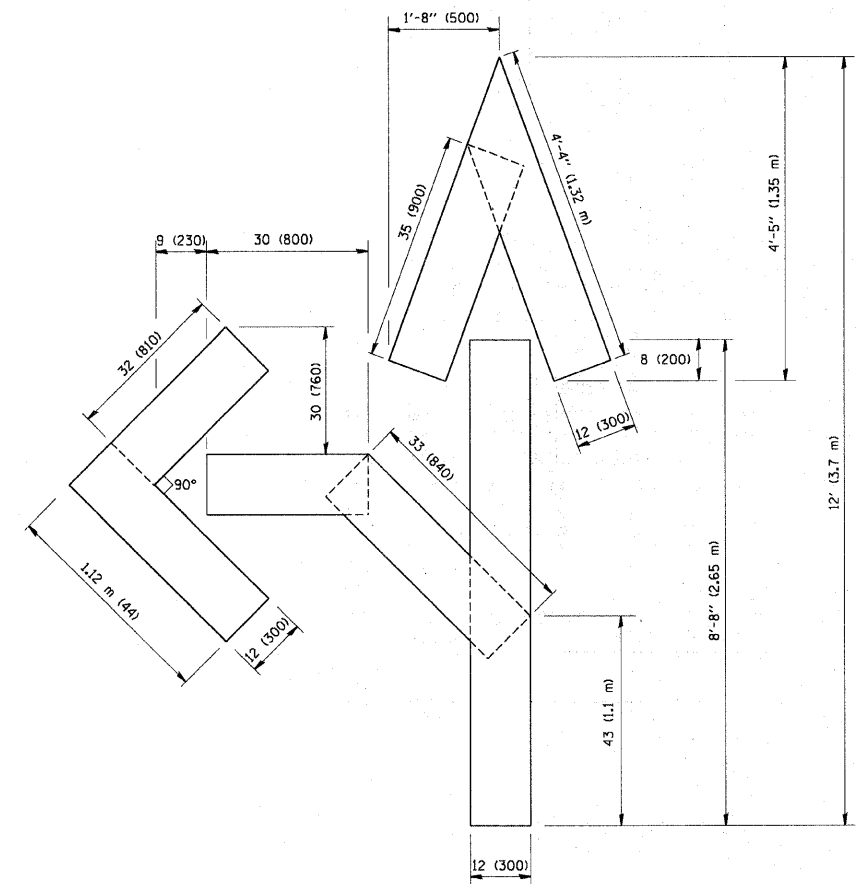

QUANTITY
 4 (100) LINE = 82.5 ft. (25.3 m)
 27.5 sq. ft. (2.53 sq. m)

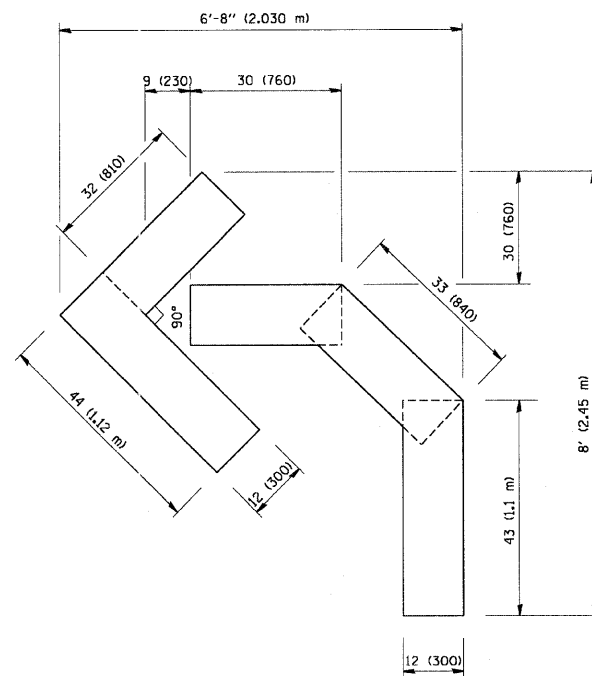

QUANTITY
 4 (100) LINE = 45.5 ft. (13.9 m)
 15.2 sq. ft. (1.39 sq. m)

All dimensions are in Inches (millimeters) unless otherwise shown.

FILE NAME = C:\Projects\DistStd.dgn	USER NAME = ieyse	DESIGNED -	REVISED - T. RAMMACHER 06-05-96
		DRAWN -	REVISED - T. RAMMACHER 11-04-97
	PLOT SCALE = 50.0000 / IN.	CHECKED -	REVISED - T. RAMMACHER 03-02-98
	PLOT DATE = 4/24/2009	DATE - 09-18-94	REVISED - E. GOMEZ 08-28-00

**STATE OF ILLINOIS
 DEPARTMENT OF TRANSPORTATION**

**PAVEMENT MARKING LETTERS AND SYMBOLS
 FOR TRAFFIC STAGING**

SCALE: NONE SHEET NO. 1 OF 1 SHEETS STA. TO STA.

F.A. RTE.	SECTION	COUNTY	TOTAL SHEETS	SHEET NO.
607	128 RS-5	WILL	29	19
TC-16			CONTRACT NO. 60G66	
FED. ROAD DIST. NO. 1 ILLINOIS FED. AID PROJECT				