

TRAFFIC SIGNAL LEGEND

	PROPOSED	EXISTING
DETECTOR LOOP		
SIGNAL HEAD		
G.S. CONDUIT IN TRENCH OR PUSHED		
SIGNAL HEAD WITH BACKPLATE		
RACEWAY FOR MAGNETIC DETECTOR, TYPE I OR II		
VEHICLE DETECTOR, NON-COMPENSATED MAGNETIC TYPE		

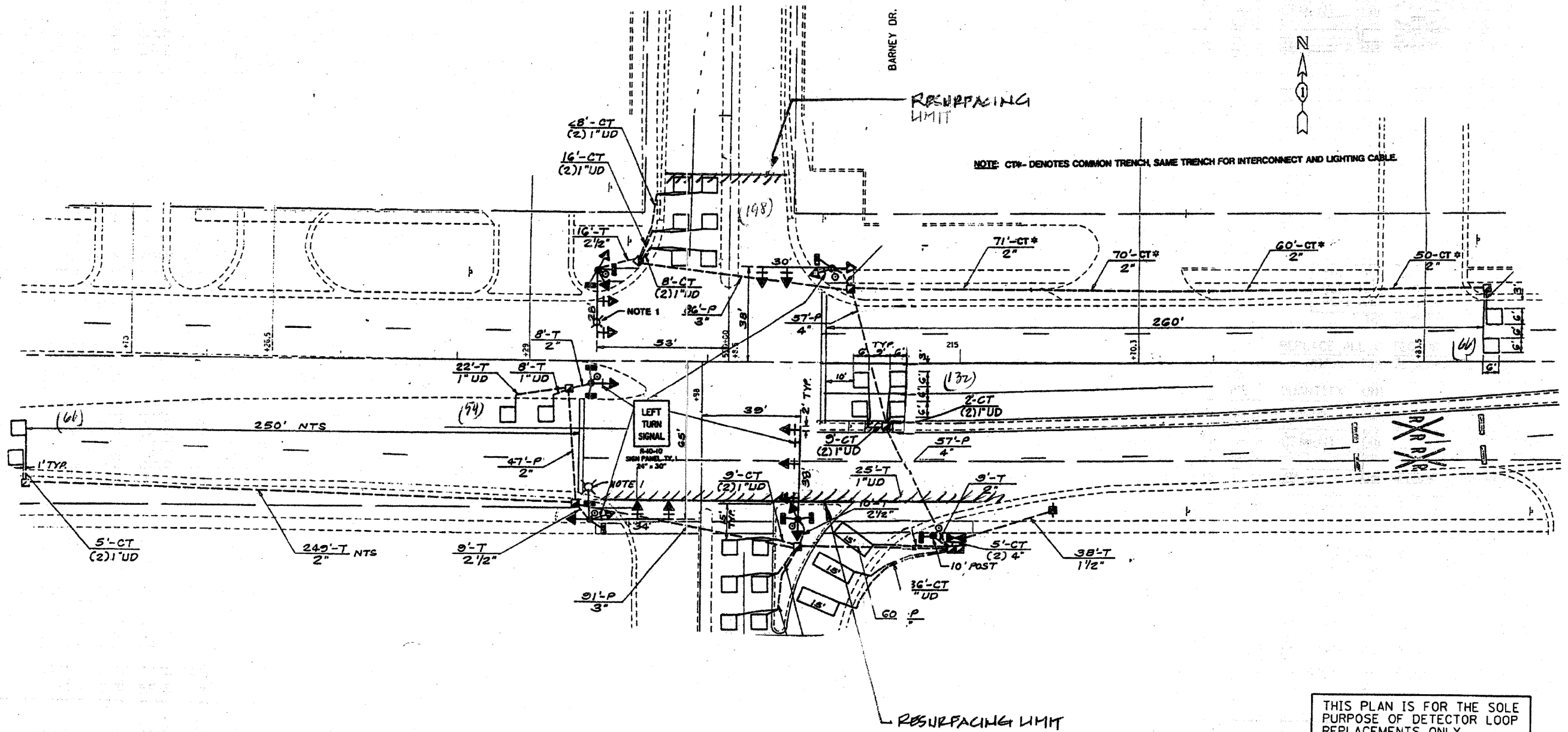

THIS PLAN IS FOR THE SOLE PURPOSE OF DETECTOR LOOP REPLACEMENTS ONLY

REPLACE ALL DETECTOR LOOPS AS SHOWN (WITHIN THE RESURFACING LIMITS)

CODE	QUANTITY	UNIT	ITEM
88600600	516	FOOT	DETECTOR LOOP, REPLACEMENT

FILE NAME =	USER NAME = kamthaphixaybc	DESIGNED - BCK	REVISED -
ct:\pwr\work\PH1001\KANTHAPHIXAYBC\d01126	traffic.legend.v7.dgn	DRAWN - BCK	REVISED -
	PLOT SCALE = 3/8" = 1' IN.	CHECKED - DAD	REVISED -
	PLOT DATE = 4/3/2009	DATE -	REVISED -

STATE OF ILLINOIS
DEPARTMENT OF TRANSPORTATION

DISTRICT ONE - DETECTOR LOOP REPLACEMENT
U.S. ROUTE 52 @ BARNEY DRIVE

F.A. RTE. 607	SECTION 128RS-5	COUNTY WILL	TOTAL SHEETS 29	SHEET NO. 28
SCALE: NONE		SHEET NO. OF SHEETS STA.		TO STA.
FED. ROAD DIST. NO.		ILLINOIS FED. AID PROJECT		

traffic legend v7.dgn 4/3/2009 11:17:41 AM User=kamthaphixaybc