

F.A.P. RTE.	SECTION	COUNTY	TOTAL SHEETS	SHEET NO.
573	61 S-3	KANE	15	1
FED. ROAD DIST. NO.	ILLINOIS	CONTRACT NO. 60G74		

D-91-530-09

PROJECT LOCATED ADJACENT TO THE CITY OF SUGAR GROVE, AND THE CITY OF AURORA

STATE OF ILLINOIS
DEPARTMENT OF TRANSPORTATION
DIVISION OF HIGHWAYS

**PROPOSED
HIGHWAY PLANS**

FAP ROUTE 573 (ILL ROUTE 56)
US ROUTE 30 TO NORRIS ROAD

SECTION: 61RS-3
RESURFACING (3P)

KANE COUNTY
C-91-530-09

FOR INDEX OF SHEETS, SEE SHEET NO. 2

ADT 19,800 (2007)
SPEED LIMIT 55 MPH

OMMISSIONS
STA. 103+00 TO STA. 105+50
STA. 201+60 TO STA. 202+40

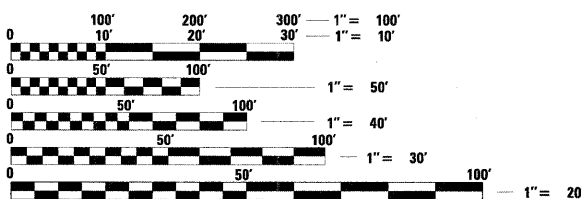

FULL SIZE PLANS HAVE BEEN PREPARED USING STANDARD ENGINEERING SCALES. REDUCED SIZED PLANS WILL NOT CONFORM TO STANDARD SCALES. IN MAKING MEASUREMENTS ON REDUCED PLANS, THE ABOVE SCALES MAY BE USED.

J.U.L.I.E.
JOINT UTILITY LOCATION INFORMATION FOR EXCAVATION
1-800-892-0123
OR 811

PROJECT MANAGER: RAJENDRA C. SHAH (847) 705-4555
PROJECT ENGINEER: ERSKINE W. KLYCE (847) 705-4594

CONTRACT NO. 60G74

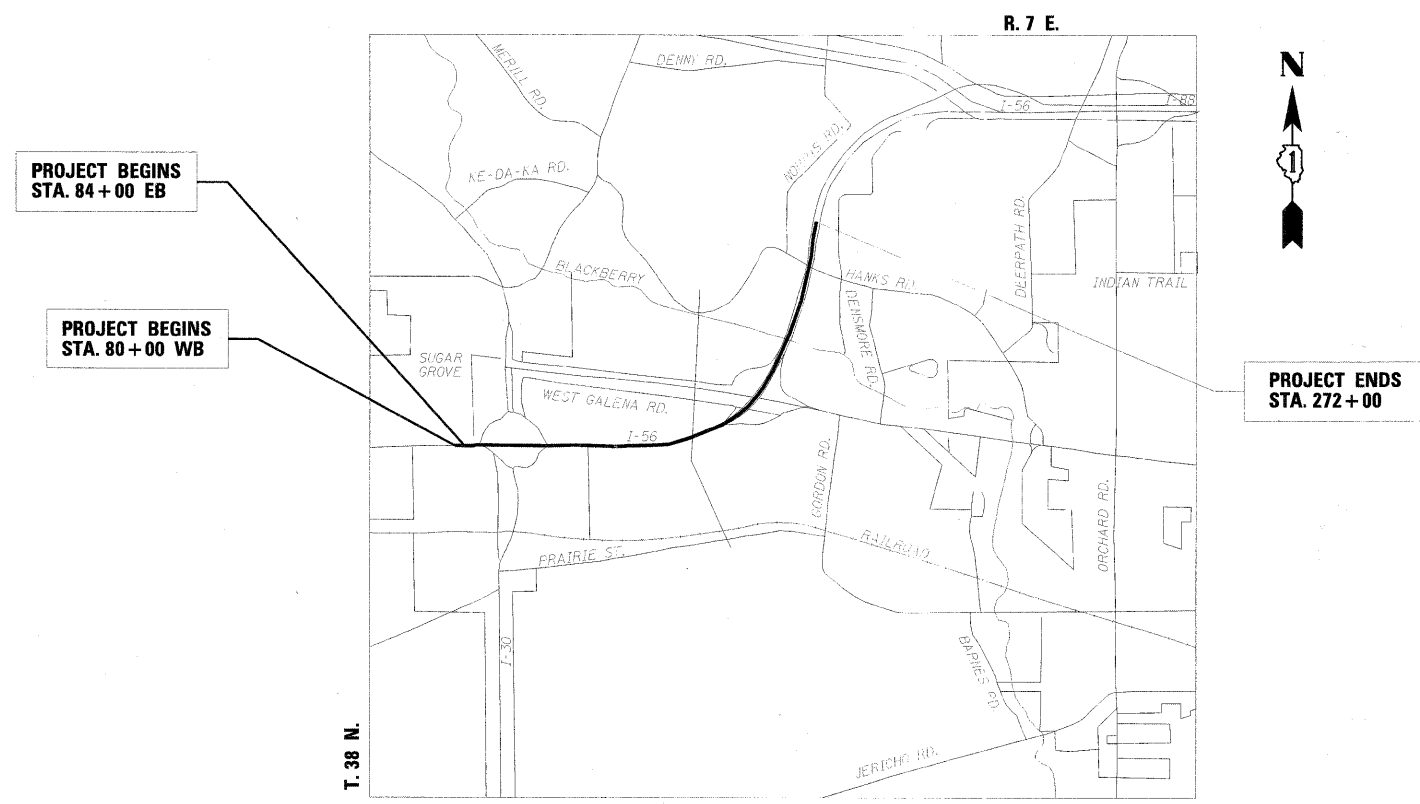

LOCATION SKETCH

GROSS LENGTH OF PROJECT = 19,200' = 3.636 MI
NET LENGTH OF PROJECT = 18,870' = 3.574 MI

STATE OF ILLINOIS
DEPARTMENT OF TRANSPORTATION
DIVISION OF HIGHWAYS

SUBMITTED APRIL 21, 2009

Diane M. O'Keefe
DEPUTY DIRECTOR OF HIGHWAYS, REGION ENGINEER
May 1, 2009

Charles G. Ingersoll
ENGINEER OF DESIGN AND ENVIRONMENT
May 1, 2009

Christine M. Reed
DIRECTOR OF HIGHWAYS, CHIEF ENGINEER

PRINTED BY THE AUTHORITY
OF THE STATE OF ILLINOIS

LOCO, INC.
CONSULTING ENGINEERS
1560 WALL ST, SUITE 222
NAPERVILLE, ILLINOIS 60563 PH: 630/577-9100

WILLIAM H. EPP
REGISTERED PROFESSIONAL ENGINEER
ILLINOIS
W. H. Epp
Expires 11-20-09

INDEX OF SHEETS

STATE STANDARDS

PLAN NOTES

<u>SHEET NO.</u>	<u>DESCRIPTION</u>
1	TITLE SHEET
2	INDEX OF SHEETS, STATE STANDARDS, AND GENERAL NOTES
3	SUMMARY OF QUANTITIES
4-5	EXISTING AND PROPOSED TYPICAL SECTIONS
6-9	ROADWAY AND PAVEMENT MARKING PLANS
10	PAVEMENT PATCHING FOR HMA SURFACED PAVEMENT
11	BUTT JOINT AND HMA TAPER DETAILS
12	TRAFFIC CONTROL AND PROTECTION FOR SIDE ROADS, INTERSECTIONS, AND DRIVEWAYS
13	TYPICAL APPLICATIONS RAISED REFLECTIVE PAVEMENT MARKERS (SNOW-PLOW RESISTANT)
14	DISTRICT ONE TYPICAL PAVEMENT MARKINGS
15	ARTERIAL ROAD INFORMATION SIGN
	STATE STANDARDS

<u>STANDARD NO.</u>	<u>DESCRIPTION</u>
000001-05	STANDARD SYMBOLS, ABBREVIATIONS AND PATTERNS
442201-03	CLASS C AND D PATCHES
606001-04	CONCRETE CURB TYPE B AND COMBINATION CONCRETE CURB AND GUTTER
701001-02	OFF-RD OPERATIONS, 2L, 2W, MORE THAN 15' (4.5M) AWAY
701006-03	OFF-RD OPERATIONS, 2L, 2W, MORE THAN 15' (4.5 M) TO 24" (600MM) FROM PAVEMENT EDGE
701011-02	OFF-RD MOVING OPERATIONS, 2L, 2W, DAY ONLY
701101-02	OFF-RD OPERATIONS, MULTILANE, 15' (4.5 M) TO 24" (600MM) FROM PAVEMENT EDGE
701501-05	URBAN LANE CLOSURE, 2L, 2W, UNDIVIDED
701701-06	URBAN LANE CLOSURE, MULTILANE INTERSECTION
701901-01	TRAFFIC CONTROL DEVICES
780001-02	TYPICAL PAVEMENT MARKINGS
781001-03	TYPICAL APPLICATIONS RAISED REFLECTIVE PAVEMENT MARKERS

BEFORE STARTING ANY EXCAVATION, THE CONTRACTOR SHALL CALL "JULIE" AT 800-892-0123 FOR FIELD LOCATIONS OF BURIED ELECTRIC, TELEPHONE AND GAS FACILITIES. (48 HOUR NOTIFICATION IS REQUIRED)

THE CONTRACTOR SHALL COORDINATE CONSTRUCTION ACTIVITIES WITH UTILITY COMPANIES WITHIN THE VILLAGE OF SUGAR GROVE, AND THE CITY OF AURORA.

THE CONTRACTOR WILL NOT BE ALLOWED TO SET UP A YARD OF FIELD OFFICE ON STATE PROPERTY WITHOUT WRITTEN PERMISSION FROM THE DEPARTMENT.

BUTT JOINTS WILL BE INSTALLED AT THE ENDS OF ALL RESURFACING (WHERE RESURFACING MEETS EXISTING PAVEMENT). IN ACCORDANCE WITH THE "BUTT JOINT AND HOT-MIX ASPHALT TAPER DETAILS" SHEETS INCLUDED ON THE PLANS, UNLESS OTHERWISE SPECIFIED.

THE RESIDENT ENGINEER SHALL CONTACT MS. PATRICE HARRIS AREA TRAFFIC FIELD ENGINEER AT (708) 597-9800 A MINIMUM OF 2 WEEKS PRIOR TO PLACEMENT OF PERMANENT PAVEMENT MARKING.

THE RESIDENT ENGINEER SHALL CONTACT THE DISTRICT ONE ARTERIAL TRAFFIC CONTROL SUPERVISOR AT (847) 705-4470 A MINIMUM OF 72 HOURS PRIOR TO START OF WORK

10 FEET (3 METERS) TRANSITION SHALL BE USED TO MATCH PROPOSED CURB AND GUTTER TO EXISTING CURB AND GUTTERS IN THE FIELD, UNLESS OTHERWISE SHOWN. THE TRANSITION SHALL BE PAID FOR AT THE CONTRACT UNIT PRICE FOR THE PROPOSED ITEMS OR WORK SPECIFIED.

WHEN MILLED PAVEMENT IS OPEN TO TRAFFIC THE MAXIMUM GRADE DIFFERENTIAL BETWEEN PASSES OF THE MILLING MACHINE SHALL NOT EXCEED 1/2 INCHES (40MM) WHERE THE SPEED LIMIT IS 45 MPH (80 KM/H) OR LESS AND 1 INCH (25MM) WHERE THE SPEED LIMIT IS GREATER THAN 45 MPH (80 KM/H). WITH WRITTEN APPROVAL FROM THE ENGINEER, A MAXIMUM GRADE DIFFERENTIAL OF 3 INCHES (75MM) MAY BE ALLOWED IF THE EDGE OF THE MILLING IS SLOPED A MINIMUM 1:3 (V:H).

SUMMARY OF QUANTITIES					SUMMARY OF QUANTITIES						
CODE NO.	ITEM	UNIT	URBAN TOTAL QUANTITIES	1000 100% STATE	CONSTRUCTION TYPE CODE	CODE NO.	ITEM	UNIT	URBAN TOTAL QUANTITIES	1000 100% STATE	CONSTRUCTION TYPE CODE
20201006	GRADING AND SHAPING SHOULDERS	UNIT	380	380		* 78000200	THERMOPLASTIC PAVEMENT MARKING - LINE 4"	FOOT	84636	84636	
40600200	BITUMINOUS MATERIALS (PRIME COAT)	TON	45	45		* 78100100	RAISED REFLECTIVE PAVEMENT MARKER	EACH	950	950	
40600300	AGGREGATE (PRIME COAT)	TON	223	223		78300200	RAISED REFLECTIVE PAVEMENT MARKER REMOVAL	EACH	950	950	
40600400	MIXTURE FOR CRACKS, JOINTS, AND FLANGEWAYS	TON	44	44		X0322256	TEMPORARY INFORMATION SIGNING	SQ FT	283	283	
40600895	CONSTRUCTING TEST STRIP	EACH	1	1		X4067107	POLYMERIZED LEVELING BINDER (MACHINE METHOD), IL-4.57, N50	TON	4674	4674	
40600982	HOT-MIX ASPHALT SURFACE REMOVAL - BUTT JOINT	SQ YD	1014	1014		X0656100	DRIVEWAY PAVEMENT REMOVAL AND REPLACEMENT	SQ YD	26	26	
40601005	HOT-MIX ASPHALT REPLACEMENT OVER PATCHES	TON	1870	1870							
40603340	HOT-MIX ASPHALT SURFACE COURSE, MIX "D", N70	TON	9309	9309							
42001300	PROTECTIVE COAT	SQ YD	22	22							
44000155	HOT-MIX ASPHALT SURFACE REMOVAL, 1 1/2"	SQ YD	3632	3632							
44000158	HOT-MIX ASPHALT SURFACE REMOVAL, 2 1/4"	SQ YD	106601	106601							
44001700	COMBINATION CONCRETE CURB AND GUTTER REMOVAL AND REPLACEMENT	FOOT	120	120							
44002212	HOT-MIX ASPHALT REMOVAL OVER PATCHES, 3"	SQ YD	11128	11128							
44201765	CLASS D PATCHES, TYPE II, 10 INCH	SQ YD	5564	5564							
44201769	CLASS D PATCHES, TYPE III, 10 INCH	SQ YD	1781	1781							
44201771	CLASS D PATCHES, TYPE IV, 10 INCH	SQ YD	3784	3784							
67000400	ENGINEER'S FIELD OFFICE, TYPE A	CAL MO	6	6							
67100100	MOBILIZATION	L SUM	1	1							
70102620	TRAFFIC CONTROL AND PROTECTION, STANDARD 701501	L SUM	1	1							
70102635	TRAFFIC CONTROL AND PROTECTION, STANDARD 701701	L SUM	1	1							
70300100	SHORT - TERM PAVEMENT MARKING	FOOT	25391	25391							
70300220	TEMPORARY PAVEMENT MARKING - LINE 4"	FOOT	84636	84636							
70301000	WORK ZONE PAVEMENT MARKING REMOVAL	SQ FT	28212	28212							

* Specialty Items

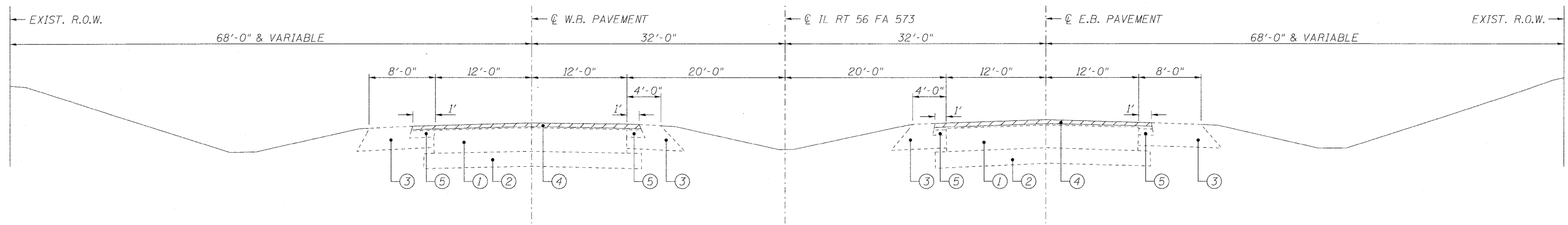

EXISTING TYPICAL SECTION
 STA. 80+00 TO STA. 166+20
 STA. 204+04 TO STA. 272+20
 (EXCEPT DRYLAND BRIDGE)

- ① EXIST. 10" REINFORCED P.C.C. PAVEMENT
- ② EXIST. 6" SUB BASE GRANULAR MATERIAL, TYPE A
- ③ EXIST. AGGREGATE SHOULDER 11-1/4"
- ④ EXIST. HMA BINDER COURSE 3-1/4" (REMOVE 2-1/2")
- ⑤ EXIST. HMA BINDER COURSE
- ⑥ PROP. POLYMERIZED LEVELING BINDER (MACHINE METHOD), N50 (3/4")
- ⑦ PROP. HOT-MIX ASPHALT SURFACE COURSE, MIX "D", N70 (1-3/4")

HOT-MIX ASPHALT MIXTURE REQUIREMENTS		
MIXTURE TYPE	AC/PG	DESIGN AIR VOIDS
HMA SURFACE COURSE, MIX D, N70. (IL-9.5 mm)	PG 64-22	4% @ 70 GYR
POLYMERIZED LEVELING BINDER (MACHINE METHOD). IL-4.75, N50	SBS-SBR PG 76-28/22	4% @ 50 GYR
CLASS D PATCHES (HMA BINDER IL 19 mm)	PG 64-22*	4% @ 70 GYR
HMA REPLACEMENT OVER PATCHES (HMA BINDER IL 19 mm)	PG 64-22*	4% @ 70 GYR

NOTE:
 1: THE UNIT WEIGHT USED TO CALCULATE ALL HMA SURFACE COURSE MIXTURES IS 112 LSB/SQYD/IN.
 *WHEN RAP EXCEEDS 20%. THE NEW ASPHALT BINDER IN THE MIX SHALL BE PG 58-22

2: THE CONTRACTOR SHALL PATCH FIRST BEFORE MILLING

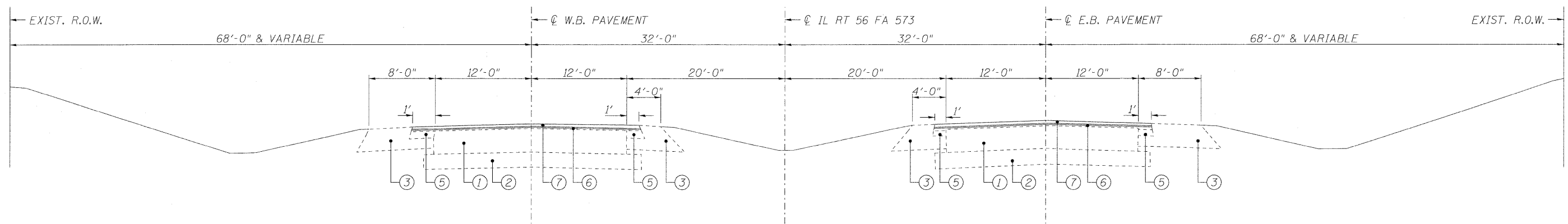

PROPOSED TYPICAL SECTION
 STA. 80+00 TO STA. 166+20
 STA. 204+04 TO STA. 272+20
 (EXCEPT DRYLAND BRIDGE)

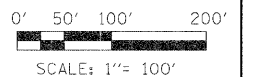

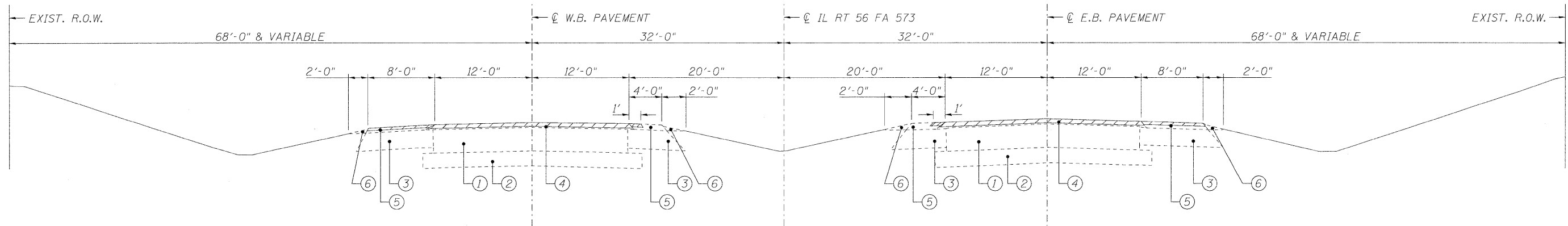

EXISTING SECTION
STA. 166+20 TO STA. 204+04

- ① EXIST. 10" REINFORCED P.C.C. PAVEMENT
- ② EXIST. 6" SUB BASE GRANULAR MATERIAL, TYPE A
- ③ EXIST. AGGREGATE SHOULDER 8"
- ④ EXIST. HMA BINDER COURSE 3-1/4" (REMOVE 2-1/2")
- ⑤ EXIST. HMA SHOULDER 3-1/4" (REMOVE 1-1/2")
- ⑥ EXIST AGGREGATE SHOULDERS, TYPE B
- ⑦ PROP. POLYMERIZED LEVELING BINDER (MACHINE METHOD), N50 (3/4")
- ⑧ PROP. HOT-MIX ASPHALT SURFACE COURSE, MIX "D", N70 (1-3/4")
- ⑨ PROP. HMA SHOULDER (1-1/2")

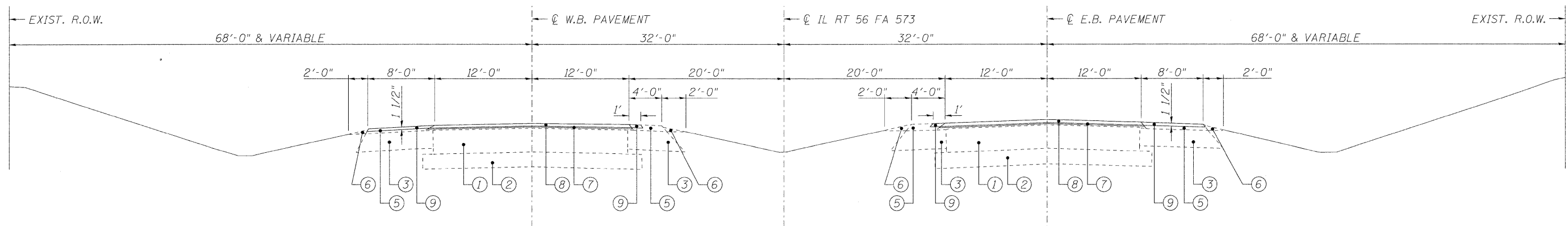

PROPOSED SECTION
STA. 166+20 TO STA. 204+04

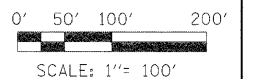

LOXCO INC.
CONSULTING ENGINEERS
1560 WALL ST., SUITE 222
NAPERVILLE, ILLINOIS 60563 PH: 630/577-9100

USER NAME = *USER*	DESIGNED - MJY	REVISED -
	DRAWN - SLV	REVISED -
PLOT SCALE = *SCALE*	CHECKED - MJY	REVISED -
PLOT DATE = *DATE*	DATE - 04/22/2009	REVISED -

**STATE OF ILLINOIS
DEPARTMENT OF TRANSPORTATION**

**EXISTING AND PROPOSED SECTIONS
IL ROUTE 56**

SCALE: 1"=100' SHEET NO. 5 OF 15 SHEETS STA. 80+00 TO STA. 272+00

F.A.I. RTE.	SECTION	COUNTY	TOTAL SHEETS	SHEET NO.
573	61 S-3	KANE	15	5
C-91-530-09		CONTRACT NO. 60G74		
FED. ROAD DIST. NO.		ILLINOIS FED. AID PROJECT		

PLAN NOTES:

1. ALL PAVEMENT PATCHING, COMBINATION CONCRETE CURB AND GUTTER REPLACEMENT, AND DRIVEWAY REMOVAL & REPLACEMENT (1.5 FT), LOCATIONS SHALL BE DETERMINED BY THE ENGINEER IN THE FIELD.
2. IN ADDITION TO FIELD REVIEW AND AERIAL DATA, PLAN DIMENSIONS AND DETAILS RELATIVE TO THE EXISTING FACILITIES HAVE BEEN TAKEN FROM EXISTING PLANS AND ARE SUBJECT TO CONSTRUCTION VARIATIONS. IT SHALL BE THE CONTRACTOR'S RESPONSIBILITY TO VERIFY SUCH DIMENSIONS AND DETAILS IN THE FIELD. SUCH VARIATIONS SHALL NOT BE A CAUSE FOR ADDITIONAL COMPENSATION DUE TO A CHANGE IN THE SCOPE OF THE WORK. HOWEVER, THE CONTRACTOR WILL BE PAID FOR THE QUANTITY ACTUALLY FURNISHED AT THE BID PRICE FOR THE WORK.
3. THE LOCATION AND CONFIGURATION OF ALL EXISTING PAVEMENT MARKINGS, INCLUDING NO PASSING ZONES, WILL BE NOTED PRIOR TO RESURFACING AND REPLACED IN THE SAME LOCATIONS AFTER RESURFACING. COST TO BE INCLUDED IN THE REPLACED PAVEMENT MARKING PAY ITEMS.

LEGEND

 - HMA SURFACE REMOVAL - BUTT JOINT

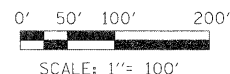
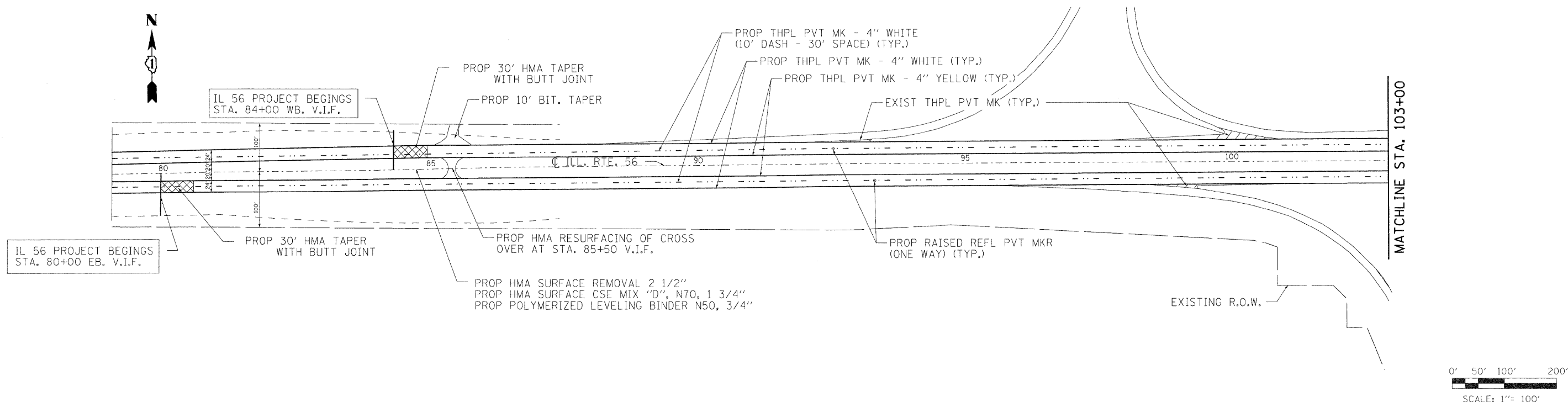

LOCO, INC.
CONSULTING ENGINEERS
1560 WALL ST., SUITE 222
NAPERVILLE, ILLINOIS 60563 PH: (630) 577-9100

USER NAME = #USER#	DESIGNED - MJY	REVISED -
PLOT SCALE = #SCALE#	DRAWN - SLV	REVISED -
PLOT DATE = #DATE#	CHECKED - MJY	REVISED -
	DATE - 04/22/2009	REVISED -

**STATE OF ILLINOIS
DEPARTMENT OF TRANSPORTATION**

**ROADWAY AND PAVEMENT MARKING PLAN
IL ROUTE 56**

SCALE: 1"=100' SHEET NO. 6 OF 15 SHEETS STA. 80+00 TO STA. 103+00

F.A.J. RTE. 573	SECTION 61 S-3	COUNTY KANE	TOTAL SHEETS 15	SHEET NO. 6
C-91-530-09			CONTRACT NO. 60G74	
FED. ROAD DIST. NO. ILLINOIS FED. AID PROJECT				



MATCHLINE STA. 103+00

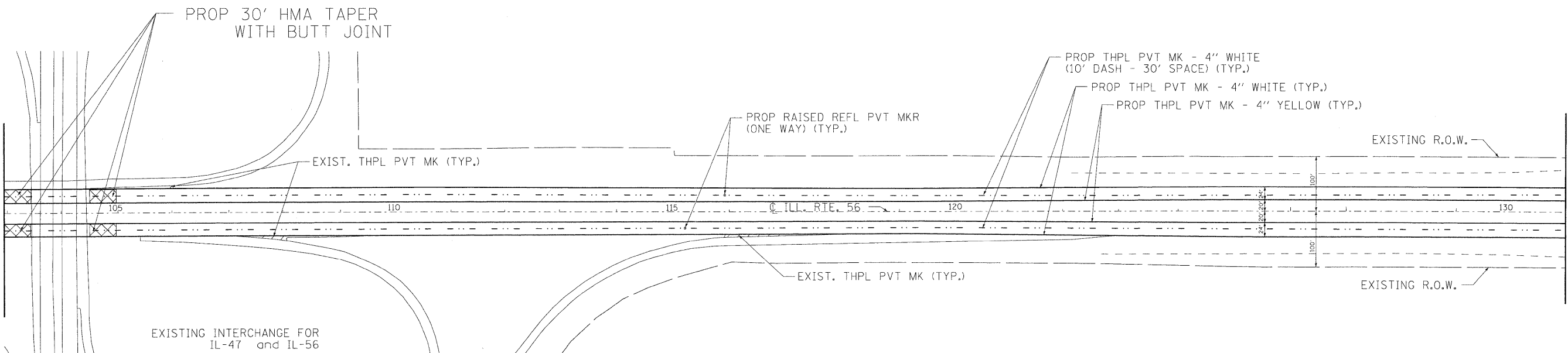

MATCHLINE STA. 131+00

EXISTING INTERCHANGE FOR IL-47 and IL-56

PLAN NOTES:

1. ALL PAVEMENT PATCHING, COMBINATION CONCRETE CURB AND GUTTER REPLACEMENT, AND DRIVEWAY REMOVAL & REPLACEMENT (1.5 FT), LOCATIONS SHALL BE DETERMINED BY THE ENGINEER IN THE FIELD.
2. IN ADDITION TO FIELD REVIEW AND AERIAL DATA, PLAN DIMENSIONS AND DETAILS RELATIVE TO THE EXISTING FACILITIES HAVE BEEN TAKEN FROM EXISTING PLANS AND ARE SUBJECT TO CONSTRUCTION VARIATIONS. IT SHALL BE THE CONTRACTOR'S RESPONSIBILITY TO VERIFY SUCH DEMENSIONS AND DETAILS IN THE FIELD. SUCH VARIATIONS SHALL NOT BE A CAUSE FOR ADDITIONAL COMPENSATION DUE TO A CHANGE IN THE SCOPE OF THE WORK. HOWEVER, THE CONTRACTOR WILL BE PAID FOR THE QUANTITY ACTUALLY FURNISHED AT THE BID PRICE FOR THE WORK.
3. THE LOCATION AND CONFIGURATION OF ALL EXISTING PAVEMENT MARKINGS, INCLUDING NO PASSING ZONES, WILL BE NOTED PRIOR TO RESURFACING AND REPLACED IN THE SAME LOCATIONS AFTER RESURFACING. COST TO BE INCLUDED IN THE REPLACED PAVEMENT MARKING PAY ITEMS.

LEGEND

 HMA SURFACE REMOVAL - BUTT JOINT



MATCHLINE STA. 131+00

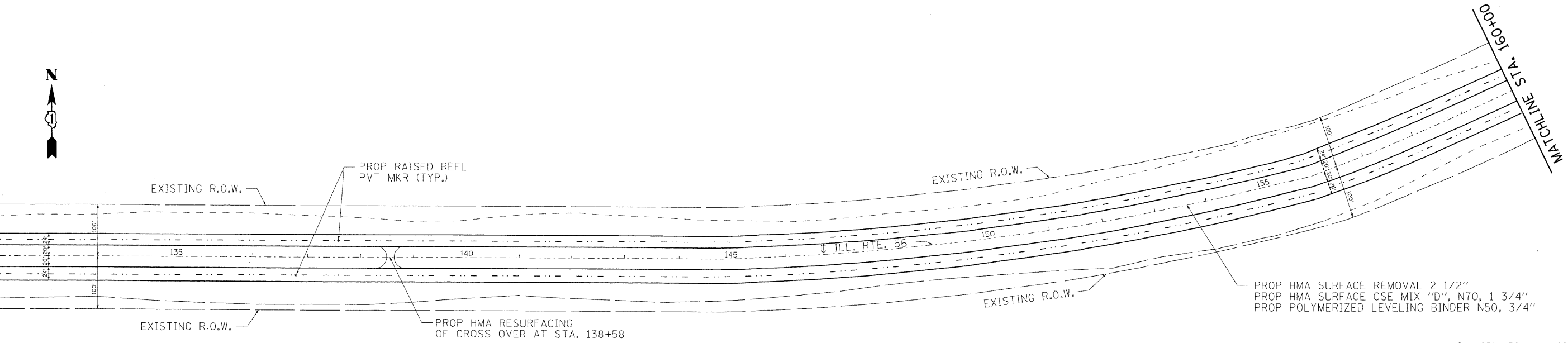

MATCHLINE STA. 160+00

PROPOSED HMA SURFACE REMOVAL 2 1/2"
 PROPOSED HMA SURFACE CSE MIX "D", N70, 1 3/4"
 PROPOSED POLYMERIZED LEVELING BINDER N50, 3/4"

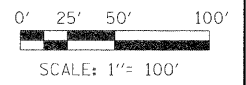

LOCO INC.
 CONSULTING ENGINEERS
 1560 WALL ST., SUITE 222
 NAPERVILLE, ILLINOIS 60563 PH: (630) 577-9100

USER NAME = #USER#	DESIGNED - MJY	REVISED -
PLOT SCALE = #SCALE#	DRAWN - SLV	REVISED -
PLOT DATE = #DATE#	CHECKED - MJY	REVISED -
	DATE - 04/22/2009	REVISED -

**STATE OF ILLINOIS
 DEPARTMENT OF TRANSPORTATION**

**ROADWAY AND PAVEMENT MARKING PLAN
 IL ROUTE 56**

SCALE: 1"=100' SHEET NO. 7 OF 15 SHEETS STA. 103+00 TO STA. 160+00

F.A.I. RTE. 573	SECTION 61 S-3	COUNTY KANE	TOTAL SHEETS 15	SHEET NO. 7
C-91-530-09		CONTRACT NO. 60G74		
FED. ROAD DIST. NO. [ILLINOIS] FED. AID PROJECT				

PLAN NOTES:

1. ALL PAVEMENT PATCHING, COMBINATION CONCRETE CURB AND GUTTER REPLACEMENT, AND DRIVEWAY REMOVAL & REPLACEMENT 1.5 FT, LOCATIONS SHALL BE DETERMINED BY THE ENGINEER IN THE FIELD.
2. IN ADDITION TO FIELD REVIEW AND AERIAL DATA, PLAN DIMENSIONS AND DETAILS RELATIVE TO THE EXISTING FACILITIES HAVE BEEN TAKEN FROM EXISTING PLANS AND ARE SUBJECT TO CONSTRUCTION VARIATIONS. IT SHALL BE THE CONTRACTOR'S RESPONSIBILITY TO VERIFY SUCH DIMENSIONS AND DETAILS IN THE FIELD. SUCH VARIATIONS SHALL NOT BE A CAUSE FOR ADDITIONAL COMPENSATION DUE TO A CHANGE IN THE SCOPE OF THE WORK. HOWEVER, THE CONTRACTOR WILL BE PAID FOR THE QUANTITY ACTUALLY FURNISHED AT THE BID PRICE FOR THE WORK.
3. THE LOCATION AND CONFIGURATION OF ALL EXISTING PAVEMENT MARKINGS, INCLUDING NO PASSING ZONES, WILL BE NOTED PRIOR TO RESURFACING AND REPLACED IN THE SAME LOCATIONS AFTER RESURFACING. COST TO BE INCLUDED IN THE REPLACED PAVEMENT MARKING PAY ITEMS.

LEGEND

 HMA SURFACE REMOVAL - BUTT JOINT

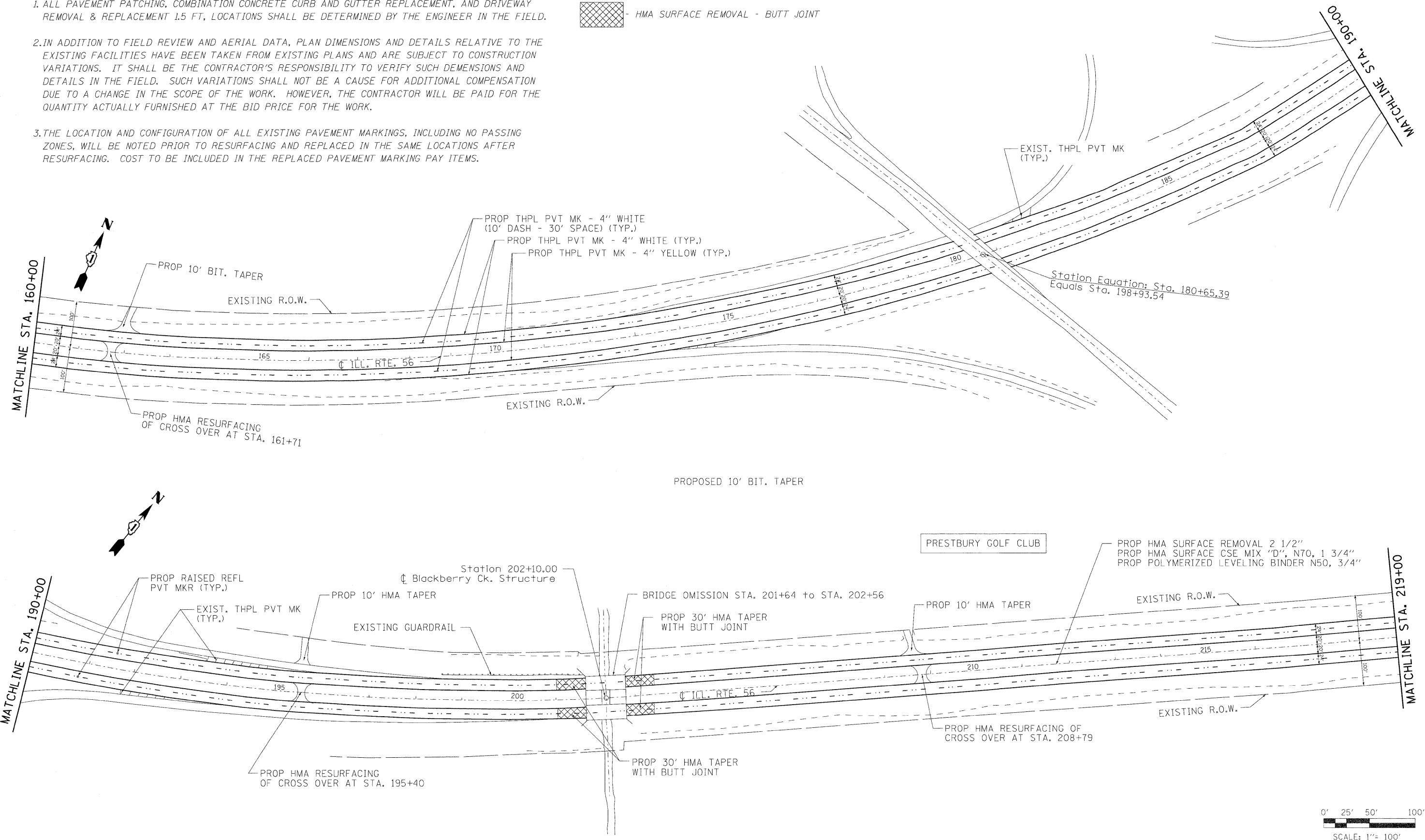

PRESTBURY GOLF CLUB

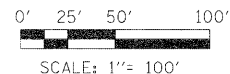

LOCO, INC.
CONSULTING ENGINEERS
1560 WALL ST. SUITE 222
NAPERVILLE, ILLINOIS 60563 PH (630) 577-9100

USER NAME = #USER#	DESIGNED - MJY	REVISED -
PLOT SCALE = #SCALE#	DRAWN - SLV	REVISED -
PLOT DATE = #DATE#	CHECKED - MJY	REVISED -
	DATE - 04/22/2009	REVISED -

**STATE OF ILLINOIS
DEPARTMENT OF TRANSPORTATION**

**ROADWAY AND PAVEMENT MARKING PLAN
IL ROUTE 56**

SCALE: 1"=100' SHEET NO. 8 OF 15 SHEETS STA. 160+00 TO STA. 219+00

F.A.I. RTE. 573	SECTION 61 S-3	COUNTY KANE	TOTAL SHEETS 15	SHEET NO. 8
C-91-530-09			CONTRACT NO. 60G74	
FED. ROAD DIST. NO. ILLINOIS FED. AID PROJECT				

PLAN NOTES:

1. ALL PAVEMENT PATCHING, COMBINATION CONCRETE CURB AND GUTTER REPLACEMENT, AND DRIVEWAY REMOVAL & REPLACEMENT (1.5 FT), LOCATIONS SHALL BE DETERMINED BY THE ENGINEER IN THE FIELD.
2. IN ADDITION TO FIELD REVIEW AND AERIAL DATA, PLAN DIMENSIONS AND DETAILS RELATIVE TO THE EXISTING FACILITIES HAVE BEEN TAKEN FROM EXISTING PLANS AND ARE SUBJECT TO CONSTRUCTION VARIATIONS. IT SHALL BE THE CONTRACTOR'S RESPONSIBILITY TO VERIFY SUCH DEMENSIONS AND DETAILS IN THE FIELD. SUCH VARIATIONS SHALL NOT BE A CAUSE FOR ADDITIONAL COMPENSATION DUE TO A CHANGE IN THE SCOPE OF THE WORK. HOWEVER, THE CONTRACTOR WILL BE PAID FOR THE QUANTITY ACTUALLY FURNISHED AT THE BID PRICE FOR THE WORK.
3. THE LOCATION AND CONFIGURATION OF ALL EXISTING PAVEMENT MARKINGS, INCLUDING NO PASSING ZONES, WILL BE NOTED PRIOR TO RESURFACING AND REPLACED IN THE SAME LOCATIONS AFTER RESURFACING. COST TO BE INCLUDED IN THE REPLACED PAVEMENT MARKING PAY ITEMS.

LEGEND

 - HMA SURFACE REMOVAL - BUTT JOINT

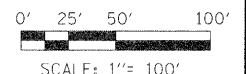
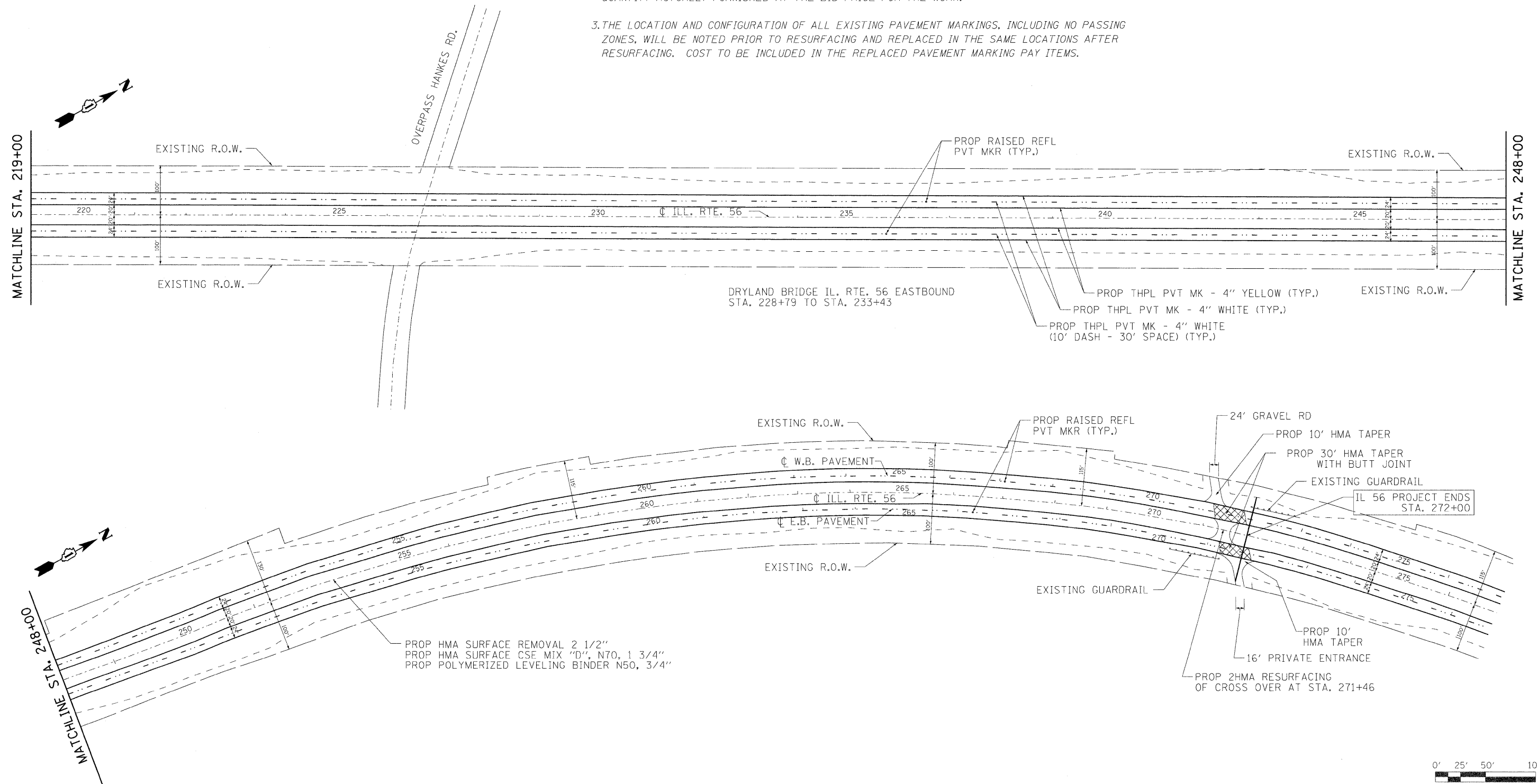

LONGO, INC.
CONSULTING ENGINEERS
1560 WALL ST, SUITE 222
NAPERVILLE, ILLINOIS 60563 PH (630) 577-9100

USER NAME = #USER#	DESIGNED - MJY	REVISED -
PLOT SCALE = #SCALE#	DRAWN - SLV	REVISED -
PLOT DATE = #DATE#	CHECKED - MJY	REVISED -
	DATE - 04/22/2009	REVISED -

**STATE OF ILLINOIS
DEPARTMENT OF TRANSPORTATION**

**ROADWAY AND PAVEMENT MARKING PLAN
ILL ROUTE 56**

SCALE: 1"=100' SHEET NO. 9 OF 15 SHEETS STA. 219+00 TO STA. 272+00

F.A.I. RTE. 573	SECTION 61 S-3	COUNTY KANE	TOTAL SHEETS 15	SHEET NO. 9
C-91-530-09			CONTRACT NO. 60G74	
FED. ROAD DIST. NO. [ILLINOIS] FED. AID PROJECT				

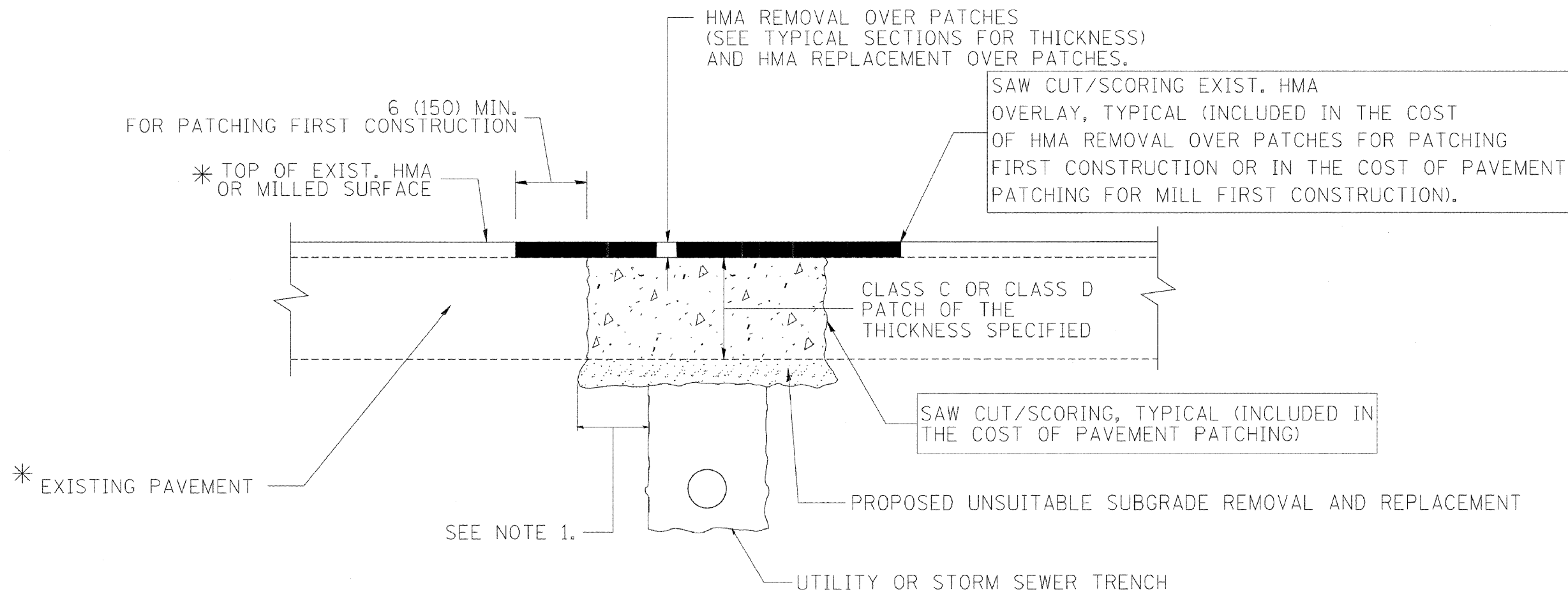

* SEE TYPICAL SECTIONS FOR THICKNESS AND MATERIALS

NOTES:

1. THE WIDTH OF THE FULL DEPTH PATCH OVER A TRENCH SHALL BE 12 (300) WIDER ON EACH SIDE OF THE TRENCH.
2. FOR METHOD OF MEASUREMENT AND BASIS OF PAYMENT, SEE RECURRING SPECIAL PROVISION "PATCHING WITH HOT-MIX ASPHALT OVERLAY REMOVAL".

SEQUENCE OF CONSTRUCTION (PATCHING FIRST)

1. REMOVE THE EXISTING HMA MATERIAL OVER THE AREA TO BE PATCHED.
2. REMOVE AND REPLACE WITH CLASS C OR D PATCH.
3. REPLACE HMA MATERIAL OVER THE AREA TO BE PATCHED.

SEQUENCE OF CONSTRUCTION (MILLING FIRST)

1. MILL HMA FIRST IF THERE IS AT LEAST 4 1/2 INCHES OR MORE OF HMA MATERIAL ON TOP OF THE EXISTING PAVEMENT OR IF THE PAVEMENT IS FULL DEPTH HMA. A MINIMUM OF 2 INCHES OF HMA MATERIAL SHALL BE IN PLACE AFTER MILLING.
2. REMOVE AND REPLACE WITH FULL DEPTH CLASS D PATCHES TO TOP OF MILLED SURFACE.

ALL DIMENSIONS ARE IN INCHES (MILLIMETERS) UNLESS OTHERWISE SHOWN.

PAVEMENT PATCHING FOR HMA SURFACED PAVEMENT

<p>CONSULTING ENGINEERS 1970 N. MILL ST., SUITE 210 NAPERVILLE, ILLINOIS 60563 PH 630/577-9100</p>	USER NAME = \$USER\$	DESIGNED - MJY	REVISED -	STATE OF ILLINOIS DEPARTMENT OF TRANSPORTATION	INDEX OF SHEETS, STATE STANDARDS, AND GENERAL NOTES IL ROUTE 56			F.A.P. RTE.	SECTION	COUNTY	TOTAL SHEETS	SHEET NO.
	PLOT SCALE = \$SCALE\$	DRAWN - SLV	REVISED -					573	61 S-3	KANE	15	10
PLOT DATE = \$DATE\$	CHECKED - MJY	REVISED -			C-91-530-09			CONTRACT NO. 60G74				
DATE - 04/22/2009	REVISED -				SCALE: NONE	SHEET NO. 10 OF 15 SHEETS	STA. 80+00 TO STA. 272+00	FED. ROAD DIST. NO.	ILLINOIS FED. AID PROJECT			

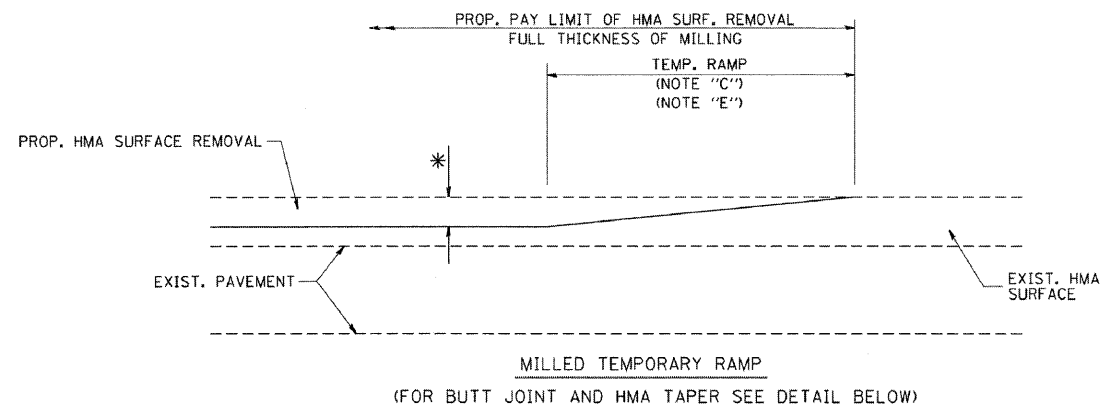

OPTION 1

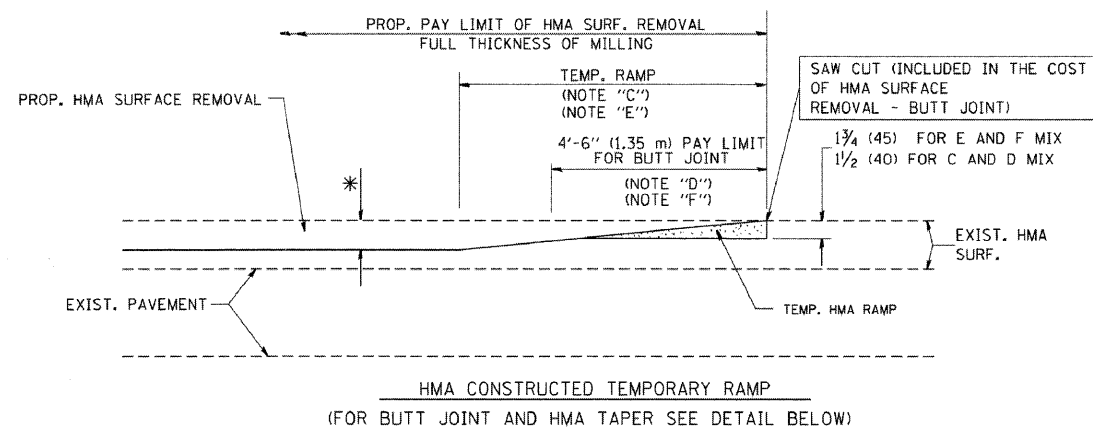

OPTION 2

TYPICAL TEMPORARY RAMP

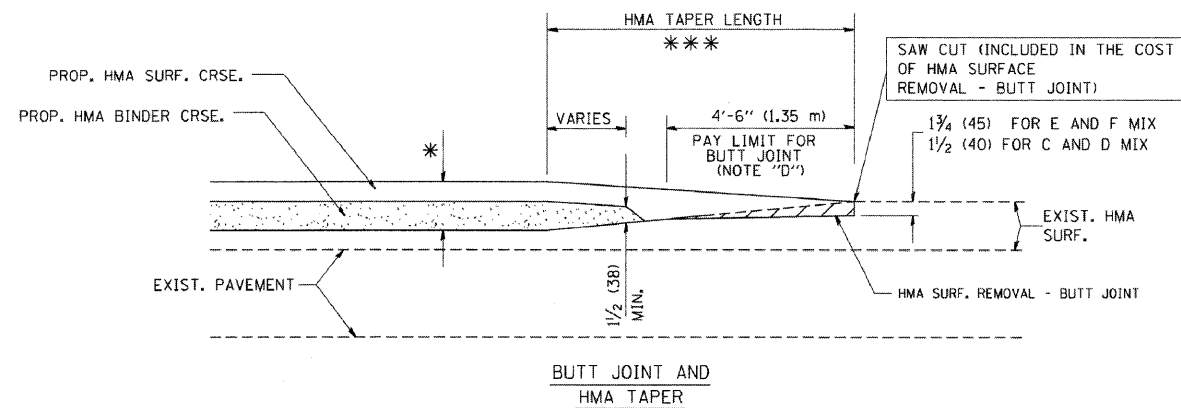

TYPICAL BUTT JOINT AND HMA TAPER FOR MILLING AND RESURFACING

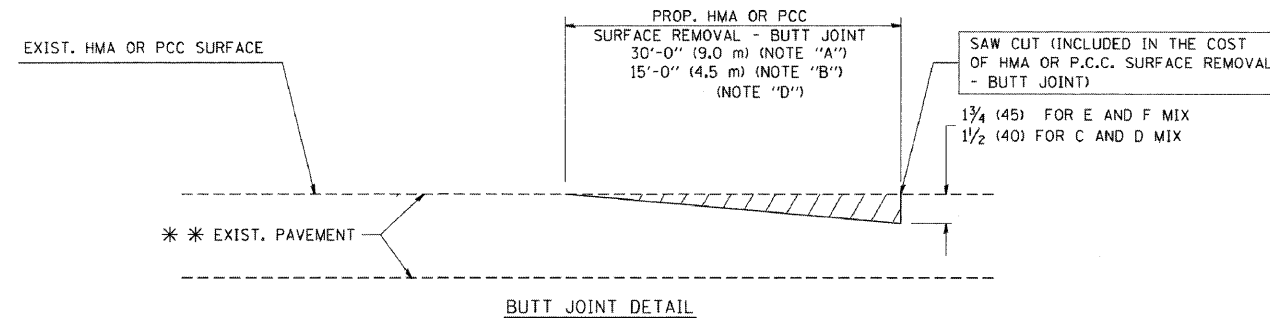

BUTT JOINT DETAIL

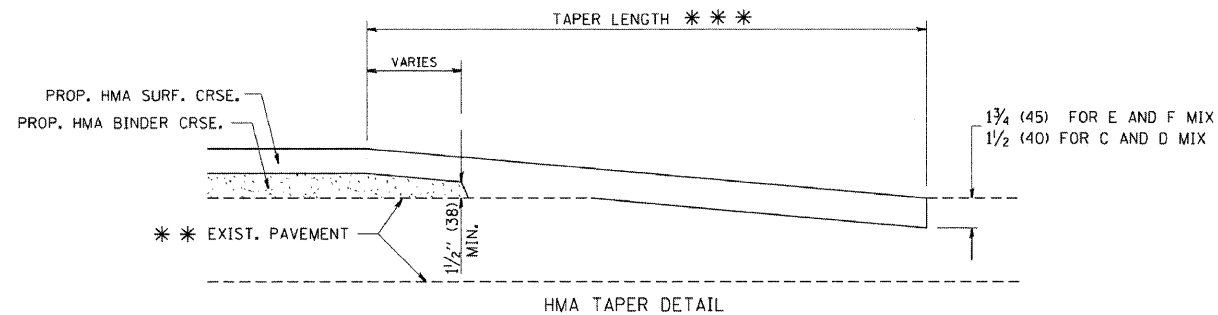

HMA TAPER DETAIL

TYPICAL BUTT JOINT AND HMA TAPER FOR RESURFACING ONLY

*** PC CONCRETE, HMA OR HMA RESURFACED PAVEMENT.

NOTES

- A: MAINLINE ROADWAYS AND MAJOR SIDE ROADS.
- B: MINOR SIDE ROADS.
- C: THE TEMP. RAMP SHALL BE CONSTRUCTED IMMEDIATELY UPON REMOVAL OF THE EXISTING HMA SURFACE.
- D: THE BUTT JOINT SHALL BE CONSTRUCTED IMMEDIATELY PRIOR TO PLACING THE PROPOSED HMA COURSES.
- E: TAPER THE TEMP. RAMP AT A RATE OF 3'-0" (900 mm) PER 1 INCH (25 mm) OF MILLING THICKNESS.
- F: INSTALLATION AND REMOVAL OF THE 4'-6" (1.35 m) TEMP. RAMP IS INCLUDED IN COST OF HMA SURFACE REMOVAL - BUTT JOINT
- G: SEE ARTICLE 406.08 AND 406.14 OF THE STANDARD SPECIFICATIONS FOR "HMA AND/OR PCC SURFACE REMOVAL, BUTT JOINT".
- * SEE TYPICAL SECTIONS FOR MILLING THICKNESS.
- *** 20'-0" (6.1 m) PER 1 (25) RESURFACING (NOTE "A")
10'-0" (3.0 m) PER 1 (25) RESURFACING (NOTE "B")

ALL DIMENSIONS ARE IN INCHES (MILLIMETERS) UNLESS OTHERWISE SHOWN.

BASIS OF PAYMENT:

THE BUTT JOINT WILL BE PAID FOR AT THE CONTRACT UNIT PRICE PER SQUARE YARD (SQUARE METER) FOR "HOT-MIX ASPHALT SURFACE REMOVAL - BUTT JOINT" OR FOR "PORTLAND CEMENT CONCRETE SURFACE REMOVAL - BUTT JOINT".

BUTT JOINT AND HMA TAPER DETAILS

USER NAME = #USER#	DESIGNED - MJY	REVISED -
PLOT SCALE = #SCALE#	DRAWN - SLV	REVISED -
PLOT DATE = #DATE#	CHECKED - MJY	REVISED -
	DATE - 04/22/2009	REVISED -

F.A.P. RTE.	SECTION	COUNTY	TOTAL SHEETS	SHEET NO.
573	61 S-3	KANE	15	11
C-91-530-09			CONTRACT NO. 60G74	
FED. ROAD DIST. NO.		ILLINOIS FED. AID PROJECT		

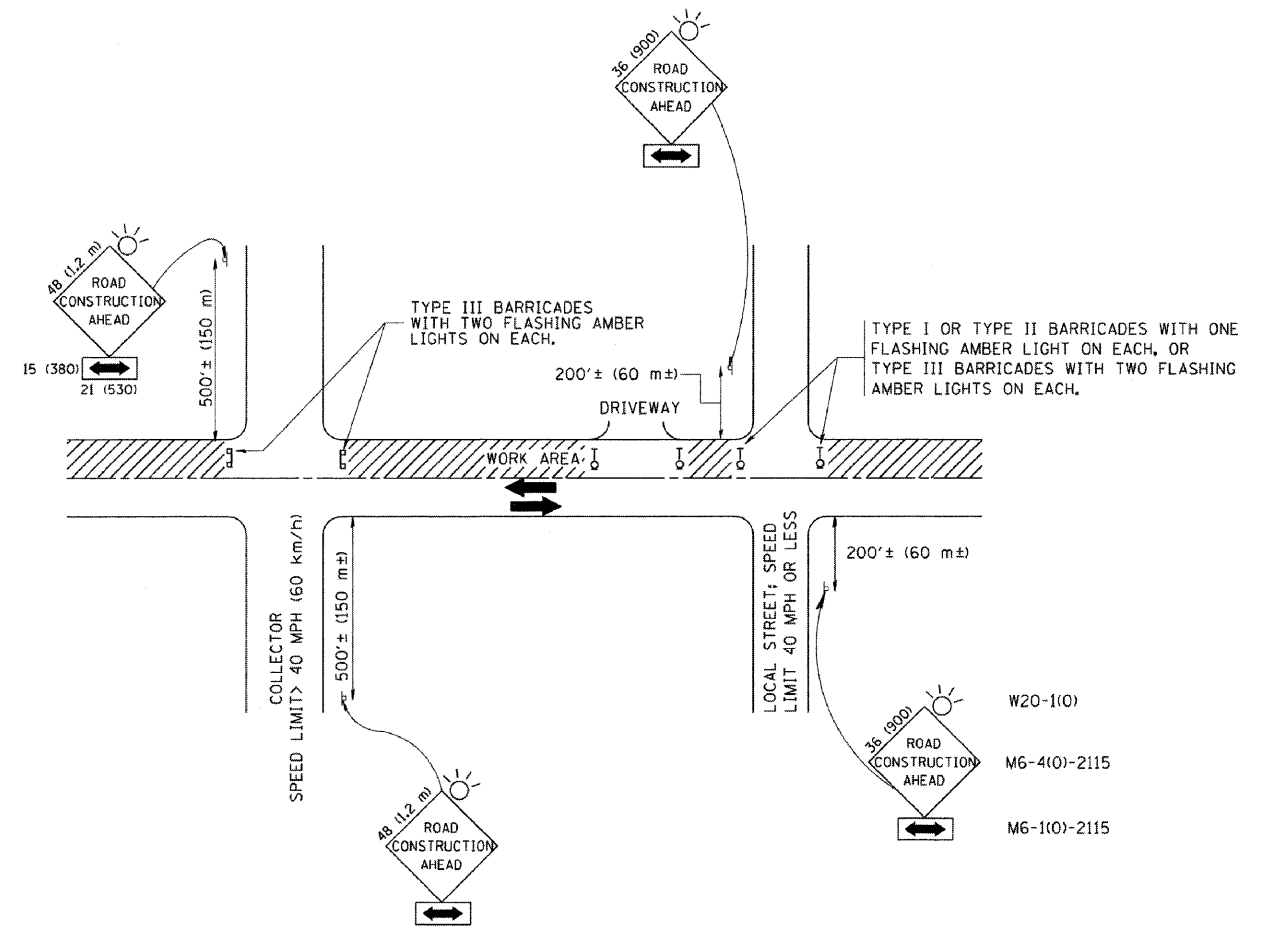

NOTES:

- A. FOR NO LANE RESTRICTION ON THE SIDE ROAD OR DRIVEWAYS**
- SIDE ROAD WITH A SPEED LIMIT OF 40 MPH (60 km/h) OR LESS AS SHOWN ON THE DRAWING AND AS DIRECTED BY THE ENGINEER:
 - ONE ROAD CONSTRUCTION AHEAD SIGN 36 x 36 (900x900) WITH A FLASHER AND FLAG MOUNTED ON IT APPROXIMATELY 200' (60 m) IN ADVANCE OF THE MAIN ROUTE.
 - THE CLOSED PORTION OF THE MAIN ROUTE SHALL BE PROTECTED BY BLOCKING WITH TYPE I, TYPE II OR TYPE III BARRICADES, 1/3 OF THE CROSS SECTION OF THE CLOSED PORTION.
 - SIDE ROAD WITH A SPEED LIMIT GREATER THAN 40 MPH (60 km/h) AS SHOWN ON THE DRAWING AND AS DIRECTED BY THE ENGINEER:
 - ONE ROAD CONSTRUCTION AHEAD SIGN 48 x 48 (1.2 m x 1.2 m) WITH A FLASHER MOUNTED ON IT APPROXIMATELY 500' (150 m) IN ADVANCE OF THE MAIN ROUTE.
 - THE CLOSED PORTION OF THE MAIN ROUTE SHALL BE PROTECTED BY BLOCKING WITH TYPE III BARRICADES, 1/2 OF THE CROSS SECTION OF THE CLOSED PORTION.
- B. FOR A LANE CLOSURE ON A SIDE ROAD OR DRIVEWAY:**
- USE APPLICABLE PORTIONS OF THE TYPICAL APPLICATION OF TRAFFIC CONTROL DEVICES (STD. 70150), STD. 701606 OR THE APPROPRIATE STANDARD). THE SPACING OF SIGNS AND BARRICADES SHALL BE ADJUSTED FOR FIELD CONDITIONS AS DIRECTED BY THE ENGINEER. THE DIRECTIONAL ARROW SHALL BE COVERED OR REMOVED WHEN NO LONGER CONSISTENT WITH THE SIDE ROAD LANE CLOSURE.
- C. ADVANCE WARNING SIGNS ARE TO BE OMITTED ON DRIVEWAY UNLESS OTHERWISE NOTED.**
- D. THE TRAFFIC CONTROL AND PROTECTION FOR SIDE ROADS, INTERSECTIONS, AND DRIVEWAYS SHALL BE INCIDENTAL TO THE COST OF SPECIFIED TRAFFIC CONTROL STANDARDS OR ITEMS.**

All dimensions are in millimeters (inches) unless otherwise shown.

TRAFFIC CONTROL AND PROTECTION FOR SIDE ROADS, INTERSECTIONS, AND DRIVEWAYS

USER NAME = #USER#	DESIGNED - MJY	REVISED -
	DRAWN - SLV	REVISED -
PLOT SCALE = #SCALE#	CHECKED - MJY	REVISED -
PLOT DATE = #DATE#	DATE - 04/22/2009	REVISED -

F.A.P. RTE.	SECTION	COUNTY	TOTAL SHEETS	SHEET NO.
573	61 S-3	KANE	15	12
C-91-530-09			CONTRACT NO. 60G74	
FED. ROAD DIST. NO. ILLINOIS FED. AID PROJECT				

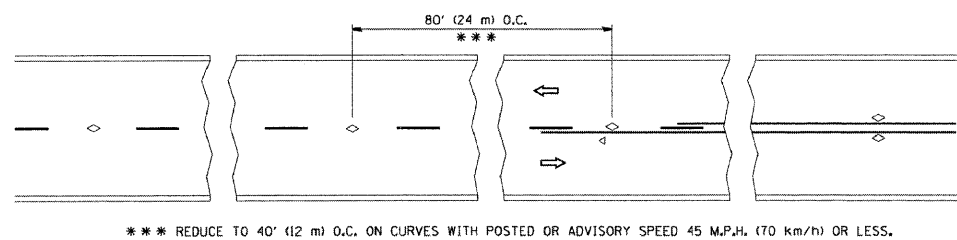

TWO-LANE/TWO-WAY

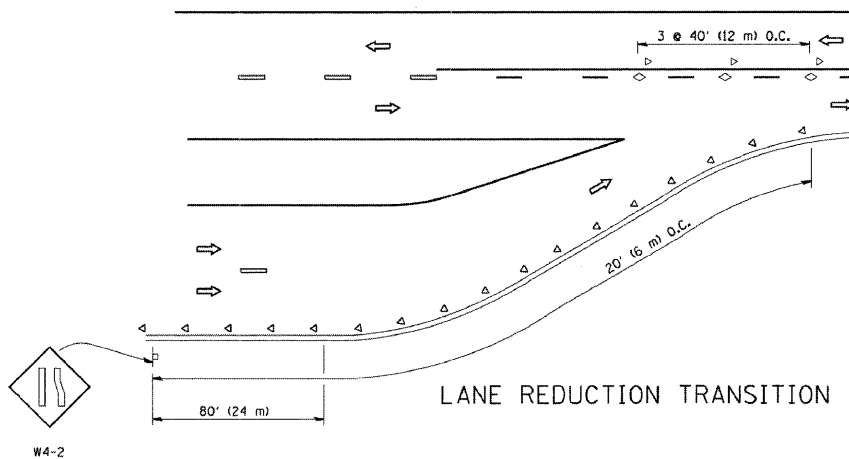

LANE REDUCTION TRANSITION

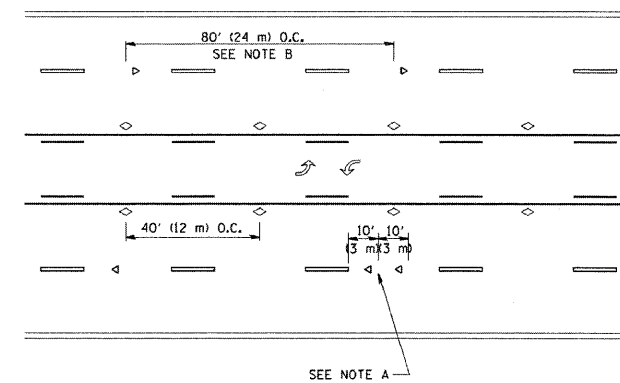

TWO-WAY LEFT TURN

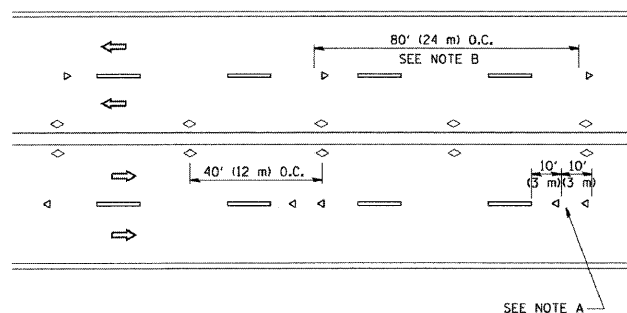

MULTI-LANE/UNDIVIDED

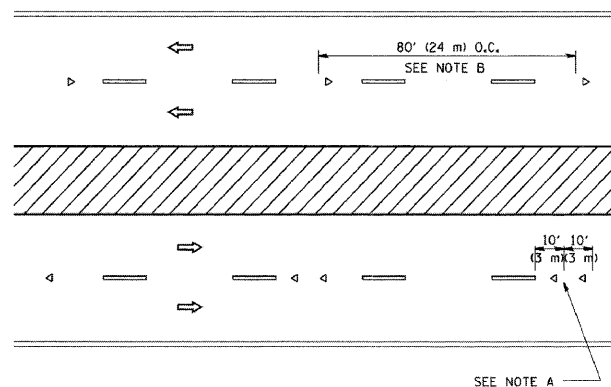

MULTI-LANE/DIVIDED

GENERAL NOTES

1. MARKERS USED WITH DASHED LINES SHALL BE CENTERED IN THE GAP BETWEEN SEGMENTS.
2. MARKERS USED ADJACENT TO SOLID LINES SHALL BE OFFSET 2 TO 3 (50 TO 75) TOWARD TRAFFIC AS SHOWN.
3. MARKERS THROUGH TANGENTS LESS THAN 500' (150 m) IN LENGTH BETWEEN CURVES SHALL BE INSTALLED AT THE LESSER OF THE TWO CURVE SPACINGS.

SYMBOLS

- YELLOW STRIPE
- WHITE STRIPE
- ◁ ONE-WAY AMBER MARKER
- ◁ ONE-WAY CRYSTAL MARKER (W/O)
- ◊ TWO-WAY AMBER MARKER

LANE MARKER NOTES

- A. USE DOUBLE LANE LINE MARKERS SPACED AS SHOWN.
- B. REDUCE TO 40' (12 m) O.C. ON CURVES WHERE ADVISORY SPEEDS ARE 10 M.P.H (20 km/h) LOWER THAN POSTED SPEEDS.

DESIGN NOTES

1. DOUBLE LANE LINE MARKERS SHALL BE USED UNLESS SPECIFIED OTHERWISE.
2. EXCEPT AS SHOWN ON THE LANE REDUCTION TRANSITION AND FREEWAY EXIT RAMP DETAIL, MARKERS ARE NOT TO BE SPECIFIED ON RIGHT EDGE LINES.
3. THE EXACT MARKER LIMITS, SPACING, AND COLOR SHOULD BE INCLUDED IN THE PLANS.
4. MARKERS SHOULD NOT BE USED ALONGSIDE CURBS EXCEPT FOR EXTREMELY SHORT SECTIONS OF CURBS WHERE NOT MORE THAN TWO MARKERS WOULD BE INVOLVED.

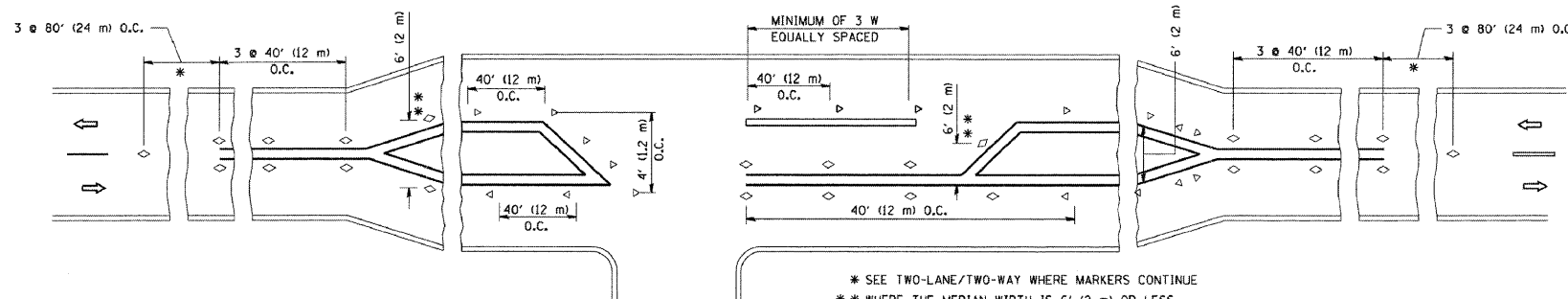

LEFT TURN

TYPICAL APPLICATIONS RAISED REFLECTIVE PAVEMENT MARKERS (SNOW-PLOW RESISTANT)

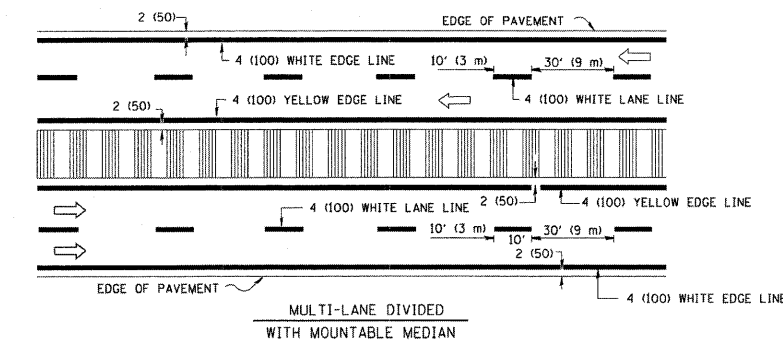
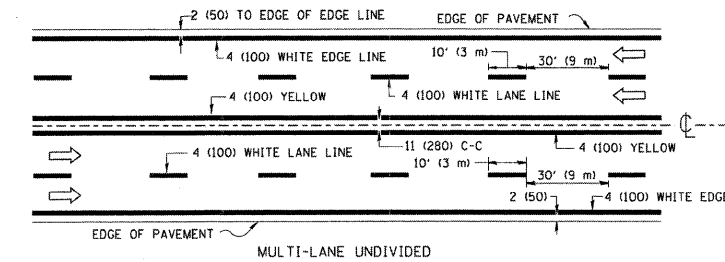
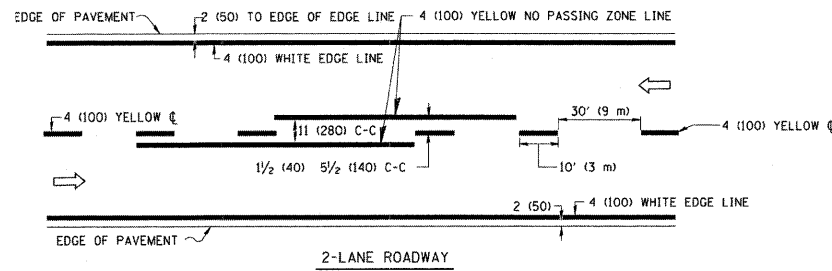

NOTE: MEDIANS WITH BARRIER CURB DO NOT REQUIRE AN EDGE LINE

TYPICAL LANE AND EDGE LINE MARKING

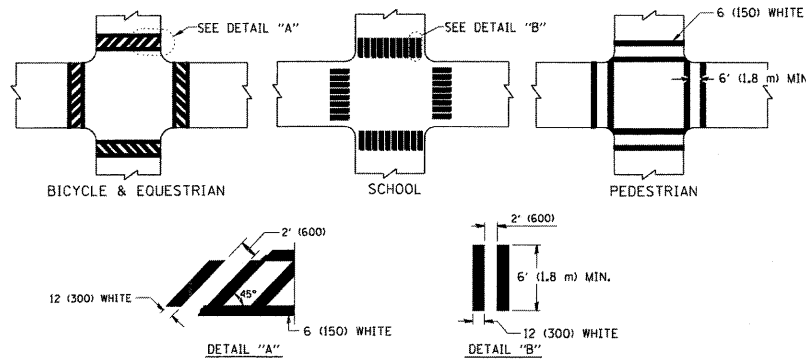

TYPICAL CROSSWALK MARKING

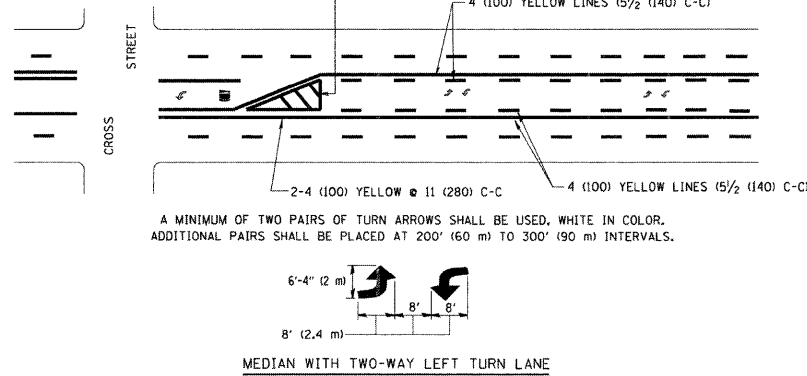
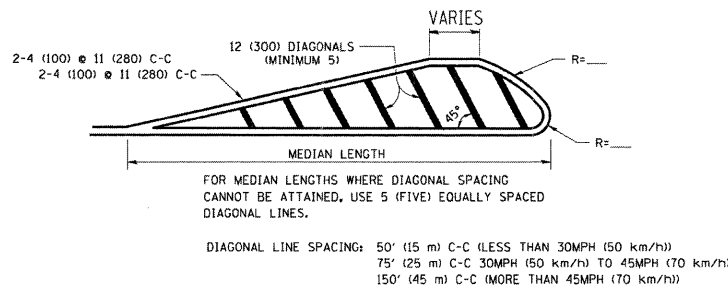
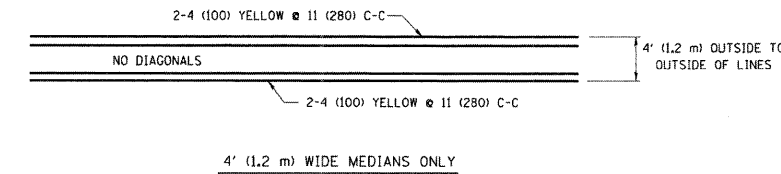

TYPICAL PAINTED MEDIAN MARKING

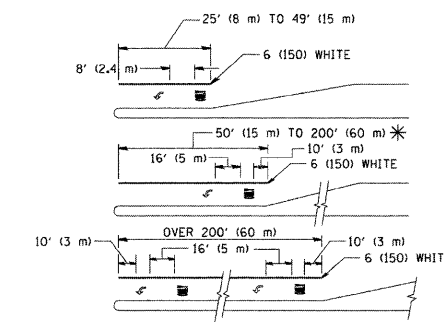

FULL SIZE LETTERS 8' (2.4 m) AND ARROWS SHALL BE USED.
 AREA = 15.6 SQ. FT. (1.5 m²) ONLY AREA = 20.8 SQ. FT. (1.9 m²)
 * TURN LANES IN EXCESS OF 400' (120 m) IN LENGTH MAY HAVE AN ADDITIONAL SET OF ARROW - "ONLY" INSTALLED MIDWAY BETWEEN THE OTHER TWO SETS OF ARROW - "ONLY".

TYPICAL LEFT (OR RIGHT) TURN LANE

TYPICAL TURN LANE MARKING

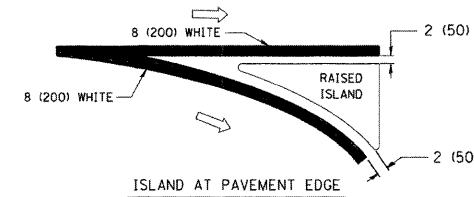
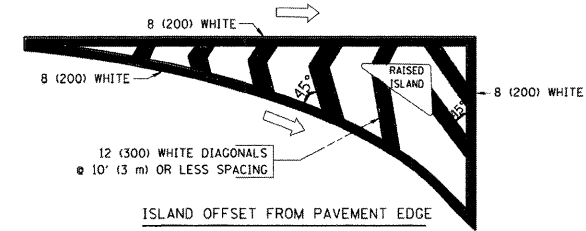

TYPICAL ISLAND MARKING

TYPE OF MARKING	WIDTH OF LINE	PATTERN	COLOR	SPACING / REMARKS
CENTERLINE ON 2 LANE PAVEMENT	4 (100)	SKIP-DASH	YELLOW	10' (3 m) LINE WITH 30' (9 m) SPACE
CENTERLINE ON MULTI-LANE UNDIVIDED PAVEMENT	2 @ 4 (100)	SOLID	YELLOW	11 (280) C-C
NO PASSING ZONE LINES FOR ONE DIRECTION FOR BOTH DIRECTIONS	4 (100) 2 @ 4 (100)	SOLID SOLID	YELLOW YELLOW	5/2 (140) C-C FROM SKIP-DASH CENTERLINE 11 (280) C-C OMIT SKIP-DASH CENTERLINE BETWEEN
LANE LINES	4 (100) 5 (125) ON FREEWAYS	SKIP-DASH SKIP-DASH	WHITE WHITE	10' (3 m) LINE WITH 30' (9 m) SPACE
DOTTED LINES (EXTENSIONS OF CENTER, LANE OR TURN LANE MARKINGS)	SAME AS LINE BEING EXTENDED	SKIP-DASH	SAME AS LINE BEING EXTENDED	2' (600) LINE WITH 6' (1.8 m) SPACE
EDGE LINES	4 (100)	SOLID	YELLOW-LEFT WHITE-RIGHT	OUTLINE MOUNTABLE MEDIANS IN YELLOW; EDGE LINES ARE NOT USED NEXT TO BARRIER CURB
TURN LANE MARKINGS	6 (150) LINE; FULL SIZE LETTERS & SYMBOLS (8' (2.4m))	SOLID	WHITE	SEE TYPICAL TURN LANE MARKING DETAIL
TWO WAY LEFT TURN MARKING	2 @ 4 (100) EACH DIRECTION 8' (2.4m) LEFT ARROW	SKIP-DASH AND SOLID IN PAIRS	YELLOW WHITE	10' (3 m) LINE WITH 30' (9 m) SPACE FOR SKIP-DASH; 5/2 (140) C-C BETWEEN SOLID LINE AND SKIP-DASH LINE SEE TYPICAL TWO-WAY LEFT TURN MARKING DETAIL
CROSSWALK LINES (PEDESTRIAN) A. DIAGONALS (BIKE & EQUESTRIAN) B. LONGITUDINAL BARS (SCHOOL)	2 @ 6 (150) 12 (300) @ 45° 12 (300) @ 90°	SOLID SOLID SOLID	WHITE WHITE WHITE	NOT LESS THAN 6' (1.8 m) APART 2' (600) APART SEE TYPICAL CROSSWALK MARKING DETAILS.
STOP LINES	24 (600)	SOLID	WHITE	PLACE 4' (1.2 m) IN ADVANCE OF AND PARALLEL TO CROSSWALK, IF PRESENT. OTHERWISE, PLACE AT DESIRED STOPPING POINT, PARALLEL TO CROSSROAD CENTERLINE, WHERE POSSIBLE
PAINTED MEDIANS	2 @ 4 (100) WITH 12 (300) DIAGONALS @ 45° NO DIAGONALS USED FOR 4' (1.2 m) WIDE MEDIANS	SOLID	YELLOW; TWO WAY TRAFFIC WHITE; ONE WAY TRAFFIC	11 (280) C-C FOR THE DOUBLE LINE SEE TYPICAL PAINTED MEDIAN MARKING.
GORE MARKING AND CHANNELIZING LINES	8 (200) WITH 12 (300) DIAGONALS @ 45°	SOLID	WHITE	DIAGONALS: 15' (4.5 m) C-C (LESS THAN 30MPH (50 km/h)) 20' (6 m) C-C 30MPH (50 km/h) TO 45MPH (70 km/h) 30' (9 m) C-C (OVER 45MPH (70 km/h))
RAILROAD CROSSING	24 (600) TRANSVERSE LINES; "RR" IS 6' (1.8 m) LETTERS; 16 (400) LINE FOR "X"	SOLID	WHITE	SEE STATE STANDARD 780001 AREA OF: "R"=3.6 SQ. FT. (0.33 m ²) EACH "X"=54.0 SQ. FT. (5.0 m ²)
SHOULDER DIAGONALS	12 (300) @ 45°	SOLID	WHITE - RIGHT YELLOW - LEFT	50' (15 m) C-C (LESS THAN 30MPH (50 km/h)) 75' (25 m) C-C (30 MPH (50 km/h) TO 45MPH (70 km/h)) 150' (45 m) C-C (OVER 45MPH (70 km/h))

FOR FURTHER DETAILS ON PAVEMENT MARKING REFER TO STANDARD SPECIFICATIONS FOR ROAD AND BRIDGE CONSTRUCTION AND STATE STANDARD 78000L

All dimensions are in inches (millimeters) unless otherwise shown.

DISTRICT ONE TYPICAL PAVEMENT MARKINGS

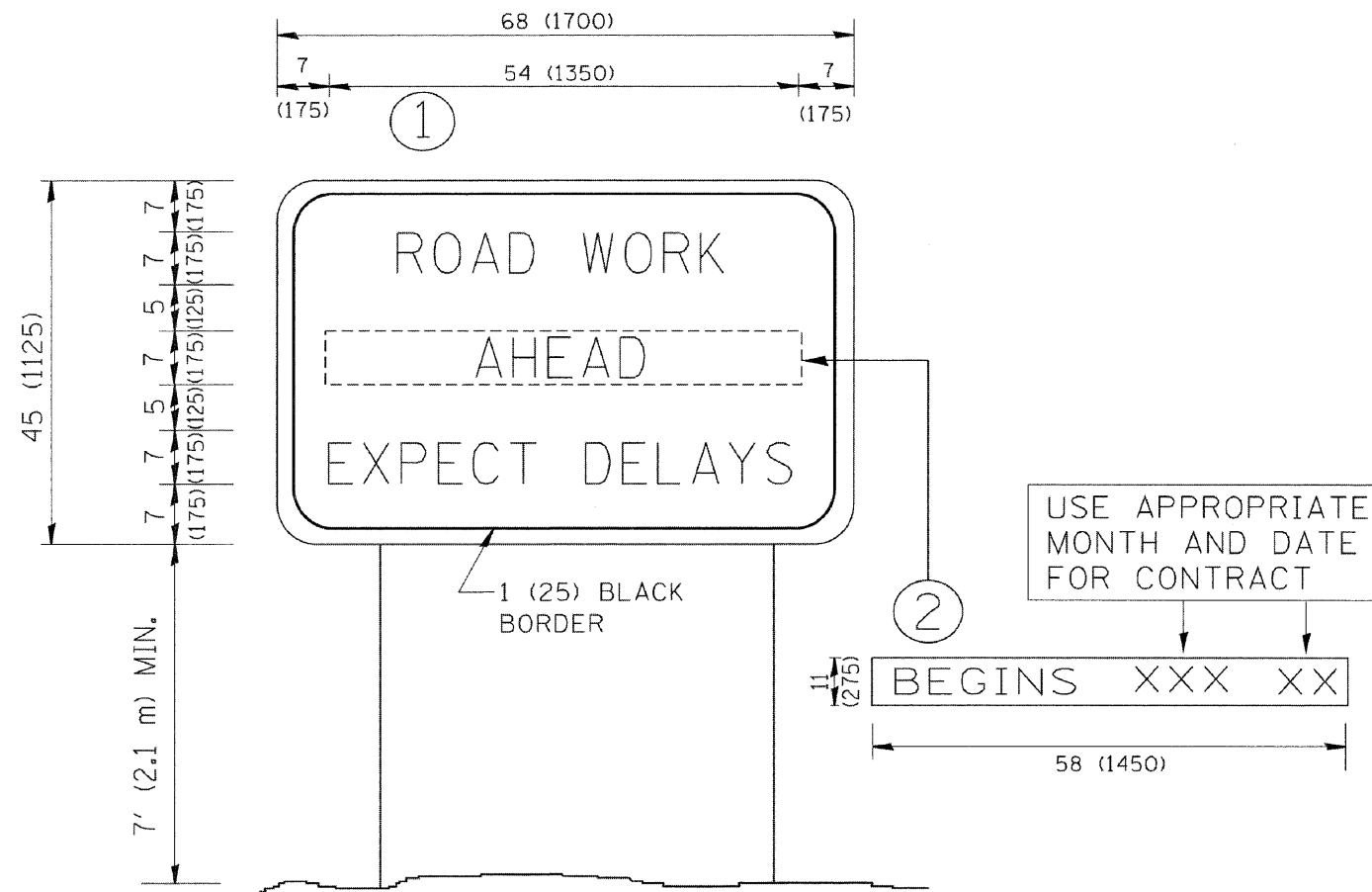

NOTES:

1. USE BLACK LETTERING ON ORANGE BACKGROUND.
2. ERECT SIGNS IN ADVANCE OF THE LOCATION FOR THE "ROAD CONSTRUCTION AHEAD" SIGN AT LOCATIONS AS DIRECTED BY THE ENGINEER.
3. ERECT SIGN ① WITH INSTALLED PANEL ② ONE WEEK PRIOR TO THE START OF CONSTRUCTION.
4. REMOVE PANEL ② SOON AFTER THE START OF CONSTRUCTION.
5. SEE SPECIAL PROVISION FOR "TEMPORARY INFORMATION SIGNING" FOR ADDITIONAL INFORMATION.
6. ONE SIGN ASSEMBLY EQUALS 25.70 SQ. FT. (2.3 SQ. M.)
7. SHALL BE PAID FOR AS TEMPORARY INFORMATION SIGNING.

ALL DIMENSIONS ARE IN INCHES (MILLIMETERS) UNLESS OTHERWISE SHOWN.

ARTERIAL ROAD INFORMATION SIGN

USER NAME = #USER#	DESIGNED - MJY	REVISED -
	DRAWN - SLV	REVISED -
PLOT SCALE = #SCALE#	CHECKED - MJY	REVISED -
PLOT DATE = #DATE#	DATE - 04/22/2009	REVISED -

F.A.P. RTE. 573	SECTION 61 S-3	COUNTY KANE	TOTAL SHEETS 15	SHEET NO. 15
C-91-530-09		CONTRACT NO. 60G74		
FED. ROAD DIST. NO. [ILLINOIS] FED. AID PROJECT				