

TYPICAL ENTRANCE/EXIT RAMP COMBINATION PAVEMENT MARKINGS

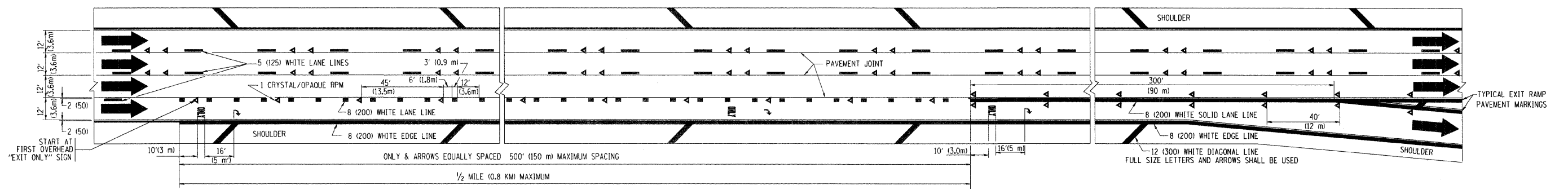

TYPICAL EXIT ONLY LANE PAVEMENT MARKINGS

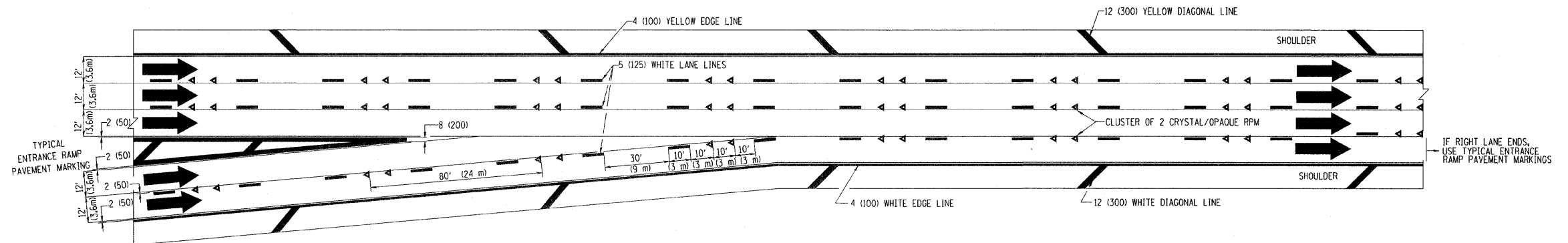

TYPICAL TWO LANE ENTRANCE RAMP PAVEMENT MARKINGS

FILE NAME = W:\diststd\22x34\td12.dgn	USER NAME = geglianob	DESIGNED - D.W.S.	REVISED - A.H. 03-96	STATE OF ILLINOIS DEPARTMENT OF TRANSPORTATION	MULTI-LANE FREEWAY PAVEMENT MARKING DETAILS			F.A.P. RTE. 541	SECTION (X-R & T-13-A) RS-1	COUNTY LAKE	TOTAL SHEETS 29	SHEET NO. 24
	PLOT SCALE = 50,000' / IN.	CHECKED -	REVISED - J.A.F. 02-06					TC-12				CONTRACT NO. 60G78
	PLOT DATE = 1/4/2008	DATE - 01-90	REVISED - S.P.B. 01-07					FED. ROAD DIST. NO. 1 ILLINOIS FED. AID PROJECT				
					SCALE: NONE	SHEET NO. 2 OF 2 SHEETS	STA.	TO STA.				