

QUANTITY  
 4 (100) LINE = 64.1 ft. (19.7 m)  
 21.1 sq. ft. (1.97 sq. m)

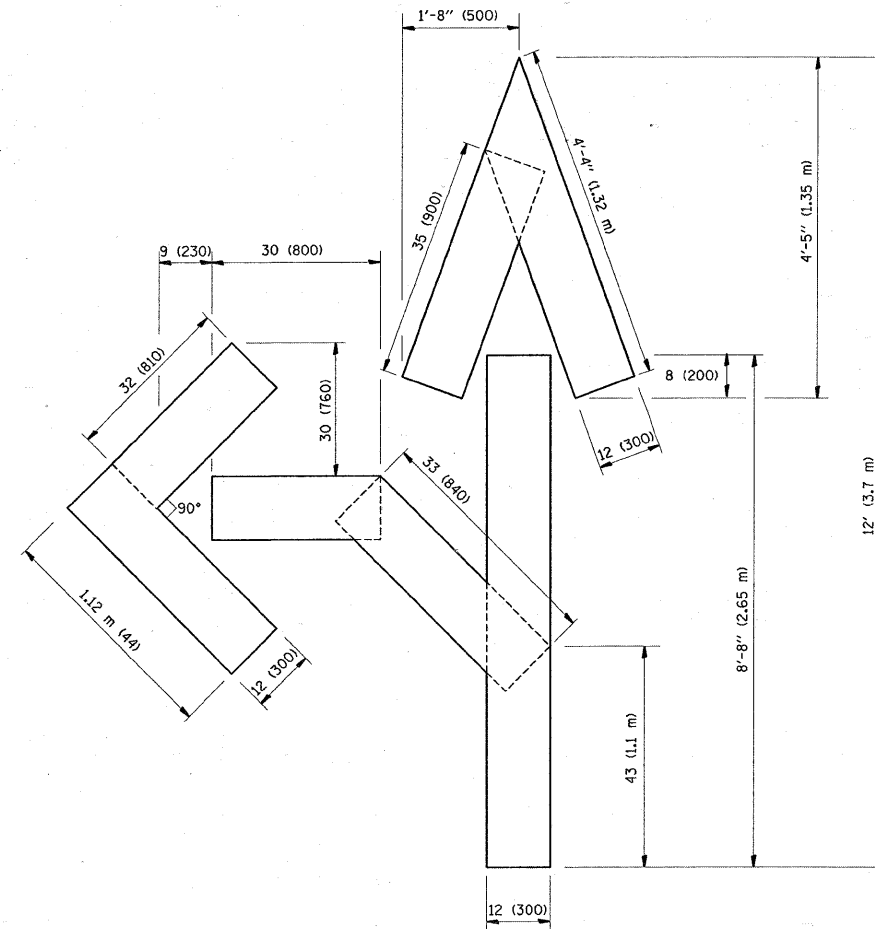

QUANTITY  
 4 (100) LINE = 82.5 ft. (25.3 m)  
 27.5 sq. ft. (2.53 sq. m)

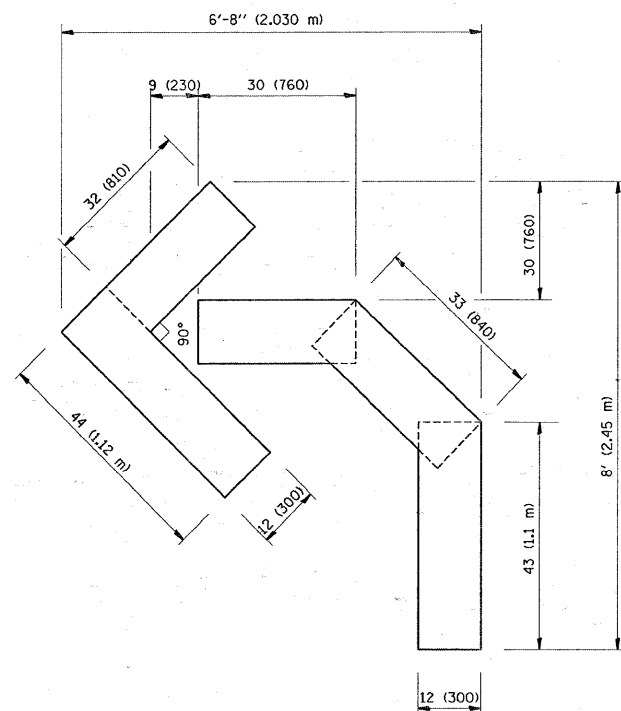

QUANTITY  
 4 (100) LINE = 45.5 ft. (13.9 m)  
 15.2 sq. ft. (1.39 sq. m)

All dimensions are in Inches (millimeters) unless otherwise shown.

|  |                    |                 |                                |
|--|--------------------|-----------------|--------------------------------|
| FILE NAME =                                  | USER NAME = mossse | DESIGNED -      | REVISED -T. RAMMACHER 06-05-96 |
| ce:\pwwork\VPW\DOT\MOSSSE\d0137443\01st5.dgn |                    | DRAWN -         | REVISED -T. RAMMACHER 11-04-97 |
| PLOT SCALE = 50.0000' / IN.                  |                    | CHECKED -       | REVISED -T. RAMMACHER 03-02-98 |
| PLOT DATE = 4/22/2009                        |                    | DATE - 09-18-94 | REVISED -E. GOMEZ 08-28-00     |

STATE OF ILLINOIS  
 DEPARTMENT OF TRANSPORTATION

PAVEMENT MARKING LETTERS AND SYMBOLS  
 FOR TRAFFIC STAGING

SCALE: NONE SHEET NO. 1 OF 1 SHEETS STA. TO STA.

| F.A.I. RTE.                                     | SECTION      | COUNTY | TOTAL SHEETS       | SHEET NO. |
|---|--------------|--------|--------------------|-----------|
| 55  | 99-2AC-IRS-1 | WILL   | 18                 | 17        |
| TC-16   |              |        | CONTRACT NO. 60G96 |           |
| FED. ROAD DIST. NO. 1 ILLINOIS FED. AID PROJECT |              |        |                    |           |