

STATE OF ILLINOIS  
DEPARTMENT OF TRANSPORTATION  
DIVISION OF HIGHWAYS

# PROPOSED HIGHWAY PLANS

CH 07 (OLD CHICAGO RD.)  
3.7 MI. N. OF IL 102 TO IL 102  
RESURFACING (MAINTENANCE)  
SECTION: 38 RS-6  
WILL COUNTY  
C-91-562-09

F.A.P. RTE.	SECTION	COUNTY	TOTAL SHEETS	SHEET NO.
607	128 RS-5	WILL	19	1
FED. ROAD DIST. NO. 1		ILLINOIS	CONTRACT NO. 60H06	

FOR INDEX OF SHEETS, SEE SHEET NO. 2

IMPROVEMENT LOCATED IN THE VILLAGE OF WESLEY

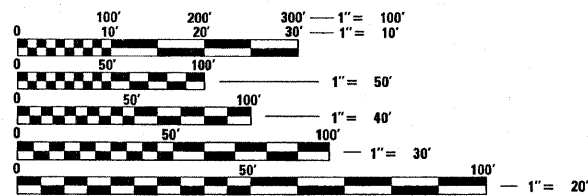
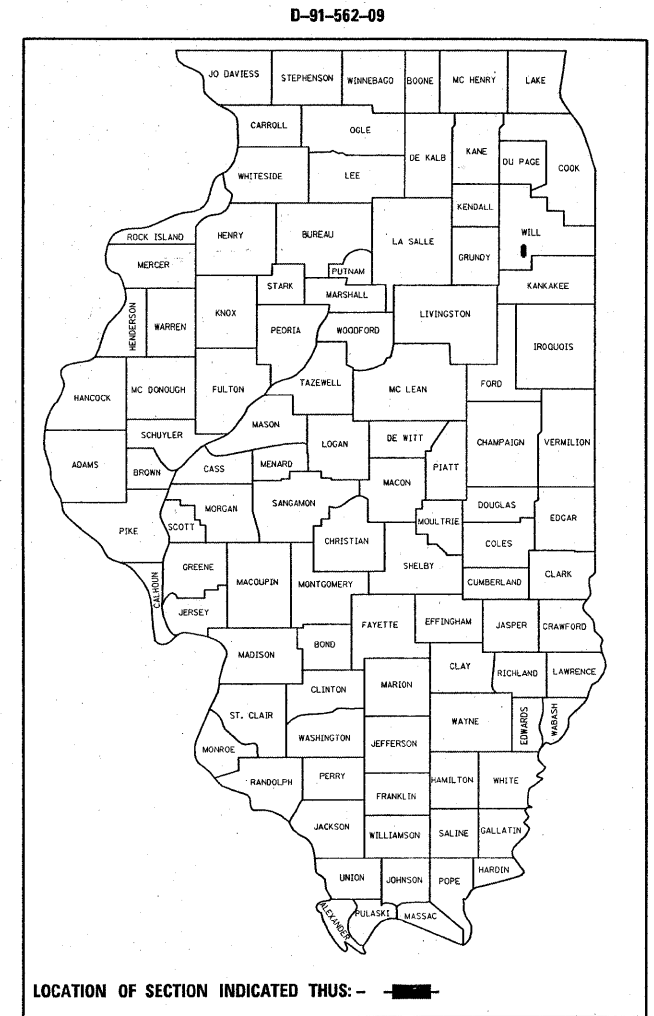

FULL SIZE PLANS HAVE BEEN PREPARED USING STANDARD ENGINEERING SCALES. REDUCED SIZED PLANS WILL NOT CONFORM TO STANDARD SCALES. IN MAKING MEASUREMENTS ON REDUCED PLANS, THE ABOVE SCALES MAY BE USED.

J.U.L.I.E.  
JOINT UTILITY LOCATION INFORMATION FOR EXCAVATION  
1-800-892-0123  
OR 811

IMPROVEMENT BEGINS  
STA. 0 + 69

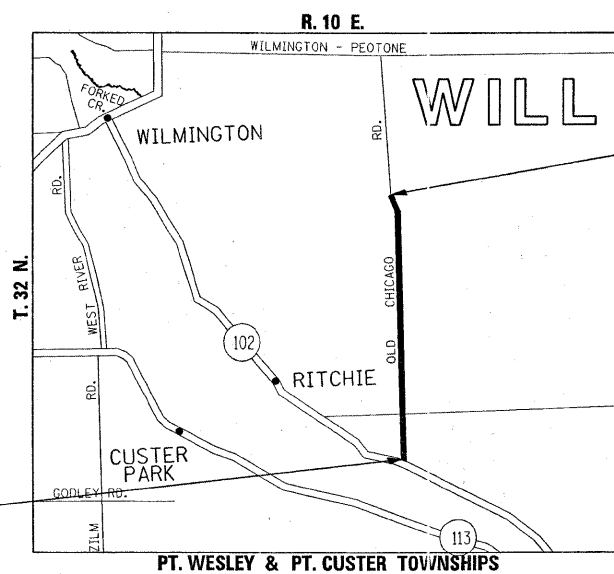

TRAFFIC DATA:  
2008 ADT - 1150  
SPEED LIMIT - 45 TO 50 MPH

IMPROVEMENT ENDS  
STA. 196 + 23

GROSS AND NET LENGTH OF IMPROVEMENT = 19554 LIN FT = 3.71 MILES

PROJECT ENGINEER: JENPAI CHANG (847) 705-4432  
PROJECT MANAGER: KEN ENG (847) 705-4247

CONTRACT NO. 60H06

STATE OF ILLINOIS  
DEPARTMENT OF TRANSPORTATION  
DIVISION OF HIGHWAYS

SUBMITTED APRIL 20, 2009  
Dennis M. O'Keefe, Jr.  
DEPUTY DIRECTOR OF HIGHWAYS, REGION ENGINEER

May 1, 2009  
Charles J. Ingersoll, P.E.  
ENGINEER OF DESIGN AND ENVIRONMENT

May 1, 2009  
Christine M. Reed, P.E.  
DIRECTOR OF HIGHWAYS, CHIEF ENGINEER

PRINTED BY THE AUTHORITY  
OF THE STATE OF ILLINOIS

**INDEX OF SHEETS**

SHEET NO.	DESCRIPTION
1	COVER SHEET
2	INDEX OF SHEETS, STATE STANDARDS AND GENERAL NOTES
3	SUMMARY OF QUANTITIES
4	TYPICAL SECTIONS
5-11	ROADWAY AND PAVEMENT MARKING PLANS
12	PAVEMENT PATCHING FOR HMA SURFACED PAVEMENT
13	BUTT JOINT AND HMA TAPER DETAILS
14	TRAFFIC CONTROL AND PROTECTION FOR SIDEROADS, INTERSECTIONS, AND DRIVEWAYS
15	TYPICAL APPLICATIONS RAISED REFLECTIVE PAVEMENT MARKERS (SNOW PLOW RESISTANT)
16	TRAFFIC CONTROL AND PROTECTION AT TURN BAYS (TO REMAIN OPEN TO TRAFFIC)
17	DISTRICT ONE TYPICAL PAVEMENT MARKINGS
18	PAVEMENT MARKING LETTERS AND SYMBOLS FOR TRAFFIC STAGING
19	ARTERIAL INFORMATION SIGNING

**STANDARDS**

000001-05	TYPICAL SYMBOLS, ABBREVIATIONS AND PATTERNS
442201-03	CLASS C AND D PATCHES
701011-02	OFF-RD, MOVING OPERATIONS, 2L, 2W, DAY ONLY
701201-03	LANE CLOSURE, 2L, 2W, DAY ONLY
701301-03	LANE CLOSURE, 2L, 2W, SHORT TIME OPERATIONS
701311-03	LANE CLOSURE, 2L, 2W, MOVING OPERATIONS - DAY ONLY
701501-05	URBAN LANE CLOSURE, 2L 2W, UNDIVIDED
701901-01	TRAFFIC CONTROL DEVICES

**GENERAL NOTES**

BEFORE STARTING ANY EXCAVATION, THE CONTRACTOR SHALL CALL "JULIE" AT 800-892-0123 OR 811 FOR FIELD LOCATIONS OF BURIED ELECTRIC, TELEPHONE AND GAS FACILITIES. (48 HOURS NOTIFICATION REQUIRED).

THE CONTRACTOR SHALL COORDINATE CONSTRUCTION ACTIVITIES WITH UTILITY COMPANIES AND THE VILLAGE OF WESLEY.

THE CONTRACTOR WILL NOT BE ALLOWED TO SET UP A YARD OR FIELD OFFICE ON STATE PROPERTY WITHOUT WRITTEN PERMISSION FROM THE DEPARTMENT.

WHEN MILLED PAVEMENT IS OPEN TO TRAFFIC, THE MAXIMUM GRADE DIFFERENTIAL BETWEEN PASSES OF THE MILLING MACHINE SHALL NOT EXCEED 1 1/2 INCHES (40 MM) WHERE THE SPEED LIMIT IS 45 MPH (80 KM/H) OR LESS AND 1 INCH (25 MM) WHERE THE SPEED LIMIT IS GREATER THAN 45 MPH (80 KM/H). WITH WRITTEN APPROVAL FROM THE ENGINEER, A MAXIMUM GRADE DIFFERENTIAL OF 3 INCHES (75 MM) MAY BE ALLOWED IF THE EDGE OF THE MILLING IS SLOPED A MINIMUM 1:3 (V:H).

BUTT JOINTS WILL BE INSTALLED AT THE ENDS OF ALL RESURFACING (WHERE RESURFACING MEETS EXISTING PAVEMENT), IN ACCORDANCE WITH THE "BUTT JOINT AND HMA TAPER DETAILS" SHEET INCLUDED IN THE PLANS, UNLESS OTHERWISE SPECIFIED.

THE RESIDENT ENGINEER SHALL CONTACT MS. CORA MATHIS, AREA TRAFFIC FIELD ENGINEER AT (815) 485-6475 A MINIMUM OF 2 WEEKS PRIOR TO PLACEMENT OF PERMANENT PAVEMENT MARKING.

ALL PAVEMENT PATCHING LOCATIONS WILL BE DETERMINED IN THE FIELD BY THE ENGINEER. IT SHALL BE THE CONTRACTOR'S RESPONSIBILITY TO VERIFY ALL DIMENSIONS AND CONDITIONS EXISTING IN THE FIELD PRIOR TO CONSTRUCTION AND ORDERING OF MATERIALS.

BEFORE BEGINNING ANY WORK, THE CONTRACTOR SHALL RETAIN AND RECORD FOR FUTURE REFERENCE, ALL EXISTING PAVEMENT MARKING LINES (AND RAISED REFLECTIVE PAVEMENT MARKERS) IN ORDER THAT THESE LOCATIONS CAN BE RE-ESTABLISHED FOR STRIPING. EXACT LOCATIONS OF ALL PAVEMENT MARKINGS SHALL BE AS DIRECTED BY THE ENGINEER.

PAVEMENT MARKING TAPE, TYPE III SHALL BE USED FOR SHORT TERM PAVEMENT MARKINGS ON ALL FINAL SURFACES. THE COST OF THE PAVEMENT MARKING TAPE, TYPE II AND ITS REMOVAL SHALL BE INCLUDED IN THE COST OF SHORT TERM PAVEMENT MARKING.

DOUBLE LANE MARKERS ARE TO BE USED AS SHOWN ON THE DISTRICT ONE DETAIL "TYPICAL APPLICATIONS - RAISED REFLECTIVE PAVEMENT MARKERS (SNOW-PLOW RESISTANT)" SHOWN IN THE PLANS.

ANY WORK FOUND ON STRUCTURES OVER CREEKS OR RIVERS IS TO BE CONSIDERED AS A RESURFACING OMISSION. OMISSION LOCATIONS AND STATIONS ARE TO BE DETERMINED IN THE FIELD BY THE RESIDENT ENGINEER.

FILE NAME =	USER NAME = guillaumefp	DESIGNED -	REVISED -	<b>STATE OF ILLINOIS DEPARTMENT OF TRANSPORTATION</b>	<b>OLD CHICAGO RD. (3.7 MI N. OF IL 102 TO IL 102) INDEX OF SHEETS, STATE STANDARDS AND GENERAL NOTES</b>	F.A. RTE.	SECTION	COUNTY	TOTAL SHEETS	SHEET NO.	
cs:\pwwork\KAP\WIDOT\GUILLAUMEFP\d0137245	0156209-shi-plot.dgn	DRAWN -	REVISED -			CH 07	38 RS-6	WILL	19	2	
PLOT SCALE = 50.0000' / IN.	CHECKED -	REVISED -				CONTRACT NO. 60H06					
PLOT DATE = 4/23/2009	DATE -	REVISED -				SCALE:	SHEET NO. OF SHEETS	STA. TO STA.	ILLINOIS FED. AID PROJECT		

SUMMARY OF QUANTITIES			URBAN 100% STATE TOTAL QUANTITIES	CONSTRUCTION TYPE CODE					SUMMARY OF QUANTITIES			TOTAL QUANTITIES	CONSTRUCTION TYPE CODE				
CODE NO	ITEM	UNIT		I000						CODE NO	ITEM		UNIT				
20201006	GRADING AND SHAPING SHOULDERS	UNIT	392	392													
40600200	BITUMINOUS MATERIALS (PRIME COAT)	TON	18	18													
40600300	AGGREGATE (PRIME COAT)	TON	90	90													
40600400	MIXTURE FOR CRACKS, JOINTS, AND FLANGEWAYS	TON	14	14													
40600895	CONSTRUCTING TEST STRIP	EACH	1	1													
40600982	HOT-MIX ASPHALT SURFACE REMOVAL - BUTT JOINT	SQ YD	69	69													
40601005	HOT-MIX ASPHALT REPLACEMENT OVER PATCHES	TON	75	75													
40603340	HOT-MIX ASPHALT SURFACE COURSE, MIX "D", N70	TON	3767	3767													
44000158	HOT-MIX ASPHALT SURFACE REMOVAL, 2 1/4"	SQ YD	44835	44835													
44002212	HOT-MIX ASPHALT REMOVAL OVER PATCHES, 3"	SQ YD	672	672													
44201749	CLASS D PATCHES, TYPE I, 9 INCH	SQ YD	10	10													
44201753	CLASS D PATCHES, TYPE II, 9 INCH	SQ YD	170	170													
44201757	CLASS D PATCHES, TYPE III, 9 INCH	SQ YD	70	70													
44201759	CLASS D PATCHES, TYPE IV, 9 INCH	SQ YD	350	350													
48101200	AGGREGATE SHOULDERS, TYPE B	TON	1305	1305													
67000400	ENGINEER'S FIELD OFFICE, TYPE A	CAL MO	6	6													
67100100	MOBILIZATION	L SUM	1	1													
70100450	TRAFFIC CONTROL AND PROTECTION, STANDARD 701201	L SUM	1	1													
70102620	TRAFFIC CONTROL AND PROTECTION, STANDARD 701501	L SUM	1	1													
70300100	SHORT-TERM PAVEMENT MARKING	FOOT	10668	10668													
70300220	TEMPORARY PAVEMENT MARKING - LINE 4"	FOOT	53500	53500													
70300280	TEMPORARY PAVEMENT MARKING - LINE 24"	FOOT	88	88													
70301000	WORK ZONE PAVEMENT MARKING REMOVAL	SQ FT	3556	3556													
*78000200	THERMOPLASTIC PAVEMENT MARKING - LINE 4"	FOOT	53500	53500													
*78000650	THERMOPLASTIC PAVEMENT MARKING - LINE 24"	FOOT	88	88													
*78100100	RAISED REFLECTIVE PAVEMENT MARKER	EACH	375	375													
78300200	RAISED REFLECTIVE PAVEMENT MARKER REMOVAL	EACH	375	375													
X0322256	TEMPORARY INFORMATION SIGNING	SQ FT	51.4	51.4													
X4067107	POLYMERIZED LEVELING BINDER (MACHINE METHOD), IL-4.75, N50	TON	1766	1766													
										* SPECIALTY ITEMS							

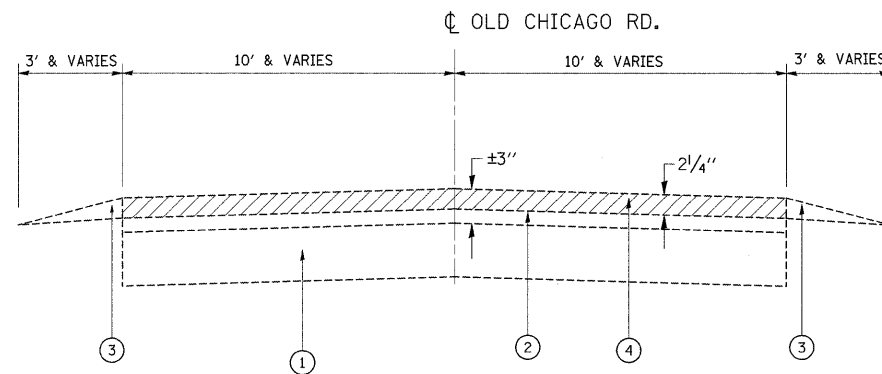

OLD CHICAGO RD..  
EXISTING TYPICAL SECTION  
STA. 0+69 TO STA. 196+23

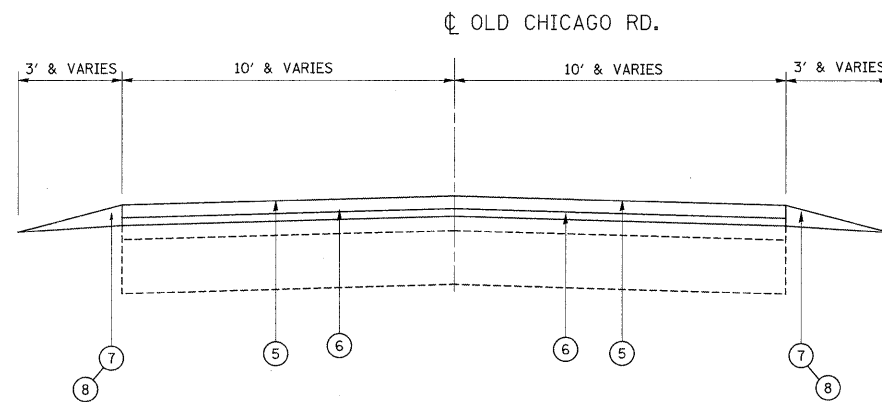

OLD CHICAGO RD..  
PROPOSED TYPICAL SECTION  
STA. 0+69 TO STA. 196+23

**LEGEND**

- ① EXISTING PCC BASE COURSE, ±9"
- ② EXISTING HMA SURFACE 3" (±)
- ③ EXISTING AGGREGATE SHOULDER
- ④ PROPOSED HMA SURFACE REMOVAL, 2 1/4 "
- ⑤ PROPOSED HOT-MIX ASPHALT SURFACE COURSE, MIX "D", N70, 1 1/2"
- ⑥ PROPOSED POLYMERIZED LEVELING BINDER (MACHINE METHOD), IL-4.75, N50, 3/4"
- ⑦ PROPOSED AGGREGATE WEDGE SHOULDER, TYPE "B"
- ⑧ PROPOSED GRADING & SHAPING SHOULDERS

NOTE:

PAVEMENT PATCHING SHALL BE DONE PRIOR TO ROADWAY MILLING

**HOT-MIX ASPHALT MIXTURE REQUIREMENTS**

	MIXTURE USE	AC TYPE	AIR VOIDS (%)
ROADWAY	POLYMERIZED LEVELING BINDER (MM), IL-4.75, N50	SBS/SBR 76-28/-22	4% @ 50 GYR
	HOT-MIX ASPHALT SURFACE COURSE, MIX "D" N70 (IL-9.5mm)	PG 64-22	4% @ 70 GYR
PATCHES	HOT-MIX ASPHALT REPLACEMENT OVER PATCHES, (HMA BINDER IL-19.0 MM)	PG 64-22*	4% @ 70 GYR
	CLASS D PATCHES, 9" (HMA BINDER IL-19.0 MM)	PG 64-22*	4% @ 70 GYR

THE UNIT WEIGHT USED TO CALCULATE ALL HOT- MIX ASPHALT SURFACE MIXTURE QUANTITIES IS 112 LBS/SY/IN.

\*WHEN RAP EXCEEDS 20%, THE NEW ASPHALT BINDER IN THE MIX SHALL BE PG 58-22.

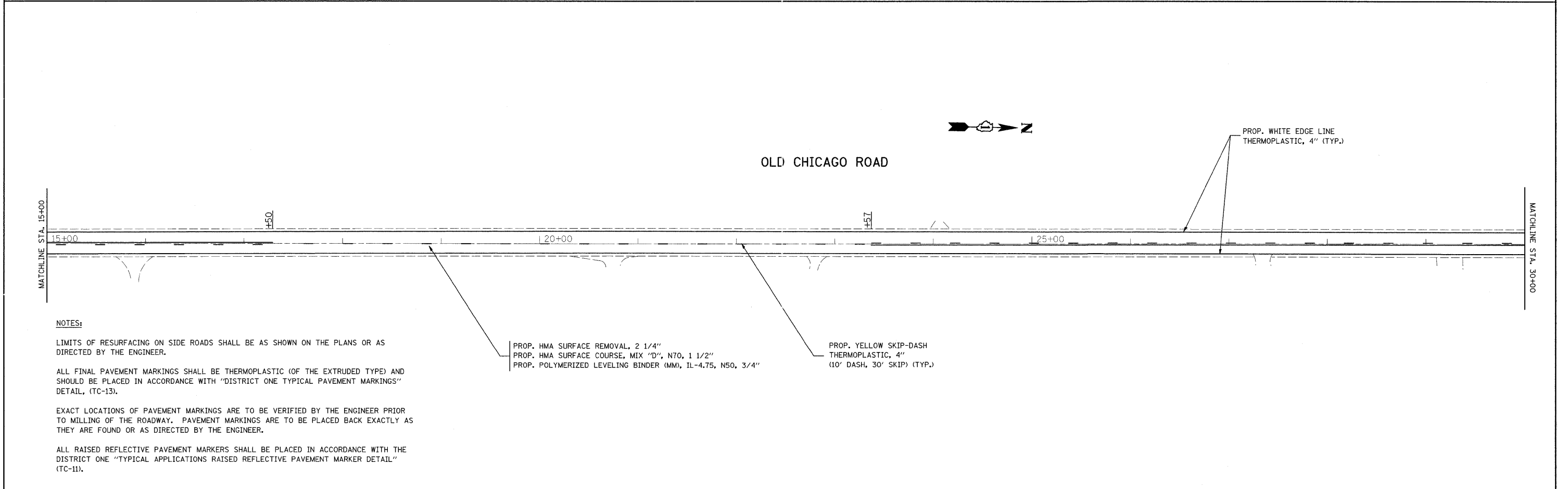
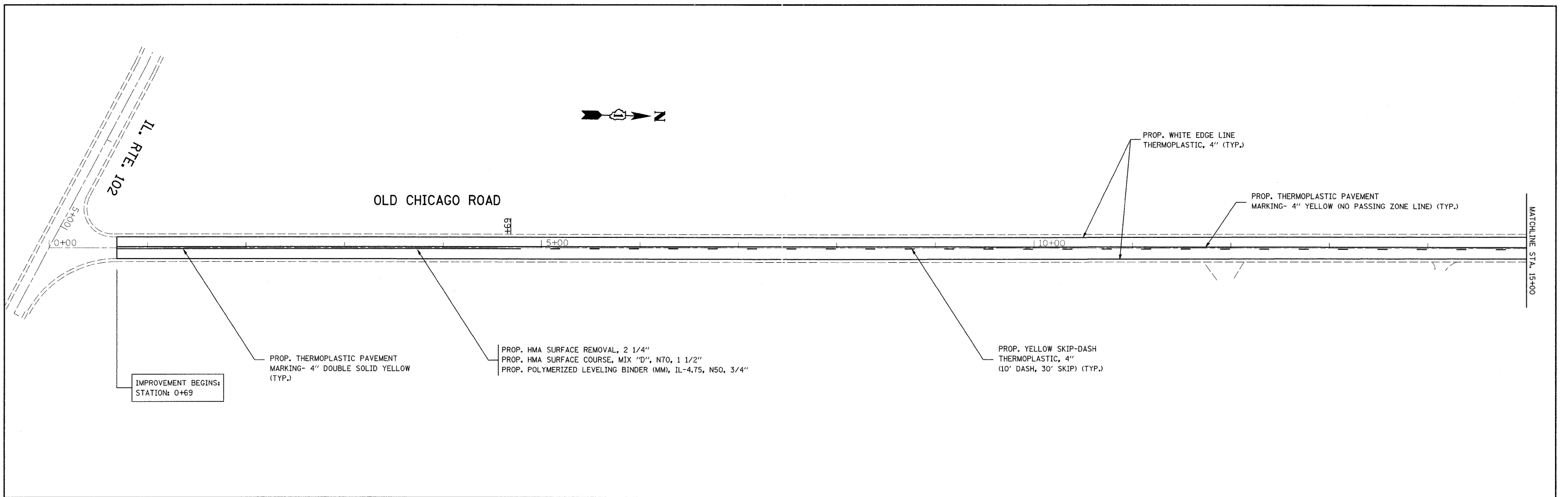

**NOTES:**

LIMITS OF RESURFACING ON SIDE ROADS SHALL BE AS SHOWN ON THE PLANS OR AS DIRECTED BY THE ENGINEER.

ALL FINAL PAVEMENT MARKINGS SHALL BE THERMOPLASTIC (OF THE EXTRUDED TYPE) AND SHOULD BE PLACED IN ACCORDANCE WITH "DISTRICT ONE TYPICAL PAVEMENT MARKINGS" DETAIL, (TC-13).

EXACT LOCATIONS OF PAVEMENT MARKINGS ARE TO BE VERIFIED BY THE ENGINEER PRIOR TO MILLING OF THE ROADWAY. PAVEMENT MARKINGS ARE TO BE PLACED BACK EXACTLY AS THEY ARE FOUND OR AS DIRECTED BY THE ENGINEER.

ALL RAISED REFLECTIVE PAVEMENT MARKERS SHALL BE PLACED IN ACCORDANCE WITH THE DISTRICT ONE "TYPICAL APPLICATIONS RAISED REFLECTIVE PAVEMENT MARKER DETAIL" (TC-11).

FILE NAME = c:\pw_work\PW\DOT\GUILLAUMEFP\30137245	USER NAME = gulllaumefp 0156209-sht-plan.dgn	DESIGNED - DRAWN -	REVISED - REVISED -	<b>STATE OF ILLINOIS DEPARTMENT OF TRANSPORTATION</b>	<b>OLD CHICAGO ROAD (3.7 MI. N OF IL. RTE. 102 &amp; IL. RTE. 102 ROADWAY &amp; PAVEMENT MARKING PLAN</b>	F.A. RTE. CH 07	SECTION 38 RS-6	COUNTY WILL	TOTAL SHEETS 5	SHEET NO. 19		
PLOT SCALE = 50.0000 ' / IN.	CHECKED -	REVISED -	SCALE: 1" = 50'			SHEET NO. OF SHEETS	STA. 00+00.00 TO STA. 30+00.00	ILLINOIS FED. AID PROJECT				
PLOT DATE = 4/23/2009	DATE -	REVISED -										
CONTRACT NO. 60H06												

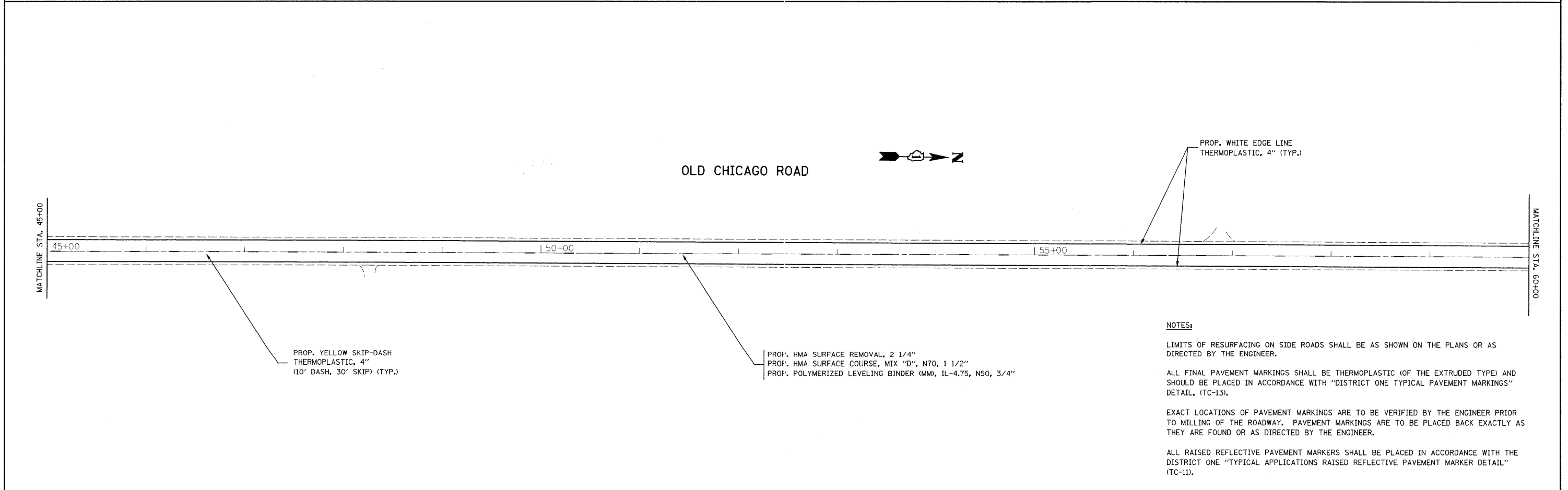
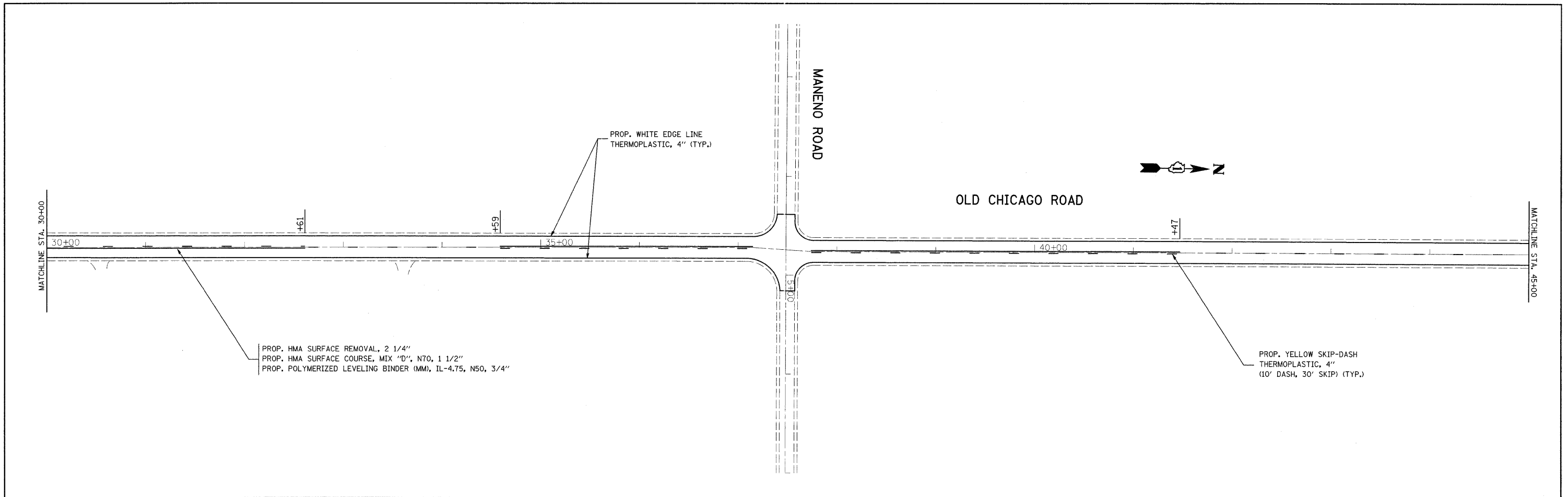

**NOTES:**

LIMITS OF RESURFACING ON SIDE ROADS SHALL BE AS SHOWN ON THE PLANS OR AS DIRECTED BY THE ENGINEER.

ALL FINAL PAVEMENT MARKINGS SHALL BE THERMOPLASTIC (OF THE EXTRUDED TYPE) AND SHOULD BE PLACED IN ACCORDANCE WITH "DISTRICT ONE TYPICAL PAVEMENT MARKINGS" DETAIL, (TC-13).

EXACT LOCATIONS OF PAVEMENT MARKINGS ARE TO BE VERIFIED BY THE ENGINEER PRIOR TO MILLING OF THE ROADWAY. PAVEMENT MARKINGS ARE TO BE PLACED BACK EXACTLY AS THEY ARE FOUND OR AS DIRECTED BY THE ENGINEER.

ALL RAISED REFLECTIVE PAVEMENT MARKERS SHALL BE PLACED IN ACCORDANCE WITH THE DISTRICT ONE "TYPICAL APPLICATIONS RAISED REFLECTIVE PAVEMENT MARKER DETAIL" (TC-11).

FILE NAME = c:\pwwork\pwwid01\GUILLAUMEFP\08137245	USER NAME = guillaumefp D156209-sht-pln.dgn	DESIGNED - DRAWN -	REVISED - REVISED -	<b>STATE OF ILLINOIS DEPARTMENT OF TRANSPORTATION</b>	<b>OLD CHICAGO ROAD (3.7 MI. N OF IL. RTE. 102 &amp; IL. RTE. 102 ROADWAY &amp; PAVEMENT MARKING PLAN</b>	F.A. RTE. CH 07	SECTION 38 RS-6	COUNTY WILL	TOTAL SHEETS 19	SHEET NO. 6		
PLOT SCALE = 50,0000 ' / IN.						SCALE: 1" = 50'	SHEET NO. OF SHEETS	STA. 30+00.00 TO STA. 60+00.00	CONTRACT NO. 60H06			
PLOT DATE = 4/23/2009						DATE -	ILLINOIS FED. AID PROJECT					

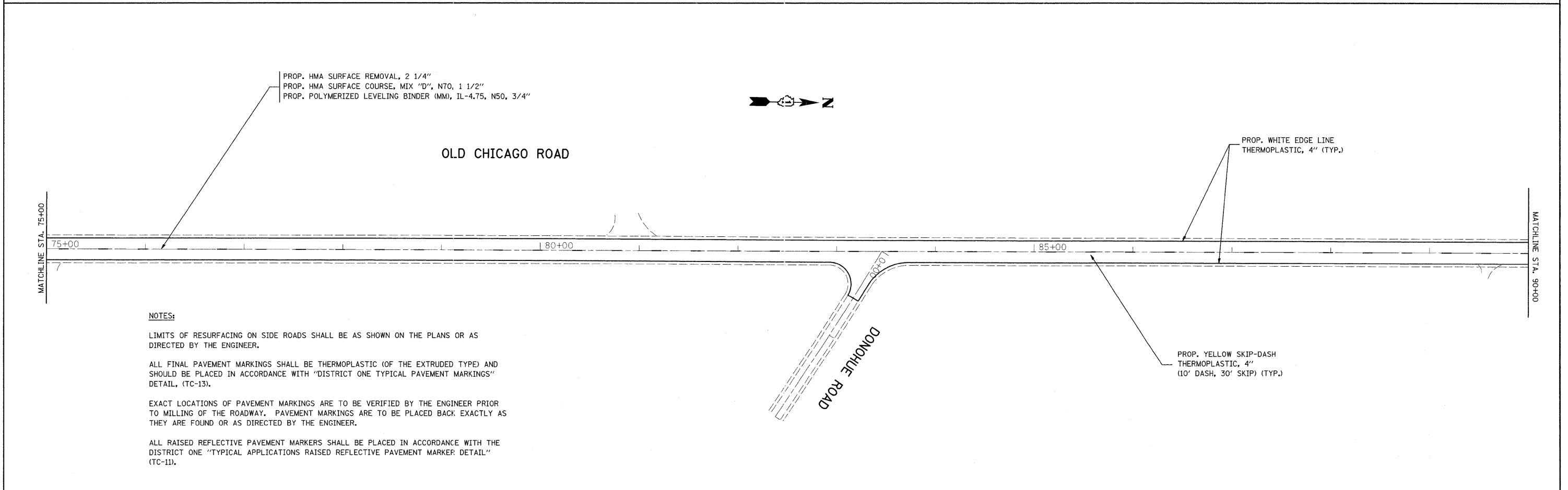
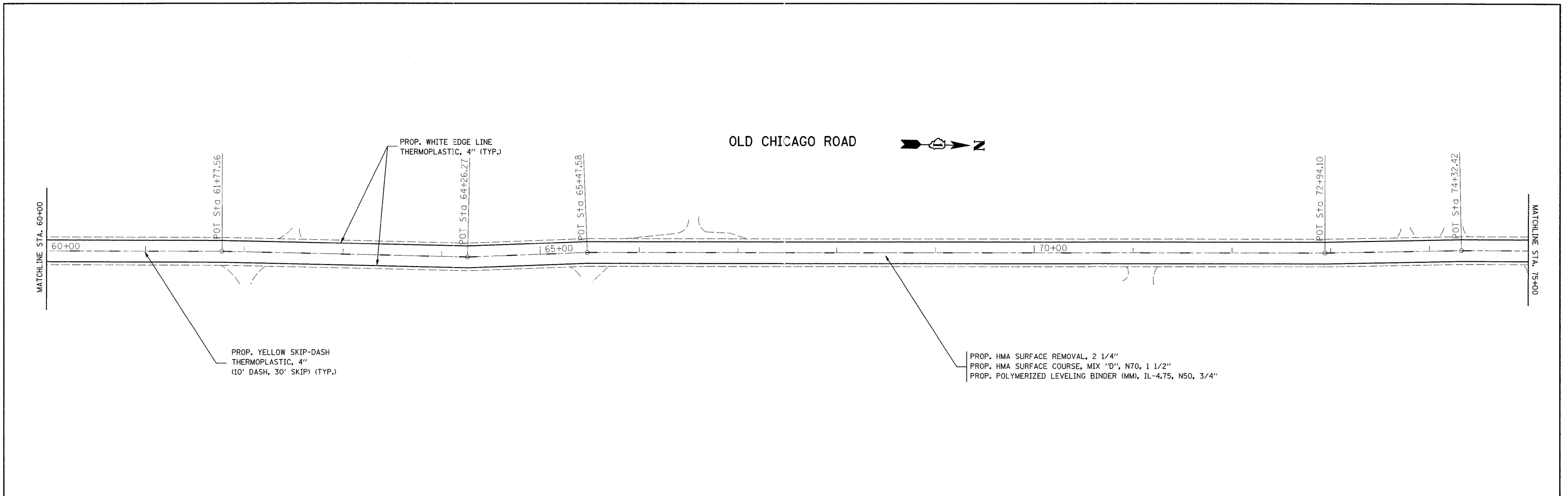

**NOTES:**

LIMITS OF RESURFACING ON SIDE ROADS SHALL BE AS SHOWN ON THE PLANS OR AS DIRECTED BY THE ENGINEER.

ALL FINAL PAVEMENT MARKINGS SHALL BE THERMOPLASTIC (OF THE EXTRUDED TYPE) AND SHOULD BE PLACED IN ACCORDANCE WITH "DISTRICT ONE TYPICAL PAVEMENT MARKINGS" DETAIL, (TC-13).

EXACT LOCATIONS OF PAVEMENT MARKINGS ARE TO BE VERIFIED BY THE ENGINEER PRIOR TO MILLING OF THE ROADWAY. PAVEMENT MARKINGS ARE TO BE PLACED BACK EXACTLY AS THEY ARE FOUND OR AS DIRECTED BY THE ENGINEER.

ALL RAISED REFLECTIVE PAVEMENT MARKERS SHALL BE PLACED IN ACCORDANCE WITH THE DISTRICT ONE "TYPICAL APPLICATIONS RAISED REFLECTIVE PAVEMENT MARKER DETAIL" (TC-11).

FILE NAME = c:\pw\work\p\WIDOT\GUILLAUMEFP\d0137245	USER NAME = guillaumefp	DESIGNED -	REVISED -	<b>STATE OF ILLINOIS DEPARTMENT OF TRANSPORTATION</b>	<b>OLD CHICAGO ROAD (3.7 MI. NOF IL. RTE. 102 &amp; IL. RTE. 102 ROADWAY &amp; PAVEMENT MARKING PLAN</b>			F.A. RTE.	SECTION	COUNTY	TOTAL SHEETS	SHEET NO.
	DI:56209-sht-plan.dgn	DRAWN -	REVISED -					CH 07	38 RS-6	WILL	19	7
PLOT SCALE = 50.0000' / IN.	CHECKED -	REVISED -	SCALE: 1" = 50'			SHEET NO. OF SHEETS	STA. 60+00.00 TO STA. 90+00.00		CONTRACT NO. 60H06			
PLOT DATE = 4/23/2009	DATE -	REVISED -	ILLINOIS FED. AID PROJECT									

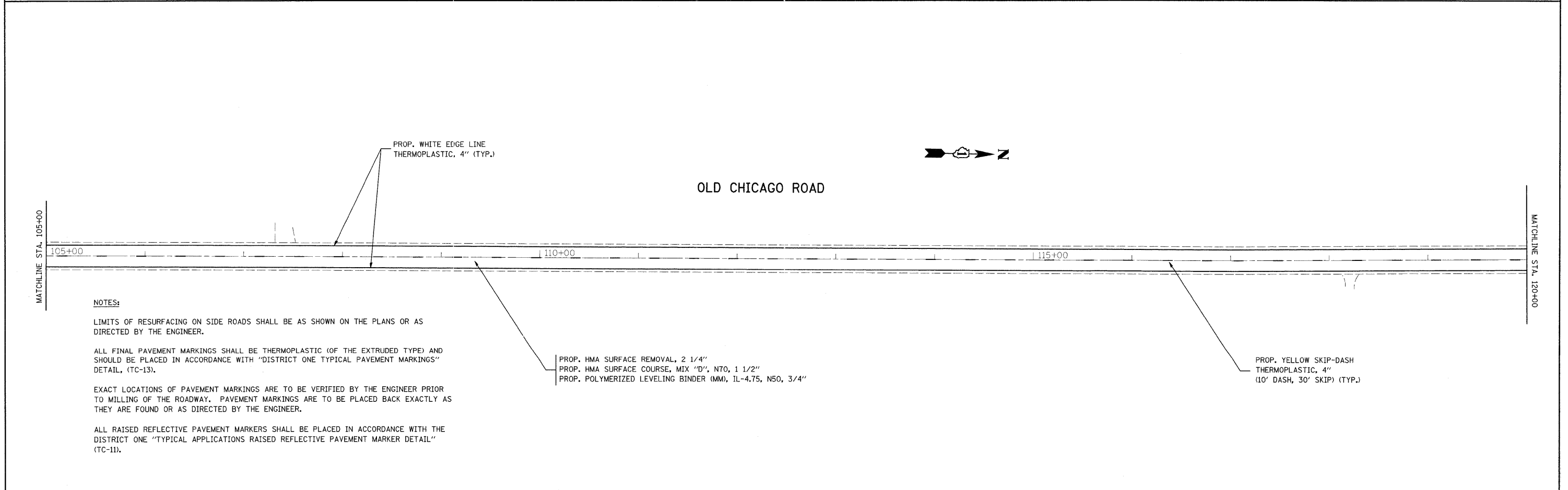
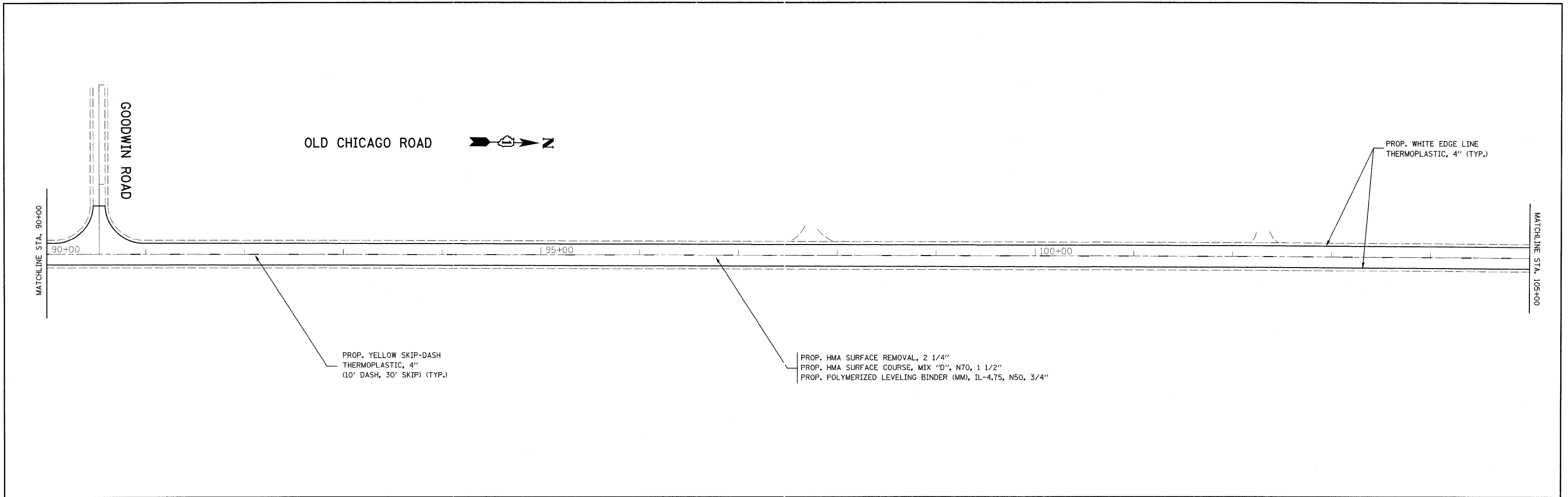

**NOTES:**

LIMITS OF RESURFACING ON SIDE ROADS SHALL BE AS SHOWN ON THE PLANS OR AS DIRECTED BY THE ENGINEER.

ALL FINAL PAVEMENT MARKINGS SHALL BE THERMOPLASTIC (OF THE EXTRUDED TYPE) AND SHOULD BE PLACED IN ACCORDANCE WITH "DISTRICT ONE TYPICAL PAVEMENT MARKINGS" DETAIL, (TC-13).

EXACT LOCATIONS OF PAVEMENT MARKINGS ARE TO BE VERIFIED BY THE ENGINEER PRIOR TO MILLING OF THE ROADWAY. PAVEMENT MARKINGS ARE TO BE PLACED BACK EXACTLY AS THEY ARE FOUND OR AS DIRECTED BY THE ENGINEER.

ALL RAISED REFLECTIVE PAVEMENT MARKERS SHALL BE PLACED IN ACCORDANCE WITH THE DISTRICT ONE "TYPICAL APPLICATIONS RAISED REFLECTIVE PAVEMENT MARKER DETAIL" (TC-11).

FILE NAME =	USER NAME = guillaumefp	DESIGNED -	REVISED -
es:\pwwork\PWIDOT\GUILLAUMEFP\08137245	DIS6209-sht-plan.dgn	DRAWN -	REVISED -
	PLOT SCALE = 50.0000' / IN.	CHECKED -	REVISED -
	PLOT DATE = 4/23/2009	DATE -	REVISED -

**STATE OF ILLINOIS  
DEPARTMENT OF TRANSPORTATION**

**OLD CHICAGO ROAD (3.7 MI. N OF IL. RTE. 102 & IL. RTE. 102  
ROADWAY & PAVEMENT MARKING PLAN**

SCALE: 1" = 50'    SHEET NO.    OF    SHEETS    STA. 90+00.00    TO    STA. 120+00.00

F.A. RTE.	SECTION	COUNTY	TOTAL SHEETS	SHEET NO.
CH 07	38 RS-6	WILL	19	8
CONTRACT NO. 60H06				
ILLINOIS FED. AID PROJECT				



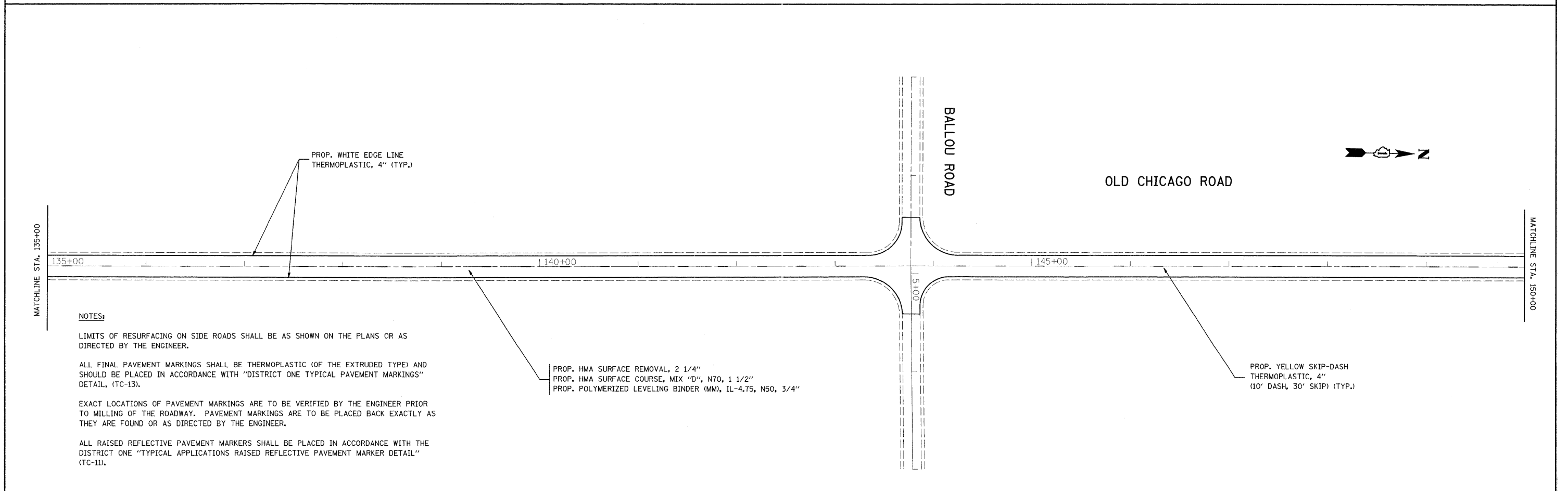
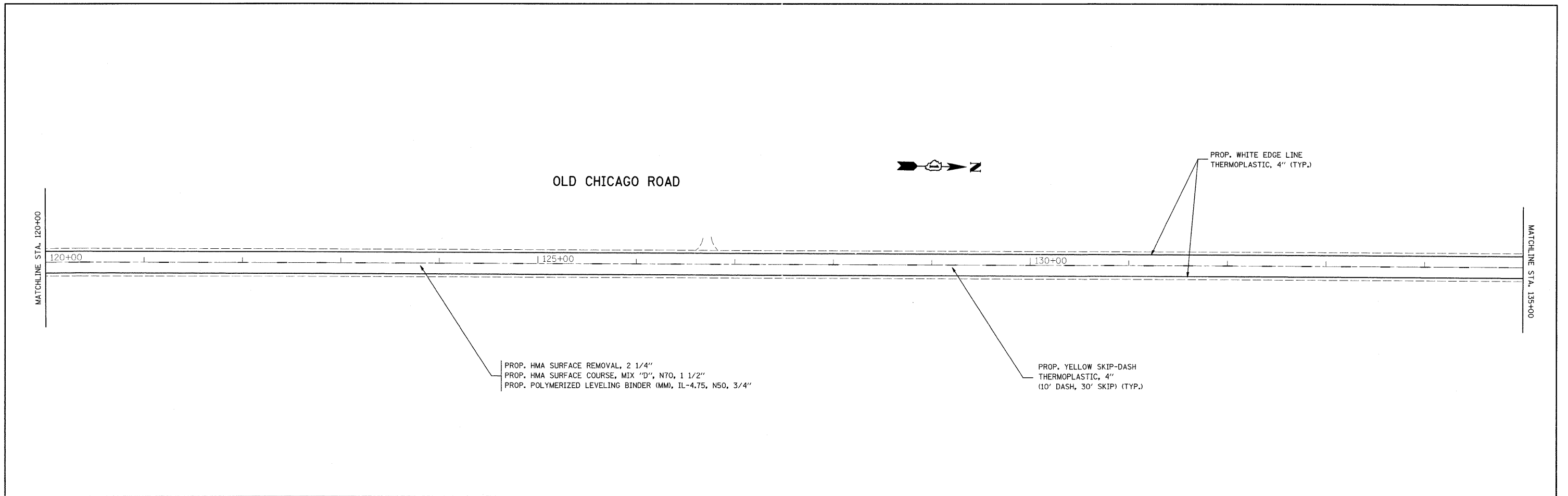

**NOTES:**

LIMITS OF RESURFACING ON SIDE ROADS SHALL BE AS SHOWN ON THE PLANS OR AS DIRECTED BY THE ENGINEER.

ALL FINAL PAVEMENT MARKINGS SHALL BE THERMOPLASTIC (OF THE EXTRUDED TYPE) AND SHOULD BE PLACED IN ACCORDANCE WITH "DISTRICT ONE TYPICAL PAVEMENT MARKINGS" DETAIL, (TC-13).

EXACT LOCATIONS OF PAVEMENT MARKINGS ARE TO BE VERIFIED BY THE ENGINEER PRIOR TO MILLING OF THE ROADWAY. PAVEMENT MARKINGS ARE TO BE PLACED BACK EXACTLY AS THEY ARE FOUND OR AS DIRECTED BY THE ENGINEER.

ALL RAISED REFLECTIVE PAVEMENT MARKERS SHALL BE PLACED IN ACCORDANCE WITH THE DISTRICT ONE "TYPICAL APPLICATIONS RAISED REFLECTIVE PAVEMENT MARKER DETAIL" (TC-11).

FILE NAME = c:\pwwork\pwwid01\GUILLAUMEFP\j0137245	USER NAME = guillaumefp	DESIGNED -	REVISED -	<b>STATE OF ILLINOIS DEPARTMENT OF TRANSPORTATION</b>	<b>OLD CHICAGO ROAD (3.7 MI. NOF IL. RTE. 102 &amp; IL. RTE. 102 ROADWAY &amp; PAVEMENT MARKING PLAN</b>	F.A. RTE.	SECTION	COUNTY	TOTAL SHEETS	SHEET NO.		
	DISEGNO = sht-plan.dgn	DRAWN -	REVISED -			CH 07	38 RS-6	WILL	19	9		
	PLOT SCALE = 50.0000 ' / IN.	CHECKED -	REVISED -			SCALE: 1" = 50'		SHEET NO. OF SHEETS		STA. 120+00.00 TO STA. 150+00.00		ILLINOIS FED. AID PROJECT
	PLOT DATE = 4/23/2009	DATE -	REVISED -			CONTRACT NO. 60H06						

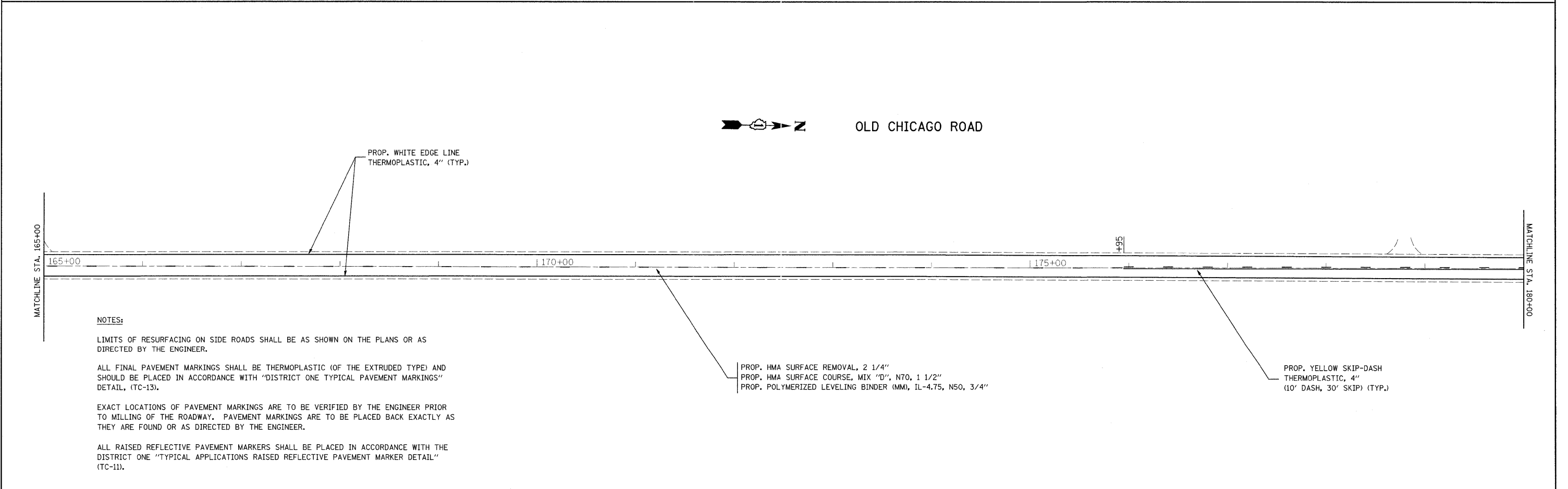
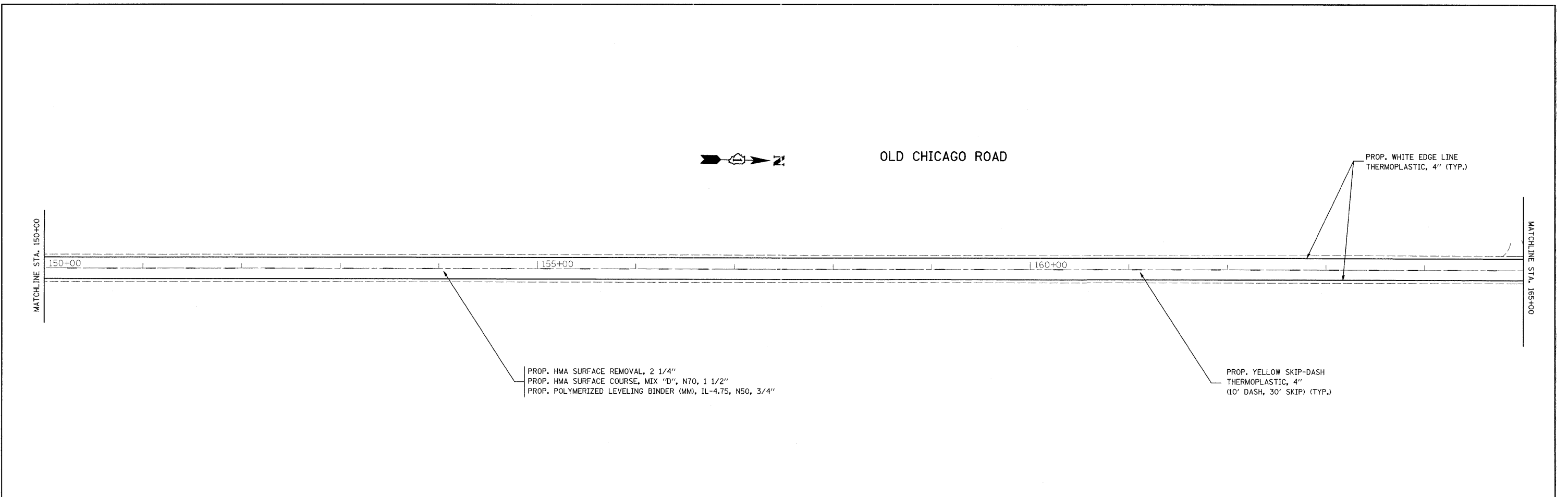

**NOTES:**

LIMITS OF RESURFACING ON SIDE ROADS SHALL BE AS SHOWN ON THE PLANS OR AS DIRECTED BY THE ENGINEER.

ALL FINAL PAVEMENT MARKINGS SHALL BE THERMOPLASTIC (OF THE EXTRUDED TYPE) AND SHOULD BE PLACED IN ACCORDANCE WITH "DISTRICT ONE TYPICAL PAVEMENT MARKINGS" DETAIL, (TC-13).

EXACT LOCATIONS OF PAVEMENT MARKINGS ARE TO BE VERIFIED BY THE ENGINEER PRIOR TO MILLING OF THE ROADWAY. PAVEMENT MARKINGS ARE TO BE PLACED BACK EXACTLY AS THEY ARE FOUND OR AS DIRECTED BY THE ENGINEER.

ALL RAISED REFLECTIVE PAVEMENT MARKERS SHALL BE PLACED IN ACCORDANCE WITH THE DISTRICT ONE "TYPICAL APPLICATIONS RAISED REFLECTIVE PAVEMENT MARKER DETAIL" (TC-11).

FILE NAME = c:\pw_work\PW\DOT\GUILLAUMEFP\0137245	USER NAME = guillaumefp	DESIGNED -	REVISED -	<b>STATE OF ILLINOIS DEPARTMENT OF TRANSPORTATION</b>	<b>OLD CHICAGO ROAD (3.7 MI. NOF IL. RTE. 102 &amp; IL. RTE. 102 ROADWAY &amp; PAVEMENT MARKING PLAN</b>	F.A. RTE.	SECTION	COUNTY	TOTAL SHEETS	SHEET NO.		
	DISE209-shr-plan.dgn	DRAWN -	REVISED -			CH 07	38 RS-6	WILL	19	10		
	PLOT SCALE = 50.0000' / IN.	CHECKED -	REVISED -			SCALE: 1"= 50'		SHEET NO. OF SHEETS		STA. 150+00.00 TO STA. 180+00.00		CONTRACT NO. 60H06
	PLOT DATE = 4/23/2009	DATE -	REVISED -			ILLINOIS FED. AID PROJECT						

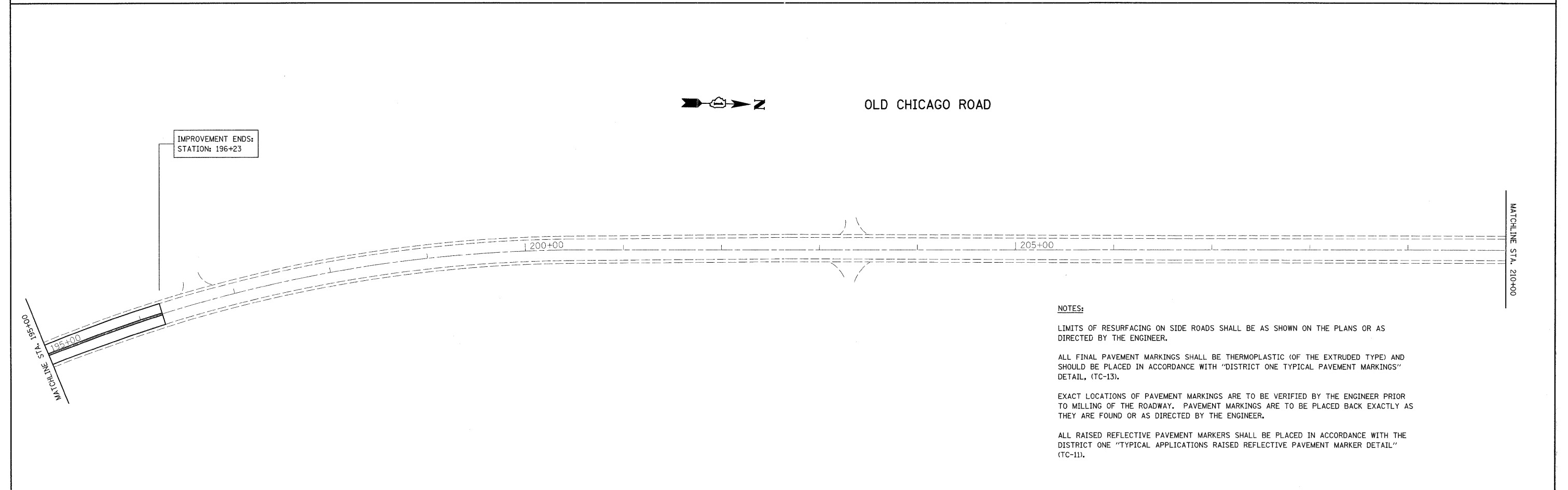
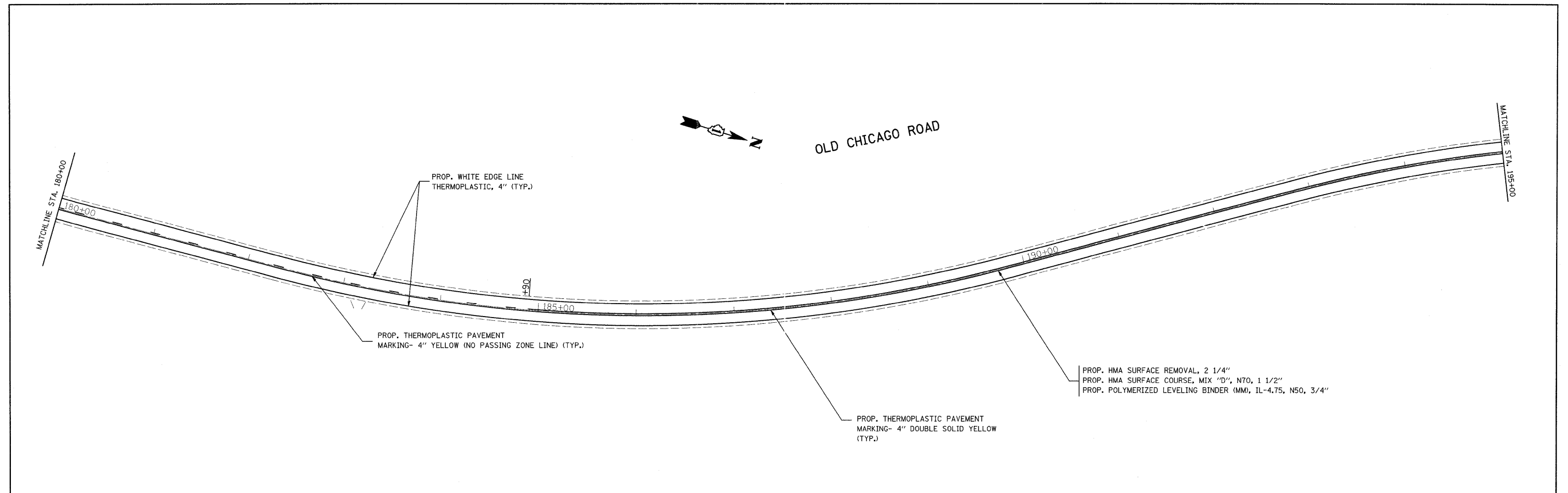

FILE NAME =	USER NAME = guillaumefp	DESIGNED -	REVISED -	<b>STATE OF ILLINOIS DEPARTMENT OF TRANSPORTATION</b>	<b>OLD CHICAGO ROAD (3.7 MI. N OF IL. RTE. 102 &amp; IL. RTE. 102 ROADWAY &amp; PAVEMENT MARKING PLAN</b>	F.A. RTE.	SECTION	COUNTY	TOTAL SHEETS	SHEET NO.	
c:\pwwork\pwwid\GUILLAUMEFP\28137245	156209-shr-plan.dgn	DRAWN -	REVISED -			CH 07	38 RS-6	WILL	19	11	
	PLOT SCALE = 50.0000' / IN.	CHECKED -	REVISED -			SCALE: 1" = 50'		SHEET NO. OF SHEETS		STA. 180+00.00 TO STA. 210+00.00	
	PLOT DATE = 4/23/2009	DATE -	REVISED -			CONTRACT NO. 60H06 ILLINOIS FED. AID PROJECT					

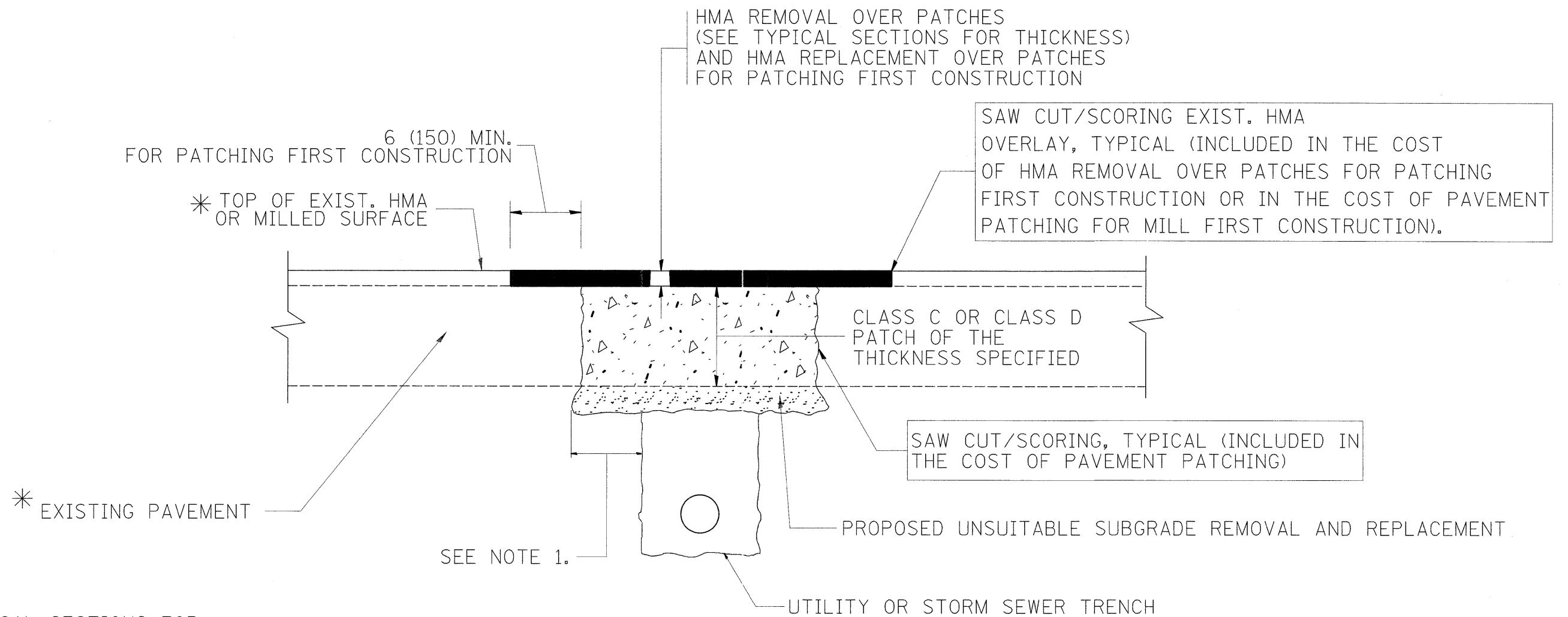

\* SEE TYPICAL SECTIONS FOR THICKNESS AND MATERIALS

**NOTES:**

1. THE WIDTH OF THE FULL DEPTH PATCH OVER A TRENCH SHALL BE 12 (300) WIDER ON EACH SIDE OF THE TRENCH.
2. FOR METHOD OF MEASUREMENT AND BASIS OF PAYMENT, SEE RECURRING SPECIAL PROVISION "PATCHING WITH HOT-MIX ASPHALT OVERLAY REMOVAL".

SEQUENCE OF CONSTRUCTION (PATCHING FIRST)

1. REMOVE THE EXISTING HMA MATERIAL OVER THE AREA TO BE PATCHED.
2. REMOVE AND REPLACE WITH CLASS C OR D PATCH.
3. REPLACE HMA MATERIAL OVER THE AREA TO BE PATCHED.

SEQUENCE OF CONSTRUCTION (MILLING FIRST)

1. MILL HMA FIRST IF THERE IS AT LEAST 4 1/2 INCHES OR MORE OF HMA MATERIAL ON TOP OF THE EXISTING PAVEMENT OR IF THE PAVEMENT IS FULL DEPTH HMA. A MINIMUM OF 2 INCHES OF HMA MATERIAL SHALL BE IN PLACE AFTER MILLING.
2. REMOVE AND REPLACE WITH FULL DEPTH CLASS D PATCHES TO TOP OF MILLED SURFACE.

ALL DIMENSIONS ARE IN INCHES (MILLIMETERS) UNLESS OTHERWISE SHOWN.

FILE NAME =	USER NAME = guillaumejp	DESIGNED - R. SHAH	REVISED - A. ABBAS 04-27-98	<b>STATE OF ILLINOIS DEPARTMENT OF TRANSPORTATION</b>	<b>PAVEMENT PATCHING FOR HMA SURFACED PAVEMENT</b>	F.A. RTE.	SECTION	COUNTY	TOTAL SHEETS	SHEET NO.
ct:\pw_work\pwidot\guillaumejp\d0137245\056209-shc-plan.dgn	DRAWN -	REVISED - R. BORO 01-01-07	CH 07			38 RS-6	WILL	19	12	
PLOT SCALE = 50,0000' / IN.	CHECKED -	REVISED - R. BORO 09-04-07	<b>BD400-04 (BD-22)</b>			<b>CONTRACT NO. 60H06</b>				
PLOT DATE = 4/23/2009	DATE - 10-25-94	REVISED - K. ENG 10-27-08	SCALE: NONE			SHEET NO. 1 OF 1 SHEETS		STA. _____ TO STA. _____		FED. ROAD DIST. NO. 1 (ILLINOIS) FED. AID PROJECT

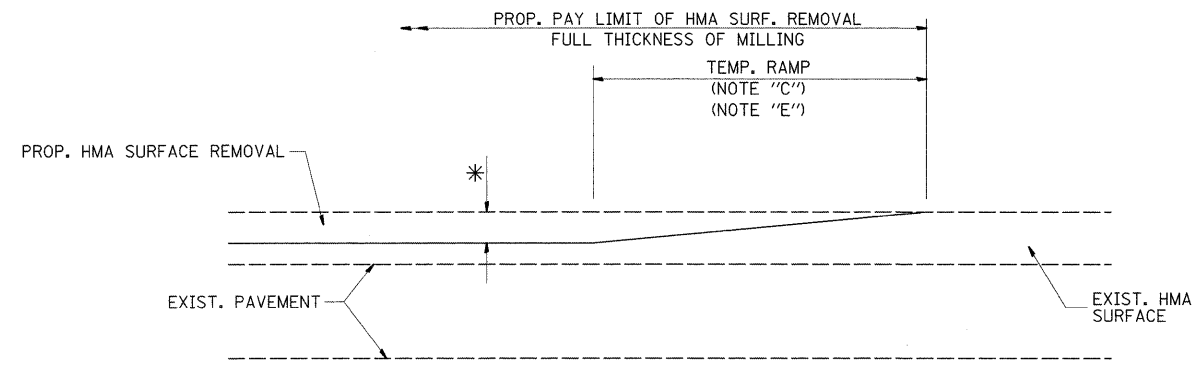

MILLED TEMPORARY RAMP  
(FOR BUTT JOINT AND HMA TAPER SEE DETAIL BELOW)

**OPTION 1**

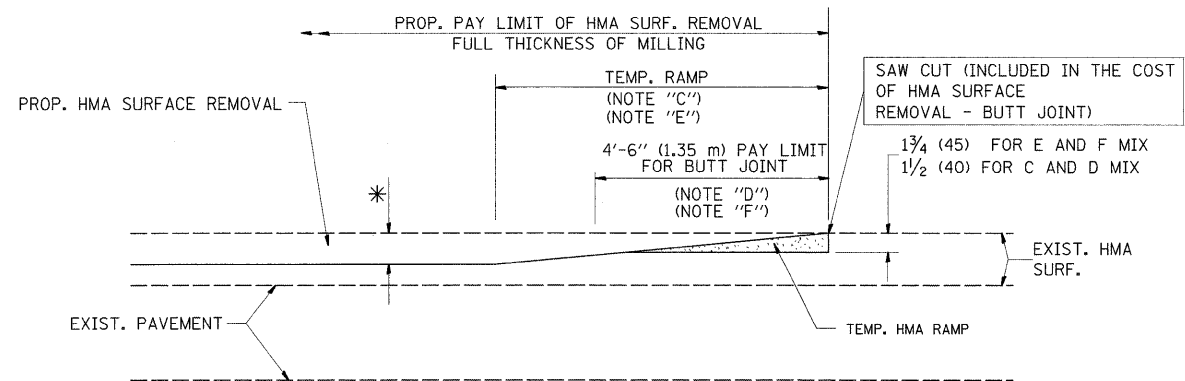

HMA CONSTRUCTED TEMPORARY RAMP  
(FOR BUTT JOINT AND HMA TAPER SEE DETAIL BELOW)

**OPTION 2**  
**TYPICAL TEMPORARY RAMP**

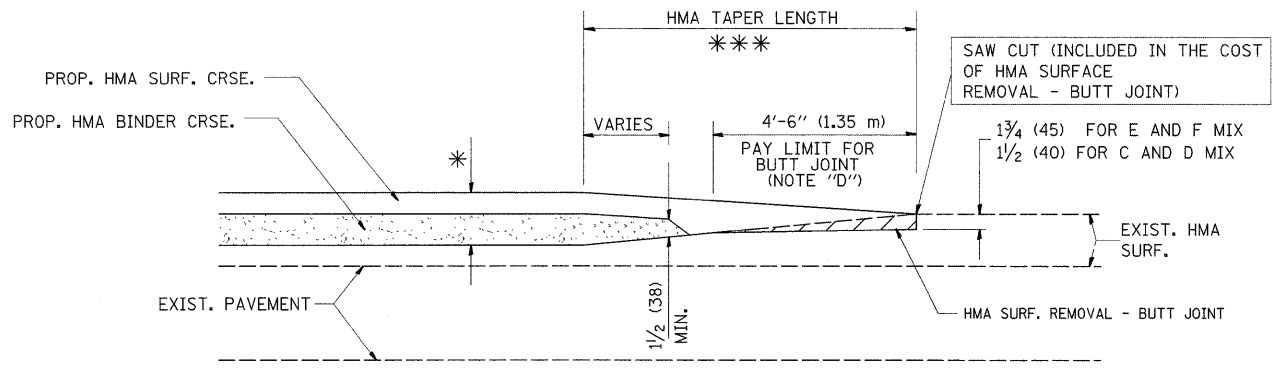

BUTT JOINT AND  
HMA TAPER

**TYPICAL BUTT JOINT AND HMA TAPER  
FOR MILLING AND RESURFACING**

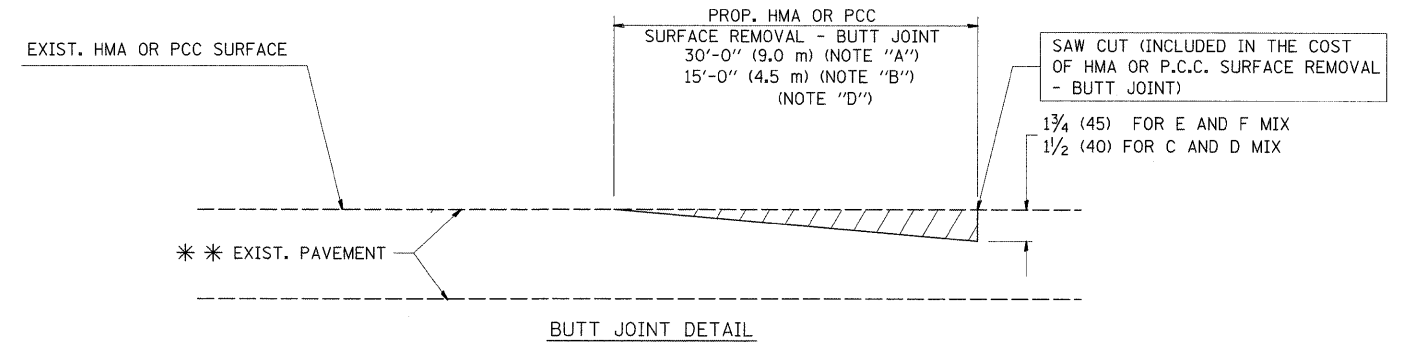

BUTT JOINT DETAIL

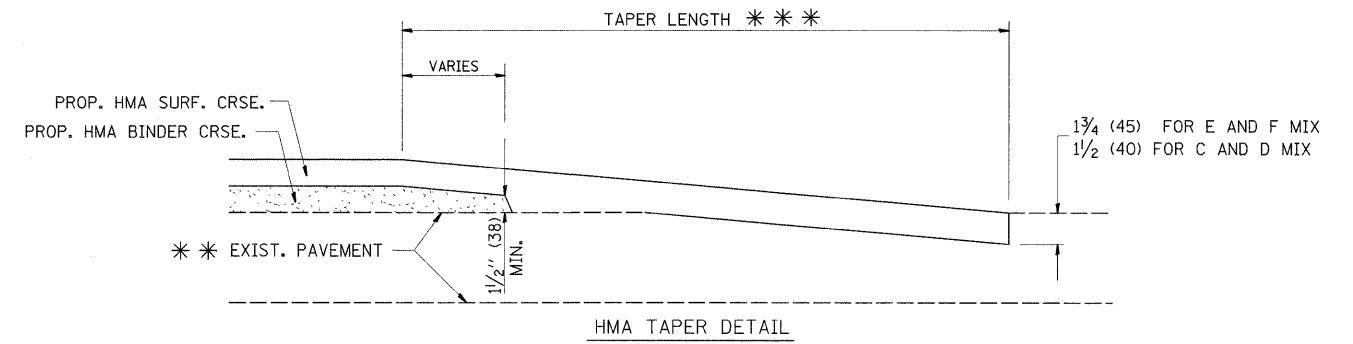

HMA TAPER DETAIL

**TYPICAL BUTT JOINT AND HMA TAPER  
FOR RESURFACING ONLY**

\*\*\* PC CONCRETE, HMA OR HMA RESURFACED PAVEMENT.

**NOTES**

- A: MAINLINE ROADWAYS AND MAJOR SIDE ROADS.
  - B: MINOR SIDE ROADS.
  - C: THE TEMP. RAMP SHALL BE CONSTRUCTED IMMEDIATELY UPON REMOVAL OF THE EXISTING HMA SURFACE.
  - D: THE BUTT JOINT SHALL BE CONSTRUCTED IMMEDIATELY PRIOR TO PLACING THE PROPOSED HMA COURSES.
  - E: TAPER THE TEMP. RAMP AT A RATE OF 3'-0" (900 mm) PER 1 INCH (25 mm) OF MILLING THICKNESS.
  - F: INSTALLATION AND REMOVAL OF THE 4'-6" (1.35 m) TEMP. RAMP IS INCLUDED IN COST OF HMA SURFACE REMOVAL - BUTT JOINT
  - G: SEE ARTICLE 406.08 AND 406.14 OF THE STANDARD SPECIFICATIONS FOR "HMA AND/OR PCC SURFACE REMOVAL, BUTT JOINT".
- \* SEE TYPICAL SECTIONS FOR MILLING THICKNESS.
- \*\*\* 20'-0" (6.1 m) PER 1 (25) RESURFACING (NOTE "A")  
10'-0" (3.0 m) PER 1 (25) RESURFACING (NOTE "B")

**BASIS OF PAYMENT:**

THE BUTT JOINT WILL BE PAID FOR AT THE CONTRACT UNIT PRICE PER SQUARE YARD (SQUARE METER) FOR "HOT-MIX ASPHALT SURFACE REMOVAL - BUTT JOINT" OR FOR "PORTLAND CEMENT CONCRETE SURFACE REMOVAL - BUTT JOINT".

ALL DIMENSIONS ARE IN INCHES (MILLIMETERS) UNLESS OTHERWISE SHOWN.

FILE NAME =	USER NAME = gulllaumefp	DESIGNED - M. DE YONG	REVISED - R. SHAH 10-25-94
ct:\pwork\pwork\gulllaumefp\d8137245\056209-shit-plan.dgn	56209-shit-plan.dgn	DRAWN -	REVISED - A. ABBAS 03-21-97
PLOT SCALE = 50.0000' / IN.	CHECKED -	REVISOR - M. GOMEZ 04-06-01	
PLOT DATE = 4/23/2009	DATE - 06-13-90	REVISED - R. BORO 01-01-07	

**STATE OF ILLINOIS  
DEPARTMENT OF TRANSPORTATION**

**BUTT JOINT AND  
HMA TAPER DETAILS**

SCALE: NONE	SHEET NO. 1 OF 1 SHEETS	STA.	TO STA.
-------------	-------------------------	------	---------

F.A. RTE.	SECTION	COUNTY	TOTAL SHEETS	SHEET NO.
CH 07	38 RS-6	WILL	19	13
BD400-05 BD32			CONTRACT NO. 60H06	
FED. ROAD DIST. NO. 1 ILLINOIS FED. AID PROJECT				

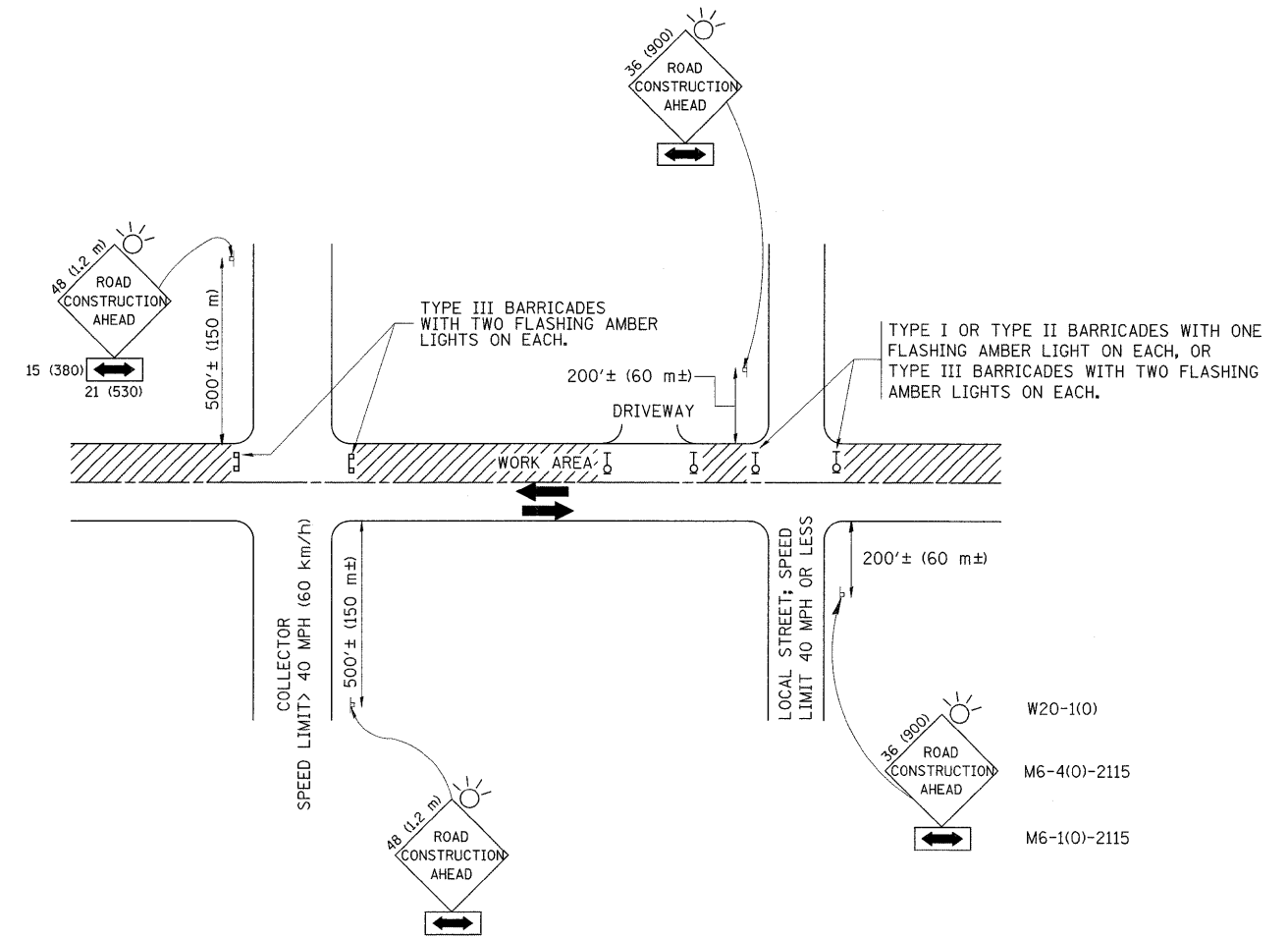

### TRAFFIC CONTROL AND PROTECTION FOR SIDE ROADS, INTERSECTIONS, AND DRIVEWAYS

#### NOTES:

##### A. FOR NO LANE RESTRICTION ON THE SIDE ROAD OR DRIVEWAYS

1. SIDE ROAD WITH A SPEED LIMIT OF 40 MPH (60 km/h) OR LESS AS SHOWN ON THE DRAWING AND AS DIRECTED BY THE ENGINEER:

a) ONE **ROAD CONSTRUCTION AHEAD** SIGN 36 x 36 (900x900) WITH A FLASHER AND FLAG MOUNTED ON IT APPROXIMATELY 200' (60 m) IN ADVANCE OF THE MAIN ROUTE.

b) THE CLOSED PORTION OF THE MAIN ROUTE SHALL BE PROTECTED BY BLOCKING WITH TYPE I, TYPE II OR TYPE III BARRICADES, 1/3 OF THE CROSS SECTION OF THE CLOSED PORTION.

2. SIDE ROAD WITH A SPEED LIMIT GREATER THAN 40 MPH (60 km/h) AS SHOWN ON THE DRAWING AND AS DIRECTED BY THE ENGINEER:

a) ONE **ROAD CONSTRUCTION AHEAD** SIGN 48 x 48 (1.2 m x 1.2 m) WITH A FLASHER MOUNTED ON IT APPROXIMATELY 500' (150 m) IN ADVANCE OF THE MAIN ROUTE.

b) THE CLOSED PORTION OF THE MAIN ROUTE SHALL BE PROTECTED BY BLOCKING WITH TYPE III BARRICADES, 1/2 OF THE CROSS SECTION OF THE CLOSED PORTION.

3. WHEN THE SIDE ROAD LIES BETWEEN THE BEGINNING OF THE MAINLINE SIGNING AND THE WORK ZONE, A SINGLE HEADED ARROW (M6-1) SHALL BE USED IN LIEU OF THE DOUBLE HEADED ARROW (M6-4).

##### B. FOR A LANE CLOSURE ON A SIDE ROAD OR DRIVEWAY:

USE APPLICABLE PORTIONS OF THE TYPICAL APPLICATION OF TRAFFIC CONTROL DEVICES (STD. 701501, STD. 701606 OR THE APPROPRIATE STANDARD). THE SPACING OF SIGNS AND BARRICADES SHALL BE ADJUSTED FOR FIELD CONDITIONS AS DIRECTED BY THE ENGINEER. THE DIRECTIONAL ARROW SHALL BE COVERED OR REMOVED WHEN NO LONGER CONSISTENT WITH THE SIDE ROAD LANE CLOSURE.

C. ADVANCE WARNING SIGNS ARE TO BE OMITTED ON DRIVEWAY UNLESS OTHERWISE NOTED.

D. THE TRAFFIC CONTROL AND PROTECTION FOR SIDE ROADS, INTERSECTIONS, AND DRIVEWAYS SHALL BE INCIDENTAL TO THE COST OF SPECIFIED TRAFFIC CONTROL STANDARDS OR ITEMS.

All dimensions are in millimeters (inches) unless otherwise shown.

FILE NAME =	USER NAME = guillaumejp	DESIGNED - LHA	REVISED - J. OBERLE 10-18-95
cs:\pwork\pwork\guillaumejp\d0137245\	56209-shc-plan.dgn	DRAWN -	REVISED - A. HOUSEH 03-06-96
	PLOT SCALE = 50.0000' / IN.	CHECKED -	REVISED - A. HOUSEH 10-15-96
	PLOT DATE = 4/23/2009	DATE - 06-89	REVISED - T. RAMMACHER 01-06-00

STATE OF ILLINOIS  
DEPARTMENT OF TRANSPORTATION

TRAFFIC CONTROL AND PROTECTION FOR  
SIDE ROADS, INTERSECTIONS, AND DRIVEWAYS

F.A. RTE.	SECTION	COUNTY	TOTAL SHEETS	SHEET NO.
CH 07	38 RS-6	WILL	19	14
TC-10			CONTRACT NO. 60H06	
FED. ROAD DIST. NO. 1 ILLINOIS FED. AID PROJECT				

SCALE: NONE SHEET NO. 1 OF 1 SHEETS STA. TO STA.

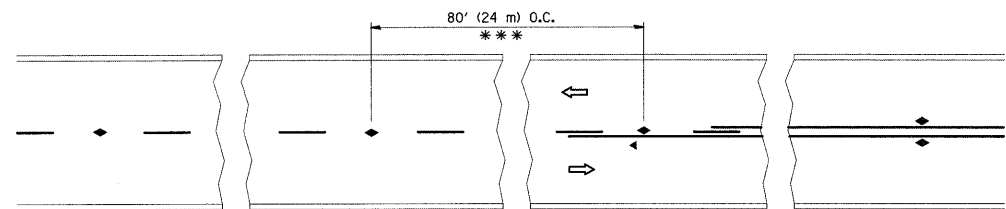

\*\*\* REDUCE TO 40' (12 m) O.C. ON CURVES WITH POSTED OR ADVISORY SPEED 45 M.P.H. (70 km/h) OR LESS.

TWO-LANE/TWO-WAY

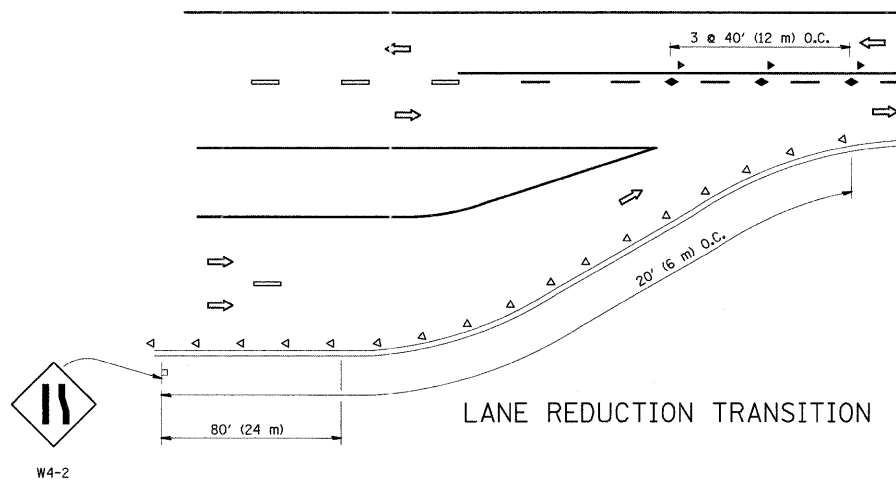

LANE REDUCTION TRANSITION

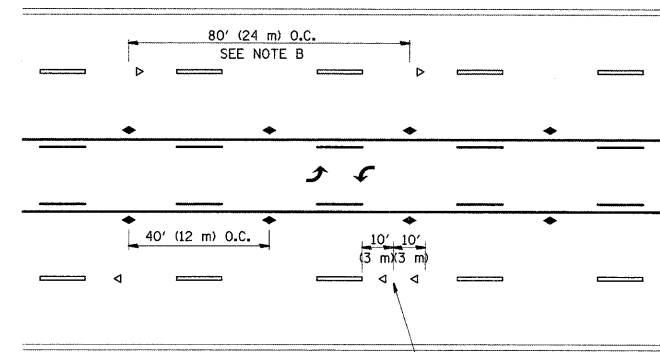

TWO-WAY LEFT TURN

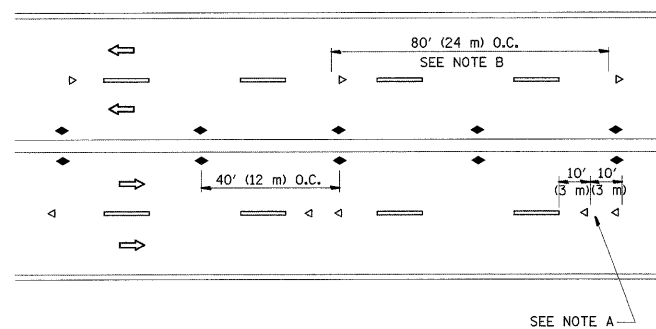

MULTI-LANE/UNDIVIDED

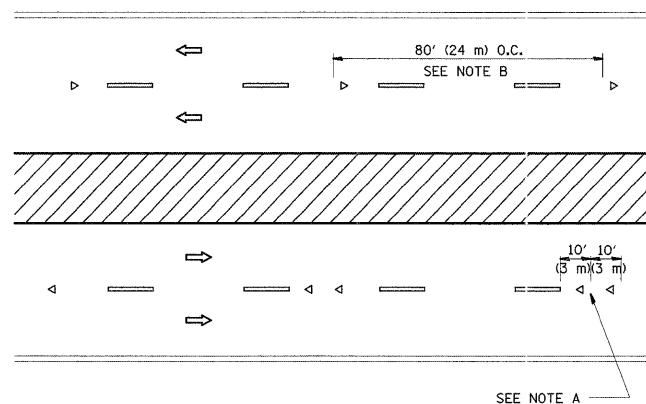

MULTI-LANE/DIVIDED

GENERAL NOTES

1. MARKERS USED WITH DASHED LINES SHALL BE CENTERED IN THE GAP BETWEEN SEGMENTS.
2. MARKERS USED ADJACENT TO SOLID LINES SHALL BE OFFSET 2 TO 3 (50 TO 75) TOWARD TRAFFIC AS SHOWN.
3. MARKERS THROUGH TANGENTS LESS THAN 500' (150 m) IN LENGTH BETWEEN CURVES SHALL BE INSTALLED AT THE LESSER OF THE TWO CURVE SPACINGS.

SYMBOLS

- YELLOW STRIPE
- WHITE STRIPE
- ◀ ONE-WAY AMBER MARKER
- ◁ ONE-WAY CRYSTAL MARKER (W/O)
- ◆ TWO-WAY AMBER MARKER

LANE MARKER NOTES

- B. REDUCE TO 40' (12 m) O.C. ON CURVES WHERE ADVISORY SPEEDS ARE 10 M.P.H. (20 km/h) LOWER THAN POSTED SPEEDS.
- A. USE DOUBLE LANE LINE MARKERS SPACED AS SHOWN.

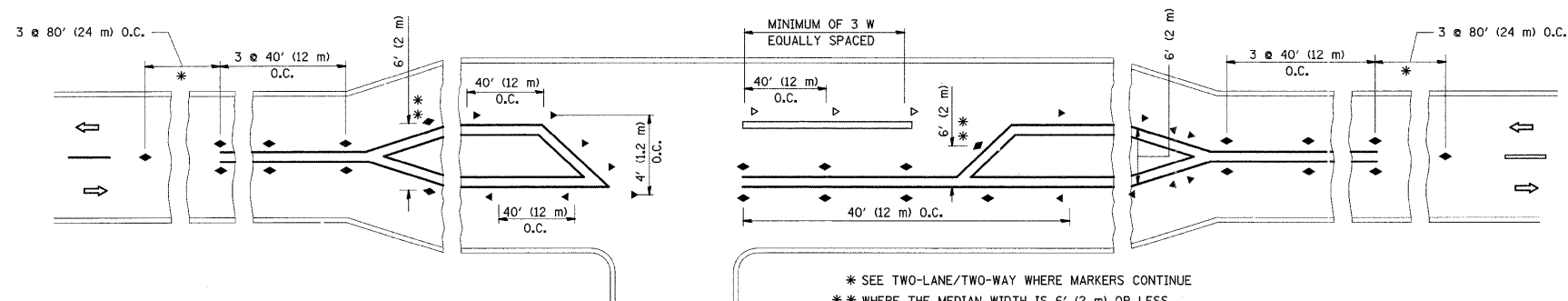

LEFT TURN

\* SEE TWO-LANE/TWO-WAY WHERE MARKERS CONTINUE  
 \*\* WHERE THE MEDIAN WIDTH IS 6' (2 m) OR LESS USE TWO-WAY MARKERS.



All dimensions are in Inches (millimeters) unless otherwise shown.



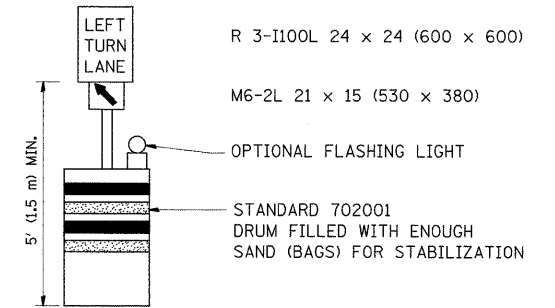
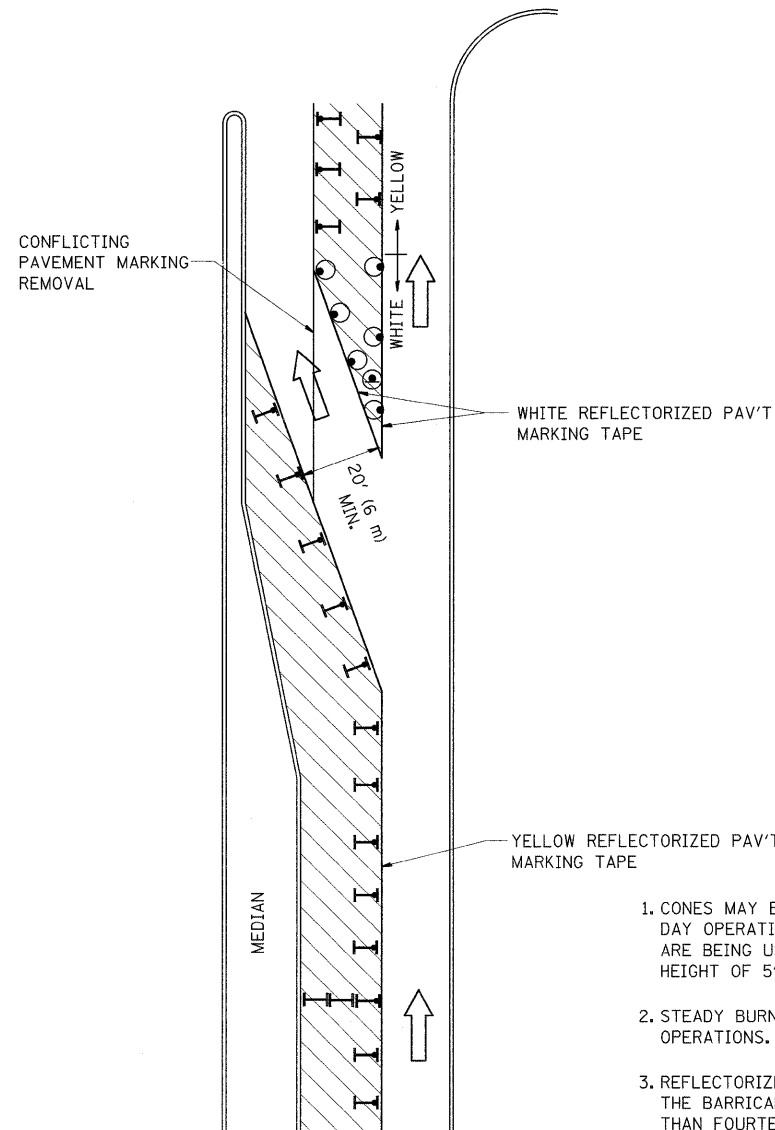

FILE NAME =	USER NAME = gulloumefp	DESIGNED -	REVISED - T. RAMMACHER 09-19-94	<b>STATE OF ILLINOIS DEPARTMENT OF TRANSPORTATION</b>	<b>TYPICAL APPLICATIONS RAISED REFLECTIVE PAVEMENT MARKERS (SNOW-PLOW RESISTANT)</b>			F.A. RTE.	SECTION	COUNTY	TOTAL SHEETS	SHEET NO.
ct:\pwork\pwsdot\gulloumefp\d0137245\	56209-shr-plan.dgn	DRAWN -	REVISED - T. RAMMACHER 03-12-99		CH 07	38 RS-6	WILL	19	15			
	PLOT SCALE = 50.0000 "/td> <td>CHECKED -</td> <td>REVISED - T. RAMMACHER 01-06-00</td> <td colspan="3" style="text-align: center;"><b>TC-11</b></td> <td colspan="3" style="text-align: center;"><b>CONTRACT NO. 60H06</b></td>	CHECKED -	REVISED - T. RAMMACHER 01-06-00		<b>TC-11</b>			<b>CONTRACT NO. 60H06</b>				
	PLOT DATE = 4/23/2009	DATE -	REVISED -		SCALE: NONE	SHEET NO. 1 OF 1 SHEETS	STA.	TO STA.	FED. ROAD DIST. NO. 1 (ILLINOIS) FED. AID PROJECT			

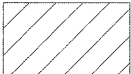
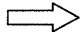

**GENERAL NOTES**

1. CONES MAY BE SUBSTITUTED FOR BARRICADES OR DRUMS AT HALF THE SPACING DURING DAY OPERATIONS. CONES SHALL BE A MINIMUM OF 28 (710) IN HEIGHT. WHEN CONES ARE BEING USED, THE "LEFT TURN LANE" SIGN MAY BE SKID MOUNTED AT A MINIMUM HEIGHT OF 5' (1.5 m).
2. STEADY BURNING LIGHTS WILL NOT BE REQUIRED ON BARRICADES OR DRUMS FOR DAY OPERATIONS. ALL LIGHTS SHALL BE MONODIRECTIONAL.
3. REFLECTORIZED TEMPORARY PAVEMENT MARKING TAPE SHALL BE PLACED THROUGHOUT THE BARRICADED AREA OF EACH TURN BAY WHERE THE CLOSURE TIME IS GREATER THAN FOURTEEN DAYS.
4. THIS APPLICATION ALSO APPLIES WHEN WORK IS BEING PERFORMED IN THE RIGHT LANE(S) AND THE RIGHT TURN BAY IS TO REMAIN OPEN. UNDER THIS CONDITION, "RIGHT TURN LANE" R3-100 24 x 24 (600 x 600) AND M6-2R 21 x 15 (530 x 380) SHALL BE USED.
5. THESE CONTROLS SHALL SUPPLEMENT MAINLINE TRAFFIC CONTROL FOR LANE CLOSURES.
6. LONGITUDINAL DIMENSIONS MAY BE ADJUSTED TO FIT FIELD CONDITIONS.
7. FORM BT 725 IS REQUIRED.
8. TRAFFIC CONTROL AND PROTECTION AT TURN BAYS (TO REMAIN OPEN TO TRAFFIC) SHALL BE INCLUDED IN THE COST SPECIFIED TRAFFIC CONTROL STANDARDS OR ITEMS.

**LEGEND**

-  WORK AREA
-  LANE OPEN TO TRAFFIC
-  TYPE I OR II BARRICADE WITH STEADY BURN LIGHT
-  DRUM WITH STEADY BURN LIGHT
-  DRUM WITH SIGN (WITH OPTIONAL FLASHING LIGHT) SEE DETAIL
-  TYPE I OR II CHECK BARRICADE WITH FLASHING LIGHT

All dimensions are in inches (millimeters) unless otherwise shown.

FILE NAME =	USER NAME = guillaumejp	DESIGNED -	REVISED -T. RAMMACHER 09-08-94
ct:\pw\work\pww\d01\guillaumejp\d0137245\056209-sht-plan.dgn		DRAWN -	REVISED - A. HOUSEH 11-07-95
		CHECKED -	REVISED - A. HOUSEH 10-12-96
		DATE -	REVISED -T. RAMMACHER 01-06-00

**STATE OF ILLINOIS  
DEPARTMENT OF TRANSPORTATION**

**TRAFFIC CONTROL AND PROTECTION AT TURN BAYS  
(TO REMAIN OPEN TO TRAFFIC)**

SCALE: NONE SHEET NO. 1 OF 1 SHEETS STA. TO STA.

F.A. RTE.	SECTION	COUNTY	TOTAL SHEETS	SHEET NO.
CH 07	38 RS-6	WILL	19	16
TC-14			CONTRACT NO. 60H06	
FED. ROAD DIST. NO. 1 ILLINOIS FED. AID PROJECT				



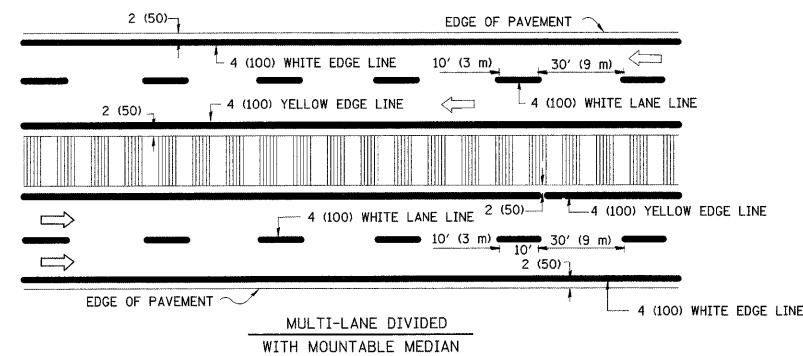
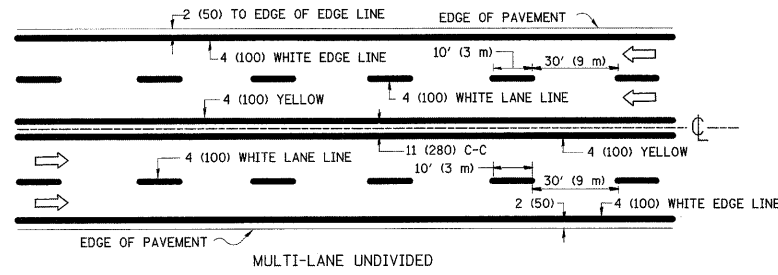
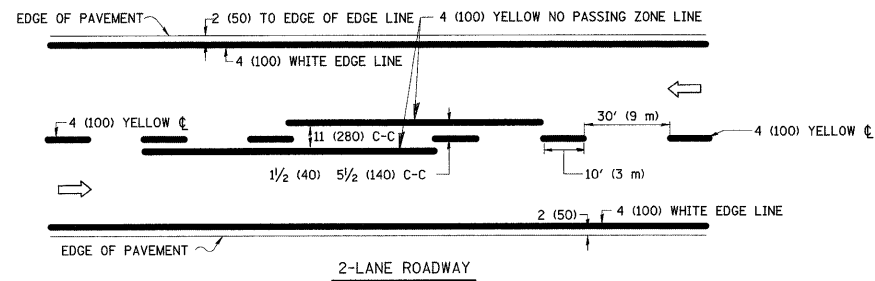

NOTE: MEDIANS WITH BARRIER CURB DO NOT REQUIRE AN EDGE LINE

### TYPICAL LANE AND EDGE LINE MARKING

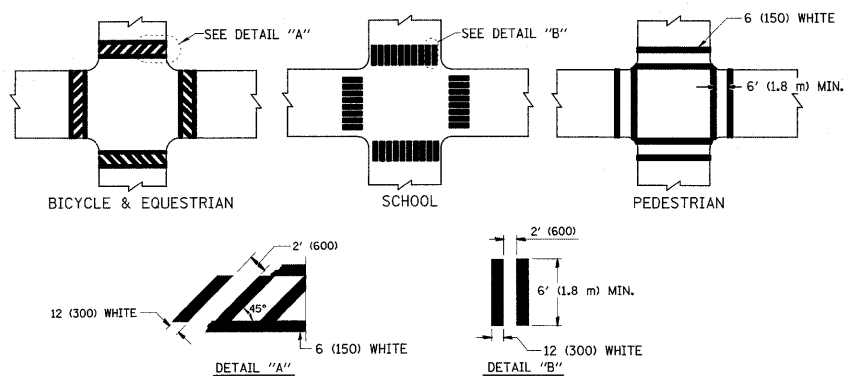

### TYPICAL CROSSWALK MARKING

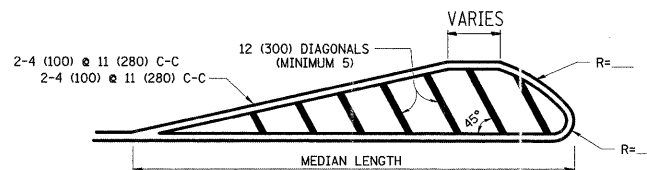
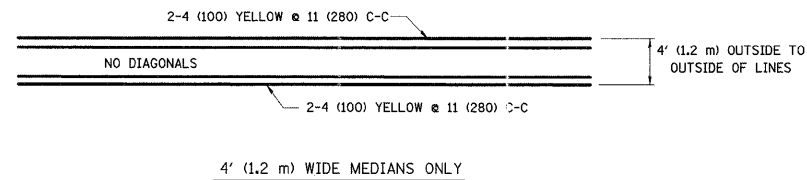

FOR MEDIAN LENGTHS WHERE DIAGONAL SPACING CANNOT BE ATTAINED, USE 5 (FIVE) EQUALLY SPACED DIAGONAL LINES.

DIAGONAL LINE SPACING: 50' (15 m) C-C (LESS THAN 30MPH (50 km/h))  
 75' (25 m) C-C 30MPH (50 km/h) TO 45MPH (70 km/h)  
 150' (45 m) C-C (MORE THAN 45MPH (70 km/h))

### MEDIANS OVER 4' (1.2 m) WIDE

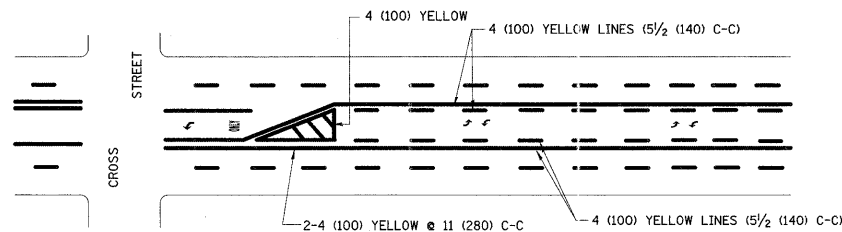

A MINIMUM OF TWO PAIRS OF TURN ARROWS SHALL BE USED, WHITE IN COLOR. ADDITIONAL PAIRS SHALL BE PLACED AT 200' (60 m) TO 300' (90 m) INTERVALS.

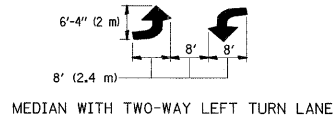

### TYPICAL PAINTED MEDIAN MARKING

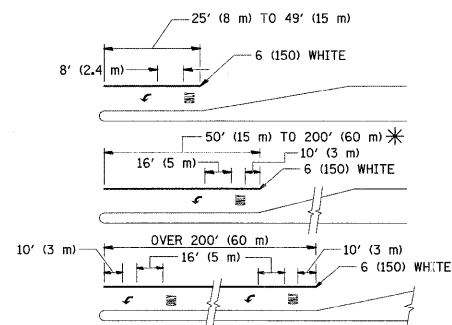

FULL SIZE LETTERS 8' (2.4 m) AND ARROWS SHALL BE USED.  
 AREA = 15.6 SQ. FT. (1.5 m<sup>2</sup>) AREA = 20.8 SQ. FT. (1.9 m<sup>2</sup>)

\* TURN LANES IN EXCESS OF 400' (120 m) IN LENGTH MAY HAVE AN ADDITIONAL SET OF ARROW - "ONLY" INSTALLED MIDWAY BETWEEN THE OTHER TWO SETS OF ARROW - "ONLY".

### TYPICAL LEFT (OR RIGHT) TURN LANE

### TYPICAL TURN LANE MARKING

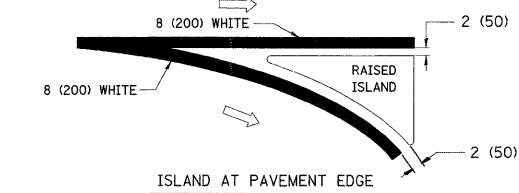
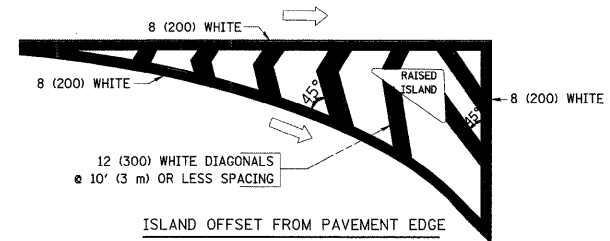

### TYPICAL ISLAND MARKING

TYPE OF MARKING	WIDTH OF LINE	PATTERN	COLOR	SPACING / REMARKS
CENTERLINE ON 2 LANE PAVEMENT	4 (100)	SKIP-DASH	YELLOW	10' (3 m) LINE WITH 30' (9 m) SPACE
CENTERLINE ON MULTI-LANE UNDIVIDED PAVEMENT	2 @ 4 (100)	SOLID	YELLOW	11 (280) C-C
NO PASSING ZONE LINES: FOR ONE DIRECTION FOR BOTH DIRECTIONS	4 (100) 2 @ 4 (100)	SOLID SOLID	YELLOW YELLOW	5/2 (140) C-C FROM SKIP-DASH CENTERLINE 11 (280) C-C OMIT SKIP-DASH CENTERLINE BETWEEN
LANE LINES	4 (100) 5 (125) ON FREEWAYS	SKIP-DASH SKIP-DASH	WHITE WHITE	10' (3 m) LINE WITH 30' (9 m) SPACE
DOTTED LINES (EXTENSIONS OF CENTER, LANE OR TURN LANE MARKINGS)	SAME AS LINE BEING EXTENDED	SKIP-DASH	SAME AS LINE BEING EXTENDED	2' (600) LINE WITH 6' (1.8 m) SPACE
EDGE LINES	4 (100)	SOLID	YELLOW-LEFT WHITE-RIGHT	OUTLINE MOUNTABLE MEDIANS IN YELLOW; EDGE LINES ARE NOT USED NEXT TO BARRIER CURB
TURN LANE MARKINGS	6 (150) LINE; FULL SIZE LETTERS & SYMBOLS (8' (2.4m))	SOLID	WHITE	SEE TYPICAL TURN LANE MARKING DETAIL
TWO WAY LEFT TURN MARKING	2 @ 4 (100) EACH DIRECTION 8' (2.4m) LEFT ARROW	SKIP-DASH AND SOLID IN PAIRS	YELLOW WHITE	10' (3 m) LINE WITH 30' (9 m) SPACE FOR SKIP-DASH 5/2 (140) C-C BETWEEN SOLID LINE AND SKIP-DASH LINE SEE TYPICAL TWO-WAY LEFT TURN MARKING DETAIL
CROSSWALK LINES (PEDESTRIAN) A. DIAGONALS (BIKE & EQUESTRIAN) B. LONGITUDINAL BARS (SCHOOL)	2 @ 6 (150) 12 (300) @ 45° 12 (300) @ 90°	SOLID SOLID SOLID	WHITE WHITE WHITE	NOT LESS THAN 6' (1.8 m) APART 2' (600) APART 2' (600) APART SEE TYPICAL CROSSWALK MARKING DETAILS.
STOP LINES	24 (600)	SOLID	WHITE	PLACE 4' (1.2 m) IN ADVANCE OF AND PARALLEL TO CROSSWALK, IF PRESENT. OTHERWISE, PLACE AT DESIRED STOPPING POINT, PARALLEL TO CROSSROAD CENTERLINE, WHERE POSSIBLE
PAINTED MEDIANS	2 @ 4 (100) WITH 12 (300) DIAGONALS @ 45° NO DIAGONALS USED FOR 4' (1.2 m) WIDE MEDIANS	SOLID	YELLOW: TWO WAY TRAFFIC WHITE: ONE WAY TRAFFIC	11 (280) C-C FOR THE DOUBLE LINE SEE TYPICAL PAINTED MEDIAN MARKING.
GORE MARKING AND CHANNELIZING LINES	8 (200) WITH 12 (300) DIAGONALS @ 45°	SOLID	WHITE	DIAGONALS: 15' (4.5 m) C-C (LESS THAN 30MPH (50 km/h)) 20' (6 m) C-C 30MPH (50 km/h) TO 45MPH (70 km/h) 30' (9 m) C-C (OVER 45MPH (70 km/h))
RAILROAD CROSSING	24 (600) TRANSVERSE LINES; "RR" IS 6' (1.8 m) LETTERS; 16 (400) LINE FOR "X"	SOLID	WHITE	SEE STATE STANDARD 780001 AREA OF: "R"=3.6 SQ. FT. (0.33 m <sup>2</sup> ) EACH "X"=54.0 SQ. FT. (5.0 m <sup>2</sup> )
SHOULDER DIAGONALS	12 (300) @ 45°	SOLID	WHITE - RIGHT YELLOW - LEFT	50' (15 m) C-C (LESS THAN 30MPH (50 km/h)) 75' (25 m) C-C (30 MPH (50 km/h) TO 45MPH (70 km/h)) 150' (45 m) C-C (OVER 45MPH (70 km/h))

FOR FURTHER DETAILS ON PAVEMENT MARKING REFER TO STANDARD SPECIFICATIONS FOR ROAD AND BRIDGE CONSTRUCTION AND STATE STANDARD 780001.

All dimensions are in inches (millimeters) unless otherwise shown.

FILE NAME =	USER NAME = guillaumeff	DESIGNED - EVERS	REVISED - T. RAMMACHER 10-27-94
c:\pwwork\pwwork\guillaumeff\d0137245\56209-shr-plan.dgn		DRAWN -	REVISED - A. HOUSEH 10-09-96
	PLOT SCALE = 50.0000' / IN.	CHECKED -	REVISED - A. HOUSEH 10-17-96
	PLOT DATE = 4/23/2009	DATE - 03-19-90	REVISED - T. RAMMACHER 01-06-00

STATE OF ILLINOIS  
DEPARTMENT OF TRANSPORTATION

DISTRICT ONE  
TYPICAL PAVEMENT MARKINGS

SCALE: NONE SHEET NO. 1 OF 1 SHEETS STA. TO STA.

F.A. RTE.	SECTION	COUNTY	TOTAL SHEETS	SHEET NO.
CH 07	38 RS-6	WILL	19	17
TC-13		CONTRACT NO. 60H06		
FED. ROAD DIST. NO. 1 ILLINOIS FED. AID PROJECT				

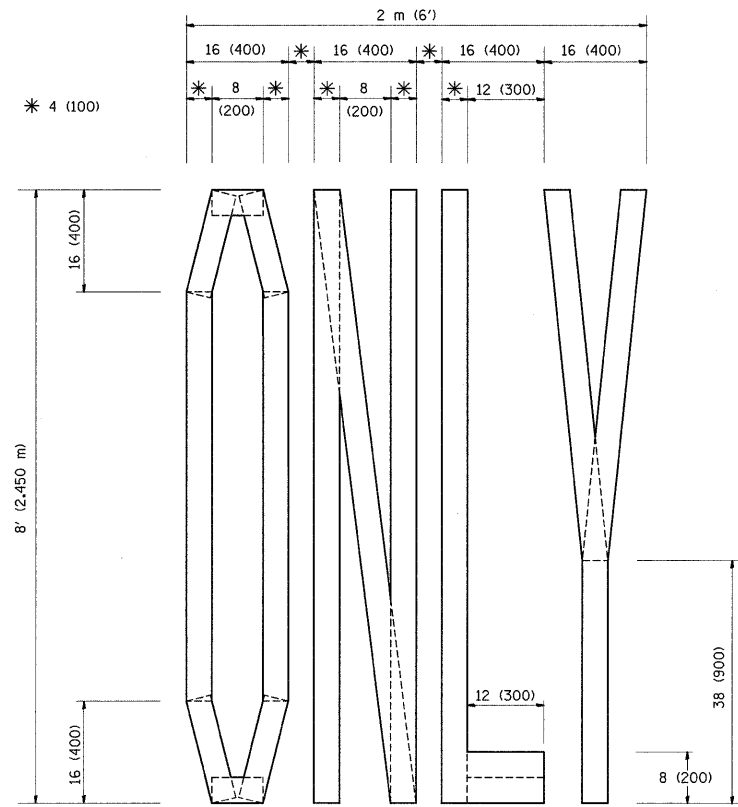

QUANTITY  
 4 (100) LINE = 64.1 ft. (19.7 m)  
 21.1 sq. ft. (1.97 sq. m)

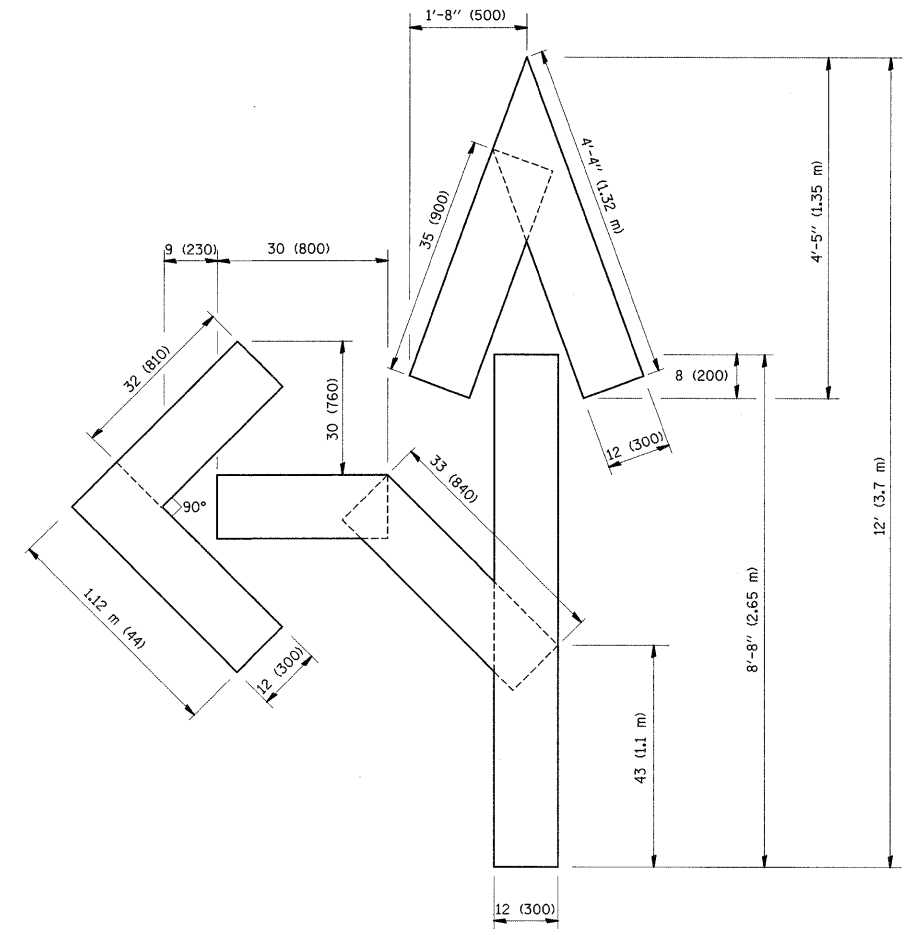

QUANTITY  
 4 (100) LINE = 82.5 ft. (25.3 m)  
 27.5 sq. ft. (2.53 sq. m)

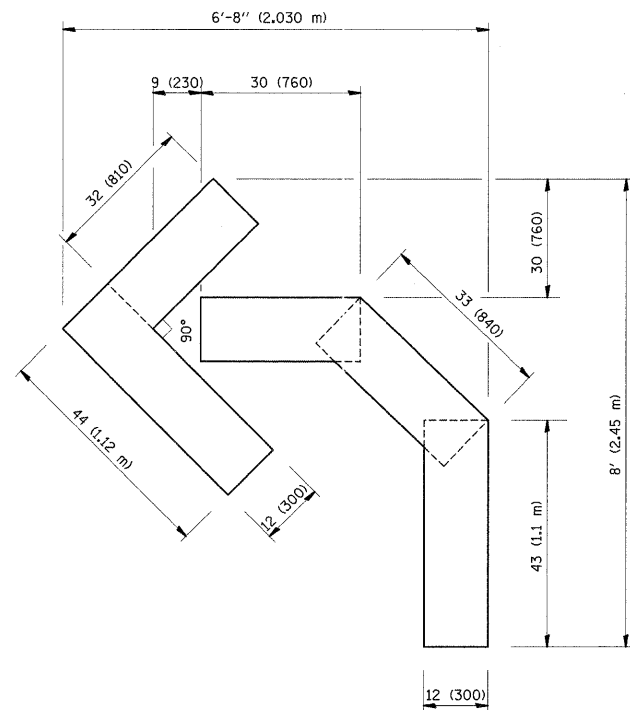

QUANTITY  
 4 (100) LINE = 45.5 ft. (13.9 m)  
 15.2 sq. ft. (1.39 sq. m)

All dimensions are in Inches (millimeters) unless otherwise shown.

FILE NAME =	USER NAME = guillaumefp	DESIGNED -	REVISED -T. RAMMACHER 06-05-96
cs:\pw_work\pwwidot\guillaumefp\d0137245\056209-sht-plan.dgn		DRAWN -	REVISED -T. RAMMACHER 11-04-97
		CHECKED -	REVISED -T. RAMMACHER 03-02-98
		DATE - 09-18-94	REVISED -E. GOMEZ 08-28-00

**STATE OF ILLINOIS  
 DEPARTMENT OF TRANSPORTATION**

**PAVEMENT MARKING LETTERS AND SYMBOLS  
 FOR TRAFFIC STAGING**

F.A. RTE.	SECTION	COUNTY	TOTAL SHEETS	SHEET NO.
CH 07	38 RS-6	WILL	19	18
TC-16			CONTRACT NO. 60H06	
FED. ROAD DIST. NO. 1 ILLINOIS FED. AID PROJECT				

SCALE: NONE SHEET NO. 1 OF 1 SHEETS STA. TO STA.

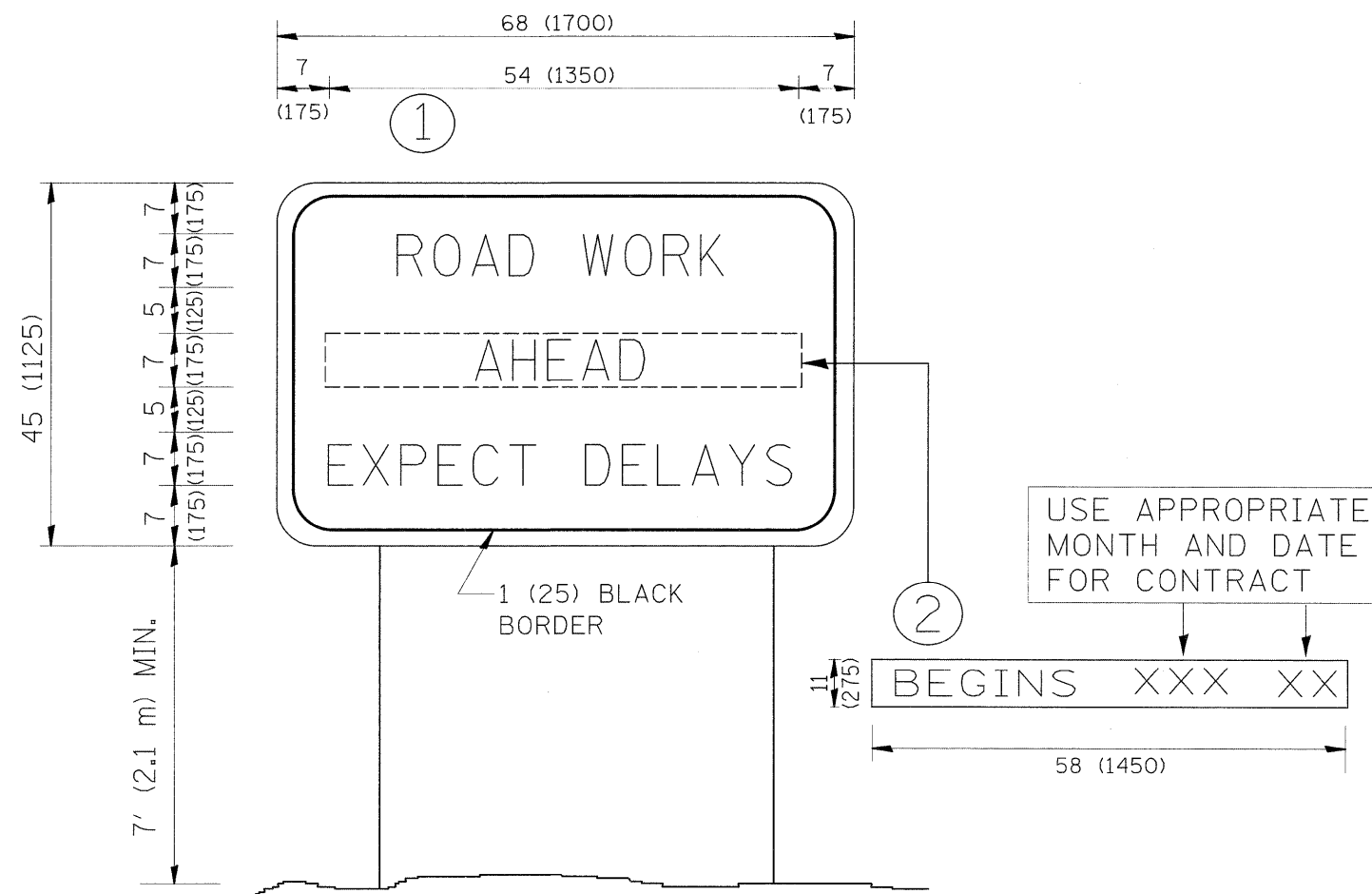

**NOTES:**

1. USE BLACK LETTERING ON ORANGE BACKGROUND.
2. ERECT SIGNS IN ADVANCE OF THE LOCATION FOR THE "ROAD CONSTRUCTION AHEAD" SIGN AT LOCATIONS AS DIRECTED BY THE ENGINEER.
3. ERECT SIGN ① WITH INSTALLED PANEL ② ONE WEEK PRIOR TO THE START OF CONSTRUCTION.
4. REMOVE PANEL ② SOON AFTER THE START OF CONSTRUCTION.
5. SEE SPECIAL PROVISION FOR "TEMPORARY INFORMATION SIGNING" FOR ADDITIONAL INFORMATION.
6. ONE SIGN ASSEMBLY EQUALS 25.70 SQ. FT. (2.3 SQ. M.)
7. SHALL BE PAID FOR AS TEMPORARY INFORMATION SIGNING.

ALL DIMENSIONS ARE IN INCHES (MILLIMETERS) UNLESS OTHERWISE SHOWN.

FILE NAME =	USER NAME = guillaumefp	DESIGNED -	REVISED - R. MIRS 09-15-97	<b>STATE OF ILLINOIS DEPARTMENT OF TRANSPORTATION</b>	<b>ARTERIAL ROAD INFORMATION SIGN</b>	F.A. RTE.	SECTION	COUNTY	TOTAL SHEETS	SHEET NO.	
ct:\pw_work\pwsidot\guillaumefp\d0137245\	56209-sht-plan.dgn	DRAWN -	REVISED - R. MIRS 12-11-97			CH 07	38 RS-6	WILL	19	19	
	PLOT SCALE = 50.0000 ' / IN.	CHECKED -	REVISED - T. RAMMACHER 02-02-99			<b>TC-22</b>		CONTRACT NO. 60H06			
	PLOT DATE = 4/23/2009	DATE -	REVISED - C. JUCIUS 01-31-07			SCALE: NONE	SHEET NO. 1 OF 1 SHEETS	STA.	TO STA.	FED. ROAD DIST. NO. 1 ILLINOIS FED. AID PROJECT	