

BEGIN IMPROVEMENTS  
STA. 98+58  
MATCH EXISTING  
PAVEMENT MARKINGS

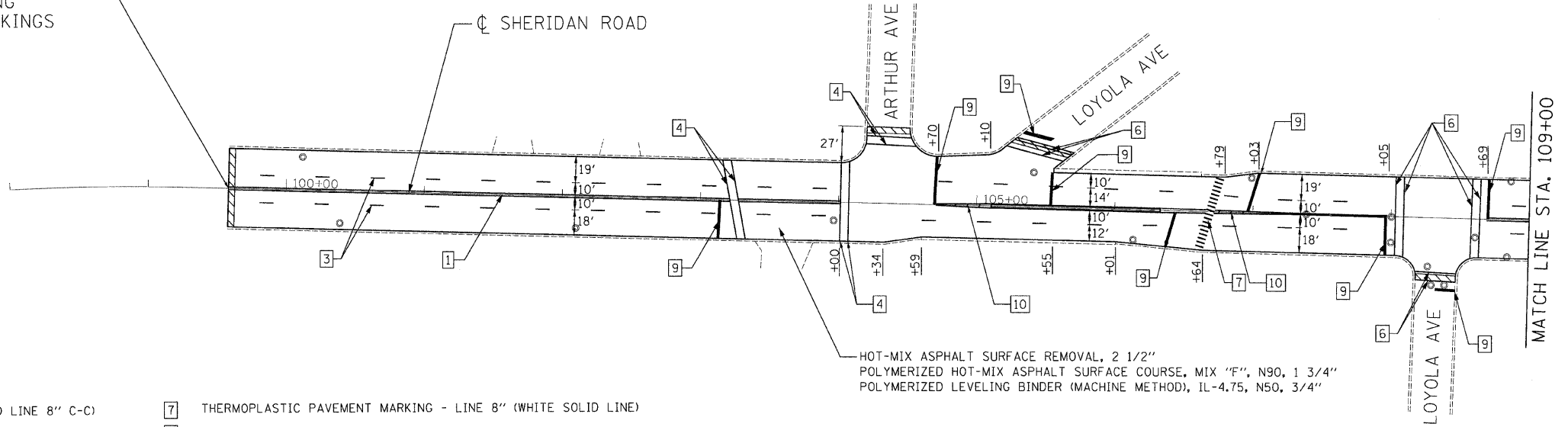
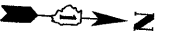

**LEGEND:**

- |  |   |
|--|---|
| 1 THERMOPLASTIC PAVEMENT MARKING - LINE 4" (DOUBLE YELLOW SOLID LINE 8" C-C)     | 7 THERMOPLASTIC PAVEMENT MARKING - LINE 8" (WHITE SOLID LINE)       |
| 2 THERMOPLASTIC PAVEMENT MARKING - LINE 4" (YELLOW SOLID LINE)                   | 8 THERMOPLASTIC PAVEMENT MARKING - LINE 8" (WHITE DIAGONAL LINE)    |
| 3 THERMOPLASTIC PAVEMENT MARKING - LINE 4" (WHITE LANE LINE - 6' DASH, 18' SKIP) | 9 THERMOPLASTIC PAVEMENT MARKING - LINE 24" (WHITE STOP LINE)       |
| 4 THERMOPLASTIC PAVEMENT MARKING - LINE 4" (WHITE SOLID LINE)                    | 10 THERMOPLASTIC PAVEMENT MARKING - LINE 12" (YELLOW DIAGONAL LINE) |
| 5 THERMOPLASTIC PAVEMENT MARKING - LINE 6" (WHITE LANE LINE - 2' DASH, 6' SKIP)  | 11 THERMOPLASTIC PAVEMENT MARKING - LETTERS AND SYMBOLS (TYP.)      |
| 6 THERMOPLASTIC PAVEMENT MARKING - LINE 6" (WHITE SOLID LINE)                    |   |

HOT-MIX ASPHALT SURFACE REMOVAL, 2 1/2"  
POLYMERIZED HOT-MIX ASPHALT SURFACE COURSE, MIX "F", N90, 1 3/4"  
POLYMERIZED LEVELING BINDER (MACHINE METHOD), IL-4.75, N50, 3/4"

HOT-MIX ASPHALT SURFACE REMOVAL - BUTT JOINT  
TEMPORARY RAMP

MATCH LINE STA. 109+00

FILE NAME = c:\p09\13363\3363-17.dwg; user = jpr; plot date = 4/21/2009

MATCH LINE STA. 109+00

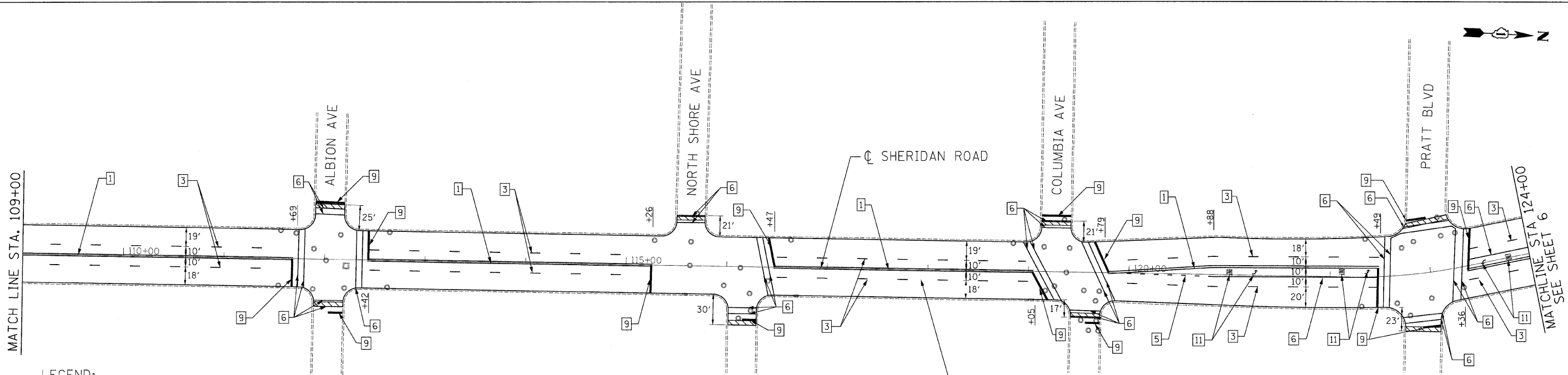

**LEGEND:**

- |  |   |
|--|---|
| 1 THERMOPLASTIC PAVEMENT MARKING - LINE 4" (DOUBLE YELLOW SOLID LINE 8" C-C)     | 7 THERMOPLASTIC PAVEMENT MARKING - LINE 8" (WHITE SOLID LINE)       |
| 2 THERMOPLASTIC PAVEMENT MARKING - LINE 4" (YELLOW SOLID LINE)                   | 8 THERMOPLASTIC PAVEMENT MARKING - LINE 8" (WHITE DIAGONAL LINE)    |
| 3 THERMOPLASTIC PAVEMENT MARKING - LINE 4" (WHITE LANE LINE - 6' DASH, 18' SKIP) | 9 THERMOPLASTIC PAVEMENT MARKING - LINE 24" (WHITE STOP LINE)       |
| 4 THERMOPLASTIC PAVEMENT MARKING - LINE 4" (WHITE SOLID LINE)                    | 10 THERMOPLASTIC PAVEMENT MARKING - LINE 12" (YELLOW DIAGONAL LINE) |
| 5 THERMOPLASTIC PAVEMENT MARKING - LINE 6" (WHITE LANE LINE - 2' DASH, 6' SKIP)  | 11 THERMOPLASTIC PAVEMENT MARKING - LETTERS AND SYMBOLS (TYP.)      |
| 6 THERMOPLASTIC PAVEMENT MARKING - LINE 6" (WHITE SOLID LINE)                    |   |

HOT-MIX ASPHALT SURFACE REMOVAL, 2 1/2"  
POLYMERIZED HOT-MIX ASPHALT SURFACE COURSE, MIX "F", N90, 1 3/4"  
POLYMERIZED LEVELING BINDER (MACHINE METHOD), IL-4.75, N50, 3/4"

HOT-MIX ASPHALT SURFACE REMOVAL - BUTT JOINT  
TEMPORARY RAMP

MATCHLINE STA 124+00  
SEE SHEET 6

**Ciorba Group, Inc.**  
CONSULTING ENGINEERS  
5507 North Cumberland Avenue, Suite 402  
Chicago, Illinois 60656  
Tel. 773.775.4009 Fax 773.775.4014

USER NAME = alau	DESIGNED - MT	REVISED -
PLOT SCALE = 50.0000' / IN.	DRAWN - MT	REVISED -
PLOT DATE = 4/21/2009	CHECKED - WBL	REVISED -
	DATE - 4/22/09	REVISED -

STATE OF ILLINOIS  
DEPARTMENT OF TRANSPORTATION

**SHERIDAN ROAD**  
ARTHUR AVENUE TO NORTH OF JUNEWAY TERRACE  
PROPOSED ROADWAY AND PAVEMENT MARKING PLAN  
SCALE: 1"=50' SHEET NO. 5 OF 18 SHEETS STA. TO STA.

F.A.U. RTE. 2865	SECTION 2829 RS-4	COUNTY COOK	TOTAL SHEETS 18	SHEET NO. 5
FED. ROAD DIST. NO. 1 ILLINOIS FED. AID PROJECT			CONTRACT NO. 60H10	