

EXIST. CURVE E_WELD-3
 PI STA. = 65+52.93
 $\Delta = 17^\circ 30' 22''$ (RT)
 $D = 9^\circ 32' 57''$
 $R = 600.00'$
 $T = 92.38'$
 $L = 183.32'$
 $E = 7.07'$
 $\theta =$
 T.R. =
 S.E. RUN =
 P.C. STA. = 64+60.55
 P.T. STA. = 66+43.87

① PROP. HMA SURFACE REMOVAL, 2 1/4"
 PROP. HMA SURFACE COURSE, MIX "D", N70, 1 1/2"
 PROP. POLY. LEVELING BINDER (MACHINE METHOD), IL-4.75, N50, 3/4"

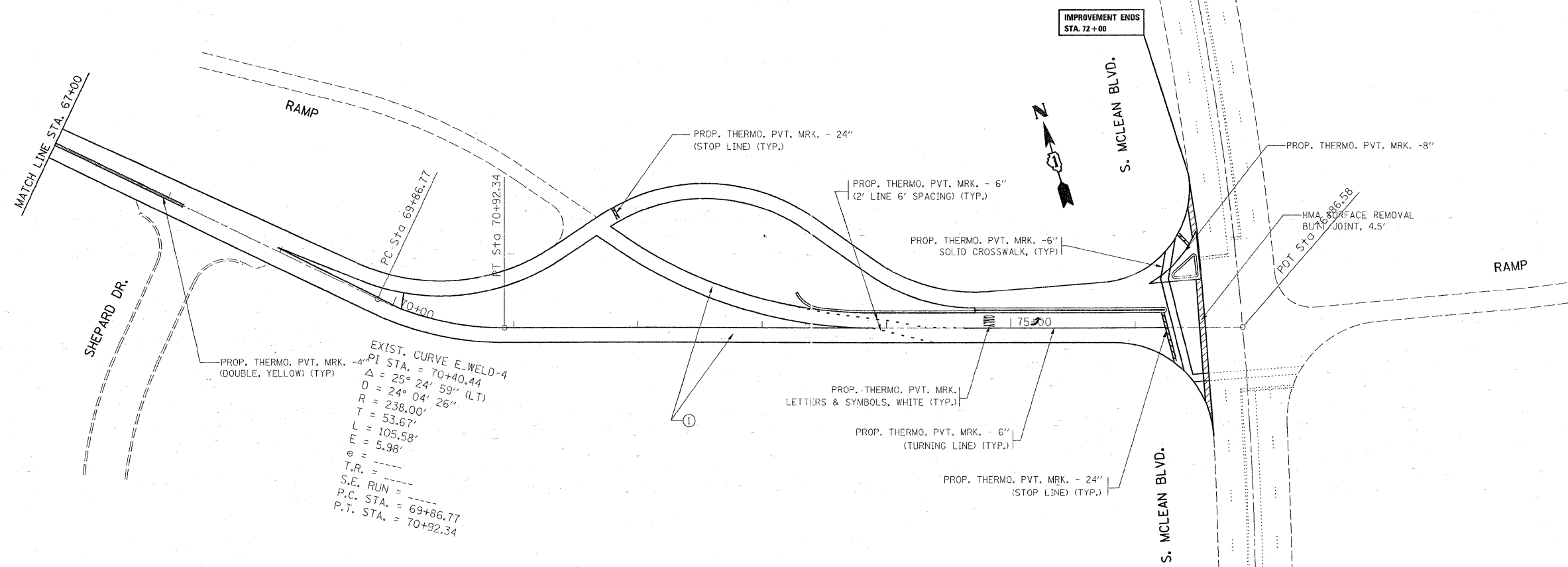

EXIST. CURVE E_WELD-4
 PI STA. = 70+40.44
 $\Delta = 25^\circ 24' 59''$ (LT)
 $D = 24^\circ 04' 26''$
 $R = 238.00'$
 $T = 53.67'$
 $L = 105.58'$
 $E = 5.98'$
 $\theta =$
 T.R. =
 S.E. RUN =
 P.C. STA. = 69+86.77
 P.T. STA. = 70+92.34

① PROP. HMA SURFACE REMOVAL, 2 1/4"
 PROP. HMA SURFACE COURSE, MIX "D", N70, 1 1/2"
 PROP. POLY. LEVELING BINDER (MACHINE METHOD), IL-4.75, N50, 3/4"

FILE NAME =
 c:\pw_work\pwido\estumablek\d0137730\DI

USER NAME = estumablek
 66889-shr-plan.dgn
 PLOT SCALE = 50.0000' / IN.
 PLOT DATE = 4/20/2009

DESIGNED -
 DRAWN -
 CHECKED -
 DATE -

REVISED -
 REVISED -
 REVISED -
 REVISED -

STATE OF ILLINOIS
 DEPARTMENT OF TRANSPORTATION

WELD RD. (RANDALL RD. TO MCLEAN BLVD)
 ROADWAY AND PAVEMENT MARKING PLAN

SCALE: SHEET NO. OF SHEETS STA. TO STA.

F.A.P. RTE. 345	SECTION 8R-IAC-RS	COUNTY KANE	TOTAL SHEETS 17	SHEET NO. 7
CONTRACT NO. 60H12				
FED. ROAD DIST. NO. [ILLINOIS] FED. AID PROJECT				