

PROPOSED THERMOPLASTIC PAVEMENT
MARKING- 4" SKIP-DASH (10' LINE-30' SPACE)- (TYP.)

PROPOSED THERMOPLASTIC PAVEMENT
MARKING- 6" SOLID WHITE TURN LANE - (TYP.)

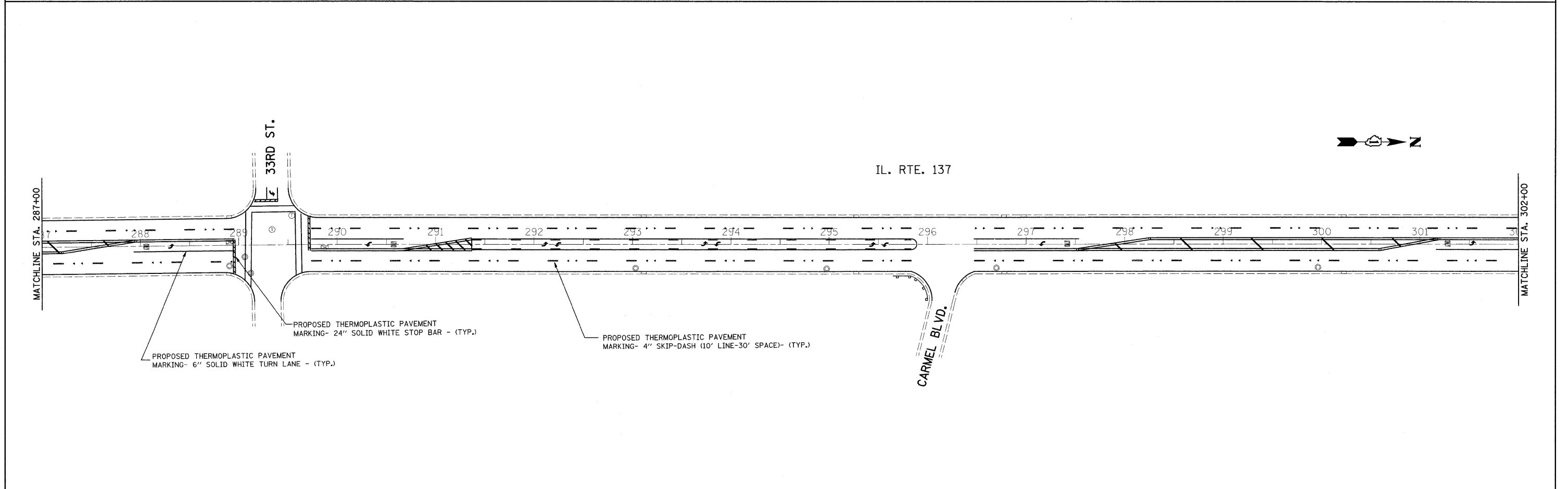

PROPOSED THERMOPLASTIC PAVEMENT
MARKING- 6" SOLID WHITE TURN LANE - (TYP.)

PROPOSED THERMOPLASTIC PAVEMENT
MARKING- 24" SOLID WHITE STOP BAR - (TYP.)

PROPOSED THERMOPLASTIC PAVEMENT
MARKING- 4" SKIP-DASH (10' LINE-30' SPACE)- (TYP.)

FILE NAME =
c:\pwwork\pwwork\guillaume\p\d0138202\0

USER NAME = guillaumefo
37202-shr-plan.dgn
PLOT SCALE = 50.0000' / IN.
PLOT DATE = 4/21/2009

DESIGNED -
DRAWN -
CHECKED -
DATE -

REVISED -
REVISED -
REVISED -
REVISED -

**STATE OF ILLINOIS
DEPARTMENT OF TRANSPORTATION**

**ROADWAY AND PAVEMENT MARKING PLAN
IL. RTE. 137 (BLANCHARD ROAD TO RUSSELL ROAD)**

SCALE: 1"=50' SHEET NO. OF SHEETS STA. 272+00 TO STA. 302+00

F.A.P. RTE. 352	SECTION (E.M.D) RS-4	COUNTY LAKE	TOTAL SHEETS 41	SHEET NO. 9
CONTRACT NO. 62545				
FED. ROAD DIST. NO. ILLINOIS FED. AID PROJECT				