

F.A.S. RTE.	SECTION	COUNTY	TOTAL SHEETS	SHEET NO.
2320/239	43RS-1	WILL	21	1
		ILLINOIS	CONTRACT NO. 62688	

STATE OF ILLINOIS  
DEPARTMENT OF TRANSPORTATION  
DIVISION OF HIGHWAYS

**PROPOSED  
HIGHWAY PLANS**

FAS ROUTE 299 (IL. RTE. 113)  
IL. RTE. 53 TO RIVER RD.  
SECTION 43RS-1  
RESURFACING  
WILL COUNTY

C-91-066-04

FOR INDEX OF SHEETS, SEE SHEET NO. 2

IMPROVEMENT LOCATED IN THE VILLAGE OF  
BRAIDWOOD & UNINCORPORATED WILL COUNTY

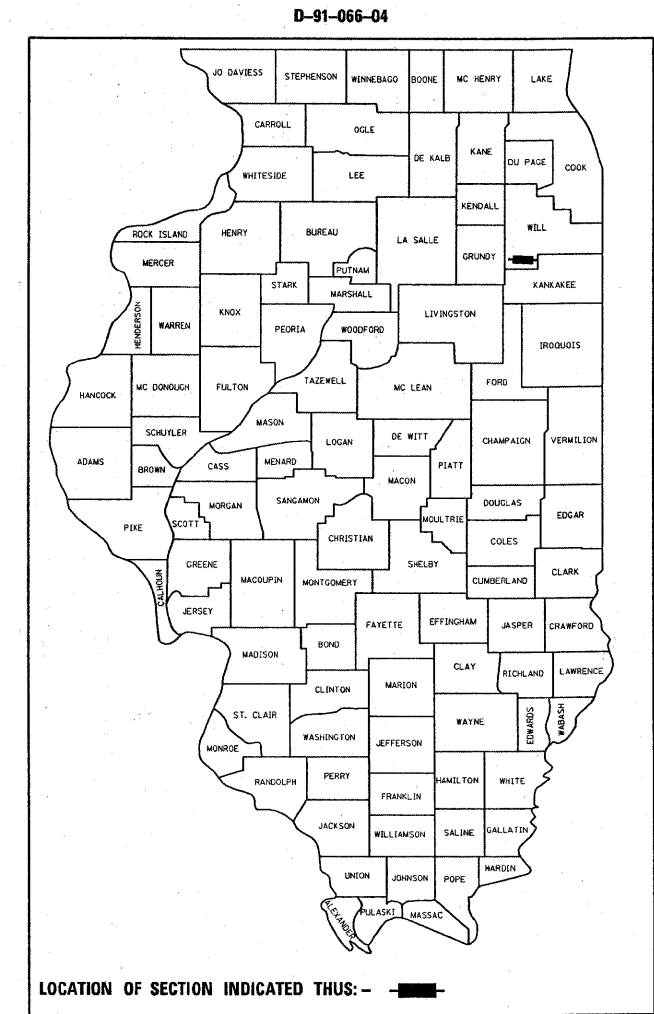

LOCATION OF SECTION INDICATED THUS: - [black rectangle] -

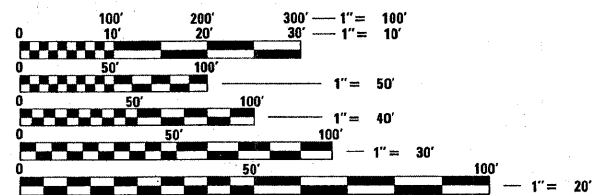

FULL SIZE PLANS HAVE BEEN PREPARED USING STANDARD ENGINEERING SCALES. REDUCED SIZED PLANS WILL NOT CONFORM TO STANDARD SCALES. IN MAKING MEASUREMENTS ON REDUCED PLANS, THE ABOVE SCALES MAY BE USED.

J.U.L.I.E.  
JOINT UTILITY LOCATION INFORMATION FOR EXCAVATION  
1-800-892-0123  
OR 811

PROJECT ENGINEER: JENPAI CHANG - (847) 705-4432  
PROJECT MANAGER: KEN ENG

CONTRACT NO. 62688

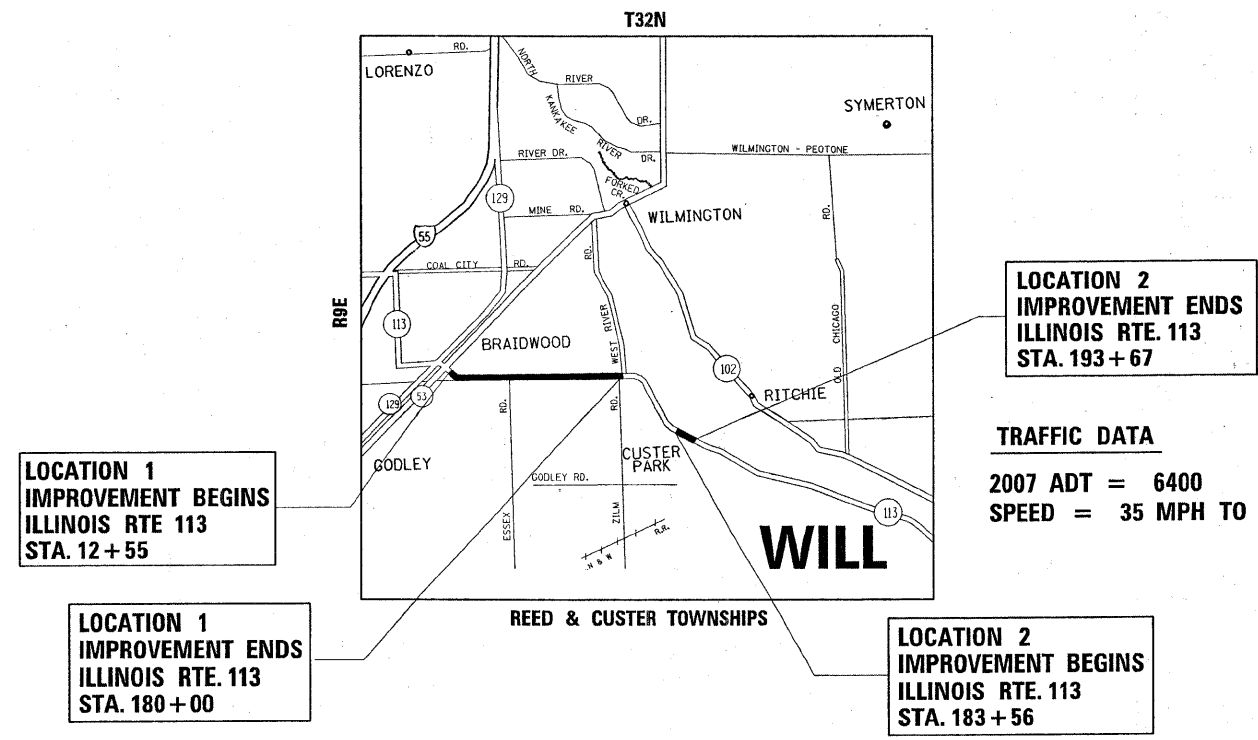

LOCATION 1  
IMPROVEMENT BEGINS  
ILLINOIS RTE 113  
STA. 12+55

LOCATION 1  
IMPROVEMENT ENDS  
ILLINOIS RTE. 113  
STA. 180+00

LOCATION 2  
IMPROVEMENT ENDS  
ILLINOIS RTE. 113  
STA. 193+67

TRAFFIC DATA  
2007 ADT = 6400  
SPEED = 35 MPH TO 55 MPH

LOCATION 2  
IMPROVEMENT BEGINS  
ILLINOIS RTE. 113  
STA. 183+56

LOCATION 1 GROSS AND NET LENGTH OF IMPROVEMENT = 16,745 FEET (3.17 MILES)  
LOCATION 2 GROSS AND NET LENGTH OF IMPROVEMENT = 1,011 FEET (0.19 MILE)

STATE OF ILLINOIS  
DEPARTMENT OF TRANSPORTATION  
DIVISION OF HIGHWAYS

SUBMITTED April 20 2009  
[Signature]  
DEPUTY DIRECTOR OF HIGHWAYS, REGION ENGINEER

May 1 2009  
[Signature]  
ENGINEER OF DESIGN AND ENVIRONMENT

May 1 2009  
[Signature]  
DIRECTOR OF HIGHWAYS, CHIEF ENGINEER

**PRINTED BY THE AUTHORITY  
OF THE STATE OF ILLINOIS**

**INDEX OF SHEETS**

SHEET NO.	DESCRIPTION
1	COVER SHEET
2	INDEX OF SHEETS, GENERAL NOTES AND STATE STANDARDS
3	SUMMARY OF QUANTITY
4-5	EXISTING AND PROPOSED TYPICAL SECTIONS
6-12	ROADWAY AND PAVEMENT MARKING PLANS
13	DETAILS FOR FRAMES AND LIDS ADJUSTMENT WITH MILLING
14	PAVEMENT PATCHING FOR HMA SURFACED PAVEMENT
15	CURB OR CURB AND GUTTER REMOVAL AND REPLACEMENT
16	BUTT JOINT AND HMA TAPER DETAILS
17	TRAFFIC CONTROL AND PROTECTION FOR SIDE ROADS, INTERSECTIONS AND DRIVEWAYS
18	TYPICAL APPLICATIONS RAISED REFLECTIVE PAVEMENT MARKERS
19	DISTRICT ONE TYPICAL PAVEMENT MARKINGS
20	PAVEMENT MARKING LETTERS AND SYMBOLS FOR TRAFFIC STAGING
21	ARTERIAL INFORMATION SINGING

**STANDARDS**

SHEET NO.	DESCRIPTION
000001-05	STANDARD SYMBOLS, ABBREVIATIONS AND PATTERNS
442201-03	CLASS C AND D PATCHES
606001-04	CONCRETE CURB AND COMBINATION CONCRETE CURB AND GUTTER
701301-03	LANE CLOSURE, 2L, 2W, SHORT TIME OPERATIONS
701311-03	LANE CLOSURE, 2L, 2W, MOVING OPERATIONS - DAY ONLY
701501-05	LANE CLOSURE, 2L, 2W, UNDIVIDED
701901-01	TRAFFIC CONTROL DEVICES

**PLAN NOTES**

BEFORE STARTING ANY EXCAVATION, THE CONTRACTOR SHALL CALL "JULIE" AT 1-800-892-0123 OR 811 FOR FIELD LOCATIONS OF BURIED ELECTRIC, TELEPHONE, AND GAS FACILITIES. (48 HOUR NOTIFICATION IS REQUIRED)

THE CONTRACTOR SHALL COORDINATE CONSTRUCTION ACTIVITIES WITH UTILITY COMPANIES, THE VILLAGE OF BRIADWOOD AND WILL COUNTY.

THE CONTRACTOR WILL NOT BE ALLOWED TO SET UP A YARD OR FIELD OFFICE ON STATE PROPERTY WITHOUT WRITTEN PERMISSIONS FROM THE DEPARTMENT.

WHEN MILLED PAVEMENT IS OPEN TO TRAFFIC THE MAXIMUM GRADE DIFFERENTIAL BETWEEN PASSES OF THE MILLING MACHINE SHALL NOT EXCEED 1 1/2 INCHES WHERE THE SPEED LIMIT IS 45 MPH OR LESS AND 1 INCH WHERE THE SPEED LIMIT IS GREATER THAN 45 MPH. WITH WRITTEN APPROVAL FROM THE ENGINEER, A MAXIMUM GRADE DIFFERENTIAL OF 3 INCHES MAY BE ALLOWED IF THE EDGE OF THE MILLING SLOPED A MINIMUM 1:3 (V:H).

BUTT JOINTS WILL BE INSTALLED AT THE ENDS OF ALL RESURFACING (WHERE RESURFACING MEETS EXISTING PAVEMENT), IN ACCORDANCE WITH THE "BUTT JOINT AND HMA TAPER DETAILS," SHEET INCLUDED IN THE PLANS, UNLESS OTHERWISE SPECIFIED.

THE RESIDENT ENGINEER SHALL CONTACT MR. CORY JUCIUS, AREA TRAFFIC FIELD ENGINEER AT (815)485-6475 A MINIMUM OF 72 HOURS PRIOR TO PLACEMENT OF PERMANENT PAVEMENT MARKINGS.

THE RESIDENT ENGINEER SHALL CONTACT THE TRAFFIC CONTROL SUPERVISOR AT (847) 705-4470 A MINIMUM OF 72 HOURS PRIOR TO THE INSTALLATION OF ANY TEMPORARY TRAFFIC CONTROL DEVICES.

LOCATIONS OF CLASS D PATCHING TO BE DETERMINED IN THE FIELD BY THE RESIDENT ENGINEER.

FILE NAME =	USER NAME = smsthk1	DESIGNED -	REVISED -	<b>STATE OF ILLINOIS DEPARTMENT OF TRANSPORTATION</b>	<b>IL. RTE. 113 (IL RTE 53 TO RIVER ST. &amp; N. OF HORSE CREEK TO GRANT ST.) INDEX OF SHEETS, LIST OF STATE STANDARDS &amp; PLAN NOTES</b>	F.A.S. RTE. 2320/ 288	SECTION	COUNTY	TOTAL SHEETS	SHEET NO.
ct:\pwork\p\100T\SMITHKL\08138047\0104-sht-plan.dgn	PLOT SCALE = 50.0000' / IN.	DRAWN -	REVISED -			43RS-1	WILL	21	2	
PLOT DATE = 4/21/2009	DATE -	CHECKED -	REVISED -			CONTRACT NO. 62688		ILLINOIS FED. AID PROJECT		
						SCALE:	SHEET NO.	OF	SHEETS	STA.

SUMMARY OF QUANTITIES			URBAN 100% STATE TOTAL QUANTITIES	CONSTRUCTION TYPE CODE					SUMMARY OF QUANTITIES			URBAN 100% STATE TOTAL QUANTITIES	CONSTRUCTION TYPE CODE				
CODE NO	ITEM	UNIT		1000					CODE NO	ITEM	UNIT		1000				
20201006	GRADING AND SHAPING SHOULDERS	UNIT	170	170					* 78000600	THERMOPLASTIC PAVEMENT MARKING - LINE 12"	FOOT	185	185				
40600200	BITUMINOUS MATERIALS (PRIME COAT)	TON	42	42					* 78000650	THERMOPLASTIC PAVEMENT MARKING - LINE 24"	FOOT	50	50				
40600300	AGGREGATE (PRIME COAT)	TON	209	209					* 78100100	RAISED REFLECTIVE PAVEMENT MARKER	EACH	250	250				
40600400	MIXTURE FOR CRACKS, JOINTS, AND FLANGEWAYS	TON	27	27					78300200	RAISED REFLECTIVE PAVEMENT MARKER REMOVAL	EACH	220	220				
40600895	CONSTRUCTING TEST STRIP	EACH	1	1					X0322256	TEMPORARY INFORMATION SIGNING	SO FT	51.4	51.4				
40600982	HOT-MIX ASPHALT SURFACE REMOVAL - BUTT JOINT	SO YD	158	158					X4067107	POLYMERIZED LEVELING BINDER (MACHINE METHOD), IL-4.75, N50	TON	2055	2055				
40601005	HOT-MIX ASPHALT REPLACEMENT OVER PATCHES	TON	425	425					Z0018500	DRAINAGE STRUCTURES TO BE CLEANED	EACH	10	10				
40603340	HOT-MIX ASPHALT SURFACE COURSE, MIX "D", N70	TON	4385	4385													
42001300	PROTECTIVE COAT	SO YD	35	35													
44000158	HOT-MIX ASPHALT SURFACE REMOVAL, 2 1/4"	SO YD	52175	52175													
44001700	COMBINATION CONCRETE CURB AND GUTTER REMOVAL AND REPLACEMENT	FOOT	100	100													
44002212	HOT-MIX ASPHALT REMOVAL OVER PATCHES, 3"	SO YD	2525	2525													
44201753	CLASS D PATCHES, TYPE II, 9 INCH	SO YD	745	745													
44201757	CLASS D PATCHES, TYPE III, 9 INCH	SO YD	980	980													
44201759	CLASS D PATCHES, TYPE IV, 9 INCH	SO YD	400	400													
48102100	AGGREGATE WEDGE SHOULDER, TYPE B	TON	650	650													
55039700	STORM SEWERS TO BE CLEANED	FOOT	50	50													
60300305	FRAMES AND LIDS TO BE ADJUSTED	EACH	5	5													
60300310	FRAMES AND LIDS TO BE ADJUSTED (SPECIAL)	EACH	5	5													
67000400	ENGINEER'S FIELD OFFICE, TYPE A	CAL MO	6	6													
67100100	MOBILIZATION	L SUM	1	1													
70102620	TRAFFIC CONTROL AND PROTECTION, STANDARD 701501	L SUM	1	1													
70300100	SHORT-TERM PAVEMENT MARKING	FOOT	1522	1522													
70300220	TEMPORARY PAVEMENT MARKING - LINE 4"	FOOT	40730	40730													
70300240	TEMPORARY PAVEMENT MARKING - LINE 6"	FOOT	80	80													
70300260	TEMPORARY PAVEMENT MARKING - LINE 12"	FOOT	185	185													
70300280	TEMPORARY PAVEMENT MARKING - LINE 24"	FOOT	50	50													
* 78000200	THERMOPLASTIC PAVEMENT MARKING - LINE 4"	FOOT	40730	40730													
* 78000400	THERMOPLASTIC PAVEMENT MARKING - LINE 6"	FOOT	80	80													

FILE NAME =	USER NAME = smh/ml	DESIGNED -	REVISED -	<b>STATE OF ILLINOIS DEPARTMENT OF TRANSPORTATION</b>	<b>IL. RTE. 113 (IL RTE 53 TO RIVER ST. &amp; N. OF HORSE CREEK TO GRANT ST.) SUMMARY OF QUANTITIES</b>	F.A.S. RTE. 23207 289	SECTION 43RS-1	COUNTY WILL	TOTAL SHEETS 21	SHEET NO. 3	
CONTRACT NO. 62688	PLOT SCALE = 50,000' / IN.	CHECKED -	REVISED -			SCALE:	SHEET NO. OF SHEETS STA. TO STA.	FED. ROAD DIST. NO. 1 ILLINOIS FED. AID PROJECT			
PLOT DATE = 4/21/2009	DATE -	REVISED -	REVISED -								

\* SPECIALTY ITEMS

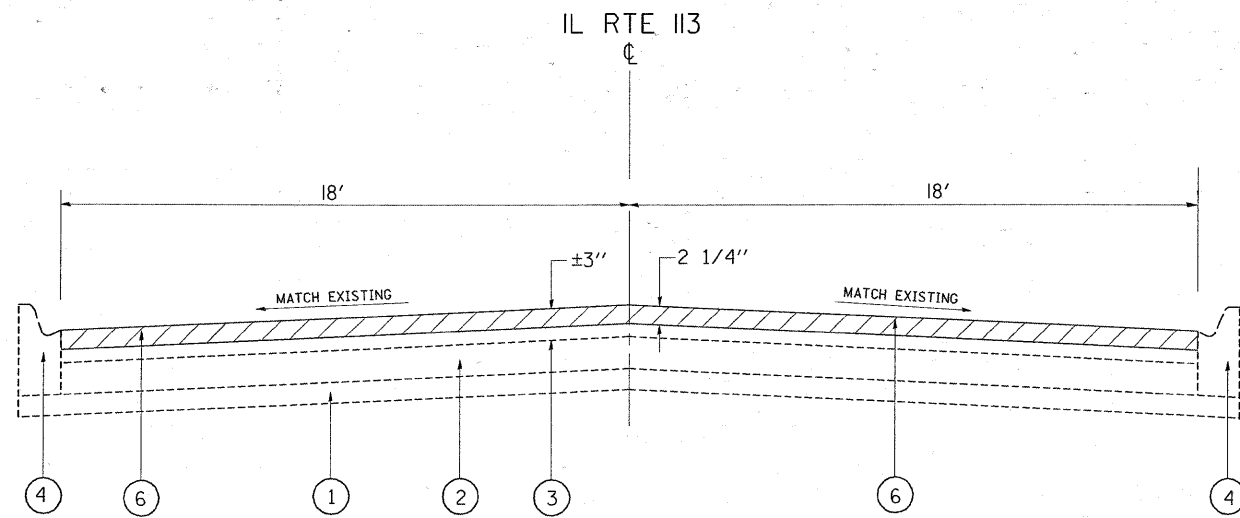

ILLINOIS ROUTE 113  
EXISTING TYPICAL SECTION  
LOCATION 1  
STA. 12+55 TO STA. 17+24

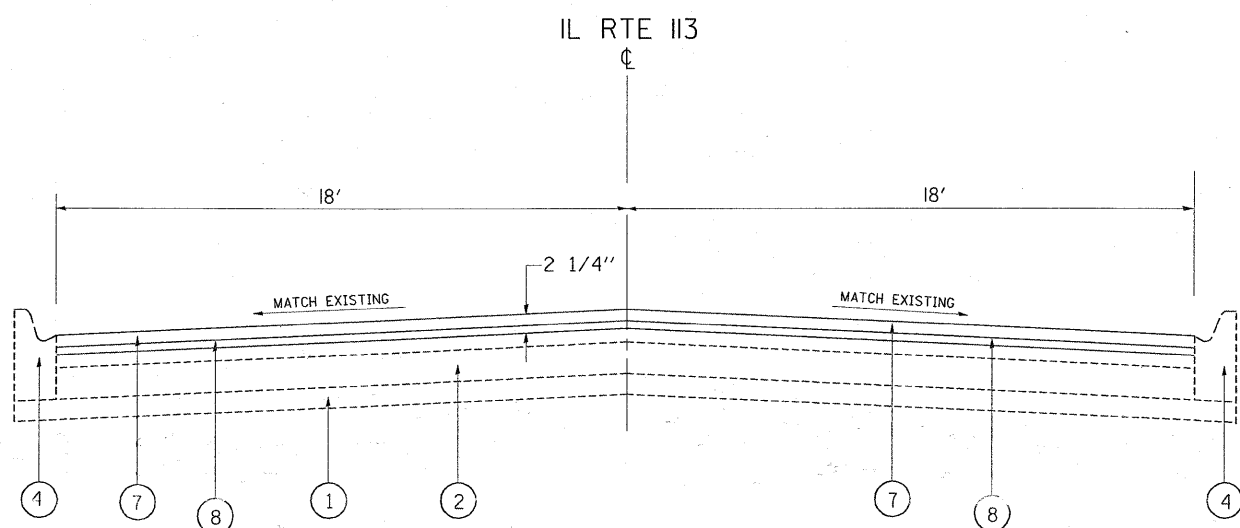

ILLINOIS ROUTE 113  
PROPOSED TYPICAL SECTION  
LOCATION 1  
STA. 12+55 TO STA. 17+24

**LEGEND**

- ① EXISTING AGGREGATE SUB-BASE
- ② EXISTING BASE COURSE, ±9"
- ③ EXISTING HOT-MIX ASPHALT OVERLAY, ±3"
- ④ EXISTING CONCRETE CURB & GUTTER, TYPE B-6.24
- ⑤ EXISTING AGGREGATE SHOULDER
- ⑥ PROPOSED HOT-MIX ASPHALT SURFACE REMOVAL 2 1/4"
- ⑦ PROPOSED HOT-MIX ASPHALT SURFACE COURSE, MIX "D", N70, 1 1/2 "
- ⑧ PROPOSED POLYMERIZED HOT-MIX ASPHALT LEVELING BINDER, (MM), IL-4.75, N50, 3/4"
- ⑨ PROPOSED AGGREGATE WEDGE SHOULDER, TYPE B
- ⑩ PROPOSED GRADING AND SHAPING SHOULDERS

**HOT-MIX ASPHALT MIXTURE REQUIREMENTS**

	MIXTURE USE	AC TYPE	AIR VOIDS (%)
ROADWAY	HOT-MIX ASPHALT SURFACE COURSE, MIX "D", N70 (IL 9.5 MM), 1 1/2 "	PG 64-22	4% @ 70 GYR
	POLYMERIZED LEVELING BINDER, (MM) IL-4.75, N50, 3/4"	SBS/SBR PG 76-28/-22	4% @ 50 GYR
PATCHES	CLASS D PATCHES, (BINDER IL-19.0 MM), 9"	PG 64-22 *	4% @ 70 GYR
	HOT-MIX ASPHALT REPLACEMENT OVER PATCHES, (BINDER IL-19.0 MM)	PG 64-22 *	4% @ 70 GYR

THE UNIT WEIGHT USED TO CALCULATE ALL HOT-MIX ASPHALT SURFACE MIXTURE QUANTITIES IS 112 LBS/SY/IN.

\* WHEN RAP EXCEEDS 20%, THE NEW ASPHALT BINDER IN THE MIX SHALL BE PG 58-22

NOTE:  
PAVEMENT PATCHING SHALL BE DONE PRIOR TO ROADWAY MILLING.  
SEE DISTRICT DETAIL BD-22.

IL RTE 113

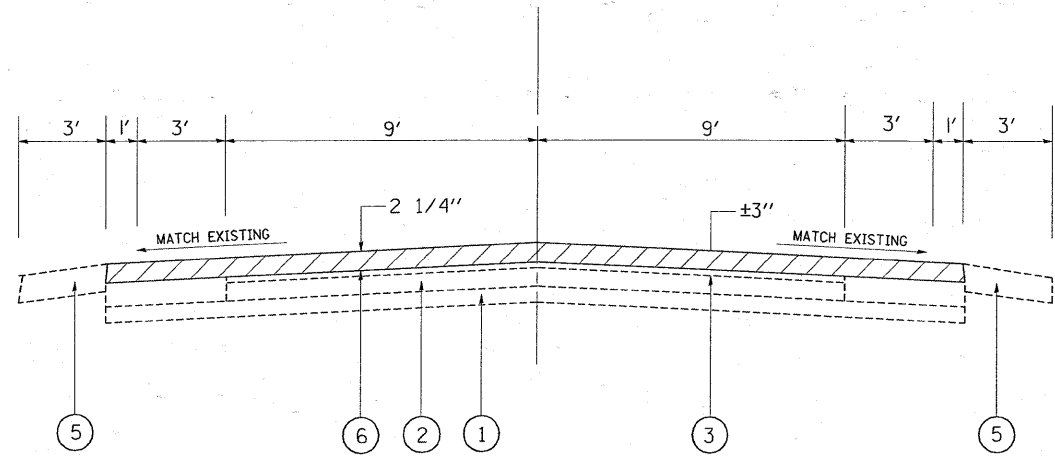

ILLINOIS ROUTE 113  
EXISTING TYPICAL SECTION  
LOCATION 1  
STA. 17+24 TO STA. 180+00

IL RTE 113

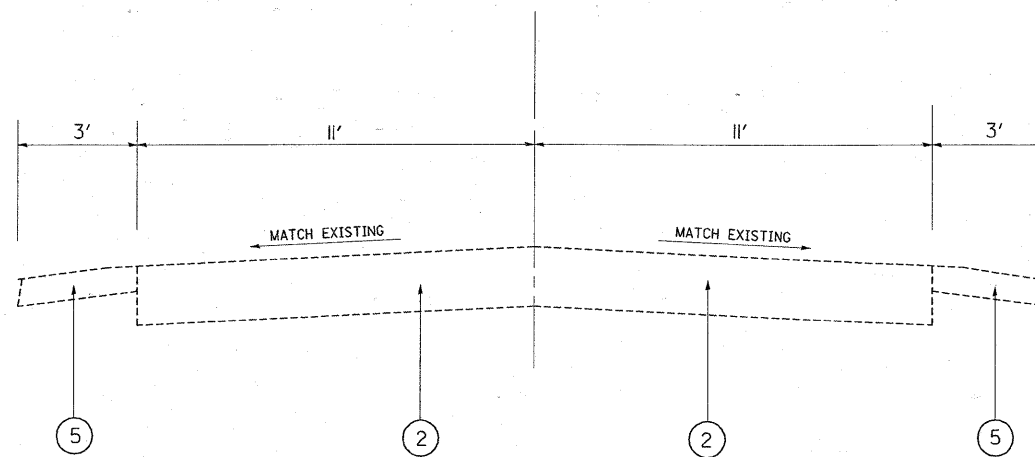

ILLINOIS ROUTE 113  
EXISTING TYPICAL SECTION  
LOCATION 2  
STA. 17+24 TO STA. 180+00

**LEGEND**

- ① EXISTING AGGREGATE SUB-BASE
- ② EXISTING PCC BASE COURSE, ±9"
- ③ EXISTING HOT-MIX ASPHALT OVERLAY, ±3"
- ④ EXISTING CONCRETE CURB & GUTTER, TYPE B-6.24
- ⑤ EXISTING AGGREGATE SHOULDER
- ⑥ PROPOSED HOT-MIX ASPHALT SURFACE REMOVAL 2 1/4"
- ⑦ PROPOSED HOT-MIX ASPHALT SURFACE COURSE, MIX "D", N70, 1 1/2 "
- ⑧ PROPOSED POLYMERIZED HOT-MIX ASPHALT LEVELING BINDER, (MM), IL-4.75, N50, 3/4"
- ⑨ PROPOSED AGGREGATE WEDGE SHOULDER, TYPE B
- ⑩ PROPOSED GRADING AND SHAPING SHOULDERS

IL RTE 113

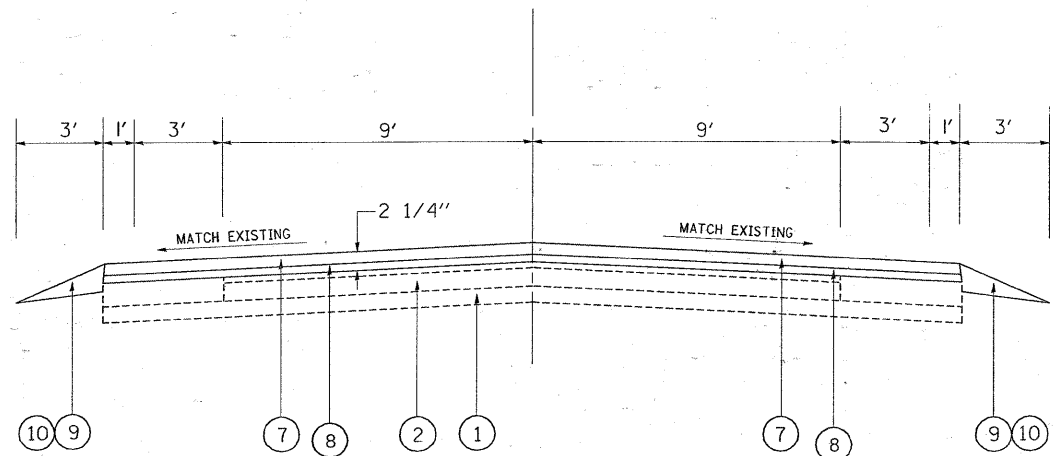

ILLINOIS ROUTE 113  
PROPOSED TYPICAL SECTION  
LOCATION 1  
STA. 17+24 TO STA. 180+00

IL RTE 113

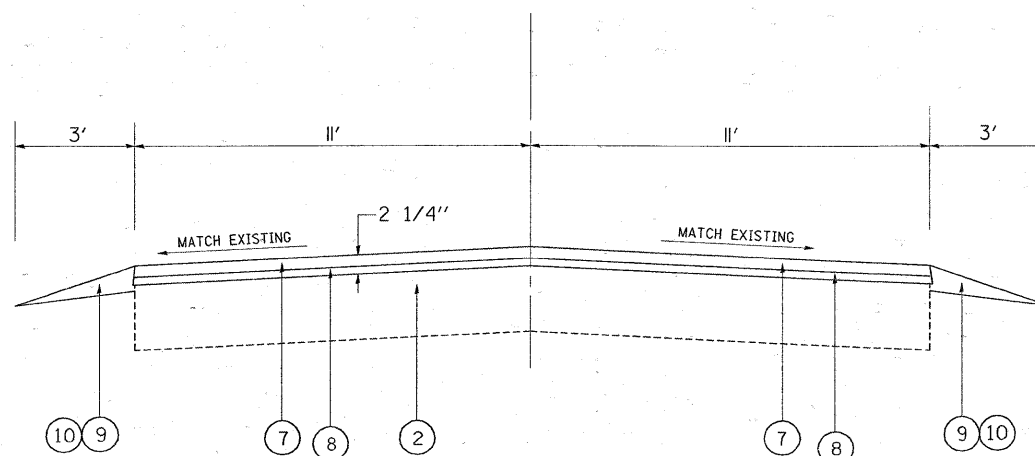

ILLINOIS ROUTE 113  
PROPOSED TYPICAL SECTION  
LOCATION 2  
STA. 17+24 TO STA. 180+00

FILE NAME =	USER NAME = smthkl	DESIGNED -	REVISED -	<b>STATE OF ILLINOIS DEPARTMENT OF TRANSPORTATION</b>	<b>IL RTE. 113 (IL RTE 53 TO RIVER ST. &amp; N. OF HORSE CREEK TO GRANT ST.) PROPOSED TYPICAL SECTIONS</b>	F.A.S. RTE. 2320/299	SECTION 43RS-1	COUNTY WILL	TOTAL SHEETS 21	SHEET NO. 5
CONTRACT NO. 62688	PLOT SCALE = 50.0000' / IN.	DRAWN -	REVISED -			ILLINOIS FED. AID PROJECT				
PLOT DATE = 4/21/2009	CHECKED -	REVISOR -	DATE -			SCALE:	SHEET NO. OF SHEETS STA. TO STA.			

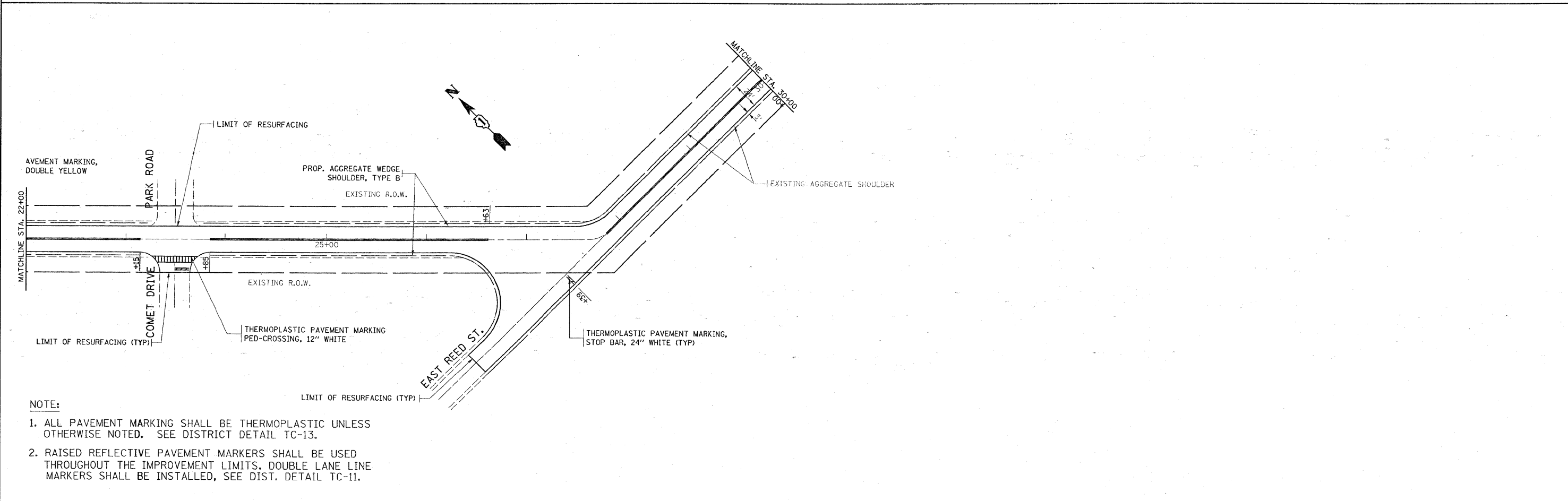
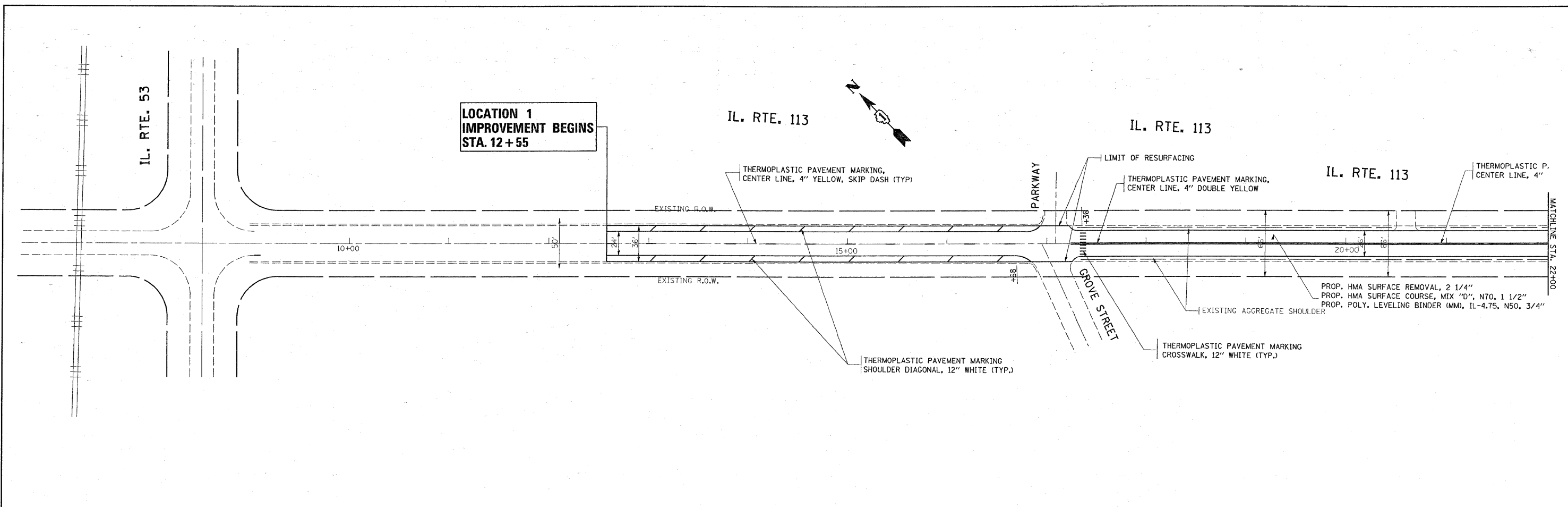

- NOTE:**
1. ALL PAVEMENT MARKING SHALL BE THERMOPLASTIC UNLESS OTHERWISE NOTED. SEE DISTRICT DETAIL TC-13.
  2. RAISED REFLECTIVE PAVEMENT MARKERS SHALL BE USED THROUGHOUT THE IMPROVEMENT LIMITS. DOUBLE LANE LINE MARKERS SHALL BE INSTALLED, SEE DIST. DETAIL TC-11.

FILE NAME =	USER NAME = sm:thkl	DESIGNED -	REVISED -	<b>STATE OF ILLINOIS DEPARTMENT OF TRANSPORTATION</b>	<b>IL. RTE. 113 (IL RTE 53 TO RIVER ST. &amp; N. OF HORSE CREEK TO GRANT ST.) PROPOSED ROADWAY &amp; PAVEMENT MARKING PLAN</b>	F.A.S. RTE. 2350/289	SECTION 43RS-1	COUNTY WILL	TOTAL SHEETS 21	SHEET NO. 6		
ca:\pwork\pwork\TASME\HKL\d0138947\0106	04-sh-tr-plan.dgn	DRAWN -	REVISED -			CONTRACT NO. 62688		ILLINOIS FED. AID PROJECT				
	PLOT SCALE = 50.0000' / IN.	CHECKED -	REVISED -			SCALE:	SHEET NO. OF SHEETS	STA. TO STA.				
	PLOT DATE = 4/21/2009	DATE -	REVISED -									

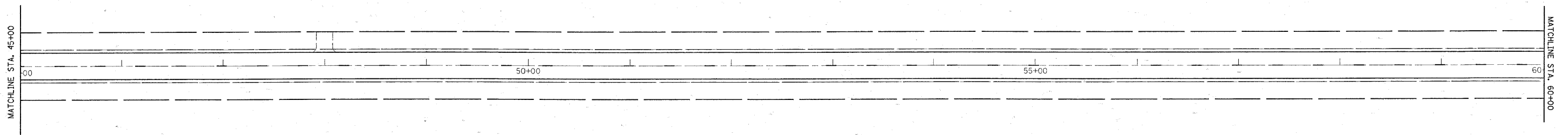
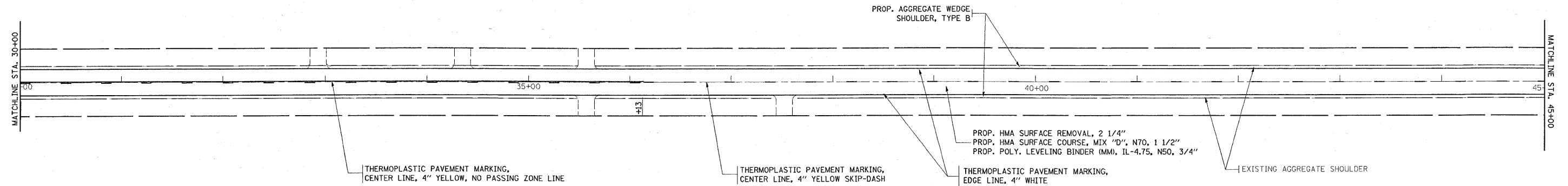

**NOTE:**

1. ALL PAVEMENT MARKING SHALL BE THERMOPLASTIC UNLESS OTHERWISE NOTED. SEE DISTRICT DETAIL TC-13.
2. RAISED REFLECTIVE PAVEMENT MARKERS SHALL BE USED THROUGHOUT THE IMPROVEMENT LIMITS. DOUBLE LANE LINE MARKERS SHALL BE INSTALLED, SEE DIST. DETAIL TC-11.

FILE NAME =	USER NAME = smithkl	DESIGNED -	REVISED -
c:\pwwork\p\10DOT\SMITHKL\0130047\0106624-sht-pln.dgn		DRAWN -	REVISED -
		CHECKED -	REVISED -
		DATE -	REVISED -

**STATE OF ILLINOIS  
DEPARTMENT OF TRANSPORTATION**

**IL RTE. 113 (IL RTE 53 TO RIVER ST. & N. OF HORSE CREEK TO GRANT ST.)  
PROPOSED ROADWAY & PAVEMENT MARKING PLAN**

SCALE: SHEET NO. OF SHEETS STA. TO STA.

F.A.S. RTE. 2320/ 299	SECTION	COUNTY	TOTAL SHEETS	SHEET NO.
	43RS-1	WILL	21	7
CONTRACT NO. 62688			ILLINOIS FED. AID PROJECT	

IL. RTE. 113

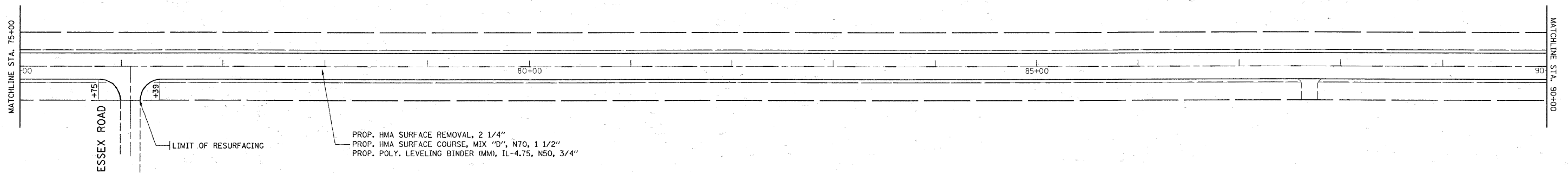
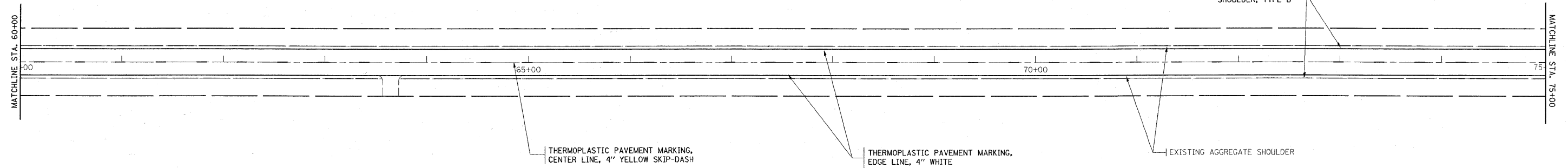

**NOTE:**

1. ALL PAVEMENT MARKING SHALL BE THERMOPLASTIC UNLESS OTHERWISE NOTED. SEE DISTRICT DETAIL TC-13.
2. RAISED REFLECTIVE PAVEMENT MARKERS SHALL BE USED THROUGHOUT THE IMPROVEMENT LIMITS. DOUBLE LANE LINE MARKERS SHALL BE INSTALLED, SEE DIST. DETAIL TC-11.

FILE NAME =	USER NAME = sm:thkl	DESIGNED -	REVISED -
es:\pwork\pwork\DOT\SMITHKL\ad0138847\0108	04-shr-plan.dgn	DRAWN -	REVISED -
	PLOT SCALE = 50.0000' / IN.	CHECKED -	REVISED -
	PLOT DATE = 4/21/2009	DATE -	REVISED -

**STATE OF ILLINOIS  
DEPARTMENT OF TRANSPORTATION**

**IL. RTE. 113 (IL RTE 53 TO RIVER ST. & N. OF HORSE CREEK TO GRANT ST.)  
PROPOSED ROADWAY & PAVEMENT MARKING PLAN**

SCALE: SHEET NO. OF SHEETS STA. TO STA.

F.A.S. RTE. 2380/ 289	SECTION	COUNTY	TOTAL SHEETS	SHEET NO.
	43RS-1	WILL	21	8
CONTRACT NO. 62688				
ILLINOIS FED. AID PROJECT				



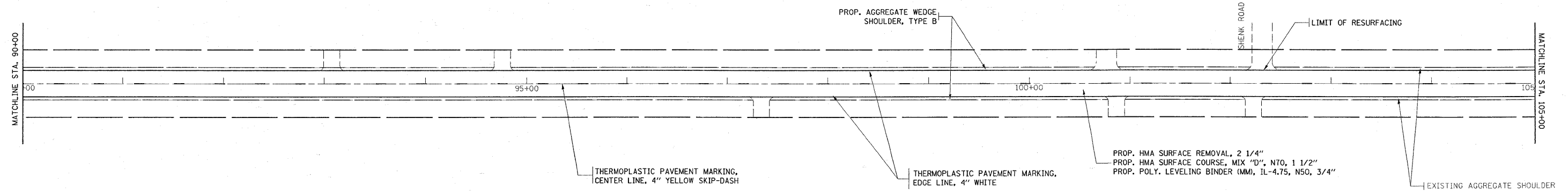

IL. RTE. 113

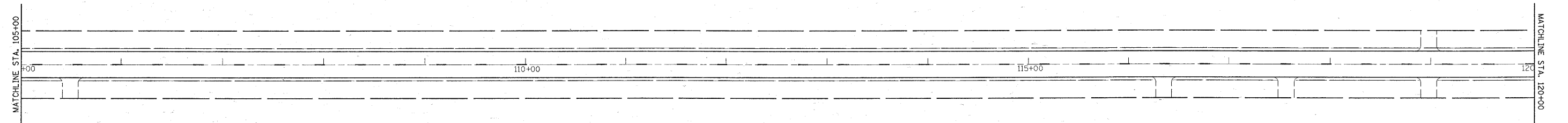

**NOTE:**

1. ALL PAVEMENT MARKING SHALL BE THERMOPLASTIC UNLESS OTHERWISE NOTED. SEE DISTRICT DETAIL TC-13.
2. RAISED REFLECTIVE PAVEMENT MARKERS SHALL BE USED THROUGHOUT THE IMPROVEMENT LIMITS. DOUBLE LANE LINE MARKERS SHALL BE INSTALLED, SEE DIST. DETAIL TC-11.

FILE NAME =	USER NAME = smithk1	DESIGNED -	REVISED -	<b>STATE OF ILLINOIS DEPARTMENT OF TRANSPORTATION</b>	<b>IL. RTE. 113 (IL RTE 53 TO RIVER ST. &amp; N. OF HORSE CREEK TO GRANT ST.) PROPOSED ROADWAY &amp; PAVEMENT MARKING PLAN</b>	F.A.S. RTE. 2320/299	SECTION 43RS-1	COUNTY WILL	TOTAL SHEETS 21	SHEET NO. 9	
cs:\pwwork\VPWID01\SMITHK1\0138047\0106504-sht-plan.dgn	PLOT SCALE = 50.0000' / IN.	DRAWN -	REVISED -			CONTRACT NO. 62688					
	PLOT DATE = 4/21/2009	CHECKED -	REVISED -			ILLINOIS FED. AID PROJECT					
		DATE -	REVISED -			SCALE:	SHEET NO.	OF	SHEETS	STA.	TO STA.

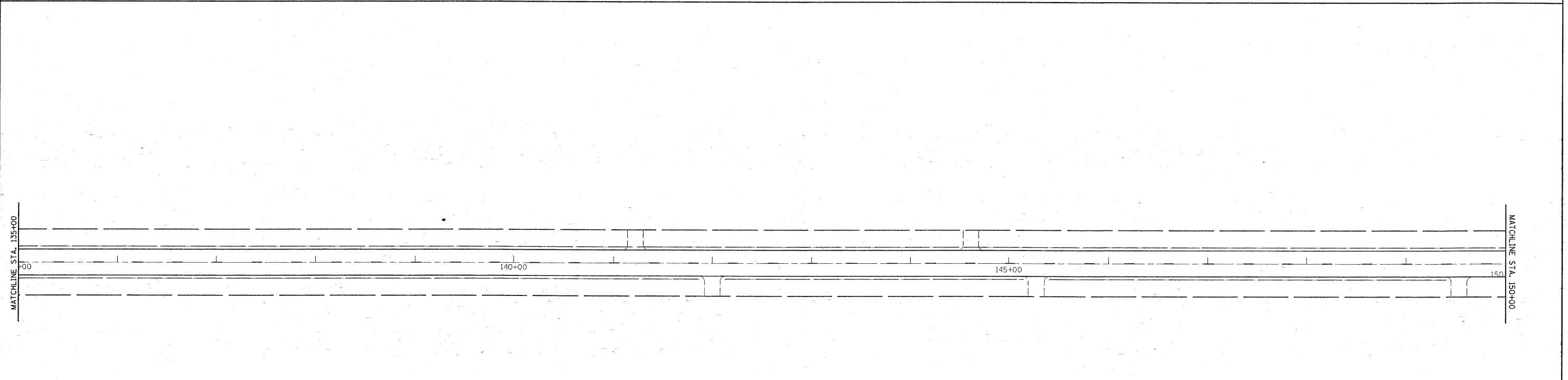
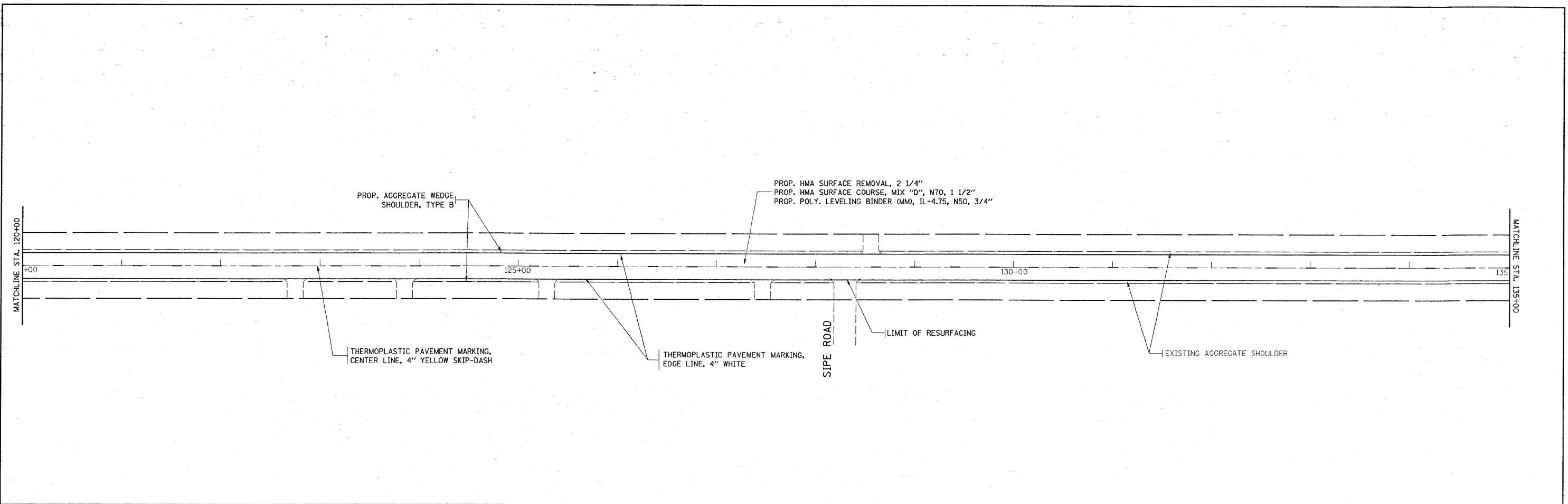

- NOTE:**
1. ALL PAVEMENT MARKING SHALL BE THERMOPLASTIC UNLESS OTHERWISE NOTED. SEE DISTRICT DETAIL TC-13.
  2. RAISED REFLECTIVE PAVEMENT MARKERS SHALL BE USED THROUGHOUT THE IMPROVEMENT LIMITS. DOUBLE LANE LINE MARKERS SHALL BE INSTALLED, SEE DIST. DETAIL TC-11.

FILE NAME =	USER NAME = smthkl	DESIGNED -	REVISED -	<b>STATE OF ILLINOIS DEPARTMENT OF TRANSPORTATION</b>	<b>IL RTE. 113 (IL RTE 53 TO RIVER ST. &amp; N. OF HORSE CREEK TO GRANT ST.) PROPOSED ROADWAY &amp; PAVEMENT MARKING PLAN</b>	F.A.S. RTE. 2320/299	SECTION 43RS-1	COUNTY WILL	TOTAL SHEETS 21	SHEET NO. 10
ca\pwwork\PIWIDOT\SMITHKL\d0138047\0106	04-sht-plan.dgn	DRAWN -	REVISED -			CONTRACT NO. 62688				
	PLOT SCALE = 50.0000' / IN.	CHECKED -	REVISED -			ILLINOIS FED. AID PROJECT				
	PLOT DATE = 4/21/2009	DATE -	REVISED -			SCALE:	SHEET NO. OF SHEETS STA. TO STA.			

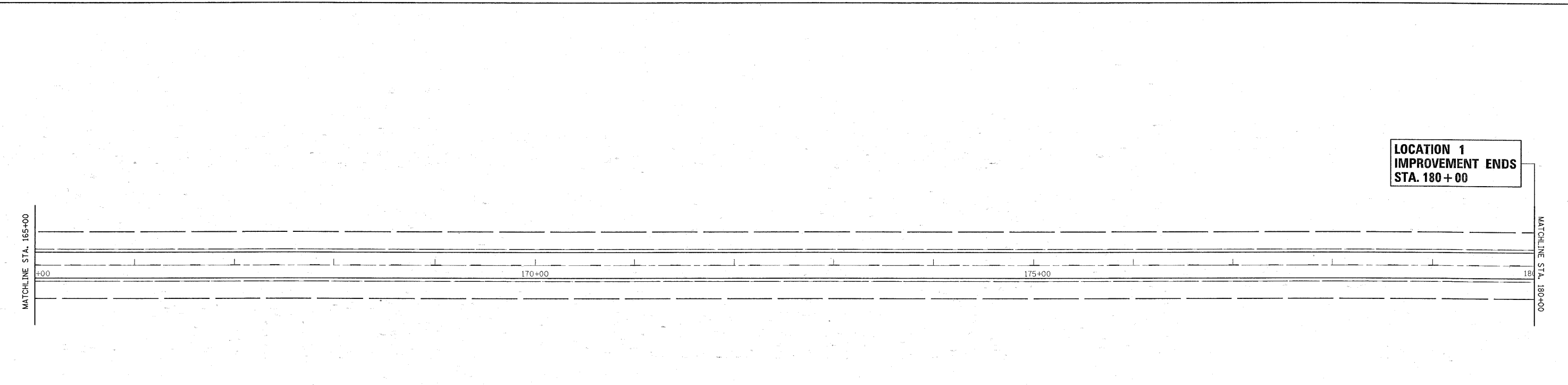
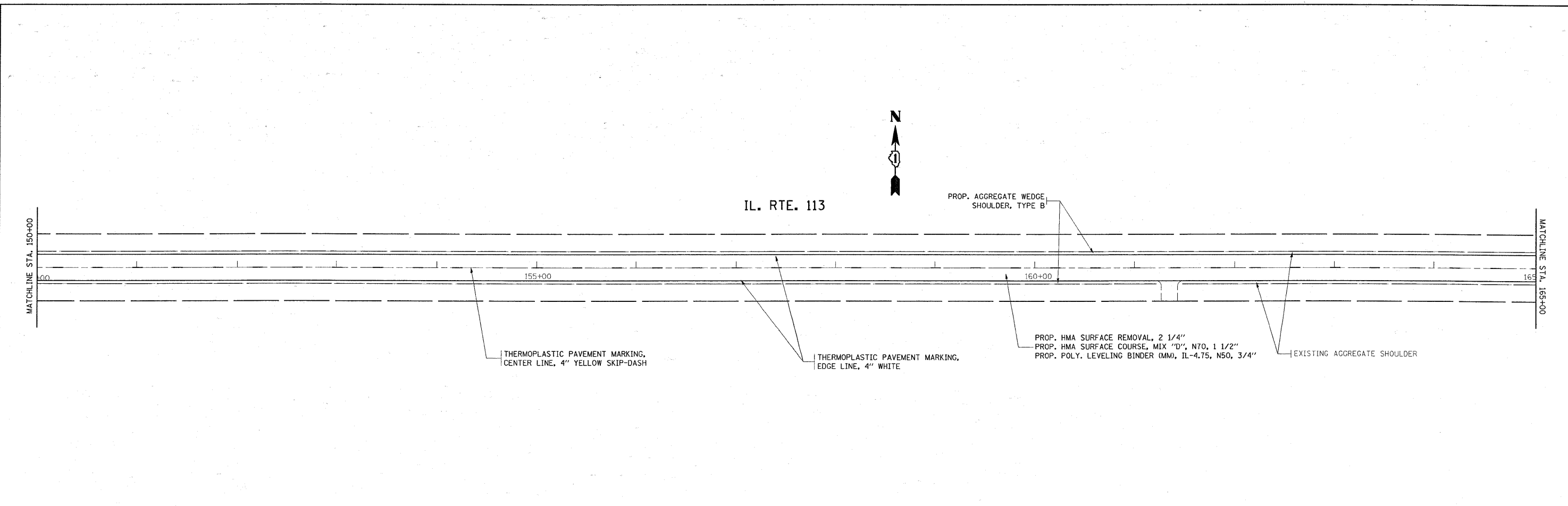

- NOTE:**
1. ALL PAVEMENT MARKING SHALL BE THERMOPLASTIC UNLESS OTHERWISE NOTED. SEE DISTRICT DETAIL TC-13.
  2. RAISED REFLECTIVE PAVEMENT MARKERS SHALL BE USED THROUGHOUT THE IMPROVEMENT LIMITS. DOUBLE LANE LINE MARKERS SHALL BE INSTALLED, SEE DIST. DETAIL TC-11.

FILE NAME =	USER NAME = sm:thkl	DESIGNED -	REVISED -	<b>STATE OF ILLINOIS DEPARTMENT OF TRANSPORTATION</b>	<b>IL. RTE. 113 (IL RTE 53 TO RIVER ST. &amp; N. OF HORSE CREEK TO GRANT ST.) PROPOSED ROADWAY &amp; PAVEMENT MARKING PLAN</b>	F.A.S. RTE. 2320/ 239	SECTION 43RS-1	COUNTY WILL	TOTAL SHEETS 21	SHEET NO. 11		
cr:\pw\work\PIWIDOT\SMITHKL\d0138047\01185804-shit-plan.dgn	PLOT SCALE = 50.0000' / IN.	DRAWN -	REVISED -			SCALE:	SHEET NO. OF SHEETS	STA. TO STA.	ILLINOIS FED. AID PROJECT CONTRACT NO. 62688			
	PLOT DATE = 4/21/2009	CHECKED -	REVISED -									
		DATE -	REVISED -									

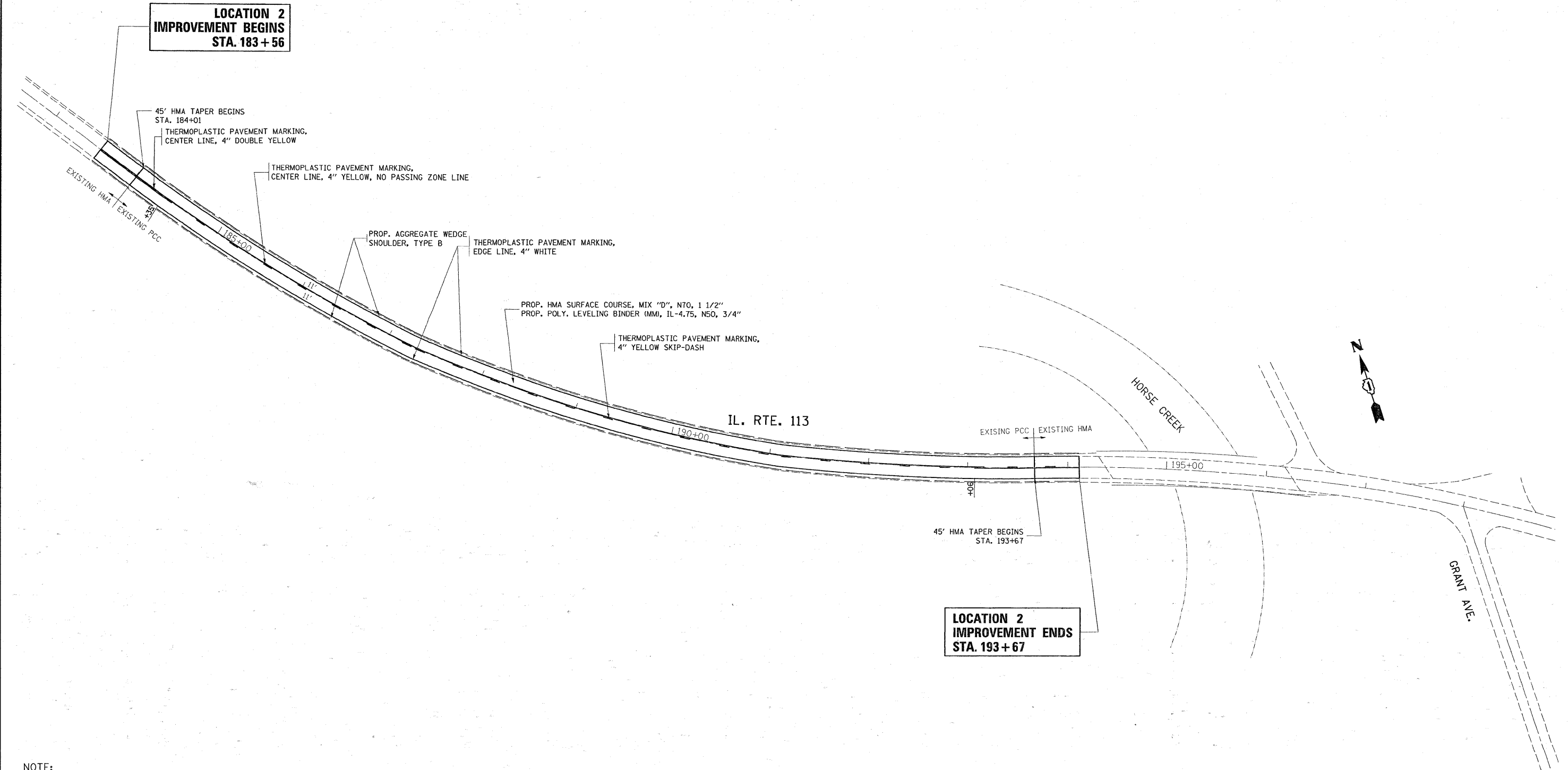

**NOTE:**

1. ALL PAVEMENT MARKING SHALL BE THERMOPLASTIC UNLESS OTHERWISE NOTED. SEE DISTRICT DETAIL TC-13.
2. RAISED REFLECTIVE PAVEMENT MARKERS SHALL BE USED THROUGHOUT THE IMPROVEMENT LIMITS. DOUBLE LANE LINE MARKERS SHALL BE INSTALLED, SEE DIST. DETAIL TC-11.
3. STATIONING SHOWN HERE DOES NOT COORDINATE WITH STATIONS SHOWN IN PLAN SHEETS FOR LOCATION 1.

FILE NAME = c:\pwork\pwork\DOT\SMITH\CL\d0138047\0106	USER NAME = smthkl 204-shit-plan.dgn	DESIGNED -	REVISED -	<b>STATE OF ILLINOIS DEPARTMENT OF TRANSPORTATION</b>	<b>IL. RTE. 113 (IL RTE 53 TO RIVER ST. &amp; N. OF HORSE CREEK TO GRANT ST.) PROPOSED ROADWAY &amp; PAVEMENT MARKING PLAN</b>			F.A.S. RTE. 23507 299	SECTION 43RS-1	COUNTY WILL	TOTAL SHEETS 21	SHEET NO. 12
	PLOT SCALE = 50,0000 ' / IN.	DRAWN -	REVISED -		SCALE:	SHEET NO.	OF	SHEETS	STA.	TO STA.	CONTRACT NO. 62688	
	PLOT DATE = 4/21/2009	CHECKED -	REVISED -								ILLINOIS FED. AID PROJECT	
		DATE -	REVISED -									

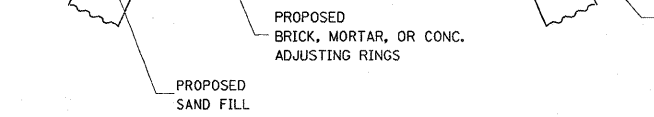
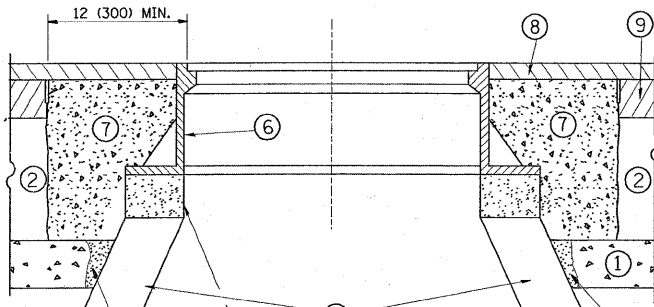
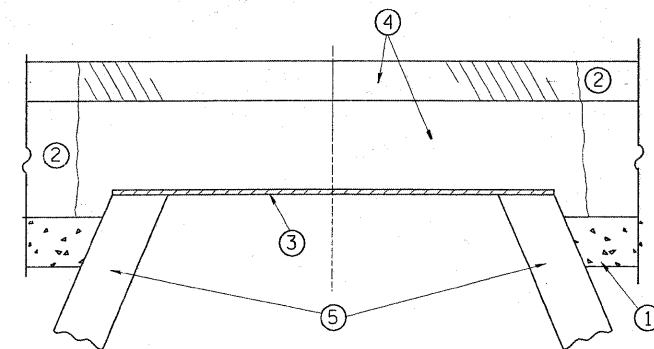

**CONSTRUCTION PROCEDURES**

**STAGE 1 (BEFORE PAVEMENT MILLING)**

- A) REMOVE A MINIMUM OF 12 (300) OF THE PAVEMENT FROM AROUND THE STRUCTURE.
- B) REMOVE THE EXISTING FRAME AND LID FROM THE STRUCTURE.
- C) COVER THE STRUCTURE OPENING WITH A 36 (900) DIAMETER METAL PLATE.
- D) BACKFILL WITH CRUSHED STONE AND A MINIMUM 1/2 (40) THICK HMA SURFACE MIX APPROVED BY THE ENGINEER.

**STAGE 2 (AFTER PAVEMENT MILLING)**

- A) REMOVE THE HMA SURFACE MIX AND CRUSHED STONE.
- B) INSTALL THE FRAME AND LID; ADJUST THE FRAME TO ITS FINAL SURFACE ELEVATION.
- C) THE SURROUNDING SPACE SHALL BE FILLED WITH CLASS SI CONCRETE, OR HMA SURFACE COURSE OR HMA BINDER COURSE TO THE ELEVATION OF THE SURFACE OF THE EXISTING BASE COURSE OR THE BINDER COURSE.

THE PROCEDURE EXPLAINED ABOVE SHALL CONFORM TO THE APPLICABLE PORTIONS OF SECTIONS 353, 406, 602, AND 603 OF THE STANDARD SPECIFICATIONS.

**LEGEND**

- ① SUB-BASE GRANULAR MATERIAL
- ② EXISTING PAVEMENT
- ③ 36 (900) DIAMETER METAL PLATE
- ④ PROPOSED CRUSHED STONE AND HMA SURFACE MIX
- ⑤ EXISTING STRUCTURE
- ⑥ FRAME AND LID (SEE NOTES)
- ⑦ CLASS SI CONCRETE, HMA SURFACE COURSE OR HMA BINDER COURSE
- ⑧ PROPOSED HMA SURFACE COURSE
- ⑨ PROPOSED HMA BINDER COURSE

**NOTES:**

EXISTING BROKEN FRAMES AND LIDS SHALL BE REMOVED AND DISPOSED OF BY THE CONTRACTOR AND SHALL BE REPLACED AS DIRECTED BY THE ENGINEER. REPLACEMENT FRAMES AND LIDS WILL BE PAID FOR IN ACCORDANCE WITH ARTICLE 109.04 OF THE STANDARD SPECIFICATIONS UNLESS A SEPARATE PAY ITEM HAS BEEN PROVIDED.

IF THE EXISTING LIDS ARE OPEN, THE FRAME WILL BE ADJUSTED TO THE ELEVATION OF THE MILLED PAVEMENT SURFACE PRIOR TO THE MILLING OPERATION. THE FRAME WILL NOT BE REMOVED AND COVERED BY THE METAL PLATE.

CITY OF CHICAGO CASTINGS ARE THE PROPERTY OF THE CITY AND THE CONTRACTOR SHALL NOTIFY THE CITY FOR REMOVAL AND DISPOSITION OF THE CASTINGS.

THE METAL PLATE USED TO COVER THE STRUCTURE SHALL REMAIN THE PROPERTY OF THE CONTRACTOR.

WHEN STRUCTURES ARE TO BE ADJUSTED OR RECONSTRUCTED, THE LOWERING AND RAISING OF THE FRAMES AND LIDS WILL NOT BE PAID FOR SEPARATELY BUT WILL BE INCLUDED IN THE COST OF THE CORRESPONDING PAY ITEM.

**LOCATION OF STRUCTURES:**

THE CONTRACTOR WILL BE REQUIRED TO KEEP A RECORD OF THE LOCATIONS OF THE BURIED STRUCTURES ACCORDING TO THE STATION AND DISTANCE LEFT OR RIGHT OF THE CENTERLINE OF PAVEMENT. UPON COMPLETION OF THE WORK, THE CONTRACTOR WILL DELIVER THE RECORD TO THE ENGINEER.

**BASIS OF PAYMENT:** THIS WORK WILL BE PAID FOR AT THE CONTRACT UNIT PRICE PER EACH FOR "FRAMES AND LIDS TO BE ADJUSTED, SPECIAL"

NEW FRAMES AND LIDS, WHEN SPECIFIED, WILL BE PAID FOR SEPARATELY.

**DETAILS FOR FRAMES AND LIDS ADJUSTMENT WITH MILLING**

ALL DIMENSIONS ARE IN INCHES (MILLIMETERS) UNLESS OTHERWISE SHOWN

FILE NAME =	USER NAME = smthkl	DESIGNED - R. SHAH	REVISED - R. SHAH 03-10-95
ca\pwork\PWIDOT\SMTHKL\0138047\Dist\td.dgn		DRAWN -	REVISED - A. ABBAS 03-21-97
	PLOT SCALE = 50.00000 ' / IN.	CHECKED -	REVISED - R. WIEDEMAN 05-14-04
	PLOT DATE = 4/21/2009	DATE - 10-25-94	REVISED - R. BORO 01-01-07

**STATE OF ILLINOIS  
DEPARTMENT OF TRANSPORTATION**

<b>DETAILS FOR FRAMES AND LIDS ADJUSTMENT WITH MILLING</b>	
SCALE: NONE	SHEET NO. 1 OF 1 SHEETS STA. TO STA.

F.A.S. RTE. 23207/299	SECTION 43RS-1	COUNTY WILL	TOTAL SHEETS 21	SHEET NO. 13
<b>BD600-03 (BD-8)</b>		CONTRACT NO. 62688		
FED. ROAD DIST. NO. 1 ILLINOIS FED. AID PROJECT				

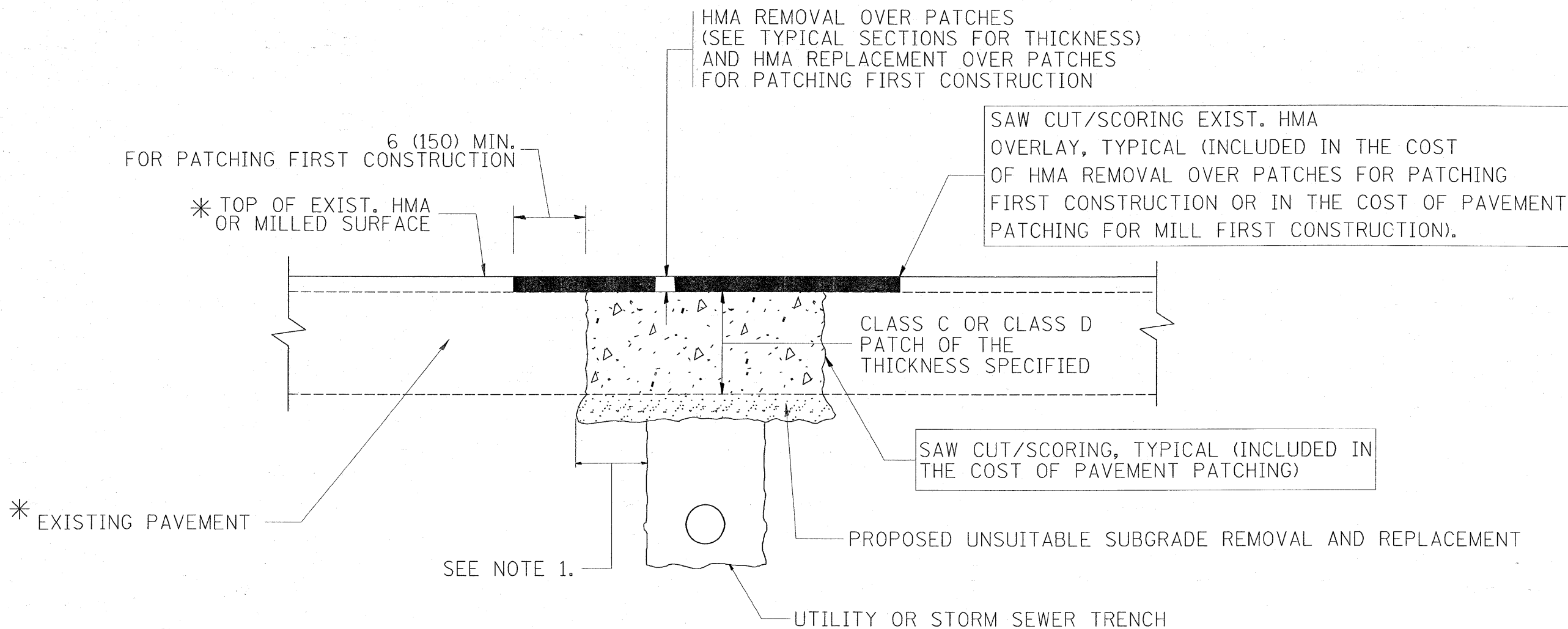

\* SEE TYPICAL SECTIONS FOR THICKNESS AND MATERIALS

**NOTES:**

1. THE WIDTH OF THE FULL DEPTH PATCH OVER A TRENCH SHALL BE 12 (300) WIDER ON EACH SIDE OF THE TRENCH.
2. FOR METHOD OF MEASUREMENT AND BASIS OF PAYMENT, SEE RECURRING SPECIAL PROVISION "PATCHING WITH HOT-MIX ASPHALT OVERLAY REMOVAL".

SEQUENCE OF CONSTRUCTION (PATCHING FIRST)

1. REMOVE THE EXISTING HMA MATERIAL OVER THE AREA TO BE PATCHED.
2. REMOVE AND REPLACE WITH CLASS C OR D PATCH.
3. REPLACE HMA MATERIAL OVER THE AREA TO BE PATCHED.

SEQUENCE OF CONSTRUCTION (MILLING FIRST)

1. MILL HMA FIRST IF THERE IS AT LEAST 4 1/2 INCHES OR MORE OF HMA MATERIAL ON TOP OF THE EXISTING PAVEMENT OR IF THE PAVEMENT IS FULL DEPTH HMA. A MINIMUM OF 2 INCHES OF HMA MATERIAL SHALL BE IN PLACE AFTER MILLING.
2. REMOVE AND REPLACE WITH FULL DEPTH CLASS D PATCHES TO TOP OF MILLED SURFACE.

ALL DIMENSIONS ARE IN INCHES (MILLIMETERS) UNLESS OTHERWISE SHOWN.

FILE NAME =	USER NAME = smthkl	DESIGNED - R. SHAH	REVISED - A. ABBAS 04-27-98	<b>STATE OF ILLINOIS DEPARTMENT OF TRANSPORTATION</b>	<b>PAVEMENT PATCHING FOR HMA SURFACED PAVEMENT</b>	F.A.S. RTE. 2320/299	SECTION 43RS-1	COUNTY WILL	TOTAL SHEETS 21	SHEET NO. 14	
cd:\pwork\pwidot\SMITHKL\d0138047\01sttd.dgn		DRAWN -	REVISED - R. BORO 01-01-07			SCALE: NONE	SHEET NO. 1 OF 1 SHEETS	STA. TO STA.	FED. ROAD DIST. NO. 1 ILLINOIS FED. AID PROJECT		CONTRACT NO. 62688
		PLOT SCALE = 50,0000' / IN.	REVISED - R. BORO 09-04-07								
		PLOT DATE = 4/21/2009	REVISED - K. ENG 10-27-08								

VARIABLE - TO MEET EXISTING DIMENSIONS AND FIELD CONDITIONS (SEE NOTE ②)

PROP. CONC. CURB OR CURB AND GUTTER REPLACEMENT IN ACCORDANCE WITH STATE STANDARD 606001. (SEE NOTE ②)

SAW CUT FULL DEPTH - INCLUDED IN THE COST OF SIDEWALK, DRIVEWAY OR MEDIAN SURFACE REMOVAL PAY ITEM.

SEE STATE STANDARD 606001  
EXISTING OR PROPOSED HMA SURFACE (IF APPLICABLE)

18" (450) MAX.

1/4" (5) \*\*

EXISTING SIDEWALK, DRIVEWAY, MEDIAN SURFACE OR GROUND.

PROPOSED SIDEWALK, DRIVEWAY PAVEMENT, MEDIAN SURFACE OR SALT TOLERANT SOD AND TOP SOIL, 4" (100) SOD RESTORATION (SEE NOTE ①).

SUITABLE BACKFILL MATERIAL (INCLUDED IN THE COST OF CURB OR CURB AND GUTTER REMOVAL AND REPLACEMENT)

3" (75) MIN.

PROPOSED 3/4" (20) PREFORMED EXPANSION JOINT AT CONCRETE SIDEWALKS, DRIVEWAYS, AND MEDIANS. (INCLUDED IN THE COST OF CURB OR CURB AND GUTTER REMOVAL AND REPLACEMENT.)

UNSUITABLE SUB-BASE MATERIAL TO BE REMOVED, IF DIRECTED BY THE ENGINEER, SHALL BE REPLACED WITH EITHER SUB-BASE GRANULAR MATERIAL, TYPE B OR ADDITIONAL THICKNESS OF CONCRETE.

REMOVAL AND REPLACEMENT 4" (100) OR LESS IS INCLUDED IN THE COST OF CURB OR CURB AND GUTTER REMOVAL AND REPLACEMENT.

REMOVAL AND REPLACEMENT IN EXCESS OF 4" (100) WILL BE PAID FOR IN ACCORDANCE WITH ARTICLE 109.04 OF THE STANDARD SPECIFICATIONS.

PROPOSED #6 (20) EPOXY COATED TIE BARS 24" (600) LONG AT 24" (600) CENTERS WILL NOT BE PAID FOR SEPARATELY. DELETE EPOXY COATED TIE BARS IF EXISTING TIE BARS ARE USUABLE AS DETERMINED BY THE ENGINEER. (SEE NOTE ③).

**BASIS OF PAYMENT:**

THIS WORK WILL BE PAID FOR AT THE CONTRACT UNIT PRICE PER FOOT (METER) FOR "CURB REMOVAL AND REPLACEMENT" OR "COMBINATION CONCRETE CURB AND GUTTER REMOVAL AND REPLACEMENT".

- \* 3" (75) MINIMUM FROM TOP AND BOTTOM OF THE CONCRETE PAVEMENT OR BASE COURSE.
- \*\* IF THE FINAL SURFACE OF THE PAVEMENT IS CONCRETE, THE GUTTER IS TO BE FLUSH WITH THE PAVEMENT.

NOTE: ① SIDEWALK, DRIVEWAY PAVEMENT OR MEDIAN SURFACE SHALL BE SIMILAR TO THE MATERIAL BEING REMOVED AND WILL BE PAID FOR SEPARATELY.

SALT TOLERANT SOD AND TOP SOIL, 4" (100) RESTORATION WILL NOT BE PAID FOR SEPARATELY, BUT SHALL BE INCLUDED IN THE COST OF CURB OR CURB AND GUTTER REMOVAL AND REPLACEMENT.

② CURB OR CURB AND GUTTER REPLACEMENT SHALL MATCH THE SHAPE OF THE EXISTING CURB OR CURB AND GUTTER UNLESS OTHERWISE SPECIFIED.

③ FOR CURB OR CURB AND GUTTER REMOVAL AND REPLACEMENT ADJACENT TO FLEXIBLE PAVEMENT DELETE EPOXY COATED TIE BARS.

④ LONGITUDINAL BARS, IF ENCOUNTERED IN THE EXISTING CURB OR CURB AND GUTTER, ARE NOT TO BE REPLACED. CUTTING AND REMOVING LONGITUDINAL BARS SHALL BE INCLUDED IN THE COST OF CURB OR CURB AND GUTTER REMOVAL AND REPLACEMENT.

⑤ THE COST OF HMA SURFACE REMOVAL IN THE EXISTING GUTTER FLAG SHALL BE INCLUDED IN THE COST OF THE CURB AND GUTTER REMOVAL AND REPLACEMENT.

⑥ THE REMOVAL AND REPLACEMENT OF THE EXISTING CURB OR CURB AND GUTTER SHALL BE DONE IN ACCORDANCE WITH THE APPLICABLE PORTIONS OF SECTION 440 AND 606 OF THE STANDARD SPECIFICATIONS.

⑦ THE LOCATIONS OF REMOVAL AND REPLACEMENT OF EXISTING CURB OR CURB AND GUTTER SHALL BE DETERMINED BY THE RESIDENT ENGINEER AT THE TIME OF CONSTRUCTION.

# CURB OR CURB AND GUTTER REMOVAL AND REPLACEMENT

ALL DIMENSIONS ARE IN INCHES (MILLIMETERS) UNLESS OTHERWISE SHOWN.

FILE NAME =	USER NAME = smthkl	DESIGNED - A. HOUSEH	REVISED - R. SHAH 10-03-96	<b>STATE OF ILLINOIS DEPARTMENT OF TRANSPORTATION</b>	<b>CURB OR CURB AND GUTTER REMOVAL AND REPLACEMENT</b>			F.A.S. RTE. 2320/299	SECTION 43RS-1	COUNTY WILL	TOTAL SHEETS 21	SHEET NO. 15
c:\pw\work\PW100T\SMITHKL\d0138047\01st	td.dgn	DRAWN -	REVISED - A. ABBAS 03-21-97		SCALE: NONE	SHEET NO. 1 OF 1 SHEETS	STA. TO STA.	<b>BD600-06 (BD-24)</b>		CONTRACT NO. 62688		
	PLOT SCALE = 50,0000 ' / IN.	CHECKED -	REVISED - M. GOMEZ 01-22-01		FED. ROAD DIST. NO. 1 (ILLINOIS) FED. AID PROJECT							
	PLOT DATE = 4/21/2009	DATE - 03-11-94	REVISED - R. BORO 01-01-07									

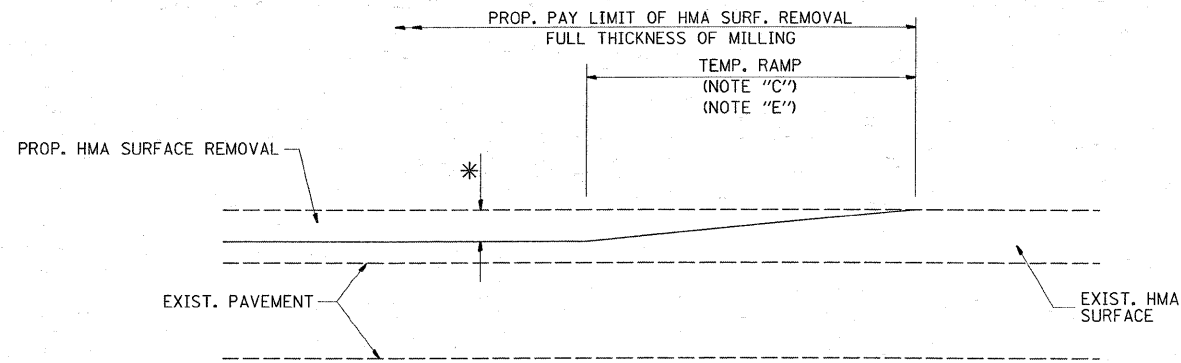

MILLED TEMPORARY RAMP  
(FOR BUTT JOINT AND HMA TAPER SEE DETAIL BELOW)

OPTION 1

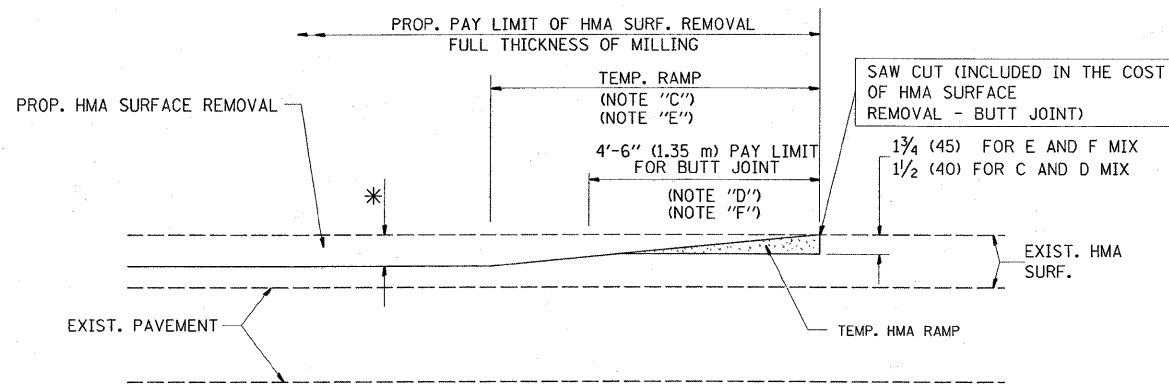

HMA CONSTRUCTED TEMPORARY RAMP  
(FOR BUTT JOINT AND HMA TAPER SEE DETAIL BELOW)

OPTION 2

TYPICAL TEMPORARY RAMP

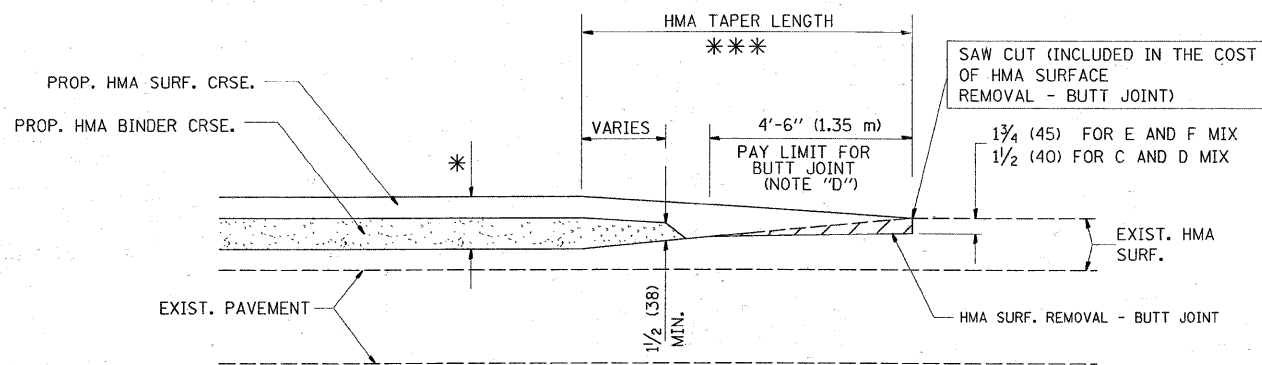

BUTT JOINT AND  
HMA TAPER

TYPICAL BUTT JOINT AND HMA TAPER  
FOR MILLING AND RESURFACING

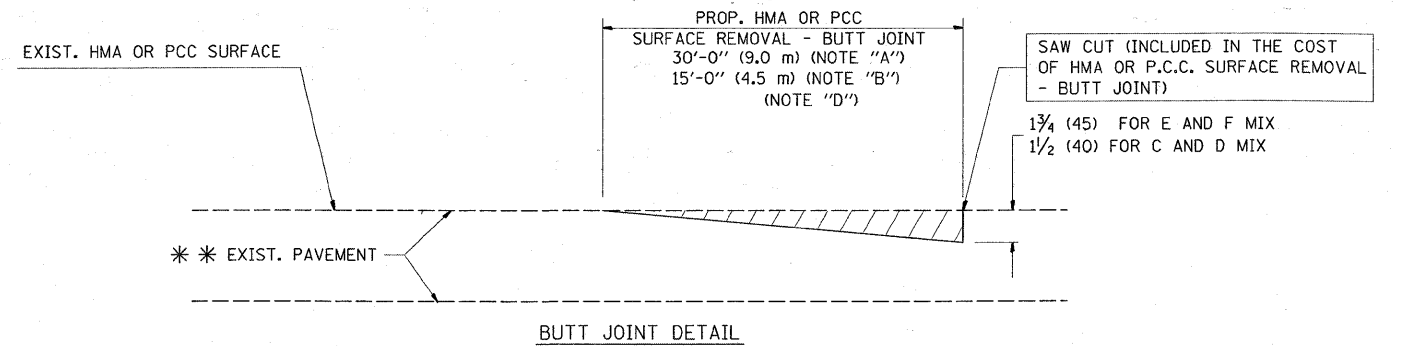

BUTT JOINT DETAIL

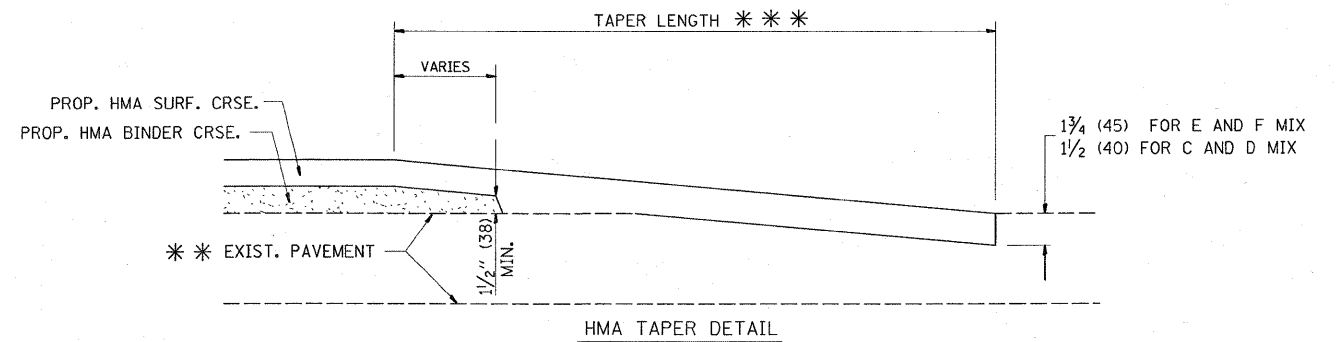

HMA TAPER DETAIL

TYPICAL BUTT JOINT AND HMA TAPER  
FOR RESURFACING ONLY

\*\*\* PC CONCRETE, HMA OR HMA RESURFACED PAVEMENT.

NOTES

- A: MAINLINE ROADWAYS AND MAJOR SIDE ROADS.
  - B: MINOR SIDE ROADS.
  - C: THE TEMP. RAMP SHALL BE CONSTRUCTED IMMEDIATELY UPON REMOVAL OF THE EXISTING HMA SURFACE.
  - D: THE BUTT JOINT SHALL BE CONSTRUCTED IMMEDIATELY PRIOR TO PLACING THE PROPOSED HMA COURSES.
  - E: TAPER THE TEMP. RAMP AT A RATE OF 3'-0" (900 mm) PER 1 INCH (25 mm) OF MILLING THICKNESS.
  - F: INSTALLATION AND REMOVAL OF THE 4'-6" (1.35 m) TEMP. RAMP IS INCLUDED IN COST OF HMA SURFACE REMOVAL - BUTT JOINT
  - G: SEE ARTICLE 406.08 AND 406.14 OF THE STANDARD SPECIFICATIONS FOR "HMA AND/OR PCC SURFACE REMOVAL, BUTT JOINT".
- \* SEE TYPICAL SECTIONS FOR MILLING THICKNESS.
- \*\*\* 20'-0" (6.1 m) PER 1 (25) RESURFACING (NOTE "A")  
10'-0" (3.0 m) PER 1 (25) RESURFACING (NOTE "B")

BASIS OF PAYMENT:

THE BUTT JOINT WILL BE PAID FOR AT THE CONTRACT UNIT PRICE PER SQUARE YARD (SQUARE METER) FOR "HOT-MIX ASPHALT SURFACE REMOVAL - BUTT JOINT" OR FOR "PORTLAND CEMENT CONCRETE SURFACE REMOVAL - BUTT JOINT".

ALL DIMENSIONS ARE IN INCHES (MILLIMETERS) UNLESS OTHERWISE SHOWN.

FILE NAME =	USER NAME = smithkl	DESIGNED - M. DE YONG	REVISED - R. SHAH 10-25-94
ct:\pwork\PWIDOT\SMITHKL\0138047\Dis\td.dgn		DRAWN -	REVISED - A. ABBAS 03-21-97
	PLOT SCALE = 50.0000' / IN.	CHECKED -	REVISED - M. GOMEZ 04-06-01
	PLOT DATE = 4/21/2009	DATE - 06-13-90	REVISED - R. BORO 01-01-07

STATE OF ILLINOIS  
DEPARTMENT OF TRANSPORTATION

BUTT JOINT AND  
HMA TAPER DETAILS

SCALE: NONE SHEET NO. 1 OF 1 SHEETS STA. TO STA.

F.A.S. RTE. 2320/299	SECTION 43RS-1	COUNTY WILL	TOTAL SHEETS 21	SHEET NO. 16
BD400-05 BD32			CONTRACT NO. 62688	
FED. ROAD DIST. NO. 1 ILLINOIS FED. AID PROJECT				



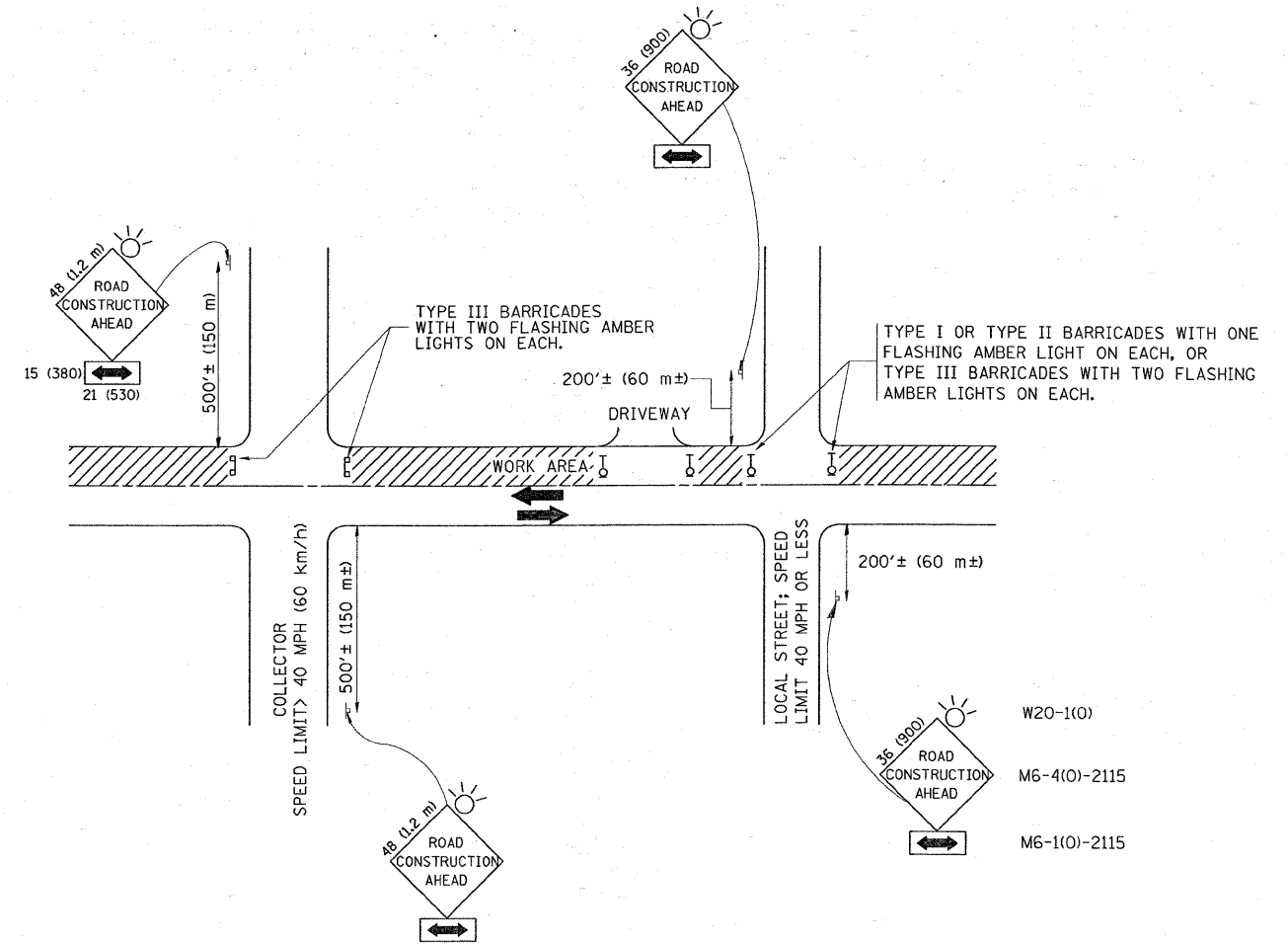

### TRAFFIC CONTROL AND PROTECTION FOR SIDE ROADS, INTERSECTIONS, AND DRIVEWAYS

#### NOTES:

##### A. FOR NO LANE RESTRICTION ON THE SIDE ROAD OR DRIVEWAYS

1. SIDE ROAD WITH A SPEED LIMIT OF 40 MPH (60 km/h) OR LESS AS SHOWN ON THE DRAWING AND AS DIRECTED BY THE ENGINEER:

a) ONE **ROAD CONSTRUCTION AHEAD** SIGN 36 x 36 (900x900) WITH A FLASHER AND FLAG MOUNTED ON IT APPROXIMATELY 200' (60 m) IN ADVANCE OF THE MAIN ROUTE.

b) THE CLOSED PORTION OF THE MAIN ROUTE SHALL BE PROTECTED BY BLOCKING WITH TYPE I, TYPE II OR TYPE III BARRICADES, 1/3 OF THE CROSS SECTION OF THE CLOSED PORTION.

2. SIDE ROAD WITH A SPEED LIMIT GREATER THAN 40 MPH (60 km/h) AS SHOWN ON THE DRAWING AND AS DIRECTED BY THE ENGINEER:

a) ONE **ROAD CONSTRUCTION AHEAD** SIGN 48 x 48 (1.2 m x 1.2 m) WITH A FLASHER MOUNTED ON IT APPROXIMATELY 500' (150 m) IN ADVANCE OF THE MAIN ROUTE.

b) THE CLOSED PORTION OF THE MAIN ROUTE SHALL BE PROTECTED BY BLOCKING WITH TYPE III BARRICADES, 1/2 OF THE CROSS SECTION OF THE CLOSED PORTION.

3. WHEN THE SIDE ROAD LIES BETWEEN THE BEGINNING OF THE MAINLINE SIGNING AND THE WORK ZONE, A SINGLE HEADED ARROW (M6-1) SHALL BE USED IN LIEU OF THE DOUBLE HEADED ARROW (M6-4).

##### B. FOR A LANE CLOSURE ON A SIDE ROAD OR DRIVEWAY:

USE APPLICABLE PORTIONS OF THE TYPICAL APPLICATION OF TRAFFIC CONTROL DEVICES (STD. 701501, STD. 701606 OR THE APPROPRIATE STANDARD). THE SPACING OF SIGNS AND BARRICADES SHALL BE ADJUSTED FOR FIELD CONDITIONS AS DIRECTED BY THE ENGINEER. THE DIRECTIONAL ARROW SHALL BE COVERED OR REMOVED WHEN NO LONGER CONSISTENT WITH THE SIDE ROAD LANE CLOSURE.

C. ADVANCE WARNING SIGNS ARE TO BE OMITTED ON DRIVEWAY UNLESS OTHERWISE NOTED.

D. THE TRAFFIC CONTROL AND PROTECTION FOR SIDE ROADS, INTERSECTIONS, AND DRIVEWAYS SHALL BE INCIDENTAL TO THE COST OF SPECIFIED TRAFFIC CONTROL STANDARDS OR ITEMS.

All dimensions are in millimeters (inches) unless otherwise shown.

FILE NAME =	USER NAME = smthkl	DESIGNED - LHA	REVISED - J. OBERLE 10-18-95
ct\pwork\pwidot\SMITHKL\d0138847\Dist	td.dgn	DRAWN -	REVISED - A. HOUSEH 03-06-96
	PLOT SCALE = 50.0000' / IN.	CHECKED -	REVISED - A. HOUSEH 10-15-96
	PLOT DATE = 4/21/2009	DATE - 06-89	REVISED - T. RAMMACHER 01-06-00

STATE OF ILLINOIS  
DEPARTMENT OF TRANSPORTATION

TRAFFIC CONTROL AND PROTECTION FOR  
SIDE ROADS, INTERSECTIONS, AND DRIVEWAYS

SCALE: NONE SHEET NO. 1 OF 1 SHEETS STA. TO STA.

F.A.S. RTE. 2320/ 299	SECTION 43RS-1	COUNTY WILL	TOTAL SHEETS 21	SHEET NO. 17
TC-10		CONTRACT NO. 62688		
FED. ROAD DIST. NO. 1 ILLINOIS FED. AID PROJECT				

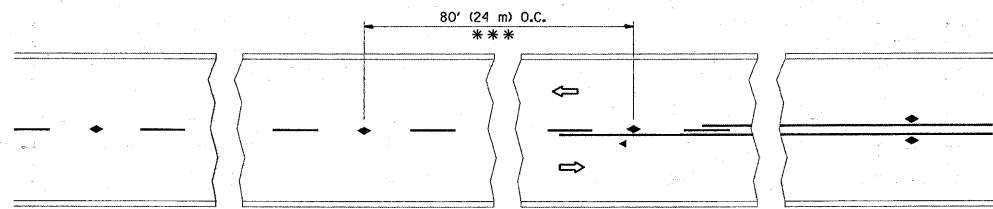

\*\*\* REDUCE TO 40' (12 m) O.C. ON CURVES WITH POSTED OR ADVISORY SPEED 45 M.P.H. (70 km/h) OR LESS.

TWO-LANE/TWO-WAY

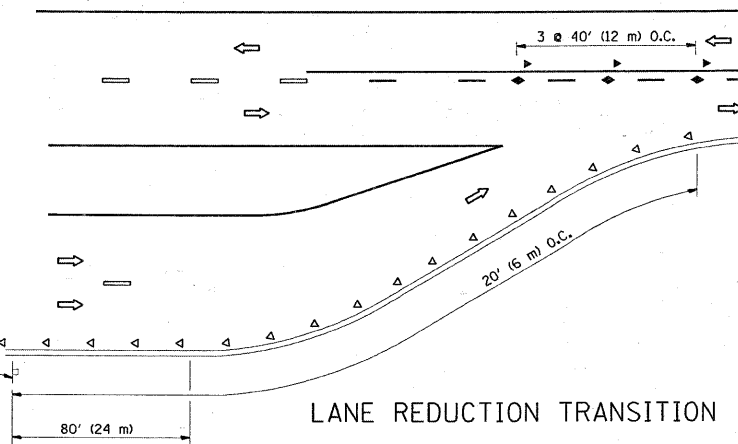

LANE REDUCTION TRANSITION

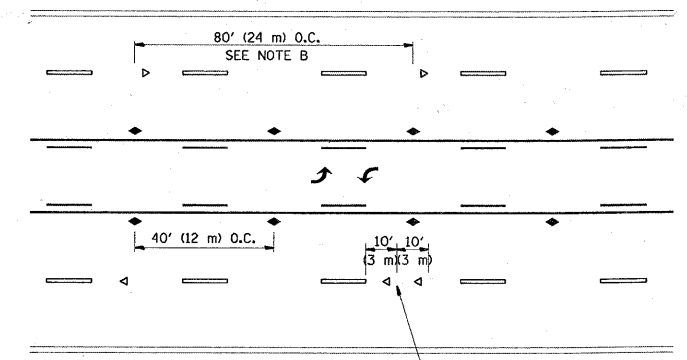

TWO-WAY LEFT TURN

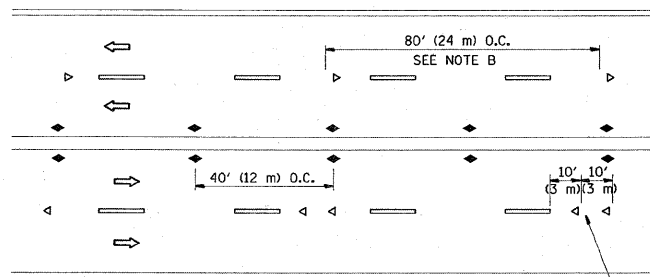

MULTI-LANE/UNDIVIDED

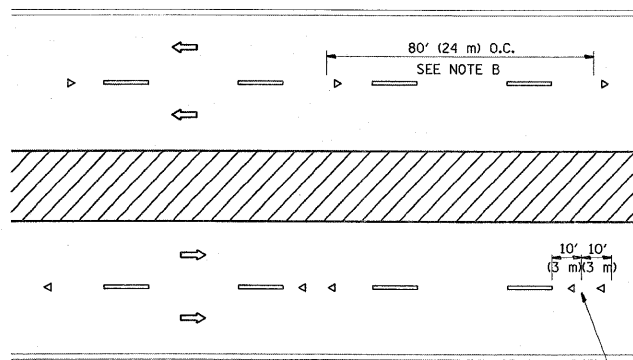

MULTI-LANE/DIVIDED

GENERAL NOTES

1. MARKERS USED WITH DASHED LINES SHALL BE CENTERED IN THE GAP BETWEEN SEGMENTS.
2. MARKERS USED ADJACENT TO SOLID LINES SHALL BE OFFSET 2 TO 3 (50 TO 75) TOWARD TRAFFIC AS SHOWN.
3. MARKERS THROUGH TANGENTS LESS THAN 500' (150 m) IN LENGTH BETWEEN CURVES SHALL BE INSTALLED AT THE LESSER OF THE TWO CURVE SPACINGS.

SYMBOLS

- YELLOW STRIPE
- WHITE STRIPE
- ◀ ONE-WAY AMBER MARKER
- ◁ ONE-WAY CRYSTAL MARKER (W/O)
- ◆ TWO-WAY AMBER MARKER

LANE MARKER NOTES

- B. REDUCE TO 40' (12 m) O.C. ON CURVES WHERE ADVISORY SPEEDS ARE 10 M.P.H. (20 km/h) LOWER THAN POSTED SPEEDS.
- A. USE DOUBLE LANE LINE MARKERS SPACED AS SHOWN.

DESIGN NOTES

1. DOUBLE LANE LINE MARKERS SHALL BE USED UNLESS SPECIFIED OTHERWISE.
2. EXCEPT AS SHOWN ON THE LANE REDUCTION TRANSITION AND FREEWAY EXIT RAMP DETAIL, MARKERS ARE NOT TO BE SPECIFIED ON RIGHT EDGE LINES.
3. THE EXACT MARKER LIMITS, SPACING, AND COLOR SHOULD BE INCLUDED IN THE PLANS.
4. MARKERS SHOULD NOT BE USED ALONGSIDE CURBS EXCEPT FOR EXTREMELY SHORT SECTIONS OF CURBS WHERE NOT MORE THAN TWO MARKERS WOULD BE INVOLVED.

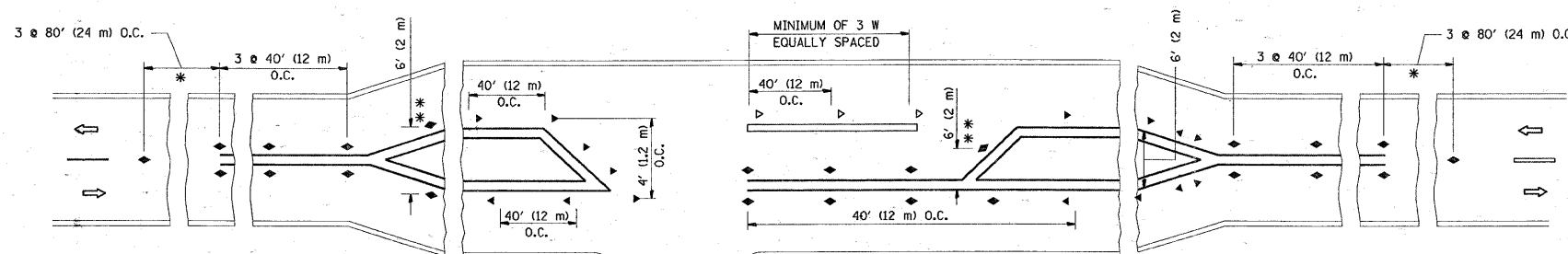

\* SEE TWO-LANE/TWO-WAY WHERE MARKERS CONTINUE  
 \*\* WHERE THE MEDIAN WIDTH IS 6' (2 m) OR LESS USE TWO-WAY MARKERS.

LEFT TURN

All dimensions are in inches (millimeters) unless otherwise shown.

FILE NAME =	USER NAME = smthkl	DESIGNED -	REVISED - T. RAMMACHER 09-19-94
ca\pwork\p\WIDOT\SMITHKL\00130047\Dist\td.dgn		DRAWN -	REVISED - T. RAMMACHER 03-12-99
	PLOT SCALE = 50.0000' / IN.	CHECKED -	REVISED - T. RAMMACHER 01-06-00
	PLOT DATE = 4/21/2009	DATE -	REVISED -

STATE OF ILLINOIS  
 DEPARTMENT OF TRANSPORTATION

TYPICAL APPLICATIONS				F.A.S. RTE. 2320/299	SECTION 43RS-1	COUNTY WILL	TOTAL SHEETS 21	SHEET NO. 18
RAISED REFLECTIVE PAVEMENT MARKERS (SNOW-PLOW RESISTANT)				TC-11		CONTRACT NO. 62688		
SCALE: NONE	SHEET NO. 1 OF 1 SHEETS	STA.	TO STA.	FED. ROAD DIST. NO. 1 [ILLINOIS] FED. AID PROJECT				

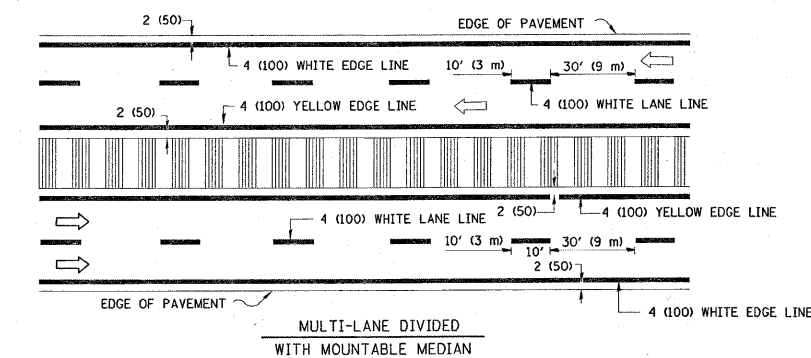
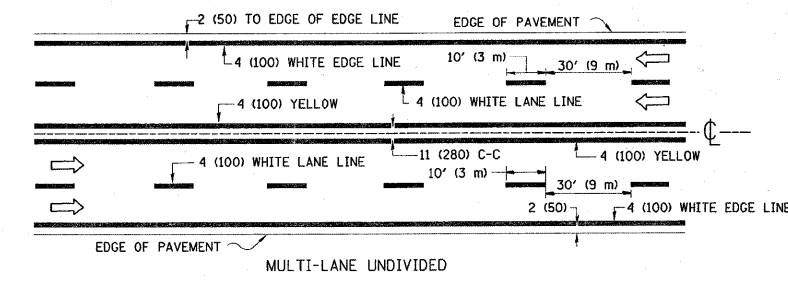
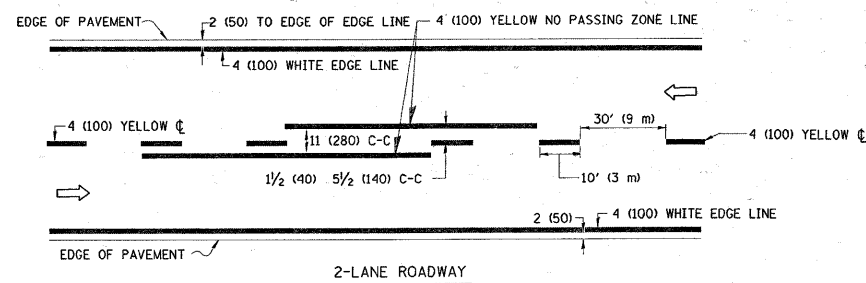

NOTE: MEDIANS WITH BARRIER CURB DO NOT REQUIRE AN EDGE LINE

### TYPICAL LANE AND EDGE LINE MARKING

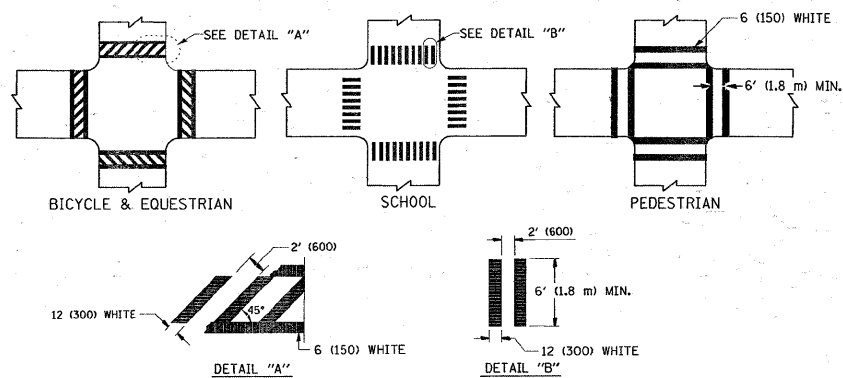

### TYPICAL CROSSWALK MARKING

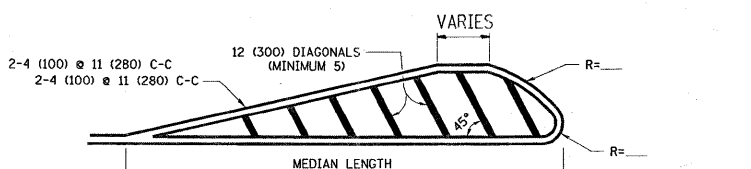
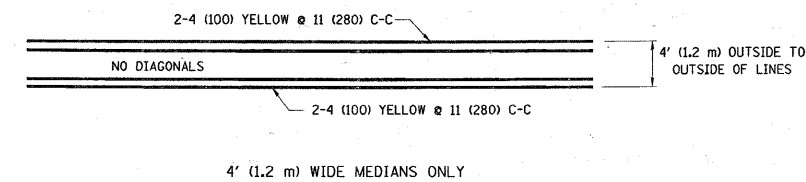

FOR MEDIAN LENGTHS WHERE DIAGONAL SPACING CANNOT BE ATTAINED, USE 5 (FIVE) EQUALLY SPACED DIAGONAL LINES.  
 DIAGONAL LINE SPACING: 50' (15 m) C-C (LESS THAN 30MPH (50 km/h))  
 75' (25 m) C-C 30MPH (50 km/h) TO 45MPH (70 km/h)  
 150' (45 m) C-C (MORE THAN 45MPH (70 km/h))

### MEDIANS OVER 4' (1.2 m) WIDE

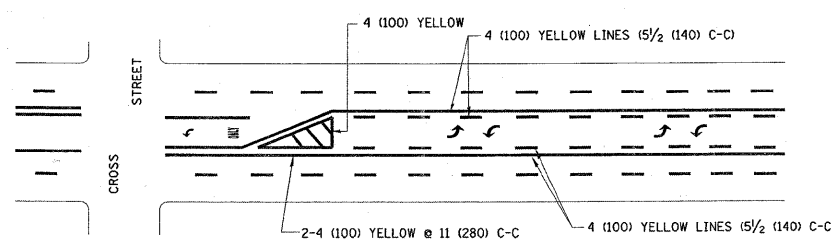

A MINIMUM OF TWO PAIRS OF TURN ARROWS SHALL BE USED, WHITE IN COLOR. ADDITIONAL PAIRS SHALL BE PLACED AT 200' (60 m) TO 300' (90 m) INTERVALS.

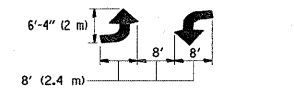

### MEDIAN WITH TWO-WAY LEFT TURN LANE

### TYPICAL PAINTED MEDIAN MARKING

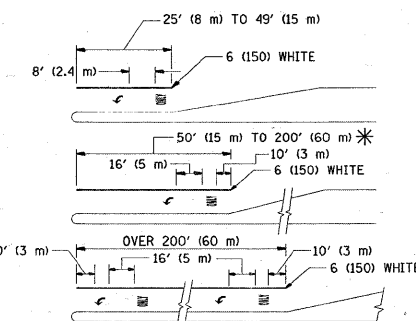

FULL SIZE LETTERS 8' (2.4 m) AND ARROWS SHALL BE USED.  
 AREA = 15.6 SQ. FT. (1.5 m<sup>2</sup>) ONLY AREA = 20.8 SQ. FT. (1.9 m<sup>2</sup>)

\* TURN LANES IN EXCESS OF 400' (120 m) IN LENGTH MAY HAVE AN ADDITIONAL SET OF ARROW - "ONLY" INSTALLED MIDWAY BETWEEN THE OTHER TWO SETS OF ARROW - "ONLY".

### TYPICAL LEFT (OR RIGHT) TURN LANE

### TYPICAL TURN LANE MARKING

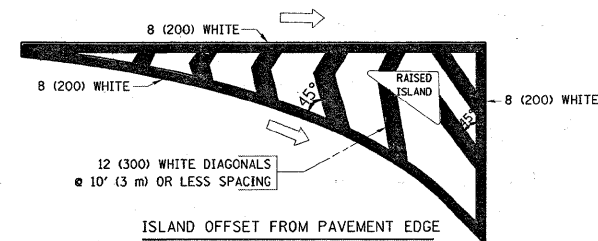

### ISLAND OFFSET FROM PAVEMENT

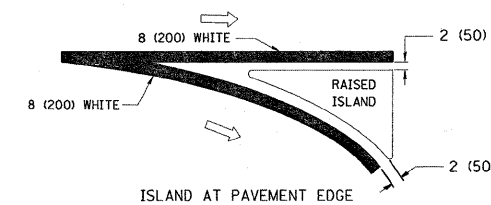

### ISLAND AT PAVEMENT EDGE

### TYPICAL ISLAND MARKING

TYPE OF MARKING	WIDTH OF LINE	PATTERN	COLOR	SPACING / REMARKS
CENTERLINE ON 2 LANE PAVEMENT	4 (100)	SKIP-DASH	YELLOW	10' (3 m) LINE WITH 30' (9 m) SPACE
CENTERLINE ON MULTI-LANE UNDIVIDED PAVEMENT	2 @ 4 (100)	SOLID	YELLOW	11 (280) C-C
NO PASSING ZONE LINES: FOR ONE DIRECTION FOR BOTH DIRECTIONS	4 (100) 2 @ 4 (100)	SOLID SOLID	YELLOW YELLOW	5/2 (140) C-C FROM SKIP-DASH CENTERLINE 11 (280) C-C OMIT SKIP-DASH CENTERLINE BETWEEN
LANE LINES	4 (100) 5 (125) ON FREEWAYS	SKIP-DASH SKIP-DASH	WHITE WHITE	10' (3 m) LINE WITH 30' (9 m) SPACE
DOTTED LINES (EXTENSIONS OF CENTER, LANE OR TURN LANE MARKINGS)	SAME AS LINE BEING EXTENDED	SKIP-DASH	SAME AS LINE BEING EXTENDED	2' (600) LINE WITH 6' (1.8 m) SPACE
EDGE LINES	4 (100)	SOLID	YELLOW-LEFT WHITE-RIGHT	OUTLINE MOUNTABLE MEDIANS IN YELLOW; EDGE LINES ARE NOT USED NEXT TO BARRIER CURB
TURN LANE MARKINGS	6 (150) LINE; FULL SIZE LETTERS & SYMBOLS (8' (2.4m))	SOLID	WHITE	SEE TYPICAL TURN LANE MARKING DETAIL
TWO WAY LEFT TURN MARKING	2 @ 4 (100) EACH DIRECTION 8' (2.4m) LEFT ARROW	SKIP-DASH AND SOLID IN PAIRS	YELLOW WHITE	10' (3 m) LINE WITH 30' (9 m) SPACE FOR SKIP-DASH; 5/2 (140) C-C BETWEEN SOLID LINE AND SKIP-DASH LINE SEE TYPICAL TWO-WAY LEFT TURN MARKING DETAIL
CROSSWALK LINES (PEDESTRIAN) A. DIAGONALS (BIKE & EQUESTRIAN) B. LONGITUDINAL BARS (SCHOOL)	2 @ 6 (150) 12 (300) @ 45° 12 (300) @ 90°	SOLID SOLID SOLID	WHITE WHITE WHITE	NOT LESS THAN 6' (1.8 m) APART 2' (600) APART SEE TYPICAL CROSSWALK MARKING DETAILS.
STOP LINES	24 (600)	SOLID	WHITE	PLACE 4' (1.2 m) IN ADVANCE OF AND PARALLEL TO CROSSWALK, IF PRESENT. OTHERWISE, PLACE AT DESIRED STOPPING POINT, PARALLEL TO CROSSROAD CENTERLINE, WHERE POSSIBLE.
PAINTED MEDIANS	2 @ 4 (100) WITH 12 (300) DIAGONALS @ 45° NO DIAGONALS USED FOR 4' (1.2 m) WIDE MEDIANS	SOLID	YELLOW; TWO WAY TRAFFIC WHITE; ONE WAY TRAFFIC	11 (280) C-C FOR THE DOUBLE LINE SEE TYPICAL PAINTED MEDIAN MARKING.
GORE MARKING AND CHANNELIZING LINES	8 (200) WITH 12 (300) DIAGONALS @ 45°	SOLID	WHITE	DIAGONALS: 15' (4.5 m) C-C (LESS THAN 30MPH (50 km/h)) 20' (6 m) C-C 30MPH (50 km/h) TO 45MPH (70 km/h) 30' (9 m) C-C (OVER 45MPH (70 km/h))
RAILROAD CROSSING	24 (600) TRANSVERSE LINES; "RR" IS 6' (1.8 m) LETTERS; 16 (400) LINE FOR "X"	SOLID	WHITE	SEE STATE STANDARD 780001 AREA OF: "R"=3.6 SQ. FT. (0.33 m <sup>2</sup> ) EACH "X"=54.0 SQ. FT. (5.0 m <sup>2</sup> )
SHOULDER DIAGONALS	12 (300) @ 45°	SOLID	WHITE - RIGHT YELLOW - LEFT	50' (15 m) C-C (LESS THAN 30MPH (50 km/h)) 75' (25 m) C-C (30 MPH (50 km/h) TO 45MPH (70 km/h)) 150' (45 m) C-C (OVER 45MPH (70 km/h))

FOR FURTHER DETAILS ON PAVEMENT MARKING REFER TO STANDARD SPECIFICATIONS FOR ROAD AND BRIDGE CONSTRUCTION AND STATE STANDARD 780001.

All dimensions are in inches (millimeters) unless otherwise shown.

FILE NAME =	USER NAME = smithkl	DESIGNED - EVERS	REVISED - T. RAMMACHER 10-27-94
ca:\pwork\PWID01\SMITHKL\0138847\01st.dgn		DRAWN -	REVISED - A. HOUSEH 10-09-96
	PLOT SCALE = 50.0000" / IN.	CHECKED -	REVISED - A. HOUSEH 10-17-96
	PLOT DATE = 4/21/2009	DATE - 03-19-90	REVISED - T. RAMMACHER 01-06-00

## STATE OF ILLINOIS DEPARTMENT OF TRANSPORTATION

DISTRICT ONE		F.A.S. RTE. 2380/2389	SECTION 43RS-1	COUNTY WILL	TOTAL SHEETS 21	SHEET NO. 19
TYPICAL PAVEMENT MARKINGS		TC-13		CONTRACT NO. 62688		
SCALE: NONE	SHEET NO. 1 OF 1 SHEETS	STA.	TO STA.		FED. ROAD DIST. NO. 1 ILLINOIS FED. AID PROJECT	

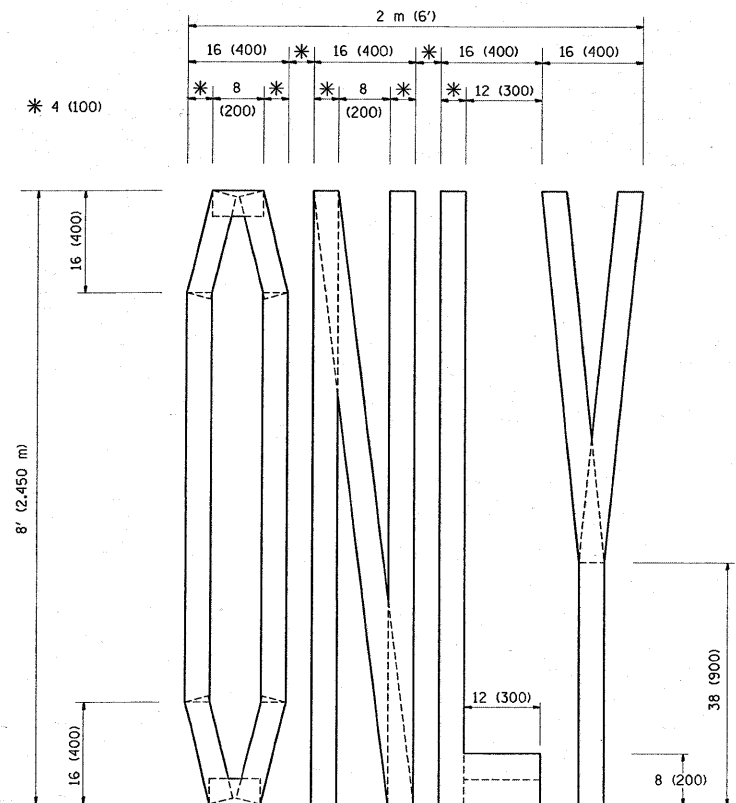

QUANTITY  
 4 (100) LINE = 64.1 ft. (19.7 m)  
 21.1 sq. ft. (1.97 sq. m)

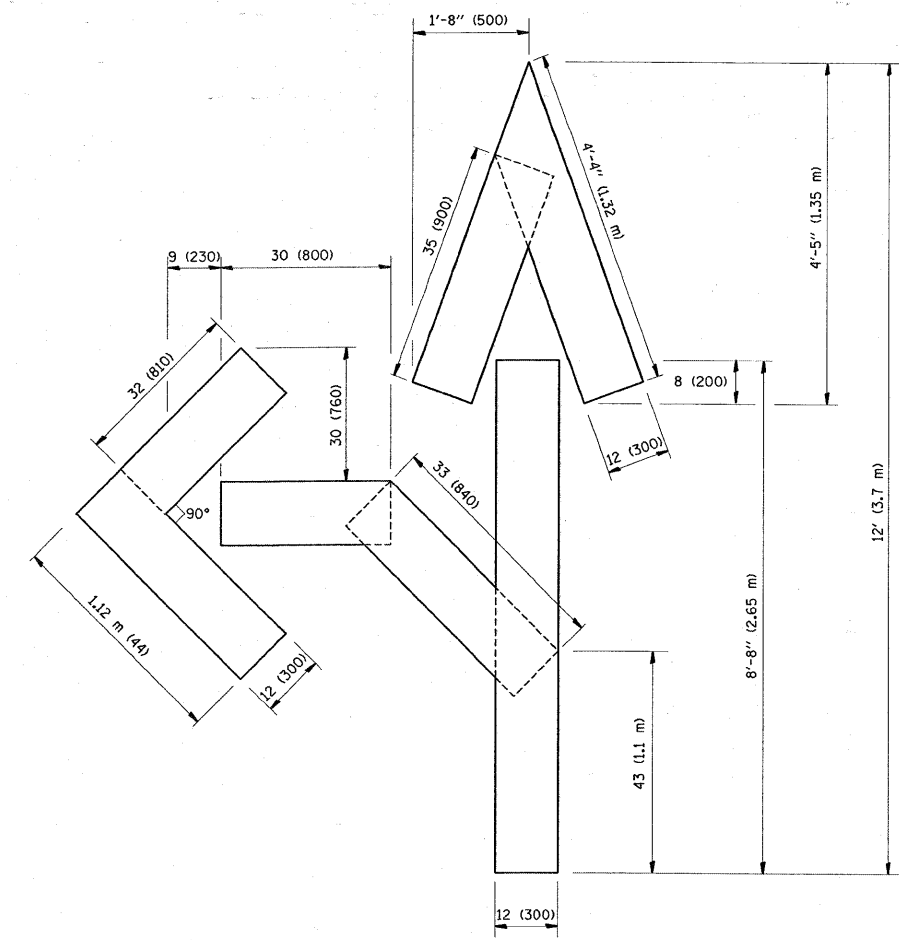

QUANTITY  
 4 (100) LINE = 82.5 ft. (25.3 m)  
 27.5 sq. ft. (2.53 sq. m)

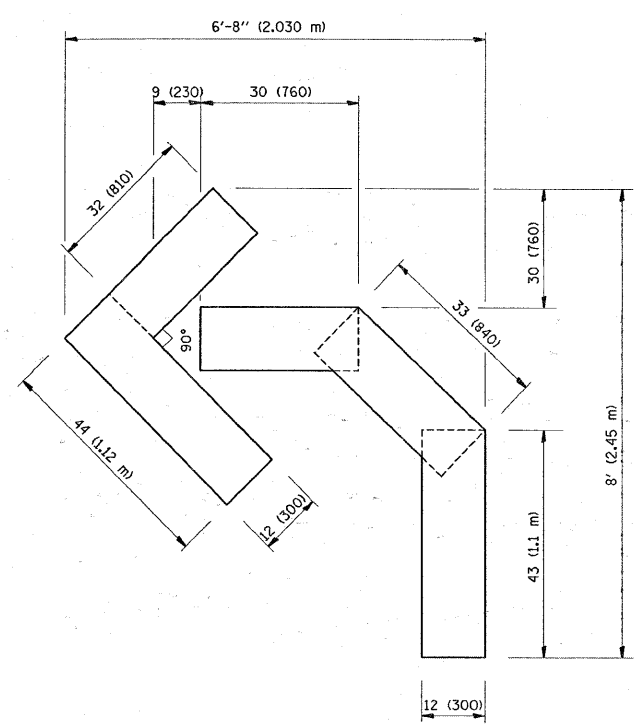

QUANTITY  
 4 (100) LINE = 45.5 ft. (13.9 m)  
 15.2 sq. ft. (1.39 sq. m)

All dimensions are in inches (millimeters) unless otherwise shown.

FILE NAME =	USER NAME = smithk1	DESIGNED -	REVISED -T. RAMMACHER 06-05-96
ca:\pwwork\p\WIDOT\SMITHKL\d0139847\01st.dgn		DRAWN -	REVISED -T. RAMMACHER 11-04-97
	PLOT SCALE = 50.0000 // IN.	CHECKED -	REVISED -T. RAMMACHER 03-02-98
	PLOT DATE = 4/21/2009	DATE - 09-18-94	REVISED -E. GOMEZ 08-28-00

**STATE OF ILLINOIS  
 DEPARTMENT OF TRANSPORTATION**

**PAVEMENT MARKING LETTERS AND SYMBOLS  
 FOR TRAFFIC STAGING**

SCALE: NONE SHEET NO. 1 OF 1 SHEETS STA. TO STA.

F.A.S. RTE. 2320/299	SECTION 43RS-1	COUNTY WILL	TOTAL SHEETS 21	SHEET NO. 20
TC-16			CONTRACT NO. 62688	
FED. ROAD DIST. NO. 1 ILLINOIS FED. AID PROJECT				

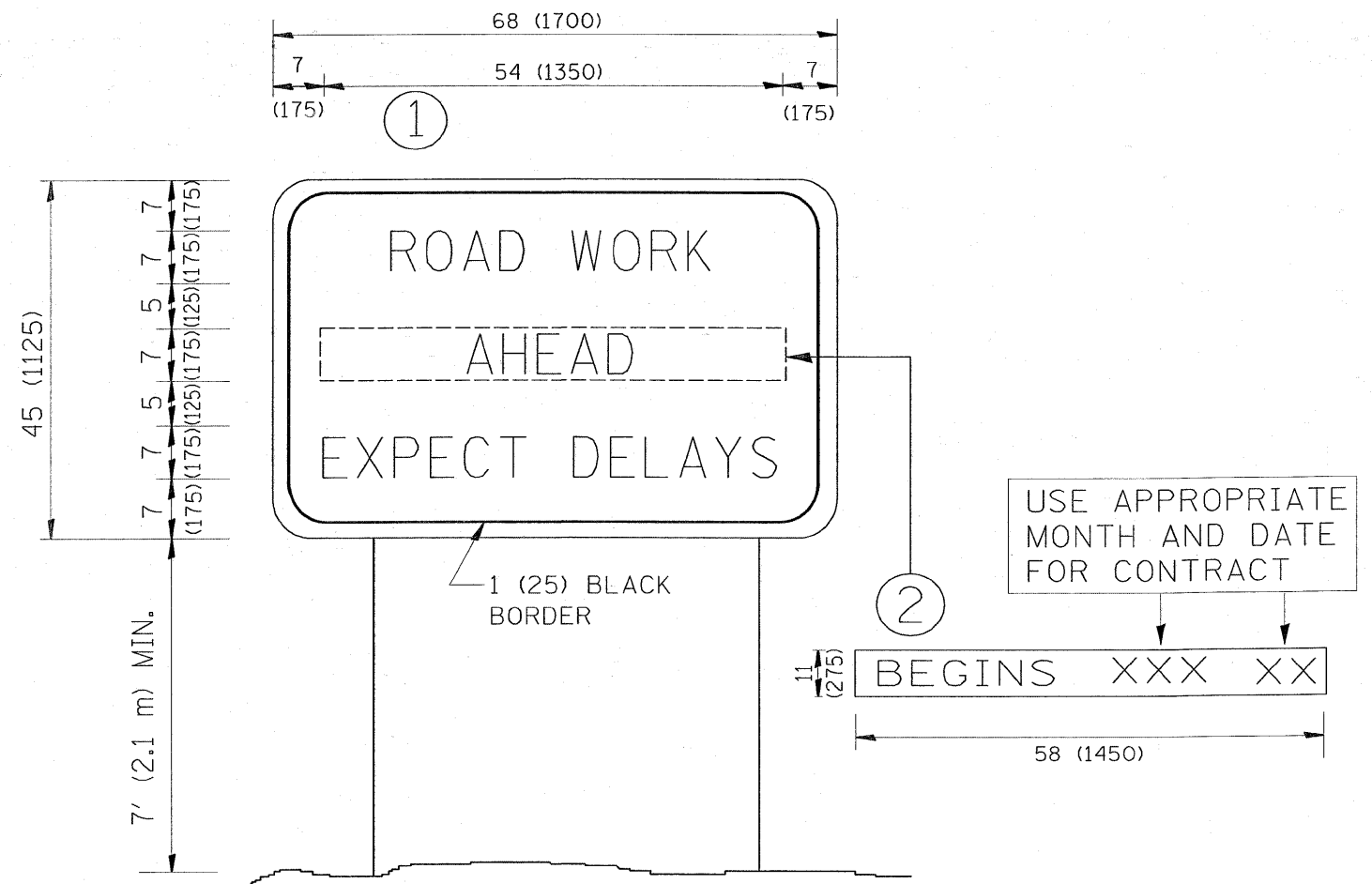

**NOTES:**

1. USE BLACK LETTERING ON ORANGE BACKGROUND.
2. ERECT SIGNS IN ADVANCE OF THE LOCATION FOR THE "ROAD CONSTRUCTION AHEAD" SIGN AT LOCATIONS AS DIRECTED BY THE ENGINEER.
3. ERECT SIGN ① WITH INSTALLED PANEL ② ONE WEEK PRIOR TO THE START OF CONSTRUCTION.
4. REMOVE PANEL ② SOON AFTER THE START OF CONSTRUCTION.
5. SEE SPECIAL PROVISION FOR "TEMPORARY INFORMATION SIGNING" FOR ADDITIONAL INFORMATION.
6. ONE SIGN ASSEMBLY EQUALS 25.70 SQ. FT. (2.3 SQ. M.)
7. SHALL BE PAID FOR AS TEMPORARY INFORMATION SIGNING.

ALL DIMENSIONS ARE IN INCHES (MILLIMETERS) UNLESS OTHERWISE SHOWN.

FILE NAME =	USER NAME = smithkl	DESIGNED -	REVISED - R. MIRS 09-15-97	<b>STATE OF ILLINOIS DEPARTMENT OF TRANSPORTATION</b>	<b>ARTERIAL ROAD INFORMATION SIGN</b>	F.A.S. RTE. 23207/299	SECTION 43RS-1	COUNTY WILL	TOTAL SHEETS 21	SHEET NO. 21
et\pe_work\FWID00T\SMITHKL\0138047\Dis\td.dgn	DRAWN -	REVISED - R. MIRS 12-11-97	TC-22			CONTRACT NO. 62688				
PLOT SCALE = 50.0000' / IN.	CHECKED -	REVISED - T. RAMMACHER 02-02-99	FED. ROAD DIST. NO. 1 ILLINOIS FED. AID PROJECT							
PLOT DATE = 4/21/2009	DATE -	REVISED - C. JUCIUS 01-31-07	SCALE: NONE			SHEET NO. 1 OF 1 SHEETS	STA. TO STA.			