

① Spacing 80 ft. (24 m) max. for first 400 ft. (122 m) or curve spacing shown in Standard 635001, whichever is less (min. 4 reflectors regardless of length).

② After 400 ft. (122 m), transition to normal delineator spacing shown in Standard 635001, and continue as required.

**ONE-WAY TRAFFIC**

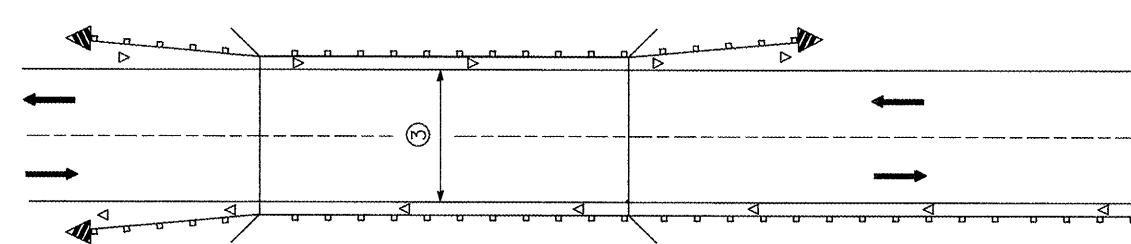

③ Bidirectional silver/silver should be used in lieu of monodirectional silver on both sides of two-lane bridges where the bridge pavement is less than 24 (610) wider than the pavement approaching the bridge.

**TWO-WAY TRAFFIC**

**GUARDRAIL / BARRIER WALL / BRIDGE RAIL REFLECTORS**

**LEGEND**

- ◁ Monodirectional silver
- ◄ Monodirectional amber
- ▴ Terminal Marker - Black/Yellow  
Left or Right as appropriate

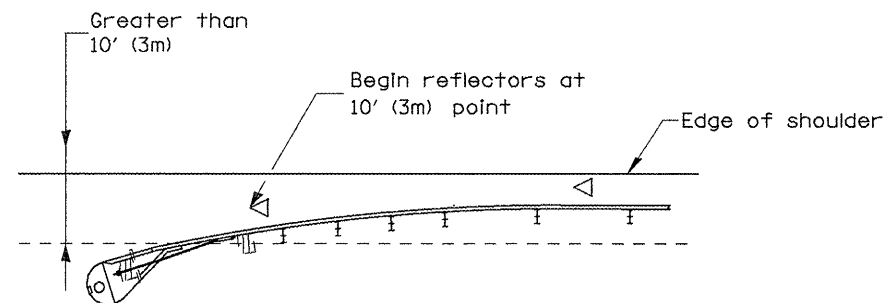

NOTE: Omit terminal marker when terminal over 10' (3m) from edge of paved shoulder or break point of unpaved shoulder, or when terminal buried in backslope.

**Traffic Barrier Terminal Type(\*) and/or Turned-Down Terminal**

[Terminal over 10' (3m) from edge of shoulder]  
\*See Plans for Type

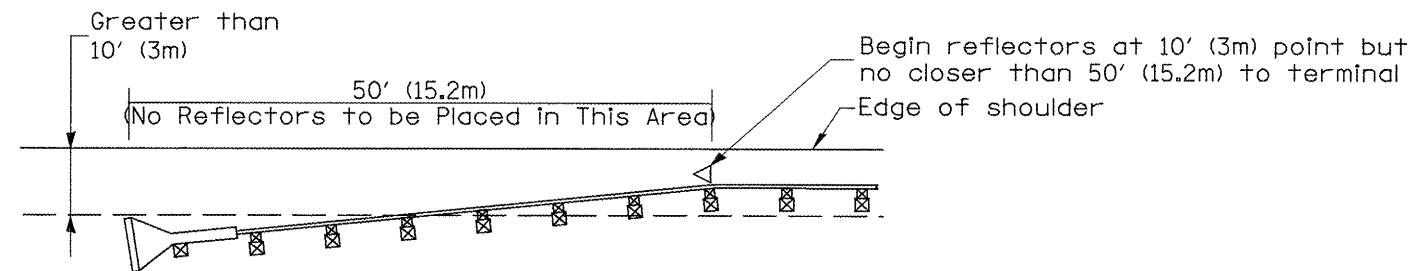

NOTE: Omit terminal marker when terminal over (10') from edge of paved shoulder or break point of unpaved shoulder.

**Traffic Barrier Terminal Type 1 (Special)**  
[Terminal over 10' (3m) from edge of shoulder]

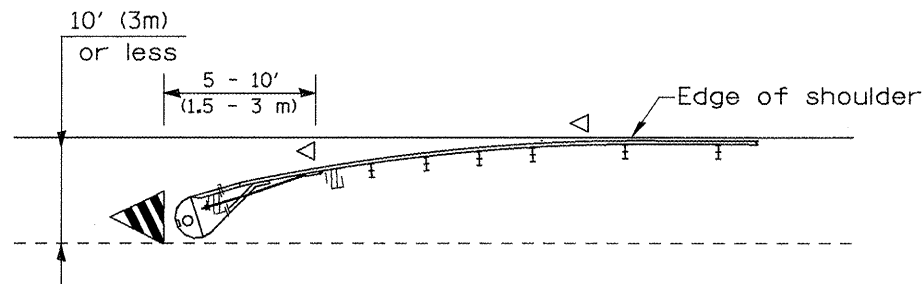

**Traffic Barrier Terminal Type(\*) and/or Turned-Down Terminal**  
[Terminal over 10' (3m) or less from edge of shoulder]  
\*See Plans for Type

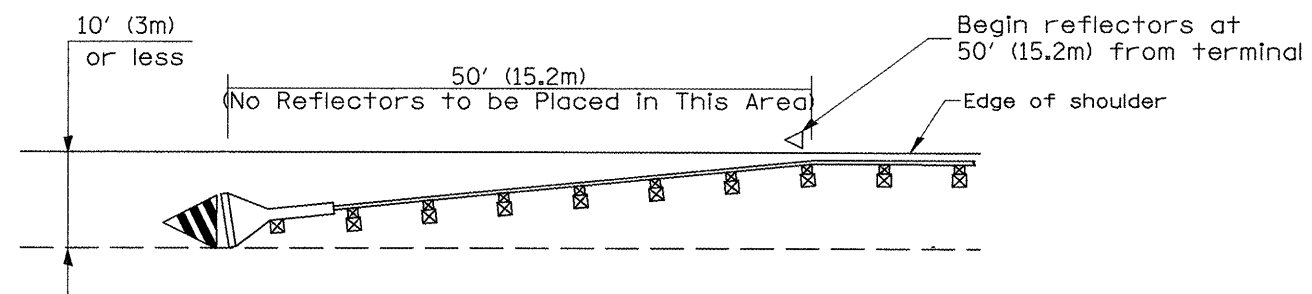

**Traffic Barrier Terminal Type 1(Special)**  
[Terminal 10' (3m) or less from edge of shoulder]

**TERMINAL MARKER PLACEMENT**

All dimensions are in inches (millimeters) unless otherwise noted.

F.A.P. RTE.	SECTION	COUNTY	TOTAL SHEETS	SHEET NO.
317	(16.13)RS-3,17RS-5,14RS-1	PEORIA/TAZEWELL	56	52
CADD STD. 635101-04			CONTRACT NO. 68455	
FED. ROAD DIST. NO. ILLINOIS FED. AID PROJECT				