

F.A.P. RTE.	SECTION	COUNTY	TOTAL SHEETS	SHEET NO.
693		TAZEWELL	54	27
STA. _____ TO STA. _____		ILLINOIS FED. AID PROJECT		
FED. ROAD DIST. NO. _____		CONTRACT NO. 68892		

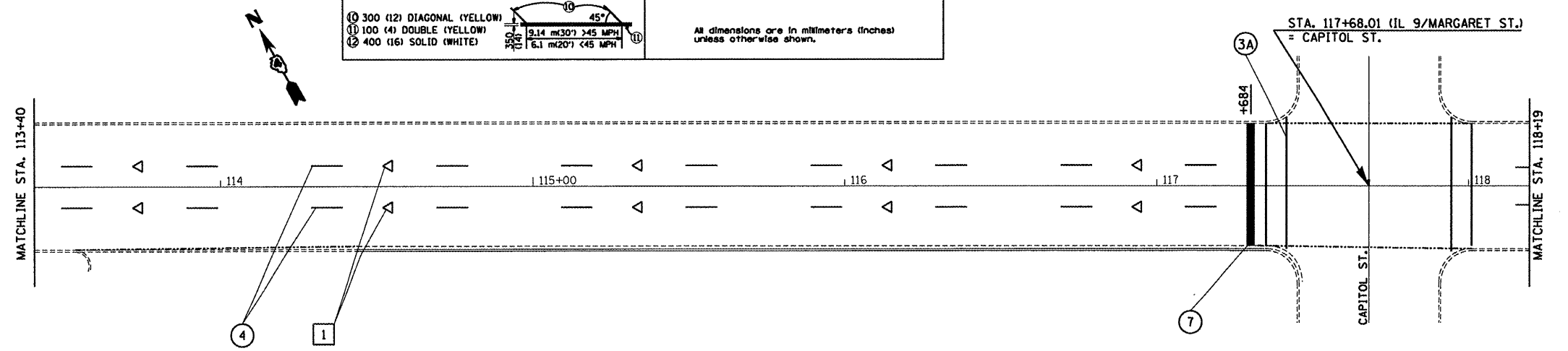

PAVEMENT MARKING LEGEND		RAISED REFLECTIVE PAVEMENT MARKERS (RRPM)	
① 100 (4) SOLID (YELLOW)		① ONE-WAY CRYSTAL MARKER AT 24.38 m(80') CENTERS	
② 100 (4) SOLID (WHITE)		② ONE-WAY CRYSTAL MARKER AT 12.19 m(40') CENTERS	
③ 2-150 (6) CROSSWALK @ min. 2 m (6.5') c.c. (WHITE)		③ ONE-WAY CRYSTAL MARKER AT 6.10 m(20') CENTERS	
④ 2-200 (8) CROSSWALK @ min. 2 m (6.5') c.c. (WHITE)		④ ONE-WAY AMBER MARKER AT 12.19 m(40') CENTERS	
⑤ 150 (6) SKIP DASH (WHITE)		⑤ TWO-WAY AMBER MARKER AT 12.19 m(40') CENTERS	
⑥ 200 (8) SOLID (WHITE)		⑥ ONE-WAY CRYSTAL MARKER	
⑦ 300 (12) DIAGONAL (WHITE)		⑦ ONE-WAY AMBER MARKER	
⑧ 600 (24) STOP BAR (WHITE)			
⑨ LETTERS AND ARROWS			
⑩ 100 (4) SKIP DASH (YELLOW)			
⑪ 300 (12) DIAGONAL (YELLOW)			
⑫ 100 (4) DOUBLE (YELLOW)			
⑬ 400 (16) SOLID (WHITE)			

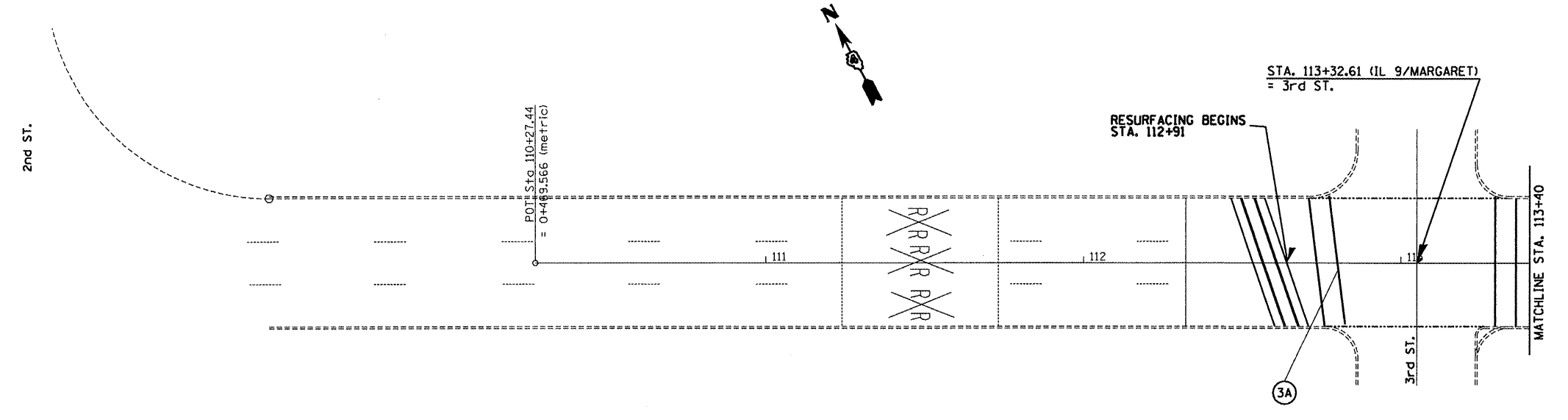
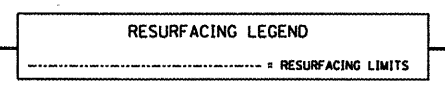
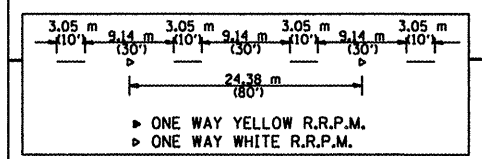

**DELINEATORS**

- ▬ DELINEATOR WITH TWO AMBER REFLECTORS
- ▬ DELINEATOR WITH THREE AMBER REFLECTORS

All dimensions are in millimeters (inches) unless otherwise shown.

STA. 117+68.01 (IL 9/MARGARET ST.) = CAPITOL ST.

REVISIONS	
NAME	DATE

ILLINOIS DEPARTMENT OF TRANSPORTATION  
**PAVEMENT MARKING  
 DETAILS &  
 RESURFACING LIMITS**  
 MARGARET ST. STA. 109+69 TO STA.118+19  
 DRAWN BY \_\_\_\_\_  
 CHECKED BY \_\_\_\_\_  
 DATE \_\_\_\_\_

\$\$\$DATE\$\$\$  
 \*DGN-ONLY\*