

F.A.I. RTE.	SECTION	COUNTY	TOTAL SHEETS	SHEET NO.
72	*	**	104	39

STA. 1407+00 TO STA. 1437+50  
 FED. ROAD DIST. NO. ILLINOIS FED. AID PROJECT

- 74(10-70)RS-3 & (10-71,73)RS-2
- PIATT & CHAMPAIGN CONTRACT NO. 70025

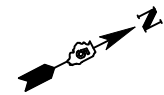

EXISTING STRUCTURE DATA  
 Q STATION 1421+61.77 (F.A.I. ROUTE 72)  
 SKEW 33°-58'-54" LT. FOR.  
 APPROX. LENGTH 269'-2"  
 (BK.-BK. APPR. BENTS)  
 APPROX. HORIZ. CLEARANCE 34'-0"  
 CONSTRUCTED AS SECTION 74-70 HB  
 STRUCTURE No. 074-0007  
 DATA OBTAINED FROM OLD PLANS

STATION EQUATION  
 STATION 1436+97.55 (FAI 72) =  
 STATION 200+00.00 (RAMP B)

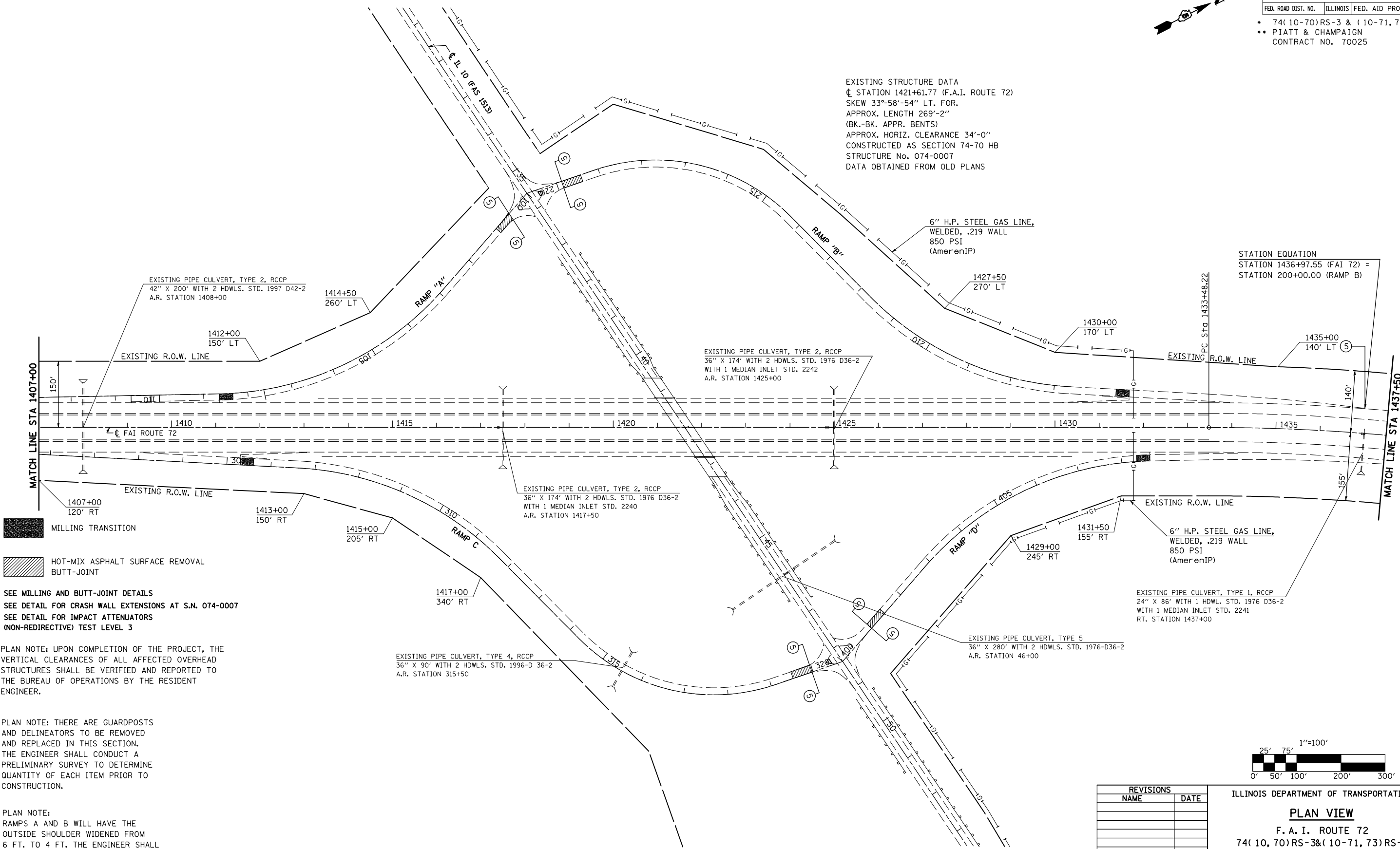

- MILLING TRANSITION
- HOT-MIX ASPHALT SURFACE REMOVAL BUTT-JOINT

SEE MILLING AND BUTT-JOINT DETAILS  
 SEE DETAIL FOR CRASH WALL EXTENSIONS AT S.N. 074-0007  
 SEE DETAIL FOR IMPACT ATTENUATORS (NON-REDIRECTIVE) TEST LEVEL 3

PLAN NOTE: UPON COMPLETION OF THE PROJECT, THE VERTICAL CLEARANCES OF ALL AFFECTED OVERHEAD STRUCTURES SHALL BE VERIFIED AND REPORTED TO THE BUREAU OF OPERATIONS BY THE RESIDENT ENGINEER.

PLAN NOTE: THERE ARE GUARDPOSTS AND DELINEATORS TO BE REMOVED AND REPLACED IN THIS SECTION. THE ENGINEER SHALL CONDUCT A PRELIMINARY SURVEY TO DETERMINE QUANTITY OF EACH ITEM PRIOR TO CONSTRUCTION.

PLAN NOTE: RAMPS A AND B WILL HAVE THE OUTSIDE SHOULDER WIDENED FROM 6 FT. TO 4 FT. THE ENGINEER SHALL CONDUCT A PRELIMINARY SURVEY TO DETERMINE THE LOCATION TO BEGIN AND END THE SHOULDER WIDENING.

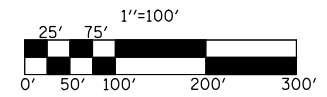

REVISIONS	
NAME	DATE

ILLINOIS DEPARTMENT OF TRANSPORTATION  
**PLAN VIEW**  
 F. A. I. ROUTE 72  
 74(10,70)RS-3&(10-71,73)RS-2  
 PIATT & CHAMPAIGN COUNTY  
 SCALE: 1" = 100'  
 DATE: JULY 2003  
 DRAWN BY  
 CHECKED BY