

F.A.I. RTE.	SECTION	COUNTY	TOTAL SHEETS	SHEET NO.
72	*	**	104	48

STA. 1660+00	TO STA. 1690+00
FED. ROAD DIST. NO.	ILLINOIS FED. AID PROJECT

- 74(10-70)RS-3 & (10-71,73)RS-2
- PIATT & CHAMPAIGN CONTRACT NO. 70025

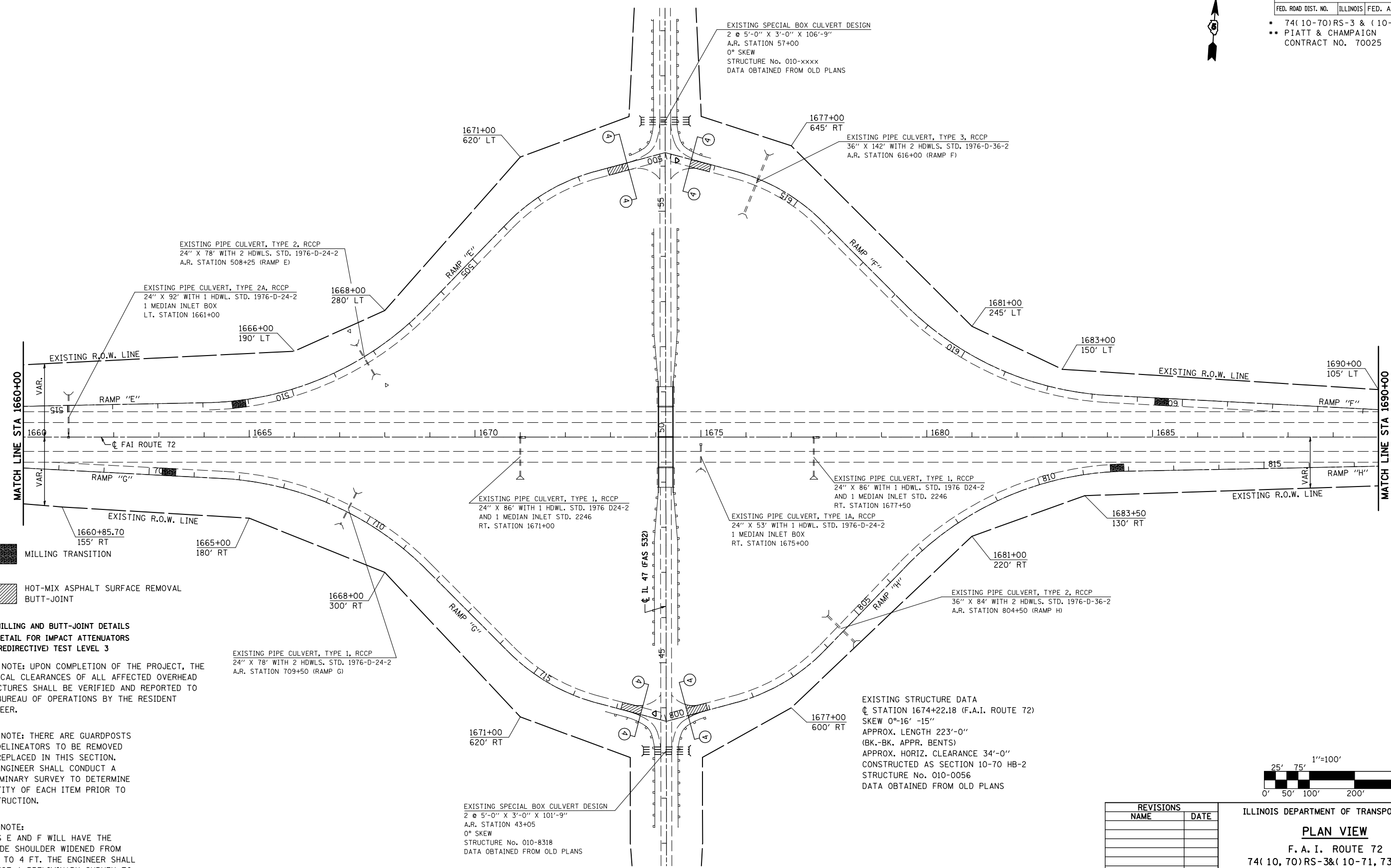

EXISTING PIPE CULVERT, TYPE 2, RCCP
24" X 78" WITH 2 HDWLS. STD. 1976-D-24-2
A.R. STATION 508+25 (RAMP E)

EXISTING PIPE CULVERT, TYPE 2A, RCCP
24" X 92" WITH 1 HDWL. STD. 1976-D-24-2
1 MEDIAN INLET BOX
LT. STATION 1661+00

EXISTING SPECIAL BOX CULVERT DESIGN
2 @ 5'-0" X 3'-0" X 106'-9"
A.R. STATION 57+00
0° SKEW
STRUCTURE No. 010-xxxx
DATA OBTAINED FROM OLD PLANS

EXISTING PIPE CULVERT, TYPE 3, RCCP
36" X 142" WITH 2 HDWLS. STD. 1976-D-36-2
A.R. STATION 616+00 (RAMP F)

EXISTING PIPE CULVERT, TYPE 1, RCCP
24" X 86" WITH 1 HDWL. STD. 1976 D24-2
AND 1 MEDIAN INLET STD. 2246
RT. STATION 1671+00

EXISTING PIPE CULVERT, TYPE 1A, RCCP
24" X 53" WITH 1 HDWL. STD. 1976-D-24-2
1 MEDIAN INLET BOX
RT. STATION 1675+00

EXISTING PIPE CULVERT, TYPE 1, RCCP
24" X 86" WITH 1 HDWL. STD. 1976 D24-2
AND 1 MEDIAN INLET STD. 2246
RT. STATION 1677+50

EXISTING PIPE CULVERT, TYPE 2, RCCP
36" X 84" WITH 2 HDWLS. STD. 1976-D-36-2
A.R. STATION 804+50 (RAMP H)

EXISTING PIPE CULVERT, TYPE 1, RCCP
24" X 78" WITH 2 HDWLS. STD. 1976-D-24-2
A.R. STATION 709+50 (RAMP G)

EXISTING STRUCTURE DATA
CL STATION 1674+22.18 (F.A.I. ROUTE 72)
SKEW 0°-16' -15"
APPROX. LENGTH 223'-0"
(BK.-BK. APPR. BENTS)
APPROX. HORIZ. CLEARANCE 34'-0"
CONSTRUCTED AS SECTION 10-70 HB-2
STRUCTURE No. 010-0056
DATA OBTAINED FROM OLD PLANS

EXISTING SPECIAL BOX CULVERT DESIGN
2 @ 5'-0" X 3'-0" X 101'-9"
A.R. STATION 43+05
0° SKEW
STRUCTURE No. 010-8318
DATA OBTAINED FROM OLD PLANS

SEE MILLING AND BUTT-JOINT DETAILS
SEE DETAIL FOR IMPACT ATTENUATORS
(NON-REDIRECTIVE) TEST LEVEL 3

PLAN NOTE: UPON COMPLETION OF THE PROJECT, THE VERTICAL CLEARANCES OF ALL AFFECTED OVERHEAD STRUCTURES SHALL BE VERIFIED AND REPORTED TO THE BUREAU OF OPERATIONS BY THE RESIDENT ENGINEER.

PLAN NOTE: THERE ARE GUARDPOSTS AND DELINEATORS TO BE REMOVED AND REPLACED IN THIS SECTION. THE ENGINEER SHALL CONDUCT A PRELIMINARY SURVEY TO DETERMINE QUANTITY OF EACH ITEM PRIOR TO CONSTRUCTION.

PLAN NOTE: RAMP E AND F WILL HAVE THE OUTSIDE SHOULDER WIDENED FROM 6 FT. TO 4 FT. THE ENGINEER SHALL CONDUCT A PRELIMINARY SURVEY TO DETERMINE THE LOCATION TO BEGIN AND END THE SHOULDER WIDENING.

REVISIONS	
NAME	DATE

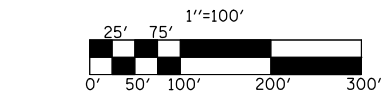

ILLINOIS DEPARTMENT OF TRANSPORTATION

PLAN VIEW

F. A. I. ROUTE 72
74(10,70)RS-3&(10-71,73)RS-2
PIATT & CHAMPAIGN COUNTY

SCALE: 1" = 100'
DATE: JULY 2003

DRAWN BY
CHECKED BY