

F.A.P. RTE.	SECTION	COUNTY	TOTAL SHEETS	SHEET NO.
323	(149,150)RS-3	EDGAR	83	1

STATE OF ILLINOIS  
 DEPARTMENT OF TRANSPORTATION  
 DIVISION OF HIGHWAYS  
**PROPOSED  
 HIGHWAY PLANS**

D-95-043-00

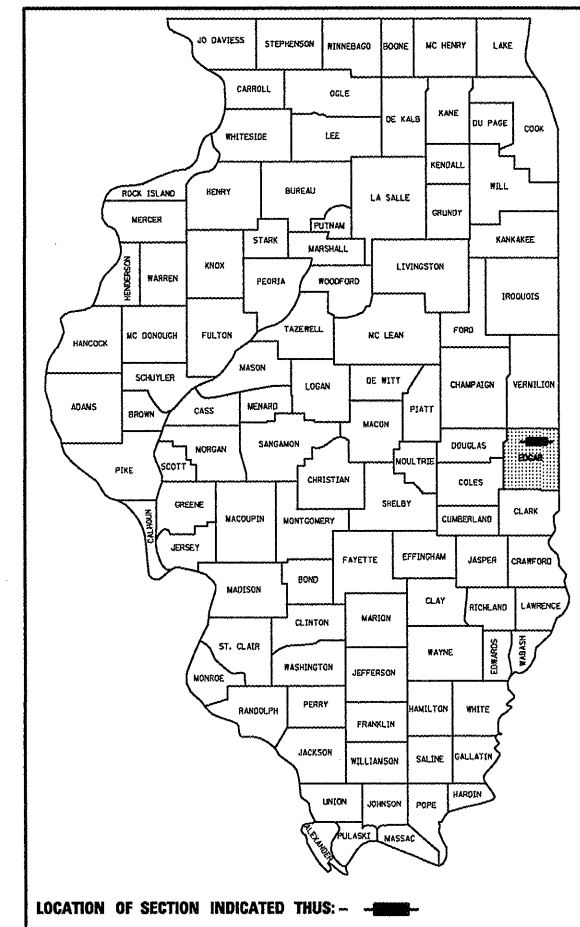

LOCATION OF SECTION INDICATED THUS: - [shaded box] -

FOR INDEX OF SHEETS, SEE SHEET NO. 2  
 FOR SUMMARY OF QUANTITIES, SEE SHEETS NO. 4 - 7

ADDITIONAL STRUCTURE INFORMATION

S.N.	SCOPE OF WORK
16-02	CULVERT REPLACEMENT
18-22	CULVERT REPLACEMENT
18-52	CULVERT REPLACEMENT
023-0010	OMISSION
023-0025	OMISSION
023-0030	OMISSION
023-8017	HMA RESURFACING
023-8018	HMA RESURFACING
023-8311	HMA RESURFACING

F.A.P. ROUTE 323 (U.S. ROUTE 36)  
 SECTION (149,150)RS-3

EDGAR COUNTY

C-95-105-00

RESURFACING MAINTENANCE (3P),  
 GUARDRAIL, CULVERT REPLACEMENT

US 150 AT CHRISMAN TO INDIANA STATE LINE

PROP. S. N. 023-2017  
 CULVERT NO. 3  
 STATION 1833+78.50  
 PROP. PCC BOX CULVERT  
 4' X 2'

PROP. S. N. 023-8063  
 CULVERT NO. 2  
 STATION 1818+71.00  
 PROP. PCC BOX CULVERT  
 6' X 3'

S. N. 023-0010  
 STRUCTURE OMISSION  
 STATION 1785+07.35 TO  
 STATION 1786+32.63

F. A. P. ROUTE 323  
 SECTION BEGINS  
 STATION 1681+95.00

S. N. 023-0025  
 STRUCTURE OMISSION  
 STATION 1944+65.00 TO  
 STATION 1945+91.80

F. A. P. ROUTE 323  
 SECTION ENDS  
 STATION 2081+75.87

S. N. 023-0030  
 STRUCTURE OMISSION  
 STATION 2027+66.58 TO  
 STATION 2028+59.42

CULVERT NO. 1  
 STATION 1701+41.00  
 PROP. PCC BOX CULVERT  
 2 @ 10' X 2'

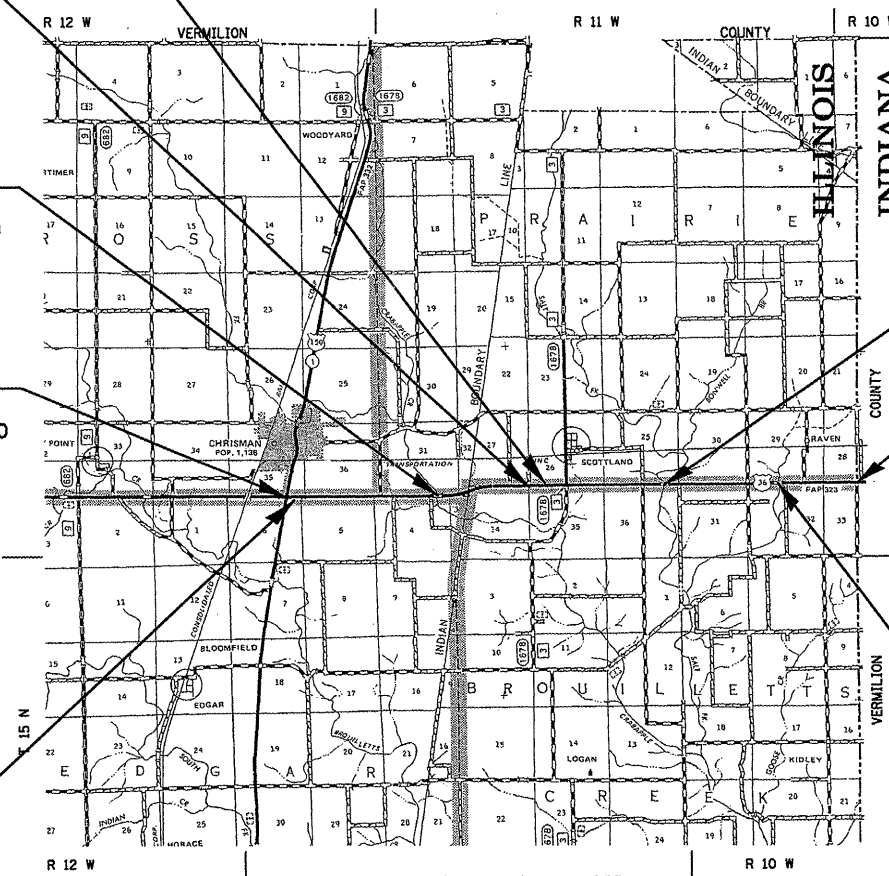

CURRENT ADT:

1,650 (2007)  
 PV = 73.4%  
 SU = 8.5%  
 MU = 18.1%

DESIGN DESIGNATION

OTHER PRINCIPAL ARTERIAL

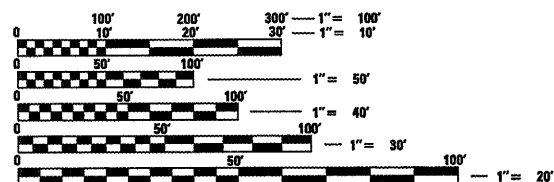

FULL SIZE PLANS HAVE BEEN PREPARED USING STANDARD  
 ENGINEERING SCALES. REDUCED SIZED PLANS WILL NOT  
 CONFORM TO STANDARD SCALES. IN MAKING MEASUREMENTS  
 ON REDUCED PLANS, THE ABOVE SCALES MAY BE USED.

J.U.L.I.E.  
 JOINT UTILITY LOCATION INFORMATION FOR EXCAVATION  
 1-800-892-0123 (CHRISMAN TOWNSHIP)

CONTRACT NO. 70113

TOTAL LENGTH OF SECTION & PROJECT = 39980.870 FEET = 7.572 MILES  
 NET LENGTH OF SECTION & PROJECT = 39635.950 FEET = 7.507 MILES

STATE OF ILLINOIS  
 DEPARTMENT OF TRANSPORTATION  
 DIVISION OF HIGHWAYS

SUBMITTED 4/6 20 09  
 x [Signature] DEPUTY DIRECTOR OF HIGHWAYS, REGION THREE ENGINEER  
 May 1 20 09  
 [Signature] ENGINEER OF DESIGN AND ENVIRONMENT  
 May 1 20 09  
 [Signature] DIRECTOR OF HIGHWAYS, CHIEF ENGINEER

PRINTED BY THE AUTHORITY  
 OF THE STATE OF ILLINOIS