

STATE OF ILLINOIS
DEPARTMENT OF TRANSPORTATION
DIVISION OF HIGHWAYS

**PROPOSED
HIGHWAY PLANS**

F.A.P. ROUTE 693 (IL 9)
SECTION (21,22)R,RS-1

**RESURFACING (3P) BOX CULVERT REPLACEMENT
MCLEAN COUNTY**

F.A.P. RTE.	SECTION	COUNTY	TOTAL SHEETS	SHEET NO.
693	(22,21)R,RS-1	MCLEAN	105	1
		ILLINOIS	CONTRACT NO. 70509	

D-95-029-06

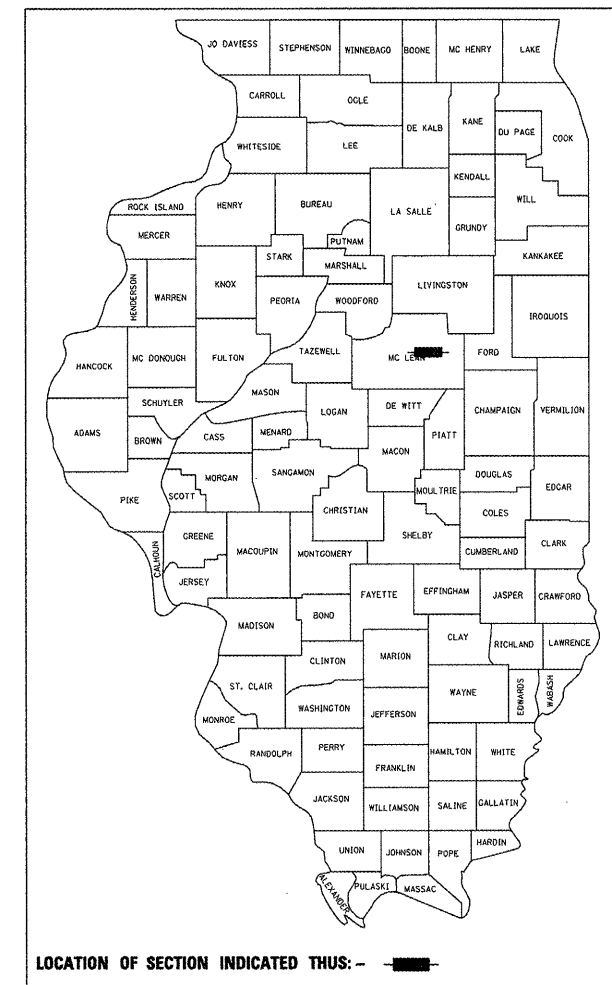

FOR INDEX OF SHEETS, SEE SHEET NO. 2
FOR SUMMARY OF QUANTITIES, SEE SHEETS 4-6

RESURFACING OMISSIONS

S.N. 057-0076: 1914 + 50.00 TO 1919 + 60.00
S.N. 057-0077: 1646 + 98.35 TO 1647 + 24.84
S.N. 057-0139: 1608 + 90.10 TO 1609 + 09.64

H.M.A. RESURFACING

S.N. 057-8143
S.N. 057-8144
S.N. 057-8146
S.N. 057-8147
S.N. 057-8164
S.N. 057-8165

**STRUCTURE REPLACEMENTS
SEE LOCATION MAP**

CURRENT ADT
EAST OF IL 165 = 4,200 (2007)
EAST OF ELSWORTH RD = 2,400 (2007)

DESIGN DESIGNATION
N/A

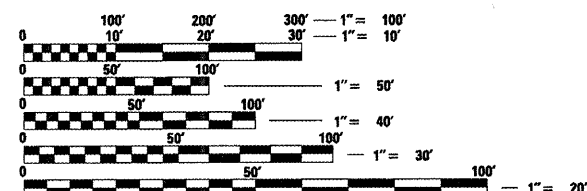

FULL SIZE PLANS HAVE BEEN PREPARED USING STANDARD ENGINEERING SCALES. REDUCED SIZED PLANS WILL NOT CONFORM TO STANDARD SCALES. IN MAKING MEASUREMENTS ON REDUCED PLANS, THE ABOVE SCALES MAY BE USED.

J.U.L.I.E.
JOINT UTILITY LOCATION INFORMATION FOR EXCAVATION
1-800-892-0123
OR 811

PROJECT ENGINEER - NANCY FASIG
DESIGNER - RYAN CARROLL

CONTRACT NO. 70509

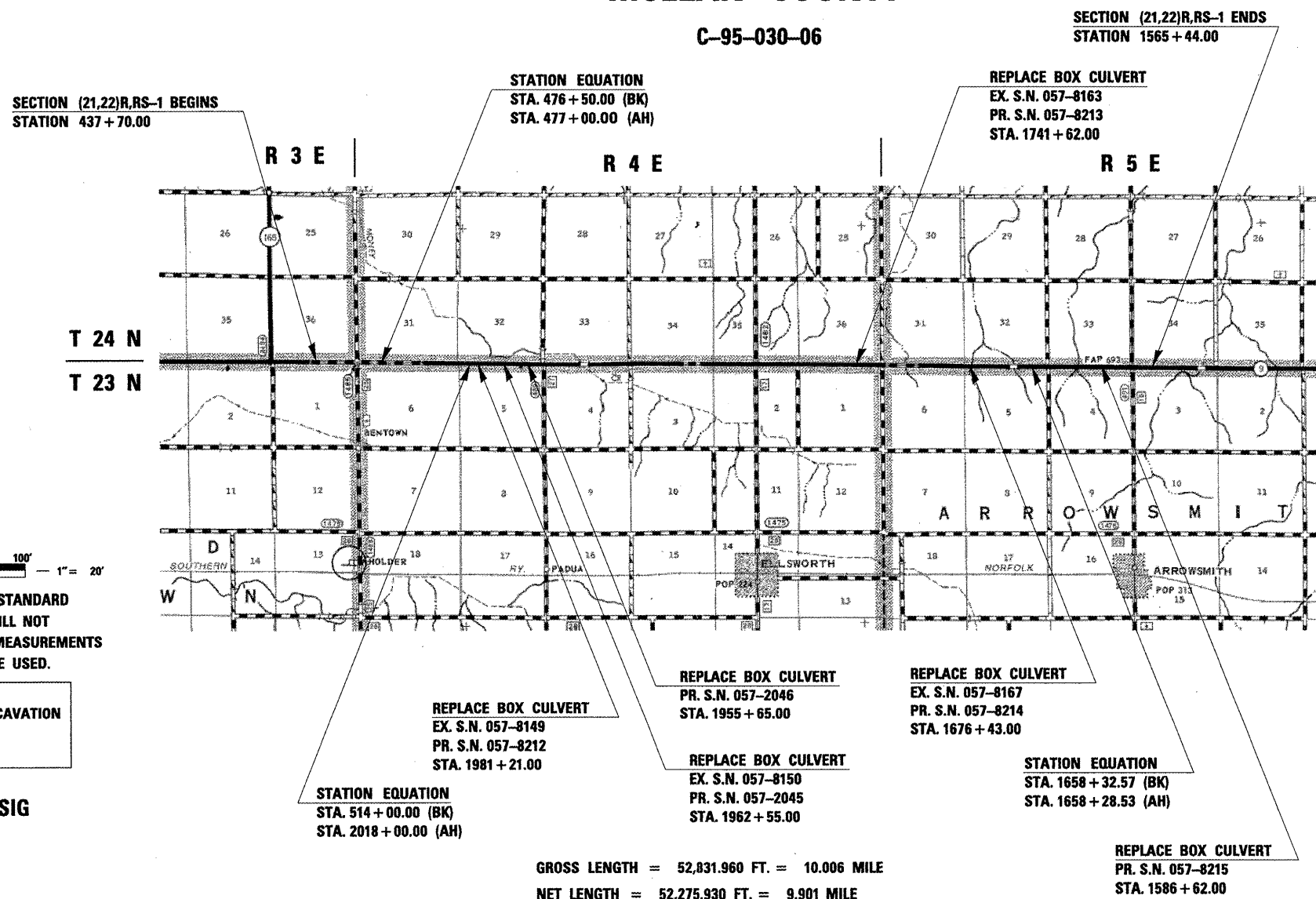

STATE OF ILLINOIS
DEPARTMENT OF TRANSPORTATION
DIVISION OF HIGHWAYS

SUBMITTED 4/3 20 09
David R. Dowson
DEPUTY DIRECTOR OF HIGHWAYS, REGION 3 ENGINEER

May 1, 20 09
Charles J. Imersoll
ENGINEER OF DESIGN AND ENVIRONMENT

May 1, 20 09
Christine M. Reed
DIRECTOR OF HIGHWAYS, CHIEF ENGINEER

**PRINTED BY THE AUTHORITY
OF THE STATE OF ILLINOIS**