

STATE OF ILLINOIS
DEPARTMENT OF TRANSPORTATION
DIVISION OF HIGHWAYS

**PROPOSED
HIGHWAY PLANS**

FAP ROUTE 758 (ILL ROUTE 32)
SECTION 3RS-4,(4,5)RS-2

3P RESURFACING
MOULTRIE COUNTY

C-97-065-09

F.A.P. RTE.	SECTION	COUNTY	TOTAL SHEETS	SHEET NO.
758	3RS-4,(4,5)RS-2	Moultrie	10	1
ILLINOIS			CONTRACT NO. 74380	

FOR INDEX OF SHEETS, SEE SHEET NO. 2

ADT = 1800(2007)

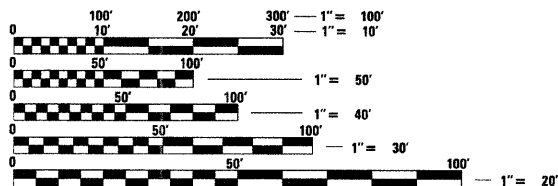
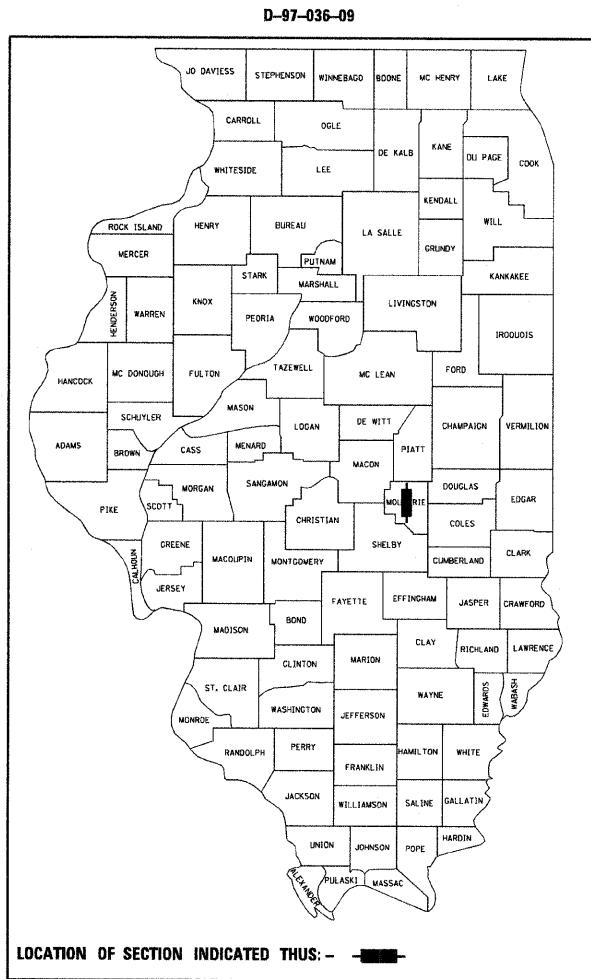

FULL SIZE PLANS HAVE BEEN PREPARED USING STANDARD ENGINEERING SCALES. REDUCED SIZED PLANS WILL NOT CONFORM TO STANDARD SCALES. IN MAKING MEASUREMENTS ON REDUCED PLANS, THE ABOVE SCALES MAY BE USED.

J.U.L.I.E.
JOINT UTILITY LOCATION INFORMATION FOR EXCAVATION
1-800-892-0123
OR 811

PROJECT ENGINEER: MARK DAUGHERTY
PROJECT MANAGER: SOLOMON DZAKUMA

CONTRACT NO. 74380

BRIDGE OMISSION
STA 68+15.6 TO
STA 68+40.4

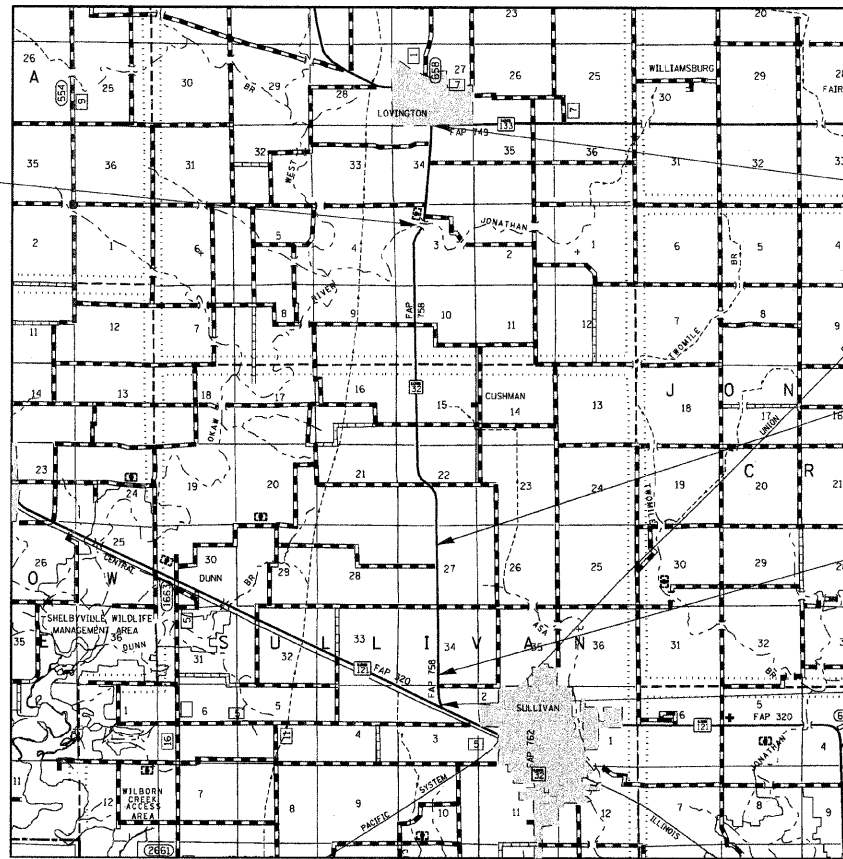

PROJECT BEGINS
STA 0+35

STATION EQUATION
STA 285+99.7 (BK) =
STA 284+64 (AH)

STATION EQUATION
STA 376+86 (BK) =
STA 913+00 (AH)

PROJECT ENDS
STA 900+23

GROSS LENGTH = 39,063.7 FT. = 7.398 MILES
NET LENGTH = 39,038.9 FT. = 7.394 MILES

STATE OF ILLINOIS
DEPARTMENT OF TRANSPORTATION
DIVISION OF HIGHWAYS

SUBMITTED April 10 20 09

Raymond L. Sindell
DEPUTY DIRECTOR OF HIGHWAYS, REGION ENGINEER

May 1, 20 09
Charles J. Ingersoll
ENGINEER OF DESIGN AND ENVIRONMENT

May 1, 20 09
Christine M. Reed
DIRECTOR OF HIGHWAYS, CHIEF ENGINEER

PRINTED BY THE AUTHORITY
OF THE STATE OF ILLINOIS

GENERAL NOTES

THE PROPOSED PROJECT IS LOCATED ON IL 32, BEGINNING AT THE INTERSECTION WITH IL 133 IN LOVINGTON AND PROCEEDING SOUTH 7.4 MILES TO IL 121 WEST OF SULLIVAN. THE WORK CONSISTS OF PAVEMENT PATCHING, HMA SURFACE REMOVAL, RESURFACING, PAVEMENT MARKING, GUARDRAIL AND OTHER WORK NECESSARY TO COMPLETE THE SECTION.

SHORT TERM PAVEMENT MARKING SHALL BE APPLIED TO THE MILLED SURFACE, BITUMINOUS MATERIALS (PRIME COAT) AND BOTH LIFTS OF HOT-MIX ASPHALT. PAINT SHALL BE USED ON THE MILLED SURFACE.

FILLING INLETS PAY ITEM IS LOCATED ON THE SOUTH END OF THE PROJECT NEAR THE CENTER OF THE ROADWAY. RUMBLE STRIPS ARE LOCATED ON BOTH ENDS OF THE PROJECT.

THE CONTRACTOR SHALL PROVIDE INTERNET ACCESS TO THE HMA PLANT QUALITY CONTROL LAB SO THAT THE PLANT REPORTS CAN BE E-MAILED TO THE DISTRICT HEADQUARTERS. COST SHALL BE INCLUDED IN THE BID PRICES OF THE HOT-MIX ASPHALT ITEMS.

BITUMINOUS MATERIALS (PRIME COAT) SHALL BE EITHER RC-70 OR AN EMULSIFIED POLYMER PRIME SS-1HP.

THE TOTAL QUANTITY OF PAVEMENT MARKING-LINE 4 INCH CONSISTS OF 20,357 FEET OF YELLOW AND 78,127 FEET OF WHITE. OTHER WIDTHS OF PAVEMENT MARKING EXIST ON THE PROJECT.

THE EXISTING PAVEMENT SHALL BE PATCHED IN ACCORDANCE WITH SECTION 442 OF THE STANDARD SPECIFICATIONS AND THE SPECIAL PROVISIONS. THE QUANTITY OF PATCHING SHOWN ON THE PLANS IS ONLY AN ESTIMATE AND THE FINAL LOCATIONS AND QUANTITY SHALL BE DETERMINED BY THE ENGINEER IN THE FIELD.

COST OF REMOVAL OF TEMPORARY RAMP SHALL BE INCLUDED IN THE UNIT PRICE FOR TEMPORARY RAMP.

THE MATERIAL USED FOR AGGREGATE SHOULDERS, TYPE B SHALL BE CRUSHED STONE, CRUSHED CONCRETE, OR RAP.

SAVE AND PROTECT THE MONUMENTS LISTED IN THE SCHEDULE IN THE PLANS UNTIL SUCH TIME AS THEY MUST BE REPLACED.

THE FOLLOWING MIXTURE REQUIREMENTS ARE APPLICABLE TO THIS PROJECT:

APPLICATION	AC/PG	DESIGN AIR VOIDS	MIXTURE COMPOSITION	FRICTION AGGREGATE
LEVELING BINDER	PG 64-22	4.0% @ N=70	IL - 9.5	N/A
SURFACE COURSE	PG 64-22	4.0% @ N=70	IL - 9.5	MIXTURE C
INCIDENTAL SURFACE	PG 64-22	4.0% @ N=50	IL - 9.5	MIXTURE C
PAVEMENT PATCHING	PG 64-22	4.0% @ N=70	IL - 19.0	N/A
HOT-MIX ASPHALT SHOULDERS	PG 58-22	4.0% @ N=30	IL - 19.0L	N/A

INDEX OF SHEETS

SHEET NO	TITLE
1	COVER SHEET
2	GENERAL NOTES, INDEX OF SHEETS
3	SUMMARY OF QUANTITIES
4	TYPICAL SECTIONS
5-6	SCHEDULES
7	SURVEY MARKER TIES
8	LOCATION MAP
9	TYPICAL APPS. OF PAVEMENT MARKING
10	RUMBLE STRIPS

THE FOLLOWING STANDARDS ARE A PART OF THESE PLANS AND ARE INCLUDED FOLLOWING THE LAST NUMBERED SHEET OF THE PLANS.

000001-05	STANDARD SYMBOLS, ABBREVIATIONS, AND PATTERNS
001006	DECIMAL OF AN INCH AND OF A FOOT
406201-01	MAILBOX TURNOUT
442201-03	CLASS C AND D PATCHES
630001-08	STEEL PLATE BEAM GUARDRAIL
635006-03	REFLECTOR AND TERMINAL MARKER PLACEMENT
635011-02	REFLECTOR MARKER AND MOUNTING DETAILS
667101-01	PERMANENT SURVEY MARKERS
701001-02	OFF-ROAD OPERATIONS, 2L, 2W, MORE THAN 15' AWAY
701006-03	OFF-ROAD OPERATIONS, 2L, 2W, 15' TO 24" FROM PAVEMENT EDGE
701201-03	LANE CLOSURE, 2L, 2W, DAY ONLY, FOR SPEEDS >= 45 MPH
701301-03	LANE CLOSURE, 2L, 2W, SHORT TIME OPERATIONS
701306-02	LANE CLOSURE, 2L, 2W, SLOW MOVING OPERATIONS DAY ONLY, FOR SPEEDS >= 45 MPH
701311-03	LANE CLOSURE, 2L, 2W, MOVING OPERATIONS - DAY ONLY
701336-05	LANE CLOSURE, 2L, 2W, WORK AREAS IN SERIES, FOR SPEEDS >= 45 MPH
701901-01	TRAFFIC CONTROL DEVICES
780001-02	TYPICAL PAVEMENT MARKINGS
781001-03	TYPICAL APPLICATIONS RAISED REFLECTIVE PAVEMENT MARKERS

FILE NAME =	USER NAME = teasleyck	DESIGNED -	REVISED -	STATE OF ILLINOIS DEPARTMENT OF TRANSPORTATION	GENERAL NOTES & INDEX OF SHEETS	F.A.P. RTE.	SECTION	COUNTY	TOTAL SHEETS	SHEET NO.	
ca\pwwork\pwwid01\TEASLEYCK\d0123490\74380-shit-cover.dgn		DRAWN -	REVISED -			758	3RS-4,(4,5)RS-2	Moultrie	10	2	
PLOT SCALE = 100.0000' / IN.		CHECKED -	REVISED -			CONTRACT NO. 74380					
PLOT DATE = 4/10/2009		DATE -	REVISED -			[ILLINOIS] FED. AID PROJECT					
						SCALE:	SHEET NO.	OF	SHEETS	STA.	TO STA.

SUMMARY OF QUANTITIES			100% STATE	CONSTRUCTION TYPE CODE		
CODE NO	ITEM	UNIT	TOTAL QUANTITIES	I000		
40200800	AGGREGATE SURFACE COURSE, TYPE B	TON	113	113		
40600100	BITUMINOUS MATERIALS (PRIME COAT)	GALLON	11740	11740		
40600300	AGGREGATE (PRIME COAT)	TON	235	235		
40600635	LEVELING BINDER (MACHINE METHOD), N70	TON	4615	4615		
40600895	CONSTRUCTING TEST STRIP	EACH	1	1		
40600982	HOT-MIX ASPHALT SURFACE REMOVAL - BUTT JOINT	SQ YD	174	174		
40600990	TEMPORARY RAMP	SQ YD	81	81		
40603315	HOT-MIX ASPHALT SURFACE COURSE, MIX "C", N70	TON	9861	9861		
40800050	INCIDENTAL HOT-MIX ASPHALT SURFACING	TON	141	141		
44000151	HOT-MIX ASPHALT SURFACE REMOVAL, 1/2"	SQ YD	109500	109500		
44000155	HOT-MIX ASPHALT SURFACE REMOVAL, 1 1/2"	SQ YD	7520	7520		
44000198	HOT-MIX ASPHALT SURFACE REMOVAL, VARIABLE DEPTH	SQ YD	202	202		
44201798	CLASS D PATCHES, TYPE I, 13 INCH	SQ YD	98	98		
44201803	CLASS D PATCHES, TYPE II, 13 INCH	SQ YD	148	148		
44201807	CLASS D PATCHES, TYPE III, 13 INCH	SQ YD	17	17		
44201809	CLASS D PATCHES, TYPE IV, 13 INCH	SQ YD	86	86		
48101200	AGGREGATE SHOULDERS, TYPE B	TON	2150	2150		
48203100	HOT-MIX ASPHALT SHOULDERS	TON	238	238		
60500305	FILLING INLETS	EACH	2	2		
* 63000003	STEEL PLATE BEAM GUARD RAIL, TYPE A, 9 FOOT POSTS	FOOT	1250	1250		
* 63100167	TRAFFIC BARRIER TERMINAL, TYPE 1 (SPECIAL) TANGENT	EACH	8	8		
63200310	GUARDRAIL REMOVAL	FOOT	1025	1025		
66700205	PERMANENT SURVEY MARKERS, TYPE I	EACH	9	9		
67000500	ENGINEER'S FIELD OFFICE, TYPE B	CAL MO	4	4		
67100100	MOBILIZATION	L SUM	1	1		
70100450	TRAFFIC CONTROL AND PROTECTION, STANDARD 701201	L SUM	1	1		
70100460	TRAFFIC CONTROL AND PROTECTION, STANDARD 701306	L SUM	1	1		
70100600	TRAFFIC CONTROL AND PROTECTION, STANDARD 701336	L SUM	1	1		
70300100	SHORT-TERM PAVEMENT MARKING	FOOT	15360	15360		
70301000	WORK ZONE PAVEMENT MARKING REMOVAL	SQ FT	1301	1301		
* 78000200	THERMOPLASTIC PAVEMENT MARKING - LINE 4"	FOOT	5834	5834		
* 78000600	THERMOPLASTIC PAVEMENT MARKING - LINE 12"	FOOT	220	220		

SUMMARY OF QUANTITIES			100% STATE	CONSTRUCTION TYPE CODE		
CODE NO	ITEM	UNIT	TOTAL QUANTITIES	I000		
* 78000650	THERMOPLASTIC PAVEMENT MARKING - LINE 24"	FOOT	39	39		
* 78001110	PAINT PAVEMENT MARKING - LINE 4"	FOOT	98485	98485		
* 78100100	RAISED REFLECTIVE PAVEMENT MARKER	EACH	490	490		
* 78200410	GUARDRAIL MARKERS, TYPE A	EACH	21	21		
* 78201000	TERMINAL MARKER - DIRECT APPLIED	EACH	8	8		
Z0025500	FURNISHING AND INSTALLING PROPERTY MARKERS	EACH	3	3		
Z0055600	RUMBLE STRIP	SQ YD	217	217		

* Specialty Items

FILE NAME =	USER NAME = teasleyck	DESIGNED -	REVISED -
ct:\pwork\PWID01\TEASLEYCK\0123498.D	74380-shr-SDD.dgn	DRAWN -	REVISED -
	PLOT SCALE = 100.0000' / IN.	CHECKED -	REVISED -
	PLOT DATE = 4/10/2009	DATE -	REVISED -

STATE OF ILLINOIS
DEPARTMENT OF TRANSPORTATION

SUMMARY OF QUANTITIES			
SCALE:	SHEET NO.	OF SHEETS	STA. TO STA.

F.A.P. RTE.	SECTION	COUNTY	TOTAL SHEETS	SHEET NO.
758	3RS-4,(4,5)RS-2	Moutrie	10	3
CONTRACT NO. 74380				
ILLINOIS FED. AID PROJECT				

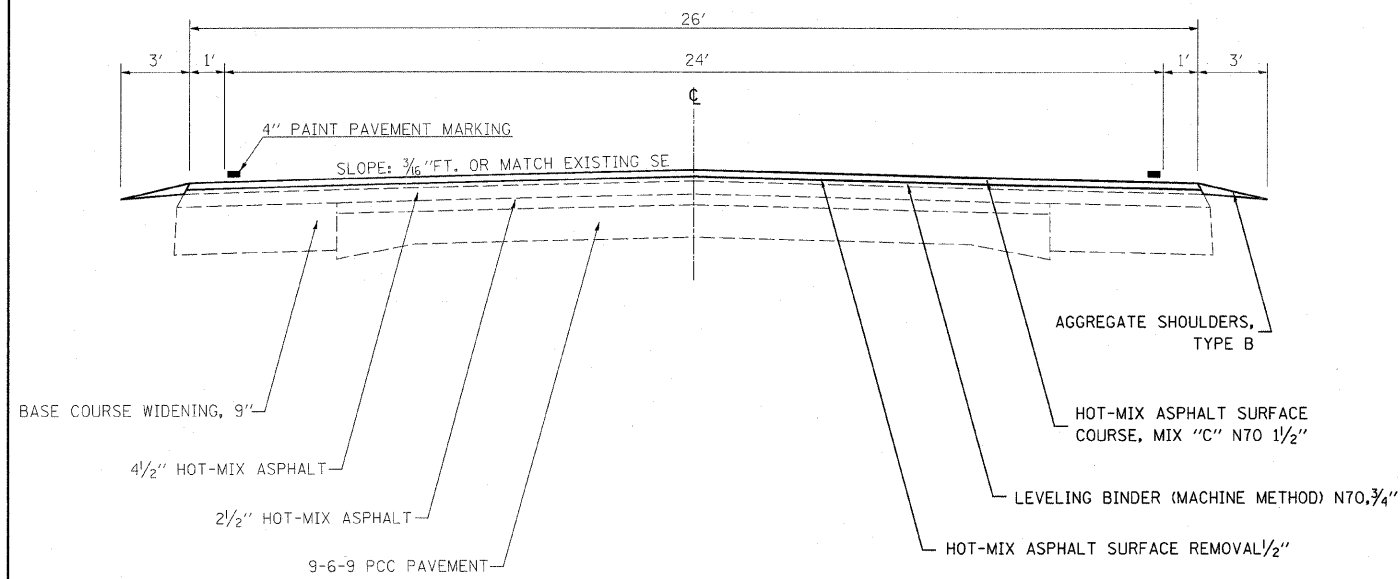

STA 0+35 TO STA 62+28
 STA 67+83 TO STA 73+41
 STA 82+28 TO STA 228+50
 STA 238+91 TO STA 246+20
 STA 256+76 TO STA 376+86

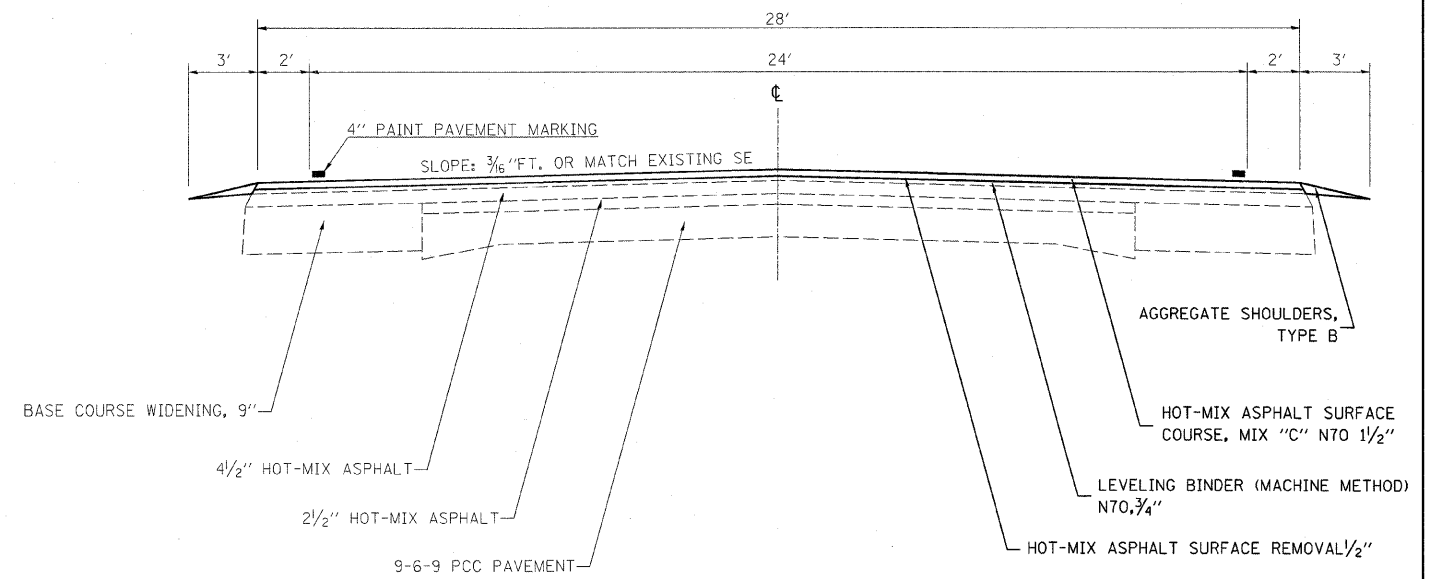

STA 62+28 TO STA 67+83
 STA 73+41 TO STA 82+28
 STA 228+50 TO STA 238+91
 STA 246+20 TO STA 256+76

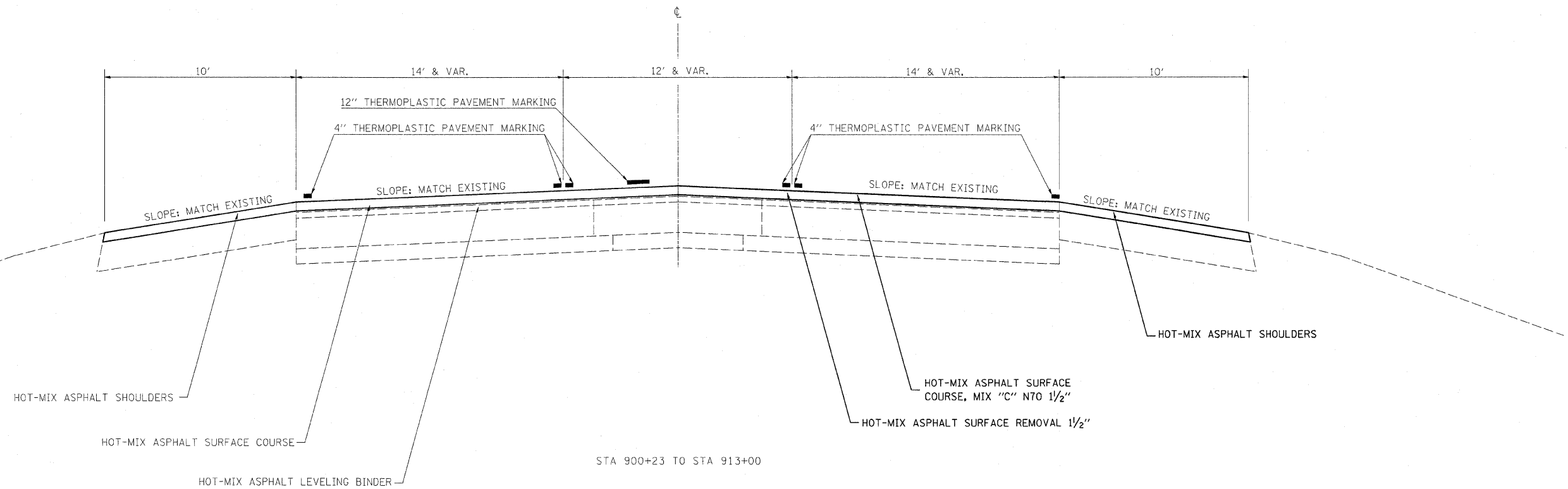

FILE NAME =
 c:\pwork\pilot\teasleyck\08123490\074388-shr-tyr.dgn

USER NAME = teasleyck
 PLOT SCALE = 50.0000 "/ IN.
 PLOT DATE = 4/18/2009

DESIGNED -
 DRAWN -
 CHECKED -
 DATE -

REVISED -
 REVISED -
 REVISED -
 REVISED -

STATE OF ILLINOIS
 DEPARTMENT OF TRANSPORTATION

TYPICAL SECTIONS

SCALE: SHEET NO. OF SHEETS STA. TO STA.

F.A.P. RTE.	SECTION	COUNTY	TOTAL SHEETS	SHEET NO.
758	3RS-4,(4,5)RS-2	Moultrie	10	4
CONTRACT NO. 74380				
ILLINOIS FED. AID PROJECT				

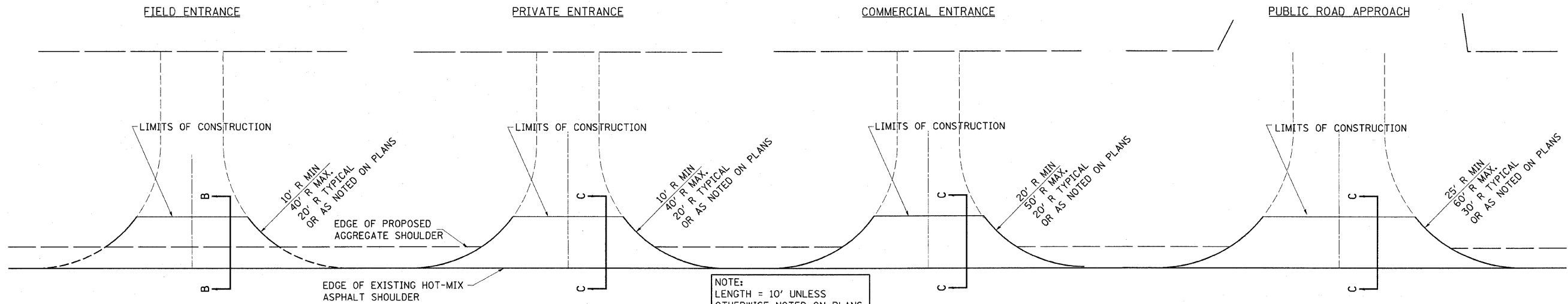

NOTE:
LENGTH = 10' UNLESS
OTHERWISE NOTED ON PLANS.

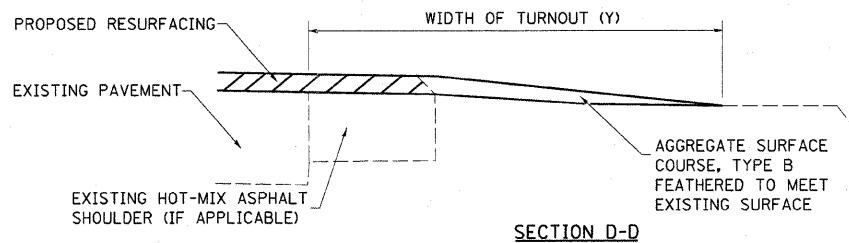
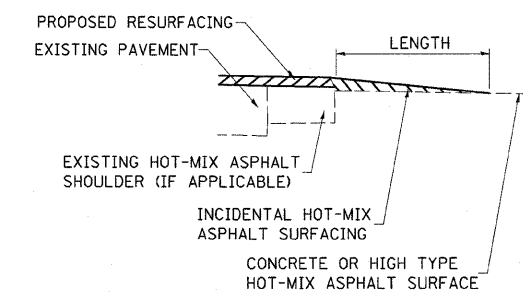
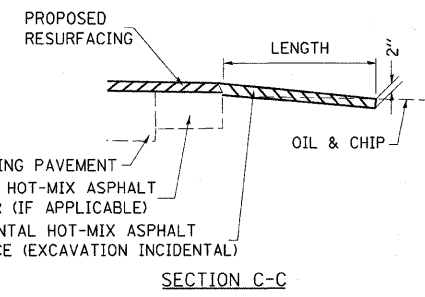
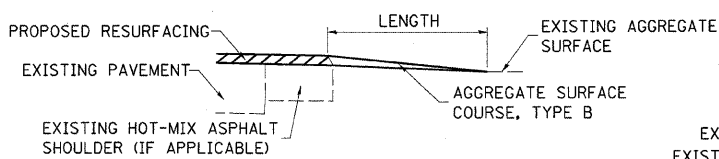
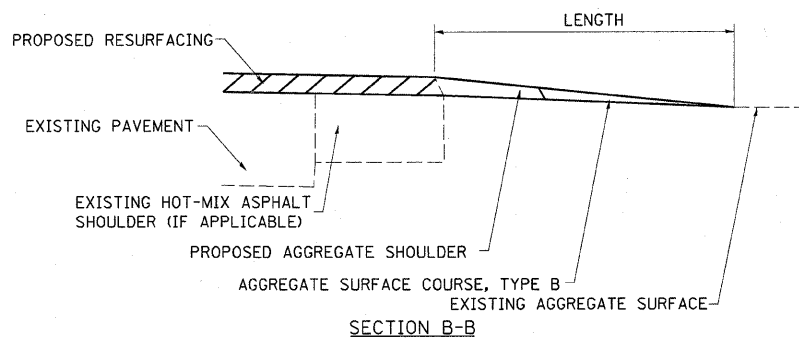

TYPICAL SECTION AT MAILBOX TURNOUT
NOTE: SEE STANDARD 406201 FOR MAILBOX TURNOUT DETAILS

NOTES

THE COST OF THE ASPHALT MATERIALS, AND AGGREGATE (PRIME COAT) FOR ENTRANCES AND PUBLIC ROADS AND APPROACHES SHALL BE INCLUDED IN THE PAY ITEM INCIDENTAL HOT-MIX ASPHALT SURFACING.

THE COST OF EXCAVATION IS INCLUDED IN THE PAY ITEM INCIDENTAL HOT-MIX ASPHALT SURFACING.

IF THERE IS NOT EXISTING HOT-MIX ASPHALT SHOULDER THEN THE ENTRANCE TAPER STARTS AT THE EDGE OF EXISTING PAVEMENT.

THE COST OF THE BITUMINOUS MATERIALS AND AGGREGATE (PRIME COAT) FOR ENTRANCES AND PUBLIC ROAD APPROACHES SHALL BE INCLUDED IN THE PAY ITEM INCIDENTAL HOT-MIX ASPHALT SURFACING.

NOTE: STATIONS ARE GIVEN AS MILE POST READINGS, LT SIDE IS ON EAST, RT SIDE IS ON WEST, MILEAGE INCREASES TO NORTH

SIDE	STATION	TYPE	INCIDENTAL HOT-MIX ASPHALT SURFACING		AGGREGATE SURFACE COURSE, TYPE B
			TON	TON	
Lt	9.034	CE	4.7		
Lt	9.129	CE	5.1		
Rt	9.151	MBT	3.3		
Rt	9.161	PE	2.3		
Lt	9.301	PE	2.3		
Lt	9.348	PE	3.8		
Rt	9.35	MBT		3.3	
Rt	9.551	PE	2.2		
Rt	9.558	MBT		2.8	
Rt	9.571	PE	2.3		
Lt	9.631	PE	2.5		
Rt	9.661	MBT		1.8	
Rt	9.665	PE	2.3		
Lt	9.753	FE		1.8	
Lt	9.883	FE		1.9	
Lt	10128	FE		2.3	
Lt	10.136	PRA	6		
Rt	10.136	PRA	5.3		
Lt	10.144	FE		1.7	
Lt	10.379	FE		1.7	
Lt	10.406	PE	2.5		
Lt	10.446	PE	2.3		
Rt	10.514	FE		1.9	
Lt	10.635	FE		1.8	
Rt	10.639	PRA	5.1		
Rt	10.662	FE		1.7	
Lt	10.734	PE	2.4		
Rt	10.737	MBT	2.3		
Lt	10.903	PE	2.3		
Rt	10.903	MBT		2.0	
Lt	10.961	FE		1.3	
Lt	10.98	FE		1.9	
Lt	11.166	PE	2.4		
Rt	11.177	MBT		2.2	
Rt	11.317	FE		1.6	
Lt	11.399	FE		1.6	
Lt	11.694	PRA	3.7		
Rt	11.694	PRA	3.5		
Rt	11.913	FE		1.5	
Lt	11.991	FE		1.7	
Rt	12.02	FE		1.7	
Lt	12.134	2XFE		3.5	
Lt	12.159	FE		1.5	
Rt	12.159	FE		1.6	
Lt	12.18	2XFE		3.1	
Lt	12.188	FE		1.6	
Lt	12.246	FE		1.5	
Rt	12.246	FE		1.7	
Rt	12.414	FE		1.6	
Lt	12.5	PRA	5.3		
Rt	12.5	PRA	4.7		
Rt	12.514	FE		1.5	
Rt	12.587	PE		1.7	
Rt	12.587	MBT		2.1	
Rt	12.59	PE	2.3		
Lt	12.73	FE		1.5	
Rt	12.748	FE		1.7	
Rt	12.754	FE		1.7	
Lt	13.003	FE		1.6	
Lt	13.243	FE		1.6	
Rt	13.243	FE		1.6	
Rt	13.444	FE		1.6	
Lt	13.55	FE		1.6	
Rt	13.55	FE		1.7	
Rt	13.586	FE		1.6	
Lt	13.665	FE		1.6	
Rt	13.714	PE	1.6		
Lt	13.742	PRA	3.3		
Rt	13.742	PRA	3.4		
Rt	13.924	FE		1.7	
Lt	13.99	FE		1.7	
Rt	13.998	FE		1.7	
Lt	14.085	FE		1.7	
Rt	14.146	FE		1.7	
Lt	14.16	PE	1.7		
Rt	14.196	FE		1.7	
Lt	14.327	PE	2.3		
Rt	14.455	PE	2.3		
Rt	14.455	MBT	1.9		
Lt	14.488	FE		1.6	
Lt	14.739	FE		1.6	
Rt	14.739	FE		1.6	
Rt	14.786	FE		1.6	
Rt	14.909	PE	3.8		
Rt	14.925	PE	3.8		
Lt	14.936	FE		1.7	
Rt	15.023	PE	2.3		
Lt	15.029	PE	2.3		
Rt	15.08	PE	2.3		
Rt	15.085	PE	2.3		
Lt	15.093	CE	4.7		
Lt	15.129	PRA	3.7		
Rt	15.186	PE	3.8		
Lt	15.238	FE		1.7	
Rt	15.284	PRA	3.3		
Lt	15.472	FE		1.5	
Lt	15.513	FE		1.5	
Rt	15.532	PE	3.8		
Lt	15.786	PRA	3.3		
Rt	15.786	FE		1.7	
Lt	15.862	PE	3.8		
Lt	15.866	MBT		2.2	
Rt	16.029	PRA	5.3		
Lt	16.032	FE		1.5	
Rt	16.254	PE		2.3	
TOTALS			141	113	

FE=FIELD ENTRANCE PRA - PUBLIC ROAD APPROACH
PE=PRIVATE ENTRANCE MBT - MAILBOX TURNOUT
CE=COMMERCIAL ENTRANCE

RESURFACING SCHEDULE

STATION TO STATION	LENGTH	PVMT WIDTH	AREA	BITUMINOUS MATERIAL (PRIME COAT)	AGGREGATE (PRIME COAT)	LEVELING BINDER (MACHINE METHOD) NTO	HOT-MIX ASPHALT SURFACE COURSE, MIX "C", NTO	HOT-MIX ASPHALT SURFACE REMOVAL BUTT-JOINT	HOT-MIX ASPHALT SURFACE REMOVAL VARIABLE DEPTH	HOT-MIX ASPHALT SURFACE REMOVAL 1/2"	HOT-MIX ASPHALT SURFACE REMOVAL 1 1/2"	SHORT-TERM PAVEMENT MARKING	WORK ZONE PAVEMENT MARKING REMOVAL	RAISED REFLECTIVE PAVEMENT MARKER	AGGREGATE SHOULDERS, TYPE B	TEMPORARY RAMP
	FT	FT	SQ YD	GALLON	TON	TON	TON	SQ YD	SQ YD	SQ YD	SQ YD	FOOT	SQ FT	EACH	TON	SQ YD
STA 0+35 TO STA 62+28	6193.0	26	17890.9	1789.1	35.8	751.4	1502.8	58	0	17830	0	1857.9	206.4	77	352.6	14
STA 62+28 TO STA 67+83	555.0	28	1726.7	172.7	3.5	72.5	145.0	0	0	1721	0	166.5	18.5	7	31.6	0
STA 67+83 TO STA 68+15	32.6	26	94.2	9.4	0.2	4.0	7.9	58	0	94	0	9.8	1.1	2	1.9	14
STA 68+15 TO STA 68+40	24.8	0	0.0	0.0	0.0	0.0	0.0	0	0	0	0	7.4	0.8	0	0.0	0
STA 68+40 TO STA 73+41	500.6	26	1446.2	144.6	2.9	60.7	121.5	58	0	1441	0	150.2	16.7	7	28.5	14
STA 73+41 TO STA 82+28	887.0	28	2759.6	276.0	5.5	115.9	231.8	0	0	2750	0	266.1	29.6	11	50.5	0
STA 82+28 TO STA 228+50	14622.0	26	42241.3	4224.1	84.5	1774.1	3548.3	0	0	42097	0	4386.6	487.4	182	832.5	0
STA 228+50 TO STA 238+91	1041.0	28	3238.7	323.9	6.5	136.0	272.0	0	0	3227	0	312.3	34.7	13	59.3	0
STA 238+91 TO STA 246+20	729.0	26	2106.0	210.6	4.2	88.5	176.9	0	0	2099	0	218.7	24.3	9	41.5	0
STA 246+20 TO STA 256+76	1056.0	28	3285.3	328.5	6.6	138.0	276.0	0	0	3274	0	316.8	35.2	13	60.0	0
STA 256+76 TO STA 285+99	2923.7	26	8446.2	844.6	16.9	354.7	709.5	0	0	8417	0	877.1	97.5	26	166.5	0
STA 284+64 TO STA 376+86	9222.0	26	26641.3	2664.1	53.3	1118.9	2237.9	0	202	26550	0	2766.6	307.4	125	525.1	0
STA 900+23 TO STA 913+00	1277.0	53	7520.0	752.0	15.4	0.0	631.7	0	0	0	7520	248.1	42.6	18	0.0	39
TOTAL QUANTITIES	39063.7		117396.	11740	235	4615	9861	174	202	109500	7520	11584	1301	490	2150	81

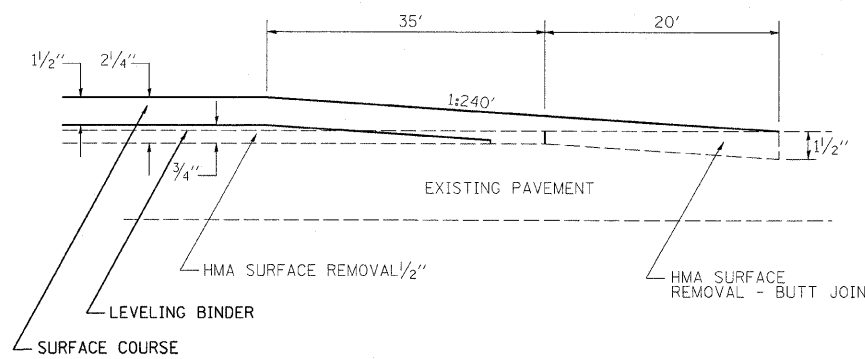
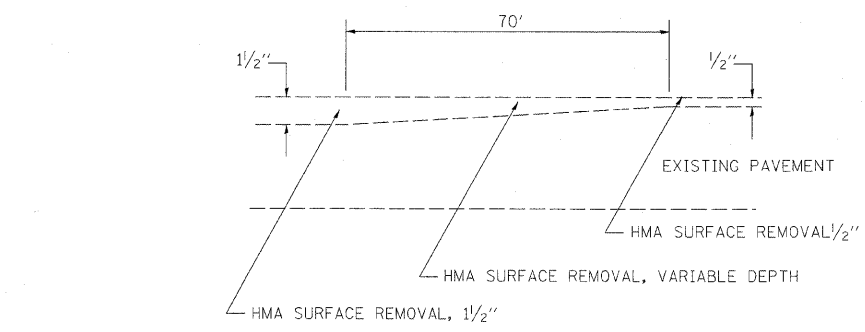

PERMANENT SURVEY MARKERS

Station	Offset	Description
900+00 (IL 32) = 647+01.41 (IL 121)	0	Alum. IDOT Disc flush at intersection of IL 121 and IL 32
902+23.39	0	P.C. Alum. IDOT Disc flush in median
909+16.60	0	P.T. Alum. IDOT Disc flush at 1.0 ft off center line
91+53.82	0	P.O.T. I.P. with yellow cap - flush
81+97.14	0	P.T. Magnetic Nail
74+17.73	0	P.C. Magnetic Nail
62+52.60	0	P.C. Magnetic Nail
51+65.74	0	P.O.T. I.P. with yellow Cap - Flush
0+32	0	I.P.

FURNISH & INSTALL PROPERTY MARKERS

Station	Offset	Description
912+95	7.46' RT	PK Nail N*Corner Sec 3
323+76	6.72' LT	IDOT Alum. Disk flush with bituminous pavement
297+35	16.4' RT	I.P. (bent)

GUARDRAIL SCHEDULE

STATION TO STATION	FT	EACH	EACH	EACH
LT STA 104+65 TO STA 105+15		1		1
LT STA 105+15 TO STA 108+77.5	362.5	1	6	1
LT STA 108+77.5 TO STA 109+27.5		1		1
RT STA 103+52.5 TO STA 104+02.5		1		1
RT STA 104+02.5 TO STA 107+65	362.5	1	6	1
RT STA 107+65 TO STA 108+15		1		1
LT STA 138+22 TO STA 138+72		1		1
LT STA 138+72 TO STA 142+34.5	362.5	1	6	1
LT STA 142+34.5 TO STA 142+84.5		1		1
RT STA 139+09.5 TO STA 139+59.5		1		1
RT STA 139+59.5 TO STA 141+22	162.5	1	3	1
RT STA 141+22 TO STA 141+72		1		1
TOTALS	1250	8	21	8

NOTE: PLACE FACE OF RAIL AT 15' FROM CENTERLINE ROADWAY.

MILLING DETAILS

GUARDRAIL REMOVAL	
LT STA 104+38 TO 107+38	300 FOOT
RT STA 104+88 TO 107+38	250 FOOT
LT STA 138+92 TO 141+42	250 FOOT
RT STA 139+00 TO 141+25	225 FOOT
TOTAL	1025 FOOT

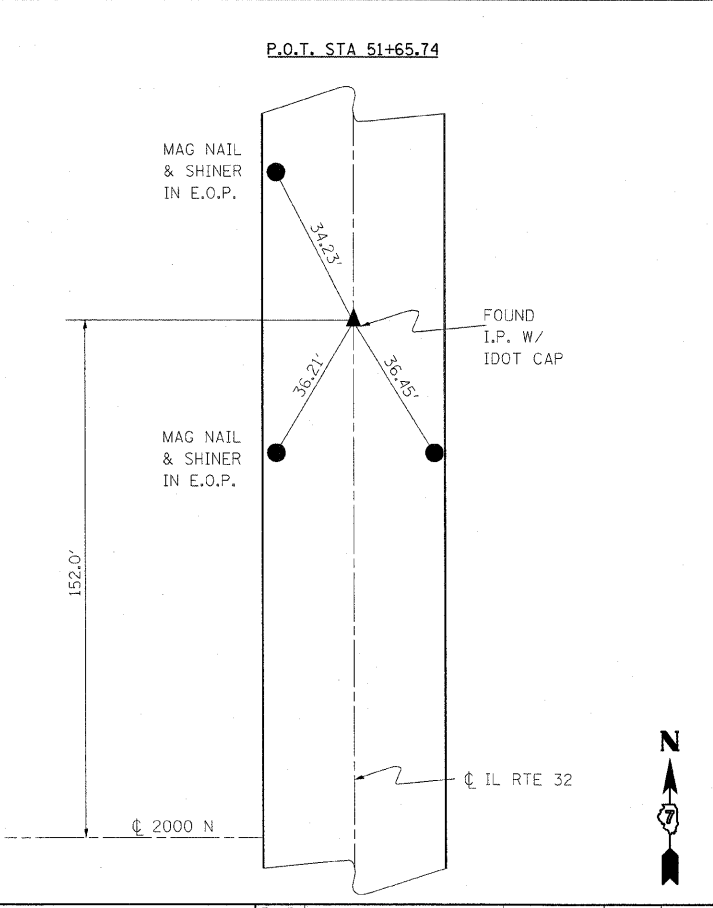
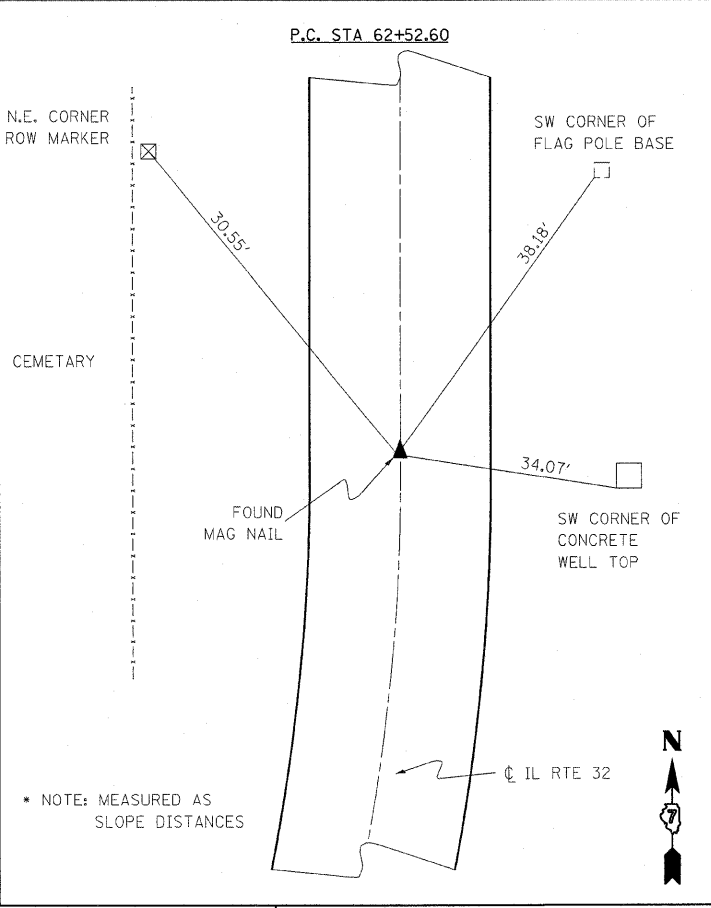
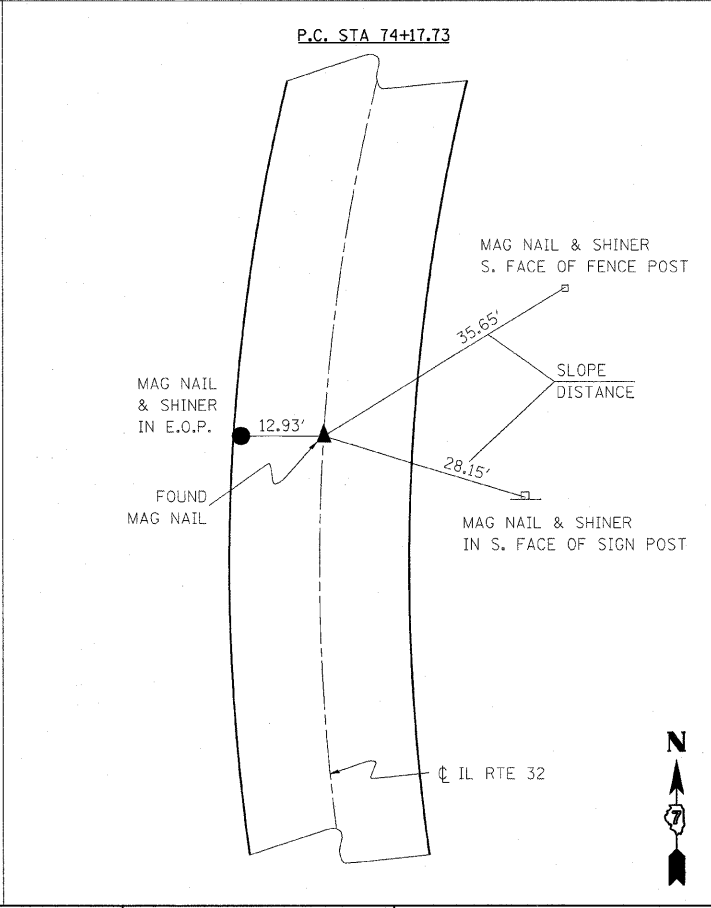
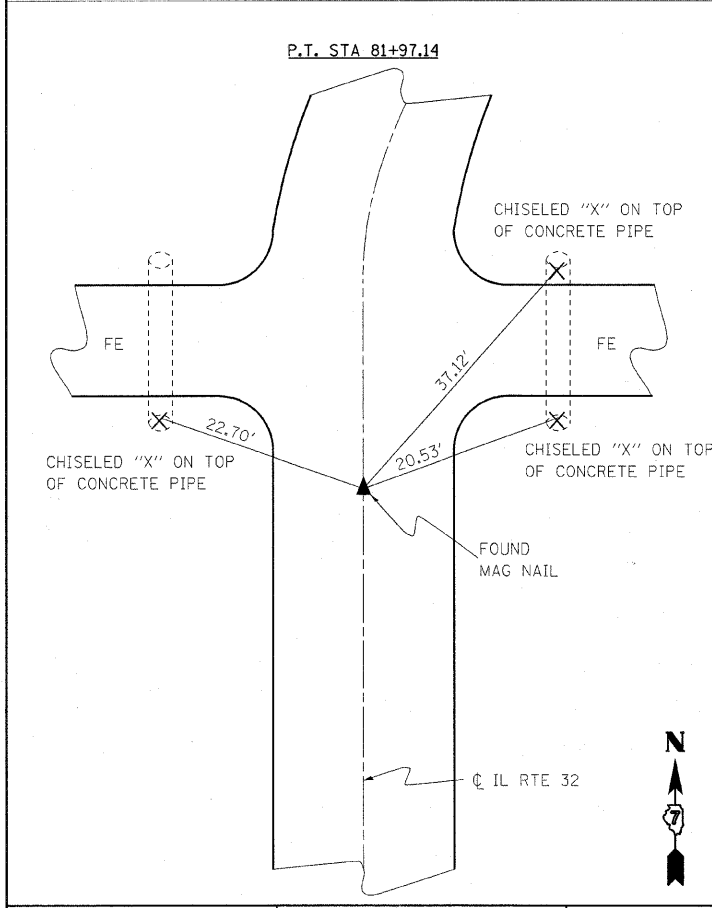
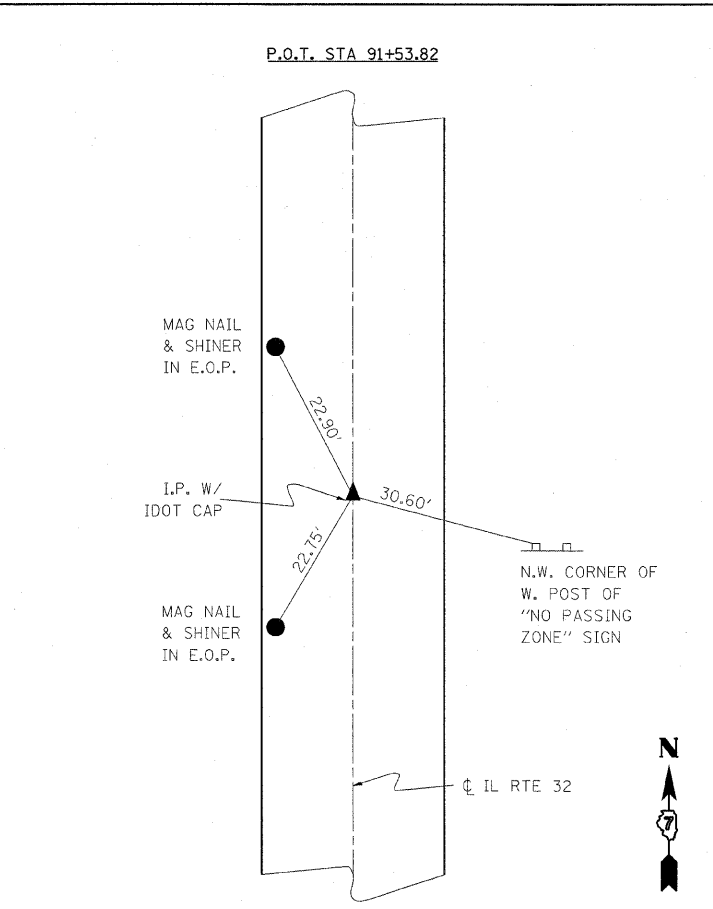
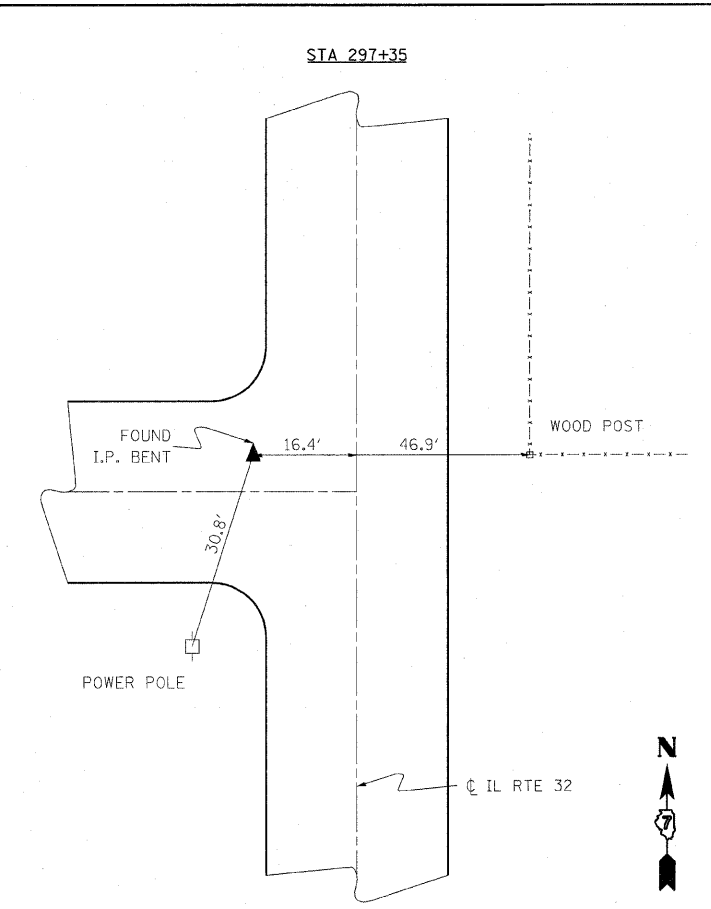
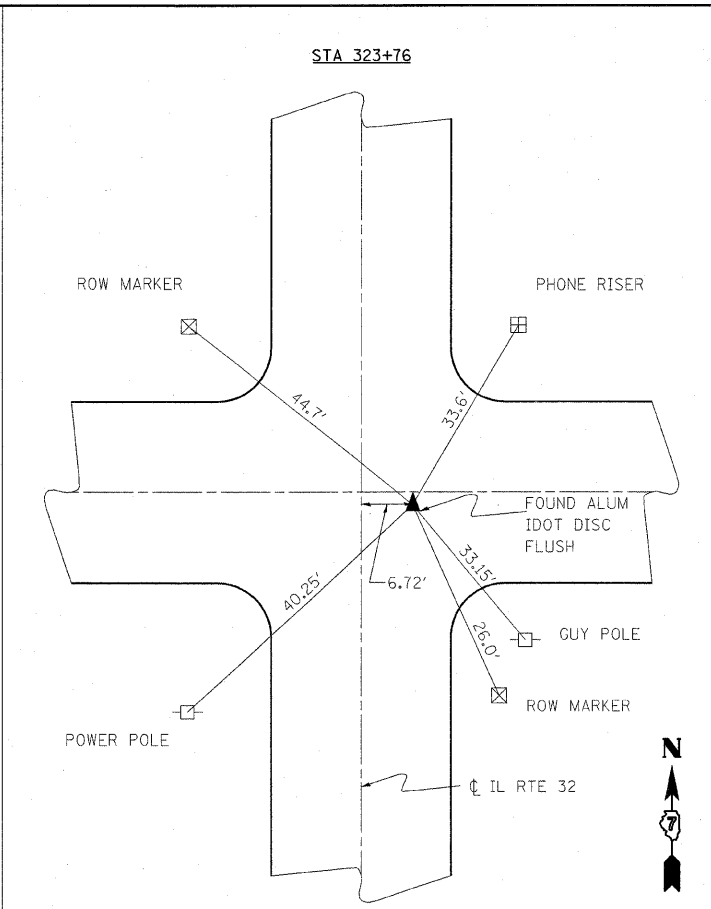
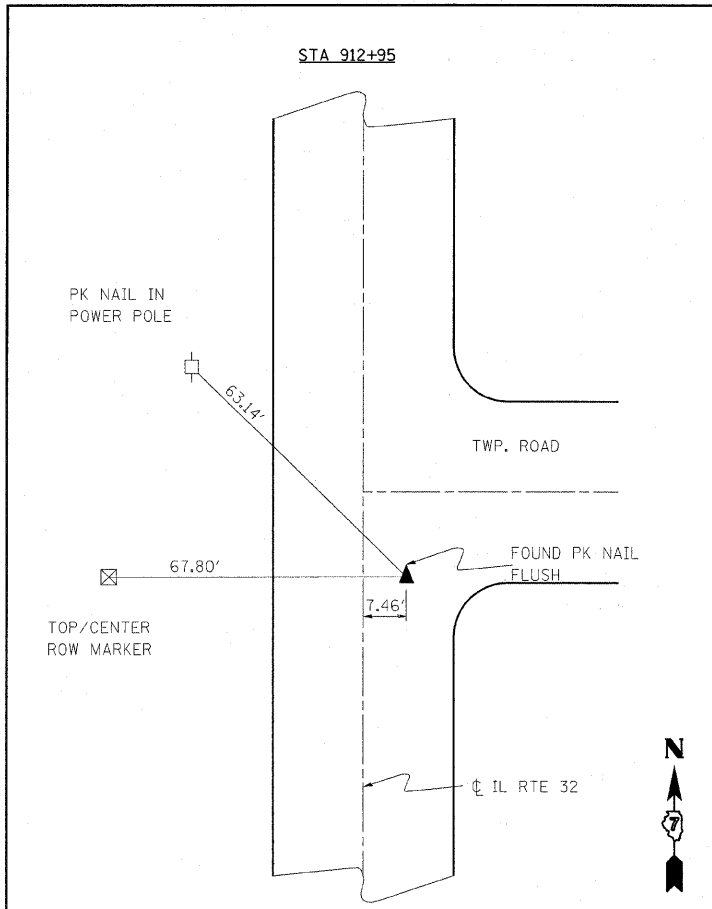

FILE NAME =
c:\pwork\pwork\TEASLEYCK\0123490\

USER NAME = teasleyck
74380-sh1-ATB.dgn
PLOT SCALE = 50.0000' / IN.
PLOT DATE = 4/10/2009

DESIGNED -
DRAWN -
CHECKED -
DATE -

REVISED -
REVISED -
REVISED -
REVISED -

**STATE OF ILLINOIS
DEPARTMENT OF TRANSPORTATION**

TIES
SCALE: SHEET NO. OF SHEETS STA. TO STA.

F.A.P. RTE.	SECTION	COUNTY	TOTAL SHEETS	SHEET NO.
758	3RS-4,(4,5)RS-2	Moultrie	10	7
CONTRACT NO. 74380			ILLINOIS FED. AID PROJECT	



FILE NAME =
 USER NAME = teasleyck
 74380-sht-locmap.dgn
 PLOT SCALE = 50.0000' / IN.
 PLOT DATE = 4/10/2009

DESIGNED -
 DRAWN -
 CHECKED -
 DATE -

REVISED -
 REVISED -
 REVISED -
 REVISED -

**STATE OF ILLINOIS
 DEPARTMENT OF TRANSPORTATION**

LOCATION MAP

SCALE: SHEET NO. OF SHEETS STA. TO STA.

F.A.P. RTE.	SECTION	COUNTY	TOTAL SHEETS	SHEET NO.
758	3RS-4,(4,5)RS-2	Moultrie	10	8
CONTRACT NO. 74380				
ILLINOIS FED. AID PROJECT				

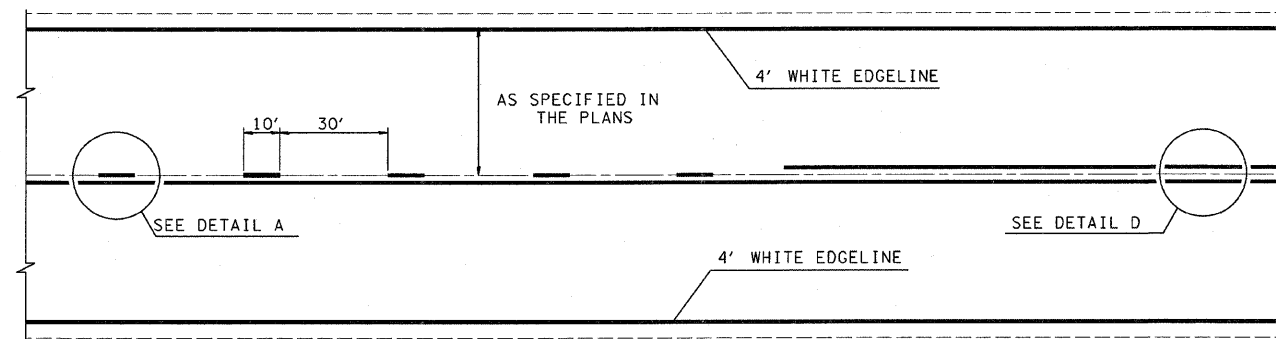

TYPICAL CENTERLINE, NO PASSING ZONE LINE (NPZ) & EDGELINE MARKINGS
2-LANE PAVEMENT

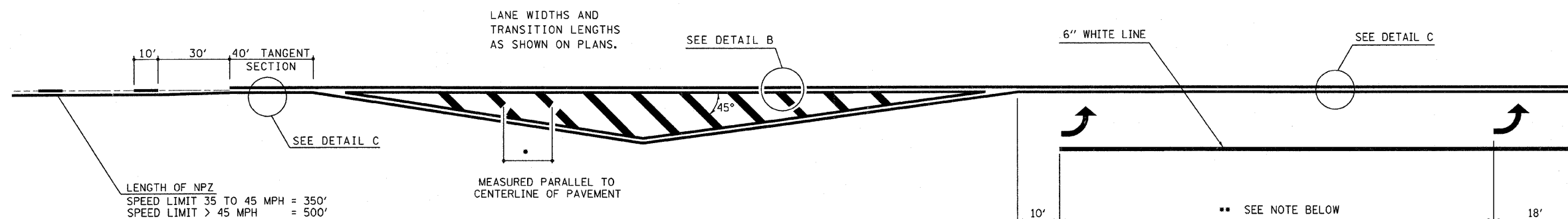

LENGTH OF NPZ
SPEED LIMIT 35 TO 45 MPH = 350'
SPEED LIMIT > 45 MPH = 500'

LANE WIDTHS AND
TRANSITION LENGTHS
AS SHOWN ON PLANS.

MEASURED PARALLEL TO
CENTERLINE OF PAVEMENT

•DIAGONAL SPACING

SPEED LIMIT < 30 MPH = 15'
SPEED LIMIT 30 TO 45 MPH = 20'
SPEED LIMIT > 45 MPH = 30'

•• PLACE THE FIRST ARROW EVEN WITH THE BEGINNING OF THE TURN BAY.
PLACE ANOTHER ARROW 18' BACK FROM THE STOP BAR. IF REQUIRED,
ADD ADDITIONAL ARROWS TO MAINTAIN A MAXIMUM OF 80' SPACING.

NOTES:

1. OMIT EDGELINE THRU SIDE ROADS.
2. TAPER RATES, LANE WIDTHS, AND STORAGE LENGTHS AS SHOWN ON THE PLANS.
3. WHEN MEDIANS ARE PRESENT, PLACE A SINGLE YELLOW STRIPE AROUND ITS PERIMETER.

DETAIL A

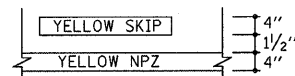

DETAIL B

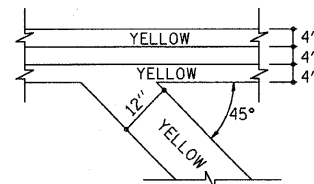

DETAIL C

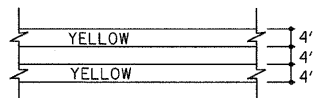

DETAIL D

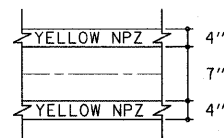

NOT TO SCALE

FILE NAME =	USER NAME = teasleyck	DESIGNED -	REVISED - MM0 12-99	STATE OF ILLINOIS DEPARTMENT OF TRANSPORTATION	TYPICAL APPLICATIONS OF PAVEMENT MARKINGS	F.A.P. RTE.	SECTION	COUNTY	TOTAL SHEETS	SHEET NO.	
ca:\pwork\pwork\DOT\TEASLEYCK\0123490\074380-sht-details.dgn	74380-sht-details.dgn	DRAWN -	REVISED - DRM 08-04			758	3RS-4,(4,5)RS-2	MOULTRIE	10	9	
PLOT SCALE = 50,0000 ' / IN.		CHECKED -	REVISED - MKS 04-08			CONTRACT NO. 74380					
PLOT DATE = 4/10/2009		DATE -	REVISED -			FED. ROAD DIST. NO. ILLINOIS FED. AID PROJECT					
					SCALE:	SHEET NO. OF SHEETS STA.		TO STA.			

TYPICAL RUMBLE STRIP APPLICATION IN ADVANCE OF AN INTERSECTION

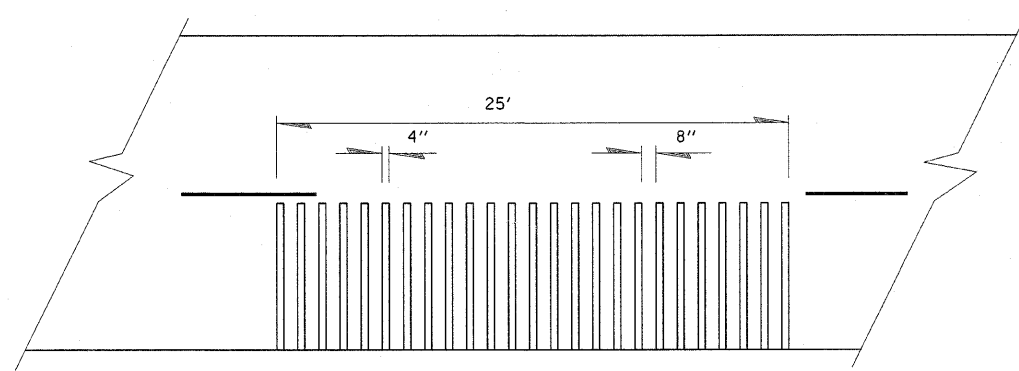
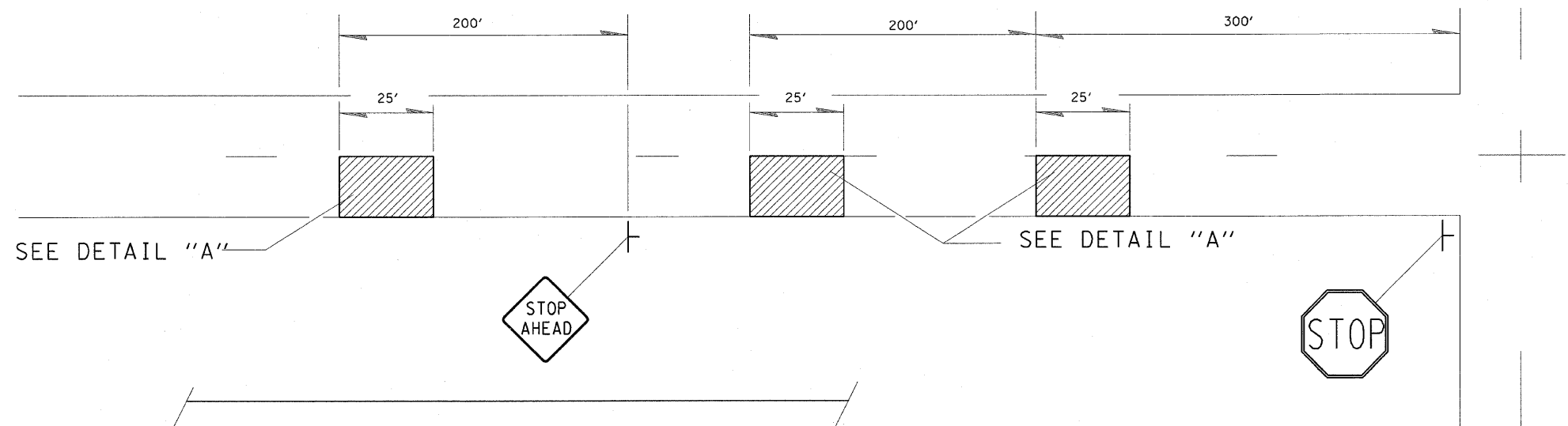

DETAIL "A"

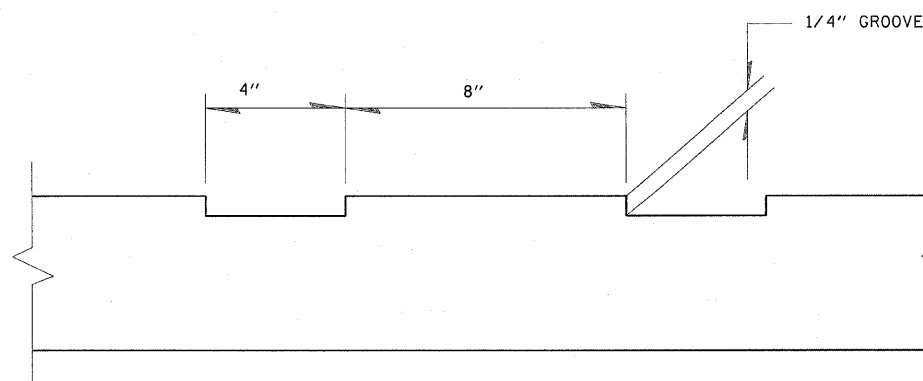

NOTE: THE 25 FEET RUMBLE AREA HAS 4" WIDE GROOVES SAWED INTO THE PAVEMENT, SEPARATED BY 8" OF EXISTING PAVEMENT. THE SAW CUTS SHALL EXTEND 12" INTO THE SHOULDER TO ALLOW FOR DRAINAGE.

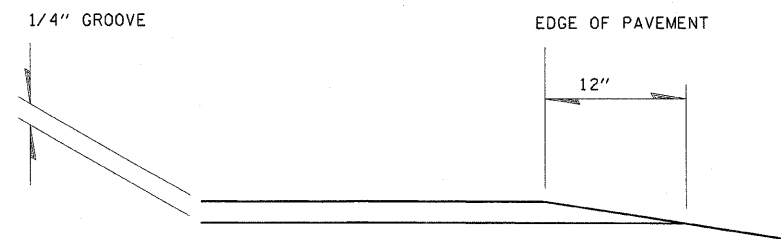

FILE NAME =	USER NAME = teasleyck	DESIGNED -	REVISED - MMO 12-99	STATE OF ILLINOIS DEPARTMENT OF TRANSPORTATION	TYPICAL RUMBLE STRIP APPLICATION	F.A.P. RTE.	SECTION	COUNTY	TOTAL SHEETS	SHEET NO.	
c:\pw\work\PWIDOT\TEASLEYCK\00123490.D	74380-sht-details.dgn	DRAWN -	REVISED -			758	3RS-4,(4,5)RS-2	Moultrie	10	10	
	PLOT SCALE = 50.0000' / IN.	CHECKED -	REVISED -			CONTRACT NO. 74380					
	PLOT DATE = 4/10/2009	DATE -	REVISED -			ILLINOIS FED. AID PROJECT					
				SCALE:	SHEET NO. OF SHEETS	STA.	TO STA.				