

EXIST. CURVE CUR2  
 PI STA. = 367+00.18  
 $\Delta$  = 2° 40' 00" (RT)  
 D = 0° 08' 00"  
 R = 42,971.30'  
 T = 1,000.18'  
 L = 2,000.00'  
 E = 11.64'  
 e = -----  
 T.R. = -----  
 S.E. RUN = -----  
 P.C. STA. = 357+00.00  
 P.T. STA. = 377+00.00

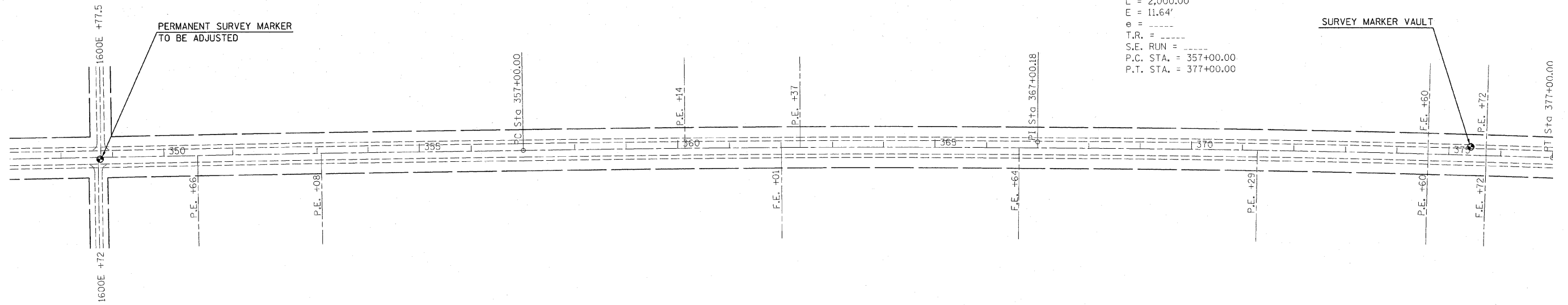

FILE NAME =	USER NAME = toasleyck	DESIGNED -	REVISED -	<b>STATE OF ILLINOIS DEPARTMENT OF TRANSPORTATION</b>	<b>IL 133 PLAN</b>			F.A.P. RTE.	SECTION	COUNTY	TOTAL SHEETS	SHEET NO.
ca:\pwork\pwork\DOT\TEASLEYCK\121195\07	4381-SHT-PLAN.dgn	DRAWN -	REVISED -		SCALE: 100	SHEET NO. 7 OF 8 SHEETS	STA. 348+00 TO STA. 406+00	749	119 RS-2	Moultrie	26	19
	PLOT SCALE = 100.0000' / IN.	CHECKED -	REVISED -		CONTRACT NO. 74381							
	PLOT DATE = 4/10/2009	DATE -	REVISED -		ILLINOIS FED. AID PROJECT							