

ROUTE NO.	SECTION	COUNTY	TOTAL SHEETS	SHEET NO.
F.A.I. 74	(48-26HB-4)I	KNOX	54	25
FED. ROAD DIST. NO.	ILLINOIS	PROJECT		

CONTRACT 88919

BENCHMARK:
Top of S.E. Bolt on N.W. Leg
of Sign over W.B. 1-74 at Exit 45
Sta. 225+27+ (1-74)
Elev. = 802.34

EXISTING STRUCTURES: Existing Str. No. 048-0019 & 048-0020
Built in 1965 as F.A.I. 74, Sec. 48-26HB-4
Four Spans W/ 36 WF 150 Fascia Beams & 27 WF 102 Interior Beams @ Spans 1 & 4
and 36 WF 230 Beams @ Spans 2 & 3, W/ Conc. Deck and Safety Walks W/ Alum.
Handrail on Conc. Parapets, Conc. Pile Bent Abutments and Multiple Column
Conc. Piers. Length = 264'-0" Bk. - Bk. Abuts.
Width = 49'-7 1/16" (Min.) & 53'-5 1/16" (Max) O. to O. Tapered Deck.
Hinged Beams, Bearings, Concrete Deck, Abutment Backwalls & Wingwalls to be Removed & Replaced (No Salvage)
Traffic Control shall be Maintained by Stage Construction.

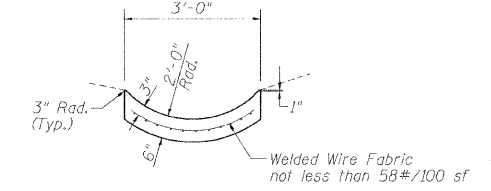
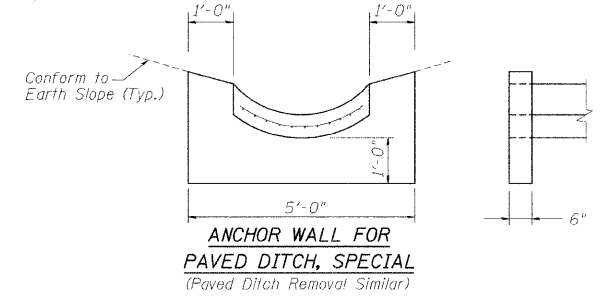
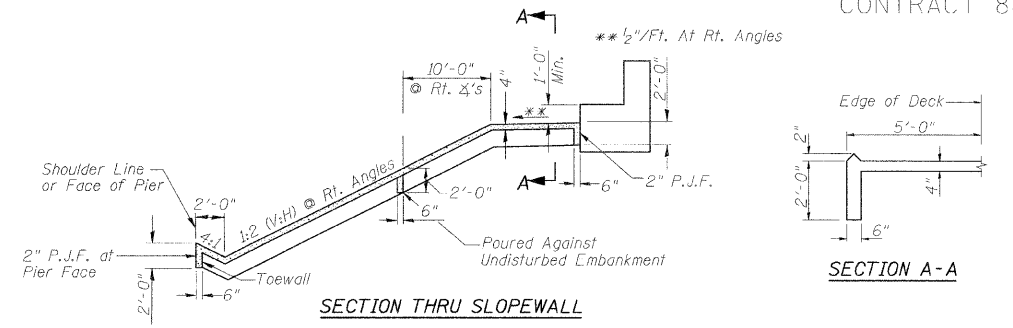
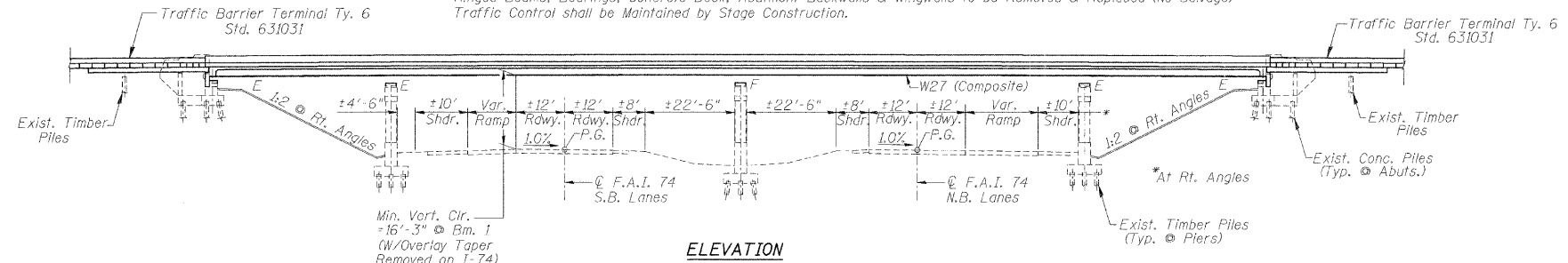

DESIGN SPECIFICATIONS
1996 AASHTO With 1997, 1998 & 1999 Interims
LOADING HS20-44
Allow 50 p.s.f. for future wearing surface.

DESIGN STRESSES
New Construction:
f_c = 3500 p.s.i.
f_y = 60,000 p.s.i. (Reinf.)
f_y = 50,000 p.s.i. (Structural) M270 Gr. 50
f_y = 36,000 p.s.i. (Structural) M270 Gr. 36
Existing Construction:
f_c = 1,000 p.s.i. (W/ Earth Pressure)
f_c = 1,400 p.s.i. (W/O Earth Pressure)
f_s = 20,000 p.s.i. (Reinf.)
v = 75 p.s.i. (Shear in Pier Footings)
n = 10

SEISMIC DATA
Seismic Performance Category (S.P.C.) = A
Bedrock Acceleration Coefficient (A) = 0.037 g
Site Coefficient (S) = 1.2

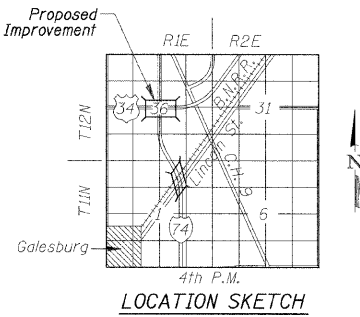

STATION 212+20.71
REBUILT 20 BY
STATE OF ILLINOIS
F.A.I. RTE. 74 SEC. (48-26HB-4)I
LOADING HS20-44
STR. NO. 048-0020

NAME PLATE
(See Std. 515001)
2-Required
E.B. Struct. Shown - W.B. Struct.
Same Except Str. No. - 048-0019
(Existing name plate to be
cleaned and relocated next
to new plate. Cost included
with Name Plates.)

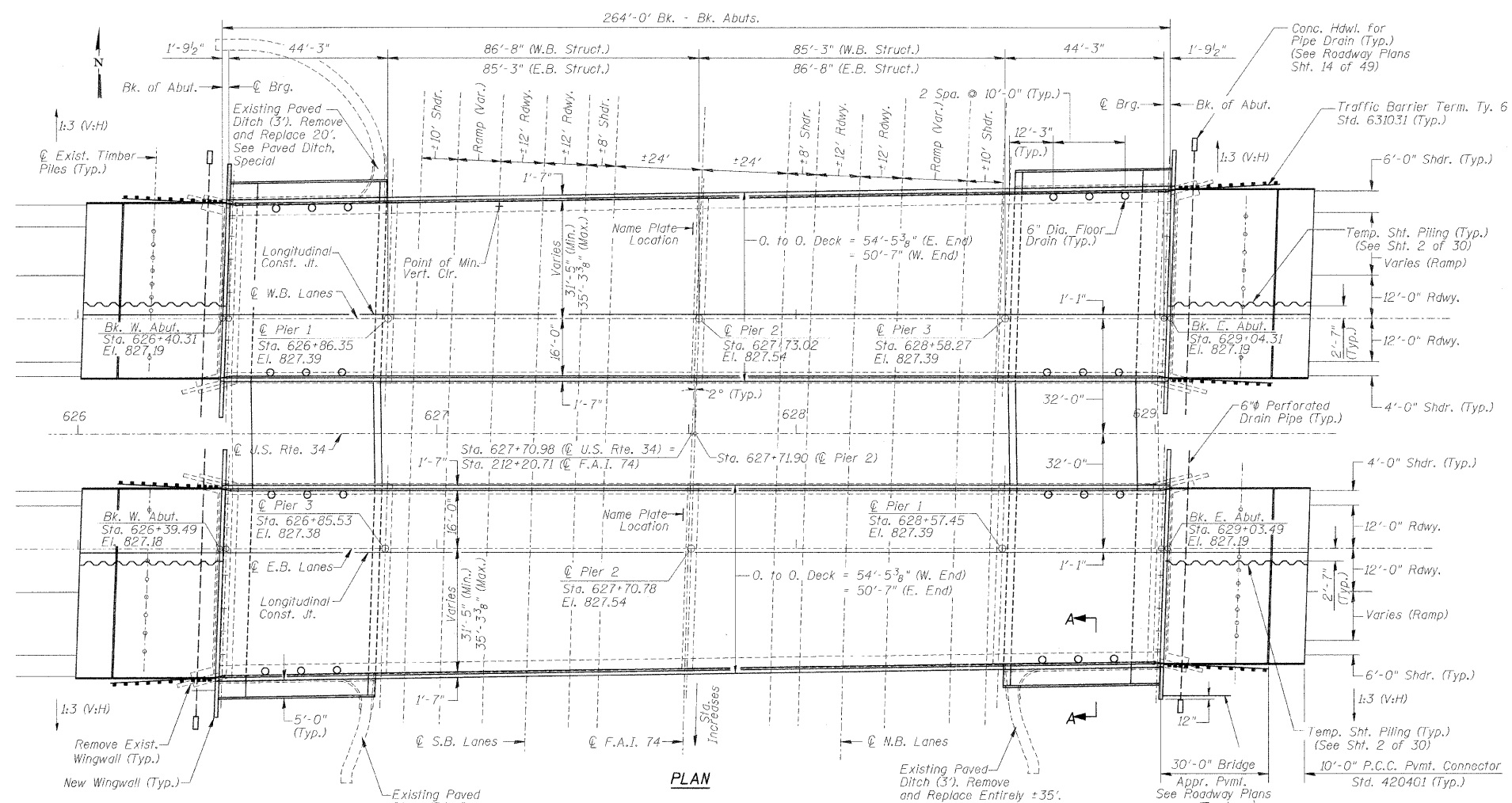

CURVE DATA
F.A.I. 74

P.I. Sta. 228+38.15
Δ = 20°-40'-20"
D = 0°-36'-00"
T = 1741.65'
R = 9549.30'
L = 3445.38'
E = 157.54'

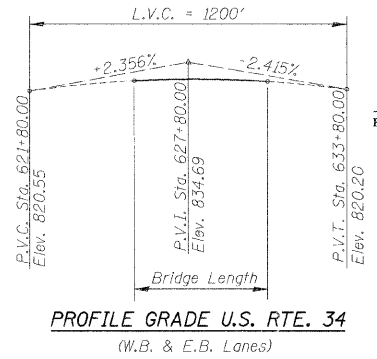
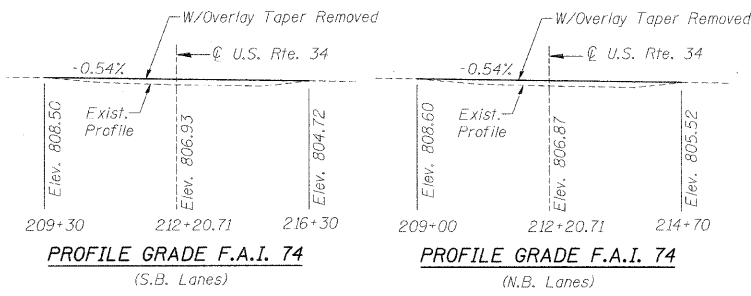

APPROVED
FOR STRUCTURAL ADEQUACY ONLY

Ralph E. Anderson
ENGINEER OF BRIDGES AND STRUCTURES

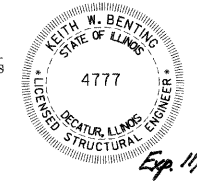

Date: April 10, 2009
Keith W. Bentley
Ill. Structural No. 4777

GENERAL PLAN AND ELEVATION		Sheet No.
Date	Designed ACW	U.S. ROUTE 34 OVER F.A.I. ROUTE 74 F.A.I. RTE. 74 SECTION (48-26HB-4)I KNOX COUNTY STA. 212+20.71 STRUCTURES NO. 048-0019 (WB) & 048-0020 (EB)
Revisions	Drawn SRS	
	Checked KWB	
	Approved KWB	
Prepared by: WVP CORPORATION	Engineers - Architects - Planners Decatur, Illinois - St. Louis, Missouri	
A Division of URS Greiner Woodward Clyde		WVP Job No. 2100001161.04