

ROUTE	SECTION	COUNTY	TOTAL SHEETS	SHEET NUMBER
VARIOUS	2008-009 PP	LAKE	37	1

STATE OF ILLINOIS
DEPARTMENT OF TRANSPORTATION
DIVISION OF HIGHWAYS
DISTRICT ONE
PROPOSED HIGHWAY PLANS

CONTRACT NO. 60E35

D-91-360-08

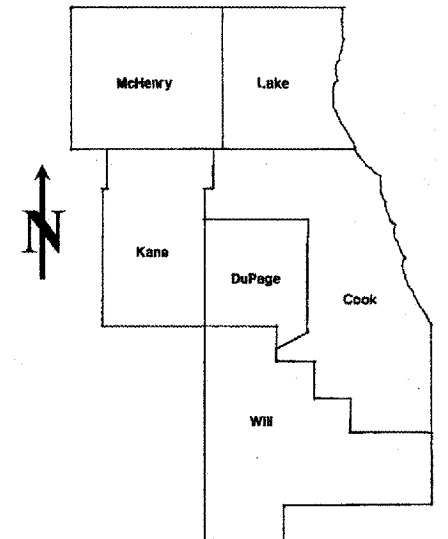

LOCATION OF IMPROVEMENT INDICATED THUS:

FOR INDEX OF SHEETS SEE SHEET 2

VARIOUS ROUTES
 SECTION: 2008-009 PP
 VARIOUS LOCATIONS IN EAST LAKE COUNTY
 PAVEMENT PATCHING
 LAKE COUNTY
 C-91-360-08

DISTRICT ONE - DESIGN - PLAN PREPARATION ENGINEER:
 KEN ENG / (847) 705-4247

CONTRACT NO. 60E35

STATE OF ILLINOIS DEPARTMENT OF TRANSPORTATION DIVISION OF HIGHWAYS
SUBMITTED: <u>APRIL 11, 2008</u> <i>Diana M. O'Keefe</i> <i>dk</i> <small>DEPUTY DIRECTOR OF HIGHWAYS, REGION ENGINEER</small>
<i>Interim</i> <u>April 18, 2008</u> <i>Eric E. Darnell</i> <i>ED</i> <small>ENGINEER OF DESIGN AND ENVIRONMENT</small>
<u>April 18, 2008</u> <i>Christine M. Reed</i> <i>CR</i> <small>DIRECTOR, DIVISION OF HIGHWAYS</small>

PRINTED BY THE AUTHORITY
OF THE STATE OF ILLINOIS

J.U.L.I.E.: JOINT UTILITY LOCATION
INFORMATION FOR EXCAVATION
(312) 744-7000

INDEX OF SHEETS

<u>SHEET NO.</u>	<u>DESCRIPTION</u>
1	TITLE SHEET
2	INDEX OF SHEETS, STATE STANDARDS AND GENERAL NOTES
3	SUMMARY OF QUANTITIES
4	GENERAL LOCATION MAP
5	SUMMARY OF PATCHING SCHEDULE
6-30	PATCHING SCHEDULE
31	SPECIAL DETAIL FOR PAVEMENT PATCHING FOR HMA SURFACED PAVEMENT
32	BUTT JOINT AND HMA TAPER DETAILS
33	TYPICAL APPLICATIONS: RAISED REFLECTIVE PAVEMENT MARKERS (SNOW-PLOW RESISTANT)
34	DISTRICT ONE TYPICAL PAVEMENT MARKINGS
35	TRAFFIC CONTROL AND PROTECTION OF TURN BAYS (TO REMAIN OPEN TO TRAFFIC)
36	ARTERIAL ROAD INFORMATION SIGN
37	TRAFFIC CONTROL AND PROTECTION FOR SIDE ROADS, INTERSECTIONS AND DRIVEWAYS

STATE STANDARDS

<u>STANDARD NO.</u>	<u>DESCRIPTION</u>
000001-05	TYPICAL SYMBOLS, ABBREVIATIONS AND PATTERNS
442201-03	CLASS C AND D PATCHES
701201-02	LANE CLOSURE, 2L, 2W, DAY ONLY
701306-01	LANE CLOSURE, 2L, 2W, SLOW MOVING OPERATIONS - DAY ONLY
701336-04	LANE CLOSURE, 2L, 2W, WORK AREAS IN SERIES
701501-04	URBAN LANE CLOSURE, 2L, 2W, UNDIVIDED
701601-05	URBAN LANE CLOSURE, MULTILANE, 1W OR 2W WITH NONTRAVERSABLE MEDIAN
701606-05	URBAN LANE CLOSURE, MULTILANE, 2W WITH MOUNTABLE MEDIAN
701701-05	URBAN LANE CLOSURE, MULTILANE INTERSECTION
701901	TRAFFIC CONTROL DEVICES

THE PAY ITEM "MIXTURE FOR CRACKS, JOINTS AND FLANGEWAYS" SHALL BE USED IN AREAS WHERE THE EXISTING CRACK IS 2 INCHES OR LESS. THE CONTRACTOR SHALL CLEAN OUT ALL DEBRIS FROM THE CRACK. THE CLEAN OUT WORK SHALL BE INCLUDED IN THE COST OF "MIXTURE FOR CRACKS, JOINTS AND FLANGEWAYS". THE ENGINEER SHALL DETERMINE THE LOCATIONS FOR THE PLACEMENT OF THE "MIXTURE FOR CRACKS, JOINTS AND FLANGEWAYS".

GENERAL NOTES

BEFORE STARTING ANY EXCAVATION, THE CONTRACTOR SHALL CALL "JULIE" AT (800) 892-0123 OR 811 FOR FIELD LOCATIONS OF BURIED ELECTRIC, TELEPHONE AND GAS FACILITIES. (48 HOUR NOTIFICATION REQUIRED)

THE CONTRACTOR WILL NOT BE ALLOWED TO SET UP A YARD OR FIELD OFFICE ON STATE (OR TOLLWAY) PROPERTY WITHOUT WRITTEN PERMISSION FROM THE DEPARTMENT (OR ISTHA)

WHEN ARTIFICIAL LIGHTING IS UTILIZED IN NIGHT OPERATIONS, THE CONTRACTOR SHALL EXERCISE THE UTMOST PRECAUTIONS IN PREVENTING ADVERSE VISABILITY TO THE MOTORING PUBLIC AND ADJOINING RESIDENTIAL AREAS.

ANY PAVEMENT MARKINGS AND RAISED REFLECTIVE PAVEMENT MARKERS OBLITERATED BY MILLING AND RESURFACING OPERATIONS ON SIDE STREETS AND ENTRANCES SHALL BE REPLACED AND PAID FOR IN KIND.

BEFORE BEGINNING ANY WORK, THE CONTRACTOR SHALL RETAIN AND RECORD FOR FUTURE REFERENCE, ALL EXISTING PAVEMENT MARKING LINES (AND RAISED REFLECTIVE PAVEMENT MARKERS) IN ORDER THAT THESE LOCATIONS CAN BE RE-ESTABLISHED FOR STRIPING. EXACT LOCATIONS OF ALL PAVEMENT MARKINGS SHALL BE AS DIRECTED BY THE ENGINEER.

ALL PAVEMENT PATCHING LOCATIONS WILL BE DETERMINED IN THE FIELD BY THE ENGINEER.

THE CONTRACTOR SHALL CONTACT THE DISTRICT ONE TRAFFIC CONTROL SUPERVISOR AT (847) 705-4470 A MINIMUM OF 72 HOURS IN ADVANCE OF BEGINNING WORK.

THE ENGINEER SHALL CONTACT MS. DEBBIE HANLON, AREA TRAFFIC FIELD ENGINEER AT (815) 438-2300 MINIMUM OF TWO (2) WEEKS PRIOR TO PLACEMENT OF PERMANENT PAVEMENT MARKINGS.

DOUBLE LANE MARKERS ARE TO BE USED AS SHOWN ON THE DISTRICT ONE DETAIL "TYPICAL APPLICATIONS - RAISED REFLECTIVE PAVEMENT MARKERS (SNOW-PLOW RESISTANT)" SNOWN IN THE PLANS.

THE EXISTING ROADWAY TYPICAL SECTION IS ASSUMED TO HAVE A 3 INCH HOT-MIX ASPHALT OVERLAY ON TOP OF A TEN INCH CONCRETE BASE.

ALL MILLING AREAS AS NOTED ON THE INDIVIDUAL PATCHING SCHEDULES WITH A PATCH WIDTH OF 3 FEET OR LESS AND PATCH LENGTH OF 25 FEET OR MORE SHALL BE PAID FOR AS HOT-MIX ASPHALT SURFACE REMOVAL (SPECIAL).

THE COST OF TRAFFIC CONTROL AND PROTECTION FOR THE PROJECT SHALL BE INCLUDED IN THE COST OF THE ASSOCIATED ROAD WORK.

HOT-MIX ASPHALT MIXTURE REQUIREMENTS

MIXTURE TYPE	AC TYPE	AIR VOIDS (%)
HOT-MIX ASPHALT SURFACE COURSE, MIX "D", N70 (IL 9.5 MM)	PG 64-22	4% @ 70 GYR
LEVELING BINDER (MM), N70	PG 64-22/58-22	4% @ 70 GYR
CLASS D PATCHES, (HMA BINDER IL-19.0 MM)	PG 64-22 *	4% @ 70 GYR
HOT-MIX ASPHALT REPLACEMENT OVER PATCHES, (HMA BINDER IL-19.0 MM)	PG 64-22 *	4% @ 70 GYR
TOP 1 1/2 INCH OF REPLACEMENT OVER PATCHES: (HMA SURFACE COURSE, MIX "D", N70 (IL 9.5 MM))	PG 64-22	4% @ 70 GYR

THE UNIT WEIGHT USED TO CALCULATE ALL HOT-MIX ASPHALT SURFACE MIXTURE QUANTITIES IS 112 LBS/SY/IN.

* WHEN RAP EXCEEDS 20%, THE NEW ASPHALT BINDER IN THE MIX SHALL BE PG 58-22

SUMMARY OF QUANTITIES			URBAN 100% STATE TOTAL QUANTITIES	CONSTRUCTION TYPE CODE				
CODE NO	ITEM	UNIT	1000					
40600200	BITUMINOUS MATERIALS (PRIME COAT)	TON	17	17				
40600300	AGGREGATE (PRIME COAT)	TON	85	85				
40600400	MIXTURE FOR CRACKS, JOINTS, AND FLANGEWAYS	TON	43	43				
40600635	LEVELING BINDER (MACHINE METHOD), N70	TON	1200	1200				
40600982	HOT-MIX ASPHALT SURFACE REMOVAL - BUTT JOINT	SO YD	978	978				
40601005	HOT-MIX ASPHALT REPLACEMENT OVER PATCHES	TON	1280	1280				
40603340	HOT-MIX ASPHALT SURFACE COURSE, MIX "D", N70	TON	3568	3568				
44000158	HOT-MIX ASPHALT SURFACE REMOVAL, 2 1/4"	SO YD	28715	28715				
44000196	HOT-MIX ASPHALT SURFACE REMOVAL, SPECIAL	SO YD	13766	13766				
44002212	HOT-MIX ASPHALT REMOVAL OVER PATCHES, 3"	SO YD	7620	7620				
44201761	CLASS D PATCHES, TYPE I, 10 INCH	SO YD	1861	1861				
44201765	CLASS D PATCHES, TYPE II, 10 INCH	SO YD	3579	3579				
44201769	CLASS D PATCHES, TYPE III, 10 INCH	SO YD	608	608				
44201771	CLASS D PATCHES, TYPE IV, 10 INCH	SO YD	882	882				
67000400	ENGINEER'S FIELD OFFICE, TYPE A	CAL MO	3	3				
67100100	MOBILIZATION	L SUM	1	1				
* 78000200	THERMOPLASTIC PAVEMENT MARKING - LINE 4"	FOOT	38048	38048				
* 78100100	RAISED REFLECTIVE PAVEMENT MARKER	EACH	932	932				
78300200	RAISED REFLECTIVE PAVEMENT MARKER REMOVAL	EACH	932	932				
X0322256	TEMPORARY INFORMATION SIGNING	SO FT	669	669				

SUMMARY OF QUANTITIES			TOTAL QUANTITIES	CONSTRUCTION TYPE CODE				
CODE NO	ITEM	UNIT	1000-2A					

* SPECIALTY ITEM

REVISIONS	
NAME	DATE

ILLINOIS DEPARTMENT OF TRANSPORTATION
SUMMARY OF QUANTITIES

PLOT DATE: 4/11/2008

4/11/2008 11:23:05 AM User:wilgreen

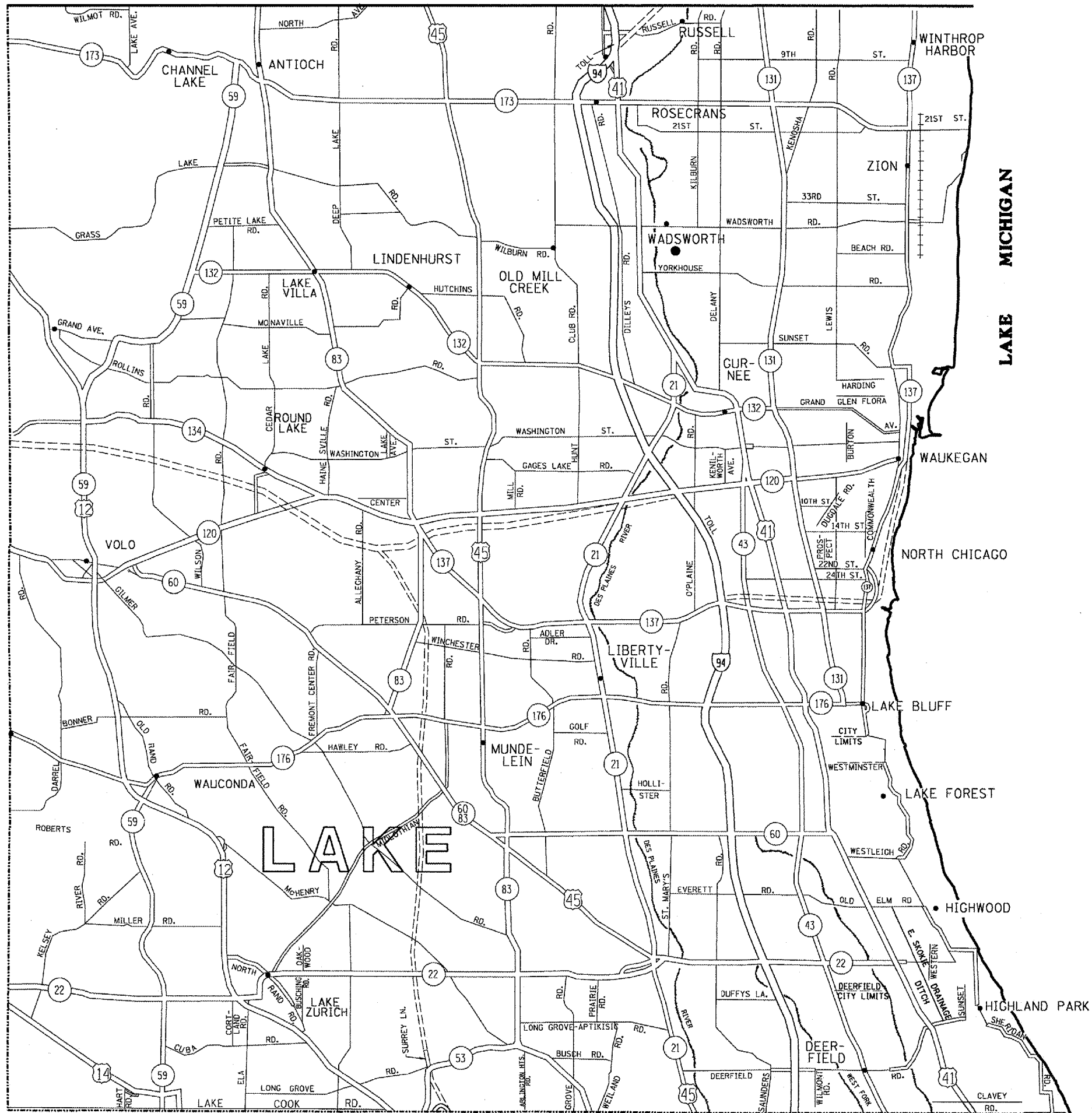

FILE NAME :
c:\projects\dl36808\design.ea.dgn

USER NAME = wilgrndp
 PLOT SCALE = 100.0000' / IN.
 PLOT DATE = 4/11/2008

DESIGNED -	REVISED -
DRAWN -	REVISED -
CHECKED -	REVISED -
DATE -	REVISED -

**STATE OF ILLINOIS
DEPARTMENT OF TRANSPORTATION**

GENERAL LOCATION MAP - LAKE COUNTY

SCALE: SHEET NO. OF SHEETS STA. TO STA.

F.A. RTE.	SECTION	COUNTY	TOTAL SHEETS	SHEET NO.
VAR.	2008-009 PP	LAKE	37	4
			CONTRACT NO. 60E35	

EAST LAKE COUNTY ROUTE SEGMENT	HMA SURF REM 2-1/4" & RESURF (SY)	HMA SURF REM (SP) & RESURF (SY)	CLASS D PATCH TYPE I (SY)	CLASS D PATCH TYPE II (SY)	CLASS D PATCH TYPE III (SY)	CLASS D PATCH TYPE IV (SY)	PAVT MARKING 4" (FT)	RAISED REFL PAVT MKS (EACH)
US 41(Washington St. to S/O IL 132)	211	1167	53	177	36	120	2000	40
IL 21 (Lake Cook Rd to IL 60)	50	1165	376	304	27	0	3500	70
IL. RTE 137 (IL. 83 TO IL RTE 21)	27	1284	0	1577	0	0	16500	300
IL Rte 137 (Wadsworth Rd to 33rd St)	187	384	71	24	0	0	600	12
IL Rte 43 (Talbot Ave to Albrecht Dr)	733	3516	29	122	0	73	4600	92
IL Rte 22 (Rte 43 to Westminster Way)	0	775	141	36	48	0	1160	24
IL 22	1065	116	76	196	16	87	700	20
IL Rte 132 (US Rte 45 to I-94 Tollway)	1034	5068	189	456	239	533	7200	300
RTE 131 (GREENBAY ROAD): From RTE 137 to RTE 120	0	0	616	0	0	30	8	0
Old Skokie Hwy (Wisc.State Line to I94 Tollway Ramp)	64	234	95	49	17	0	430	22
22ND STREET (MARTIN LUTHER KING DRIVE)	0	0	0	342	172	0	100	10
SHERIDAN ROAD: From Amstutz Expressway to 22ND STREET IN North Chicago	25344	0	0	151	37	0	850	42
IL 120 Frontage Rd (Old Plank Rd) (Will Ave. to Knight Ave.-Village of Park City)	0	57	215	145	16	39	400	0
SUMMARY TOTALS:	28715	13766	1861	3579	608	882	38048	932
	SY	SY	SY	SY	SY	SY	FT	EACH

NOTE:

ALL MILLING AREAS AS NOTED ON THE INDIVIDUAL PATCHING SCHEDULES WITH A PATCH WIDTH OF 3 FEET OR LESS AND PATCH LENGTH OF 25 FEET OR MORE SHALL BE PAID FOR AS HOT-MIX ASPHALT SURFACE REMOVAL (SPECIAL).

ROUTE: US 41(Washington St. to S/O IL 132)

CROSS STREETS		DIRECTION (EB/WB) (NB/SB)	LANE NO. (1, 2, 3)	PAVEMENT PATCH WIDTH	PAVEMENT PATCH LENGTH	REPAIR AREA (SQ FT)	REPAIR AREA (SQ YD)	HMA SURF REM 2-1/4" & RESURF	HMA SURF REM (SP) & RESURF	CLASS D PATCH TYPE I	CLASS D PATCH TYPE II	CLASS D PATCH TYPE III	CLASS D PATCH TYPE IV	PAVT MARKING 4"	RAISED REFL PAVT MKS
FROM	TO														
Washington	IL 132	NB	1&2	2	1500	2250	250		250						
		NB	1&2	3	500	1500	167		167						
		NB	1	12	30	360	40						40		
		NB	2	12	30	360	40						40		
		NB	1	6	12	72	8				8				
		NB	2	6	12	72	8				8				
		NB	1	4	4	16	2			2					
		NB	2	4	4	16	2			2					
		NB	1	6	12	72	8				8				
		NB	2	4	12	48	5				5				
		NB	1	4	12	48	5				5				
		NB	1	4	12	48	5				5				
		NB	1	4	12	48	5				5				
		NB	1	8	12	96	11				11				
		NB	1	8	12	96	11				11				
		NB	2	8	12	96	11				11				
		NB	2	8	12	96	11				11				
		NB	1	4	12	48	5				5				
		NB	2	6	12	72	8				8				
		NB	2	4	30	120	13				13				
		NB	2	4	6	24	3			3					
		NB	2	4	6	24	3			3					
		NB	2	4	12	48	5				5				
		NB	1	4	12	48	5				5				
		NB	2	4	12	48	5				5				
		NB	1	4	12	48	5				5				
		NB	2	12	12	144	16					16			
		NB	2	4	12	48	5				5				
		NB	2	4	4	16	2			2					
		NB	2	4	4	16	2			2					
		NB	2	4	100	400	44	44							
		NB	2	6	150	900	100	100							
		NB	2	6	100	600	67	67							
		SB	2	4	4	16	2			2					
		SB	2	4	4	16	2			2					
		SB	1&2	2	1500	2250	250		250						
		SB	1&2	3	500	1500	167		500						
		SB	2	4	4	16	2			2					
		SB	2	4	4	16	2			2					
		SB	1	4	12	48	5				5				
		SB	1	4	6	24	3			3					
		SB	2	4	4	16	2			2					
		SB	2	4	12	48	5				5				
		SB	2	4	6	24	3			3					
		SB	2	4	4	16	2			2					
		SB	2	6	30	180	20					20			
		SB	2	4	4	16	2			2					
		SB	2	4	4	16	2			2					
		SB	2	4	12	48	5				5				
		SB	Ramp	12	30	360	40						40		
		SB	1	4	4	16	2			2					
		SB	1	4	4	16	2			2					
		SB	2	4	4	16	2			2					
		SB	2	4	4	16	2			2					
		SB	1	4	8	32	4			4					
		SB	1	4	8	32	4			4					
		SB	2	4	8	32	4			4					
		SB	2	4	8	32	4			4					
		SB	1	4	12	48	5				5				
		SB	1	4	12	48	5				5				
		SB	2	4	12	48	5				5				
		SB	2	4	12	48	5				5				

TOTALS 211 SY 1167 SY 53 SY 177 SY 36 SY 120 SY 2000 FT 40 EACH

ROUTE: IL 21 (Lake Cook Rd to IL 60)

CROSS STREETS		DIRECTION (EB/WB) (NB/SB)	LANE NO. (1, 2, 3)	PAVEMENT PATCH WIDTH	PAVEMENT PATCH LENGTH	REPAIR AREA (SQ FT)	REPAIR AREA (SQ YD)	HMA SURF REM 2-1/4" & RESURF	HMA SURF REM (SP) & RESURF	CLASS D PATCH TYPE I	CLASS D PATCH TYPE II	CLASS D PATCH TYPE III	CLASS D PATCH TYPE IV	PAVT MARKING 4"	RAISED REFL PAVT MKS
FROM	TO														
IL 60	Executive Dr	SB	1&2	2	500	750	83		83						
		SB	1	4	4	16	2			2					
		SB	1	12	12	144	16				16				
		SB	1	12	12	144	16				16				
		SB	1	4	12	48	5				5				
		SB	1	4	12	48	5				5				
		SB	1	4	12	48	5				5				
		SB	1	4	12	48	5				5				
		SB	1	4	10	40	4			4					
		SB	1	4	12	48	5				5				
Executive Dr	CDW Way	SB	1&2	2	1000	1500	167		167						
		SB	1	4	4	16	2			2					
		SB	1	4	6	24	3				3				
		SB	LT TN	4	6	24	3				3				
CDW Way	Corporate Woods Pkwy	SB	LT TN	4	4	16	2			2					
		SB	3	4	4	16	2			2					
		SB	3	4	4	16	2			2					
		SB	3	4	4	16	2			2					
		SB	1	4	4	16	2			2					
		SB	1	4	4	16	2			2					
		SB	1	4	4	16	2			2					
		SB	2	4	6	24	3				3				
		SB	1	4	4	16	2			2					
		SB	2	4	4	16	2			2					
		SB	2	4	4	16	2			2					
		SB	2	4	4	16	2			2					
		SB	1	4	6	24	3				3				
		SB	1	4	12	48	5				5				
		SB	2&3	2	500	750	83		83						
		SB	2	2	100	150	17		17						
		SB	1	4	6	24	3				3				
		SB	1	4	4	16	2				2				
		SB	3	4	4	16	2				2				
		SB	3	4	4	16	2				2				
		SB	3	4	4	16	2				2				
		SB	3	4	4	16	2				2				
		SB	2	4	6	24	3				3				
		SB	1	4	4	16	2				2				
		SB	3	4	4	16	2				2				
		SB	3	4	4	16	2				2				
		SB	3	4	4	16	2				2				
		SB	2	12	20	240	27				27				
		SB	1	4	4	16	2				2				
		SB	2	4	6	24	3				3				
		SB	2	4	6	24	3				3				
		SB	2	4	4	16	2				2				
		SB	3	4	4	16	2				2				
		SB	1	4	6	24	3				3				
		SB	2	4	4	16	2				2				
		SB	2	6	75	450	50		50						
		SB	3	4	4	16	2				2				
		SB	2	6	30	180	20					20			
		SB	3	4	4	16	2				2				
		SB	1	4	4	16	2				2				
SB	1	6	12	72	8					8					
SB	2	6	15	90	10					10					
SB	3	4	4	16	2				2						
SB	2	4	4	16	2				2						
SB	1	4	4	16	2				2						
SB	1	4	4	16	2				2						
SB	2	4	4	16	2				2						
SB	1	4	12	48	5					5					
SB	2	4	4	16	2				2						
SB	1	4	12	48	5					5					
SB	2	4	10	40	4				4						
SB	1	4	4	16	2				2						
SB	1	4	6	24	3				3						
SB	1&2	2	500	750	83			83							

CONTINUED ON THE NEXT SHEET

FILE NAME =	USER NAME = wlgreendp	DESIGNED -	REVISED -	STATE OF ILLINOIS DEPARTMENT OF TRANSPORTATION	PATCHING SCHEDULE IL 21				F.A.P. RTE.	SECTION	COUNTY	TOTAL SHEETS	SHEET NO.	
PROJECT =	PLT SCALE = 1/8" = 1' / IN.	DRAWN -	REVISED -		SCALE:	SHEET NO.	OF	SHEETS	STA.	TO STA.	LAKE	37	7	
DATE = 4/10/2008	PLT DATE = 4/10/2008	CHECKED -	REVISED -						VAR.	2008-009 PP	ILLINOIS	FED. AID PROJECT	CONTRACT NO. 60E35	
		DATE -	REVISED -											

...projects\136008\design_sa.dgn 4/10/2008 5:16:55 PM User=wlgreendp

ROUTE: IL 21 (Lake Cook Rd to IL 60)

CROSS STREETS		DIRECTION (EB/WB) (NB/SB)	LANE NO. (1, 2, 3)	PAVEMENT PATCH WIDTH	PAVEMENT PATCH LENGTH	REPAIR AREA (SQ FT)	REPAIR AREA (SQ YD)	HMA SURF REM 2-1/4" & RESURF	HMA SURF REM (SP) & RESURF	CLASS D PATCH TYPE I	CLASS D PATCH TYPE II	CLASS D PATCH TYPE III	CLASS D PATCH TYPE IV	PAVT MARKING 4"	RAISED REFL PAVT MKS
FROM	TO														
		SB	2	4	4	16	2			2					
		SB	2	2	1000	1500	167		167						
		SB	1	4	4	16	2			2					
		SB	1	4	4	16	2			2					
		SB	2	4	4	16	2			2					
		SB	3	4	4	16	2			2					
		SB	3	4	4	16	2			2					
		SB	2	4	4	16	2			2					
		SB	1	4	4	16	2			2					
		SB	2	4	4	16	2			2					
		SB	1	4	4	16	2			2					
		SB	2	4	6	24	3			3					
Corporate Woods Pkwy	Woodlands Pkwy	SB	RT E/P	2	50	75	8		8						
		SB	1	4	6	24	3			3					
		SB	2	4	4	16	2			2					
		SB	1	4	6	24	3			3					
		SB	2	4	4	16	2			2					
		SB	1	4	4	16	2			2					
		SB	RT E/P	2	300	450	50		50						
		SB	1	4	12	48	5				5				
Woodlands Pkwy	US 45	SB	1	4	4	16	2			2					
		SB	2	4	10	40	4			4					
		SB	1	6	12	72	8				8				
		SB	1	4	6	24	3			3					
		SB	1	4	4	16	2			2					
		SB	1	6	12	72	8				8				
		SB	2	6	12	72	8				8				
		SB	2	4	4	16	2			2					
		SB	2	4	4	16	2			2					
		SB	2	4	4	16	2			2					
		SB	2	4	4	16	2			2					
		SB	1	4	4	16	2			2					
US 45	IL 22	SB	1&2	2	150	225	25		25						
		SB	2	4	6	24	3			3					
		SB	2	4	4	16	2			2					
		SB	2	4	4	16	2			2					
		SB	2	4	4	16	2			2					
		SB	2	4	6	24	3			3					
		SB	2	4	6	24	3			3					
		SB	2	4	4	16	2			2					
		SB	2	4	10	40	4			4					
		SB	2	6	12	72	8				8				
		SB	1	4	4	16	2			2					
		SB	1	4	4	16	2			2					
		SB	1	4	4	16	2			2					
		SB	2	4	6	24	3			3					
		SB	1	4	12	48	5				5				
		SB	1	4	12	48	5				5				
IL 22	Marriott Drive	SB	2	4	12	48	5				5				
		SB	1	4	4	16	2			2					
		SB	2	4	4	16	2			2					
		SB	2	4	4	16	2			2					
		SB	2	4	10	40	4			4					
Marriott Drive	Aptakasic Road	SB	2	4	4	16	2			2					
		SB	2	4	4	16	2			2					
		SB	2	4	6	24	3			3					
		SB	2	6	4	24	3			3					
		SB	2	2	200	300	33		33						
		SB	2	4	4	16	2			2					
		SB	2	4	10	40	4			4					
		SB	1	4	4	16	2			2					
		SB	1	4	4	16	2			2					
		SB	1	4	4	16	2			2					
		SB	1	4	4	16	2			2					

CONTINUED ON THE NEXT SHEET

FILE NAME = c:\projects\dl36008\design_aa.dgn	USER NAME = wlgreendp	DESIGNED -	REVISED -	STATE OF ILLINOIS DEPARTMENT OF TRANSPORTATION	PATCHING SCHEDULE IL 21				F.A.P. RTE.	SECTION	COUNTY	TOTAL SHEETS	SHEET NO.
PLOT SCALE = 100.0000' / IN.	CHECKED -	REVISED -	REVISED -		SCALE:	SHEET NO.	OF	SHEETS	STA.	TO STA.	LAKE	37	8
PLOT DATE = 4/10/2008	DATE -	REVISED -	REVISED -								CONTRACT NO. 60E35		
...projects\dl36008\design_aa.dgn 4/10/2008 5:17:13 PM User=wlgreendp											FED. ROAD DIST. NO. 1 ILLINOIS FED. AID PROJECT		

ROUTE: IL 21 (Lake Cook Rd to IL 60)

CROSS STREETS		DIRECTION (EB/WB) (NB/SB)	LANE NO. (1, 2, 3)	PAVEMENT PATCH WIDTH	PAVEMENT PATCH LENGTH	REPAIR AREA (SQ FT)	REPAIR AREA (SQ YD)	HMA SURF REM 2-1/4" & RESURF	HMA SURF REM (SP) & RESURF	CLASS D PATCH TYPE I	CLASS D PATCH TYPE II	CLASS D PATCH TYPE III	CLASS D PATCH TYPE IV	PAVT MARKING 4"	RAISED REFL PAVT MKS		
FROM	TO																
Aptakisic Road	Deerfield Parkway	SB	2	4	20	80	9				9						
		SB	2	4	8	32	4			4							
		SB	2	4	8	32	4			4							
		SB	2	4	4	16	2			2							
		SB	2	4	4	16	2			2							
		SB	2	4	12	48	5				5						
		SB	2	4	4	16	2			2							
		SB	2	6	4	24	3			3							
		SB	2	6	4	24	3			3							
		SB	2	4	10	40	4			4							
		SB	2	4	6	24	3			3							
		SB	1	12	12	144	16				16						
		SB	1	4	15	60	7				7						
		Deerfield Parkway	Lake Cook Road	SB	2	4	12	48	5				5				
SB	2			4	12	48	5				5						
SB	2			4	4	16	2			2							
SB	2			4	8	32	4			4							
SB	2			4	4	16	2			2							
SB	1&2			2	800	1200	133		133								
Lake Cook Road	Deerfield Parkway	NB	2	4	4	16	2			2							
		NB	2	4	4	16	2			2							
		NB	2	4	6	24	3			3							
		NB	2	4	6	24	3			3							
		NB	2	4	4	16	2			2							
		NB	2	4	4	16	2			2							
		NB	1	6	12	72	8				8						
		NB	2	4	4	16	2			2							
		Deerfield Pkwy	Aptakisic	NB	2	6	6	36	4			4					
				NB	2	6	6	36	4			4					
NB	2			4	4	16	2			2							
NB	2			4	4	16	2			2							
NB	1			4	4	16	2			2							
NB	2			4	4	16	2			2							
NB	2			4	20	80	9				9						
NB	1&2			2	500	750	83		83								
Aptakisic	IL 22	NB	1	4	4	16	2			2							
		NB	1	4	4	16	2			2							
		NB	1	4	4	16	2			2							
		NB	LT TN	4	4	16	2			2							
		NB	1	4	4	16	2			2							
		NB	2	2	200	300	33		33								
		NB	2	4	4	16	2			2							
IL 22	IL 45	NB	2	6	10	60	7				7						
		NB	1	4	4	16	2			2							
		NB	2	4	6	24	3			3							
		NB	2	4	6	24	3			3							
		NB	2	4	6	24	3			3							
		NB	2	12	15	180	20				20						
		NB	2	4	4	16	2			2							
		NB	2	4	4	16	2			2							
		NB	2	4	4	16	2			2							
		NB	1&2	2	100	150	17		17								
		NB	2	12	20	240	27						27				
		NB	1	4	12	48	5				5						
		NB	1&2	2	100	150	17		17								
		NB	2	4	4	16	2			2							
		NB	2	4	4	16	2			2							
		NB	1	4	4	16	2			2							

CONTINUED ON THE NEXT SHEET

ROUTE: IL 21 (Lake Cook Rd to IL 60)

CROSS STREETS		DIRECTION (EB/WB) (NB/SB)	LANE NO. (1, 2, 3)	PAVEMENT PATCH WIDTH	PAVEMENT PATCH LENGTH	REPAIR AREA (SQ FT)	REPAIR AREA (SQ YD)	HMA SURF REM 2-1/4" & RESURF	HMA SURF REM (SP) & RESURF	CLASS D PATCH TYPE I	CLASS D PATCH TYPE II	CLASS D PATCH TYPE III	CLASS D PATCH TYPE IV	PAVT MARKING 4"	RAISED REFL PAVT MKS
FROM	TO														
IL 45	Woodlands Pkwy	NB	1	4	4	16	2			2					
		NB	1	4	4	16	2			2					
		NB	1	4	4	16	2			2					
		NB	2	4	4	16	2			2					
		NB	2	4	4	16	2			2					
		NB	2	4	4	16	2			2					
		NB	1	4	12	48	5			2	5				
		NB	1	4	4	16	2			2					
		NB	1	4	4	16	2			2					
		NB	1	4	4	16	2			2					
Woodlands Pkwy	CDW Way	NB	1	4	4	16	2			2					
		NB	2	4	4	16	2			2					
		NB	1	4	4	16	2			2					
		NB	1	4	4	16	2			2					
		NB	1	4	4	16	2			2					
		NB	1	6	10	60	7			2	7				
		NB	1	4	4	16	2			2					
		NB	1	4	4	16	2			2					
		NB	1	4	4	16	2			2					
		NB	1&2	2	200	300	33		33	2					
		NB	2	4	4	16	2			2					
		NB	2	4	4	16	2			2					
		NB	2	4	4	16	2			2					
		NB	2	4	4	16	2			2					
		NB	2	4	4	16	2			2					
		NB	2	4	4	16	2			2					
		NB	2	4	12	48	5			2	5				
		NB	2	4	15	60	7			2	7				
		NB	2	4	12	48	5			2	5				
		NB	2	4	4	16	2			2					
		NB	2	4	4	16	2			2					
		NB	2	4	12	48	5			2	5				
		NB	1	4	4	16	2			2					
		NB	2	4	4	16	2			2					
		NB	2	4	4	16	2			2					
		NB	2	4	4	16	2			2					
		NB	2	4	4	16	2			2					
		NB	2	4	6	24	3			2					
		NB	2	4	4	16	2			2					
		NB	2	4	4	16	2			2					
		NB	2	4	4	16	2			2					
CDW Way	Executive Dr	NB	2	4	4	16	2			2					
		NB	1	4	4	16	2			2					
		NB	1&2	2	300	450	50		50	2					
		NB	1	4	4	16	2			2					
Executive Dr	IL 60	NB	1	4	4	16	2			2					
		NB	RT EP	2	500	750	83		83	2					
		NB	2	4	4	16	2			2					
		NB	2	4	4	16	2			2					
		NB	2	4	4	16	2			2					

TOTALS: 50 SY 1165 SY 376 SY 304 SY 27 SY 3500 FT 70 EACH

...projects\dl35888\design_00.dgn 4/10/2008 5:17:53 PM User=w1greendp

ROUTE: IL Rte 22 (Rte 43 to Westminster Way)

CROSS STREETS		DIRECTION (EB/WB) (NB/SB)	LANE NO. (1, 2, 3)	PAVEMENT PATCH WIDTH	PAVEMENT PATCH LENGTH	REPAIR AREA (SQ FT)	REPAIR AREA (SQ YD)	HMA SURF REM 2-1/4" & RESURF	HMA SURF REM (SP) & RESURF	CLASS D PATCH TYPE I	CLASS D PATCH TYPE II	CLASS D PATCH TYPE III	CLASS D PATCH TYPE IV	PAVT MARKING 4"	RAISED REFL PAVT MKS
FROM	TO														
200' west of Westminster	Westminster Way	EB	2	3	36	108	12				12				
200' west of Westminster	Westminster Way	EB	2	2	2	4	1			1					
200' west of Westminster	Westminster Way	EB	RT TL	3	48	144	16	16							
200' west of Westminster	Westminster Way	EB	2	2	12	24	3			3					
200' west of Westminster	Westminster Way	EB	2	2	6	12	1			1					
200' west of Westminster	Westminster Way	EB	2	4	4	16	2			2					
200' west of Westminster	Westminster Way	EB	2	3	6	18	2			2					
200' west of Westminster	Westminster Way	EB	2	3	4	12	1			1					
200' west of Westminster	Westminster Way	EB	2	2	8	16	2			2					
Westminster Way	194 Tollway	EB	1	3	6	18	2			2					
Westminster Way	194 Tollway	EB	RT TL	3	275	825	92	92							
Westminster Way	194 Tollway	EB	1	4	4	16	2			2					
Westminster Way	194 Tollway	EB	1	12	2	24	3			3					
Westminster Way	194 Tollway	EB	RT TL	12	4	48	5				5				
Westminster Way	194 Tollway	EB	2	2	2	4	1			1					
194 Tollway	Lakeside Dr	EB	2	2	2	4	1			1					
194 Tollway	Lakeside Dr	EB	2	2	2	4	1			1					
194 Tollway	Lakeside Dr	EB	2	2	100	150	17	17							
Lakeside Dr	Rte 43	EB	2	2	6	12	1			1					
Lakeside Dr	Rte 43	EB	2	2	100	150	17	17							
Lakeside Dr	Rte 43	EB	1	2	2	4	1			1					
Lakeside Dr	Rte 43	EB	1	1	1	1	1			1					
Lakeside Dr	Rte 43	EB	1	6	24	144	16					16			
Lakeside Dr	Rte 43	EB	1	6	24	144	16					16			
Lakeside Dr	Rte 43	EB	1	6	24	144	16					16			
Lakeside Dr	Rte 43	EB	1	3	6	18	2			2					
Lakeside Dr	Rte 43	EB	1	2	4	8	1			1					
Lakeside Dr	Rte 43	EB	1	2	6	12	1			1					
Lakeside Dr	Rte 43	EB	1	1	1	1	1			1					
Lakeside Dr	Rte 43	EB	1	2	2	4	1			1					
Lakeside Dr	Rte 43	EB	1	2	2	4	1			1					
Lakeside Dr	Rte 43	EB	1	2	6	12	1			1					
Lakeside Dr	Rte 43	EB	1	2	2	4	1			1					
Lakeside Dr	Rte 43	EB	1	2	6	12	1			1					
Lakeside Dr	Rte 43	EB	1	2	4	8	1			1					
Lakeside Dr	Rte 43	EB	2	3	200	600	67	67							
Lakeside Dr	Rte 43	EB	1	2	2	4	1			1					
Lakeside Dr	Rte 43	EB	2	4	12	48	5				5				
Lakeside Dr	Rte 43	EB	1	1	30	30	3			3					
Lakeside Dr	Rte 43	EB	2	2	40	80	9				9				
Lakeside Dr	Rte 43	EB	2	2	6	12	1			1					
Lakeside Dr	Rte 43	EB	2	12	2	24	3			3					
Lakeside Dr	Rte 43	EB	2	12	2	24	3			3					
Lakeside Dr	Rte 43	EB	1	12	2	24	3			3					
Lakeside Dr	Rte 43	EB	2	12	2	24	3			3					
Lakeside Dr	Rte 43	EB	1	12	2	24	3			3					
Rte 43	600' east of	EB	2	12	2	24	3			3					
Rte 43	Rte 43	EB	1	12	2	24	3			3					
Rte 43	600' east of	EB	2	12	2	24	3			3					
Rte 43	Rte 43	EB	2	12	2	24	3			3					
Rte 43	600' east of	EB	2	12	2	24	3			3					
Rte 43	Rte 43	EB	1	2	2	4	1			1					

CONTINUED ON THE NEXT SHEET

ROUTE: IL Rte 22 (Rte 43 to Westminster Way)

CROSS STREETS		DIRECTION (EB/WB) (NB/SB)	LANE NO. (1, 2, 3)	PAVEMENT PATCH WIDTH	PAVEMENT PATCH LENGTH	REPAIR AREA (SQ FT)	REPAIR AREA (SQ YD)	HMA SURF REM 2-1/4" & RESURF	HMA SURF REM (SP) & RESURF	CLASS D PATCH TYPE I	CLASS D PATCH TYPE II	CLASS D PATCH TYPE III	CLASS D PATCH TYPE IV	PAVT MARKING 4"	RAISED REFL PAVT MKS
FROM	TO														
600' east of Rte 43	Rte 43	WB	2	1	1	1	1			1					
600' east of Rte 43	Rte 43	WB	1	2	2	4	1			1					
600' east of Rte 43	Rte 43	WB	2	2	2	4	1			1					
600' east of Rte 43	Rte 43	WB	2	2	2	4	1			1					
Rte 43	Lakeside Dr	WB	1	2	2	4	1			1					
Rte 43	Lakeside Dr	WB	1	2	12	24	3			3					
Rte 43	Lakeside Dr	WB	1	3	900	2700	300		300						
Rte 43	Lakeside Dr	WB	1	4	4	16	2			2					
Rte 43	Lakeside Dr	WB	1	3	6	18	2			2					
Rte 43	Lakeside Dr	WB	1	1	1	1	1			1					
Rte 43	Lakeside Dr	WB	1	2	2	4	1			1					
Rte 43	Lakeside Dr	WB	1	1	1	1	1			1					
Rte 43	Lakeside Dr	WB	1	2	4	8	1			1					
Rte 43	Lakeside Dr	WB	1	1	1	1	1			1					
Rte 43	Lakeside Dr	WB	1	2	2	4	1			1					
Rte 43	Lakeside Dr	WB	1	6	6	36	4			4					
Rte 43	Lakeside Dr	WB	1	2	4	8	1			1					
Rte 43	Lakeside Dr	WB	1	6	6	36	4			4					
Rte 43	Lakeside Dr	WB	1	1	1	1	1			1					
Rte 43	Lakeside Dr	WB	1	1	1	1	1			1					
Rte 43	Lakeside Dr	WB	2	2	4	8	1			1					
Rte 43	Lakeside Dr	WB	2	2	4	8	1			1					
Rte 43	Lakeside Dr	WB	2	3	300	900	100		100						
Lakeside Dr	I94 Tollway	WB	2	2	2	4	1			1					
Lakeside Dr	I94 Tollway	WB	2	2	1	2	1			1					
Lakeside Dr	I94 Tollway	WB	2	2	1	2	1			1					
Lakeside Dr	I94 Tollway	WB	2	3	400	1200	133		133						
I94 Tollway	200' west of Hewitt Dr	WB	1	3	1	3	1			1					
I94 Tollway	200' west of Hewitt Dr	WB	2	1	1	1	1			1					
I94 Tollway	200' west of Hewitt Dr	WB	LT TL	3	100	300	33		33						
I94 Tollway	200' west of Hewitt Dr	WB	1	12	2	24	3			3					
I94 Tollway	200' west of Hewitt Dr	WB	2	12	2	24	3			3					
I94 Tollway	200' west of Hewitt Dr	WB	1	3	8	24	3			3					
I94 Tollway	200' west of Hewitt Dr	WB	2	3	7	21	2			2					
I94 Tollway	200' west of Hewitt Dr	WB	1	3	6	18	2			2					
I94 Tollway	200' west of Hewitt Dr	WB	1	2	2	4	1			1					
I94 Tollway	200' west of Hewitt Dr	WB	2	2	2	4	1			1					
I94 Tollway	200' west of Hewitt Dr	WB	2	3	12	36	4			4					
I94 Tollway	200' west of Hewitt Dr	WB	2	3	8	24	3			3					
I94 Tollway	200' west of Hewitt Dr	WB	1	4	6	24	3			3					
I94 Tollway	200' west of Hewitt Dr	WB	1	12	2	24	3			3					
I94 Tollway	200' west of Hewitt Dr	WB	2	1	8	8	1			1					
I94 Tollway	200' west of Hewitt Dr	WB	1	4	6	24	3			3					
I94 Tollway	200' west of Hewitt Dr	WB	2	12	4	48	5				5				
I94 Tollway	200' west of Hewitt Dr	WB	2	1	1	1	1			1					

TOTALS:

0 SY 775 SY 141 SY 36 SY 48 SY 1160 FT 24 EACH

ROUTE: IL 22

CROSS STREETS		DIRECTION (EB/WB) (NB/SB)	LANE NO. (1, 2, 3)	PAVEMENT PATCH WIDTH	PAVEMENT PATCH LENGTH	REPAIR AREA (SQ FT)	REPAIR AREA (SQ YD)	HMA SURF REM 2-1/4" & RESURF	HMA SURF REM (SP) & RESURF	CLASS D PATCH TYPE I	CLASS D PATCH TYPE II	CLASS D PATCH TYPE III	CLASS D PATCH TYPE IV	PAVT MARKING 4"	RAISED REFL PAVT MKS
FROM	TO														
US 14	Kelsey Rd	EB	1	4	12	48	5				5				
		EB	1	4	4	16	2			2					
		EB	1	4	4	16	2			2					
		EB	1	4	20	80	9				9				
		EB	1	4	6	24	3			3					
		EB	1	4	100	400	44	44							
		EB	1	4	20	80	9				9				
		EB	1	4	6	24	3			3					
		EB	1	6	10	60	7				7				
		EB	1	12	50	600	67	67							
Kelsey Rd	IL 59	EB	1	4	10	40	4			4	4				
		EB	CL	2	200	300	33		33						
		EB	1	4	10	40	4			4	4				
		EB	1	4	500	2000	222	222							
		EB	1	4	100	400	44	100							
		EB	1	4	4	16	2			2					
		EB	1	4	20	80	9				9				
		EB	1	4	30	120	13				13				
		EB	RT EP	4	20	80	9				9				
		EB	RT EP	4	20	80	9				9				
IL 59	US 12	EB	1	4	4	16	2			2					
		EB	1	4	6	24	3			3					
Quentin	Old McHenry	EB	1	4	10	40	4			4					
		EB	1	4	8	32	4			4					
		EB	1	4	300	1200	133	133							
		EB	CL	2	300	450	50		50						
		EB	1	4	6	24	3			3	3				
		EB	1	12	20	240	27						27		
		EB	1	4	4	16	2			2					
		EB	1	4	4	16	2			2					
		EB	1	4	4	16	2			2					
		EB	1	4	4	16	2			2					
		EB	1	4	100	400	44	44			44				
		EB	1	4	4	16	2			2					
		EB	1	4	4	16	2			2					
		EB	1	4	12	48	5				5				
		EB	1	4	12	48	5				5				
		EB	1	4	50	200	22	22							
Old McHenry	IL 83	EB	1	4	4	16	2			2					
		EB	1	4	4	16	2			2					
		EB	1	4	4	16	2			2					
		EB	1	12	25	300	33						33		
		EB	CL	2	200	300	33		33						
		EB	1	6	12	72	8				8				
		EB	2	6	12	72	8				8				
IL 83	Old McHenry	WB	1	4	4	16	2			2					
		WB	1	4	4	16	2			2					
		WB	1	4	6	24	3			3					
Old McHenry	Quentin	WB	1	4	12	48	5				5				
		WB	1	4	4	16	2			2					
		WB	1	4	12	48	5				5				
		WB	1	4	4	16	2			2					
		WB	1	4	4	16	2			2					
		WB	1	12	100	1200	133	133							
		WB	1	4	12	48	5				5				
		WB	1	4	20	80	9				9				
		WB	1	4	6	24	3			3	3				
		WB	1	4	12	48	5				5				
		WB	1	6	100	600	67	67							
		WB	1	6	50	300	33	33							
		WB	1	12	100	1200	133	133							
		WB	1	4	12	48	5				5				
		WB	1	4	4	16	2			2					
		WB	1	4	4	16	2			2					
		WB	1	4	4	16	2			2					
		WB	1	4	4	16	2			2					
		WB	1	4	4	16	2			2					
		WB	1	4	4	16	2			2					
		WB	1	12	20	240	27						27		
		WB	1	4	4	16	2			2					
@ IL 59 intersection		WB	1	4	12	48	5				5				
Kelsey	US 14	WB	1	12	12	144	16						16		
		WB	1	6	100	600	67	67							

TOTALS:

1065
SY

116
SY

76
SY

196
SY

16
SY

87
SY

700
FT

20
EACH

FILE NAME = c:\projects\dl36003\design_aa.dgn
PLOT SCALE = 100.0000' / IN.
PLOT DATE = 4/18/2008

USER NAME = wlgreendp
DESIGNED -
DRAWN -
CHECKED -
DATE -

REVISED -
REVISED -
REVISED -
REVISED -

STATE OF ILLINOIS
DEPARTMENT OF TRANSPORTATION

PATCHING SCHEDULE
IL 22

SCALE: SHEET NO. OF SHEETS STA. TO STA.

F.A.P. RTE. VAR.	SECTION 2008-009 PP	COUNTY LAKE	TOTAL SHEETS 37	SHEET NO. 13
CONTRACT NO. 60E35				

FED. ROAD DIST. NO. 1 ILLINOIS FED. AID PROJECT

ROUTE: IL Rte 43 (Talbot Ave to Albrecht Dr)

CROSS STREETS		DIRECTION (EB/WB) (NB/SB)	LANE NO. (1, 2, 3)	PAVEMENT PATCH WIDTH	PAVEMENT PATCH LENGTH	REPAIR AREA (SQ FT)	REPAIR AREA (SQ YD)	HMA SURF REM 2-1/4" & RESURF	HMA SURF REM (SP) & RESURF	CLASS D PATCH TYPE I	CLASS D PATCH TYPE II	CLASS D PATCH TYPE III	CLASS D PATCH TYPE IV	PAVT MARKING 4"	RAISED REFL PAVT MKS
FROM	TO														
Talbot Ave	Foster Ave	SB	2	3	1600	4800	533		533						
Talbot Ave	Foster Ave	SB	1	12	6	72	8				8				
Talbot Ave	Foster Ave	SB	2	12	6	72	8				8				
Talbot Ave	Foster Ave	SB	2	2	2	4	1			1					
Talbot Ave	Foster Ave	SB	2	2	2	4	1			1					
Talbot Ave	Foster Ave	SB	1	12	250	3000	333	333							
Talbot Ave	Foster Ave	SB	1	12	150	1800	200	200							
Talbot Ave	Foster Ave	SB	1	12	30	360	40						40		
Talbot Ave	Foster Ave	SB	1	12	25	300	33						33		
Foster Ave	IL Rte 176	SB	2	3	1500	4500	500		500						
Foster Ave	IL Rte 176	SB	2	12	6	72	8				8				
Foster Ave	IL Rte 176	SB	1	12	6	72	8				8				
Foster Ave	IL Rte 176	SB	2	12	6	72	8				8				
Foster Ave	IL Rte 176	SB	1	12	6	72	8				8				
Foster Ave	IL Rte 176	SB	2	12	6	72	8				8				
Foster Ave	IL Rte 176	SB	2	3	25	75	8				8				
IL Rte 176	Albrecht Dr	SB	2	3	1500	4500	500		500						
IL Rte 176	Albrecht Dr	SB	2	2	2	4	1			1					
IL Rte 176	Albrecht Dr	SB	2	2	24	48	5				5				
IL Rte 176	Albrecht Dr	SB	1	12	150	1800	200	200							
IL Rte 176	Albrecht Dr	SB	2	12	5	60	7				7				
IL Rte 176	Albrecht Dr	SB	2	2	8	16	2			2					
IL Rte 176	Albrecht Dr	SB	2	3	8	24	3			3					
IL Rte 176	Albrecht Dr	SB	2	2	2	4	1			1					
IL Rte 176	Albrecht Dr	SB	2	3	8	24	3			3					
IL Rte 176	Albrecht Dr	SB	2	3	500	1500	167		167						
Albrecht Dr	IL Rte 176	NB	2	3	2200	6600	733		733						
Albrecht Dr	IL Rte 176	NB	2	4	8	32	4			4					
Albrecht Dr	IL Rte 176	NB	2	6	8	48	5				5				
Albrecht Dr	IL Rte 176	NB	2	2	6	12	1			1					
Albrecht Dr	IL Rte 176	NB	2	2	8	16	2			2					
Albrecht Dr	IL Rte 176	NB	2	2	8	16	2			2					
Albrecht Dr	IL Rte 176	NB	2	2	2	4	1			1					
Albrecht Dr	IL Rte 176	NB	2	1	6	6	1			1					
Albrecht Dr	IL Rte 176	NB	2	1	1	1	1			1					
Albrecht Dr	IL Rte 176	NB	2	3	150	450	50		50						
Albrecht Dr	IL Rte 176	NB	2	4	6	24	3			3					
IL Rte 176	Foster Ave	NB	2	3	1500	4500	500		500						
IL Rte 176	Foster Ave	NB	2	4	24	96	11				11				
IL Rte 176	Foster Ave	NB	2	2	24	48	5				5				
IL Rte 176	Foster Ave	NB	2	3	40	120	13				13				
IL Rte 176	Foster Ave	NB	2	12	8	96	11				11				
Foster Ave	Talbot Ave	NB	2	3	1600	4800	533		533						
Foster Ave	Talbot Ave	NB	2	4	8	32	4			4					
Foster Ave	Talbot Ave	NB	2	2	2	4	1			1					

TOTALS:

733
SY

3516
SY

29
SY

122
SY

73
SY

4600
FT

92
EACH

FILE NAME = c:\projects\dl36008\design_aa.dgn
PLOT SCALE = 100.0000 / IN.
PLOT DATE = 4/18/2008

USER NAME = w1greendp
DESIGNED -
DRAWN -
CHECKED -
DATE -

REVISED -
REVISED -
REVISED -
REVISED -

STATE OF ILLINOIS
DEPARTMENT OF TRANSPORTATION

PATCHING SCHEDULE
IL 43

SCALE: SHEET NO. OF SHEETS STA. TO STA.

F.A.P. RTE.	SECTION	COUNTY	TOTAL SHEETS	SHEET NO.
VAR.	2008-009 PP	LAKE	37	14
FED. ROAD DIST. NO. 1 ILLINOIS FED. AID PROJECT			CONTRACT NO. 60E35	

ROUTE: RTE 131 (GREENBAY ROAD): From RTE 137 to RTE 120

CROSS STREETS		DIRECTION (EB/WB (NB/SB))	LANE NO. (1, 2, 3)	PAVEMENT PATCH WIDTH	PAVEMENT PATCH LENGTH	REPAIR AREA (SQ FT)	REPAIR AREA (SQ YD)	HMA SURF REM 2-1/4" & RESURF	HMA SURF REM (SP) & RESURF	CLASS D PATCH TYPE I	CLASS D PATCH TYPE II	CLASS D PATCH TYPE III	CLASS D PATCH TYPE IV	PAVT MARKING 4"	RAISED REFL PAVT MKS	
FROM	TO															
RTE 137	RTE 120	SB	1	6 FT	12FT		8.0**	3 to 4"			ASPHALT					
						**	17 Patches on the SB lane 1									ne 1 (Type II Patches) 136 SQ YD
RTE 137	RTE 120	SB	2	6FT	12FT		8.00***	3" to 4"			ASPHALT					
							NOTE: Total of 20 Type II Patches on SB lane 2 = 160 SQ YD									
RTE 137	RTE 120	NB	1	6FT	12 FT		8.00*	3" TO 4"			ASPHALT					
							NOTE: Total of 20 Type II Patches on NB lane 1= 160 SQ YD									
RTE 137	RTE 120	NB	2	6 FT	12 FT		8.00 ****	3" to 4"			ASPHALT					
							NOTE: Total of 20 Type II Patches on NB Lane 2 = 160 SQ YD									

TOTALS:

616
SY

30
FT

8
EACH

ROUTE: IL Rte 132 (US Rte 45 to I-94 Tollway)

CROSS STREETS		DIRECTION (EB/WB) (NB/SB)	LANE NO. (1, 2, 3)	PAVEMENT PATCH WIDTH	PAVEMENT PATCH LENGTH	REPAIR AREA (SQ FT)	REPAIR AREA (SQ YD)	HMA SURF REM 2-1/4" & RESURF	HMA SURF REM (SP) & RESURF	CLASS D PATCH TYPE I	CLASS D PATCH TYPE II	CLASS D PATCH TYPE III	CLASS D PATCH TYPE IV	PAVT MARKING 4"	RAISED REFL PAVT MKS
FROM	TO														
Rte 45	Rollings Rd	EB	1	12	1	12	1			1					
Rte 45	Rollings Rd	EB	2	12	1	12	1			1					
Rte 45	Rollings Rd	EB	1	12	3	36	4			4					
Rte 45	Rollings Rd	EB	2	12	3	36	4			4					
Rte 45	Rollings Rd	EB	2	12	1	12	1			1					
Rte 45	Rollings Rd	EB	2	1	3	3	1			1					
Rte 45	Rollings Rd	EB	1	12	1	12	1			1					
Rte 45	Rollings Rd	EB	2	12	1	12	1			1					
Rte 45	Rollings Rd	EB	2	2	2	4	1			1					
Rte 45	Rollings Rd	EB	1	1	5	5	1			1					
Rte 45	Rollings Rd	EB	1	1	2	2	1			1					
Rte 45	Rollings Rd	EB	2	12	6	72	8				8				
Rte 45	Rollings Rd	EB	2	1	4	4	1			1					
Rte 45	Rollings Rd	EB	2	2	2	4	1			1					
Rte 45	Rollings Rd	EB	1	2	2	4	1			1					
Rte 45	Rollings Rd	EB	2	6	6	36	4			4					
Rte 45	Rollings Rd	EB	2	4	4	16	2			2					
Rte 45	Rollings Rd	EB	2	4	6	24	3			3					
Rte 45	Rollings Rd	EB	2	2	3	6	1			1					
Rte 45	Rollings Rd	EB	2	3	125	375	42	42							
Rte 45	Rollings Rd	EB	2	2	3	6	1			1					
Rte 45	Rollings Rd	EB	2	12	4	48	5				5				
Rte 45	Rollings Rd	EB	2	3	15	45	5				5				
Rte 45	Rollings Rd	EB	2	3	700	2100	233	233							
Rte 45	Rollings Rd	EB	2	3	250	750	83	83							
Rte 45	Rollings Rd	EB	1	12	10	120	13								
Rte 45	Rollings Rd	EB	1	1	3	3	1			1					
Rte 45	Rollings Rd	EB	1	12	12	144	16					16			
Rollings Rd	Almond Rd	EB	1	3	150	450	50	50							
Rollings Rd	Almond Rd	EB	2	3	25	75	8				8				
Rollings Rd	Almond Rd	EB	2	1	3	3	1			1					
Rollings Rd	Almond Rd	EB	1	1	3	3	1			1					
Rollings Rd	Almond Rd	EB	1	12	4	48	5				5				
Rollings Rd	Almond Rd	EB	1	12	2	24	3			3					
Rollings Rd	Almond Rd	EB	2	12	2	24	3			3					
Rollings Rd	Almond Rd	EB	1	2	6	12	1			1					
Rollings Rd	Almond Rd	EB	2	1	6	6	1			1					
Rollings Rd	Almond Rd	EB	1	12	6	72	8				8				
Rollings Rd	Almond Rd	EB	2	6	6	36	4			4					
Rollings Rd	Almond Rd	EB	1	1	3	3	1			1					
Rollings Rd	Almond Rd	EB	1	1	1	1	1			1					
Rollings Rd	Almond Rd	EB	1	1	3	3	1			1					
Rollings Rd	Almond Rd	EB	1	12	6	72	8				8				
Rollings Rd	Almond Rd	EB	LT TL	12	6	72	8				8				
Rollings Rd	Almond Rd	EB	2	1	3	3	1			1					
Rollings Rd	Almond Rd	EB	2	1	3	3	1			1					
Rollings Rd	Almond Rd	EB	1	12	8	96	11				11				
Rollings Rd	Almond Rd	EB	2	1	3	3	1			1					
Almond Rd	Brookside Dr.	EB	1	12	3	36	4			4					
Almond Rd	Brookside Dr.	EB	1	12	3	36	4			4					
Almond Rd	Brookside Dr.	EB	2	12	4	48	5				5				
Almond Rd	Brookside Dr.	EB	1	1	4	4	1			1					
Almond Rd	Brookside Dr.	EB	1	1	4	4	1			1					
Almond Rd	Brookside Dr.	EB	1	1	3	3	1			1					
Almond Rd	Brookside Dr.	EB	1	1	2	2	1			1					
Almond Rd	Brookside Dr.	EB	1	12	4	48	5				5				
Almond Rd	Brookside Dr.	EB	1	3	150	450	50	50							
Almond Rd	Brookside Dr.	EB	1	1	3	3	1			1					
Almond Rd	Brookside Dr.	EB	1	1	3	3	1			1					
Almond Rd	Brookside Dr.	EB	1	12	4	48	5				5				
Almond Rd	Brookside Dr.	EB	2	12	6	72	8				8				
Almond Rd	Brookside Dr.	EB	2	12	4	48	5				5				
Almond Rd	Brookside Dr.	EB	2	12	4	48	5				5				
Almond Rd	Brookside Dr.	EB	2	12	4	48	5				5				
Almond Rd	Brookside Dr.	EB	2	3	60	180	20	20							

CONTINUED ON THE NEXT SHEET

FILE NAME = c:\proj\jct\132\08\design\00.dgn

USER NAME = wilgreendp
 PLOT SCALE = 100.0000' / IN.
 PLOT DATE = 4/19/2008

DESIGNED -
 DRAWN -
 CHECKED -
 DATE -

REVISED -
 REVISED -
 REVISED -
 REVISED -

STATE OF ILLINOIS
 DEPARTMENT OF TRANSPORTATION

PATCHING SCHEDULE
 IL 132

SCALE: SHEET NO. OF SHEETS STA TO STA

F.A.P. RTE.	SECTION	COUNTY	TOTAL SHEETS	SHEET NO.
VAR.	2008-009 PP	LAKE	37	16
			CONTRACT NO. 60E35	

ROUTE: IL Rte 132 (US Rte 45 to I-94 Tollway)

CROSS STREETS		DIRECTION (EB/WB) (NB/SB)	LANE NO. (1, 2, 3)	PAVEMENT PATCH WIDTH	PAVEMENT PATCH LENGTH	REPAIR AREA (SQ FT)	REPAIR AREA (SQ YD)	HMA SURF REM 2-1/4" & RESURF	HMA SURF REM (SP) & RESURF	CLASS D PATCH TYPE I	CLASS D PATCH TYPE II	CLASS D PATCH TYPE III	CLASS D PATCH TYPE IV	PAVT MARKING 4"	RAISED REFL PAVT MKS
FROM	TO														
Brookside Dr	Stonebrook	EB	1	12	6	72	8				8				
Brookside Dr	Stonebrook	EB	2	12	12	144	16					16			
Brookside Dr	Stonebrook	EB	2	6	6	36	4			4					
Brookside Dr	Stonebrook	EB	2	12	6	72	8				8				
Brookside Dr	Stonebrook	EB	1	12	12	144	16					16			
Brookside Dr	Stonebrook	EB	2	12	18	216	24					24			
Brookside Dr	Stonebrook	EB	2	3	60	180	20					20			
Brookside Dr	Stonebrook	EB	2	6	6	36	4			4					
Brookside Dr	Stonebrook	EB	2	6	6	36	4			4					
Brookside Dr	Stonebrook	EB	2	6	6	36	4			4					
Brookside Dr	Stonebrook	EB	1	2	2	4	1			1					
Brookside Dr	Stonebrook	EB	1	12	2	24	3			3					
Brookside Dr	Stonebrook	EB	2	12	6	72	8				8				
Brookside Dr	Stonebrook	EB	2	12	10	120	13				13				
Brookside Dr	Stonebrook	EB	2	3	300	900	100		100						
Brookside Dr	Stonebrook	EB	1	12	1	12	1			1					
Brookside Dr	Stonebrook	EB	2	12	1	12	1			1					
Brookside Dr	Stonebrook	EB	1	12	6	72	8				8				
Brookside Dr	Stonebrook	EB	2	12	12	144	16					16			
Stonebrook	Mall Ent	EB	2	6	18	108	12				12				
Stonebrook	Mall Ent	EB	1	1	1	1	1			1					
Stonebrook	Mall Ent	EB	1	1	1	1	1			1					
Stonebrook	Mall Ent	EB	1	12	3	36	4			4					
Stonebrook	Mall Ent	EB	2	12	3	36	4			4					
Stonebrook	Mall Ent	EB	3	12	3	36	4			4					
Stonebrook	Mall Ent	EB	3	3	50	150	17								
Stonebrook	Mall Ent	EB	2	3	400	1200	133		133						
Mall Ent	Hunt Club Rd	EB	2	3	700	2100	233		233						
Mall Ent	Hunt Club Rd	EB	3	6	24	144	16					16			
Mall Ent	Hunt Club Rd	EB	3	6	6	36	4			4					
Mall Ent	Hunt Club Rd	EB	2	6	6	36	4			4					
Mall Ent	Hunt Club Rd	EB	1	3	60	180	20		20						
Mall Ent	Hunt Club Rd	EB	1	12	10	120	13								
Mall Ent	Hunt Club Rd	EB	3	12	300	3600	400	400							
Mall Ent	Hunt Club Rd	EB	1	3	3	9	1			1					
Mall Ent	Hunt Club Rd	EB	LT TL	12	25	300	33						33		
Mall Ent	Hunt Club Rd	EB	LT TL	12	20	240	27						27		
Mall Ent	Hunt Club Rd	EB	3	3	100	300	33		33						
Mall Ent	Hunt Club Rd	EB	2	3	100	300	33		33						
Mall Ent	Hunt Club Rd	EB	RT TL	3	3	9	1			1					
Mall Ent	Hunt Club Rd	EB	2	12	30	360	40						40		
Hunt Club Rd	Gurnee Mills Circle West	EB	1	3	100	300	33		33						
Hunt Club Rd	Gurnee Mills Circle West	EB	3	12	75	900	100	100							
Hunt Club Rd	Gurnee Mills Circle West	EB	1	12	50	600	67	67							
Hunt Club Rd	Gurnee Mills Circle West	EB	2	3	200	600	67		67						
Hunt Club Rd	Gurnee Mills Circle West	EB	3	6	75	450	50	50							
Hunt Club Rd	Gurnee Mills Circle West	EB	1	3	4	12	1			1					
Hunt Club Rd	Gurnee Mills Circle West	EB	2	3	6	18	2			2					
Hunt Club Rd	Gurnee Mills Circle West	EB	3	3	100	300	33		33						
Hunt Club Rd	Gurnee Mills Circle West	EB	1	12	40	480	53	53							
Hunt Club Rd	Gurnee Mills Circle West	EB	3	3	800	2400	267		267						
Hunt Club Rd	Gurnee Mills Circle West	EB	1	3	30	90	10				10				
Hunt Club Rd	Gurnee Mills Circle West	EB	1	3	100	300	33		33						
Hunt Club Rd	Gurnee Mills Circle West	EB	1	12	20	240	27						27		
Hunt Club Rd	Gurnee Mills Circle West	EB	1	12	20	240	27						27		
Hunt Club Rd	Gurnee Mills Circle West	EB	2	12	40	480	53						53		
Hunt Club Rd	Gurnee Mills Circle West	EB	2	3	400	1200	133		133						
Gurnee Mills Circle West	Tri-state Pkwy	EB	1	3	300	900	100		100						
Tri-state Pkwy	I94 Tollway	EB	1	3	600	1800	200		200						
Tri-state Pkwy	I94 Tollway	EB	2	3	1100	3300	367		367						
Tri-state Pkwy	I94 Tollway	EB	2	12	12	144	16					16			
I94 Tollway	Tri-State Pkwy	WB	3	3	125	375	42		42						
I94 Tollway	Tri-State Pkwy	WB	4	2	4	8	1			1					
I94 Tollway	Tri-State Pkwy	WB	1	3	3	9	1			1					

CONTINUED ON THE NEXT SHEET

FILE NAME : c:\projects\dl36008\design.aa.dgn

USER NAME : wilgreendp

DESIGNED -

REVISED -

PLOT SCALE = 1/8" = 1' IN.

DRAWN -

REVISED -

PLOT DATE = 4/10/2008

CHECKED -

REVISED -

DATE -

REVISED -

STATE OF ILLINOIS
DEPARTMENT OF TRANSPORTATION

PATCHING SCHEDULE
IL 132

SCALE: SHEET NO. OF SHEETS STA. TO STA.

F.A.P. RTE.	SECTION	COUNTY	TOTAL SHEETS	SHEET NO.
VAR.	2008-009 PP	LAKE	37	17
FED. ROAD DIST. NO. 1 ILLINOIS FED. AID PROJECT			CONTRACT NO. 60E35	

ROUTE: IL Rte 132 (US Rte 45 to I-94 Tollway)

CROSS STREETS		DIRECTION (EB/WB)	LANE NO. (1, 2, 3)	PAVEMENT PATCH WIDTH	PAVEMENT PATCH LENGTH	REPAIR AREA (SQ FT)	REPAIR AREA (SQ YD)	HMA SURF REM 2-1/4" & RESURF	HMA SURF REM (SP) & RESURF	CLASS D PATCH TYPE I	CLASS D PATCH TYPE II	CLASS D PATCH TYPE III	CLASS D PATCH TYPE IV	PAVT MARKING 4"	RAISED REFL PAVT MKS
FROM	TO														
Tri-State Pkwy	Gurnee Mills Circle East	WB	3	3	800	2400	267		267						
Tri-State Pkwy	Gurnee Mills Circle East	WB	1	3	250	750	83		83						
Tri-State Pkwy	Gurnee Mills Circle East	WB	2	3	250	750	83		83						
Tri-State Pkwy	Gurnee Mills Circle East	WB	3	3	3	9	1			1					
Tri-State Pkwy	Gurnee Mills Circle East	WB	3	12	4	48	5				5				
Tri-State Pkwy	Gurnee Mills Circle East	WB	3	3	100	300	33		33						
Tri-State Pkwy	Gurnee Mills Circle East	WB	3	3	150	450	50		50						
Gurnee Mills Circle East	Gurnee Mills Circle West	WB	1	3	400	1200	133		133						
Gurnee Mills Circle East	Gurnee Mills Circle West	WB	2	3	400	1200	133		133						
Gurnee Mills Circle East	Gurnee Mills Circle West	WB	3	3	400	1200	133		133						
Gurnee Mills Circle East	Gurnee Mills Circle West	WB	3	12	6	72	8				8				
Gurnee Mills Circle East	Gurnee Mills Circle West	WB	2	12	6	72	8				8				
Gurnee Mills Circle East	Gurnee Mills Circle West	WB	3	12	6	72	8				8				
Gurnee Mills Circle East	Gurnee Mills Circle West	WB	2	12	6	72	8				8				
Gurnee Mills Circle East	Gurnee Mills Circle West	WB	3	3	600	1800	200		200						
Gurnee Mills Circle East	Gurnee Mills Circle West	WB	2	3	600	1800	200		200						
Gurnee Mills Circle East	Gurnee Mills Circle West	WB	1	3	125	375	42		125						
Gurnee Mills Circle East	Gurnee Mills Circle West	WB	3	4	4	16	2			2					
Gurnee Mills Circle East	Gurnee Mills Circle West	WB	3	2	2	4	1			1					
Gurnee Mills Circle East	Gurnee Mills Circle West	WB	RT TL	6	20	120	13				13				
Gurnee Mills Circle East	Gurnee Mills Circle West	WB	RT TL	3	30	90	10				10				
Gurnee Mills Circle West	Hunt Club Rd	WB	RT TL	3	300	900	100		100						
Gurnee Mills Circle West	Hunt Club Rd	WB	1	1	1	1	1			1					
Gurnee Mills Circle West	Hunt Club Rd	WB	3	4	6	24	3			3					
Gurnee Mills Circle West	Hunt Club Rd	WB	3	12	26	312	35						35		
Gurnee Mills Circle West	Hunt Club Rd	WB	3	12	12	144	16					16			
Gurnee Mills Circle West	Hunt Club Rd	WB	1	3	250	750	83		83						
Gurnee Mills Circle West	Hunt Club Rd	WB	2	12	60	720	80	80							
Gurnee Mills Circle West	Hunt Club Rd	WB	2	12	25	300	33						33		
Gurnee Mills Circle West	Hunt Club Rd	WB	3	6	125	750	83	83							
Gurnee Mills Circle West	Hunt Club Rd	WB	3	6	15	90	10				10				
Gurnee Mills Circle West	Hunt Club Rd	WB	3	6	20	120	13				13				
Hunt Club Rd	Mall Ent	WB	2	12	50	600	67	67							
Hunt Club Rd	Mall Ent	WB	2	12	50	600	67	67							
Hunt Club Rd	Mall Ent	WB	3	12	20	240	27						27		
Hunt Club Rd	Mall Ent	WB	1	1	1	1	1			1					
Hunt Club Rd	Mall Ent	WB	1	12	25	300	33						33		
Hunt Club Rd	Mall Ent	WB	2	3	60	180	20		20						
Hunt Club Rd	Mall Ent	WB	3	3	60	180	20		20						
Hunt Club Rd	Mall Ent	WB	LT TL	3	50	150	17		17						
Mall Ent	Stonebrook Dr.	WB	1	12	30	360	40						40		
Mall Ent	Stonebrook Dr.	WB	2	12	30	360	40						40		
Mall Ent	Stonebrook Dr.	WB	3	3	250	750	83		83						
Mall Ent	Stonebrook Dr.	WB	2	6	25	150	17					17			
Mall Ent	Stonebrook Dr.	WB	3	4	4	16	2			2					
Mall Ent	Stonebrook Dr.	WB	1	12	20	240	27						27		
Mall Ent	Stonebrook Dr.	WB	1	3	75	225	25		25						
Mall Ent	Stonebrook Dr.	WB	2	3	75	225	25		25						
Mall Ent	Stonebrook Dr.	WB	2	12	12	144	16				16				
Mall Ent	Stonebrook Dr.	WB	1	3	12	36	4			4					
Mall Ent	Stonebrook Dr.	WB	1	12	12	144	16				16				
Mall Ent	Stonebrook Dr.	WB	2	12	12	144	16				16				
Mall Ent	Stonebrook Dr.	WB	1	1	1	1	1			1					
Mall Ent	Stonebrook Dr.	WB	2	2	2	4	1			1					
Mall Ent	Stonebrook Dr.	WB	2	6	6	36	4			4					
Mall Ent	Stonebrook Dr.	WB	1	2	2	4	1			1					
Mall Ent	Stonebrook Dr.	WB	2	2	2	4	1			1					
Mall Ent	Stonebrook Dr.	WB	2	3	25	75	8		8						
Mall Ent	Stonebrook Dr.	WB	1	3	50	150	17		17						
Mall Ent	Stonebrook Dr.	WB	2	3	50	150	17		17						
Mall Ent	Stonebrook Dr.	WB	3	3	50	150	17		17						
Mall Ent	Stonebrook Dr.	WB	1	3	130	390	43		43						
Mall Ent	Stonebrook Dr.	WB	2	2	2	4	1			1					
Stonebrook Dr.	Brookside Dr	WB	1	6	6	36	4				4				
Stonebrook Dr.	Brookside Dr	WB	3	1	1	1	1				1				
Stonebrook Dr.	Brookside Dr	WB	3	1	1	1	1				1				
Stonebrook Dr.	Brookside Dr	WB	1	3	250	750	83		83						
Stonebrook Dr.	Brookside Dr	WB	3	2	4	8	1			1					
Stonebrook Dr.	Brookside Dr	WB	1	3	3	9	1			1					
Stonebrook Dr.	Brookside Dr	WB	2	2	2	4	1			1					
Stonebrook Dr.	Brookside Dr	WB	2	2	2	4	1			1					
Stonebrook Dr.	Brookside Dr	WB	2	2	3	6	1			1					
Stonebrook Dr.	Brookside Dr	WB	2	3	300	900	100		100						
Stonebrook Dr.	Brookside Dr	WB	3	1	1	1	1			1					

CONTINUED ON THE NEXT SHEET

FILE NAME =	USER NAME = wilgreendp	DESIGNED -	REVISED -	STATE OF ILLINOIS DEPARTMENT OF TRANSPORTATION	PATCHING SCHEDULE IL 132			F.A.P. RTE.	SECTION	COUNTY	TOTAL SHEETS	SHEET NO.			
at\proj\jobs\dl35008\design_ee.dgn		DRAWN -	REVISED -		SCALE:	SHEET NO.	OF	SHEETS	STA.	TO STA.	VAR.	2008-009 PP	LAKE	37	18
		CHECKED -	REVISED -		FED. ROAD DIST. NO. 1 ILLINOIS FED. AID PROJECT										
		DATE	REVISED -		CONTRACT NO. 60E35										

ROUTE: IL Rte 132 (US Rte 45 to I-94 Tollway)

CROSS STREETS		DIRECTION (EB/WB) (NB/SB)	LANE NO. (1, 2, 3)	PAVEMENT PATCH WIDTH	PAVEMENT PATCH LENGTH	REPAIR AREA (SQ FT)	REPAIR AREA (SQ YD)	HMA SURF REM 2-1/4" & RESURF	HMA SURF REM (SP) & RESURF	CLASS D PATCH TYPE I	CLASS D PATCH TYPE II	CLASS D PATCH TYPE III	CLASS D PATCH TYPE IV	PAVT MARKING 4"	RAISED REFL PAVT MKS
FROM	TO														
Stonebrook Dr.	Brookside Dr	WB	3	1	1	1	1			1					
Brookside Dr	Bridlewood Ave.	WB	1	6	20	120	13				13				
Brookside Dr	Bridlewood Ave.	WB	2	1	1	1	1			1					
Brookside Dr	Bridlewood Ave.	WB	2	1	1	1	1			1					
Brookside Dr	Bridlewood Ave.	WB	2	1	1	1	1			1					
Brookside Dr	Bridlewood Ave.	WB	1	3	1	3	1			1					
Brookside Dr	Bridlewood Ave.	WB	1	3	25	75	8				8				
Brookside Dr	Bridlewood Ave.	WB	1	1	1	1	1			1					
Brookside Dr	Bridlewood Ave.	WB	3	3	25	75	8				8				
Brookside Dr	Bridlewood Ave.	WB	2	3	100	300	33		33						
Brookside Dr	Bridlewood Ave.	WB	LT TL	3	50	150	17		17						
Brookside Dr	Bridlewood Ave.	WB	1	3	50	150	17		17						
Bridlewood Ave.	Hutchins Rd	WB	1	1	4	4	1			1					
Bridlewood Ave.	Hutchins Rd	WB	2	3	100	300	33		33						
Bridlewood Ave.	Hutchins Rd	WB	1	3	3	9	1			1					
Bridlewood Ave.	Hutchins Rd	WB	1	12	12	144	16					16			
Bridlewood Ave.	Hutchins Rd	WB	2	12	20	240	27						27		
Bridlewood Ave.	Hutchins Rd	WB	2	3	120	360	40		40						
Bridlewood Ave.	Hutchins Rd	WB	1	3	20	60	7			7					
Bridlewood Ave.	Hutchins Rd	WB	1	3	6	18	2			2					
Bridlewood Ave.	Hutchins Rd	WB	1	3	3	9	1			1					
Bridlewood Ave.	Hutchins Rd	WB	2	3	300	900	100		100						
Bridlewood Ave.	Hutchins Rd	WB	2	2	2	4	1			1					
Bridlewood Ave.	Hutchins Rd	WB	LT TL	3	3	9	1			1					
Bridlewood Ave.	Hutchins Rd	WB	LT TL	2	2	4	1			1					
Bridlewood Ave.	Hutchins Rd	WB	LT TL	3	3	9	1			1					
Bridlewood Ave.	Hutchins Rd	WB	LT TL	3	125	375	42		42						
Bridlewood Ave.	Hutchins Rd	WB	1	3	100	300	33		33						
Hutchins Rd	Grandwood Dr	WB	1	2	4	8	1			1					
Hutchins Rd	Grandwood Dr	WB	1	2	2	4	1			1					
Hutchins Rd	Grandwood Dr	WB	1	2	2	4	1			1					
Hutchins Rd	Grandwood Dr	WB	1	3	75	225	25		25						
Hutchins Rd	Grandwood Dr	WB	1	6	12	72	8				8				
Hutchins Rd	Grandwood Dr	WB	2	6	20	120	13				13				
Hutchins Rd	Grandwood Dr	WB	2	8	35	280	31					31			
Hutchins Rd	Grandwood Dr	WB	1	6	12	72	8				8				
Hutchins Rd	Grandwood Dr	WB	1	6	12	72	8				8				
Hutchins Rd	Grandwood Dr	WB	2	6	12	72	8				8				
Hutchins Rd	Grandwood Dr	WB	2	3	300	900	100		100						
Hutchins Rd	Grandwood Dr	WB	1	3	100	300	33		33						
Hutchins Rd	Grandwood Dr	WB	2	6	12	72	8				8				
Hutchins Rd	Grandwood Dr	WB	1	1	1	1	1			1					
Hutchins Rd	Grandwood Dr	WB	1	1	1	1	1			1					
Hutchins Rd	Grandwood Dr	WB	1	3	3	9	1			1					
Hutchins Rd	Grandwood Dr	WB	1	3	75	225	25		25						
Hutchins Rd	Grandwood Dr	WB	RT TL	3	3	9	1			1					
Grandwood Dr	Oakwood Dr	WB	2	6	10	60	7				7				
Grandwood Dr	Oakwood Dr	WB	2	12	12	144	16					16			
Oakwood Dr	Rte 45	WB	1	3	15	45	5				5				
Oakwood Dr	Rte 46	WB	2	3	20	60	7				7				
Oakwood Dr	Rte 47	WB	1	3	200	600	67		67						
Oakwood Dr	Rte 48	WB	2	3	20	60	7				7				
Oakwood Dr	Rte 49	WB	2	3	20	60	7				7				
Oakwood Dr	Rte 50	WB	1	3	6	18	2			2					
Oakwood Dr	Rte 51	WB	1	3	30	90	10				10				
Oakwood Dr	Rte 52	WB	2	3	30	90	10				10				
Oakwood Dr	Rte 53	WB	2	3	50	150	17					17			
Oakwood Dr	Rte 54	WB	2	3	100	300	33		33						
Oakwood Dr	Rte 55	WB	2	3	3	9	1			1					
Oakwood Dr	Rte 56	WB	1	12	6	72	8				8				
Oakwood Dr	Rte 57	WB	2	12	6	72	8				8				
Oakwood Dr	Rte 58	WB	2	3	50	150	17					17			
Oakwood Dr	Rte 59	WB	2	3	200	600	67		67						
Oakwood Dr	Rte 60	WB	LT TL	12	50	600	67	67							
Oakwood Dr	Rte 61	WB	LT TL	12	25	300	33						33		
Oakwood Dr	Rte 62	WB	LT TL	3	12	36	4			4					

TOTALS: 1034 SY 5068 SY 189 SY 456 SY 239 SY 533 SY 7200 FT 300 EACH

FILE NAME = c:\projects\dl35008\design_aa.dgn
 USER NAME = wlgreendp
 PLOT SCALE = 100.0000' / IN.
 PLOT DATE = 4/10/2008

DESIGNED -	REVISED -
DRAWN -	REVISED -
CHECKED -	REVISED -
DATE -	REVISED -

**STATE OF ILLINOIS
DEPARTMENT OF TRANSPORTATION**

PATCHING SCHEDULE			
IL 132			
SCALE:	SHEET NO.	OF SHEETS	STA. TO STA.

F.A.P. RTE. VAR.	SECTION 2008-009 PP	COUNTY LAKE	TOTAL SHEETS 37	SHEET NO. 19
CONTRACT NO. 60E35				
FED. ROAD DIST. NO. 1 ILLINOIS FED. AID PROJECT				

ROUTE: IL RTE 137 (IL. 83 TO IL RTE 21)

CROSS STREETS		DIRECTION (EB/WB) (NB/SB)	LANE NO. (1, 2, 3)	PAVEMENT PATCH WIDTH	PAVEMENT PATCH LENGTH	REPAIR AREA (SQ FT)	REPAIR AREA (SQ YD)	HMA SURF REM 2-1/4" & RESURF	HMA SURF REM (SP) & RESURF	CLASS D PATCH TYPE I	CLASS D PATCH TYPE II	CLASS D PATCH TYPE III	CLASS D PATCH TYPE IV	PAVT MARKING 4"	RAISED REFL PAVT MKS		
FROM	TO																
IL 83		EB	1	12	4	48	5				5						
		EB	1	12	6	72	8				8						
		WB	1	12	6	72	8				8						
		C/L	C/L	2	100	150	17		17								
		C/L	C/L	2	100	150	17		17								
		C/L	C/L	2	100	150	17		17								
		CASEY ROAD	C/L	C/L	2	100	150	17		17							
	CASEY ROAD		EB	1	12	4	48	5				5					
			EB	1	12	4	48	5				5					
			EB	1	12	4	48	5				5					
			EB	1	12	6	72	8				8					
			EB	1	12	6	72	8				8					
		EB	1	12	6	72	8				8						
		EB	1	12	6	72	8				8						
		EB	1	12	6	72	8				8						
		EB	1	12	6	72	8				8						
		EB	1	12	6	72	8				8						
		EB	1	12	6	72	8				8						
		EB	1	12	6	72	8				8						
		EB	1	12	6	72	8				8						
		EB	1	12	6	72	8				8						
		EB	1	12	6	72	8				8						
		EB	1	12	6	72	8				8						
		EB	1	12	6	72	8				8						
		EB	1	12	6	72	8				8						
		EB	1	12	6	72	8				8						
		EB	1	12	6	72	8				8						
		EB	1	12	6	72	8				8						
		EB	1	12	6	72	8				8						
		EB	1	12	6	72	8				8						
		EB	1	12	6	72	8				8						
		EB	1	12	6	72	8				8						
		EB	1	12	10	120	13									13	
		EB	1	12	10	120	13									13	
		EB	1	12	10	120	13									13	
		EB	1	12	10	120	13									13	
		EB	1	12	10	120	13									13	
		EB	1	12	10	120	13									13	
		EB	1	12	10	120	13									13	
		EB	1	12	10	120	13									13	
		EB	2	12	4	48	5					5					
		EB	2	12	4	48	5					5					
		EB	2	12	4	48	5					5					
	EB	2	12	6	72	8					8						
	EB	2	12	6	72	8					8						
	EB	2	12	6	72	8					8						
	EB	2	12	6	72	8					8						
	EB	2	12	6	72	8					8						
	EB	2	12	6	72	8					8						
	EB	2	12	6	72	8					8						
	EB	2	12	6	72	8					8						
	EB	2	12	6	72	8					8						
	EB	2	12	6	72	8					8						
	EB	2	12	10	120	13					13						
	WB	1	12	4	48	5					5						
	WB	1	12	4	48	5					5						
	WB	1	12	4	48	5					5						
	WB	1	12	6	72	8					8						
	WB	1	12	6	72	8					8						
	WB	1	12	6	72	8					8						
	WB	1	12	6	72	8					8						
	WB	1	12	6	72	8					8						
	WB	1	12	6	72	8					8						
	WB	1	12	6	72	8					8						
	WB	1	12	6	72	8					8						
	WB	1	12	6	72	8					8						
	WB	1	12	6	72	8					8						
	WB	1	12	6	72	8					8						
	WB	1	12	6	72	8					8						

CONTINUED ON THE NEXT SHEET

FILE NAME = c:\projects\dl36000\design_aa.dgn	USER NAME = wjgreendp	DESIGNED -	REVISED -	STATE OF ILLINOIS DEPARTMENT OF TRANSPORTATION	PATCHING SCHEDULE IL 137		SCALE:	SHEET NO.	OF	SHEETS	STA.	TO STA.	F.A.P.	SECTION	COUNTY	TOTAL	SHEET
		DRAWN -	REVISED -										VAR.	2008-009 PP	LAKE	37	20
	PLOT SCALE = 100.0000 ' / IN.	CHECKED -	REVISED -			CONTRACT NO. 60E35											
	PLOT DATE = 4/18/2008	DATE -	REVISED -			FED. ROAD DIST. NO. 1 ILLINOIS FED. AID PROJECT											

ROUTE: IL RTE 137 (IL 83 TO IL RTE 21)

GROSS STREETS		DIRECTION (EB/WB) (NB/SB)	LANE NO. (1, 2, 3)	PAVEMENT PATCH WIDTH	PAVEMENT PATCH LENGTH	REPAIR AREA (SQ FT)	REPAIR AREA (SQ YD)	HMA SURF REM 2-1/4" & RESURF	HMA SURF REM (SP) & RESURF	CLASS D PATCH TYPE I	CLASS D PATCH TYPE II	CLASS D PATCH TYPE III	CLASS D PATCH TYPE IV	PAVT MARKING 4"	RAISED REFL PAVT MKS
FROM	TO														
		WB	1	12	6	72	8				8				
		WB	1	12	6	72	8				8				
		WB	1	12	6	72	8				8				
		WB	1	12	6	72	8				8				
		WB	1	12	6	72	8				8				
		WB	1	12	6	72	8				8				
		WB	1	12	6	72	8				8				
		WB	1	12	6	72	8				8				
		WB	1	12	6	72	8				8				
		WB	1	12	6	72	8				8				
		WB	1	12	6	72	8				8				
		WB	1	12	6	72	8				8				
		WB	1	12	6	72	8				8				
		WB	1	12	6	72	8				8				
		WB	1	12	6	72	8				8				
		WB	1	12	6	72	8				8				
		WB	1	12	6	72	8				8				
		WB	1	12	6	72	8				8				
		WB	1	12	6	72	8				8				
		WB	1	12	6	72	8				8				
		WB	1	12	10	120	13				13				
		WB	1	12	10	120	13				13				
		WB	1	12	10	120	13				13				
		WB	1	12	10	120	13				13				
		WB	1	12	10	120	13				13				
		WB	1	12	10	120	13				13				
		WB	2	12	6	72	8				8				
		WB	2	12	6	72	8				8				
		WB	2	12	6	72	8				8				
		WB	2	12	6	72	8				8				
		WB	2	12	6	72	8				8				
		WB	2	12	6	72	8				8				
		WB	2	12	6	72	8				8				
		WB	2	12	6	72	8				8				
		WB	2	12	6	72	8				8				
		WB	2	12	6	72	8				8				
		WB	2	12	6	72	8				8				
		WB	2	12	6	72	8				8				
		WB	2	12	6	72	8				8				
		WB	2	12	6	72	8				8				
		WB	2	12	6	72	8				8				
		WB	2	12	6	72	8				8				
		WB	2	12	6	72	8				8				
		WB	2	12	6	72	8				8				
		WB	2	12	6	72	8				8				
		WB	2	12	6	72	8				8				
		WB	2	12	6	72	8				8				
		WB	2	12	10	120	13				13				
		WB	2	12	10	120	13				13				
		WB	2	12	10	120	13				13				
		WB	2	12	10	120	13				13				
		WB	2	12	10	120	13				13				
		WB	2	12	10	120	13				13				
		CL	CL	2	50	75	8		8						
		CL	CL	2	50	75	8		8						
		CL	CL	2	50	75	8		8						
		CL	CL	2	50	75	8		8						
		CL	CL	2	50	75	8		8						
		CL	CL	2	50	75	8		8						
		CL	CL	2	50	75	8		8						
		CL	CL	2	50	75	8		8						
		CL	CL	2	50	75	8		8						
		CL	CL	2	50	75	8		8						
		CL	CL	2	50	75	8		8						
		CL	CL	2	50	75	8		8						
		CL	CL	2	100	150	17		17						
		CL	CL	2	100	150	17		17						
		CL	CL	2	100	150	17		17						
		CL	CL	2	100	150	17		17						
		CL	CL	2	100	150	17		17						
		CL	CL	2	100	150	17		17						
		CL	CL	2	100	150	17		17						
		CL	CL	2	100	150	17		17						

CONTINUED ON THE NEXT SHEET

FILE NAME =	USER NAME = wlgrendp	DESIGNED -	REVISED -	STATE OF ILLINOIS DEPARTMENT OF TRANSPORTATION	PATCHING SCHEDULE IL 137				F.A.P. RTE.	SECTION	COUNTY	TOTAL SHEETS	SHEET NO.
ca:\projects\dl36008\design_oo.dgn		DRAWN -	REVISED -		SCALE:	SHEET NO.	OF	SHEETS	STA.	TO STA.	LAKE	37	21
PLOT SCALE = 100.0000' / IN.		CHECKED -	REVISED -		FED. ROAD DIST. NO. 1	ILLINOIS		FED. AID PROJECT	CONTRACT NO. 60E35				
PLOT DATE = 4/18/2008		DATE -	REVISED -										

ROUTE: IL RTE 137 (IL 83 TO IL RTE 21)

CROSS STREETS		DIRECTION (EB/WB) (NB/SB)	LANE NO. (1, 2, 3)	PAVEMENT PATCH WIDTH	PAVEMENT PATCH LENGTH	REPAIR AREA (SQ FT)	REPAIR AREA (SQ YD)	HMA SURF REM 2-1/4" & RESURF	HMA SURF REM (SP) & RESURF	CLASS D PATCH TYPE I	CLASS D PATCH TYPE II	CLASS D PATCH TYPE III	CLASS D PATCH TYPE IV	PAVT MARKING 4"	RAISED REFL PAVT MKS
FROM	TO														
		WB	2	12	6	72	8				8				
		WB	2	12	6	72	8				8				
		WB	2	12	6	72	8				8				
		WB	2	12	6	72	8				8				
		WB	2	12	10	120	13				13				
		WB	2	12	10	120	13				13				
		WB	2	12	10	120	13				13				
		WB	2	12	10	120	13				13				
		CL	CL	2	50	75	8		8						
		CL	CL	2	50	75	8		8						
		CL	CL	2	50	75	8		8						
		CL	CL	2	50	75	8		8						
		CL	CL	2	50	75	8		8						
		CL	CL	2	50	75	8		8						
		CL	CL	2	50	75	8		8						
	IL RTE 21	CL	CL	2	200	300	33		33						
IL 137 (EAST OF PETERSON RD & US 45 TO IL 137 RAMPS)															
US RTE 45															
		EB	1	12	6	72	8				8				
		EB	1	12	6	72	8				8				
		EB	1	12	6	72	8				8				
		EB	1	12	6	72	8				8				
		EB	1	12	6	72	8				8				
		EB	1	12	6	72	8				8				
		EB	1	12	6	72	8				8				
		EB	1	12	6	72	8				8				
		EB	1	12	6	72	8				8				
		EB	1	12	6	72	8				8				
		EB	1	12	6	72	8				8				
		EB	1	12	6	72	8				8				
		EB	1	12	6	72	8				8				
		EB	1	12	6	72	8				8				
		EB	1	12	6	72	8				8				
		EB	1	12	6	72	8				8				
		WB	1	12	4	48	5				5				
		WB	1	12	4	48	5				5				
		WB	1	12	4	48	5				5				
		WB	1	12	6	72	8				8				
		WB	1	12	6	72	8				8				
		WB	1	12	6	72	8				8				
		WB	1	12	6	72	8				8				
		WB	1	12	6	72	8				8				
		WB	1	12	6	72	8				8				
		WB	1	12	6	72	8				8				
		WB	1	12	6	72	8				8				
		WB	1	12	6	72	8				8				
		WB	1	12	6	72	8				8				
		WB	1	12	6	72	8				8				
		WB	1	12	6	72	8				8				
		WB	1	12	6	72	8				8				
		WB	1	12	6	72	8				8				
		WB	1	6	40	240	27	27							
		CL	CL	2	50	75	8		8						
		CL	CL	2	50	75	8		8						
		CL	CL	2	50	75	8		8						
		CL	CL	2	100	150	17		17						
		CL	CL	2	100	150	17		17						
		CL	CL	2	100	150	17		17						
		CL	CL	2	200	300	33		33						
		CL	CL	2	200	300	33		33						
	IL RTE 137	CL	CL	2	200	300	33		33						

TOTALS: 27 SY 1284 SY 1577 SY 16500 FT 300 EACH

..project\dl136888\design_aa.dgn 4/19/2008 5:19:06 PM User=wjgreendp

ROUTE: IL Rte 137 (Wadsworth Rd to 33rd St)

CROSS STREETS		DIRECTION (EB/WB) (NB/SB)	LANE NO. (1, 2, 3)	PAVEMENT PATCH WIDTH	PAVEMENT PATCH LENGTH	REPAIR AREA (SQ FT)	REPAIR AREA (SQ YD)	HMA SURF REM 2-1/4" & RESURF	HMA SURF REM (SP) & RESURF	CLASS D PATCH TYPE I	CLASS D PATCH TYPE II	CLASS D PATCH TYPE III	CLASS D PATCH TYPE IV	PAVT MARKING 4"	RAISED REFL PAVT MKS
FROM	TO														
Wadsworth Rd	33rd St	NB	1	3	400	1200	133								
Wadsworth Rd	33rd St	NB	2	12	140	1680	187	187							
Wadsworth Rd	33rd St	NB	2	4	1	4	1			1					
Wadsworth Rd	33rd St	NB	1	3	100	300	33		33						
Wadsworth Rd	33rd St	NB	1	12	2	24	3			3					
Wadsworth Rd	33rd St	NB	2	12	2	24	3			3					
Wadsworth Rd	33rd St	NB	1	12	2	24	3			3					
Wadsworth Rd	33rd St	NB	2	12	2	24	3			3					
Wadsworth Rd	33rd St	NB	1	12	2	24	3			3					
Wadsworth Rd	33rd St	NB	2	12	2	24	3			3					
Wadsworth Rd	33rd St	NB	2	1	1	1	1			1					
Wadsworth Rd	33rd St	NB	2	1	1	1	1			1					
Wadsworth Rd	33rd St	NB	2	2	12	24	3			3					
Wadsworth Rd	33rd St	NB	1	3	50	150	17		17						
Wadsworth Rd	33rd St	NB	2	6	15	90	10				10				
Wadsworth Rd	33rd St	NB	2	4	4	16	2			2					
Wadsworth Rd	33rd St	NB	1	3	300	900	100		100						
Wadsworth Rd	33rd St	NB	2	2	2	4	1			1					
Wadsworth Rd	33rd St	NB	2	2	2	4	1			1					
Wadsworth Rd	33rd St	NB	2	2	3	6	1			1					
Wadsworth Rd	33rd St	NB	2	2	2	4	1			1					
Wadsworth Rd	33rd St	NB	2	2	2	4	1			1					
33rd St	Wadsworth Rd	SB	1	2	2	4	1			1					
33rd St	Wadsworth Rd	SB	2	4	2	8	1			1					
33rd St	Wadsworth Rd	SB	2	1	1	1	1			1					
33rd St	Wadsworth Rd	SB	1	3	50	150	17		17						
33rd St	Wadsworth Rd	SB	2	4	3	12	1			1					
33rd St	Wadsworth Rd	SB	2	1	2	2	1			1					
33rd St	Wadsworth Rd	SB	2	1	2	2	1			1					
33rd St	Wadsworth Rd	SB	2	2	4	8	1			1					
33rd St	Wadsworth Rd	SB	2	1	1	1	1			1					
33rd St	Wadsworth Rd	SB	1	3	200	600	67		67						
33rd St	Wadsworth Rd	SB	2	1	1	1	1			1					
33rd St	Wadsworth Rd	SB	2	1	1	1	1			1					
33rd St	Wadsworth Rd	SB	2	2	2	4	1			1					
33rd St	Wadsworth Rd	SB	2	2	6	12	1			1					
33rd St	Wadsworth Rd	SB	2	4	2	8	1			1					
33rd St	Wadsworth Rd	SB	1	3	50	150	17		17						
33rd St	Wadsworth Rd	SB	2	4	2	8	1			1					
33rd St	Wadsworth Rd	SB	1	1	2	2	1			1					
33rd St	Wadsworth Rd	SB	2	4	1	4	1			1					
33rd St	Wadsworth Rd	SB	1	4	2	8	1			1					
33rd St	Wadsworth Rd	SB	2	4	2	8	1			1					
33rd St	Wadsworth Rd	SB	1	4	3	12	1			1					
33rd St	Wadsworth Rd	SB	2	1	8	8	1			1					
33rd St	Wadsworth Rd	SB	1	12	2	24	3			3					
33rd St	Wadsworth Rd	SB	2	12	2	24	3			3					
33rd St	Wadsworth Rd	SB	1	12	2	24	3			3					
33rd St	Wadsworth Rd	SB	RT TL	6	6	36	4			4					
33rd St	Wadsworth Rd	SB	1	1	1	1	1			1					
33rd St	Wadsworth Rd	SB	1	12	2	24	3			3					
33rd St	Wadsworth Rd	SB	2	12	2	24	3			3					
33rd St	Wadsworth Rd	SB	2	12	2	24	3			3					
33rd St	Wadsworth Rd	SB	2	8	8	64	7				7				
33rd St	Wadsworth Rd	SB	2	8	8	64	7				7				
33rd St	Wadsworth Rd	SB	2	4	2	8	1			1					

TOTALS:

187 SY 384 SY 71 SY 24 SY 600 FT 12 EACH

FILE NAME = c:\projects\136008\design\design.dgn
PLOT SCALE = 1/8" = 1' / IN.
PLOT DATE = 4/18/2008

USER NAME = wlgrendp
DESIGNED -
DRAWN -
CHECKED -
DATE -
REVISED -
REVISED -
REVISED -
REVISED -

**STATE OF ILLINOIS
DEPARTMENT OF TRANSPORTATION**

**PATCHING SCHEDULE
IL 137**
SCALE: SHEET NO. OF SHEETS STA. TO STA.

F.A.P. RTE. SECTION COUNTY TOTAL SHEETS SHEET NO.
VAR. 2008-009 PP LAKE 37 24
CONTRACT NO. 60E35
FED. ROAD DIST. NO. 1 ILLINOIS FED. AID PROJECT

ROUTE: Frontage Rd (Old Plank Rd) (Will Ave. to Knight Ave.-Village of Park City)

CROSS STREETS		DIRECTION (EB/WB) (NB/SB)	LANE NO. (1, 2, 3)	PAVEMENT PATCH WIDTH	PAVEMENT PATCH LENGTH	REPAIR AREA (SQ FT)	REPAIR AREA (SQ YD)	HMA SURF REM 2-1/4" & RESURF	HMA SURF REM (SP) & RESURF	CLASS D PATCH TYPE I	CLASS D PATCH TYPE II	CLASS D PATCH TYPE III	CLASS D PATCH TYPE IV	PAVT MARKING 4"	RAISED REFL PAVT MKS
FROM	TO														
Will Ave	Koehmstedt Ave.	EB	1	12	4	48	5				5				
Will Ave	Koehmstedt Ave.	EB	1	12	3	36	4			4					
Will Ave	Koehmstedt Ave.	EB	1	12	2	24	3			3					
Will Ave	Koehmstedt Ave.	EB	1	12	2	24	3			3					
Will Ave	Koehmstedt Ave.	EB	1	12	2	24	3			3					
Will Ave	Koehmstedt Ave.	EB	1	12	4	48	5				5				
Will Ave	Koehmstedt Ave.	EB	1	12	3	36	4			4					
Will Ave	Koehmstedt Ave.	EB	1	12	4	48	5				5				
Will Ave	Koehmstedt Ave.	EB	1	12	3	36	4			4					
Will Ave	Koehmstedt Ave.	EB	1	12	2	24	3			3					
Will Ave	Koehmstedt Ave.	EB	1	12	3	36	4			4					
Will Ave	Koehmstedt Ave.	EB	1	12	2	24	3			3					
Will Ave	Koehmstedt Ave.	EB	1	12	3	36	4			4					
Will Ave	Koehmstedt Ave.	EB	1	12	3	36	4			4					
Koehmstedt Ave.	Teske Blvd	EB	1	12	3	36	4			4					
Koehmstedt Ave.	Teske Blvd	EB	1	12	3	36	4			4					
Koehmstedt Ave.	Teske Blvd	EB	1	12	4	48	5				5				
Koehmstedt Ave.	Teske Blvd	EB	1	12	4	48	5				5				
Koehmstedt Ave.	Teske Blvd	EB	1	12	2	24	3			3					
Koehmstedt Ave.	Teske Blvd	EB	1	12	3	36	4			4					
Koehmstedt Ave.	Teske Blvd	EB	1	12	2	24	3			3					
Koehmstedt Ave.	Teske Blvd	EB	1	12	2	24	3			3					
Koehmstedt Ave.	Teske Blvd	EB	1	12	2	24	3			3					
Koehmstedt Ave.	Teske Blvd	EB	1	12	1	12	1			1					
Koehmstedt Ave.	Teske Blvd	EB	1	12	3	36	4			4					
Koehmstedt Ave.	Teske Blvd	EB	1	12	2	24	3			3					
Teske Blvd	Knight Ave.	EB	1	12	1	12	1			1					
Teske Blvd	Knight Ave.	EB	1	12	1	12	1			1					
Teske Blvd	Knight Ave.	EB	1	12	1	12	1			1					
Teske Blvd	Knight Ave.	EB	1	12	1	12	1			1					
Teske Blvd	Knight Ave.	EB	1	12	1	12	1			1					
Teske Blvd	Knight Ave.	EB	1	12	1	12	1			1					
Teske Blvd	Knight Ave.	EB	1	12	2	24	3			3					
Teske Blvd	Knight Ave.	EB	1	12	3	36	4			4					
Teske Blvd	Knight Ave.	EB	1	12	2	24	3			3					
Teske Blvd	Knight Ave.	EB	1	12	3	36	4			4					
Teske Blvd	Knight Ave.	EB	1	12	3	36	4			4					
Teske Blvd	Knight Ave.	EB	1	12	10	120	13				13				
Teske Blvd	Knight Ave.	EB	1	4	4	16	2			2					
Teske Blvd	Knight Ave.	EB	1	4	4	16	2			2					
Teske Blvd	Knight Ave.	EB	1	4	4	16	2			2					
Teske Blvd	Knight Ave.	EB	1	4	4	16	2			2					
Knight Ave.	Teske Blvd	WB	1	12	3	36	4			4					
Knight Ave.	Teske Blvd	WB	1	12	3	36	4			4					
Knight Ave.	Teske Blvd	WB	1	12	6	72	8				8				
Knight Ave.	Teske Blvd	WB	1	12	3	36	4			4					
Knight Ave.	Teske Blvd	WB	1	12	3	36	4			4					
Knight Ave.	Teske Blvd	WB	1	12	3	36	4			4					
Knight Ave.	Teske Blvd	WB	1	12	2	24	3			3					
Knight Ave.	Teske Blvd	WB	1	12	3	36	4			4					
Knight Ave.	Teske Blvd	WB	1	12	1	12	1			1					
Knight Ave.	Teske Blvd	WB	1	12	1	12	1			1					
Knight Ave.	Teske Blvd	WB	1	12	2	24	3			3					
Knight Ave.	Teske Blvd	WB	1	3	3	9	1			1					
Knight Ave.	Teske Blvd	WB	1	12	3	36	4			4					
Knight Ave.	Teske Blvd	WB	1	12	12	144	16					16			
Knight Ave.	Teske Blvd	WB	1	12	1	12	1			1					
Knight Ave.	Teske Blvd	WB	1	2	2	4	0			1					

CONTINUED ON THE NEXT SHEET

FILE NAME =
c:\projects\136008\design_ee.dgn

USER NAME = wilgreendp
DESIGNED -
DRAWN -
PLOT SCALE = 100.0000' / IN.
PLOT DATE = 4/19/2008

CHECKED -
DATE -

REVISED -
REVISED -
REVISED -
REVISED -

**STATE OF ILLINOIS
DEPARTMENT OF TRANSPORTATION**

**PATCHING SCHEDULE
FRONTAGE RD. (OLD PLANK RD.)**
SCALE: SHEET NO. OF SHEETS STA. TO STA.

F.A.P. RTE.	SECTION	COUNTY	TOTAL SHEETS	SHEET NO.
VAR.	2008-009 PP	LAKE	37	25
FED. ROAD DIST. NO. 1 ILLINOIS FED. AID PROJECT			CONTRACT NO. 60E35	

ROUTE: Frontage Rd (Old Plank Rd) (Wil Ave. to Knight Ave.-Village of Park City)

CROSS STREETS		DIRECTION (EB/WB) (NB/SB)	LANE NO. (1, 2, 3)	PAVEMENT PATCH WIDTH	PAVEMENT PATCH LENGTH	REPAIR AREA (SQ FT)	REPAIR AREA (SQ YD)	HMA SURF REM 2-1/4" & RESURF	HMA SURF REM (SP) & RESURF	CLASS D PATCH TYPE I	CLASS D PATCH TYPE II	CLASS D PATCH TYPE III	CLASS D PATCH TYPE IV	PAVT MARKING 4"	RAISED REFL PAVT MKS
FROM	TO														
Knight Ave.	Teske Blvd	WB	1	12	1	12	1			1					
Knight Ave.	Teske Blvd	WB	1	12	1	12	1			1					
Knight Ave.	Teske Blvd	WB	1	12	2	24	3			3					
Knight Ave.	Teske Blvd	WB	1	12	3	36	4			4					
Teske Blvd	Koehmstedt Ave.	WB	1	3	1	3	0			1					
Teske Blvd	Koehmstedt Ave.	WB	1	12	1	12	1			1					
Teske Blvd	Koehmstedt Ave.	WB	1	12	1	12	1			1					
Teske Blvd	Koehmstedt Ave.	WB	1	12	4	48	5				5				
Teske Blvd	Koehmstedt Ave.	WB	1	12	4	48	5				5				
Teske Blvd	Koehmstedt Ave.	WB	1	12	3	36	4			4					
Teske Blvd	Koehmstedt Ave.	WB	1	12	4	48	5				5				
Koehmstedt Ave.	Wil Ave.	WB	1	12	3	36	4			4					
Koehmstedt Ave.	Wil Ave.	WB	1	4	2	8	1			1					
Koehmstedt Ave.	Wil Ave.	WB	1	12	3	36	4			4					
Koehmstedt Ave.	Wil Ave.	WB	1	12	2	24	3			3					
Koehmstedt Ave.	Wil Ave.	WB	1	12	1	12	1			1					
Koehmstedt Ave.	Wil Ave.	WB	1	12	4	48	5				5				
Koehmstedt Ave.	Wil Ave.	WB	1	12	3	36	4			4					
Koehmstedt Ave.	Wil Ave.	WB	1	12	2	24	3			3					
Koehmstedt Ave.	Wil Ave.	WB	1	12	2	24	3			3					
Koehmstedt Ave.	Wil Ave.	WB	1	12	3	36	4			4					
Koehmstedt Ave.	Wil Ave.	WB	1	12	3	36	4			4					
Koehmstedt Ave.	Wil Ave.	WB	1	12	4	48	5				5				
Koehmstedt Ave.	Wil Ave.	WB	1	12	4	48	5				5				
Koehmstedt Ave.	Wil Ave.	WB	1	12	2	24	3			3					
Koehmstedt Ave.	Wil Ave.	WB	1	12	3	36	4			4					
Koehmstedt Ave.	Wil Ave.	WB	1	12	4	48	5				5				
Koehmstedt Ave.	Wil Ave.	WB	1	12	4	48	5				5				
Koehmstedt Ave.	Wil Ave.	WB	1	12	2	24	3			3					
Koehmstedt Ave.	Wil Ave.	WB	1	12	3	36	4			4					
Koehmstedt Ave.	Wil Ave.	WB	1	12	4	48	5				5				
Longitudinal joint repair along centerline		EB	1	3	60	180	20		20						
Starting at Wil Ave., ending at Knight Ave.		EB	2	1	60	60	7				7				
Longitudinal joint repair along centerline		EB	3	1	60	60	7				7				
Longitudinal joint repair along centerline		EB	4	2	80	160	18		18						
Longitudinal joint repair along centerline		EB	5	4	100	350	39						39		
Longitudinal joint repair along centerline		EB	6	1	25	25	3			3					
Longitudinal joint repair along centerline		EB	7	4	30	120	13				13				
Longitudinal joint repair along centerline		EB	8	3	70	175	19		19						
Longitudinal joint repair along centerline		EB	9	4	25	100	11				11				
Longitudinal joint repair along centerline		EB	10	1	60	60	7				7				
Longitudinal joint repair along centerline		EB	11	2	10	20	2			2					
Longitudinal joint repair along centerline		EB	12	1	130	130	14				14				

TOTALS:

57 SY 215 SY 145 SY 16 SY 39 SY 400 FT 0 EACH

FILE NAME = c:\projects\dl36008\design_00.dgn

USER NAME = wilgreandp	DESIGNED -	REVISED -
	DRAWN -	REVISED -
PLOT SCALE = 100.0000' / IN.	CHECKED -	REVISED -
PLOT DATE = 4/10/2008	DATE -	REVISED -

STATE OF ILLINOIS
DEPARTMENT OF TRANSPORTATION

PATCHING SCHEDULE
FRONTAGE RD. (OLD PLANK RD.)

SCALE: SHEET NO. OF SHEETS STA. TO STA.

F.A.P. RTE. VAR.	SECTION 2008-009 PP	COUNTY LAKE	TOTAL SHEETS 37	SHEET NO. 26
CONTRACT NO. 60E35			FOR ROAD DIST. AND FURNISHMENT AND PROJECT	

ROUTE: Old Skokie Hwy (Wisc.State Line to I94 Tollway Ramp)

CROSS STREETS		DIRECTION (EB/WB) (NB/SB)	LANE NO. (1, 2, 3)	PAVEMENT PATCH WIDTH	PAVEMENT PATCH LENGTH	REPAIR AREA (SQ FT)	REPAIR AREA (SQ YD)	HMA SURF REM 2-1/4" & RESURF	HMA SURF REM (SP) & RESURF	CLASS D PATCH TYPE I	CLASS D PATCH TYPE II	CLASS D PATCH TYPE III	CLASS D PATCH TYPE IV	PAVT MARKING 4"	RAISED REFL PAVT MKS
FROM	TO														
Wisc. State Line	Russell Rd	SB	1	1	1	1	1			1					
Wisc. State Line	Russell Rd	SB	2	2	3	6	1			1					
Wisc. State Line	Russell Rd	SB	2	3	100	300	33		33						
Wisc. State Line	Russell Rd	SB	2	1	1	1	1			1					
Wisc. State Line	Russell Rd	SB	2	1	1	1	1			1					
Wisc. State Line	Russell Rd	SB	2	3	2	6	1			1					
Wisc. State Line	Russell Rd	SB	2	1	1	1	1			1					
Wisc. State Line	Russell Rd	SB	1	2	6	12	1			1					
Wisc. State Line	Russell Rd	SB	2	6	2	12	1			1					
Wisc. State Line	Russell Rd	SB	1	1	1	1	1			1					
Wisc. State Line	Russell Rd	SB	2	1	1	1	1			1					
Wisc. State Line	Russell Rd	SB	2	1	1	1	1			1					
Wisc. State Line	Russell Rd	SB	1	2	2	4	1			1					
Wisc. State Line	Russell Rd	SB	1	1	1	1	1			1					
Wisc. State Line	Russell Rd	SB	1	1	1	1	1			1					
Wisc. State Line	Russell Rd	SB	1	1	1	1	1			1					
Wisc. State Line	Russell Rd	SB	1	2	1	2	1			1					
Wisc. State Line	Russell Rd	SB	1	2	1	2	1			1					
Wisc. State Line	Russell Rd	SB	1	1	2	2	1			1					
Wisc. State Line	Russell Rd	SB	2	8	2	16	2			2					
Wisc. State Line	Russell Rd	SB	1	4	4	16	2			2					
Wisc. State Line	Russell Rd	SB	2	3	8	24	3			3					
Wisc. State Line	Russell Rd	SB	1	6	8	48	5				5				
Wisc. State Line	Russell Rd	SB	1	2	12	24	3			3					
Wisc. State Line	Russell Rd	SB	1	2	4	8	1			1					
Wisc. State Line	Russell Rd	SB	1	12	1	12	1			1					
Wisc. State Line	Russell Rd	SB	1	12	1	12	1			1					
Wisc. State Line	Russell Rd	SB	2	6	55	330	37	37							
Wisc. State Line	Russell Rd	SB	1	3	200	600	67		67						
Russell Rd	I94 Tollway Ramp	SB	1	6	6	36	4			4					
Russell Rd	I94 Tollway Ramp	SB	1	6	6	36	4			4					
Russell Rd	I94 Tollway Ramp	SB	1	2	2	4	1			1					
Russell Rd	I94 Tollway Ramp	SB	2	6	40	240	27	27							
Russell Rd	I94 Tollway Ramp	SB	1	6	20	120	13				13				
Russell Rd	I94 Tollway Ramp	SB	1	3	125	375	42		42						
Russell Rd	I94 Tollway Ramp	SB	1	3	125	375	42		42						
Russell Rd	I94 Tollway Ramp	SB	1	6	6	36	4			4					
Russell Rd	I94 Tollway Ramp	SB	1	6	2	12	1			1					
Russell Rd	I94 Tollway Ramp	SB	1	1	1	1	1			1					
Russell Rd	I94 Tollway Ramp	SB	2	1	1	1	1			1					
Russell Rd	I94 Tollway Ramp	SB	1	2	40	80	9		9						
Russell Rd	I94 Tollway Ramp	SB	1	12	1	12	1			1					
Russell Rd	I94 Tollway Ramp	SB	1	1	1	1	1			1					
Russell Rd	I94 Tollway Ramp	SB	1	1	1	1	1			1					
Russell Rd	I94 Tollway Ramp	SB	1	1	1	1	1			1					
Russell Rd	I94 Tollway Ramp	SB	1	1	1	1	1			1					
Russell Rd	I94 Tollway Ramp	SB	2	2	2	4	1			1					
Russell Rd	I94 Tollway Ramp	SB	1	2	4	8	1			1					
Russell Rd	I94 Tollway Ramp	SB	2	3	6	18	2			2					
Russell Rd	I94 Tollway Ramp	SB	2	7	15	105	12				12				
Russell Rd	I94 Tollway Ramp	SB	1	6	25	150	17					17			

CONTINUED ON THE NEXT SHEET

FILE NAME = c:\projects\136008\design_aa.dgn	USER NAME = wlgreendp	DESIGNED -	REVISED -	STATE OF ILLINOIS DEPARTMENT OF TRANSPORTATION	PATCHING SCHEDULE OLD SKOKIE HIGHWAY				F.A.P. RTE.	SECTION	COUNTY	TOTAL SHEETS	SHEET NO.
PLOT SCALE = 100.0000' / IN.	CHECKED -	REVISED -	REVISED -		SCALE:	SHEET NO.	OF	SHEETS	STA.	TO STA.	LAKE	37	27
PLOT DATE = 4/18/2008	DATE -	REVISED -	REVISED -		CONTRACT NO. 60E35								
FED. ROAD DIST. NO. 1 ILLINOIS FED. AID PROJECT													

ROUTE: Old Skokie Hwy (Wisc.State Line to I94 Tollway Ramp)

CROSS STREETS		DIRECTION (EB/WB) (NB/SB)	LANE NO. (1, 2, 3)	PAVEMENT PATCH WIDTH	PAVEMENT PATCH LENGTH	REPAIR AREA (SQ FT)	REPAIR AREA (SQ YD)	HMA SURF REM 2-1/4" & RESURF	HMA SURF REM (SP) & RESURF	CLASS D PATCH TYPE I	CLASS D PATCH TYPE II	CLASS D PATCH TYPE III	CLASS D PATCH TYPE IV	PAVT MARKING 4"	RAISED REFL PAVT MKS
FROM	TO														
I94 Tollway Ramp	Russell Rd.	NB	1	1	1	1	1			1					
I94 Tollway Ramp	Russell Rd.	NB	1	1	1	1	1			1					
I94 Tollway Ramp	Russell Rd.	NB	1	2	2	4	1			1					
I94 Tollway Ramp	Russell Rd.	NB	1	1	1	1	1			1					
I94 Tollway Ramp	Russell Rd.	NB	2	4	24	96	11				11				
I94 Tollway Ramp	Russell Rd.	NB	2	2	36	72	8		8						
I94 Tollway Ramp	Russell Rd.	NB	1	2	12	24	3			3					
I94 Tollway Ramp	Russell Rd.	NB	2	2	2	4	1			1					
I94 Tollway Ramp	Russell Rd.	NB	2	1	1	1	1			1					
I94 Tollway Ramp	Russell Rd.	NB	1	1	1	1	0			1					
I94 Tollway Ramp	Russell Rd.	NB	1	1	1	1	0			1					
I94 Tollway Ramp	Russell Rd.	NB	1	3	100	300	33		33						
I94 Tollway Ramp	Russell Rd.	NB	1	12	2	24	3			3					
I94 Tollway Ramp	Russell Rd.	NB	2	12	3	36	4			4					
I94 Tollway Ramp	Russell Rd.	NB	2	2	2	4	1			1					
Russell Rd.	Wisc. State Line	NB	2	1	1	1	1			1					
Russell Rd.	Wisc. State Line	NB	2	1	1	1	1			1					
Russell Rd.	Wisc. State Line	NB	2	1	1	1	1			1					
Russell Rd.	Wisc. State Line	NB	2	2	6	12	1			1					
Russell Rd.	Wisc. State Line	NB	2	3	6	18	2			2					
Russell Rd.	Wisc. State Line	NB	1	12	3	36	4			4					
Russell Rd.	Wisc. State Line	NB	1	12	6	72	8				8				
Russell Rd.	Wisc. State Line	NB	2	2	2	4	1			1					
Russell Rd.	Wisc. State Line	NB	2	6	6	36	4			4					
Russell Rd.	Wisc. State Line	NB	1	1	2	2	1			1					
Russell Rd.	Wisc. State Line	NB	1	1	1	1	1			1					
Russell Rd.	Wisc. State Line	NB	1	1	1	1	1			1					
Russell Rd.	Wisc. State Line	NB	1	1	1	1	1			1					
Russell Rd.	Wisc. State Line	NB	2	1	1	1	1			1					

TOTALS:

64 SY 234 SY 95 SY 49 SY 17 SY 430 FT 22 EACH

ROUTE: SHERRIDAN ROAD: From Amstutz Expressway to 22ND STREET IN North Chicago

CROSS STREETS		DIRECTION (EB/WB) (NB/SB)	LANE NO. (1, 2, 3)	PAVEMENT PATCH WIDTH	PAVEMENT PATCH LENGTH	REPAIR AREA (SQ FT)	REPAIR AREA (SQ YD)	HMA SURF REM 2-1/4" & RESURF	HMA SURF REM (SP) & RESURF	CLASS D PATCH TYPE I	CLASS D PATCH TYPE II	CLASS D PATCH TYPE III	CLASS D PATCH TYPE IV	PAVT MARKING 4"	RAISED REFL PAVT MKS
FROM	TO														
		NB & SB													
Two lanes in each direction separated barrier wall median															
SB LANES SIX PATCHES TYPE II =72 SQ YD															
NB LANES PATCHES TYPE II (7Patches)=79 SQ YD															
TYPE III PATCHES (TWO)=37SQ YD															
TOTAL LENGTH=0.8MILE															
MILLING & RESURFACING AREA = 25344 SQ YD															

TOTALS:

25344
SY

151
SY

37
SY

850
FT

42
EACH

ROUTE: 22ND STREET (MARTIN LUTHER KING DRIVE)

CROSS STREETS		DIRECTION (EB/WB) (NB/SB)	LANE NO. (1, 2, 3)	PAVEMENT PATCH WIDTH	PAVEMENT PATCH LENGTH	REPAIR AREA (SQ FT)	REPAIR AREA (SQ YD)	HMA SURF REM 2-1/4" & RESURF	HMA SURF REM (SP) & RESURF	CLASS D PATCH TYPE I	CLASS D PATCH TYPE II	CLASS D PATCH TYPE III	CLASS D PATCH TYPE IV	PAVT MARKING 4"	RAISED REFL PAVT MKS
FROM	TO														
RTE 131 (Greenbay Rd)	W. of Sherridan Road														
			TYPE II PATCHES	342 sq yd											
			TYPE III	=172SQ YD											

TOTALS:

342 172
SY SY
100 10
FT EACH

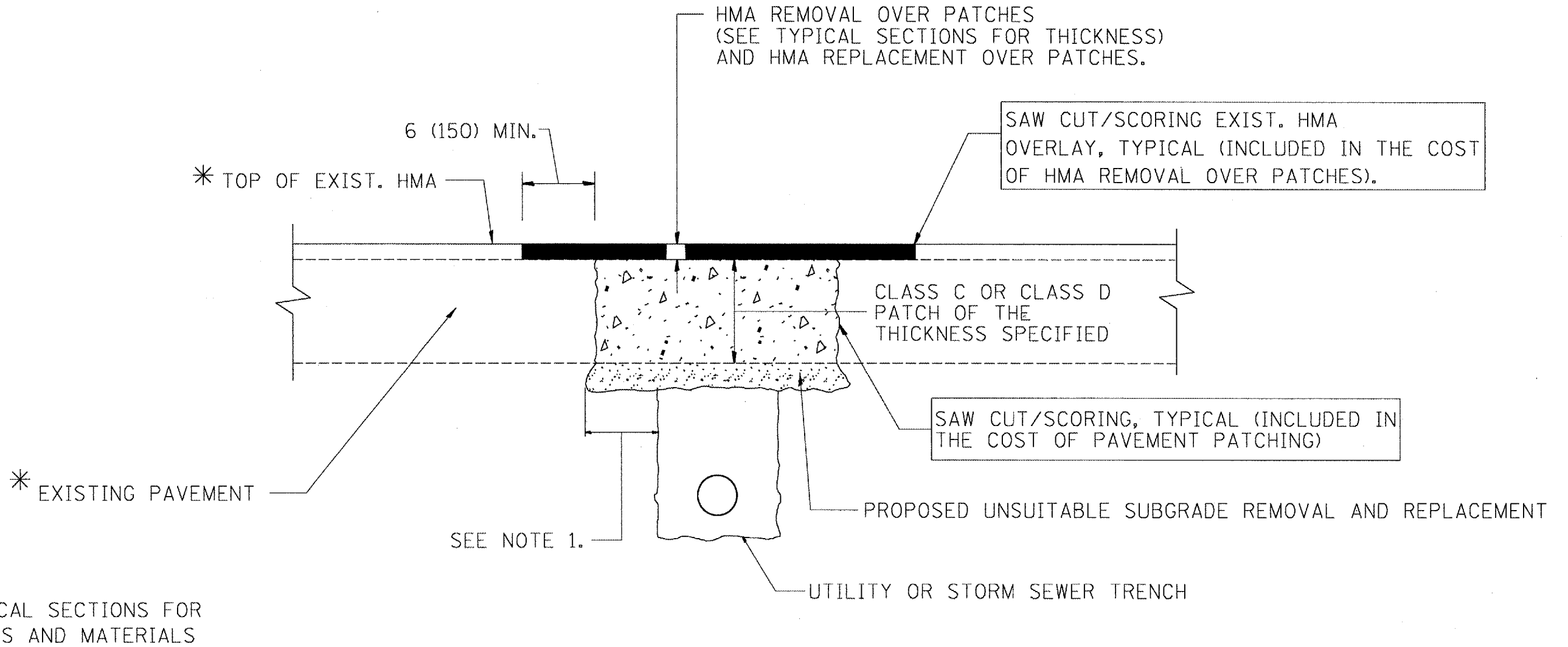

NOTES:

1. THE WIDTH OF THE FULL DEPTH PATCH OVER A TRENCH SHALL BE 12 (300) WIDER ON EACH SIDE OF THE TRENCH.
2. FOR METHOD OF MEASUREMENT AND BASIS OF PAYMENT, SEE RECURRING SPECIAL PROVISION "PATCHING WITH HOT-MIX ASPHALT OVERLAY REMOVAL".
3. THE TOP 1 1/2 INCHES OF PROPOSED HOT-MIX ASPHALT REPLACEMENT OVER PATCHES SHALL BE HOT-MIX ASPHALT SURFACE COURSE, MIX "D", N70. THE COST SHALL BE INCLUDED IN THE COST OF THE PAY ITEM FOR HOT-MIX ASPHALT REPLACEMENT OVER PATCHES.

SEQUENCE OF CONSTRUCTION

1. REMOVE THE EXISTING HMA MATERIAL OVER THE AREA TO BE PATCHED.
2. REMOVE AND REPLACE FULL DEPTH PATCHES
3. REPLACE HMA MATERIAL OVER THE AREA TO BE PATCHED.

ALL DIMENSIONS ARE IN INCHES (MILLIMETERS) UNLESS OTHERWISE SHOWN.

FILE NAME =	USER NAME = wlgreendp	DESIGNED - R. SHAH	REVISED - A. ABBAS 01-20-98	STATE OF ILLINOIS DEPARTMENT OF TRANSPORTATION	SPECIAL DETAIL PAVEMENT PATCHING FOR HMA SURFACED PAVEMENT			F.A. RTE.	SECTION	COUNTY	TOTAL SHEETS	SHEET NO.	
\\dist\inf2\users\wlgreendp\Desktop\bd22.dgn		DRAWN -	REVISED - A. ABBAS 04-27-98		SCALE: NONE	SHEET NO. 1 OF 1 SHEETS	STA.	TO STA.	VAR.	2008-009 PP	LAKE	37	37
PLT SCALE = 100.0000 "/ IN.		CHECKED -	REVISED - R. BORO 01-01-07					BD400-04 (BD-22)		CONTRACT NO. 60E35			
PLT DATE = 4/18/2008		DATE - 10-25-94	REVISED - R. BORO 09-04-07				FED. ROAD DIST. NO. 1 ILLINOIS FED. AID PROJECT						

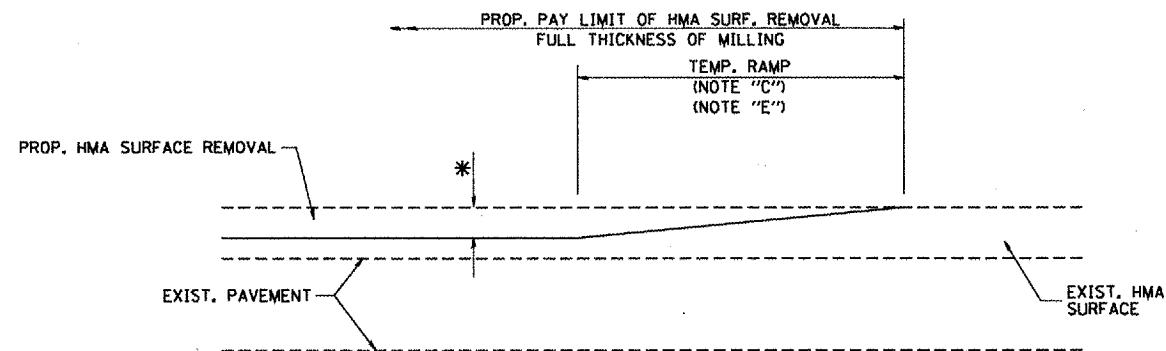

MILLED TEMPORARY RAMP
(FOR BUTT JOINT AND HMA TAPER SEE DETAIL BELOW)

OPTION 1

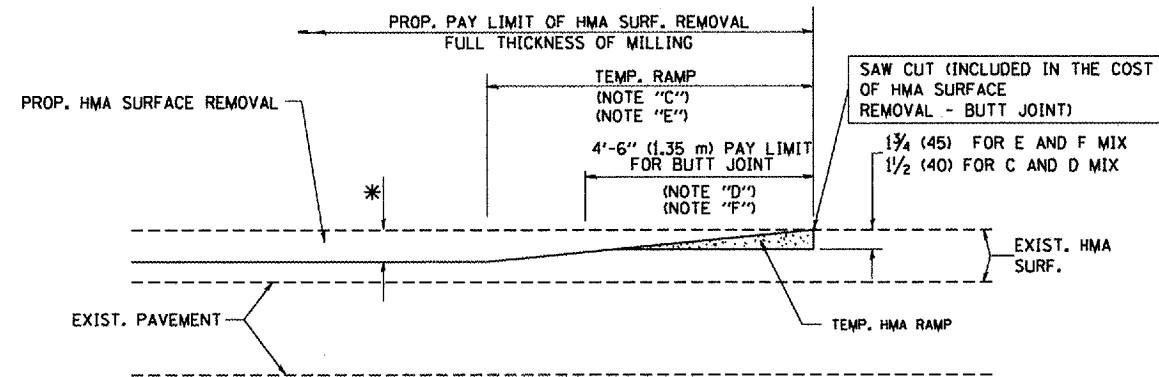

HMA CONSTRUCTED TEMPORARY RAMP
(FOR BUTT JOINT AND HMA TAPER SEE DETAIL BELOW)

OPTION 2

TYPICAL TEMPORARY RAMP

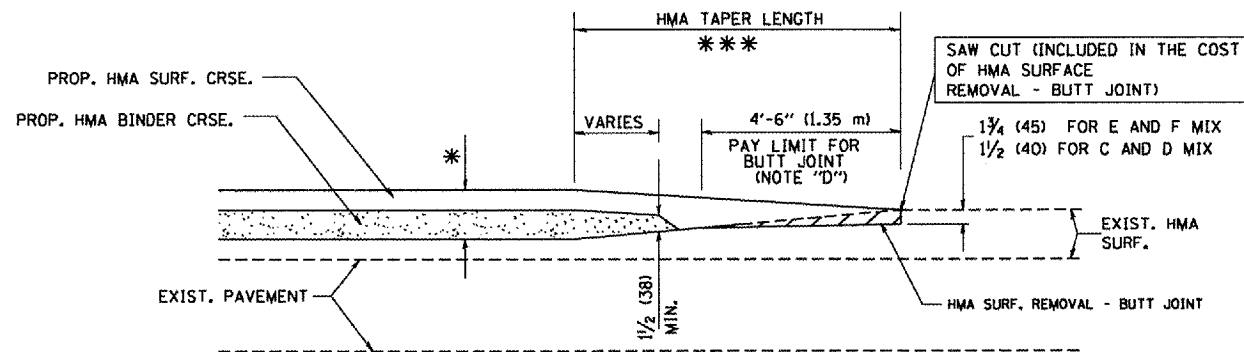

BUTT JOINT AND
HMA TAPER

TYPICAL BUTT JOINT AND HMA TAPER
FOR MILLING AND RESURFACING

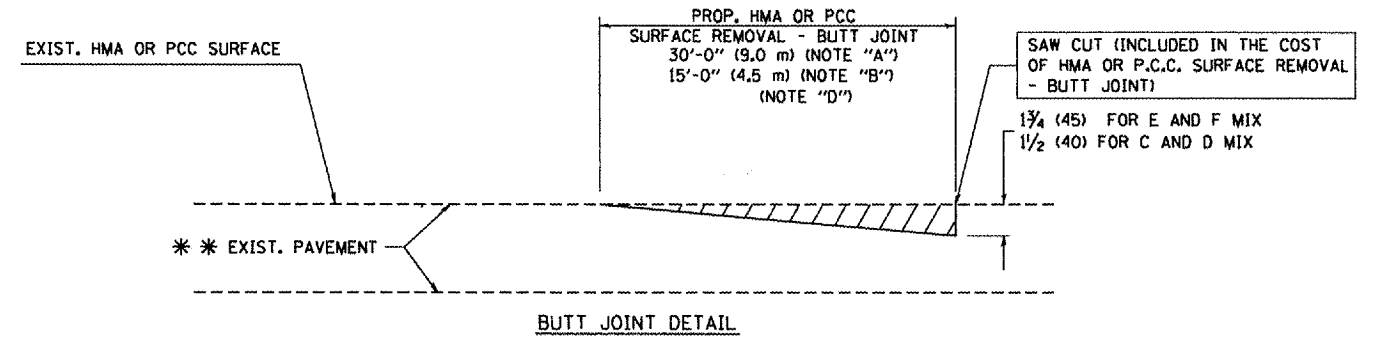

BUTT JOINT DETAIL

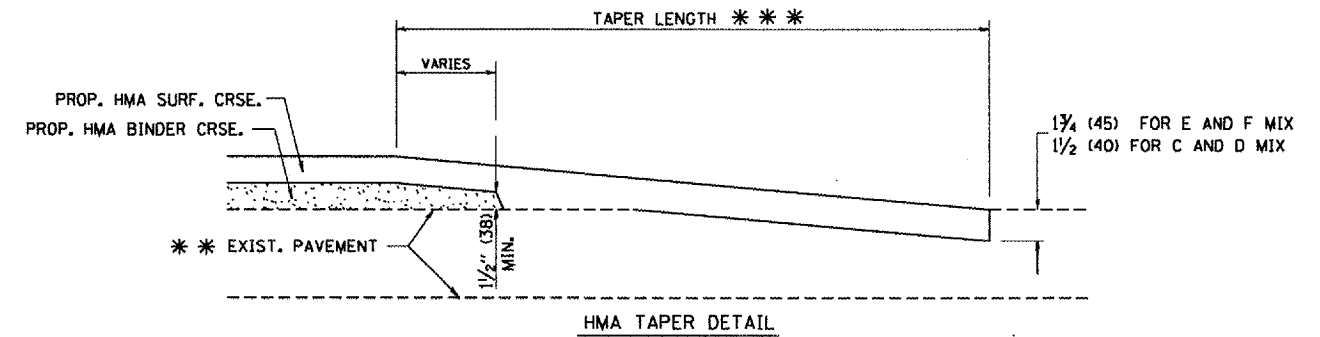

HMA TAPER DETAIL

TYPICAL BUTT JOINT AND HMA TAPER
FOR RESURFACING ONLY

*** PC CONCRETE, HMA OR HMA RESURFACED PAVEMENT.

NOTES

- A: MAINLINE ROADWAYS AND MAJOR SIDE ROADS.
- B: MINOR SIDE ROADS.
- C: THE TEMP. RAMP SHALL BE CONSTRUCTED IMMEDIATELY UPON REMOVAL OF THE EXISTING HMA SURFACE.
- D: THE BUTT JOINT SHALL BE CONSTRUCTED IMMEDIATELY PRIOR TO PLACING THE PROPOSED HMA COURSES.
- E: TAPER THE TEMP. RAMP AT A RATE OF 3'-0" (900 mm) PER 1 INCH (25 mm) OF MILLING THICKNESS.
- F: INSTALLATION AND REMOVAL OF THE 4'-6" (1.35 m) TEMP. RAMP IS INCLUDED IN COST OF HMA SURFACE REMOVAL - BUTT JOINT
- G: SEE ARTICLE 406.08 AND 406.14 OF THE STANDARD SPECIFICATIONS FOR "HMA AND/OR PCC SURFACE REMOVAL, BUTT JOINT".
- * SEE TYPICAL SECTIONS FOR MILLING THICKNESS.
- *** 20'-0" (6.1 m) PER 1 (25) RESURFACING (NOTE "A")
10'-0" (3.0 m) PER 1 (25) RESURFACING (NOTE "B")

BASIS OF PAYMENT:

THE BUTT JOINT WILL BE PAID FOR AT THE CONTRACT UNIT PRICE PER SQUARE YARD (SQUARE METER) FOR "HOT-MIX ASPHALT SURFACE REMOVAL - BUTT JOINT" OR FOR "PORTLAND CEMENT CONCRETE SURFACE REMOVAL - BUTT JOINT".

ALL DIMENSIONS ARE IN INCHES (MILLIMETERS) UNLESS OTHERWISE SHOWN.

FILE NAME = W:\d1statd\22x34\bd32.dgn	USER NAME = gaglianob	DESIGNED - M. DE YONG	REVISED - R. SHAH 10-25-94
		DRAWN -	REVISED - A. ABBAS 03-21-97
	PLOT SCALE = 50.0000 "/ IN.	CHECKED -	REVISED - M. GOMEZ 04-06-01
	PLOT DATE = 1/4/2008	DATE - 06-13-90	REVISED - R. BORO 01-01-07

STATE OF ILLINOIS
DEPARTMENT OF TRANSPORTATION

BUTT JOINT AND HMA TAPER DETAILS		F.A. RTE.	SECTION	COUNTY	TOTAL SHEETS	SHEET NO.
SCALE: NONE	SHEET NO. 1 OF 1 SHEETS	STA.	TO STA.	VAR 2008-009 PP	LAKE 37	32
				BD400-05 BD32	CONTRACT NO. 60E35	
FED. ROAD DIST. NO. 1 (ILLINOIS) FED. AID PROJECT						

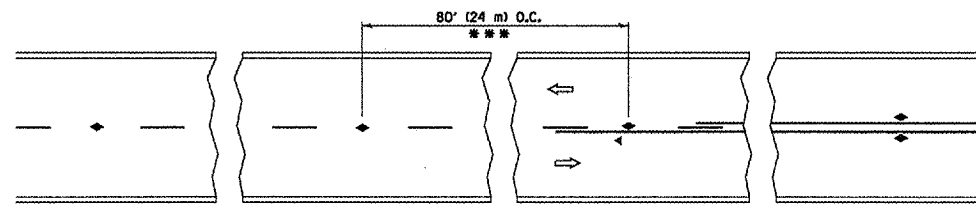

*** REDUCE TO 40' (12 m) O.C. ON CURVES WITH POSTED OR ADVISORY SPEED 45 M.P.H. (70 km/h) OR LESS.

TWO-LANE/TWO-WAY

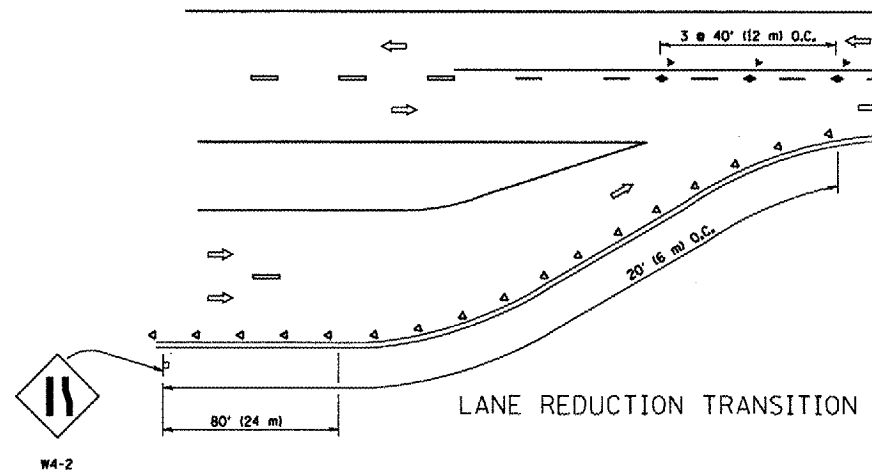

LANE REDUCTION TRANSITION

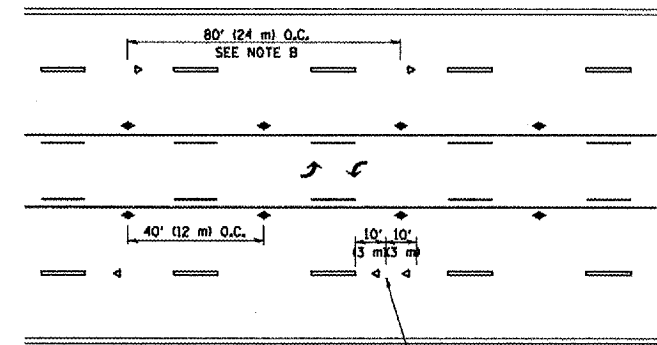

TWO-WAY LEFT TURN

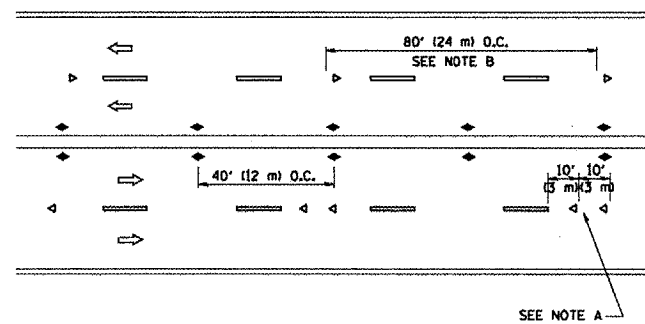

MULTI-LANE/UNDIVIDED

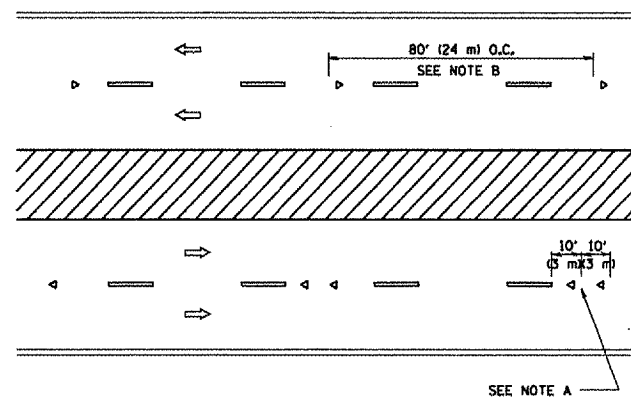

MULTI-LANE/DIVIDED

GENERAL NOTES

1. MARKERS USED WITH DASHED LINES SHALL BE CENTERED IN THE GAP BETWEEN SEGMENTS.
2. MARKERS USED ADJACENT TO SOLID LINES SHALL BE OFFSET 2 TO 3 (50 TO 75) TOWARD TRAFFIC AS SHOWN.
3. MARKERS THROUGH TANGENTS LESS THAN 500' (150 m) IN LENGTH BETWEEN CURVES SHALL BE INSTALLED AT THE LESSER OF THE TWO CURVE SPACINGS.

SYMBOLS

- YELLOW STRIPE
- WHITE STRIPE
- ◄ ONE-WAY AMBER MARKER
- ◄ ONE-WAY CRYSTAL MARKER (W/O)
- ◄ TWO-WAY AMBER MARKER

LANE MARKER NOTES

- B. REDUCE TO 40' (12 m) O.C. ON CURVES WHERE ADVISORY SPEEDS ARE 10 M.P.H. (20 km/h) LOWER THAN POSTED SPEEDS.
- A. USE DOUBLE LANE LINE MARKERS SPACED AS SHOWN.

DESIGN NOTES

1. DOUBLE LANE LINE MARKERS SHALL BE USED UNLESS SPECIFIED OTHERWISE.
2. EXCEPT AS SHOWN ON THE LANE REDUCTION TRANSITION AND FREEWAY EXIT RAMP DETAIL, MARKERS ARE NOT TO BE SPECIFIED ON RIGHT EDGE LINES.
3. THE EXACT MARKER LIMITS, SPACING, AND COLOR SHOULD BE INCLUDED IN THE PLANS.
4. MARKERS SHOULD NOT BE USED ALONGSIDE CURBS EXCEPT FOR EXTREMELY SHORT SECTIONS OF CURBS WHERE NOT MORE THAN TWO MARKERS WOULD BE INVOLVED.

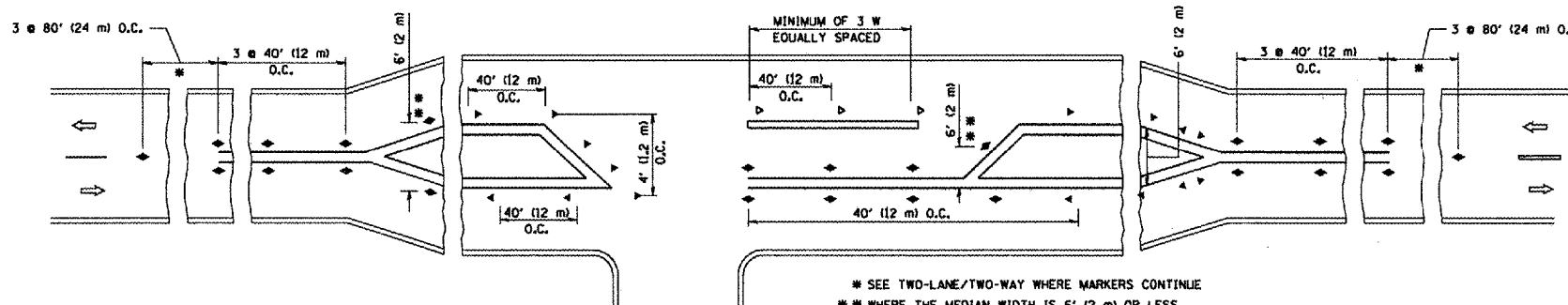

LEFT TURN

* SEE TWO-LANE/TWO-WAY WHERE MARKERS CONTINUE
 ** WHERE THE MEDIAN WIDTH IS 6' (1.2 m) OR LESS USE TWO-WAY MARKERS.

All dimensions are in inches (millimeters) unless otherwise shown.

FILE NAME = M:\distsat\22x34\coll.dgn	USER NAME = goglianob	DESIGNED -	REVISED - T. RAMMACHER 09-19-94
		DRAWN -	REVISED - T. RAMMACHER 03-12-99
	PLOT SCALE = 50,000 / IN.	CHECKED -	REVISED - T. RAMMACHER 01-06-00
	PLOT DATE = 1/4/2008	DATE -	REVISED -

STATE OF ILLINOIS
 DEPARTMENT OF TRANSPORTATION

TYPICAL APPLICATIONS		F.A. RTE.	SECTION	COUNTY	TOTAL SHEETS	SHEET NO.
RAISED REFLECTIVE PAVEMENT MARKERS (SNOW-PLow RESISTANT)		VAR	2008-009 PP	LAKE	37	33
SCALE: NONE	SHEET NO. 1 OF 1 SHEETS	STA.	TO STA.	CONTRACT NO. 60E33		
FED. ROAD DIST. NO. 1 (ILLINOIS) FED. AID PROJECT						

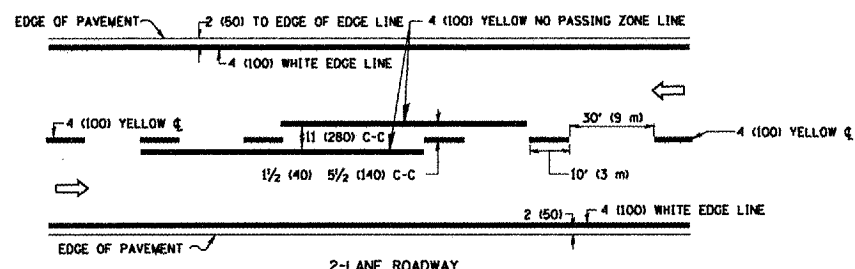

2-LANE ROADWAY

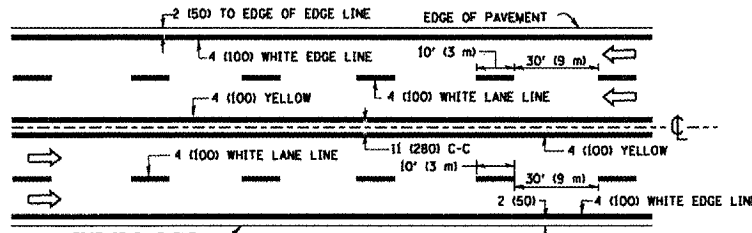

MULTI-LANE UNDIVIDED

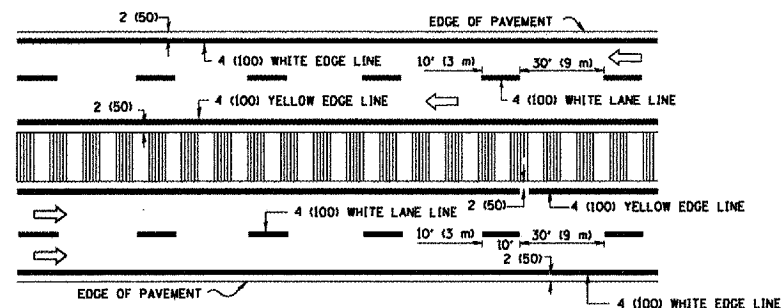

MULTI-LANE DIVIDED WITH MOUNTABLE MEDIAN

NOTE: MEDIANS WITH BARRIER CURB DO NOT REQUIRE AN EDGE LINE

TYPICAL LANE AND EDGE LINE MARKING

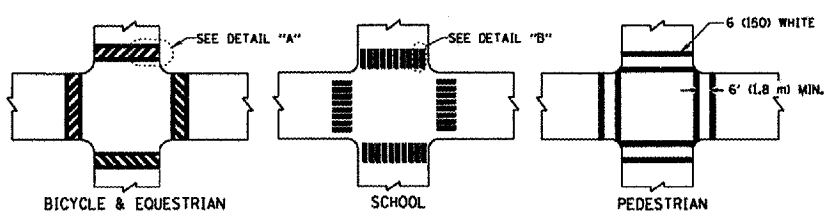

TYPICAL CROSSWALK MARKING

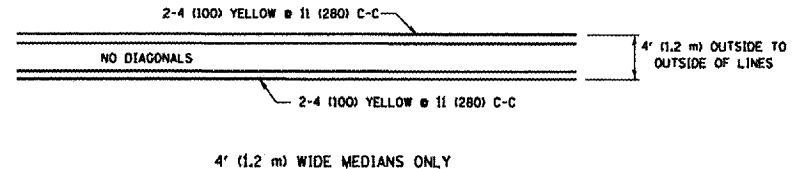

4' (1.2 m) WIDE MEDIANS ONLY

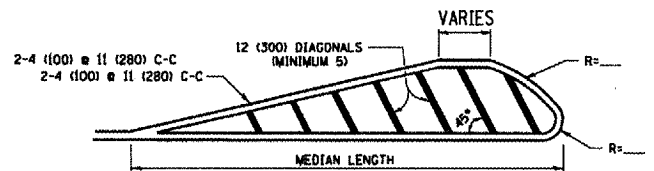

FOR MEDIAN LENGTHS WHERE DIAGONAL SPACING CANNOT BE ATTAINED, USE 5 (FIVE) EQUALLY SPACED DIAGONAL LINES.
 DIAGONAL LINE SPACING: 50' (15 m) C-C (LESS THAN 30MPH (50 km/h))
 75' (25 m) C-C (30MPH (50 km/h) TO 45MPH (70 km/h))
 150' (45 m) C-C (MORE THAN 45MPH (70 km/h))

MEDIANS OVER 4' (1.2 m) WIDE

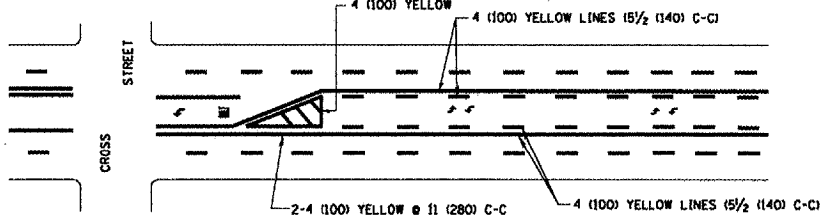

A MINIMUM OF TWO PAIRS OF TURN ARROWS SHALL BE USED, WHITE IN COLOR. ADDITIONAL PAIRS SHALL BE PLACED AT 200' (60 m) TO 300' (90 m) INTERVALS.

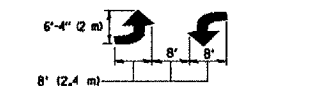

MEDIAN WITH TWO-WAY LEFT TURN LANE

TYPICAL PAINTED MEDIAN MARKING

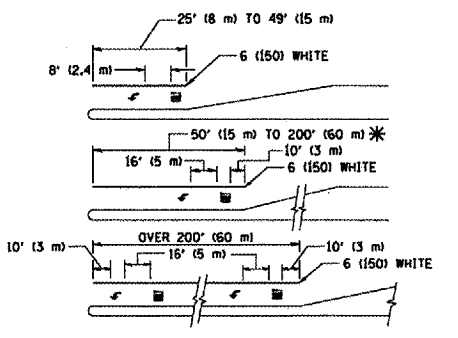

FULL SIZE LETTERS 8' (2.4 m) AND ARROWS SHALL BE USED.
 * AREA = 15.6 SQ. FT. (1.5 m²) * AREA = 20.8 SQ. FT. (1.9 m²)
 * TURN LANES IN EXCESS OF 400' (120 m) IN LENGTH MAY HAVE AN ADDITIONAL SET OF ARROW - "ONLY" INSTALLED MIDWAY BETWEEN THE OTHER TWO SETS OF ARROW - "ONLY".

TYPICAL LEFT (OR RIGHT) TURN LANE

TYPICAL TURN LANE MARKING

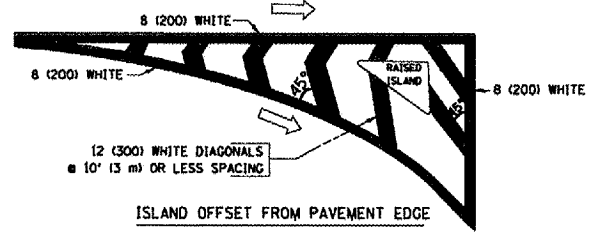

ISLAND OFFSET FROM PAVEMENT EDGE

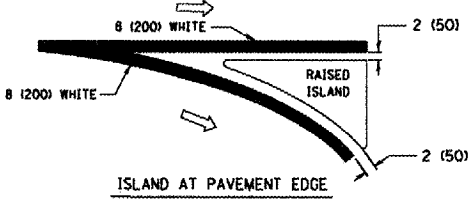

ISLAND AT PAVEMENT EDGE

TYPICAL ISLAND MARKING

TYPE OF MARKING	WIDTH OF LINE	PATTERN	COLOR	SPACING / REMARKS
CENTERLINE ON 2 LANE PAVEMENT	4 (100)	SKIP-DASH	YELLOW	10' (3 m) LINE WITH 30' (9 m) SPACE
CENTERLINE ON MULTI-LANE UNDIVIDED PAVEMENT	2 @ 4 (100)	SOLID	YELLOW	11 (280) C-C
NO PASSING ZONE LINES FOR ONE DIRECTION FOR BOTH DIRECTIONS	4 (100) 2 @ 4 (100)	SOLID SOLID	YELLOW YELLOW	5 1/2 (140) C-C FROM SKIP-DASH CENTERLINE 11 (280) C-C OMIT SKIP-DASH CENTERLINE BETWEEN
LANE LINES	4 (100) 5 (125) ON FREEWAYS	SKIP-DASH SKIP-DASH	WHITE WHITE	10' (3 m) LINE WITH 30' (9 m) SPACE
DOTTED LINES (EXTENSIONS OF CENTER, LANE OR TURN LANE MARKINGS)	SAME AS LINE BEING EXTENDED	SKIP-DASH	SAME AS LINE BEING EXTENDED	2' (600) LINE WITH 6' (1.8 m) SPACE
EDGE LINES	4 (100)	SOLID	YELLOW-LEFT WHITE-RIGHT	OUTLINE MOUNTABLE MEDIANS IN YELLOW; EDGE LINES ARE NOT USED NEXT TO BARRIER CURB
TURN LANE MARKINGS	6 (150) LINE; FULL SIZE LETTERS & SYMBOLS (8' (2.4m))	SOLID	WHITE	SEE TYPICAL TURN LANE MARKING DETAIL
TWO WAY LEFT TURN MARKING	2 @ 4 (100) EACH DIRECTION 8' (2.4m) LEFT ARROW	SKIP-DASH AND SOLID IN PAIRS	YELLOW WHITE	10' (3 m) LINE WITH 30' (9 m) SPACE FOR SKIP-DASH 5 1/2 (140) C-C BETWEEN SOLID LINE AND SKIP-DASH LINE SEE TYPICAL TWO-WAY LEFT TURN MARKING DETAIL
CROSSWALK LINES (PEDESTRIAN) A. DIAGONALS (BIKE & EQUESTRIAN) B. LONGITUDINAL BARS (SCHOOL)	2 @ 6 (150) 12 (300) @ 45° 12 (300) @ 90°	SOLID SOLID SOLID	WHITE WHITE WHITE	NOT LESS THAN 6' (1.8 m) APART 2' (600) APART SEE TYPICAL CROSSWALK MARKING DETAILS.
STOP LINES	24 (600)	SOLID	WHITE	PLACE 4' (1.2 m) IN ADVANCE OF AND PARALLEL TO CROSSWALK, IF PRESENT. OTHERWISE, PLACE AT DESIRED STOPPING POINT, PARALLEL TO CROSSROAD CENTERLINE, WHERE POSSIBLE
PAINTED MEDIANS	2 @ 4 (100) WITH 12 (300) DIAGONALS @ 45° NO DIAGONALS USED FOR 4' (1.2 m) WIDE MEDIANS	SOLID	YELLOW; TWO WAY TRAFFIC WHITE; ONE WAY TRAFFIC	11 (280) C-C FOR THE DOUBLE LINE SEE TYPICAL PAINTED MEDIAN MARKING.
GORE MARKING AND CHANNELIZING LINES	8 (200) WITH 12 (300) DIAGONALS @ 45°	SOLID	WHITE	DIAGONALS: 15' (4.5 m) C-C (LESS THAN 30MPH (50 km/h)) 20' (6 m) C-C (30MPH (50 km/h) TO 45MPH (70 km/h)) 30' (9 m) C-C (OVER 45MPH (70 km/h))
RAILROAD CROSSING	24 (600) TRANSVERSE LINES; "RR" IS 6' (1.8 m) LETTERS; 16 (400) LINE FOR "A"	SOLID	WHITE	SEE STATE STANDARD 780001 AREA OF: "R"=3.6 SQ. FT. (0.33 m ²) EACH "X"=84.0 SQ. FT. (7.8 m ²)
SHOULDER DIAGONALS	12 (300) @ 45°	SOLID	WHITE - RIGHT YELLOW - LEFT	50' (15 m) C-C (LESS THAN 30MPH (50 km/h)) 75' (25 m) C-C (30 MPH (50 km/h) TO 45MPH (70 km/h)) 150' (45 m) C-C (OVER 45MPH (70 km/h))

FOR FURTHER DETAILS ON PAVEMENT MARKING REFER TO STANDARD SPECIFICATIONS FOR ROAD AND BRIDGE CONSTRUCTION AND STATE STANDARD 780001.

All dimensions are in inches (millimeters) unless otherwise shown.

FILE NAME = W:\data\22x34\cal3.dgn	USER NAME = gaglionab	DESIGNED - EVERS	REVISED - T. RAMMACHER 10-27-94
		DRAWN -	REVISED - A. HOUSEH 10-09-96
		CHECKED -	REVISED - A. HOUSEH 10-17-96
		DATE - 03-19-90	REVISED - T. RAMMACHER 01-06-00

STATE OF ILLINOIS
DEPARTMENT OF TRANSPORTATION



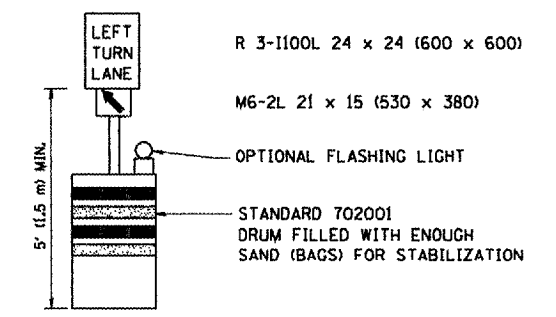
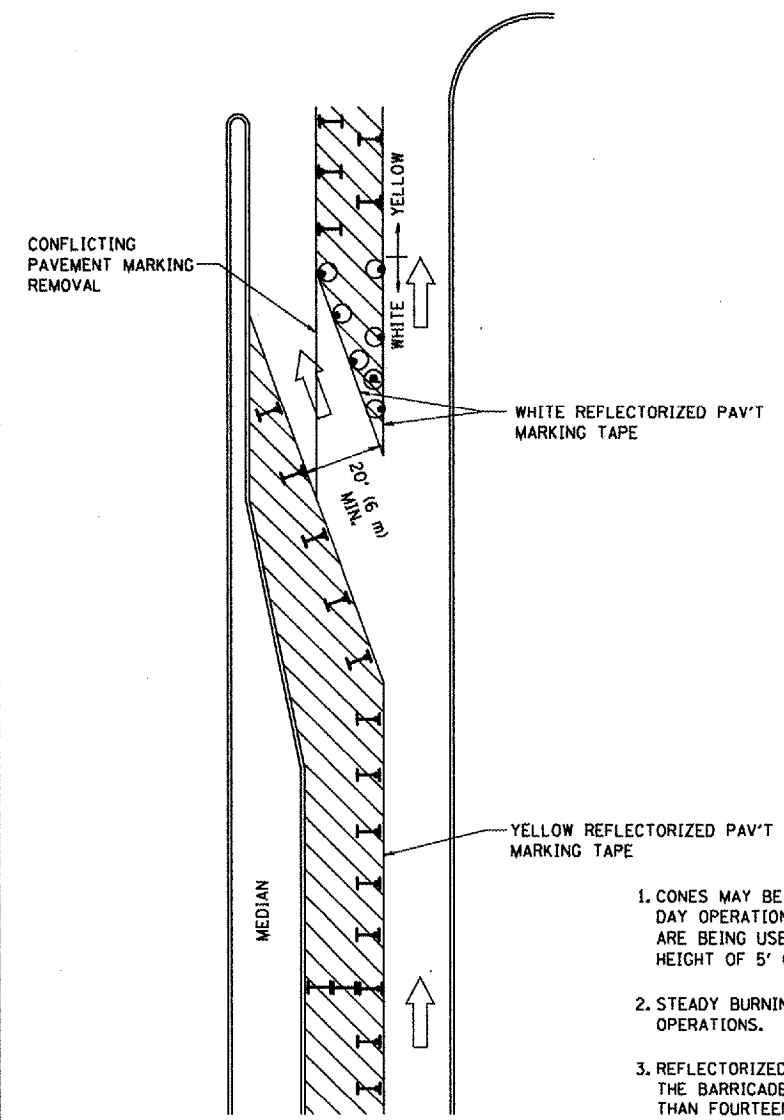

DISTRICT ONE		F.A. RTE.	SECTION	COUNTY	TOTAL SHEETS	SHEET NO.
TYPICAL PAVEMENT MARKINGS		VAR 2008-009 PP	TC-13	LAKE	37	34
SCALE: NONE	SHEET NO. 1 OF 1 SHEETS	STA.	TO STA.	FED. ROAD DIST. NO. 1 ILLINOIS FED. AID PROJECT		

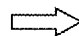

GENERAL NOTES

1. CONES MAY BE SUBSTITUTED FOR BARRICADES OR DRUMS AT HALF THE SPACING DURING DAY OPERATIONS. CONES SHALL BE A MINIMUM OF 28 (710) IN HEIGHT. WHEN CONES ARE BEING USED, THE "LEFT TURN LANE" SIGN MAY BE SKID MOUNTED AT A MINIMUM HEIGHT OF 5' (1.5 m).
2. STEADY BURNING LIGHTS WILL NOT BE REQUIRED ON BARRICADES OR DRUMS FOR DAY OPERATIONS. ALL LIGHTS SHALL BE MONODIRECTIONAL.
3. REFLECTORIZED TEMPORARY PAVEMENT MARKING TAPE SHALL BE PLACED THROUGHOUT THE BARRICADED AREA OF EACH TURN BAY WHERE THE CLOSURE TIME IS GREATER THAN FOURTEEN DAYS.
4. THIS APPLICATION ALSO APPLIES WHEN WORK IS BEING PERFORMED IN THE RIGHT LANE(S) AND THE RIGHT TURN BAY IS TO REMAIN OPEN. UNDER THIS CONDITION, "RIGHT TURN LANE" R3-100 24 x 24 (600 x 600) AND M6-2R 21 x 15 (530 x 380) SHALL BE USED.
5. THESE CONTROLS SHALL SUPPLEMENT MAINLINE TRAFFIC CONTROL FOR LANE CLOSURES.
6. LONGITUDINAL DIMENSIONS MAY BE ADJUSTED TO FIT FIELD CONDITIONS.
7. FORM BT 725 IS REQUIRED.
8. TRAFFIC CONTROL AND PROTECTION AT TURN BAYS (TO REMAIN OPEN TO TRAFFIC) SHALL BE INCLUDED IN THE COST SPECIFIED TRAFFIC CONTROL STANDARDS OR ITEMS.

LEGEND

-  WORK AREA
-  LANE OPEN TO TRAFFIC
-  TYPE I OR II BARRICADE WITH STEADY BURN LIGHT
-  DRUM WITH STEADY BURN LIGHT
-  DRUM WITH SIGN (WITH OPTIONAL FLASHING LIGHT) SEE DETAIL
-  TYPE I OR II CHECK BARRICADE WITH FLASHING LIGHT

All dimensions are in inches (millimeters) unless otherwise shown.

FILE NAME =	USER NAME = geglentobt	DESIGNED -	REVISED -T, RAMMACHER 09-08-94
W:\d\statd\22x34\col4.dgn		DRAWN -	REVISED - A. HOUSEH 11-07-95
		PLOT SCALE = 50.0000 / IN.	REVISED - A. HOUSEH 10-12-96
		CHECKED -	REVISED -T, RAMMACHER 01-06-00
		PLOT DATE = 1/4/2008	
		DATE -	

**STATE OF ILLINOIS
DEPARTMENT OF TRANSPORTATION**

TRAFFIC CONTROL AND PROTECTION AT TURN BAYS (TO REMAIN OPEN TO TRAFFIC)			
SCALE: NONE	SHEET NO. 1 OF 1 SHEETS	STA.	TO STA.

F.A. RTE.	SECTION	COUNTY	TOTAL SHEETS	SHEET NO.
VAR 2008-069 PP	LAKE	37	35	
TC-14			CONTRACT NO. 60635	
FED. ROAD DIST. NO. 1 ILLINOIS FED. AID PROJECT				

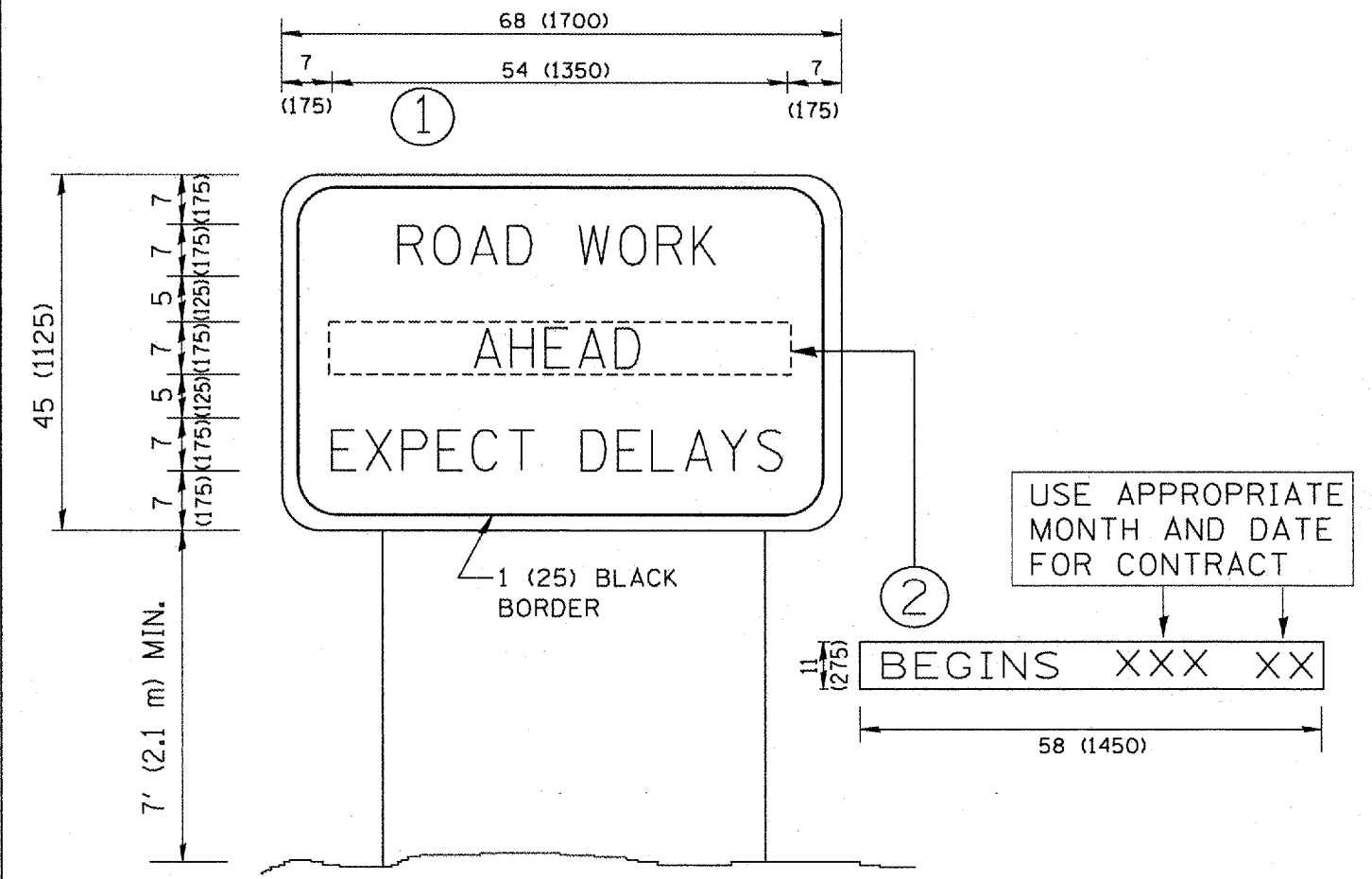

NOTES:

1. USE BLACK LETTERING ON ORANGE BACKGROUND.
2. ERECT SIGNS IN ADVANCE OF THE LOCATION FOR THE "ROAD CONSTRUCTION AHEAD" SIGN AT LOCATIONS AS DIRECTED BY THE ENGINEER.
3. ERECT SIGN ① WITH INSTALLED PANEL ② ONE WEEK PRIOR TO THE START OF CONSTRUCTION.
4. REMOVE PANEL ② SOON AFTER THE START OF CONSTRUCTION.
5. SEE SPECIAL PROVISION FOR "TEMPORARY INFORMATION SIGNING" FOR ADDITIONAL INFORMATION.
6. ONE SIGN ASSEMBLY EQUALS 25.70 SQ. FT. (2.3 SQ. M.)
7. SHALL BE PAID FOR AS TEMPORARY INFORMATION SIGNING.

ALL DIMENSIONS ARE IN INCHES (MILLIMETERS) UNLESS OTHERWISE SHOWN.

FILE NAME = W:\data\22x34\to22.dgn	USER NAME = geglianobt	DESIGNED -	REVISED - R. MIRS 09-15-97
		DRAWN -	REVISED - R. MIRS 12-11-97
	PLOT SCALE = 50.000' / IN.	CHECKED -	REVISED - T. RAMMACHER 02-02-99
	PLOT DATE = 1/4/2000	DATE -	REVISED - C. JUCIUS 01-31-07

**STATE OF ILLINOIS
DEPARTMENT OF TRANSPORTATION**

ARTERIAL ROAD INFORMATION SIGN	
SCALE: NONE	SHEET NO. 1 OF 1 SHEETS
STA.	TO STA.

F.A. RTE.	SECTION	COUNTY	TOTAL SHEETS	SHEET NO.
VAR 2008-009 PP	LAKE	37	36	
TC-22		CONTRACT NO. 60E35		
FED. ROAD DIST. NO. 1 ILLINOIS FED. AID PROJECT				

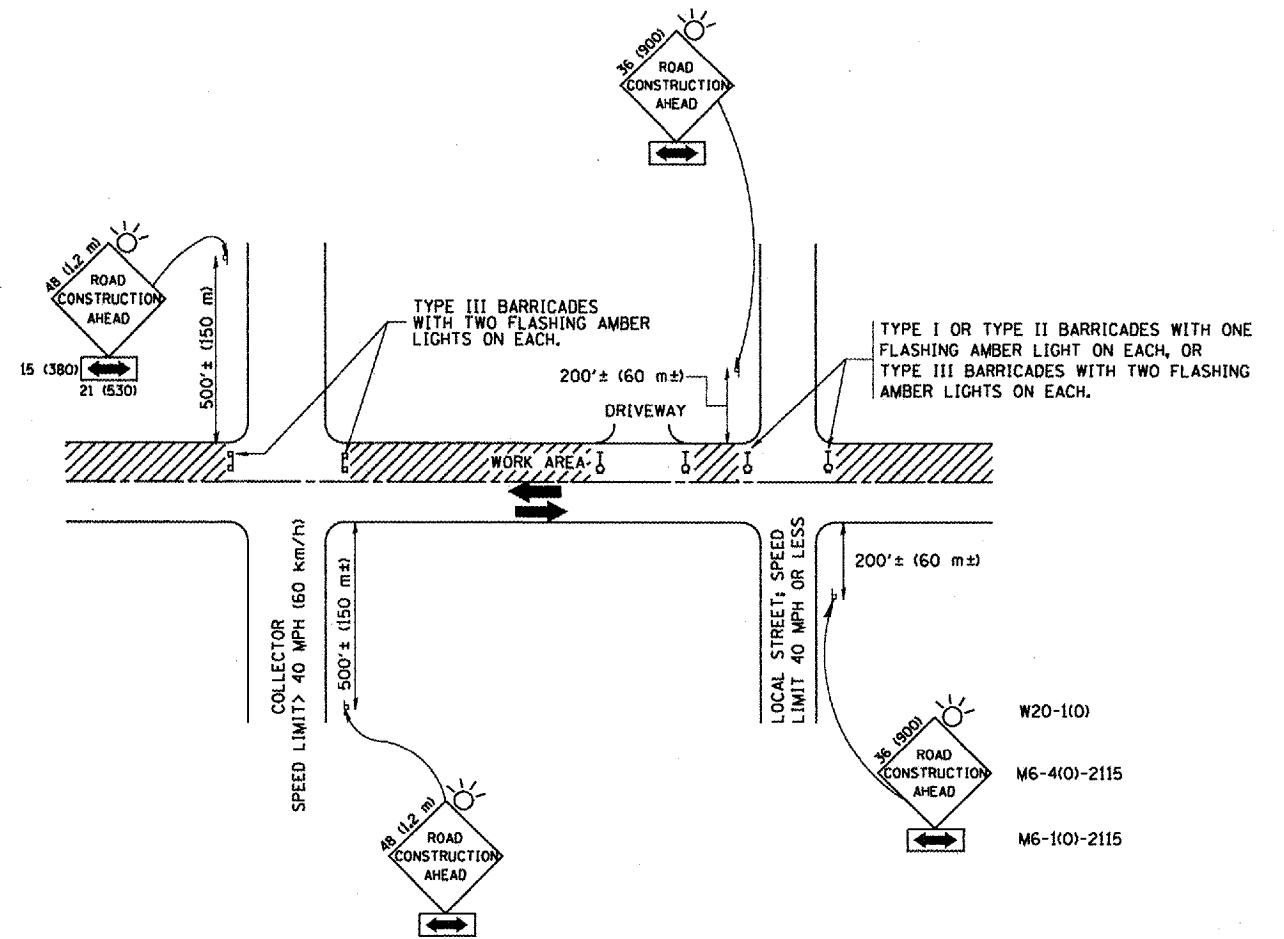

TRAFFIC CONTROL AND PROTECTION FOR SIDE ROADS, INTERSECTIONS, AND DRIVEWAYS

NOTES:

A. FOR NO LANE RESTRICTION ON THE SIDE ROAD OR DRIVEWAYS

1. SIDE ROAD WITH A SPEED LIMIT OF 40 MPH (60 km/h) OR LESS AS SHOWN ON THE DRAWING AND AS DIRECTED BY THE ENGINEER:

a) ONE ROAD CONSTRUCTION AHEAD SIGN 36 x 36 (900x900) WITH A FLASHER AND FLAG MOUNTED ON IT APPROXIMATELY 200' (60 m) IN ADVANCE OF THE MAIN ROUTE.

b) THE CLOSED PORTION OF THE MAIN ROUTE SHALL BE PROTECTED BY BLOCKING WITH TYPE I, TYPE II OR TYPE III BARRICADES, 1/3 OF THE CROSS SECTION OF THE CLOSED PORTION.

2. SIDE ROAD WITH A SPEED LIMIT GREATER THAN 40 MPH (60 km/h) AS SHOWN ON THE DRAWING AND AS DIRECTED BY THE ENGINEER:

a) ONE ROAD CONSTRUCTION AHEAD SIGN 48 x 48 (1.2 m x 1.2 m) WITH A FLASHER MOUNTED ON IT APPROXIMATELY 500' (150 m) IN ADVANCE OF THE MAIN ROUTE.

b) THE CLOSED PORTION OF THE MAIN ROUTE SHALL BE PROTECTED BY BLOCKING WITH TYPE III BARRICADES, 1/2 OF THE CROSS SECTION OF THE CLOSED PORTION.

3. WHEN THE SIDE ROAD LIES BETWEEN THE BEGINNING OF THE MAINLINE SIGNING AND THE WORK ZONE, A SINGLE HEADED ARROW (M6-1) SHALL BE USED IN LIEU OF THE DOUBLE HEADED ARROW (M6-4).

B. FOR A LANE CLOSURE ON A SIDE ROAD OR DRIVEWAY:

USE APPLICABLE PORTIONS OF THE TYPICAL APPLICATION OF TRAFFIC CONTROL DEVICES (STD. 701501, STD. 701606 OR THE APPROPRIATE STANDARD). THE SPACING OF SIGNS AND BARRICADES SHALL BE ADJUSTED FOR FIELD CONDITIONS AS DIRECTED BY THE ENGINEER. THE DIRECTIONAL ARROW SHALL BE COVERED OR REMOVED WHEN NO LONGER CONSISTENT WITH THE SIDE ROAD LANE CLOSURE.

C. ADVANCE WARNING SIGNS ARE TO BE OMITTED ON DRIVEWAY UNLESS OTHERWISE NOTED.

D. THE TRAFFIC CONTROL AND PROTECTION FOR SIDE ROADS, INTERSECTIONS, AND DRIVEWAYS SHALL BE INCIDENTAL TO THE COST OF SPECIFIED TRAFFIC CONTROL STANDARDS OR ITEMS.

All dimensions are in millimeters (Inches) unless otherwise shown.

FILE NAME = W:\d\state\22x34\col8.dgn	USER NAME = geglertob	DESIGNED - LHA	REVISED - J. OBERLE 10-18-95
		DRAWN -	REVISED - A. HOUSEH 03-06-96
		PLOT SCALE = 50.000' / IN.	REVISED - A. HOUSEH 10-15-96
		PLOT DATE = 1/4/2008	REVISED - T. RAMMACHER 01-06-00
		DATE - 06-89	

STATE OF ILLINOIS
DEPARTMENT OF TRANSPORTATION

TRAFFIC CONTROL AND PROTECTION FOR
SIDE ROADS, INTERSECTIONS, AND DRIVEWAYS

SCALE: NONE SHEET NO. 1 OF 1 SHEETS STA. TO STA.

F.A. RTE.	SECTION	COUNTY	TOTAL SHEETS	SHEET NO.
VIA 2008-009 PP	LAKE	37	37	37
TC-10	CONTRACT NO.	00E35		
FED. ROAD DIST. NO. 1 ILLINOIS FED. AID PROJECT				