

PHASE 2

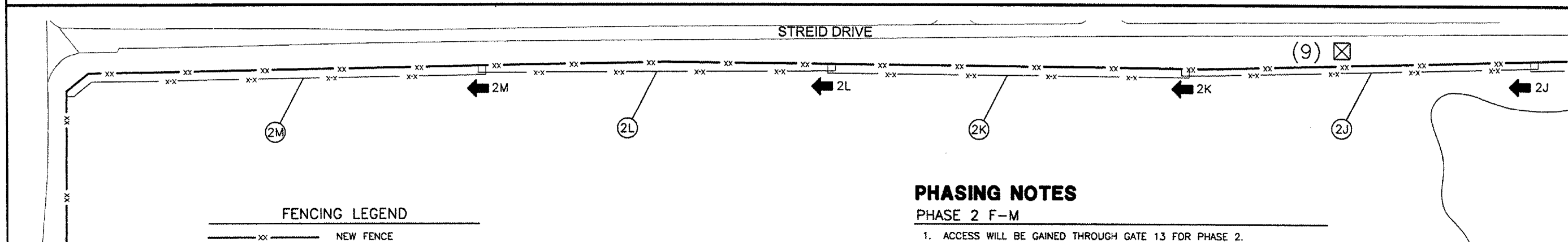

FENCING LEGEND

—xx—	NEW FENCE
-x-x-	TEMPORARY FENCE
-x-	EXISTING FENCE
⊙ 1C	SUB-PHASE
➔ 1A	ACCESS ROUTE FOR PHASE
⊠ (13)	EXISTING GATE

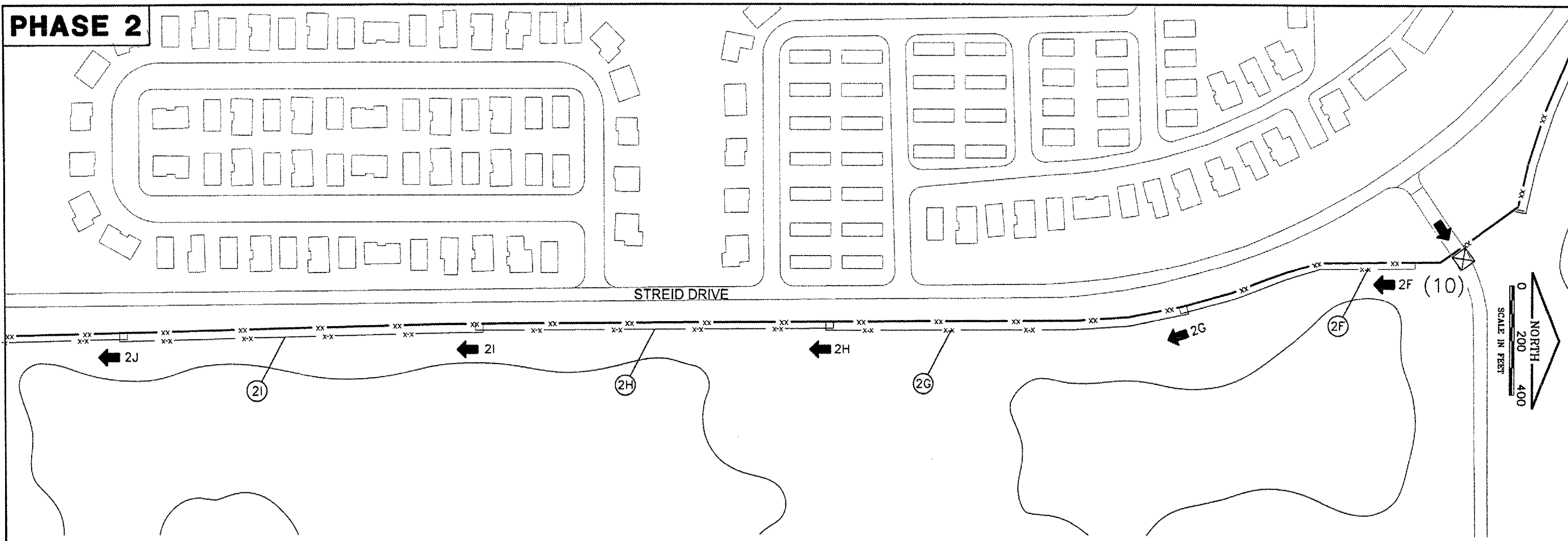
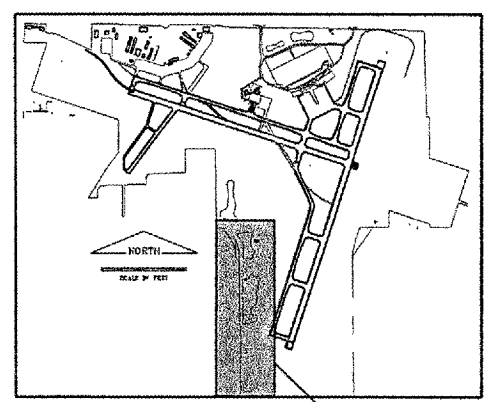

KEYMAP THIS SHEET

PHASING NOTES

PHASE 2 F-M

1. ACCESS WILL BE GAINED THROUGH GATE 13 FOR PHASE 2.
2. PHASE 2 HAS BEEN BROKEN INTO SMALLER SUB PHASES APPROXIMATELY 650' LONG.
3. NO MORE THAN 3 CONSECUTIVE SUB PHASES MAY BE CONSTRUCTED SIMULTANEOUSLY.
4. PRIOR TO THE START OF CONSTRUCTION SUB PHASES ADJACENT TO RESIDENTIAL AREAS, CONTRACTOR SHALL IDENTIFY AREAS THAT MAY NOT ALLOW THE PROPER CONSTRUCTION OF THE FENCE. CONTRACTOR SHALL WORK WITH THE AIRPORT THROUGH THE ENGINEER TO RESOLVE ANY RESIDENT AREA CONSTRUCTION LOCATION CONFLICTS.
5. PHASING ADDITIVE ALTERNATE CONSTRUCTION WILL CONTINUE IN A SIMILAR MANNER, AS PREVIOUS PHASES.

K:\Bloomington\0708506\Draw\Sheets
 FILE: 05_Phasing2A.dwg
 UPDATE BY: Chris Groth
 PLOT DATE: 4/14/2008 7:52 AM
 Security-Base
 BASE_FENCE
 KEYMAP

BL062

REVISIONS		
NUMBER	BY	DATE

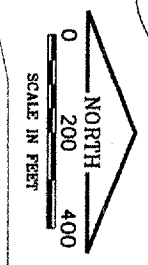
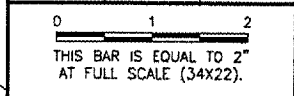

BLOOMINGTON-NORMAL AIRPORT AUTHORITY
CENTRAL ILLINOIS REGIONAL AIRPORT
BLOOMINGTON, ILLINOIS
UPGRADE PERIMETER FENCE PHASE 2
CONSTRUCTION ACTIVITY PLAN
PHASE 2 F-M

© Copyright CMT, Inc.
CMT
 CRAWFORD, MURPHY & TILLY, INC.
 CONSULTING ENGINEERS
 License No. 181-00063

DESIGN BY:	CBG
DRAWN BY:	CMT
CHECKED BY:	CSG
APPROVED BY:	RW
DATE:	MAY 9, 2008
JOB No:	0708506
BMI-3599 3-17-0006-XX	
SHEET 07 OF 16 SHEETS	