

BL062

REVISIONS		
NUMBER	BY	DATE

0 1 2
 THIS BAR IS EQUAL TO 2"
 AT FULL SCALE (34X22).

**BLOOMINGTON-NORMAL AIRPORT AUTHORITY
 CENTRAL ILLINOIS REGIONAL AIRPORT
 BLOOMINGTON, ILLINOIS**

**UPGRADE PERIMETER FENCE PHASE 2
 PROPOSED FENCE IMPROVEMENTS 2**

© copyright cmt, inc.
CMT
 CRAWFORD, MURPHY & TILLY, INC.
 CONSULTING ENGINEERS
 License No. 84-000513

DESIGN BY: CBG
 DRAWN BY: CMT
 CHECKED BY: *CBG*
 APPROVED BY: *JCLV*
 DATE: MAY 9, 2008
 JOB No: 0708506

BMI-3599
 3-17-0006-XX
 SHEET 13 OF 16 SHEETS

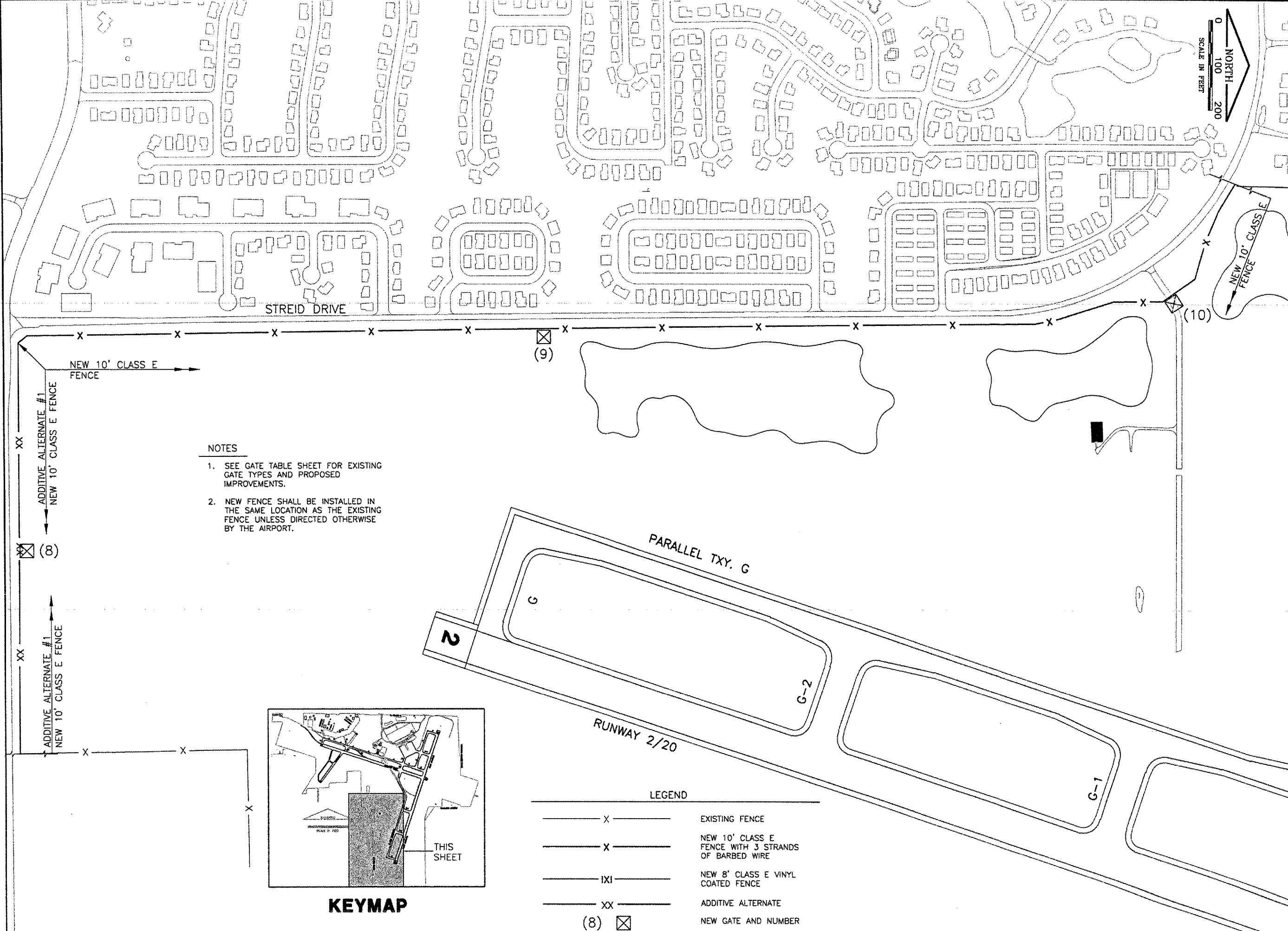

- NOTES**
1. SEE GATE TABLE SHEET FOR EXISTING GATE TYPES AND PROPOSED IMPROVEMENTS.
 2. NEW FENCE SHALL BE INSTALLED IN THE SAME LOCATION AS THE EXISTING FENCE UNLESS DIRECTED OTHERWISE BY THE AIRPORT.

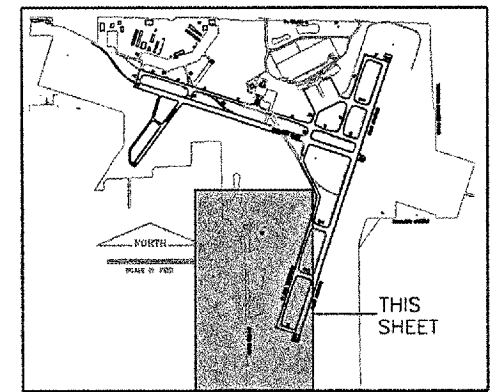

KEYMAP

LEGEND

— X —	EXISTING FENCE
— X —	NEW 10' CLASS E FENCE WITH 3 STRANDS OF BARBED WIRE
— IXI —	NEW 8' CLASS E VINYL COATED FENCE
— XX —	ADDITIVE ALTERNATE
(8) □	NEW GATE AND NUMBER