

K:\Springfield\p\0703509\Draw\Sheets\Phase 1
 FILE: EXISTPMTSTRUCT.dwg
 UPDATE BY: Dave Allen
 PLOT DATE: 4/18/2008 10:58 AM
 KEY
 BASE_EXISTTOPO
 SPI-BASE
 BASE_PROPCEO

CA006

REVISIONS		
NUMBER	BY	DATE

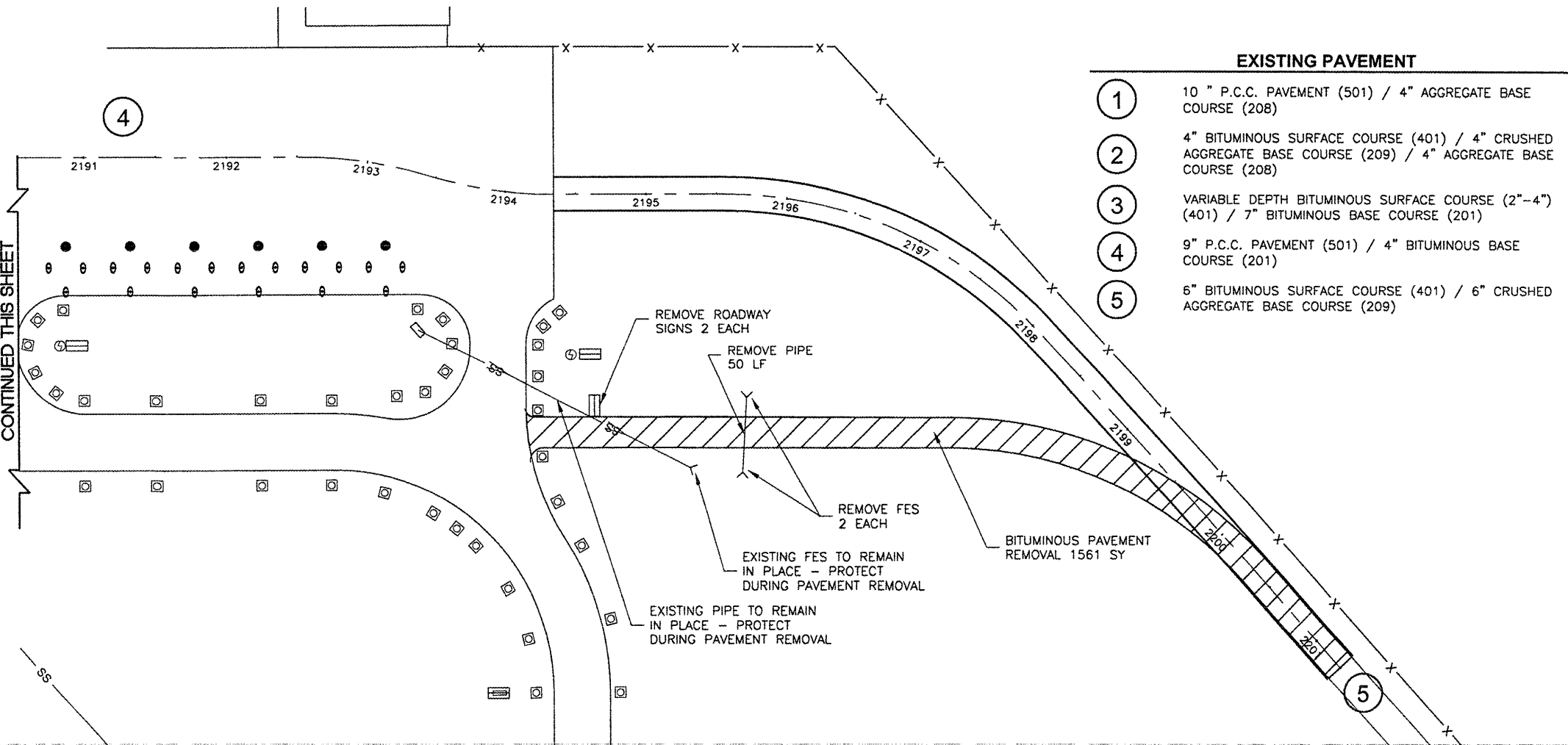
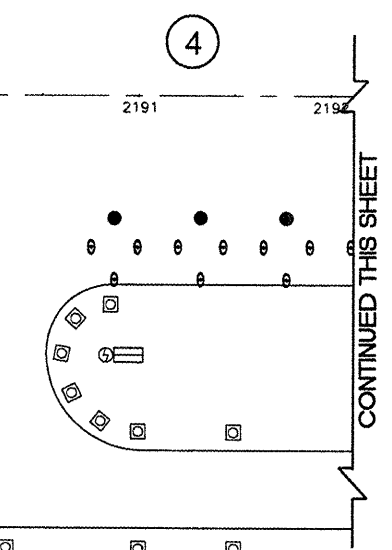
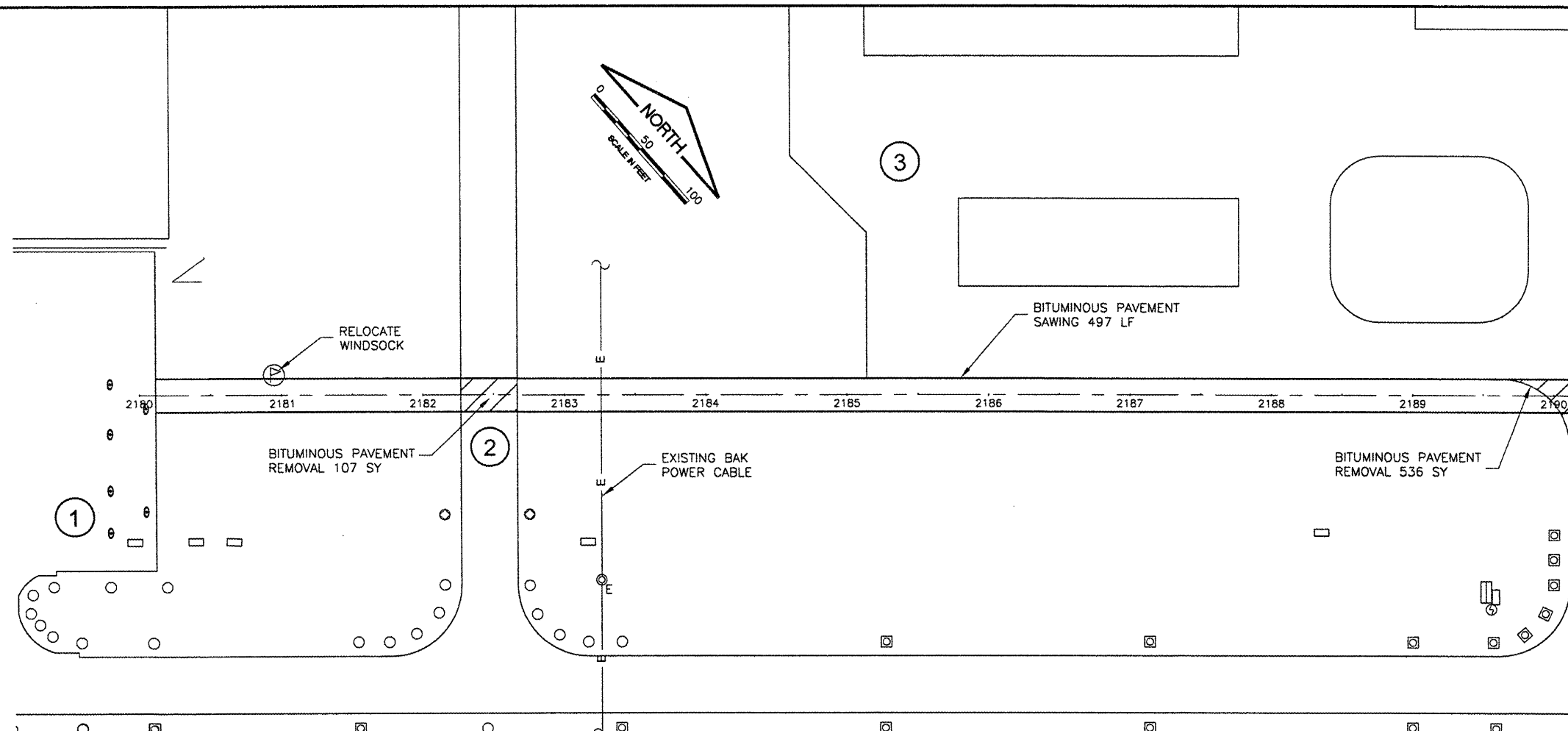
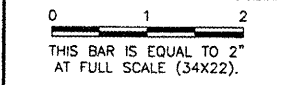

- EXISTING PAVEMENT**
- ① 10" P.C.C. PAVEMENT (501) / 4" AGGREGATE BASE COURSE (208)
 - ② 4" BITUMINOUS SURFACE COURSE (401) / 4" CRUSHED AGGREGATE BASE COURSE (209) / 4" AGGREGATE BASE COURSE (208)
 - ③ VARIABLE DEPTH BITUMINOUS SURFACE COURSE (2"-4") (401) / 7" BITUMINOUS BASE COURSE (201)
 - ④ 9" P.C.C. PAVEMENT (501) / 4" BITUMINOUS BASE COURSE (201)
 - ⑤ 6" BITUMINOUS SURFACE COURSE (401) / 6" CRUSHED AGGREGATE BASE COURSE (209)

- LEGEND**
- PAVEMENT REMOVAL
 - INLET
 - BASE MOUNTED TAXIWAY LIGHT
 - STAKE MARKED LIGHT
 - RETRO-REFLECTIVE MARKER
 - GROUND ROD
 - TIE DOWN
 - ELECTRICAL MANHOLE
 - WINDSOCK
 - FENCE
 - BAK POWER CABLE
 - EXISTING TAXIWAY SIGN
 - NEW PAVEMENT



SPRINGFIELD AIRPORT AUTHORITY
 ABRAHAM LINCOLN CAPITAL AIRPORT
 SPRINGFIELD, IL

TTY G WIDENING-PHASE 1 REALIGN NORTH PERIMETER ROAD
 EXISTING CONDITIONS AND REMOVALS

© Copyright CMT, Inc.
CMT
 CRAWFORD, MURPHY & TILLY, INC.
 CONSULTING ENGINEERS
 License No. 184-000513

DESIGN BY:	CBG
DRAWN BY:	DPA/JLR
CHECKED BY:	CBG
APPROVED BY:	RJV
DATE:	APRIL 25, 2008
JOB No:	07035-09-00
IL PROJ. NO.	SPI-3789
AIP PROJ. NO.	3-17-0096-XX
SHEET	05 OF 22 SHEETS