

DATE: Wednesday, January 09, 2008 4:54:52 PM
 FILE: K:\dupage\0725704_Rev_28\paps\Draw\Streets\Re-mark\Re-light\Rev_10-28\Third\mark-Seq.dwg
 UPDATE BY: Jeremy Linke
 LAYOUT: Layout1
 XREF: DWG: papi-base.dwg
 t:\c:\st\m\p.dwg
 IMAGE FILES:

**PHASE 1A AND 1B
SUGGESTED SEQUENCE OF CONSTRUCTION
(OUTSIDE A.O.A. OF RUNWAY 2L/20R)**

- CLOSE RUNWAY 10/28. PLACE RUNWAY CLOSURE MARKERS ON RUNWAY 10/28.
- PLACE LATHE AND RIBBON AT AIR OPERATIONS AREA (A.O.A.) LIMITS AND PLACE BARRICADES AS SHOWN ON THE PLANS.
- REMOVE EXISTING PAVEMENT MARKING.
- CONSTRUCT NEW PAVEMENT MARKING AND RELOCATED THRESHOLD.
- CONSTRUCT RUNWAY LIGHT MODS.

**PHASE 2
SUGGESTED SEQUENCE OF CONSTRUCTION
(WITHIN A.O.A. OF RUNWAY 2L/20R)**

- CLOSE RUNWAY 10/28 AND RUNWAY 2L/20R. PLACE RUNWAY CLOSURE MARKERS ON RUNWAY 10/28 AND RUNWAY 2L/20R.
- REMOVE EXISTING PAVEMENT MARKING.
- CONSTRUCT NEW PAVEMENT MARKING.
- OPEN RUNWAY 10/28 AND RUNWAY 2L/20R.

NOTES

1. RUNWAY 10/28 SHALL BE CLOSED FOR THE ENTIRE DURATION OF THE PROJECT (7 CALENDAR DAYS).
2. CONTRACTOR SHALL PLACE BARRICADES AND TEMPORARILY CLOSE TAXIWAYS AND RUNWAYS DURING CONSTRUCTION IF REQUIRED BY THE AIRPORT AND ENGINEER. OTHER METHODS AND SEQUENCING SHALL BE APPROVED BY THE FAA ATCT, AIRPORT, AND ENGINEER PRIOR TO START OF CONSTRUCTION.
3. CONSTRUCTION OF NEW PAVEMENT MARKING AND LIGHT MODS. SHALL BE COORDINATED WITH ENGINEER AND AIRPORT. CONSTRUCTION SHALL BE EXPEDITED TO MINIMIZE THE CLOSURE OF ALL RUNWAYS AND DISRUPTION TO AIRCRAFT OPERATIONS.

LEGEND

- ➔ CONTRACTOR'S ACCESS TO SITE
- ✈ AIRCRAFT MOVEMENT AREA
- AOA — AIRCRAFT OPERATIONS AREA (A.O.A.)
- PHASE 1A BARRICADES WITH FLASHING RED LIGHTS
- ▣ PHASE 1B BARRICADES WITH FLASHING RED LIGHTS
- PHASE 2 BARRICADES WITH FLASHING RED LIGHTS
- - - AIRPORT PROPERTY LINE
- X CLOSED RUNWAY MARKER
- ////// EXISTING RUNWAY CRITICAL AREA
- ▨ PHASE 1A CONSTRUCTION
- ▩ PHASE 1B CONSTRUCTION
- ▧ PHASE 2 CONSTRUCTION
- NEW LIGHT MODIFICATIONS

PHASE	WORK AREA	ALLOWABLE WORK PERIODS	AIRPORT OPERATIONAL RESTRICTIONS
1A	RUNWAY 10/28 FOR REMARKING AND LIGHT MODIFICATIONS	UNRESTRICTED FOR 4 CALENDAR DAYS MAXIMUM	RUNWAY 10/28 WILL BE CLOSED. AIRCRAFT MAY USE RUNWAY 10/28 FOP TAXIING AS APPROVED.
1B	RUNWAY 10/28 FOR REMARKING AND LIGHT MODIFICATIONS	UNRESTRICTED FOR 2 CALENDAR DAYS MAXIMUM	RUNWAY 10/28 WILL BE CLOSED. AIRCRAFT MAY USE RUNWAY 10/28 FOP TAXIING AS APPROVED.
2	INTERSECTION OF RUNWAY 10/28 AND RUNWAY 2L/20R FOR REMARKING	RESTRICTED TO 1 CALENDAR DAY MAXIMUM. CLOSURE OF RUNWAY 2L/20R ONLY PERMITTED BETWEEN 10:00 A.M. AND 2:00 P.M. WEEKDAYS.	RUNWAY 10/28 AND RUNWAY 2L/20R WILL BE CLOSED. AIRCRAFT MAY USE RUNWAY 10/28 FOP TAXIING AS APPROVED.

IL CONTRACT: **DU076**
 IL LETTING ITEM: **2A**
 IL PROJECT: **DPA-3695**
 A.I.P. PROJECT: **3-17-0017-B21**

SURVEY BOOK # BOOK #

REVISIONS		
NUMBER	BY	DATE

0 1 2
 THIS BAR IS EQUAL TO 2" AT FULL SCALE (34X22).

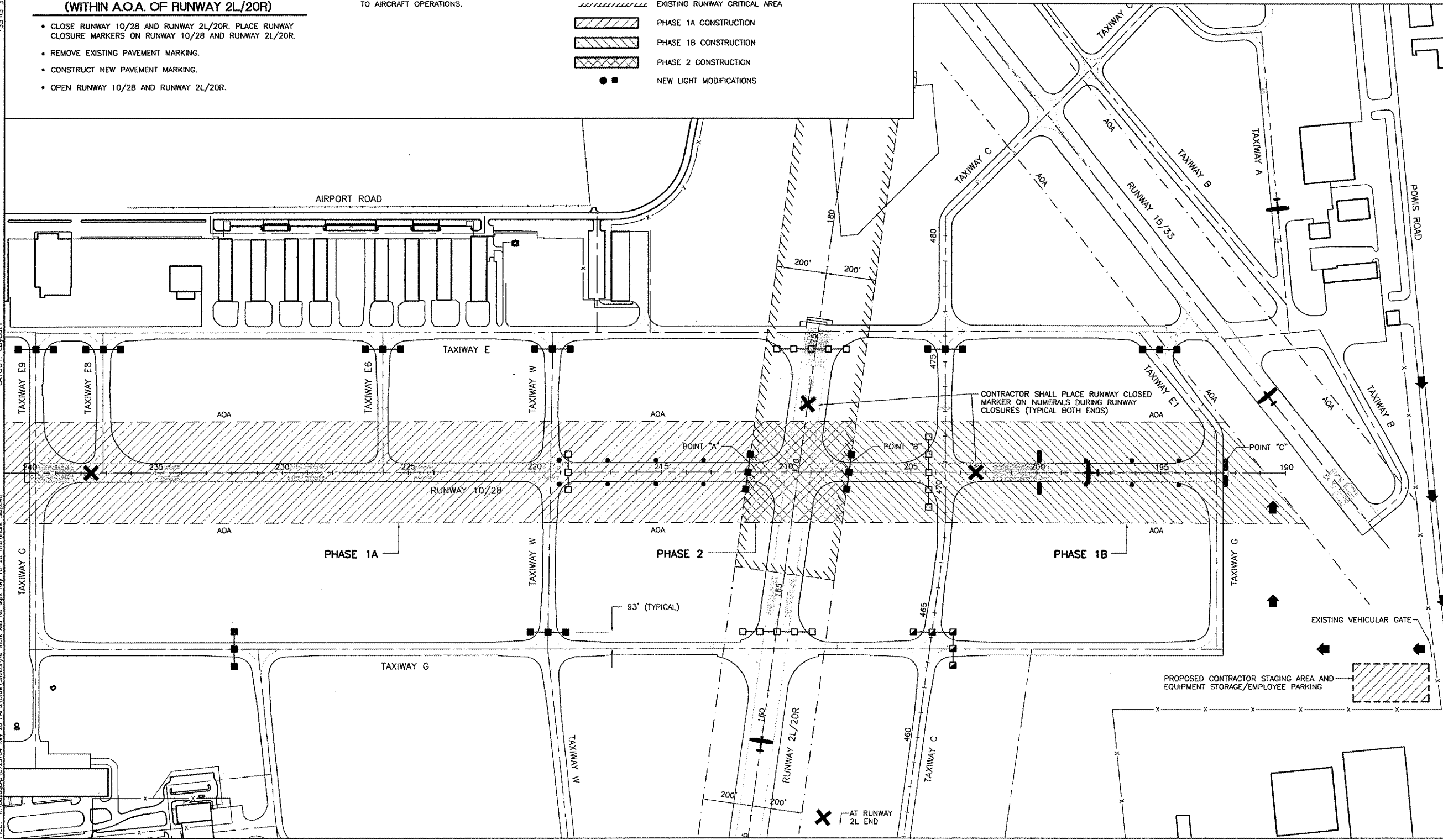

**DUPAGE AIRPORT
WEST CHICAGO, ILLINOIS**

**RE-MARK Rwy 10-28 AND RE-LIGHT Rwy END 28 THRESHOLD
SEQUENCE OF CONSTRUCTION
PER AC 150-5370-2E**

© Copyright CMT, Inc.
CMT
 CRAWFORD, MURPHY & TILLY, INC.
 CONSULTING ENGINEERS
 License No. BH-000615



DESIGN BY: JP / JRL
 DRAWN BY: JRO
 CHECKED BY: JRL
 APPROVED BY: DLP
 DATE: MARCH 7, 2008
 JOB No: 07257-04