

APR 09 2008 6:32 PM HAGL000382
 I:\AIRPORTS\EFFINGHAM\07A0143\CAD\SHEETS\R-16\INT.DWG - JOINT 4

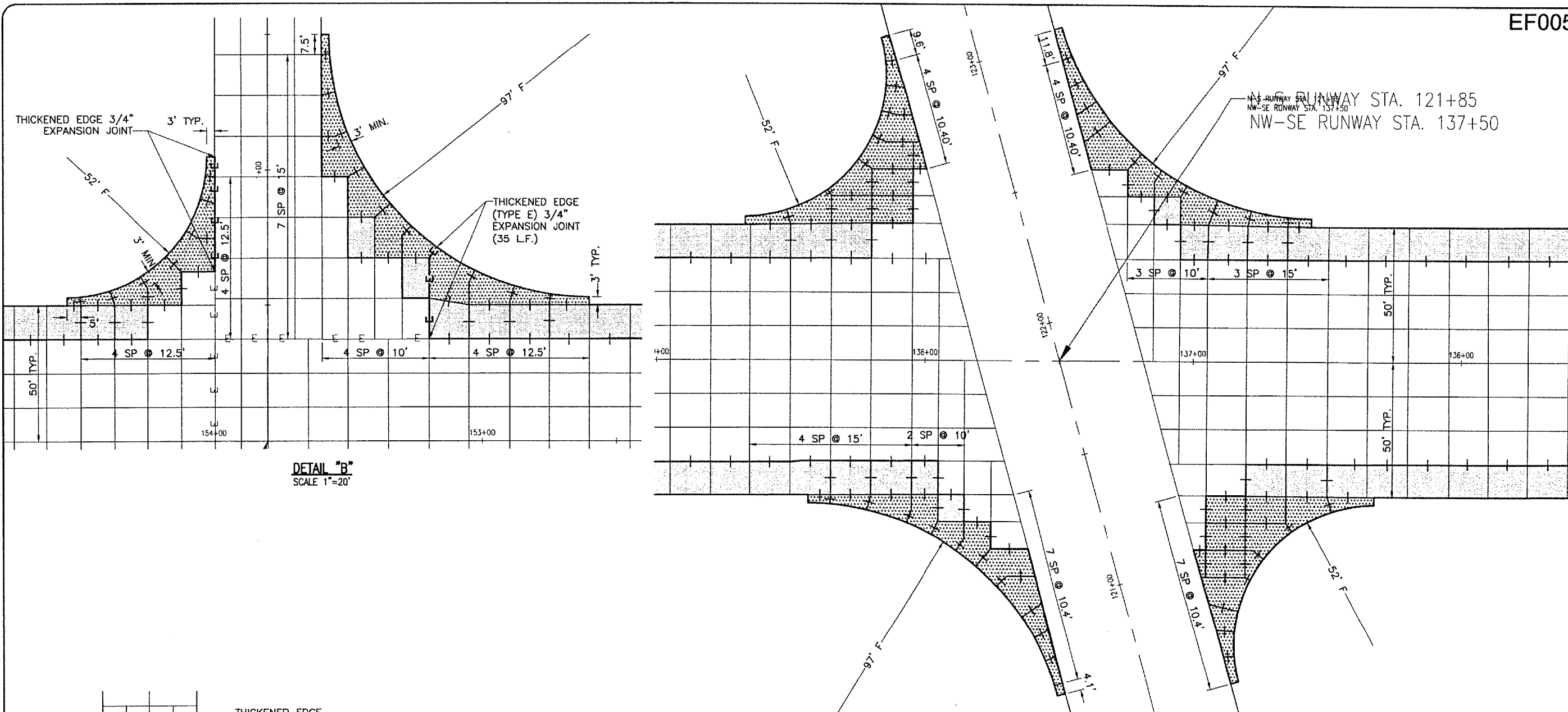

EF005

NW-SE RUNWAY STA. 121+85
 NW-SE RUNWAY STA. 137+50

DETAIL "B"
 SCALE 1"=20'

DETAIL "C"
 SCALE 1"=20'

DETAIL "A"
 SCALE 1"=20'

DETAIL "D"
 SCALE 1"=20'

- LEGEND**
- EXISTING IMPROVEMENTS
 - EXISTING EXPANSION JOINT
 - PROPOSED IMPROVEMENTS
 - PROPOSED HINGED JOINTS
 - PROPOSED TRANSVERSE DUMMY JOINT
 - PROPOSED DOWELED JOINT
 - PROPOSED EXPANSION JOINT
 - PROPOSED MESH 6' X 6' (W4 X W5)

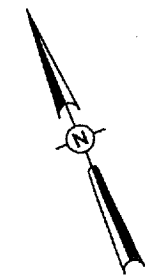

0' 10' 20' 40'
 HALF SIZE SCALE: 1"= 40'
 FULL SIZE SCALE: 1"= 20'

DATE	REVISION	BY
04/09/08	REVISED AS PER IDA REVIEW	CAH

EFFINGHAM COUNTY
 MEMORIAL AIRPORT
 EFFINGHAM, ILLINOIS

Project No.	07A0143D_0800
Filename	R-16.1.INT.DWG
Scale	1"= 50'
Date	02/12/08
LAYOUT	KDM 11/28/07
DRAWN	BAK 11/28/07
REVIEWED	CAH 02/12/08



WIDEN RUNWAY 11/29
 AND REPLACE MRL'S
 PROPOSED
 INTERSECTION
 JOINTING DETAILS

IL PROJ.: 1H2-3761 A.I.P. PROJ.: 3-17-0040-811