

THE LOCATION, SIZE AND TYPE OF MATERIAL OF EXISTING UNDERGROUND UTILITIES INDICATED ON THE PLANS IS NOT REPRESENTED AS BEING ACCURATE, SUFFICIENT OR COMPLETE. IT SHALL BE THE CONTRACTOR'S RESPONSIBILITY TO DETERMINE THE ACTUAL LOCATION OF ALL SUCH FACILITIES, INCLUDING SERVICE CONNECTIONS TO UNDERGROUND UTILITIES. PRIOR TO CONSTRUCTION, THE CONTRACTOR SHALL NOTIFY THE UTILITY COMPANIES OF HIS OPERATIONAL PLANS AND SHALL OBTAIN FROM THE RESPECTIVE UTILITY COMPANIES DETAILED INFORMATION AND ASSISTANCE RELATIVE TO THE LOCATION OF THEIR FACILITIES AND THE WORKING SCHEDULE OF THE COMPANIES FOR REMOVAL OR ADJUSTMENT WHERE REQUIRED. IN THE EVENT AN UNEXPECTED UTILITY INTERFERENCE IS ENCOUNTERED DURING CONSTRUCTION, THE CONTRACTOR SHALL IMMEDIATELY NOTIFY THE UTILITY COMPANY OF JURISDICTION. THE ENGINEER SHALL ALSO BE IMMEDIATELY NOTIFIED. ANY SUCH MAINS AND SERVICES SHALL BE RESTORED TO SERVICE AT ONCE AND PAID FOR BY THE CONTRACTOR AT NO ADDITIONAL COST TO THE CONTRACT.

CALL J.U.L.I.E. FOR UTILITY INFORMATION AT 1-800-892-0123.

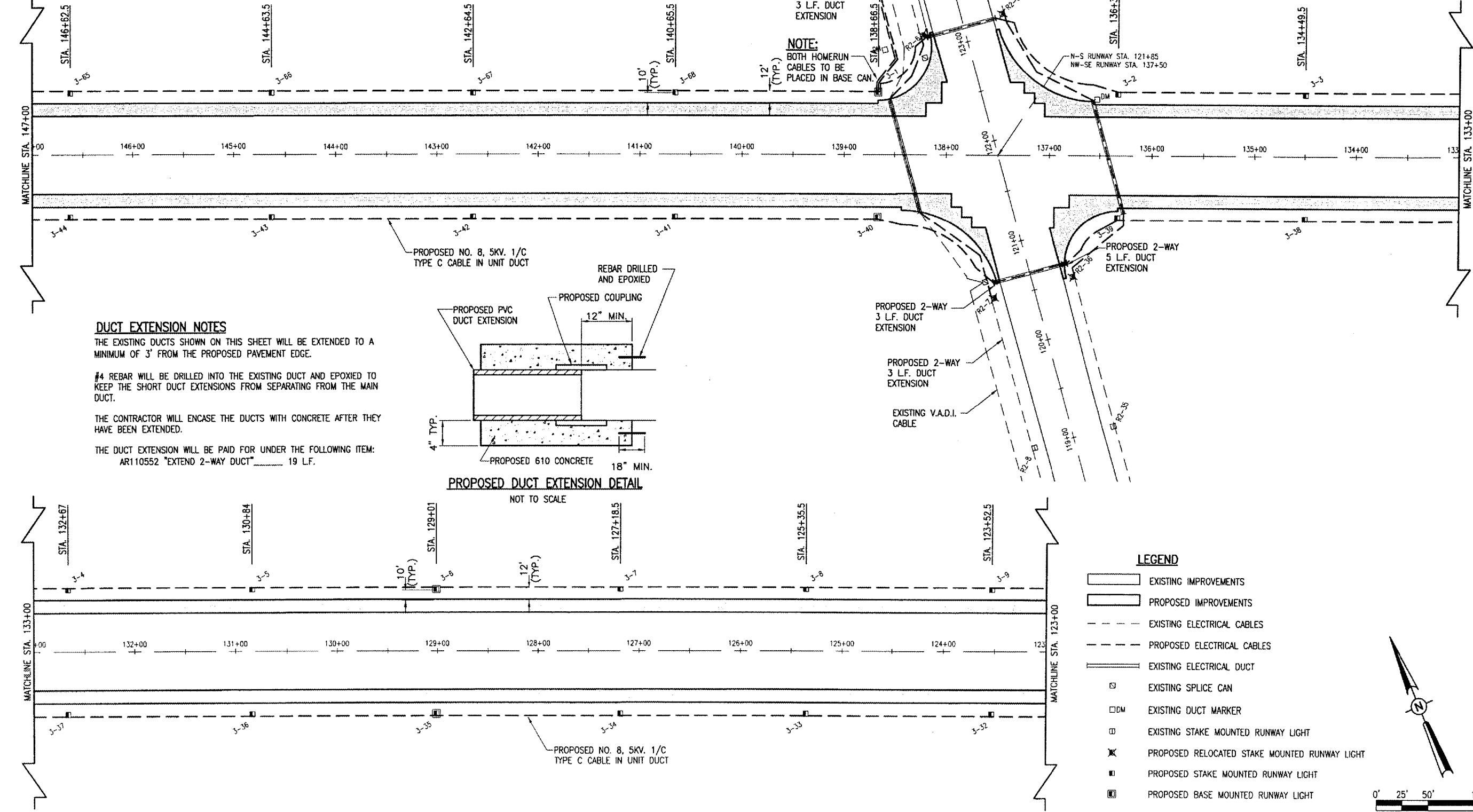

**NOTE:**  
FOR CONTINUATION OF HOME RUNS  
SEE SHEET 27

**NOTE:**  
LIGHT NUMBER'S R2-6, R2-7, R2-36 AND R2-37 WILL TIE INTO THE EXISTING RUNWAY N-S CIRCUIT AT THEIR PROPOSED LOCATIONS.

**NOTE:**  
BOTH HOMERUN CABLES TO BE PLACED IN BASE CAN.

**DUCT EXTENSION NOTES**

THE EXISTING DUCTS SHOWN ON THIS SHEET WILL BE EXTENDED TO A MINIMUM OF 3' FROM THE PROPOSED PAVEMENT EDGE.

#4 REBAR WILL BE DRILLED INTO THE EXISTING DUCT AND EPOXIED TO KEEP THE SHORT DUCT EXTENSIONS FROM SEPARATING FROM THE MAIN DUCT.

THE CONTRACTOR WILL ENCASE THE DUCTS WITH CONCRETE AFTER THEY HAVE BEEN EXTENDED.

THE DUCT EXTENSION WILL BE PAID FOR UNDER THE FOLLOWING ITEM:  
AR110552 "EXTEND 2-WAY DUCT" 19 L.F.

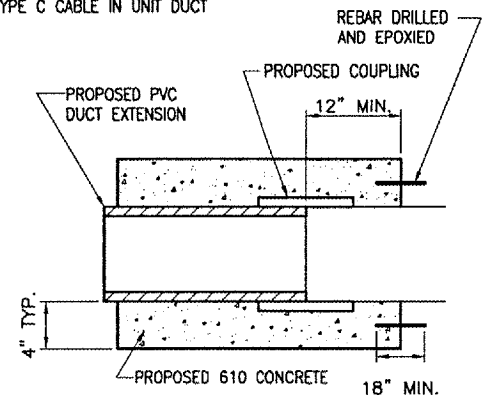

**LEGEND**

- EXISTING IMPROVEMENTS
- PROPOSED IMPROVEMENTS
- EXISTING ELECTRICAL CABLES
- PROPOSED ELECTRICAL CABLES
- EXISTING ELECTRICAL DUCT
- EXISTING SPLICE CAN
- EXISTING DUCT MARKER
- EXISTING STAKE MOUNTED RUNWAY LIGHT
- PROPOSED RELOCATED STAKE MOUNTED RUNWAY LIGHT
- PROPOSED STAKE MOUNTED RUNWAY LIGHT
- PROPOSED BASE MOUNTED RUNWAY LIGHT

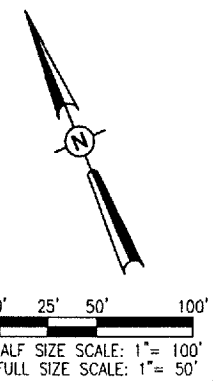

EF005

DATE	REVISION	BY

EFFINGHAM COUNTY  
MEMORIAL AIRPORT  
EFFINGHAM, ILLINOIS

A.I.P. PROJ.: 3-17-0040-811  
IL PROJ.: 1H2-3761

Project No.: 07A0143D_0800	Element: R-142ELE.DWG	Date: 02/12/08
Scale: 1" = 50'		
LAYOUT	KOM	11/28/07
DRAWN	BAK	11/28/07
REVIEWED	CAH	02/12/08

**HANSON**  
Hanson Professional Services Inc.  
1525 South Sixth Street  
Springfield, Illinois 62703-2886  
Offices Nationwide

WIDEN RUNWAY 11/29  
AND REPLACE MRL'S  
PROPOSED  
ELECTRICAL PLAN  
STA. 147+00 TO STA. 123+00