

QUANTITIES				
ITEM No.	DESCRIPTION	UNIT	QUANTITY	AS BUILT QUANTITY
AR901510	SEEDING	ACRE	0.2	
AR908510	MULCHING	ACRE	0.2	

- LEGEND**
- EXISTING PAVEMENT
 - EXISTING BUILDING
 - EXISTING PROPERTY LINE
 - EXISTING DRAINAGE DITCH
 - EXISTING CLASS E FENCE
 - EXISTING INLET
 - EXISTING AIRPORT ROTATING BEACON
 - EXISTING GRADE
 - PROPOSED GRADE
 - PROPOSED P.C.C. PAVEMENT
 - PROPOSED END SECTION
 - PROPOSED SEEDING & MULCHING LIMITS

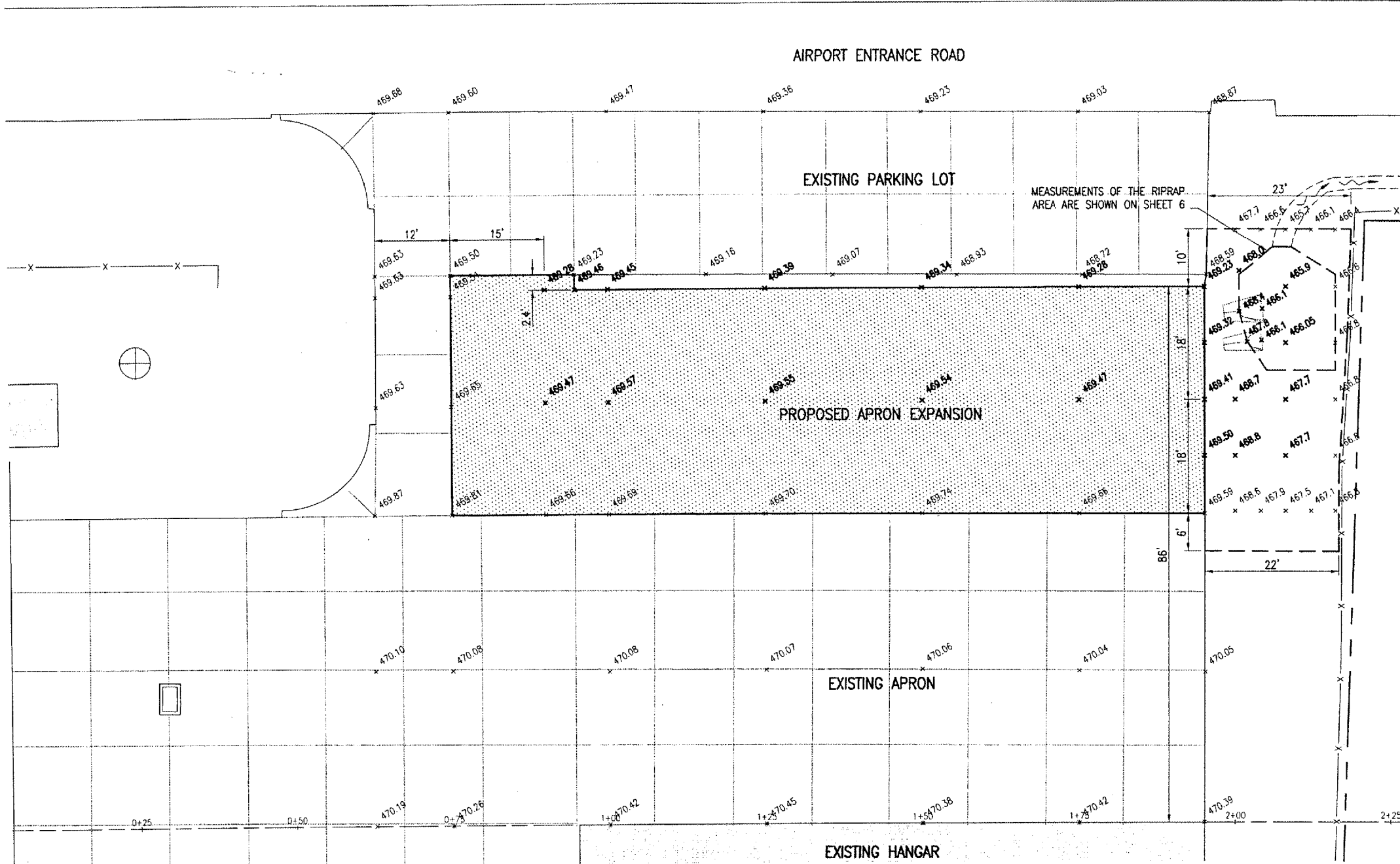

901 SEEDING NOTES

THE PROPOSED SEEDING SHALL BE ACCOMPLISHED IN ACCORDANCE WITH ITEM 901 "SEEDING" AS STATED ON PAGE 120 OF THE SUPPLEMENTAL SPECIFICATIONS AND RECURRING SPECIAL PROVISIONS, ADOPTED JULY 1, 2004.

ALL DISTURBED AREAS LOCATED WITHIN THE PROPOSED GRADING AND SEEDING LIMITS WILL BE SEEDDED IN ACCORDANCE WITH THE ABOVE NOTED SPECIFICATION. ALL AREAS OUTSIDE THE DESIGNATED GRADING AND SEEDING LIMITS WILL ALSO BE SEEDDED BUT AT THE CONTRACTOR'S OWN EXPENSE.

901-3.4 MAINTENANCE OF SEEDDED AREAS. DELETE THE SECOND PARAGRAPH OF THIS SECTION AND ADD THE FOLLOWING:

"THE CONTRACTOR WILL BE REQUIRED TO ESTABLISH A GOOD STAND OF GRASS OF UNIFORM COLOR AND DENSITY TO THE SATISFACTION OF THE RESIDENT ENGINEER. IF AT THE TIME WHEN THE CONTRACT HAS BEEN OTHERWISE COMPLETED, IT IS NOT POSSIBLE TO MAKE AN ADEQUATE DETERMINATION OF COLOR, DENSITY, AND UNIFORMITY OF SUCH STAND OF GRASS, THE ITEM OF WORK WILL BE REVIEWED AT A LATER DATE DETERMINED BY THE ILLINOIS DIVISION OF AERONAUTICS."

DATE SEEDING COMPLETED _____

THE PROPOSED SEEDING WILL BE PAID FOR UNDER ITEMS:
AR901510 "SEEDING" - PER ACRE

908 MULCHING NOTES

THE PROPOSED MULCHING SHALL BE ACCOMPLISHED IN ACCORDANCE WITH ITEM 908 "MULCHING" AS STATED ON PAGE 127 OF THE SUPPLEMENTAL SPECIFICATIONS AND RECURRING SPECIAL PROVISIONS, ADOPTED JULY 1, 2004.

THIS ITEM SHALL CONSIST OF THE FURNISHING, TRANSPORTING, AND PLACING MULCH OVER THE SEEDDED AREA. DISTURBED AREAS OUTSIDE THE GRADING LIMITS SHALL ALSO BE MULCHED AND PARTICIPATION WILL BE THE SAME AS FOR SEEDDED AREAS.

908-2.1 MULCH MATERIAL: THE CONTRACTOR MAY EITHER FURNISH STRAW OR HYDROMULCH AS THE TYPE OF MULCH MATERIAL TO BE USED ON THIS PROJECT.

908-3.1 MULCHING: THE HYDRAULIC MULCH SHALL BE APPLIED AS A SLURRY OF 2,500 POUNDS OF MULCH AND NOT LESS THAN 2,500 GALLONS OF WATER PER ACRE.

908-3.4 STRUCTURE CLEANING: AFTER THE PROPOSED MULCH HAS BEEN APPLIED, THE CONTRACTOR WILL CLEAN THE MULCH OFF ALL STRUCTURES (DRAINAGE, ELECTRICAL, LIGHTS, ETC.).

DATE MULCHING COMPLETED _____

THE PROPOSED MULCHING WILL BE PAID FOR UNDER ITEMS:
AR908510 "MULCHING" - PER ACRE

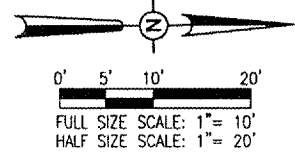

BY	REVISION	DATE

FLORA AIRPORT
FLORA, ILLINOIS

IL PROJ.: FOA-3758 A.I.P. PROJ.: 3-17-0044-B14

Project No. 07A0122D_0800	CCC	12/24/07
Filename: R-191STK.DWG	CCC	12/24/07
Scale: 1" = 10'	CAH	01/25/08
Date: 01/15/08		
LAYOUT		
DRAWN		
REVIEWED		

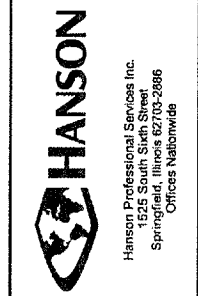

EXPAND
HANGAR PAVEMENT

PROPOSED STAKING PLAN

MAR 12, 2008 8:06 AM HAGL000382
 I:\AIRPORTS\FLORA\07A0122\CAD\SHEETS\R-191STK.DWG - Layout1