

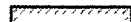



LEGEND

-  LIMITS OF PROPOSED LIGHTING IMPROVEMENTS
-  EXISTING HANGAR/BUILDING
-  EXISTING PAVEMENT
-  BENCHMARK/CONTROL POINT
-  EXISTING AIRPORT PROPERTY LINE

REVISIONS		
NUMBER	BY	DATE

0 1 2
 THIS BAR IS EQUAL TO 2"
 AT FULL SCALE (34X22).

**GREATER KANKAKEE AIRPORT
 KANKAKEE, ILLINOIS
 REHABILITATE AIRFIELD LIGHTING SYSTEM -
 RUNWAY 16/34 AND TAXIWAY H**

SITE PLAN/PROJECT CONTROL PLAN

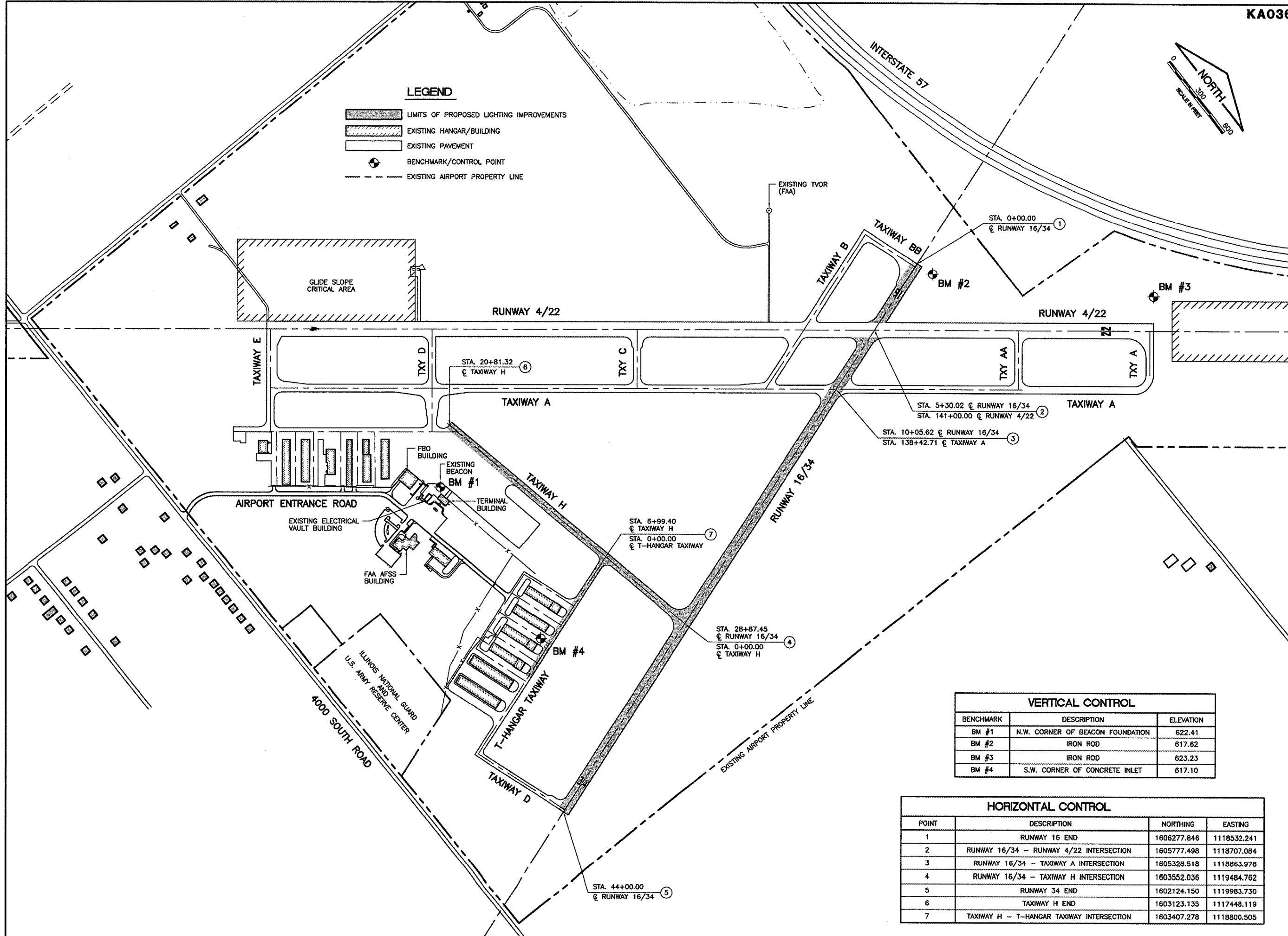

VERTICAL CONTROL		
BENCHMARK	DESCRIPTION	ELEVATION
BM #1	N.W. CORNER OF BEACON FOUNDATION	622.41
BM #2	IRON ROD	617.62
BM #3	IRON ROD	623.23
BM #4	S.W. CORNER OF CONCRETE INLET	617.10

HORIZONTAL CONTROL			
POINT	DESCRIPTION	NORTHING	EASTING
1	RUNWAY 16 END	1606277.846	1118532.241
2	RUNWAY 16/34 - RUNWAY 4/22 INTERSECTION	1605777.498	1118707.084
3	RUNWAY 16/34 - TAXIWAY A INTERSECTION	1605328.518	1118863.978
4	RUNWAY 16/34 - TAXIWAY H INTERSECTION	1603552.036	1119484.762
5	RUNWAY 34 END	1602124.150	1119983.730
6	TAXIWAY H END	1603123.135	1117448.119
7	TAXIWAY H - T-HANGAR TAXIWAY INTERSECTION	1603407.278	1118800.505

© Copyright GMT, Inc.
GMT
 CRAWFORD, MERRY & TILLY, INC.
 CONSULTING ENGINEERS
 License No. 84-006815

DESIGN BY: MND
 DRAWN BY: JRO
 CHECKED BY: MND
 APPROVED BY:
 DATE: 02/29/08
 JOB No: 07075-02
 IL PROJECT: IKK-3743
 A.I.P. PROJECT: 3-17-0057-B13
 SHEET 3 OF 17 SHEETS