

QUAD CITY INTERNATIONAL AIRPORT
TAXIWAY P, PHASE I - EARTHWORK
ILL. MLI-3790, QU006
SHEET 87 OF 94

⊙ CURVE DATA:

I = 90D 00' 00"
D = 38D 11' 49.92"
T = 150.00'
L = 235.62'
R = 150.00'
E = 62.13'
P.C. = 109+91.88
P.I. = 111+41.88
P.T. = 112+27.50

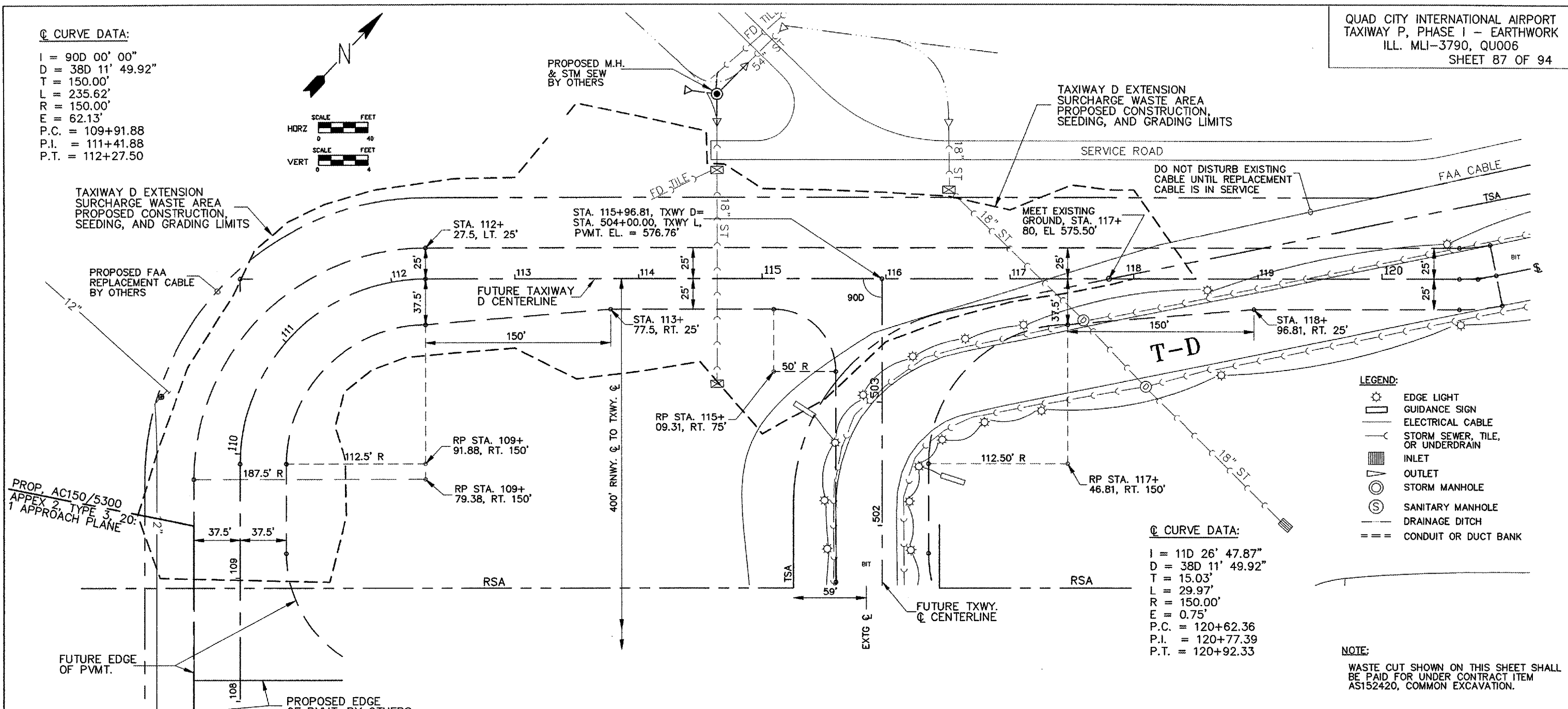
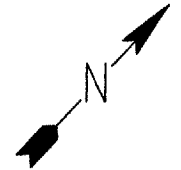
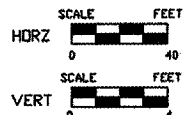

⊙ CURVE DATA:

I = 11D 26' 47.87"
D = 38D 11' 49.92"
T = 15.03'
L = 29.97'
R = 150.00'
E = 0.75'
P.C. = 120+62.36
P.I. = 120+77.39
P.T. = 120+92.33

- LEGEND:**
- ⊙ EDGE LIGHT
 - GUIDANCE SIGN
 - ELECTRICAL CABLE
 - - - STORM SEWER, TILE, OR UNDERDRAIN
 - ▨ INLET
 - ▽ OUTLET
 - ⊙ STORM MANHOLE
 - ⊙ SANITARY MANHOLE
 - - - DRAINAGE DITCH
 - == CONDUIT OR DUCT BANK

NOTE:
WASTE CUT SHOWN ON THIS SHEET SHALL BE PAID FOR UNDER CONTRACT ITEM AS152420, COMMON EXCAVATION.

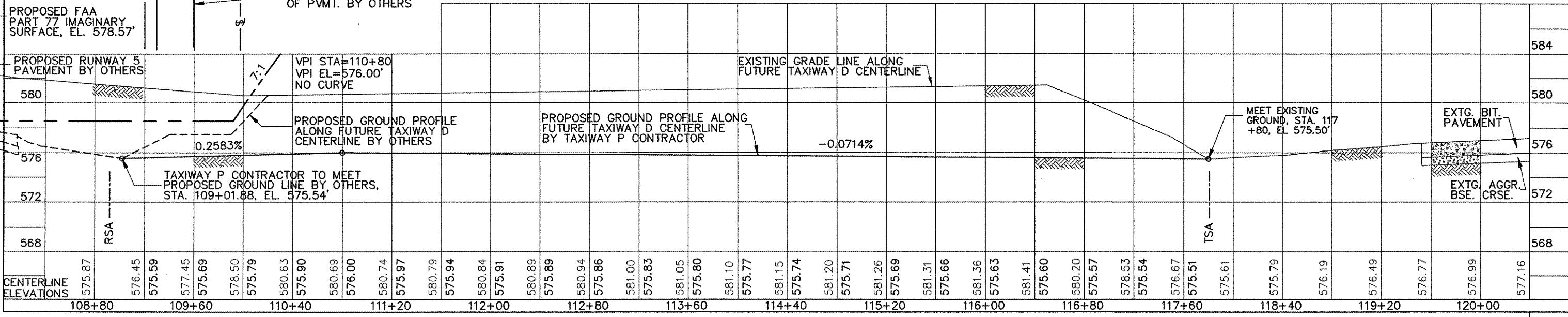

ADDITIVE ALTERNATE 1: TAXIWAY D PLAN & PROFILE, STA 108+00 TO STA 120+00 87/94

G:\AIRPORT\A077030 TP EARTHWORK\DSN\PP4.dwg, 4/21/2008 11:46:12 AM, jeffm