

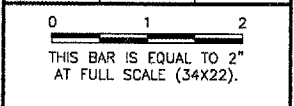

REVISIONS		
NUMBER	BY	DATE



**UNIVERSITY OF ILLINOIS
 WILLARD AIRPORT**

**REHABILITATE AIR CARRIER RAMP, PHASE 2
 STAKING PLAN 3 - TAXIWAY A6 & A7**

© Copyright CMT, Inc.





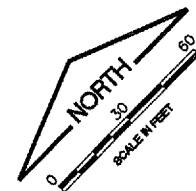

CMT
 CHAWFORD, MURPHY & TILLY, INC.
 CONSULTING ENGINEERS
 License No. 184-000618

DESIGN BY:	SMS
DRAWN BY:	CMT
CHECKED BY:	<i>SM</i>
APPROVED BY:	<i>SM</i>
DATE:	04/18/2008
JOB No:	0305903
CMI-3663 3-17-0016-XX	
SHEET 37 OF 57 SHEETS	

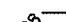

LEGEND

-  NEW PAVEMENT ELEVATION
-  EXISTING PAVEMENT ELEVATION
-  LIMITS OF BUTT JOINT CONSTRUCTION
-  NEW PAVEMENT CONTOURS

- NOTES**
- EXISTING ELEVATIONS SHOWN AT STA. 95+50 ARE TOP OF EXISTING PCC/BOTTOM OF BITUMINOUS TRANSITIONS.
 - ALL ELEVATIONS ARE ABOVE THE BASE ELEVATION OF 740 FEET TO IMPROVE CLARITY.

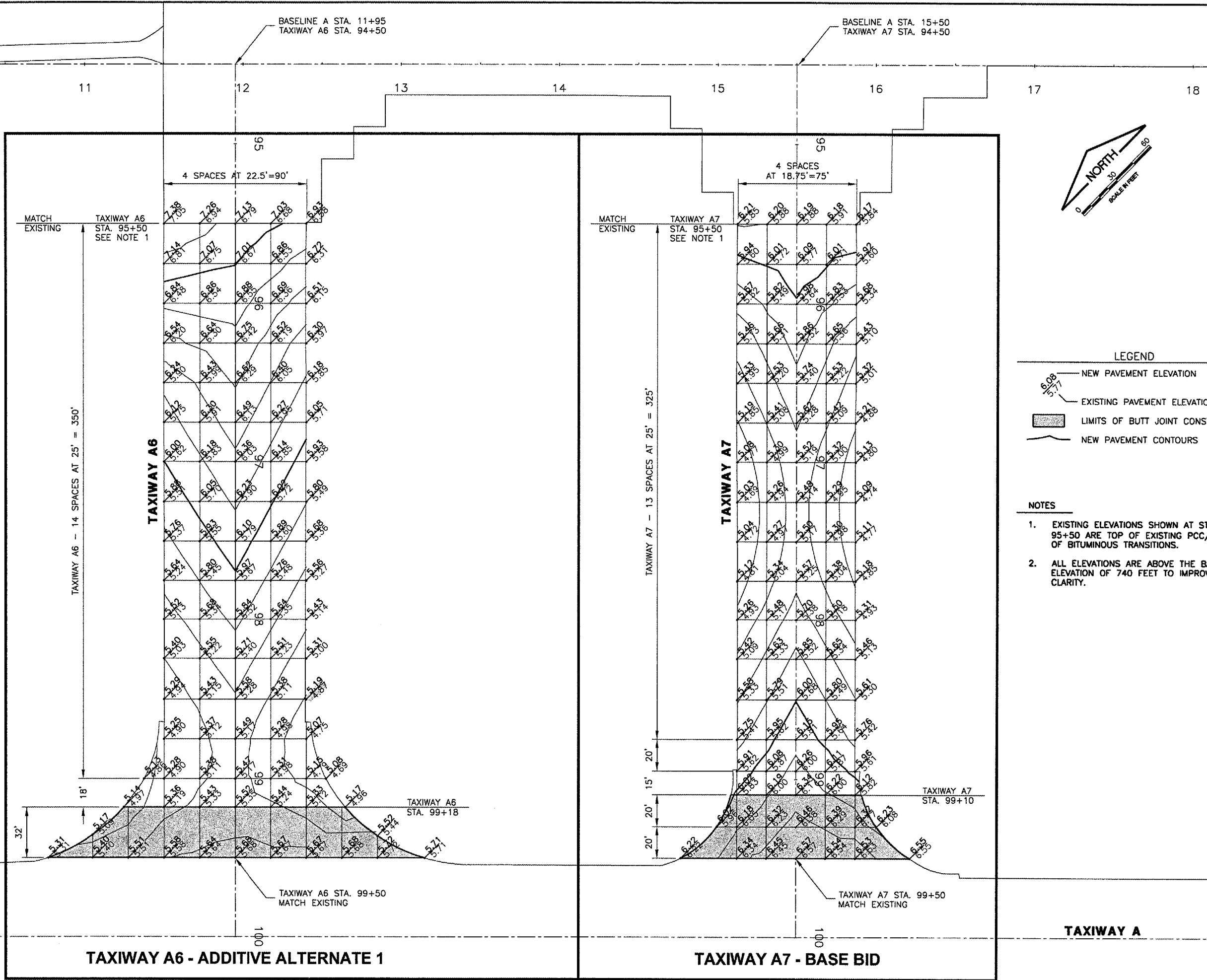

TAXIWAY A6 - ADDITIVE ALTERNATE 1

TAXIWAY A7 - BASE BID

TAXIWAY A