

CONTROL POINT 409
 STA. 3952+01.77 55.09' LT
 3/4" IRON PIPE 3' EAST OF FACE WALK, 12' WEST OF WEST BACK OF CURB OF ROUTE 59, AT PROPERTY LINE BETWEEN RED LOBSTER AND RADIOSHACK.
 N 860598.0011
 E 19051.3200
 ELEV. = 703.79

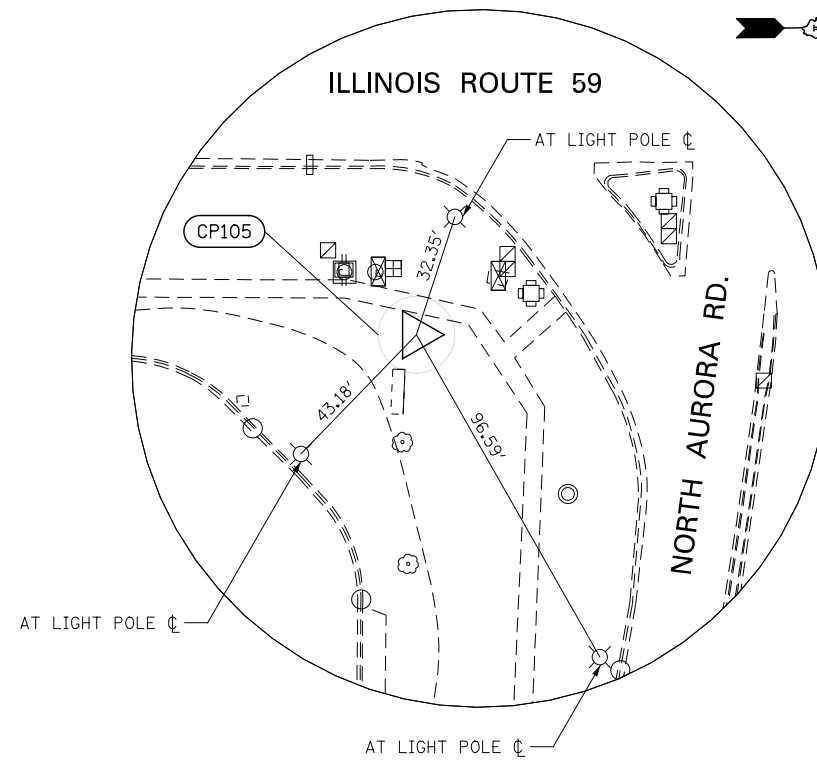

CONTROL POINT 105
 STA. 3975+40.67 90.26' RT
 3/4" IRON PIPE W/ CAP AT SOUTHEAST INTERSECTION OF ROUTE 59 AND NORTH AURORA RD., 5' EAST OF BACK WALK, 8' WEST OF DELTA SONIC SIGN.
 N 862934.9021
 E 19205.6610
 ELEV. = 705.10

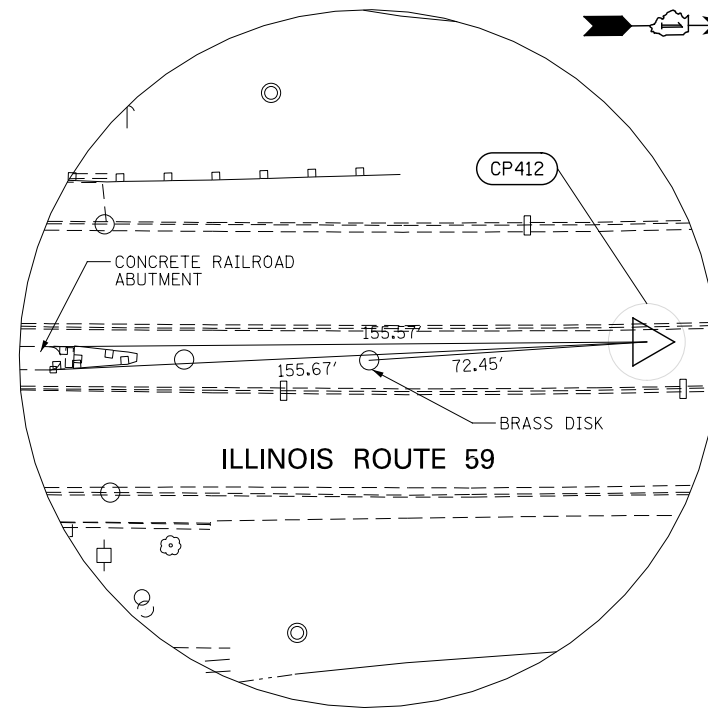

CONTROL POINT 412
 STA. 3966+62.18 04.42' LT
 CROSS (+) CUT IN ISLAND ON ROUTE 59, 150' NORTH OF CL NORTH OF RAILROAD BRIDGE PIER, 3' EAST OF WEST BACK OF CURB OF ISLAND.
 N 862057.5021
 E 19129.8910
 ELEV. = 688.16

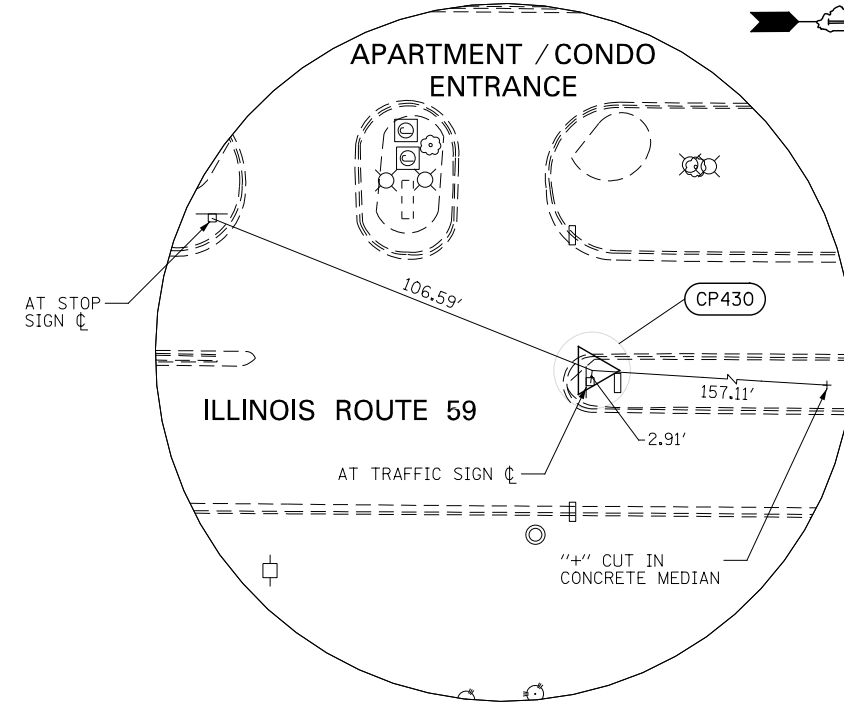

CONTROL POINT 430
 STA. 3994+25.34 02.71' LT
 MAG NAIL IN CONCRETE ISLAND NOSE, 3' EAST OF WEST BACK OF CURB POINT OF CURVE AND 5' NORTH OF NOSE OF ISLAND, EAST OF ENTRANCE TO COURTYARDS VILLAGE APARTMENTS.
 N 864820.1021
 E 19124.2910
 ELEV. = 710.38

DESIGNED *PJO*
 DRAWN *KES*
 CHECKED *JCM*
 DATE *12/14/2012*

REVISED -
 REVISED -
 REVISED -
 REVISED -

**STATE OF ILLINOIS
 DEPARTMENT OF TRANSPORTATION**

ALIGNMENT, TIES, AND BENCHMARKS

SCALE: AS SHOWN SHEET NO. 7 OF 8 SHEETS STA. TO STA.

F.A.P. RTE.	SECTION	COUNTY	TOTAL SHEETS	SHEET NO.
338	(112 & 113) WRS-7	DUPAGE	1156	93
CONTRACT NO. 60R30				
ILLINOIS FED. AID PROJECT				