

W21-I115(0)-3618
 R2-1-3648
 R10-19aP-3618
 R21-I106-3618

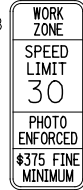

FOR CONTINUATION SEE
 ILLINOIS ROUTE 59
 MAINTENANCE OF TRAFFIC PLANS

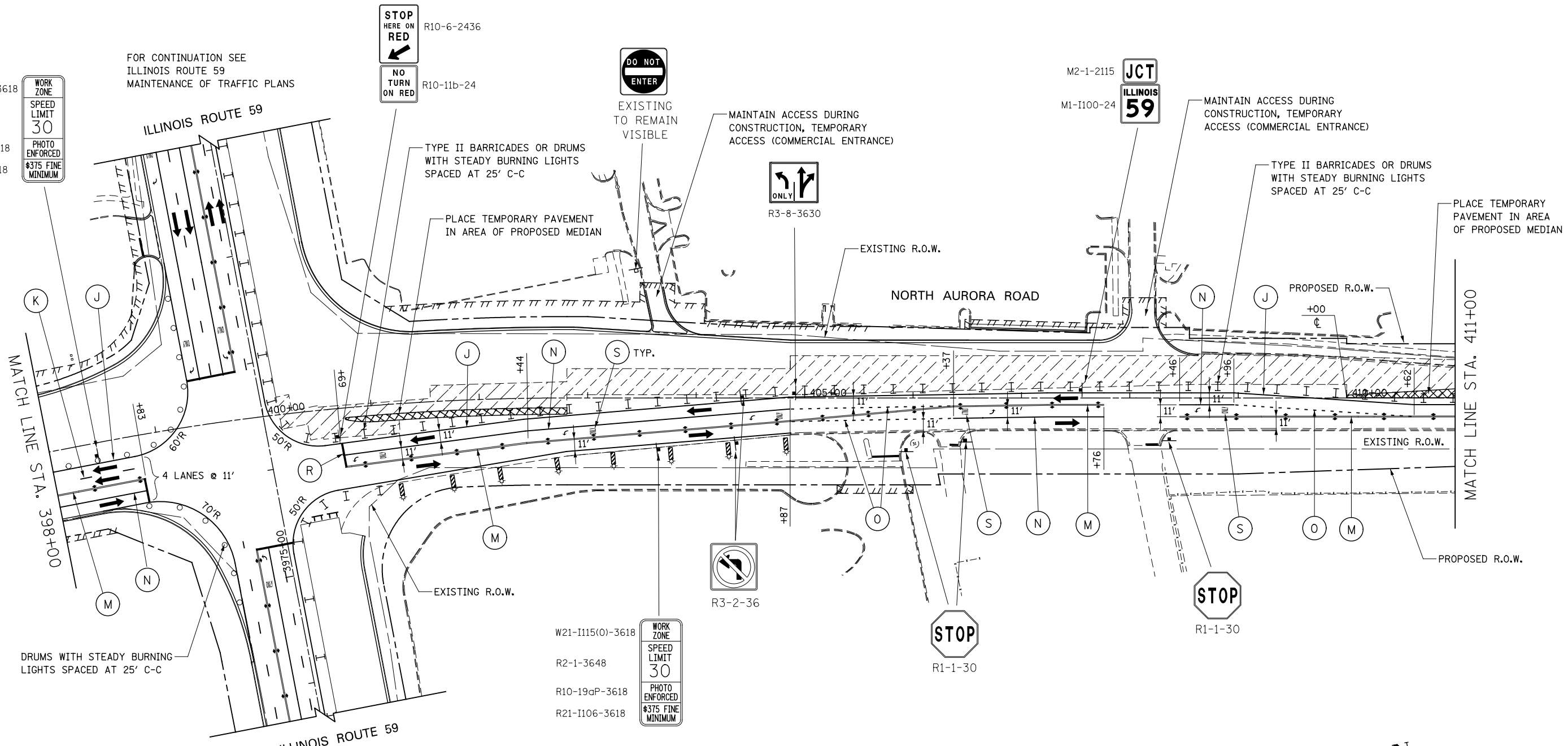

DRUMS WITH STEADY BURNING
 LIGHTS SPACED AT 25' C-C

FOR CONTINUATION SEE
 ILLINOIS ROUTE 59
 MAINTENANCE OF TRAFFIC PLANS

W21-I115(0)-3618
 R2-1-3648
 R10-19aP-3618
 R21-I106-3618



**STATE OF ILLINOIS
 DEPARTMENT OF TRANSPORTATION**

**MAINTENANCE OF TRAFFIC - STAGE 2A
 NORTH AURORA ROAD**

SCALE: AS SHOWN SHEET NO. 116 OF 195 SHEETS STA. 398+00 TO STA. 411+00

F.A.P. RTE.	SECTION	COUNTY	TOTAL SHEETS	SHEET NO.
338	(112 & 113) WRS-7	DUPAGE	1156	210
CONTRACT NO. 60R30				
ILLINOIS FED. AID PROJECT				

