

ADVANCE SIGNING FOR GLACIER PARK AVENUE / HIGH GROVE LANE

(SPACING MAY VARY DUE TO FIELD CONDITIONS)

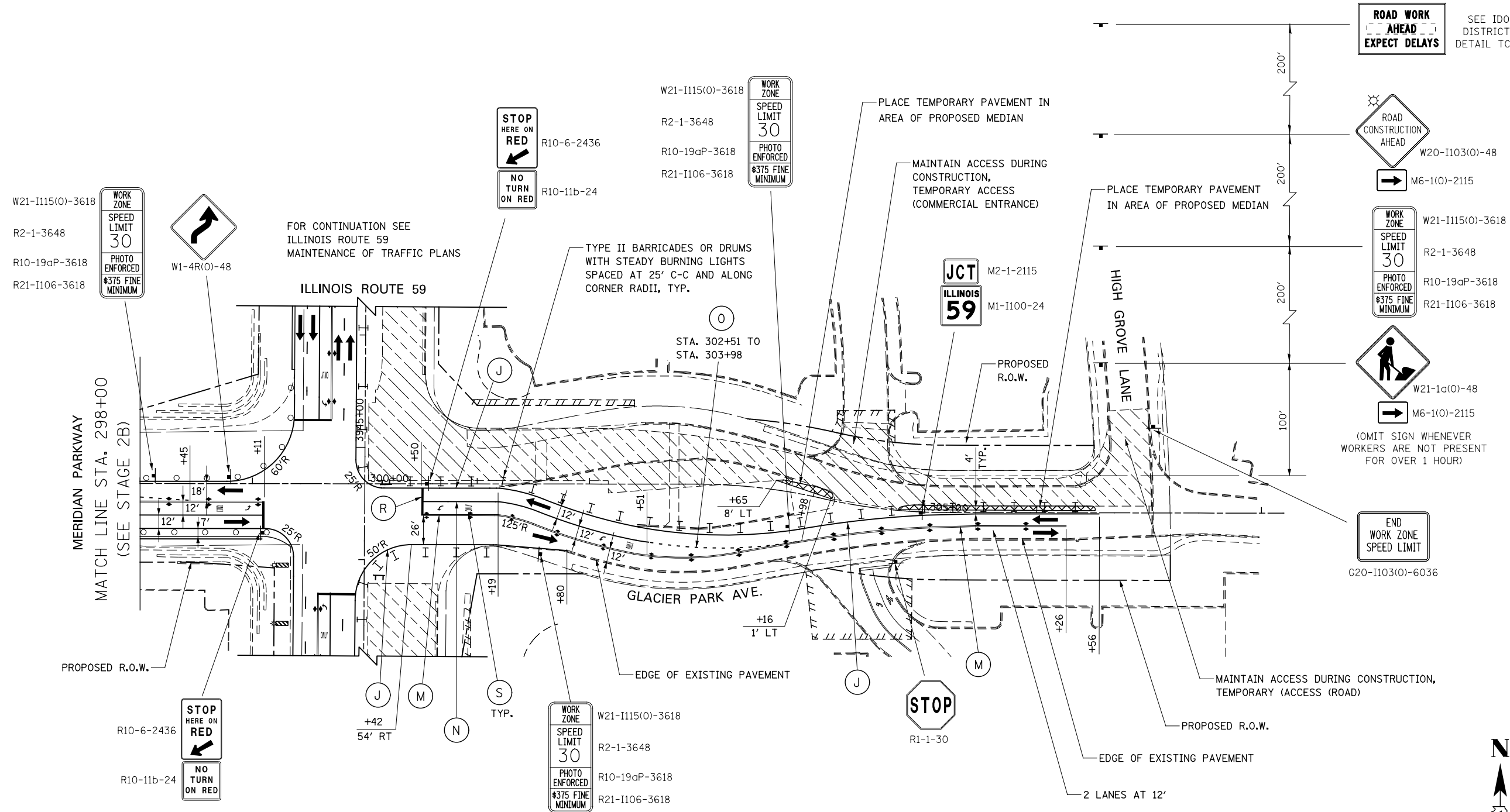

SEE IDOT DISTRICT 1 DETAIL TC-22

ROAD CONSTRUCTION AHEAD
W20-1103(0)-48

M6-1(0)-2115

WORK ZONE SPEED LIMIT 30 PHOTO ENFORCED \$375 FINE MINIMUM
W21-1115(0)-3618
R2-1-3648
R10-19aP-3618
R21-1106-3618

W21-1a(0)-48
M6-1(0)-2115
(OMIT SIGN WHENEVER WORKERS ARE NOT PRESENT FOR OVER 1 HOUR)

END WORK ZONE SPEED LIMIT
G20-1103(0)-6036

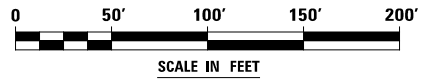
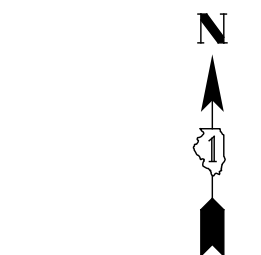

W21-1115(0)-3618
R2-1-3648
R10-19aP-3618
R21-1106-3618

MATCH LINE STA. 298+00 (SEE STAGE 2B)

STOP HERE ON RED
NO TURN ON RED
R10-6-2436
R10-11b-24

STOP HERE ON RED
NO TURN ON RED
R10-6-2436
R10-11b-24

W21-1115(0)-3618
R2-1-3648
R10-19aP-3618
R21-1106-3618

WORK ZONE SPEED LIMIT 30 PHOTO ENFORCED \$375 FINE MINIMUM
W21-1115(0)-3618
R2-1-3648
R10-19aP-3618
R21-1106-3618

JCT ILLINOIS 59
M2-1-2115
M1-1100-24

STOP
R1-1-30

FOR CONTINUATION SEE ILLINOIS ROUTE 59 MAINTENANCE OF TRAFFIC PLANS

TYPE II BARRICADES OR DRUMS WITH STEADY BURNING LIGHTS SPACED AT 25' C-C AND ALONG CORNER RADII, TYP.

PLACE TEMPORARY PAVEMENT IN AREA OF PROPOSED MEDIAN

MAINTAIN ACCESS DURING CONSTRUCTION, TEMPORARY ACCESS (COMMERCIAL ENTRANCE)

PLACE TEMPORARY PAVEMENT IN AREA OF PROPOSED MEDIAN

MAINTAIN ACCESS DURING CONSTRUCTION, TEMPORARY (ACCESS ROAD)

EDGE OF EXISTING PAVEMENT

2 LANES AT 12'

ILLINOIS ROUTE 59

GLACIER PARK AVE.

HIGH GROVE LANE

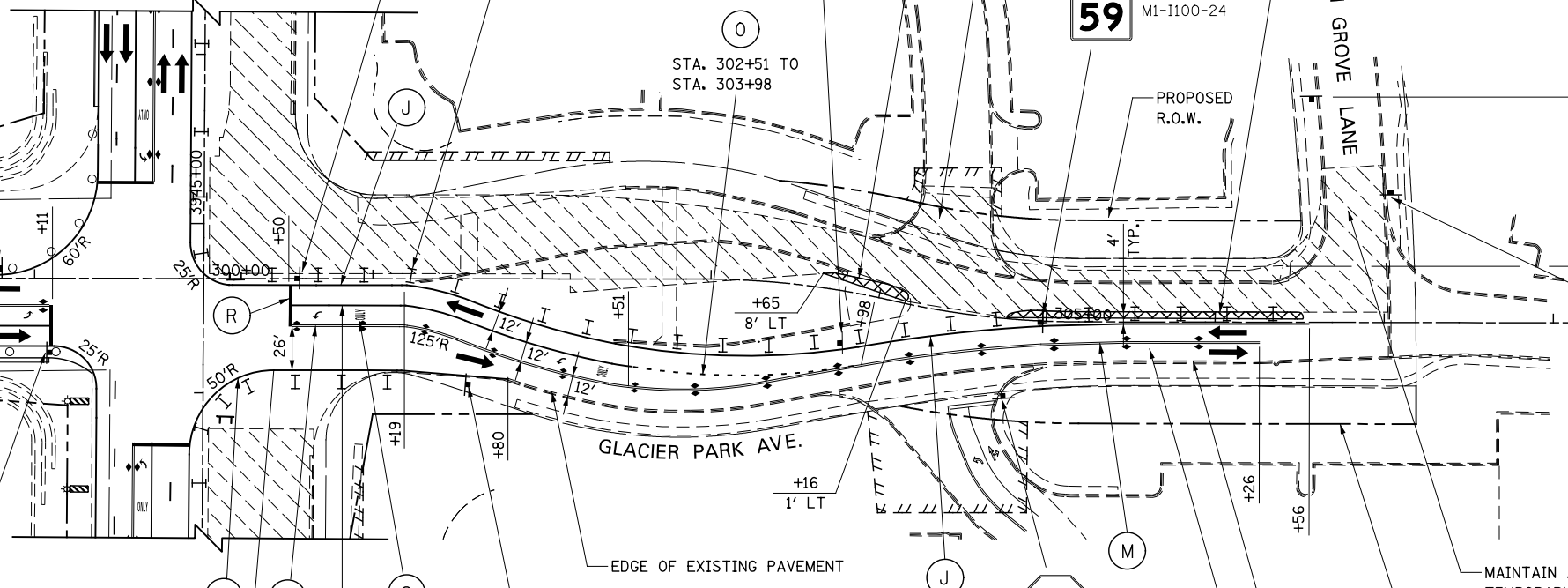

DESIGNED	PJO	REVISED	-
DRAWN	KES	REVISED	-
CHECKED	JCM	REVISED	-
DATE	12/14/2012	REVISED	-

STATE OF ILLINOIS
DEPARTMENT OF TRANSPORTATION

MAINTENANCE OF TRAFFIC - STAGE 3
GLACIER PARK AVENUE

SCALE: AS SHOWN SHEET NO. 134 OF 195 SHEETS STA. 298+00 TO STA. 308+00

F.A.P. RTE.	SECTION	COUNTY	TOTAL SHEETS	SHEET NO.
338	(112 & 113) WRS-7	DUPAGE	1156	226
CONTRACT NO. 60R30				
ILLINOIS FED. AID PROJECT				