

PLAN	SURVEYED	DATE
	PLOTTED	BY
	CHECKED	
	ALIGNED	
	FILED	
	FILE NAME	
	NO.	

PROFILE	SURVEYED	DATE
	GRADES CHECKED	BY
	STRUCTURE	
	NOT AT THIS OFFICE	
	NO.	

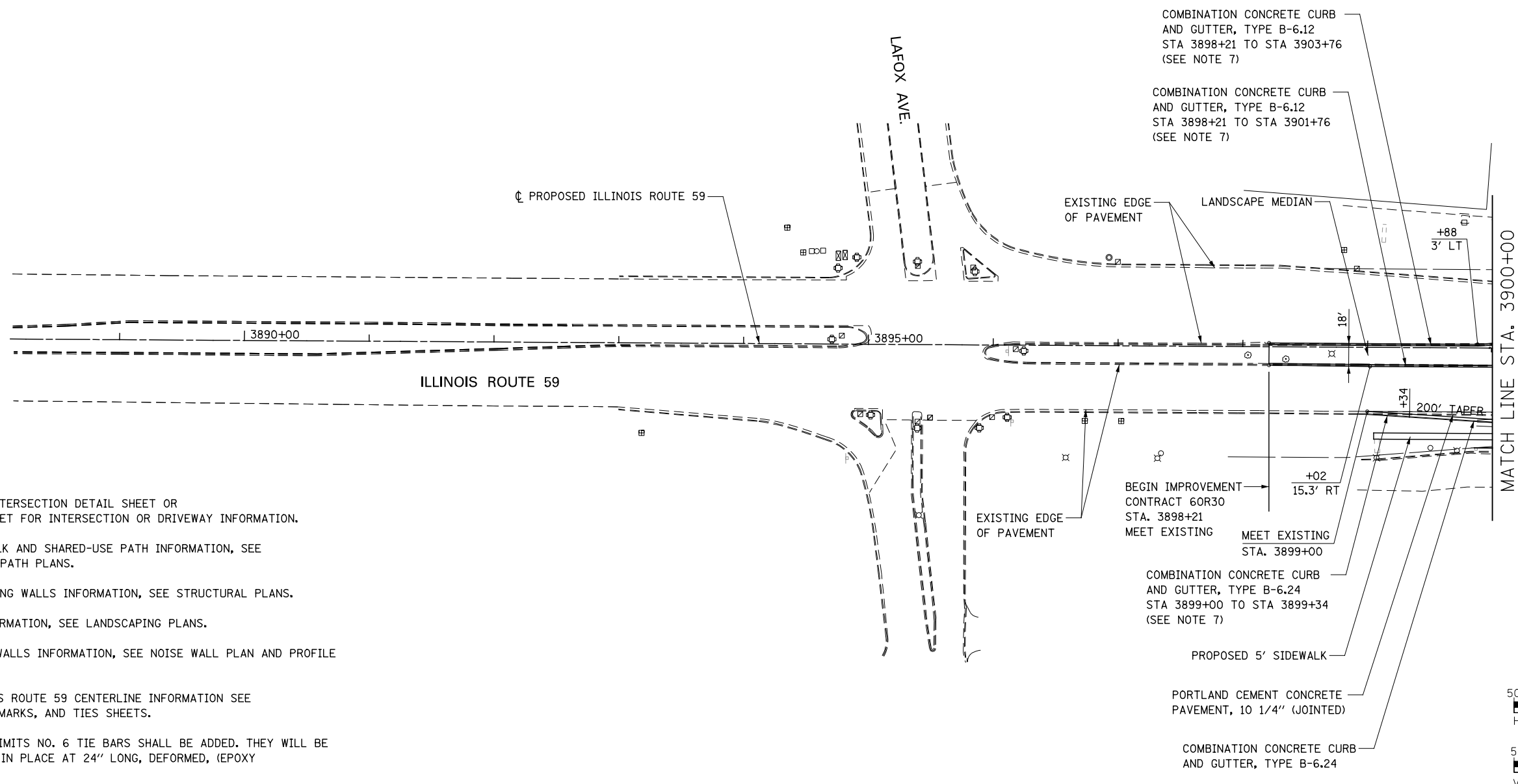

**NOTES:**

- SEE CORRESPONDING INTERSECTION DETAIL SHEET OR DRIVEWAY DETAILS SHEET FOR INTERSECTION OR DRIVEWAY INFORMATION.
- FOR PROPOSED SIDEWALK AND SHARED-USE PATH INFORMATION, SEE SIDEWALK/SHARED-USE PATH PLANS.
- FOR PROPOSED RETAINING WALLS INFORMATION, SEE STRUCTURAL PLANS.
- FOR LANDSCAPING INFORMATION, SEE LANDSCAPING PLANS.
- FOR PROPOSED NOISE WALLS INFORMATION, SEE NOISE WALL PLAN AND PROFILE SHEETS.
- FOR PROPOSED ILLINOIS ROUTE 59 CENTERLINE INFORMATION SEE THE ALIGNMENT, BENCHMARKS, AND TIES SHEETS.
- WITHIN THE STATION LIMITS NO. 6 TIE BARS SHALL BE ADDED. THEY WILL BE DRILLED AND GROUTED IN PLACE AT 24" LONG, DEFORMED, (EPOXY COATED) AT 24" CTS.

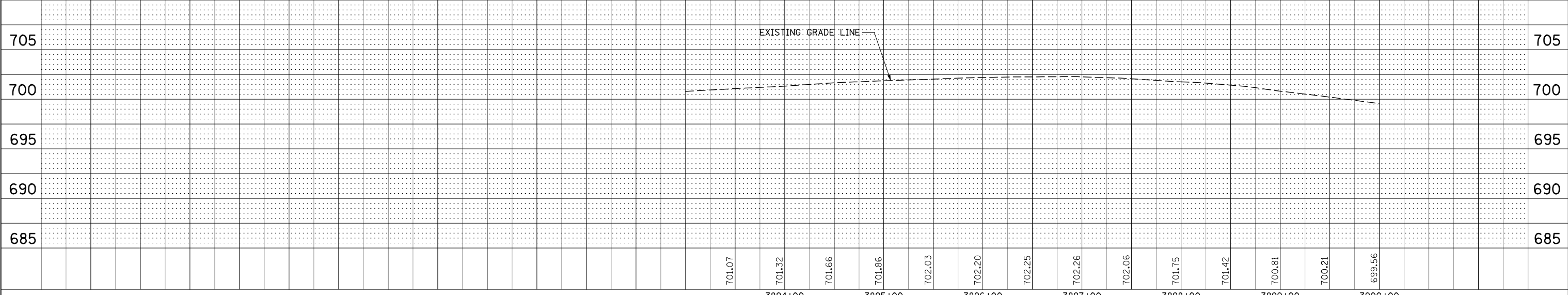
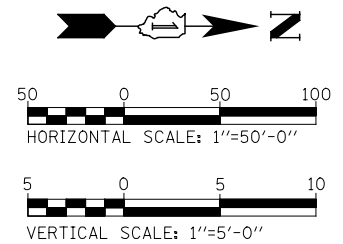

DESIGNED	PJO	REVISED	-
DRAWN	KES	REVISED	-
CHECKED	JCM	REVISED	-
DATE	12/14/2012	REVISED	-

**STATE OF ILLINOIS  
DEPARTMENT OF TRANSPORTATION**

**PLAN AND PROFILE - ILLINOIS ROUTE 59**

SCALE: AS SHOWN SHEET NO. 1 OF 16 SHEETS STA. 3898+21 TO STA. 3900+00

F.A.P. RTE.	SECTION	COUNTY	TOTAL SHEETS	SHEET NO.
338	(112 & 113) WRS-7	DUPAGE	1156	301
CONTRACT NO. 60R30				
FED. ROAD DIST. NO. ILLINOIS FED. AID PROJECT				