

PLAN	SURVISED	DATE
	PLOTTED	
	CHECKED	
	ALIGNED	
	FILED	
	NO.	

PROFILE	SURVISED	DATE
	PLOTTED	
	CHECKED	
	GRADES	
	STRUCTURE	
	NOTATIONS	
	CHWD	
	NO.	

FOR CONTINUATION OF IMPROVEMENT  
SEE MERIDIAN PARKWAY / GLACIER PARK DR.  
PLAN-PROFILE SHEETS

HOT-MIX ASPHALT PAVEMENT (FULL-DEPTH), 12"  
STA. 3944+67.58 ILLINOIS ROUTE 59 =  
STA. 300+00.00 MERIDIAN PKWY./GLACIER PARK DR. =  
STA. 100+00.00 (PLAT OF HIGHWAYS)

NOTES:

1. SEE CORRESPONDING INTERSECTION DETAIL SHEET OR DRIVEWAY DETAILS SHEET FOR INTERSECTION OR DRIVEWAY INFORMATION.
2. FOR PROPOSED SIDEWALK AND SHARED-USE PATH INFORMATION, SEE SIDEWALK/SHARED-USED PATH PLANS.
3. FOR PROPOSED RETAINING WALLS INFORMATION, SEE STRUCTURAL PLANS.
4. FOR LANDSCAPING INFORMATION, SEE LANDSCAPING PLANS.
5. FOR PROPOSED NOISE WALLS INFORMATION, SEE NOISE WALL PLAN AND PROFILE SHEETS.
6. FOR PROPOSED ILLINOIS ROUTE 59 CENTERLINE INFORMATION SEE THE ALIGNMENT, BENCHMARKS, AND TIES SHEETS.

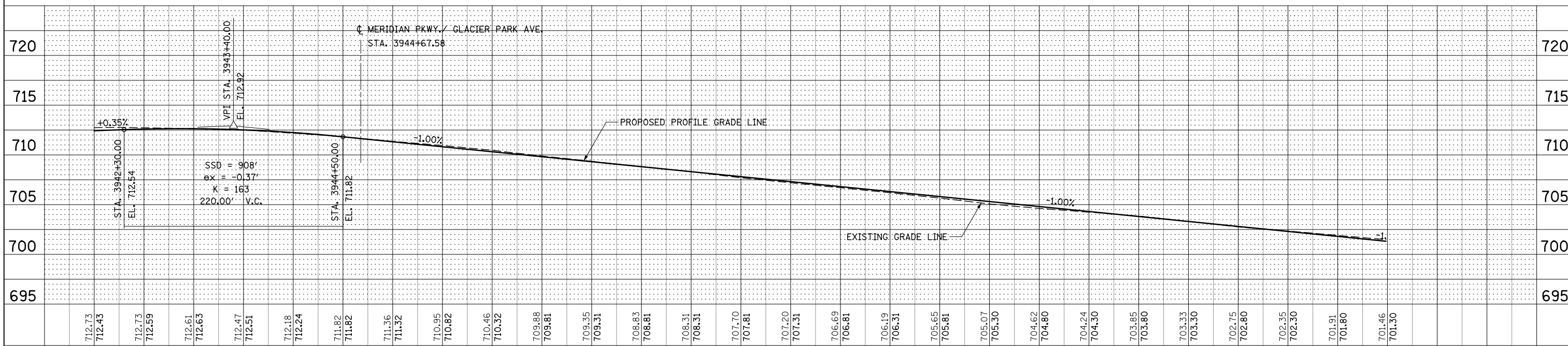
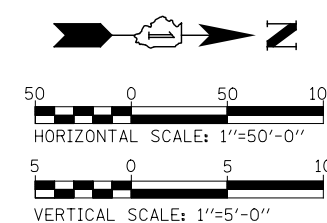
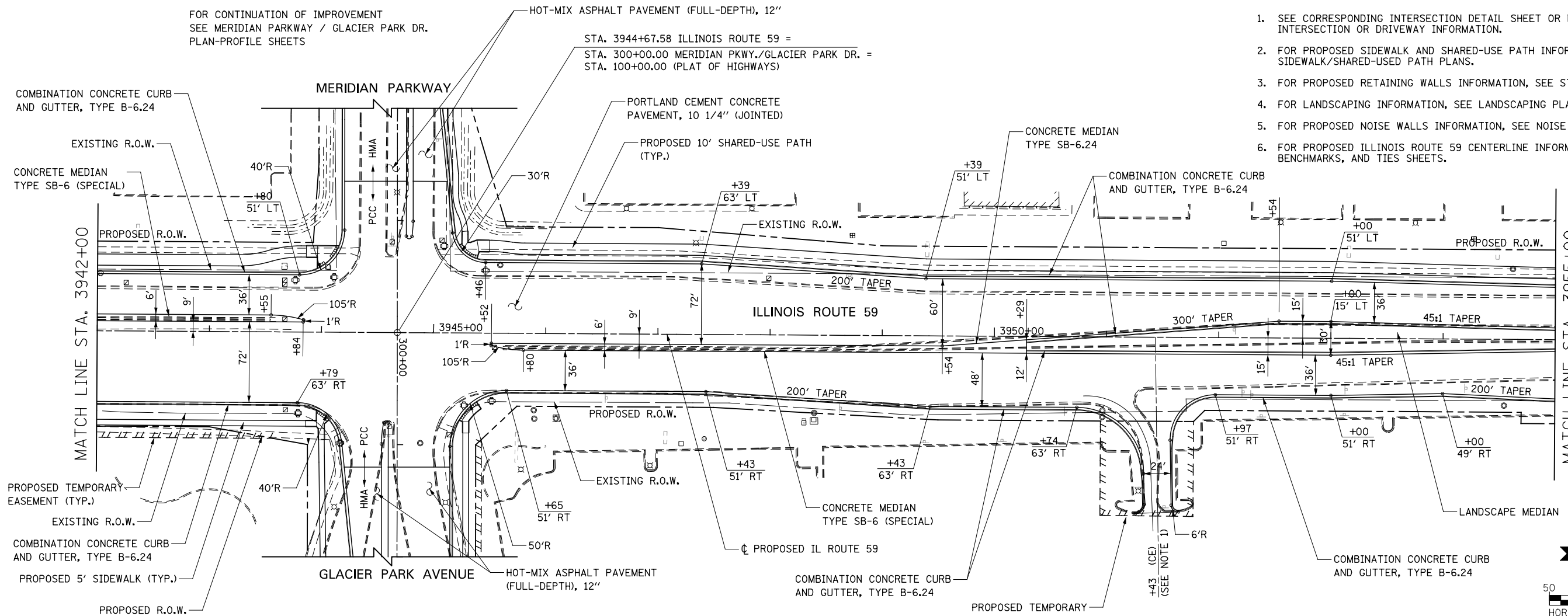

DESIGNED	PJO	REVISED	-
DRAWN	KES	REVISED	-
CHECKED	JCM	REVISED	-
DATE	12/14/2012	REVISED	-

STATE OF ILLINOIS  
DEPARTMENT OF TRANSPORTATION

PLAN AND PROFILE - ILLINOIS ROUTE 59

SCALE: AS SHOWN SHEET NO. 5 OF 16 SHEETS STA. 3942+00 TO STA. 3955+00

F.A.P. RTE.	SECTION	COUNTY	TOTAL SHEETS	SHEET NO.
338	(112 & 113) WRS-7	DUPAGE	1156	305
CONTRACT NO. 60R30				
ILLINOIS FED. AID PROJECT				