

PLAN	DATE
BY	
CHECKED	
DATE	
DESIGNED	
DATE	
NOTED	
DATE	
STRUCTURE	
ADJUSTING	
CPD	

PROFILE	DATE
BY	
CHECKED	
DATE	
DESIGNED	
DATE	
NOTED	
DATE	
STRUCTURE	
ADJUSTING	
CPD	

NOTES:

- SEE CORRESPONDING INTERSECTION DETAIL SHEET OR DRIVEWAY DETAILS SHEET FOR INTERSECTION OR DRIVEWAY INFORMATION.
- FOR PROPOSED SIDEWALK AND SHARED-USE PATH INFORMATION, SEE SIDEWALK/SHARED-USED PATH PLANS.
- FOR PROPOSED RETAINING WALLS INFORMATION, SEE STRUCTURAL PLANS.
- FOR LANDSCAPING INFORMATION, SEE LANDSCAPING PLANS.
- FOR PROPOSED NOISE WALLS INFORMATION, SEE NOISE WALL PLAN AND PROFILE SHEETS.
- FOR HMA ASPHALT PAVEMENT MIX INFORMATION, SEE TABLE FOR HOT-MIX ASPHALT MIXTURE REQUIREMENT.
- ALL WORK REQUIRED FOR THE CONSTRUCTION OF COMBINATION CONCRETE CURB AND GUTTER TRANSITION SHALL BE PAID FOR AS COMBINATION CURB AND GUTTER, TYPE B-6.24.
- FOR PROPOSED NORTH AURORA ROAD CENTERLINE INFORMATION SEE THE ALIGNMENT, BENCHMARKS, AND TIES SHEETS.
- THE EXISTING PRIVATE LIGHT POLE WITHIN THE TEMPORARY EASEMENT WILL REMAIN. UTMOST CARE SHALL BE TAKEN WHEN WORK TAKES PLACE IN THE VICINITY OF THE LIGHT POLE. ANY DAMAGE TO THE LIGHT POLE BY THE CONTRACTOR AS DETERMINED BY THE ENGINEER SHALL BE REPAIRED OR REPLACED AT THE CONTRACTOR'S OWN EXPENSE. NO ADDITIONAL COMPENSATION TO THE CONTRACT WILL BE ADDED FOR THIS WORK.

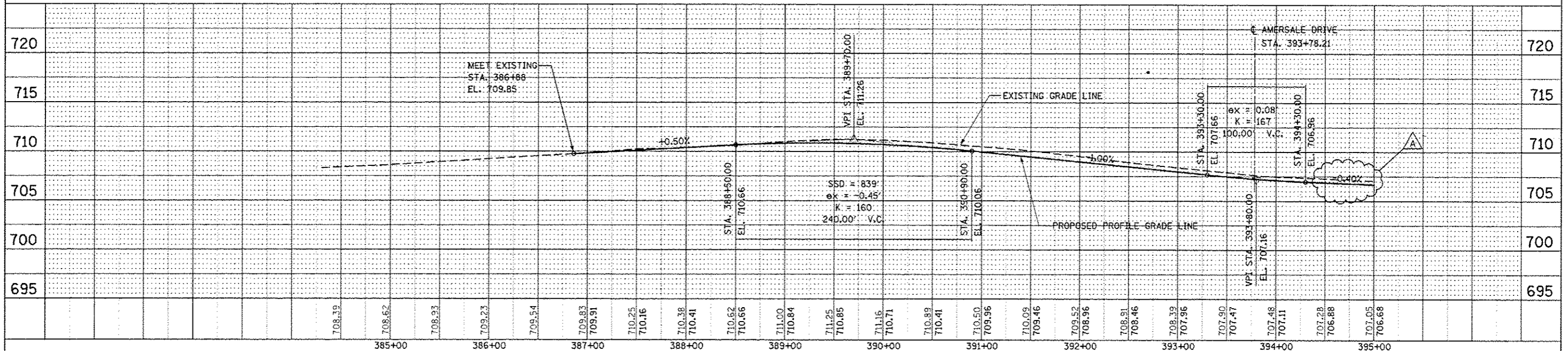
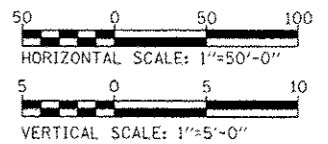
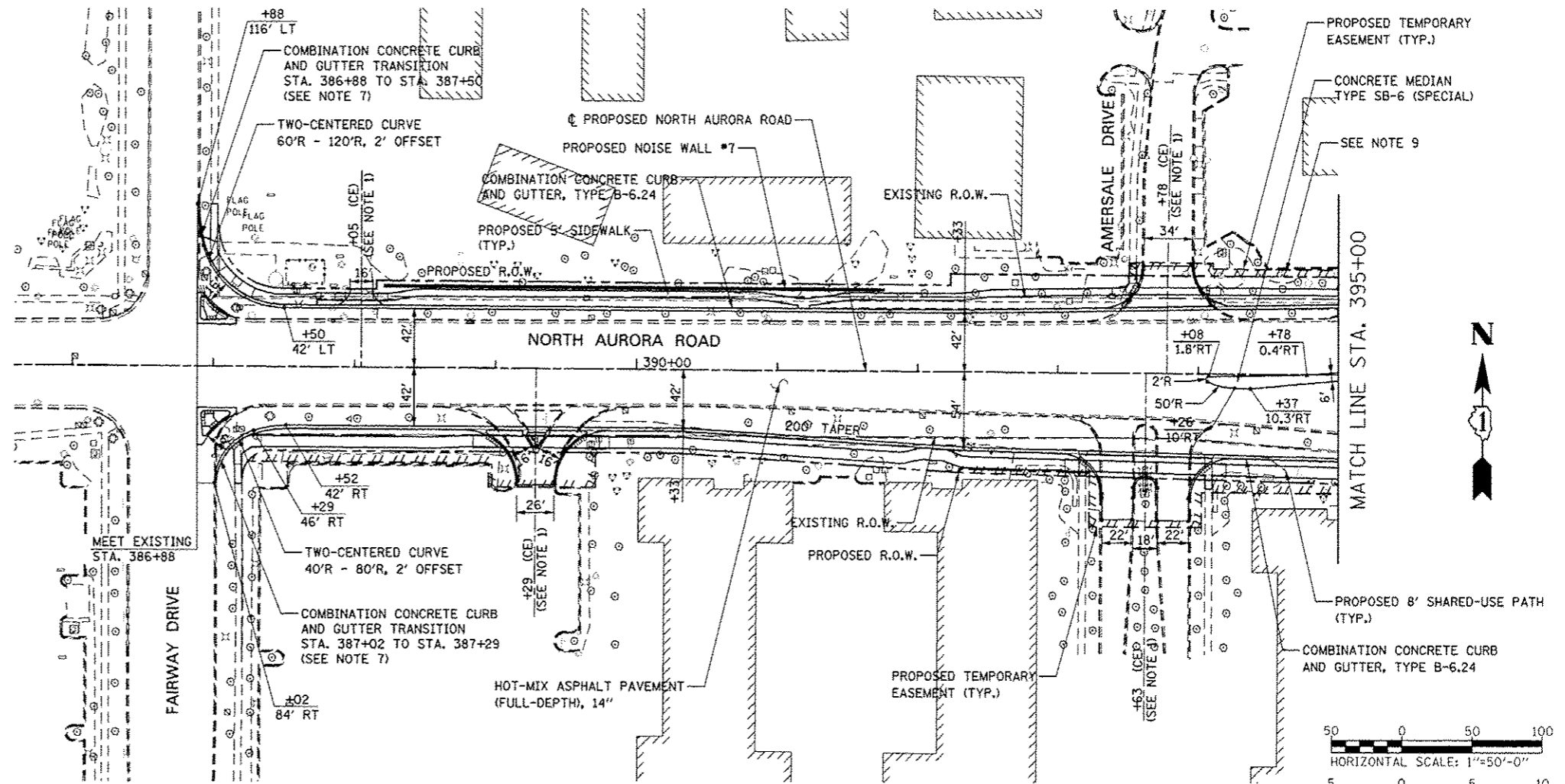

DESIGNED	PJO	REVISED - ADDENDUM A 02/20/2013	STATE OF ILLINOIS DEPARTMENT OF TRANSPORTATION	PLAN AND PROFILE - NORTH AURORA ROAD				F.A.P. RTE.	SECTION	COUNTY	TOTAL SHEETS	SHEET NO.
DRAWN	KES	REVISED -						338	(112 & 113) WRS-7	DUPAGE	1156	314
CHECKED	JCM	REVISED -						CONTRACT NO. 60R30				
DATE	12/14/2012	REVISED -						ILLINOIS FED. AID PROJECT				

SCALE: AS SHOWN SHEET NO. 14 OF 16 SHEETS STA. 386+88 TO STA. 395+00