

LOCATION	STATION	OFFSET
(A)	3915+84.8	106.5' LT
(B)	3915+85.2	86.1' LT
(C)	3915+97.1	85.8' LT
(D)	3915+96.7	106.2' LT

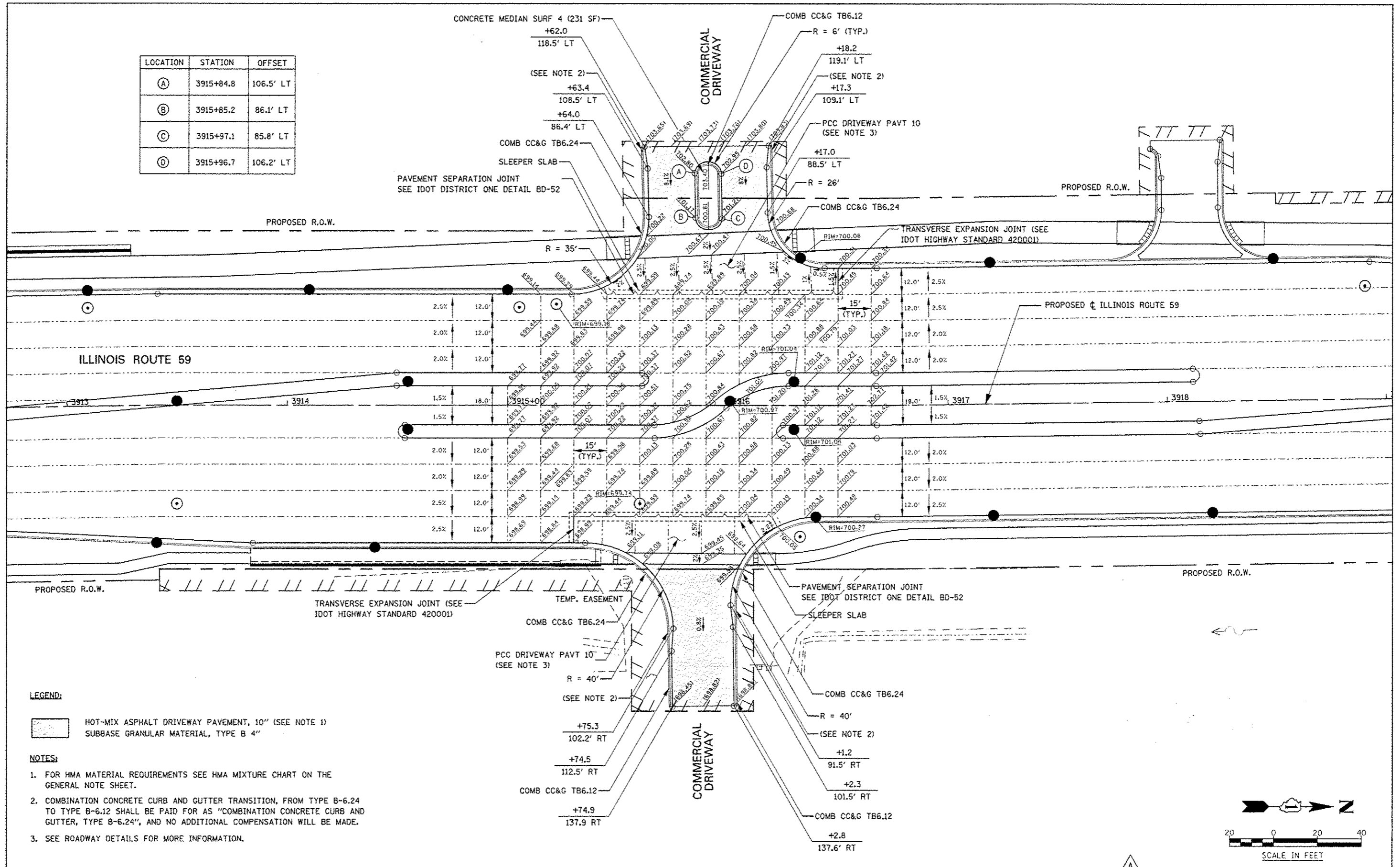

LEGEND:

- HOT-MIX ASPHALT DRIVEWAY PAVEMENT, 10" (SEE NOTE 1)
- SUBBASE GRANULAR MATERIAL, TYPE B 4"

NOTES:

1. FOR HMA MATERIAL REQUIREMENTS SEE HMA MIXTURE CHART ON THE GENERAL NOTE SHEET.
2. COMBINATION CONCRETE CURB AND GUTTER TRANSITION, FROM TYPE B-6.24 TO TYPE B-6.12 SHALL BE PAID FOR AS "COMBINATION CONCRETE CURB AND GUTTER, TYPE B-6.24", AND NO ADDITIONAL COMPENSATION WILL BE MADE.
3. SEE ROADWAY DETAILS FOR MORE INFORMATION.

DESIGNED	PJO	REVISED - ADDENDUM A 02/20/2013
DRAWN	KES	REVISED -
CHECKED	JCM	REVISED -
DATE	12/14/2012	REVISED -

**STATE OF ILLINOIS
DEPARTMENT OF TRANSPORTATION**

DRIVEWAY DETAILS
ILLINOIS ROUTE 59 - STA. 3915 + 88 RT. & STA. 3915 + 91 LT.

F.A.P. RTE.	SECTION	COUNTY	TOTAL SHEETS	SHEET NO.
338	012 & 113) WRS-7	DUPAGE	1156	376
				CONTRACT NO. 60R30
ILLINOIS FED. AID PROJECT				